



**DEPARTMENT OF NATURAL RESOURCES
STATE OF MICHIGAN
TIMBER SALE PROSPECTUS #7423**

SCHEDULED SALE DATE AND TIME: 10:00 a.m. (local time) on May 21, 2024.

LOCATION: ATLANTA MGMT UNIT, 13501 M 33, ATLANTA, MI 49709.

PROSPECTUS NOTE: The bidder is advised to inspect the sale area and review the location, estimated volumes, operating costs and contract terms of proposed sales. Please be aware that some landowners may request 60 days or more notice for access across their land.

Notice is hereby given that bids will be received by the Unit Manager, ATLANTA MANAGEMENT UNIT, for certain timber on the following described lands:

Oh Deer Aspen (54-009-23) / T33N, R02E, SEC. 1 , SESE.

T33N, R02E, SEC. 11, NENW,NWNE.

T33N, R02E, SEC. 12, NW,N1/2NE,SWNE.

Presque Isle County, Advertised Price \$155,983.00, 94.9 Acres, Aspen, Hardwood.

SALE NOTE: Good access. Some minor road work will be needed to access Payment Units 2 & 3; this may include some fill and/or gravel. No restrictions within the Sale Area. Producer is able to use the nearby wildlife openings for landings, but will be required to clean up any ruts, wood debris such as trimmings, chips and/or slash once operations are complete.

Stevens Springs Eternal (54-015-23) / T31N, R02E, SEC. 13, S1/2SE.

T31N, R02E, SEC. 24, N1/2NE,SENE,SE.

T31N, R02E, SEC. 25, N1/2NE.

T31N, R03E, SEC. 19, SWNW,NWSW.

Montmorency County, Advertised Price \$157,345.00, 134.4 Acres, Aspen, Hardwood.

SALE NOTE: Oak wilt restrictions over the entire Sale Area.

A recreation site such as a trail, pathway, or campground is within the sale area or the vicinity. Certain restrictions/specifications may be applicable including time restrictions.

Kinzie Conversion Oak (54-016-23) / T31N, R02E, SEC. 23, E1/2NW,W1/2NE,N1/2SW,NWSE.

Montmorency County, Advertised Price \$85,432.60, 70.1 Acres, Hardwood, Red Oak.

SALE NOTE: 2.2.2 - Chipping required (2/18)

The Sale Area must be chip harvested to facilitate subsequent planting operations.

2.2.3 - Stump heights (4/07)

Stump heights within the Sale Area shall not exceed 6 inches for all trees. This is in order to facilitate planting operations.

5.2.3.4 - Oak wilt restriction, no exceptions (1/18)

Within Payment Unit 1, cutting, skidding, hauling within the sale and brushing of access roads to the sale are not

permitted during the period of April 15 to July 15. No exceptions will be granted.

5.2.3.5 - Oak wilt restriction (1/18)

Within Payment Unit 2 & 3, unless changed by written agreement, cutting, skidding, hauling within the sale and brushing of access roads to the sale are not permitted during the period of April 15 to July 15.

Road Challenge Mix (54-043-23) / T33N, R05E, SEC. 33, E1/2NE,NESE.

T33N, R05E, SEC. 34, W1/2NW,SWSW.

Presque Isle County, Advertised Price \$23,434.15, 45.0 Acres, Hardwood, Spruce/Fir/ Tamarack.

SALE NOTE: Extensive road work is required. Refer to sale spec 4.1.8 for details.

Private access may be desired. Refer to sale spec 4.4.1 for details.

BID INSTRUCTIONS (VER. 10/10/2022):

1. Scheduled Bid Location, Date, and Time (2/11)

Bids must be received by the Unit Manager, ATLANTA OFFICE, 13501 M 33, ATLANTA, MI 49709, no later than 10:00 a.m. (local time) on May 21, 2024. For further information concerning this sale, contact Matt Foster at 989-619-5921 extension .

2. Bidder's Qualifications (10/22)

If all or part of a timber sale was prepared by a private contractor, the contractor and that contractor's company are not permitted to bid on the timber sale. A person must be 18 years of age or older to purchase timber. Permanent employees of the Department of Natural Resources or members of their immediate household may not bid. Former employees, in the permanent or seasonal class, may not bid until 3 months after the last day of active duty. Bids will not be accepted from individuals or companies appearing on the DNR/FRD No-Bid List. This list contains the names of purchasers who previously failed to execute a contract within 21-days or who have a history of poor performance.

3. Preparation of Sealed Bids (5/16)

Bid Forms may be completed online thru Michigan DNR Timber Sale Online Bidding (OLB) at www.michigan.gov/timberbidding or by completing the hardcopy Bid Form found in the Timber Sale Prospectus . Hardcopy Bid Forms shall be manually signed in ink. Registration in OLB is considered your 'signature' for all bids submitted thru that system. Bid prices must be entered for each species and product in the Bid Price column for all material subject to bidding and all fill-in blanks must be completed. If erasures or other changes appear on the hardcopy Bid Form, each erasure or change must be initialed by the person signing the bid.

4. Submission of Sealed Bids (5/16)

Bid forms may be obtained from the Unit Manager or thru OLB. Bids may be submitted hardcopy or thru OLB. All hardcopy bids must be submitted on the bid form and in an envelope clearly identified as described in this section. NOTE: Only one bid form per bid envelope. Sealed bids must be submitted to the Unit office designated in the prospectus and must be submitted at or prior to the time established in the prospectus. The envelope should show on the outside (a) the sale name or number and (b) the date and time of bid opening, as shown in the prospectus. Bids received after the time specified in the sale prospectus are late bids and will be rejected.

It is possible for a bidder to submit multiple bids on a single sale. For example, a bid may be submitted hardcopy and a bid may be submitted thru OLB. Or, two bidders from the same company could both submit bids on the same sale. If this were to happen, the State would accept all bids received and award the contract accordingly. All bidding and contractual requirements would apply to all bids received.

5. Public Opening of Sealed Bids (7/16)

If conditions permit, the sealed bids will be publicly opened and posted at the time and place set in the prospectus.

If a bidder, present at a bid opening, has submitted bids on more than one sale, that bidder may withdraw their unopened bid envelopes or announce the withdrawal of their online bid after being declared the successful bidder on one sale.

6. Award of Contract (1/11)

Award of the contract will be made to the Bidder whose bid, conforming to the prospectus, is most advantageous to the State of Michigan on the basis of total value at rates bid for the estimated quantities. The State reserves the right to reject any bid or waive any minor irregularity in bids received. A written award mailed (or otherwise furnished) to the successful Bidder shall be deemed to result in a binding contract without further action by either party.

7. Down Payment (1/11)

The Bidder to whom award is made must make a down payment within 21 days of the sale award. The amount of the down payment will be calculated as shown in the Bond and Payment Schedule of this prospectus. Only cash may be used to meet this requirement.

8. Performance Security (1/11)

As guarantee of faithful performance, a cash bond, certificate of deposit, surety bond or irrevocable letter of credit (LOC) is required within 21 days of the sale award. The amount of the performance security is shown in the Bond and

Payment Schedule of this prospectus. If an LOC or surety is used, the coverage must extend for at least 6 months beyond the contract expiration.

9. Worker's Compensation (10/22)

Purchaser shall obtain worker's compensation insurance to cover claims under Michigan's Worker's Disability Compensation Act of 1969 or similar employee benefit act of any other state applicable to an employee. Verification of Worker's Disability Compensation Act Compliance must be completed and submitted within 21 days of contract award and prior to the issuance of the timber sale contract. In addition, if applicable, Notice of Exclusion or Certificate of Insurance must also be submitted.

10. Timber Sale Contract (10/22)

Additional conditions and requirements common to all timber sales are listed on the timber sale contract (R4031) and are available on line at www.michigan.gov/timber. Contact the Unit Manager for additional information or a sample contract. Within 21 days of the date of the award letter, the bidder must sign the contract and provide the required down payment, performance security, and verification of worker's disability compensation. The down payment and performance security shall be in accordance with the provisions of the timber sale contract, in the sums stated in this prospectus. If these actions are not taken, then the Bidder, the Bidder's corporation, and the corporation's principals may not be permitted to bid on State timber sales for a period of 3 months after the first offense, 6 months after the second offense, and 1 year after the third offense. An offense will only be counted against the Bidder for 5 years. In addition, the Bidder certifies that if awarded this contract, the Bidder will complete the timber sale contract in accordance with its terms and any modifications thereof including requirements to purchase, cut, and remove the included timber by the expiration date.

Payment Unit values in the State Forest Timber Sale Contract are calculated based on the advertised value of the Payment Unit as a percentage of the total advertised value of the contract. The advertised value of each Payment Unit is given in the Description of Timber by Payment Unit table on the Timber Sale Information page. For example, if the value of Payment Unit 1 is advertised as \$1,500 and the total Timber Sale value is advertised as \$10,000, the contract price for Payment Unit 1 will be 15% of the total bid price ($\$1,500/\$10,000 * 100$).

11. Disclaimer of Estimates and Bidder's Warranty of Inspection (10/22)

Before submitting this bid, the Bidder is advised and cautioned to inspect the sale area, review the requirements of the sale contract, and take other steps as may be reasonably necessary to ascertain the location, estimated volumes, construction estimates, and operating costs of the proposed sale. Failure to do so will not relieve the Bidder from responsibility for completing the contract.

The Bidder warrants that this bid is submitted solely on the basis of the Bidder's examination and inspection of the quality and quantity of the timber offered for sale and the Bidder's opinion of the value thereof and the costs of recovery. No reliance should be placed on the State of Michigan's estimates of timber quality, quantity or costs of recovery. Bidder further acknowledges that the State of Michigan: (i) expressly disclaims any warranty of fitness of timber for any purpose; (ii) offers this timber as is without any warranty of quality (merchantability) or quantity and (iii) expressly disclaims any warranty as to the quantity or quality of timber sold.

12. Certification and Chain-of-Custody (10/22)

Unless otherwise indicated in the contract under section 7 – Other Conditions of the Sale Specific Conditions & Requirements, the area encompassed by this timber sale is certified to the standards of the Forest Stewardship Council (FSC) - Certificate #SCS-FM/COC-00090N and the Sustainable Forestry Initiative (SFI) - Certificate #NSF-SFIS-5Y031-SF5. Forest products from this sale may be delivered to the mill as "FSC 100% and / or SFI certified" as long as the contractor hauling the forest products is chain-of-custody (COC) certified or covered under a COC certificate from the destination mill. The purchaser is responsible for maintaining COC after leaving the sale area.

13. Good Neighbor Authority (GNA) Requirements (10/22)

If the name of this timber sales contains the acronym GNA, it is authorized by the Good Neighbor Authority (GNA) and covered by various agreements between the U.S. Forest Service and the State. The timber sale occurs on federal land and the following conditions apply:

GNA contracts on US Forest Service land will not be awarded to purchasers on the Federal list of excluded parties. The System for Award Management (SAM) will be checked for active excluded parties prior to award of contract. In

addition, the Bidder to whom award is made must complete an Assurance Regarding Felony Conviction or Tax Delinquent Status for Corporate Applicants (AD-3031).

14. Good Neighbor Authority (GNA) Requirements, con't (10/22)

Bidder certifies, by signing this bid form, that to the best of Bidder's knowledge that the following representations are accurate and complete.

- a. That the Bidder and its principals are not presently debarred, suspended, proposed for debarment, declared ineligible, or voluntary excluded from timber sales (covered transactions) by any Federal department or agency.
- b. That the Bidder and its principals have not within a 3-year period preceding this bid been convicted of or had a civil judgment rendered against them for commission of fraud or a criminal offense in connection with obtaining , attempting to obtain, or performing a public (Federal, State, or local) transaction or contract under a public transaction; violation of Federal or State antitrust statutes or commission of embezzlement, theft, forgery, bribery, falsification or destruction of records, making false statements, or receiving stolen property.
- c. That the Bidder and its principals are not presently indicted for or otherwise criminally or civilly charged by a governmental entity (Federal, State, or local) with commission of any of the offenses enumerated in paragraph b of this certification.
- d. That the Bidder and its principals have not within a 3-year period preceding this bid had one or more public transactions (Federal, State, or local) terminated for breach or default of a timber or forest product contract.

Bidders that cannot certify this requirement, in whole or in part, shall submit an explanation with their bid.

Scott Bowen
Director

TIMBER SALE INFORMATION

Oh Deer Aspen (54-009-23)

T33N, R02E, SEC. 1; T33N, R02E, SEC. 11; T33N, R02E, SEC. 12.

Presque Isle County (Advertised Price \$155,983.00)

SALE NOTE: Good access. Some minor road work will be needed to access Payment Units 2 & 3; this may include some fill and/or gravel. No restrictions within the Sale Area. Producer is able to use the nearby wildlife openings for landings, but will be required to clean up any ruts, wood debris such as trimmings, chips and/or slash once operations are complete.

A timber sale contract for this lump sum, sealed bid timber sale will be awarded to the responsible bidder offering the highest sealed bid price. All units of volume listed below were estimated using the Inventory Manager computer program and the new Michigan taper model. Bids must be at or above the following advertised price for each product and species:

<u>PRODUCTS & SPECIES</u>	<u>ESTIMATED UNITS*</u>		<u>ADVERTISED PRICE</u>
Sawtimber			
Mixed Aspen	259.5	MBF	\$ 111.00 / MBF
Red Oak	103.4	MBF	\$ 195.00 / MBF
Red Pine	3.8	MBF	\$ 139.00 / MBF
Sugar Maple	10.5	MBF	\$ 462.00 / MBF
White Pine	11.5	MBF	\$ 127.00 / MBF
Pulpwood			
Balsam Fir	351	Cords	\$ 20.20 / Cord
Basswood	12	Cords	\$ 15.65 / Cord
Mixed Aspen	2,718	Cords	\$ 25.00 / Cord
Mixed Hardwood	492	Cords	\$ 24.90 / Cord
Paper Birch	22	Cords	\$ 16.15 / Cord
Red Oak	218	Cords	\$ 33.75 / Cord
Red Pine	6	Cords	\$ 40.20 / Cord
White Pine	170	Cords	\$ 27.90 / Cord

* The total volume is statistically estimated within plus (+) or minus (-) 9.63 percent. There are an estimated 4,808 cords on this timber sale, plus or minus 463 cords at the 95% confidence level. The estimated units are final and not subject to adjustment. Prospective bidders are urged to examine this timber and to make their own estimates of quantity and quality.

BOND AND PAYMENT SCHEDULE:

1. A bond in the amount of \$7,799.00 to insure faithful performance of the conditions of the contract will be deposited by the successful bidder within 21 days of the sale award.
2. Cutting in any sale or unit without the required advance payment would be considered a trespass.
3. Total payment must be paid in advance or according to the following schedule :
 - (a) Ten percent (10%) of the sale value must be paid within 21 days of the sale award.
 - (b) The 10% down payment will be credited towards the first unit cut.
 - (c) Payment for each of the following units must be made before cutting begins in that unit:

PAYMENT UNIT NUMBER	PERCENT OF TOTAL SALE VALUE
01	14.9%
02	50.9%
03	34.2%

4. If no cutting takes place, the 10% down payment will not be refunded.
5. Operations on the contract issued will terminate on 06/30/2026.

SALE STATISTICS

Volumes were calculated in cubic feet using the Michigan taper model. Cubic foot volume includes all wood inside bark for the product indicated. For display purposes, cubic feet were converted to cords and MBF using a simple conversion factor, e.g. 79 cubic feet per cord and 185 cubic feet per MBF. The cubic foot volumes are precise; the cords and MBF volumes are not. Cubic foot volume cannot be directly converted to cords or boards with precision.

SALE VOLUMES

The total estimated sale volume may not equal the sum of the species/products due to the nature of statistical calculations associated with double sampling methodology.

VOLUME			STATISTICAL RANGE IN CORDS	
TOTAL CUBIC FEET	TOTAL CORDS	PERCENT ERROR	MINIMUM	MAXIMUM
379,827	4,808	9.63%	4,345	5,271

VDU VOLUMES

A VDU is a Volume Determination Unit. Volumes and their associated statistics are calculated at the VDU level and summarized to the sale level. There is often a one to one relationship between a VDU and a Payment Unit, but not always, depending on the cruise design. Refer to the VDU TO PAYMENT UNIT table.

	VOLUME			RANGE IN CORDS	
VDU	TOTAL CUBIC FEET	TOTAL CORDS	PERCENT ERROR	MINIMUM	MAXIMUM
21	39,701	503	18.30%	411	595
63	340,126	4,305	11.00%	3,832	4,779
TOTAL:	379,827	4,808		4,242	5,373

VDU TO PAYMENT UNIT

When a VDU is associated with more than one Payment Unit (PU), the VDU volumes are assigned to the PU based on acres of the VDU within the PU.

VDU	VDU ACRES	PU	PU ACRES
21	11.3	1	11.3
63	83.6	2	50.0
		3	33.6
TOTAL:	94.9		94.9

DESCRIPTION OF TIMBER BY PAYMENT UNIT (PU)

PU	MARKET GROUP	PRODUCT	QUANTITY	UNIT	ACRES	ADVERTISE PRICE
1	Mixed Aspen	Sawtimber	3.2	MBF	11.3	\$23,302.75
	<i>Quaking Aspen</i>		3.2	<i>MBF</i>		
	Red Oak		50.7	MBF		
	Sugar Maple		10.5	MBF		
	Balsam Fir	Pulpwood	65	Cords		
	Basswood		12	Cords		
	<i>Basswood</i>	<i>Sawtimber</i>	3.0	<i>MBF</i>		
	<i>Basswood</i>	<i>Pulpwood</i>	6	<i>Cords</i>		
	Mixed Aspen		13	Cords		
	<i>Quaking Aspen</i>		13	<i>Cords</i>		
	Mixed Hardwood		173	Cords		
	<i>Red Maple</i>	<i>Sawtimber</i>	5.1	<i>MBF</i>		
	<i>Beech</i>	<i>Pulpwood</i>	4	<i>Cords</i>		
	<i>Red Maple</i>		57	<i>Cords</i>		
	<i>Sugar Maple</i>		102	<i>Cords</i>		
	Paper Birch		22	Cords		
	<i>Paper Birch</i>	<i>Sawtimber</i>	3.4	<i>MBF</i>		
	<i>Paper Birch</i>	<i>Pulpwood</i>	15	<i>Cords</i>		
	Red Oak		51	Cords		
	2	Mixed Aspen	Sawtimber	153.3		
<i>B. T. Aspen</i>			124.6	<i>MBF</i>		
<i>Quaking Aspen</i>			28.7	<i>MBF</i>		
Red Oak			31.5	MBF		
Red Pine			2.3	MBF		
White Pine			6.9	MBF		
Balsam Fir		Pulpwood	171	Cords		
Mixed Aspen			1,618	Cords		
<i>B. T. Aspen</i>			1,310	<i>Cords</i>		
<i>Quaking Aspen</i>			308	<i>Cords</i>		
Mixed Hardwood			191	Cords		
<i>Red Maple</i>			183	<i>Cords</i>		
<i>Sugar Maple</i>			8	<i>Cords</i>		
Red Oak			100	Cords		
Red Pine			4	Cords		
White Pine			102	Cords		
3		Mixed Aspen	Sawtimber	103.0	MBF	33.6
	<i>B. T. Aspen</i>		83.7	<i>MBF</i>		
	<i>Quaking Aspen</i>		19.3	<i>MBF</i>		
	Red Oak		21.2	MBF		
	Red Pine		1.5	MBF		
	White Pine		4.6	MBF		
	Balsam Fir	Pulpwood	115	Cords		
	Mixed Aspen		1,087	Cords		
	<i>B. T. Aspen</i>		880	<i>Cords</i>		
	<i>Quaking Aspen</i>		207	<i>Cords</i>		
	Mixed Hardwood		128	Cords		
	<i>Red Maple</i>		123	<i>Cords</i>		
	<i>Sugar Maple</i>		5	<i>Cords</i>		
	Red Oak		67	Cords		
	Red Pine		2	Cords		
	White Pine		68	Cords		
	TOTAL:			388.7	MBF	
TOTAL:			3,989	Cords		

Sale Specific Conditions & Requirements

Sale Name: Oh Deer Aspen

Sale Number: 54-009-23 Seq#: 2

1 - Sale Area

1.2 - Boundaries

1.2.1 - Painted boundaries (9/19)

The sale boundary and Payment Unit boundaries are marked and identified by blue, red and yellow paint. Exterior sale boundary lines against private property are marked with blue paint, with the exception of the northern boundary of Payment Unit 1, which is unpainted and identified by 6 Mile Highway. Exterior sale boundary lines against state are marked with red paint, with the exception of the northern boundary of Payment Unit 3, which is unpainted and identified by 6 Mile Highway. Interior Payment Unit boundaries are marked with yellow paint. Retention patches are marked with Red X's; no harvesting activities may occur within these areas. The painted boundary line trees are not Included Timber and are to be protected. Yellow painted trees designating an interior Payment Unit boundary are only to be cut when all surrounding Payment Units have been paid.

2 - Timber Specifications

2.1 - Included Timber

2.1.1 - Clearcut unit(s) with unmerchantable trees (6/14)

Within Payment Unit(s) 1-3, cut all trees that are two (2) inches or more at DBH, except do not cut any trees marked with timber teal paint. Special protection trees identified in accordance with condition 3.4.2, within clearcutting unit boundaries, are not Included Timber and are to be protected.

3 - Payments

3.3 - Pre-measured Sales

3.3.4 - Dividing payment units (7/14)

Payment Unit(s) over \$25,000 may be divided at the request of the Purchaser and upon approval of the Unit Manager. Dividing Payment Units is a contract modification which requires a Timber Sale Contract Amendment. There will be only one division per Payment Unit.

3.4 - Damaged Timber

3.4.2 - Special Protection Trees (4/14)

The Purchaser shall not cut live or dead special protection trees within cutting units or clearings. Special protection trees are marked with timber teal paint. If the Purchaser's operations have cut or damaged special protection trees through carelessness, the Purchaser shall pay \$250 as fixed, agreed and liquidated damages for each special protection tree cut or damaged. Such payment does not constitute ownership of the undesignated timber.

4 - Transportation

4.1 - Construction

4.1.3 - Slash and earthen piles (8/04)

Piles or windrows of earth along roads and landings that have been widened or constructed shall be leveled. Slash from road maintenance or construction, including stumps, shall be dispersed throughout the sale, chipped, utilized or otherwise removed from the sale.

4.1.6 - Road construction (1/09)

Construction of new roads or improvements of existing roads shall be done in such a way as to minimize the environmental and visual impacts. Merchantable trees shall be cut and utilized unless otherwise directed. Non-merchantable trees shall be severed and laid flat on the ground. Slash shall be scattered, and not left in windrows and kept a minimum of 10 feet back from the road edge or be chipped, utilized or otherwise removed from the sale. Stumps shall be set upright, not left on edge, and be moved at least 10 feet away from the road edge. Disturbed soil shall be feathered into the woods and not left in berms or windrows.

4.1.7 - Road closure (10/11)

All new roads built into the sale must be blocked to vehicle traffic within 30 days of completion of hauling. Overgrown roads that are reopened shall be considered new roads. In general, this will require constructing a four (4') foot high berm of stumps and logs covered with earth. Stumps and brush must be placed along the remainder of the trail. These roads must be rendered impassable to cars and trucks. All stumps from road building and landing construction must be reserved to block any newly constructed roads upon completion of the sale. These stumps must be scattered along the road system to prohibit vehicular movement. Temporary berms may be required if no sale activity occurs for 30 or more consecutive days. Contact the Sale Administrator for specific details of design and placement.

4.2 - Maintenance

4.2.2 - Fill material (4/07)

To maintain roads, fill material may be needed in areas where "holes" exist or may be expected to develop. This fill material should be placed before trucking begins.

4.2.4 - Grading (10/16)

For completion of the sale, state forest roads must be graded. In general, this will require a road grader or bulldozer to shape up the roads after forest products have been hauled off site. This includes cleaning of drainage areas, grading, crowning and filling with gravel, if necessary. The grading equipment to be used must be approved by the Unit Manager or his/her representative.

5 - Operations

5.1 - Notification

5.1.4 - Post-sale conference (10/16)

A post-sale conference on site between the Purchaser and sale administrator is required 5 days prior to the completion of active logging operations to determine clean-up and repair of landings, road edges, and the fulfillment of other contract specifications.

5.2 - Conduct of Operations

5.2.1 - Slash

5.2.1.8 - Slash height (12/08)

No slash or treetops may exceed 24 inches in height. Slash and/or treetops shall be left scattered and not in windrows.

5.2.1.10 - No slash in openings (5/10)

No brush or logging debris is to be left in the maintained wildlife opening which is indicated by "G0" on the Timber Sale Map. Any damage to the opening shall be repaired according to specifications of the Unit Manager or his/her representative.

5.2.2 - Hazard Trees/Snags

5.2.2.1 - Den trees (10/16)

Obvious hollow and/or den trees shall be protected and left standing unless they are a safety hazard.

5.2.4 - Dead and Down Creation

5.2.4.4 - Dead and down creation, grouse (6/18)

To encourage grouse and other wildlife, in Payment Unit(s) 1-3 leave one 12" or larger diameter (or largest diameter trees within stand) whole tree on the ground for every 2 acres, preferably a hardwood species such as oak or maple or if no hardwoods are present, a pine species (white or red). These trees will be evenly scattered throughout the Payment Unit, preferably at least two chains from any roads, two-tracks, or trails open to vehicles.

5.2.32 - Decking/landing restoration (9/13)

All decking and landing areas must have the surface area restored to a condition equal to or better than before. This is to ensure the proper regeneration of the stand. Wood debris, chips and "cookies" from trimmings must be removed or scattered away from landing and loading areas and may not be windrowed on the edge.

If any of the wildlife openings (labeled "G0" on the Timber Sale Map) are used for landings, they must be left rut free and free

of slash, trimmings, or any wood debris. The producer will be required to restore these openings before the bond can be released once operations are complete.

5.2.38 - No decking against live trees (2/04)

Cut products may not be decked against unmarked or designated leave trees.

5.4 - Soil Protection

5.4.1 - Rutting restriction, general (7/16)

Operations are to cease immediately if equipment and weather conditions result in rutting of roads and/or skid trails which is 12 inches or greater in depth and 25 feet in length. The Unit Manager or his/her representative may restrict hauling and/or skidding if ruts exceed the specified depth. With the Unit Manager or his/her representative's approval, the Purchaser may return to the area when the risk of rutting has decreased.

5.7 - Protection of Historical Sites

5.7.2 - Potential historical site(s) (9/06)

The State Historic Preservation Office has identified the potential for a historic site within the boundary of this timber sale. Note that if the site is discovered during operations, General Condition and Requirement 5.7 - Protection of Historical Sites will apply.

5.8 - Protection of Endangered Species

5.8.5 - Protection of raptor nests (3/13)

All trees with raptor nests will be protected if found during harvesting operations. Notification will be made to the Unit Manager or his/her representative who will notify the Wildlife Biologist so an on-site evaluation and recommendation can be made, if necessary.

6 - Safety and Fire Prevention

6.2 - Signing

6.2.1 - Road posting (10/20)

The Purchaser is responsible for posting and maintaining caution signs on Six Mile Highway prior to beginning operations. The road must be posted at appropriate distances from the Sale Area to warn of logging activity and truck traffic. Signs must be removed when harvest operations are suspended or completed. The Purchaser will provide these signs.



TIMBER SALE MAP

This information provided by authority of Part 525, 1994 PA 451, as amended.

Forest Management Unit Atlanta Management Unit		County Presque Isle	Mapped By T. Kubitskey	Date 9/11/2023	Page 1	of 1
Township 33N	Range 02E	Section(s) and Subdivision(s) Sec. 1 SESE, Sec. 11 N1/2, Sec 12 NW, N1/2NE, SWNE		Scale 1:15,840		

Cover Type				Density	
A = Aspen	H = Hemlock	N = Marsh	U = Upland Brush	0 = Non Stocked	5 = Pole Timber Medium
B = Paper Birch	J = Jack Pine	O = Oak	UM = Upland Mixed	1 = Seedling Sapling Poor	6 = Pole Timber Well
C = Cedar	L = Lowland Brush	P = Lowland Poplar	V = Bog or Marsh	2 = Seedling Sapling Medium	7 = Saw Timber Poor
D = Treed Bog	LM = Lowland Mixed	Q = Mixed Swamp Conifer	W = White Pine	3 = Seedling Sapling Well	8 = Saw Timber Medium
E = Swamp Hdwoods	M = Mpl, Bch, Brch	R = Red Pine	X = Non Stocked	4 = Pole Timber Poor	9 = Saw Timber Well
F = Spruce Fir	MC = Mixed Conifer	S = Black Spruce	Z = Water		
G = Grass	MD = Mixed Deciduous	T = Tamarack			

PU	Acres
1	11.3
2	50
3	33.6

Oh Deer Aspen

Compartment 116

94.9 Acres

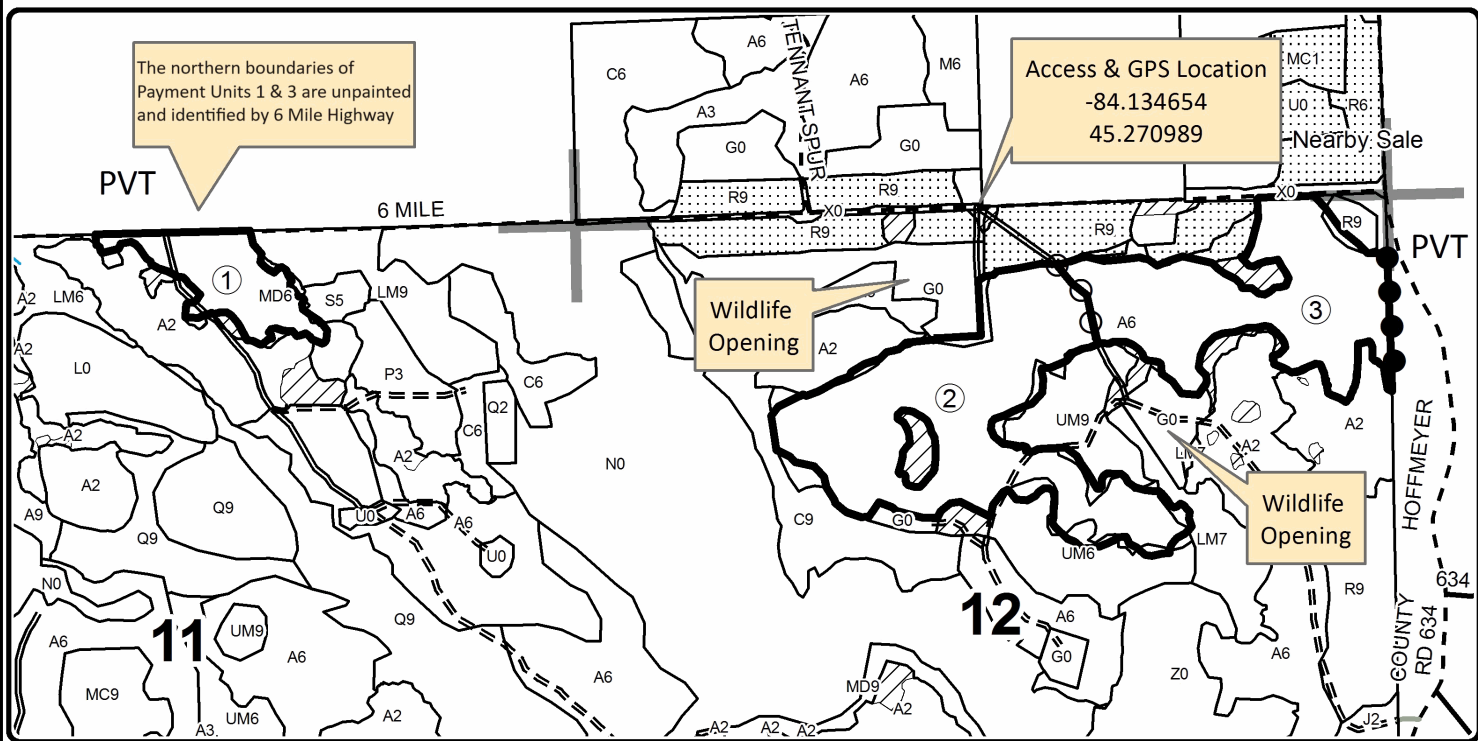
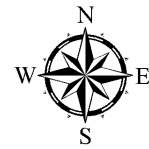

Avenza Map

Locator Map
1:150,000

Legend	
	Against State (Red)
	Payment Unit (Yellow)
	Private Line (Blue)
	Retention Area
	Stand Boundaries
	Nearby Timber Sales
	Secondary Forest Road
	Forest Access Route
	Paved Road
	Gravel Road
	Private
	Perennial River
	Section Corners

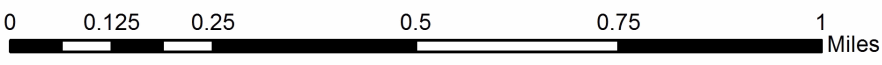
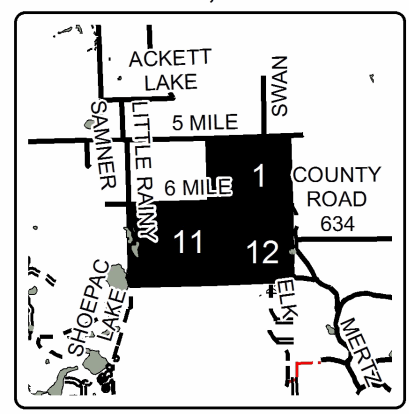

TIMBER SALE INFORMATION

Stevens Springs Eternal (54-015-23)

T31N, R02E, SEC. 13; T31N, R02E, SEC. 24; T31N, R02E, SEC. 25; T31N, R03E, SEC. 19.
Montmorency County (Advertised Price \$157,345.00)

SALE NOTE: Oak wilt restrictions over the entire Sale Area.

A recreation site such as a trail, pathway, or campground is within the sale area or the vicinity. Certain restrictions/specifications may be applicable including time restrictions.

A timber sale contract for this lump sum, sealed bid timber sale will be awarded to the responsible bidder offering the highest sealed bid price. All units of volume listed below were estimated using the Inventory Manager computer program and the new Michigan taper model. Bids must be at or above the following advertised price for each product and species:

<u>PRODUCTS & SPECIES</u>	<u>ESTIMATED UNITS*</u>		<u>ADVERTISED PRICE</u>
Sawtimber			
Black/Red (Hybrid) Oak	82.6	MBF	\$ 124.00 / MBF
Mixed Aspen	185.7	MBF	\$ 111.00 / MBF
Red Maple	10.7	MBF	\$ 77.00 / MBF
Red Oak	182.1	MBF	\$ 195.00 / MBF
Red Pine	10.7	MBF	\$ 139.00 / MBF
White Pine	49.7	MBF	\$ 127.00 / MBF
Pulpwood			
Balsam Fir	172	Cords	\$ 20.20 / Cord
Mixed Aspen	1,739	Cords	\$ 25.00 / Cord
Mixed Hardwood	527	Cords	\$ 24.90 / Cord
Mixed Oak	540	Cords	\$ 33.75 / Cord
Paper Birch	34	Cords	\$ 16.15 / Cord
Red Pine	15	Cords	\$ 40.20 / Cord
Tamarack	17	Cords	\$ 20.10 / Cord
White Pine	92	Cords	\$ 27.90 / Cord

* The total volume is statistically estimated within plus (+) or minus (-) 9.64 percent. There are an estimated 4,634 cords on this timber sale, plus or minus 447 cords at the 95% confidence level. The estimated units are final and not subject to adjustment. Prospective bidders are urged to examine this timber and to make their own estimates of quantity and quality.

BOND AND PAYMENT SCHEDULE:

1. A bond in the amount of \$7,867.00 to insure faithful performance of the conditions of the contract will be deposited by the successful bidder within 21 days of the sale award.
2. Cutting in any sale or unit without the required advance payment would be considered a trespass.
3. Total payment must be paid in advance or according to the following schedule:
 - (a) Ten percent (10%) of the sale value must be paid within 21 days of the sale award.
 - (b) The 10% down payment will be credited towards the first unit cut.
 - (c) Payment for each of the following units must be made before cutting begins in that unit:

PAYMENT UNIT NUMBER	PERCENT OF TOTAL SALE VALUE
01	13.6%
02	15.8%
03	20.2%
04	28.7%
05	9.6%
06	12.1%
4. If no cutting takes place, the 10% down payment will not be refunded.
5. Operations on the contract issued will terminate on 06/30/2028.

SALE STATISTICS

Volumes were calculated in cubic feet using the Michigan taper model. Cubic foot volume includes all wood inside bark for the product indicated. For display purposes, cubic feet were converted to cords and MBF using a simple conversion factor, e.g. 79 cubic feet per cord and 185 cubic feet per MBF. The cubic foot volumes are precise; the cords and MBF volumes are not. Cubic foot volume cannot be directly converted to cords or boards with precision.

SALE VOLUMES

The total estimated sale volume may not equal the sum of the species/products due to the nature of statistical calculations associated with double sampling methodology.

VOLUME			STATISTICAL RANGE IN CORDS	
TOTAL CUBIC FEET	TOTAL CORDS	PERCENT ERROR	MINIMUM	MAXIMUM
366,070	4,634	9.64%	4,187	5,081

VDU VOLUMES

A VDU is a Volume Determination Unit. Volumes and their associated statistics are calculated at the VDU level and summarized to the sale level. There is often a one to one relationship between a VDU and a Payment Unit, but not always, depending on the cruise design. Refer to the VDU TO PAYMENT UNIT table.

	VOLUME			RANGE IN CORDS	
VDU	TOTAL CUBIC FEET	TOTAL CORDS	PERCENT ERROR	MINIMUM	MAXIMUM
35	236,214	2,990	11.75%	2,639	3,341
76	47,620	603	24.17%	457	748
99	82,236	1,041	19.14%	842	1,240
TOTAL:	366,070	4,634		3,937	5,330

VDU TO PAYMENT UNIT

When a VDU is associated with more than one Payment Unit (PU), the VDU volumes are assigned to the PU based on acres of the VDU within the PU.

VDU	VDU ACRES	PU	PU ACRES
35	76.0	1	10.6
		2	7.5
		3	24.0
		4	33.9
76	24.1	1	7.9
		2	16.2
99	34.3	5	15.2
		6	19.1
TOTAL:	134.4		134.4

DESCRIPTION OF TIMBER BY PAYMENT UNIT (PU)

PU	MARKET GROUP	PRODUCT	QUANTITY	UNIT	ACRES	ADVERTISE PRICE
1	Black/Red (Hybrid)	Sawtimber	25.5	MBF	18.5	\$21,381.40
	Mixed Aspen		23.5	MBF		
	<i>B. T. Aspen</i>		17.1	<i>MBF</i>		
	<i>Quaking Aspen</i>		6.4	<i>MBF</i>		
	Red Maple		0.2	MBF		
	Red Oak		21.2	MBF		
	Balsam Fir	Pulpwood	20	Cords		
	Mixed Aspen		213	Cords		
	<i>B. T. Aspen</i>		117	<i>Cords</i>		
	<i>Quaking Aspen</i>		96	<i>Cords</i>		
	Mixed Hardwood		49	Cords		
	<i>Black Cherry</i>		1	<i>Cords</i>		
	<i>Red Maple</i>		43	<i>Cords</i>		
	<i>Sugar Maple</i>		4	<i>Cords</i>		
	<i>White Ash</i>		1	<i>Cords</i>		
	Mixed Oak		130	Cords		
	<i>/Red (Hybrid) Oak</i>		120	<i>Cords</i>		
	<i>Red Oak</i>		10	<i>Cords</i>		
	Paper Birch		4	Cords		
	Tamarack		3	Cords		
	<i>Tamarack</i>	<i>Sawtimber</i>	0.4	<i>MBF</i>		
<i>Tamarack</i>	<i>Pulpwood</i>	2	<i>Cords</i>			
2	Black/Red (Hybrid)	Sawtimber	50.7	MBF	23.7	\$24,861.50
	Mixed Aspen		16.7	MBF		
	<i>B. T. Aspen</i>		12.1	<i>MBF</i>		
	<i>Quaking Aspen</i>		4.6	<i>MBF</i>		
	Red Maple		0.1	MBF		
	Red Oak		15.0	MBF		
	Balsam Fir	Pulpwood	15	Cords		
	Mixed Aspen		162	Cords		
	<i>B. T. Aspen</i>		94	<i>Cords</i>		
	<i>Quaking Aspen</i>		68	<i>Cords</i>		
	Mixed Hardwood		46	Cords		
	<i>Red Maple</i>		43	<i>Cords</i>		
	<i>Sugar Maple</i>		3	<i>Cords</i>		
	Mixed Oak		243	Cords		
	<i>/Red (Hybrid) Oak</i>		236	<i>Cords</i>		
	<i>Red Oak</i>		7	<i>Cords</i>		
	Paper Birch		3	Cords		
	Tamarack		2	Cords		
	<i>Tamarack</i>	<i>Sawtimber</i>	0.3	<i>MBF</i>		
	<i>Tamarack</i>	<i>Pulpwood</i>	1	<i>Cords</i>		
	3	Black/Red (Hybrid)	Sawtimber	2.7		
Mixed Aspen			53.4	MBF		
<i>B. T. Aspen</i>			38.8	<i>MBF</i>		
<i>Quaking Aspen</i>			14.6	<i>MBF</i>		
Red Maple			0.4	MBF		
Red Oak			48.1	MBF		
Balsam Fir		Pulpwood	43	Cords		
Mixed Aspen			462	Cords		
<i>B. T. Aspen</i>			244	<i>Cords</i>		
<i>Quaking Aspen</i>			218	<i>Cords</i>		
Mixed Hardwood			87	Cords		
<i>Black Cherry</i>			1	<i>Cords</i>		
<i>Red Maple</i>			76	<i>Cords</i>		
<i>Sugar Maple</i>			9	<i>Cords</i>		

DESCRIPTION OF TIMBER BY PAYMENT UNIT (PU), CON'T

PU	MARKET GROUP	PRODUCT	QUANTITY	UNIT	ACRES	ADVERTISE PRICE
3 con't	<i>White Ash</i>	<i>Pulpwood</i>	1	<i>Cords</i>		
	Mixed Oak		40	Cords		
	<i>/Red (Hybrid) Oak</i>		18	<i>Cords</i>		
	<i>Red Oak</i>		22	<i>Cords</i>		
	Paper Birch		9	Cords		
	Tamarack		5	Cords		
	<i>Tamarack</i>	<i>Sawtimber</i>	0.9	<i>MBF</i>		
	<i>Tamarack</i>	<i>Pulpwood</i>	3	<i>Cords</i>		
4	Black/Red (Hybrid)	Sawtimber	3.7	MBF	33.9	\$44,994.40
	Mixed Aspen		75.4	MBF		
	<i>B. T. Aspen</i>		54.8	<i>MBF</i>		
	<i>Quaking Aspen</i>		20.6	<i>MBF</i>		
	Red Maple		0.6	MBF		
	Red Oak		67.8	MBF		
	Balsam Fir	Pulpwood	60	Cords		
	Mixed Aspen		653	Cords		
	<i>B. T. Aspen</i>		345	<i>Cords</i>		
	<i>Quaking Aspen</i>		308	<i>Cords</i>		
	Mixed Hardwood		124	Cords		
	<i>Black Cherry</i>		2	<i>Cords</i>		
	<i>Red Maple</i>		108	<i>Cords</i>		
	<i>Sugar Maple</i>		12	<i>Cords</i>		
	<i>White Ash</i>		2	<i>Cords</i>		
	Mixed Oak		57	Cords		
	<i>/Red (Hybrid) Oak</i>		25	<i>Cords</i>		
	<i>Red Oak</i>		32	<i>Cords</i>		
	Paper Birch		13	Cords		
	Tamarack		7	Cords		
	<i>Tamarack</i>	<i>Sawtimber</i>	1.2	<i>MBF</i>		
	<i>Tamarack</i>	<i>Pulpwood</i>	5	<i>Cords</i>		
	5	Mixed Aspen	Sawtimber	7.4		
<i>B. T. Aspen</i>			2.2	<i>MBF</i>		
<i>Quaking Aspen</i>			5.2	<i>MBF</i>		
Red Maple			4.2	MBF		
Red Oak			13.3	MBF		
Red Pine			4.7	MBF		
White Pine			22.0	MBF		
Balsam Fir		Pulpwood	15	Cords		
Mixed Aspen			110	Cords		
<i>B. T. Aspen</i>			20	<i>Cords</i>		
<i>Quaking Aspen</i>			90	<i>Cords</i>		
Mixed Hardwood			98	Cords		
<i>Black Cherry</i>			5	<i>Cords</i>		
<i>Red Maple</i>			93	<i>Cords</i>		
Mixed Oak			31	Cords		
<i>Red Oak</i>			31	<i>Cords</i>		
Paper Birch			2	Cords		
Red Pine			7	Cords		
White Pine		41	Cords			
6	Mixed Aspen	Sawtimber	9.3	MBF	19.1	\$19,071.80
	<i>B. T. Aspen</i>		2.7	<i>MBF</i>		
	<i>Quaking Aspen</i>		6.6	<i>MBF</i>		
	Red Maple		5.2	MBF		
	Red Oak		16.7	MBF		
	Red Pine		6.0	MBF		
	White Pine		27.7	MBF		

DESCRIPTION OF TIMBER BY PAYMENT UNIT (PU), CON'T

PU	MARKET GROUP	PRODUCT	QUANTITY	UNIT	ACRES	ADVERTISE PRICE
6 con't	Balsam Fir	Pulpwood	19	Cords		
	Mixed Aspen		139	Cords		
	<i>B. T. Aspen</i>		25	<i>Cords</i>		
	<i>Quaking Aspen</i>		114	<i>Cords</i>		
	Mixed Hardwood		123	Cords		
	<i>Black Cherry</i>		7	<i>Cords</i>		
	<i>Red Maple</i>		116	<i>Cords</i>		
	Mixed Oak		39	Cords		
	<i>Red Oak</i>		39	<i>Cords</i>		
	Paper Birch		3	Cords		
	Red Pine		8	Cords		
	White Pine		51	Cords		
TOTAL:			521.5	MBF		
TOTAL:			3,136	Cords		

Sale Specific Conditions & Requirements

Sale Name: Stevens Springs Eternal

Sale Number: 54-015-23 Seq#: 2

1 - Sale Area

1.2 - Boundaries

1.2.1 - Painted boundaries (9/19)

The sale boundary and Payment Unit boundaries are marked and identified by red and yellow paint, along with a road. Exterior sale boundary lines against state are marked with red paint, with the exception of the partial western boundary of Payment Unit 1, which is unpainted and represented by Stevens Spring Road (see Timber Sale Map). Interior Payment Unit boundaries are marked with yellow paint, with the exception of Stevens Spring Road, which is an unpainted Payment Unit boundary between Payment Units 1, 3, & 4. The painted boundary line trees are not Included Timber and are to be protected. Yellow painted trees designating an interior Payment Unit boundary are only to be cut when all surrounding Payment Units have been paid.

2 - Timber Specifications

2.1 - Included Timber

2.1.1 - Clearcut unit(s) with unmerchantable trees (6/14)

Within Payment Unit(s) 1-4, cut all trees that are two (2) inches or more at DBH, except do not cut any red pine, white pine, or white spruce, which are not included timber and are to be protected.

2.1.2 - Clearcut unit(s) w/o unmerchantable trees (8/11)

Within Payment Unit(s) 5 & 6, cut all trees which meet minimum piece specifications in 2.2 Utilization. Do not cut trees marked with green paint. Special protection trees identified in accordance with condition 3.4.2, within clearcutting unit boundaries, are not Included Timber and are to be protected.

2.2 - Utilization

2.2.6 - Roundwood operation required (3/21)

The skidding of whole trees or tree segments with limbs attached is prohibited within Payment Units 1, 4, 5, & 6. All products must be produced as roundwood and forwarded to existing roads or landing areas in final product length. Within Payment Units 5 & 6, trees must be harvested with in-woods processor (feller bunching harvester will not be allowed) in order to retain existing understory.

3 - Payments

3.3 - Pre-measured Sales

3.3.4 - Dividing payment units (7/14)

Payment Unit(s) exceeding \$25,000 in value may be divided at the request of the Purchaser and upon approval of the Unit Manager. Dividing Payment Units is a contract modification which requires a Timber Sale Contract Amendment. There will be only one division per Payment Unit.

3.4 - Damaged Timber

3.4.1 - Damaged timber (7/16)

General Condition and Requirement 3.4 Damaged Timber, defines liquidated damages for undesignated live merchantable trees which are cut or injured. No damage is acceptable to undesignated live merchantable trees, which are red pine, white pine, and white spruce. Within the Sale Area, if more than 5% of trees (> 4.5" DBH) within a specified area of the sale are damaged, liquidated damages will be assessed for all trees damaged. Rates will be in accordance with General Condition and Requirement 3.4 Damaged Timber.

3.4.2 - Special Protection Trees (4/14)

The Purchaser shall not cut live or dead special protection trees within cutting units or clearings. Special protection trees are pine that are thirty (30) inches or more at DBH, or any trees marked with green paint. If the Purchaser's operations have cut or damaged special protection trees through carelessness, the Purchaser shall pay \$200 as fixed, agreed and liquidated damages for each special protection tree cut or damaged. Such payment does not constitute ownership of the undesignated

timber.

4 - Transportation

4.1 - Construction

4.1.3 - Slash and earthen piles (8/04)

Piles or windrows of earth along roads and landings that have been widened or constructed shall be leveled. Slash from road maintenance or construction, including stumps, shall be dispersed throughout the sale.

4.1.6 - Road construction (1/09)

Improvements of existing roads shall be done in such a way as to minimize the environmental and visual impacts. Merchantable trees shall be cut and utilized unless otherwise directed. Non-merchantable trees shall be severed and laid flat on the ground. Slash shall be scattered, and not left in windrows and kept a minimum of 10 feet back from the road edge. Stumps shall be set upright, not left on edge, and be moved at least 10 feet away from the road edge. Disturbed soil shall be feathered into the woods and not left in berms or windrows.

4.2 - Maintenance

4.2.2 - Fill material (4/07)

To maintain roads, fill material may be needed in areas where "holes" exist or may be expected to develop. This fill material should be placed before trucking begins. Acceptable fill material must not contain organic matter or clay.

4.2.5 - Two wheel drive condition (2/04)

All existing trail roads on and adjacent to the sale area must be passable by two-wheel drive traffic for the duration of the sale.

5 - Operations

5.1 - Notification

5.1.1 - Pre-sale conference (10/16)

A pre-sale conference between the Purchaser and sale administrator is required prior to beginning any operations to determine landing and road locations. The Unit Manager or his/her representative must be contacted at least 10 days in advance to schedule the conference.

5.1.3 - Well heads and natural gas pipelines (11/15)

The Purchaser is responsible for contacting the gas or pipeline company 30 days prior to operating equipment in the vicinity of well heads or natural gas pipelines. Contact Riverside Energy Michigan, LLC at 231-995-4000 or 989-705-7665 and VCP Michigan, LLC at 989-732-8499.

5.1.4 - Post-sale conference (10/16)

A post-sale conference on site between the Purchaser and sale administrator is required 5 days prior to the completion of active logging operations to determine clean-up and repair of landings, road edges, and the fulfillment of other contract specifications.

5.2 - Conduct of Operations

5.2.1 - Slash

5.2.1.11 - Slash for reforestation (3/21)

To facilitate reforestation and to protect oak stump sprout regeneration from browsing, chipping or removal of treetops is not permitted in Payment Units 1-4. In addition, oak tops/slash are to be placed high and wide centered over harvested oak stumps to deter deer browse.

5.2.2 - Hazard Trees/Snags

5.2.2.1 - Den trees (10/16)

Obvious hollow and/or den trees shall be protected and left standing unless they are a safety hazard.

5.2.3 - Operating Restrictions

5.2.3.1 - Operating restrictions (9/11)

Within Payment Unit(s) 1, & 4-6, unless changed by written agreement, cutting, skidding, and hauling are limited to dry summer and frozen winter conditions. This restriction is to protect soils on slopes when they are most susceptible to rutting.

5.2.3.4 - Oak wilt restriction, no exceptions (1/18)

Within Payment Units 1 & 4, cutting, skidding, hauling within the sale and brushing of access roads to the sale are not permitted during the period of April 15 to July 15. No exceptions will be granted. This is necessary to reduce the spread of oak wilt.

5.2.3.5 - Oak wilt restriction (1/18)

Within Payment Units 2, 3, 5, & 6, unless changed by written agreement, cutting, skidding, hauling within the sale and brushing of access roads to the sale are not permitted during the period of April 15 to July 15. Operations may be allowed if specific steps are taken to prevent damaging uncut oak during the high risk period. Those steps may include completing all road brushing before April 15th and clearing a tree-length buffer along uncut oak cover before April 15th. This is necessary to reduce the spread of oak wilt. For more information, contact the Unit Manager or his/her representative.

5.2.3.11 - Coppice regeneration protection (4/10)

Timber harvesting in any Payment Unit must be completed before significant deciduous sprouting occurs in that Payment Unit so as to minimize damage to the new regeneration. Any post harvest operations, such as chipping, must be completed before sprouting of regeneration occurs. If it is anticipated that chipping will be delayed, then tops shall be carried to one central location or left unchipped. The Unit Manager or his/her representative may cease such operations if sprouting occurs before the operation is complete.

5.2.4 - Dead and Down Creation

5.2.4.7 - Dead and down creation: hare, grouse, deer and other species (5/15)

To improve horizontal cover habitat for snowshoe hare, grouse, deer, and other species, the Purchaser is to push over trees painted in orange. These trees should be tipped over with the root ball still attached so the base of the tree is suspended off the ground. The crown of the fallen tree should be at or near ground level after it is pushed over. If it is impossible or impractical to push these trees over, they may be severed or partially severed at the stump. Whenever possible the stem of the tree should rest above ground level. In addition, trees indicated with an orange painted R are located approximately every 400 feet along the wetland edge. These trees must be pushed over like the previously described trees painted in orange and also have an accumulation of slash and tops placed over the tree to create a cavity for rabbits.

5.2.32 - Decking/landing restoration (9/13)

All decking and landing areas must have the surface area restored to a condition equal to or better than before. This is to ensure the proper regeneration of the stand. Wood debris, chips and "cookies" from trimmings must be removed or scattered away from landing and loading areas and may not be windrowed on the edge.

5.2.39 - ORV trail/route protection (4/18)

The Atlanta ORV Trail/Route is shown on the Timber Sale Map. Do not cut trees or damage posts with yellow ORV markers. All stumps within 5 feet of the trail must be cut flush with the ground. Maintain a 20-foot-wide slash, debris, and rut free zone daily using the ORV trail or route as the centerline. Do not run equipment down the ORV trail or route. Skidding across the trail or route may only occur in locations approved by the Sale Administrator.

5.2.41 - Snowmobile trail protection (9/11)

The LP-9 snowmobile trail and the Atlanta ORV Route share the same alignment and are shown on the Timber Sale Map. Do not cut or damage posts with orange trail markers or traffic control signs. If the trail is used, it must be maintained and restored to a condition equal to or better than before the sale. The road maintenance/restoration must be done prior to December 1. If the trail is used for hauling, it must be graded to the satisfaction of the Unit Manager or his/her representative prior to December 1. If the trail road is to be used for hauling during the snowmobile season, then a snow-covered base must be left on the trail. The snowmobile trail may only be crossed at right angles. Maintain a 20-foot-wide slash, debris, and rut free zone daily using the snowmobile trail as the centerline. No decking of forest products will be permitted along the snowmobile trail. All stumps within 20 feet of the snowmobile trail must be cut at ground level.

5.4 - Soil Protection

5.4.1 - Rutting restriction, general (7/16)

Operations are to cease immediately if equipment and weather conditions result in rutting of roads and/or skid trails which is 12 inches or greater in depth and 50 feet in length. The Unit Manager or his/her representative may restrict hauling and/or skidding if ruts exceed the specified depth. With the Unit Manager or his/her representative's approval, the Purchaser may return to the area when the risk of rutting has decreased.

5.4.2 - Skid trails (2/04)

Skid trails up and down slopes should be avoided. If however this is unavoidable, these trails will be left in a non-erodible condition using water bars, logs, and slash. Placing of slash on these skid trails while logging is ongoing may alleviate need for any further action. At the direction of the sale administrator, seed, fertilizer, and mulch may also be required.

5.8 - Protection of Endangered Species

5.8.5 - Protection of raptor nests (3/13)

All trees with raptor nests will be protected if found during harvesting operations. Notification will be made to the Unit Manager or his/her representative who will notify the Wildlife Biologist so an on-site evaluation and recommendation can be made, if necessary.

6 - Safety and Fire Prevention

6.2 - Signing

6.2.2 - Snowmobile trail posting (10/20)

The Purchaser is responsible for posting and maintaining caution signs on the LP-9 snowmobile trail prior to beginning operations during the snowmobile season (approximately December 1 to March 31). The trail must be posted at appropriate distances from the Sale Area to warn of logging activity and truck traffic. Signs must be removed when harvest operations are suspended or completed. The Purchaser will provide these signs.

6.2.3 - Recreational trail posting (10/20)

The Purchaser is responsible for posting and maintaining caution signs on the Atlanta ORV Trail/Route prior to beginning operations. The trail must be posted at appropriate distances from the Sale Area to warn of logging activity and truck traffic at both ends of the trail. Signs must be removed when harvest operations are suspended or completed. The Purchaser will provide these signs.



TIMBER SALE MAP

This information provided by authority of Part 525, 1994 PA 451, as amended.

Forest Management Unit Atlanta	County Montmorency	Mapped By Natzke	Date 05/19/2023	Page 1	of 1
Township 31N	Range 02E	Section(s) and Subdivision(s) Sec. 13: S2SE; Sec. 19: W2NW, NWSW; Sec. 24: N2NE, SENE, SE; Sec 25 N2NE	Cruised By Natzke	Scale 1:15,840	

Cover Type				Density	
A = Aspen	H = Hemlock	N = Marsh	U = Upland Brush	0 = Non Stocked	5 = Pole Timber Medium
B = Paper Birch	J = Jack Pine	O = Oak	UM = Upland Mixed	1 = Seedling Sapling Poor	6 = Pole Timber Well
C = Cedar	L = Lowland Brush	P = Lowland Poplar	V = Bog or Marsh	2 = Seedling Sapling Medium	7 = Saw Timber Poor
D = Treed Bog	LM = Lowland Mixed	Q = Mixed Swamp Conifer	W = White Pine	3 = Seedling Sapling Well	8 = Saw Timber Medium
E = Swamp Hdwoods	M = Mpl, Bch, Brch	R = Red Pine	X = Non Stocked	4 = Pole Timber Poor	9 = Saw Timber Well
F = Spruce Fir	MC = Mixed Conifer	S = Black Spruce	Z = Water		
G = Grass	MD = Mixed Deciduous	T = Tamarack			

Stevens Springs Eternal

Compartment 46

134.4 Acres

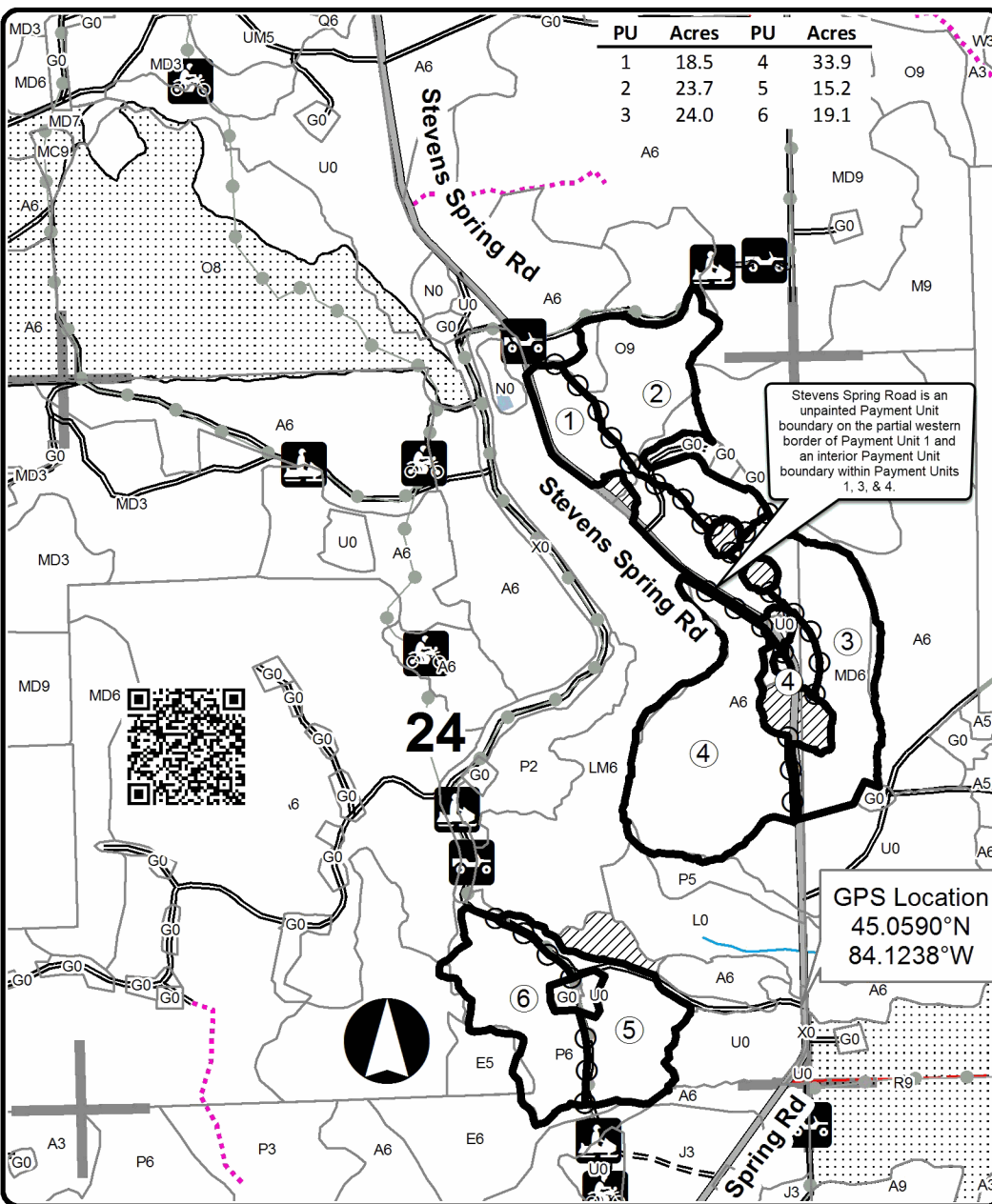

Stevens Spring Road is an unpainted Payment Unit boundary on the partial western border of Payment Unit 1 and an interior Payment Unit boundary within Payment Units 1, 3, & 4.

GPS Location
45.0590°N
84.1238°W

- Against State (Red)
- Payment Unit (Yellow)
- Retention Area
- Nearby Timber Sales
- Stand Boundaries
- Recreational Trail
- Secondary Forest Road
- Forest Access Route
- Gravel Road
- County Road - Seasonal
- Private Road
- Temporary Management Access
- Motorcycle Trails
- ORV Routes
- Snowmobile Trails
- Perennial River
- Lakes and Rivers
- Section Corners

Locator Map

1:150,000

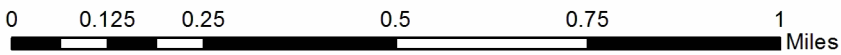
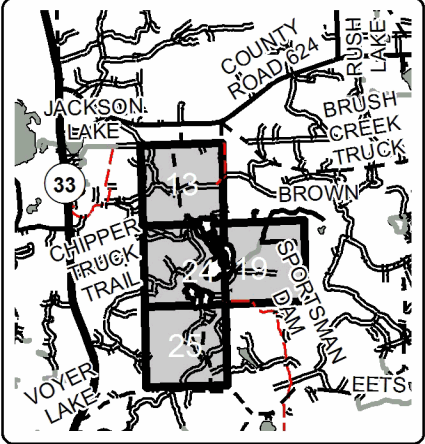

TIMBER SALE INFORMATION

Kinzie Conversion Oak (54-016-23)
T31N, R02E, SEC. 23.
Montmorency County (Advertised Price \$85,432.60)

SALE NOTE: 2.2.2 - Chipping required (2/18)

The Sale Area must be chip harvested to facilitate subsequent planting operations .

2.2.3 - Stump heights (4/07)

Stump heights within the Sale Area shall not exceed 6 inches for all trees. This is in order to facilitate planting operations.

5.2.3.4 - Oak wilt restriction, no exceptions (1/18)

Within Payment Unit 1, cutting, skidding, hauling within the sale and brushing of access roads to the sale are not permitted during the period of April 15 to July 15. No exceptions will be granted.

5.2.3.5 - Oak wilt restriction (1/18)

Within Payment Unit 2 & 3, unless changed by written agreement, cutting, skidding, hauling within the sale and brushing of access roads to the sale are not permitted during the period of April 15 to July 15.

A timber sale contract for this lump sum, sealed bid timber sale will be awarded to the responsible bidder offering the highest sealed bid price. All units of volume listed below were estimated using the Inventory Manager computer program and the new Michigan taper model. Bids must be at or above the following advertised price for each product and species:

<u>PRODUCTS & SPECIES</u>	<u>ESTIMATED UNITS*</u>	<u>ADVERTISED PRICE</u>
Sawtimber		
Basswood	11.4 MBF	\$ 89.00 / MBF
Black/Red (Hybrid) Oak	11.4 MBF	\$ 124.00 / MBF
Red Oak	271.8 MBF	\$ 195.00 / MBF
Pulpwood		
Basswood	14 Cords	\$ 15.65 / Cord
Mixed Aspen	168 Cords	\$ 25.00 / Cord
Mixed Hardwood	129 Cords	\$ 24.90 / Cord
Mixed Oak	602 Cords	\$ 33.75 / Cord
Red Pine	6 Cords	\$ 40.20 / Cord
White Pine	65 Cords	\$ 27.90 / Cord

* The total volume is statistically estimated within plus (+) or minus (-) 14.97 percent. There are an estimated 1,647 cords on this timber sale, plus or minus 247 cords at the 95% confidence level. The estimated units are final and not subject to adjustment. Prospective bidders are urged to examine this timber and to make their own estimates of quantity and quality.

BOND AND PAYMENT SCHEDULE:

1. A bond in the amount of \$4,272.00 to insure faithful performance of the conditions of the contract will be deposited by the successful bidder within 21 days of the sale award.
2. Cutting in any sale or unit without the required advance payment would be considered a trespass.
3. Total payment must be paid in advance or according to the following schedule :
 - (a) Ten percent (10%) of the sale value must be paid within 21 days of the sale award.
 - (b) The 10% down payment will be credited towards the first unit cut.

(c) Payment for each of the following units must be made before cutting begins in that unit:

PAYMENT UNIT NUMBER	PERCENT OF TOTAL SALE VALUE
01	18.0%
02	42.2%
03	39.8%

4. If no cutting takes place, the 10% down payment will not be refunded.
5. Operations on the contract issued will terminate on 06/30/2026.

SALE STATISTICS

Volumes were calculated in cubic feet using the Michigan taper model. Cubic foot volume includes all wood inside bark for the product indicated. For display purposes, cubic feet were converted to cords and MBF using a simple conversion factor, e.g. 79 cubic feet per cord and 185 cubic feet per MBF. The cubic foot volumes are precise; the cords and MBF volumes are not. Cubic foot volume cannot be directly converted to cords or boards with precision.

SALE VOLUMES

The total estimated sale volume may not equal the sum of the species/products due to the nature of statistical calculations associated with double sampling methodology.

VOLUME			STATISTICAL RANGE IN CORDS	
TOTAL CUBIC FEET	TOTAL CORDS	PERCENT ERROR	MINIMUM	MAXIMUM
130,144	1,647	14.97%	1,401	1,894

VDU VOLUMES

A VDU is a Volume Determination Unit. Volumes and their associated statistics are calculated at the VDU level and summarized to the sale level. There is often a one to one relationship between a VDU and a Payment Unit, but not always, depending on the cruise design. Refer to the VDU TO PAYMENT UNIT table.

	VOLUME			RANGE IN CORDS	
VDU	TOTAL CUBIC FEET	TOTAL CORDS	PERCENT ERROR	MINIMUM	MAXIMUM
50	22,700	287	33.19%	192	383
51	107,443	1,360	17.47%	1,122	1,598
TOTAL:	130,144	1,647		1,314	1,980

VDU TO PAYMENT UNIT

When a VDU is associated with more than one Payment Unit (PU), the VDU volumes are assigned to the PU based on acres of the VDU within the PU.

VDU	VDU ACRES	PU	PU ACRES
50	10.6	1	10.6
51	59.5	1	4.9
		2	28.1
		3	26.5
TOTAL:	70.1		70.1

DESCRIPTION OF TIMBER BY PAYMENT UNIT (PU)

PU	MARKET GROUP	PRODUCT	QUANTITY	UNIT	ACRES	ADVERTISE PRICE
1	Basswood	Sawtimber	0.9	MBF	15.5	\$15,358.55
	Black/Red (Hybrid		0.9	MBF		
	Red Oak		32.6	MBF		
	Basswood	Pulpwood	1	Cords		
	Mixed Aspen		168	Cords		
	<i>B. T. Aspen</i>		157	Cords		
	<i>Balsam Poplar</i>		5	Cords		
	<i>Quaking Aspen</i>		6	Cords		
	Mixed Hardwood		40	Cords		
	<i>Beech</i>	Sawtimber	0.1	MBF		
	<i>Sugar Maple</i>		0.4	MBF		
	<i>Beech</i>	Pulpwood	1	Cords		
	<i>Red Maple</i>		33	Cords		
	<i>Sugar Maple</i>		5	Cords		
	Mixed Oak		100	Cords		
	<i>/Red (Hybrid) Oak</i>		2	Cords		
	<i>Red Oak</i>		98	Cords		
	White Pine		8	Cords		
	<i>White Pine</i>	Sawtimber	0.4	MBF		
	<i>White Pine</i>	Pulpwood	7	Cords		
2	Basswood	Sawtimber	5.4	MBF	28.1	\$36,105.50
	Black/Red (Hybrid		5.4	MBF		
	Red Oak		123.1	MBF		
	Basswood	Pulpwood	7	Cords		
	Mixed Hardwood		47	Cords		
	<i>Beech</i>	Sawtimber	0.8	MBF		
	<i>Sugar Maple</i>		2.4	MBF		
	<i>Beech</i>	Pulpwood	3	Cords		
	<i>Red Maple</i>		11	Cords		
	<i>Sugar Maple</i>		26	Cords		
	Mixed Oak		259	Cords		
	<i>/Red (Hybrid) Oak</i>		14	Cords		
	<i>Red Oak</i>		245	Cords		
	Red Pine		3	Cords		
	White Pine		29	Cords		
	<i>White Pine</i>	Sawtimber	2.2	MBF		
	<i>White Pine</i>	Pulpwood	25	Cords		
3	Basswood	Sawtimber	5.1	MBF	26.5	\$33,993.45
	Black/Red (Hybrid		5.1	MBF		
	Red Oak		116.1	MBF		
	Basswood	Pulpwood	6	Cords		
	Mixed Hardwood		43	Cords		
	<i>Beech</i>	Sawtimber	0.8	MBF		
	<i>Sugar Maple</i>		2.2	MBF		
	<i>Beech</i>	Pulpwood	3	Cords		
	<i>Red Maple</i>		10	Cords		
	<i>Sugar Maple</i>		24	Cords		
	Mixed Oak		243	Cords		
	<i>/Red (Hybrid) Oak</i>		12	Cords		
	<i>Red Oak</i>		231	Cords		
	Red Pine		3	Cords		
	White Pine		28	Cords		
	<i>White Pine</i>	Sawtimber	2.0	MBF		
	<i>White Pine</i>	Pulpwood	24	Cords		
TOTAL:			294.6	MBF		

TOTAL:	985 Cords
--------	-----------

Sale Specific Conditions & Requirements

Sale Name: Kinzie Conversion Oak

Sale Number: 54-016-23 Seq#: 2

1 - Sale Area

1.2 - Boundaries

1.2.1 - Painted boundaries (9/19)

The sale boundary and Payment Unit boundaries are marked and identified by red paint, along with a forest road and a powerline. Exterior sale boundary lines against state are marked with red paint. Interior Payment Unit boundaries are unpainted, with the Payment Unit boundary separating Payment Units 2 & 3 being unpainted and identified by an unnamed forest road and the Payment Unit boundaries separating Payment Units 1 & 2 and 1 & 3 being unpainted and identified by a powerline. The painted boundary line trees are not Included Timber and are to be protected.

2 - Timber Specifications

2.2 - Utilization

2.2.2 - Chipping required (2/18)

The Sale Area must be chip harvested to facilitate subsequent planting operations. The Purchaser has the option to produce sawlogs or pulpwood bolts, but the remaining portion of the trees must be chipped and hauled. Products may be produced as roundwood and forwarded to decking areas in final product length, but the tops must be left intact and skidded to the landing for chipping in order to minimize the amount of residual slash. If market conditions limit the practicality of chipping, a written chipping exemption is possible only in the case the Sale Administrator determines that operational modifications will not inhibit future planting operations. Conditions that satisfy this modification require:

- Trees greater than four (4) inches at DBH must be cut to a two (2) inch top or smaller.
- Sub-merchantable trees and hardwood limbs four (4) inches or greater where they attach to the stem, must be cut/reduced to four (4) foot lengths or smaller.
- Slash must be evenly dispersed throughout the Payment Unit and not be more than two feet high.

The requirement to retain approximately 1/6 to 1/3 of tree tops and limbs less than four inches in diameter is still applicable (G. C. & R. 2.2).

2.2.3 - Stump heights (4/07)

Stump heights within the Sale Area shall not exceed 6 inches for all trees. This is in order to facilitate planting operations.

3 - Payments

3.3 - Pre-measured Sales

3.3.4 - Dividing payment units (7/14)

Payment Unit(s) exceeding \$25,000 may be divided at the request of the Purchaser and upon approval of the Unit Manager. Dividing Payment Units is a contract modification which requires a Timber Sale Contract Amendment. There will be only one division per Payment Unit.

3.6 - Payment Unit Cutting Schedule

3.6.8 - Operating period (5/16)

Once cutting begins, operations must continue until all Payment Units are completed.

4 - Transportation

4.1 - Construction

4.1.3 - Slash and earthen piles (8/04)

Piles or windrows of earth along roads and landings that have been widened or constructed shall be leveled. Slash from road maintenance or construction, including stumps, shall be dispersed throughout the sale.

4.1.6 - Road construction (1/09)

Improvements of existing roads shall be done in such a way as to minimize the environmental and visual impacts. Merchantable trees shall be cut and utilized unless otherwise directed. Non-merchantable trees shall be severed and laid flat on the ground. Slash shall be scattered, and not left in windrows and kept a minimum of 10 feet back from the road edge. Stumps shall be set upright, not left on edge, and be moved at least 10 feet away from the road edge. Disturbed soil shall be feathered into the woods and not left in berms or windrows.

4.2 - Maintenance

4.2.2 - Fill material (4/07)

To maintain roads, fill material may be needed in areas where "holes" exist or may be expected to develop. This fill material should be placed before trucking begins. Acceptable fill material shall not contain clay or organic matter.

4.2.3 - Road maintenance (8/13)

The following road maintenance is required: Within 60 days of completion of hauling, or if no hauling occurs for 60 days, the road leading to private land must be maintained and graded. This includes cleaning of drainage areas, grading, crowning and filling with gravel, if necessary. Damages will be assessed if grading/repair does not occur. The road must remain unobstructed to allow passage of two-wheel drive traffic for the duration of the timber sale.

5 - Operations

5.1 - Notification

5.1.1 - Pre-sale conference (10/16)

A pre-sale conference between the Purchaser and sale administrator is required prior to beginning any operations to determine landing and road locations. The Unit Manager or his/her representative must be contacted at least 10 days in advance to schedule the conference.

5.1.4 - Post-sale conference (10/16)

A post-sale conference on site between the Purchaser and sale administrator is required 5 days prior to the completion of active logging operations to determine clean-up and repair of landings, road edges, and the fulfillment of other contract specifications.

5.2 - Conduct of Operations

5.2.2 - Hazard Trees/Snags

5.2.2.1 - Den trees (10/16)

Obvious hollow and/or den trees shall be protected and left standing unless they are a safety hazard.

5.2.3 - Operating Restrictions

5.2.3.4 - Oak wilt restriction, no exceptions (1/18)

Within Payment Unit 1, cutting, skidding, hauling within the sale and brushing of access roads to the sale are not permitted during the period of April 15 to July 15. No exceptions will be granted. This is necessary to reduce the spread of oak wilt.

5.2.3.5 - Oak wilt restriction (1/18)

Within Payment Units 2 & 3, unless changed by written agreement, cutting, skidding, hauling within the sale and brushing of access roads to the sale are not permitted during the period of April 15 to July 15. Operations may be allowed if specific steps are taken to prevent damaging uncut oak during the high risk period. Those steps may include completing all road brushing before April 15th and clearing a tree-length buffer along uncut oak cover before April 15th. This is necessary to reduce the spread of oak wilt. For more information, contact the Unit Manager or his/her representative.

5.2.32 - Decking/landing restoration (9/13)

All decking and landing areas must have the surface area restored to a condition equal to or better than before. This is to ensure the proper regeneration of the stand. Wood debris, chips and "cookies" from trimmings must be removed or scattered away from landing and loading areas and may not be windrowed on the edge.

5.4 - Soil Protection

5.4.1 - Rutting restriction, general (7/16)

Operations are to cease immediately if equipment and weather conditions result in rutting of roads and/or skid trails which is

12 inches or greater in depth and 50 feet in length. The Unit Manager or his/her representative may restrict hauling and/or skidding if ruts exceed the specified depth. With the Unit Manager or his/her representative's approval, the Purchaser may return to the area when the risk of rutting has decreased.

5.4.2 - Skid trails (2/04)

Skid trails up and down slopes should be avoided. If however this is unavoidable, these trails will be left in a non-erodible condition using water bars, logs, and slash. Placing of slash on these skid trails while logging is ongoing may alleviate need for any further action. At the direction of the sale administrator, seed, fertilizer, and mulch may also be required.

5.8 - Protection of Endangered Species

5.8.5 - Protection of raptor nests (3/13)

All trees with raptor nests will be protected if found during harvesting operations. Notification will be made to the Unit Manager or his/her representative who will notify the Wildlife Biologist so an on-site evaluation and recommendation can be made, if necessary.

6 - Safety and Fire Prevention

6.2 - Signing

6.2.1 - Road posting (10/20)

The Purchaser is responsible for posting and maintaining caution signs on Kinzie Road prior to beginning operations. The road must be posted at appropriate distances from the Sale Area to warn of logging activity and truck traffic. Signs must be removed when harvest operations are suspended or completed. The Purchaser will provide these signs.



TIMBER SALE MAP

This information provided by authority of Part 525, 1994 PA 451, as amended.

Forest Management Unit Atlanta	County Montmorency	Mapped By Natzke	Date 08/29/2023	Page 1	of 1
Township 31N	Range 02E	Section(s) and Subdivision(s) Sec 23 E1/2NW, W1/2NE, NWSE, N1/2SW	Cruised By Natzke	Scale 1:15,840	

Cover Type				Density	
A = Aspen	H = Hemlock	N = Marsh	U = Upland Brush	0 = Non Stocked	5 = Pole Timber Medium
B = Paper Birch	J = Jack Pine	O = Oak	UM = Upland Mixed	1 = Seedling Sapling Poor	6 = Pole Timber Well
C = Cedar	L = Lowland Brush	P = Lowland Poplar	V = Bog or Marsh	2 = Seedling Sapling Medium	7 = Saw Timber Poor
D = Tread Bog	LM = Lowland Mixed	Q = Mixed Swamp Conifer	W = White Pine	3 = Seedling Sapling Well	8 = Saw Timber Medium
E = Swamp Hdwoods	M = Mpl, Bch, Brch	R = Red Pine	X = Non Stocked	4 = Pole Timber Poor	9 = Saw Timber Well
F = Spruce Fir	MC = Mixed Conifer	S = Black Spruce	Z = Water		
G = Grass	MD = Mixed Deciduous	T = Tamarack			

Kinzie Conversion Oak Compartment 46 70.1 Acres

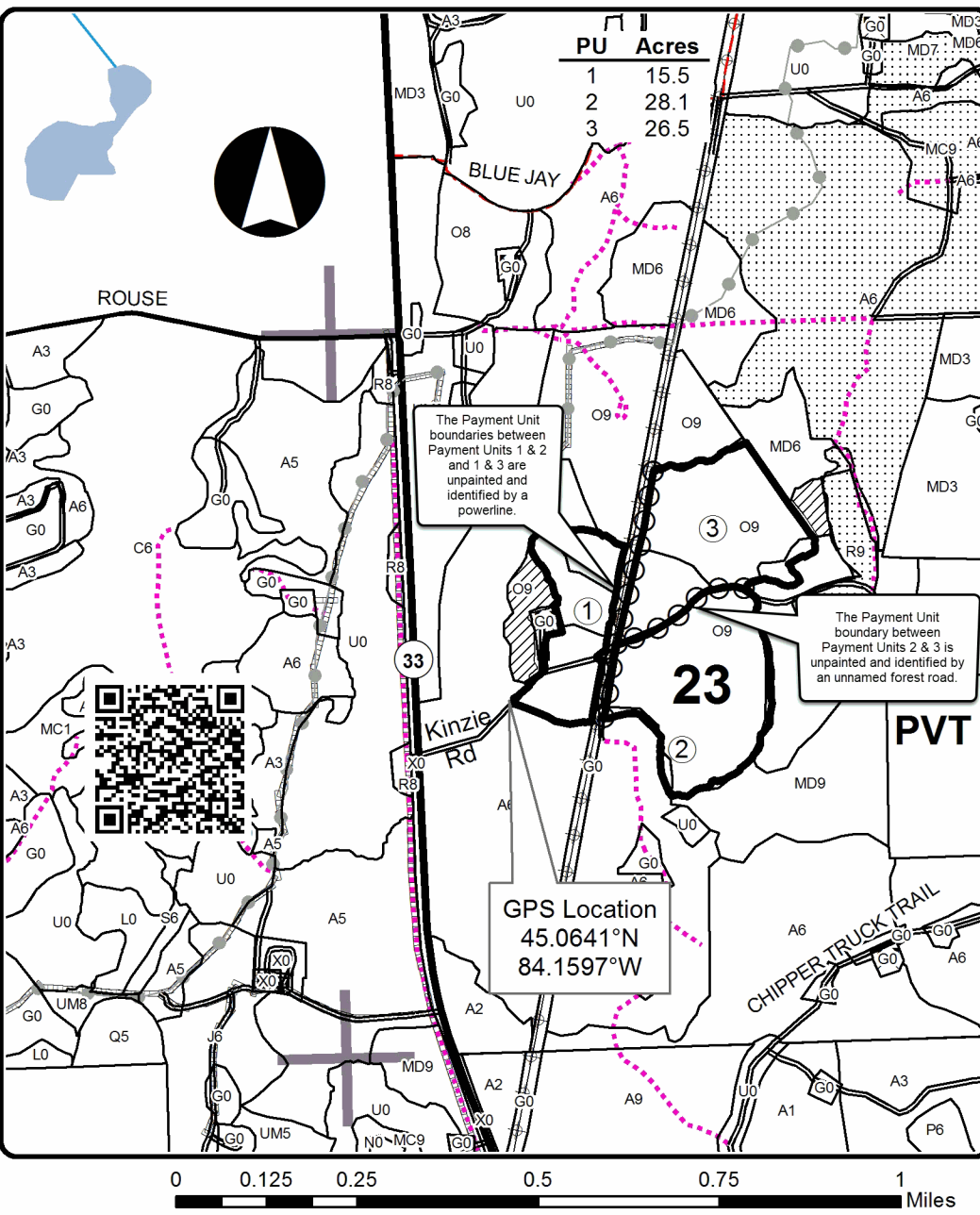

Legend

- Against State (Red)
- Payment Unit (Yellow)
- Payment Unit
- Stand Boundaries
- ▨ Retention Area
- ▤ Nearby Timber Sales
- Pipeline
- ⊕ Powerline
- Recreational Trail
- Highways
- Secondary Forest Road
- Paved Road
- County Road - Seasonal
- ⋯ Temporary Management Access
- Perennial River
- Lakes and Rivers
- Section Corners

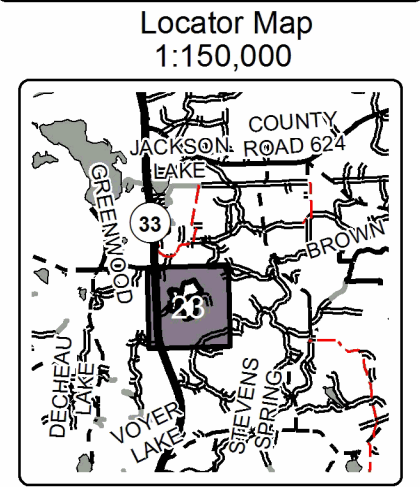

TIMBER SALE INFORMATION

Road Challenge Mix (54-043-23)
T33N, R05E, SEC. 33; T33N, R05E, SEC. 34.
Presque Isle County (Advertised Price \$23,434.15)

SALE NOTE: Extensive road work is required. Refer to sale spec 4.1.8 for details.
Private access may be desired. Refer to sale spec 4.4.1 for details.

A timber sale contract for this lump sum, sealed bid timber sale will be awarded to the responsible bidder offering the highest sealed bid price. All units of volume listed below were estimated using the Inventory Manager computer program and the new Michigan taper model. Bids must be at or above the following advertised price for each product and species:

<u>PRODUCTS & SPECIES</u>	<u>ESTIMATED UNITS*</u>	<u>ADVERTISED PRICE</u>
Sawtimber		
Balsam Fir	32.8 MBF	\$ 28.00 / MBF
Mixed Spruce	6.8 MBF	\$ 37.00 / MBF
Red Maple	26.7 MBF	\$ 51.00 / MBF
Pulpwood		
Balsam Fir	340 Cords	\$ 13.50 / Cord
Mixed Aspen	258 Cords	\$ 16.65 / Cord
Mixed Spruce	43 Cords	\$ 14.00 / Cord
N. White Cedar	21 Cords	\$ 6.30 / Cord
Paper Birch	35 Cords	\$ 10.75 / Cord
Red Maple	657 Cords	\$ 16.60 / Cord

* The total volume is statistically estimated within plus (+) or minus (-) 30.28 percent. There are an estimated 1,514 cords on this timber sale, plus or minus 459 cords at the 95% confidence level. The estimated units are final and not subject to adjustment. Prospective bidders are urged to examine this timber and to make their own estimates of quantity and quality.

BOND AND PAYMENT SCHEDULE:

1. A bond in the amount of \$1,172.00 to insure faithful performance of the conditions of the contract will be deposited by the successful bidder within 21 days of the sale award.
2. Cutting in any sale or unit without the required advance payment would be considered a trespass.
3. Total payment must be paid in advance or according to the following schedule :
 - (a) Ten percent (10%) of the sale value must be paid within 21 days of the sale award.
 - (b) The 10% down payment will be credited towards the first unit cut.
 - (c) Payment for each of the following units must be made before cutting begins in that unit:

PAYMENT UNIT NUMBER	PERCENT OF TOTAL SALE VALUE
01	18.6%
02	18.7%
03	62.7%
4. If no cutting takes place, the 10% down payment will not be refunded.
5. Operations on the contract issued will terminate on 06/30/2027.

SALE STATISTICS

Volumes were calculated in cubic feet using the Michigan taper model. Cubic foot volume includes all wood inside bark for the product indicated. For display purposes, cubic feet were converted to cords and MBF using a simple conversion factor, e.g. 79 cubic feet per cord and 185 cubic feet per MBF. The cubic foot volumes are precise; the cords and MBF volumes are not. Cubic foot volume cannot be directly converted to cords or boards with precision.

SALE VOLUMES

The total estimated sale volume may not equal the sum of the species/products due to the nature of statistical calculations associated with double sampling methodology.

VOLUME		STATISTICAL RANGE IN CORDS		
TOTAL CUBIC FEET	TOTAL CORDS	PERCENT ERROR	MINIMUM	MAXIMUM
119,645	1,514	30.28%	1,056	1,973

VDU VOLUMES

A VDU is a Volume Determination Unit. Volumes and their associated statistics are calculated at the VDU level and summarized to the sale level. There is often a one to one relationship between a VDU and a Payment Unit, but not always, depending on the cruise design. Refer to the VDU TO PAYMENT UNIT table.

VDU	VOLUME		PERCENT ERROR	RANGE IN CORDS	
	TOTAL CUBIC FEET	TOTAL CORDS		MINIMUM	MAXIMUM
50	70,347	890	21.24%	701	1,080
79	24,338	308	34.13%	203	413
80	24,960	316	27.92%	228	404
TOTAL:	119,645	1,514		1,132	1,897

VDU TO PAYMENT UNIT

When a VDU is associated with more than one Payment Unit (PU), the VDU volumes are assigned to the PU based on acres of the VDU within the PU.

VDU	VDU ACRES	PU	PU ACRES
50	24.3	3	24.3
79	11.1	2	11.1
80	9.6	1	9.6
TOTAL:	45.0		45.0

DESCRIPTION OF TIMBER BY PAYMENT UNIT (PU)

PU	MARKET GROUP	PRODUCT	QUANTITY	UNIT	ACRES	ADVERTISE PRICE
1	Balsam Fir	Sawtimber	18.7	MBF	9.6	\$4,358.30
	Red Maple		1.6	MBF		
	Balsam Fir	Pulpwood	225	Cords		
	Mixed Aspen		36	Cords		
	<i>Quaking Aspen</i>		36	<i>Cords</i>		
	Red Maple		7	Cords		
	2	Balsam Fir	Sawtimber	10.3		
Mixed Spruce			6.8	MBF		
<i>Black Spruce</i>			1.1	<i>MBF</i>		
<i>White Spruce</i>			5.7	<i>MBF</i>		
Red Maple			5.1	MBF		
Balsam Fir		Pulpwood	62	Cords		
Mixed Aspen			38	Cords		
<i>Quaking Aspen</i>			38	<i>Cords</i>		
Mixed Spruce			38	Cords		
<i>Black Spruce</i>			21	<i>Cords</i>		
<i>White Spruce</i>			17	<i>Cords</i>		
N. White Cedar			20	Cords		
<i>N. White Cedar</i>		<i>Sawtimber</i>	6.7	<i>MBF</i>		
<i>N. White Cedar</i>		<i>Pulpwood</i>	7	<i>Cords</i>		
Paper Birch			20	Cords		
<i>Paper Birch</i>			20	<i>Cords</i>		
Red Maple			75	Cords		
3		Balsam Fir	Sawtimber	3.8	MBF	24.3
	Red Maple		20.0	MBF		
	Balsam Fir	Pulpwood	53	Cords		
	Mixed Aspen		184	Cords		
	<i>Quaking Aspen</i>	<i>Sawtimber</i>	1.5	<i>MBF</i>		
	<i>B. T. Aspen</i>	<i>Pulpwood</i>	24	<i>Cords</i>		
	<i>Quaking Aspen</i>		157	<i>Cords</i>		
	Mixed Spruce		5	Cords		
	<i>White Spruce</i>		5	<i>Cords</i>		
	N. White Cedar		1	Cords		
	<i>N. White Cedar</i>		1	<i>Cords</i>		
	Paper Birch		15	Cords		
	<i>Paper Birch</i>	<i>Sawtimber</i>	2.2	<i>MBF</i>		
	<i>Paper Birch</i>	<i>Pulpwood</i>	11	<i>Cords</i>		
	Red Maple		575	Cords		
TOTAL:			66.3	MBF		
TOTAL:			1,354	Cords		

Sale Specific Conditions & Requirements

Sale Name: Road Challenge Mix

Sale Number: 54-043-23 Seq#: 2

1 - Sale Area

1.2 - Boundaries

1.2.1 - Painted boundaries (9/19)

The sale boundary and Payment Unit boundaries are marked and identified by blue, red, and orange paint. Exterior sale boundary lines against private property are marked with blue paint. Exterior sale boundary lines against state are marked with red or orange paint (see Timber Sale Map). Retention patch islands are marked with orange paint; no harvesting activities may occur within these areas. The painted boundary line trees are not Included Timber and are to be protected.

2 - Timber Specifications

2.1 - Included Timber

2.1.1 - Clearcut unit(s) with unmerchantable trees (6/14)

Within Payment Unit(s) 1-3, cut all trees that are two (2) inches or more at DBH, except within Payment Unit 2, do not cut any pine and in Payment Unit 3, do not cut any trees marked with green paint. Special protection trees identified in accordance with condition 3.4.2, within clearcutting unit boundaries, are not Included Timber and are to be protected. Purple marked habitat trees in Payment Unit 3 are to be handled as detailed in spec 5.2.4.7.

3 - Payments

3.3 - Pre-measured Sales

3.3.4 - Dividing payment units (7/14)

Payment Unit(s) \$25,000 in value or greater may be divided at the request of the Purchaser and upon approval of the Unit Manager. Dividing Payment Units is a contract modification which requires a Timber Sale Contract Amendment. There will be only one division per Payment Unit.

3.4 - Damaged Timber

3.4.1 - Damaged timber (7/16)

General Condition and Requirement 3.4 Damaged Timber, defines liquidated damages for undesignated live merchantable trees which are cut or injured. No damage is acceptable to undesignated live merchantable trees. Within the Sale Area, if more than 5% of trees (> 4.5" DBH) within a specified area of the sale are damaged, liquidated damages will be assessed for all trees damaged. Rates will be in accordance with General Condition and Requirement 3.4 Damaged Timber.

3.4.2 - Special Protection Trees (4/14)

The Purchaser shall not cut live or dead special protection trees within cutting units or clearings. Special protection trees are marked with green paint and are located in Payment Unit 3. If the Purchaser's operations have cut or damaged special protection trees through carelessness, the Purchaser shall pay \$250 as fixed, agreed and liquidated damages for each special protection tree cut or damaged. Such payment does not constitute ownership of the undesignated timber.

4 - Transportation

4.1 - Construction

4.1.3 - Slash and earthen piles (8/04)

Piles or windrows of earth along roads and landings that have been widened or constructed shall be leveled. Slash from road maintenance or construction, including stumps, shall be dispersed throughout the sale.

4.1.5 - Culverts (5/14)

Multiple culverts are present in the forest road west from Mud Lake Highway to Payment Units 1-3. It is the producer's responsibility to protect these culverts from damage during all operations. Acquisition of fill material required to protect these culverts is the responsibility of the producer. Fill material will be free of clay and must be approved by the Sale Administrator prior to placement. If the producer's operations damage any of these culverts, the producer will replace each culvert damaged according to the Michigan Forestry Best Management Practices (BMPs) IC4011 Revision dated July 10, 2023. Any

permits required for replacing damaged culverts is the responsibility of the producer.

4.1.6 - Road construction (1/09)

Improvements of existing roads shall be done in such a way as to minimize the environmental and visual impacts. Merchantable trees shall be cut and utilized unless otherwise directed. Non-merchantable trees shall be severed and laid flat on the ground. Slash shall be scattered, and not left in windrows and kept a minimum of 10 feet back from the road edge. Stumps shall be set upright, not left on edge, and be moved at least 10 feet away from the road edge. Disturbed soil shall be feathered into the woods and not left in berms or windrows.

4.1.8 - Road work (1) (8/07)

The following road work is required: Approximately 1/2 mile of forest road west from Mud Lake Highway to the Sale Area will need extensive road work and/or freezing in for the hauling of wood from the sale. Upon completion of the sale, the construction of multiple fords or broad-based dips in this forest road, to the Sale Administrator's satisfaction, will be required in lowland areas for enabling seasonal water flow across the road. The spacing and number of fords or broad-base dips must be discussed with the Sale Administrator before work begins.

4.1.12 - No new roads (1/12)

No new roads will be permitted in any Payment Unit. All operations are limited to existing roads. Skid trails only will be allowed.

4.2 - Maintenance

4.2.1 - Hauling restriction (12/08)

Hauling may be restricted on forest roads by the Unit Manager or his/her representative. The restriction is for protecting the integrity of forest roads during unfavorable weather and road conditions.

4.2.2 - Fill material (4/07)

To maintain roads, fill material may be needed in areas where "holes" exist or may be expected to develop. This fill material should be placed before trucking begins. Fill material will be free of clay and must be approved by the Sale Administrator prior to placement.

4.2.4 - Grading (10/16)

Once use of forest roads for sale operations begin, state forest roads must be graded per the Sale Administrator's request through the contract duration. Final grading of forest roads must be completed within 60 favorable weather days of completion of all contract requirements. In general, this will require a road grader or bulldozer to shape up the roads after forest products have been hauled off site. This includes cleaning of drainage areas, creation of fords, grading, crowning and filling with gravel, if necessary. The grading equipment to be used must be approved by the Unit Manager or his/her representative.

4.4 - Access

4.4.1 - Private property access (3/11)

Permission for access across private land is the responsibility of the Purchaser. Should the Purchaser desire to cross private land, a copy of the written permission from the private land-owner(s) will be required by the DNR. A copy of the written permission from the private landowner must be given to the Unit Manager within 30 days of the bid opening and prior to the beginning of operations. Private access may be desirable for the producer in two locations called out on the Timber Sale Map. Should private access at the south end of Payment Unit 2 be requested and granted, the construction of a berm on state land, blocking access to the private land, will be required at the completion of all Payment Unit 3 contract requirements. In general, this will require constructing a four (4') foot high berm of stumps and logs covered with earth. Contact DNR Forester Dale Parris at 989-590-1204 for private landowner contact information.

5 - Operations

5.1 - Notification

5.1.1 - Pre-sale conference (10/16)

A pre-sale conference on site between the Purchaser and sale administrator is required prior to beginning any operations within a Payment Unit to determine landing and road locations. The Unit Manager or his/her representative must be contacted at least 5 days in advance to schedule the conference.

5.1.4 - Post-sale conference (10/16)

A post-sale conference on site between the Purchaser and sale administrator is required 5 days prior to the completion of active logging operations to determine clean-up and repair of landings, road edges, and the fulfillment of other contract specifications.

5.2 - Conduct of Operations

5.2.2 - Hazard Trees/Snags

5.2.2.1 - Den trees (10/16)

Obvious hollow and/or den trees shall be protected and left standing unless they are a safety hazard.

5.2.3 - Operating Restrictions

5.2.3.11 - Coppice regeneration protection (4/10)

Timber harvesting in any Payment Unit must be completed before significant deciduous tree sprouting occurs in that Payment Unit so as to minimize damage to the new regeneration. Any post harvest operations, such as chipping, must be completed before sprouting of regeneration occurs. If it is anticipated that chipping will be delayed, then tops shall be carried to one central location or left unchipped. The Unit Manager or his/her representative may cease such operations if sprouting occurs before the operation is complete.

5.2.4 - Dead and Down Creation

5.2.4.7 - Dead and down creation: hare, grouse, deer and other species (5/15)

To improve horizontal cover habitat for snowshoe hare, grouse, deer, and other species, the Purchaser is to push over all purple ringed trees after all designated wood has been forwarded from Payment Unit 3. These trees should be tipped over with the root ball still attached so the base of the tree is suspended off the ground. The crown of the fallen tree should be at or near ground level after it is pushed over.

5.2.22 - Operating Caution

5.2.22.1 - Operating caution (6/11)

It is recommended, but not required, that within Payment Unit(s) 1-3, cutting, skidding, and hauling occur during dry summer or frozen winter conditions. The reason for the recommendation is due to forest roads needed for access and hauling while traversing through extensive lowland areas.

5.2.32 - Decking/landing restoration (9/13)

All decking and landing areas must have the surface area restored to a condition equal to or better than before. This is to ensure the proper regeneration of the stand. Wood debris, chips and "cookies" from trimmings must be removed or scattered away from landing and loading areas and may not be windrowed on the edge. Created landing area openings/turnarounds, preapproved by the Sale Administrator, must be reclaimed with slash to the Sale Administrator's satisfaction when operations in a Payment Unit(s) are complete.

5.2.38 - No decking against live trees (2/04)

Cut products may not be decked against unmarked or designated leave trees.

5.3 - Stream Protection

5.3.2 - Parking equipment near water (10/23)

Within Payment Unit(s) 1-3, the parking of or storage of equipment is prohibited within 100 feet of water bodies or ground water supplies. All equipment, when not in use for harvest operations, must be parked a minimum of 100 feet away from water sources (streams, rivers, lakes, ponds, vernal pools, ground water sources) and 50 feet away from slopes leading to water sources and/or riparian areas. This restriction is for preventing unforeseen oil and/or fluid leaks from contaminating water bodies and/or ground water supplies.

5.4 - Soil Protection

5.4.1 - Rutting restriction, general (7/16)

Operations are to cease immediately if equipment and weather conditions result in rutting of roads and/or skid trails which is 12 inches or greater in depth and 50 feet in length. The Unit Manager or his/her representative may restrict hauling and/or skidding if ruts exceed the specified depth. With the Unit Manager or his/her representative's approval, the Purchaser may

return to the area when the risk of rutting has decreased.

5.4.3 - Erosion control (12/08)

Skid trails or haul roads may require erosion control structures or berms per direction of the Unit Manager or his/her representative.

5.8 - Protection of Endangered Species

5.8.5 - Protection of raptor nests (3/13)

All trees with raptor nests will be protected if found during harvesting operations. Notification will be made to the Unit Manager or his/her representative who will notify the Wildlife Biologist so an on-site evaluation and recommendation can be made, if necessary.

6 - Safety and Fire Prevention

6.2 - Signing

6.2.1 - Road posting (10/20)

The Purchaser is responsible for posting and maintaining caution signs on forest roads prior to beginning operations. The road must be posted at appropriate distances from the Sale Area to warn of logging activity and truck traffic. Signs must be removed when harvest operations are suspended or completed. The Purchaser will provide these signs.



TIMBER SALE MAP

This information provided by authority of Part 525, 1994 PA 451, as amended.

Sale Number	Date	
54-043-23	11/16/2023	
Scale	Page	Of
1:15,840	1	1

Forest Management Unit	County	Mapped By: D. Parris
Atlanta Mgt Unit	Presque Isle	Cruised By: D. Parris

Township	Range	Section(s) and Subdivision(s)
33N	05E	Sec. 33 E1/2NE,NESE; Sec. 34 W1/2NW,SWSW;

Cover Type			
A = Aspen	J = Jack Pine	O = Oak	U = Upland Brush
B = Paper Birch	K = Rock	P = Lowland Poplar	UM = Upland Mix Forest
C = Cedar	L = Lowland Brush	Q = Mixed Swamp Conifer	V = Bog or Marsh
D = Treed Bog	LM = Lowland Mix Forest	R = Red Pine	W = White Pine
E = Swamp Hardwoods	M = Maple, Beech, Birch	S = Black Spruce	X = Non Stocked
F = Spruce/Fir	MC = Mixed Conifer	T = Tamarack	Y = Sand
G = Grass	MD = Mixed Deciduous	Z = Water	
H = Hemlock	N = Marsh		

Density	
0 = Non Stocked	5 = Pole Timber Medium
1 = Seedling Sapling Poor	6 = Pole Timber Well
2 = Seedling Sapling Medium	7 = Saw Timber Poor
3 = Seedling Sapling Well	8 = Saw Timber Medium
4 = Pole Timber Poor	9 = Saw Timber Well

PU #	Acres
1	9.6
2	11.1
3	24.3

Use QR Code to open Map in App



Road Challenge Mix

Compartments 131 and 132

45.0 Acres

Legend	
	Against State (Red)
	Against State (Orange)
	Private Line (Blue)
	Stand
	Intermittent Stream
	Perennial River
	Primary Forest Road
	Secondary Forest Road
	Forest Access Route
	Administrative Access Only
	Non-DNR Road
	Survey Corners

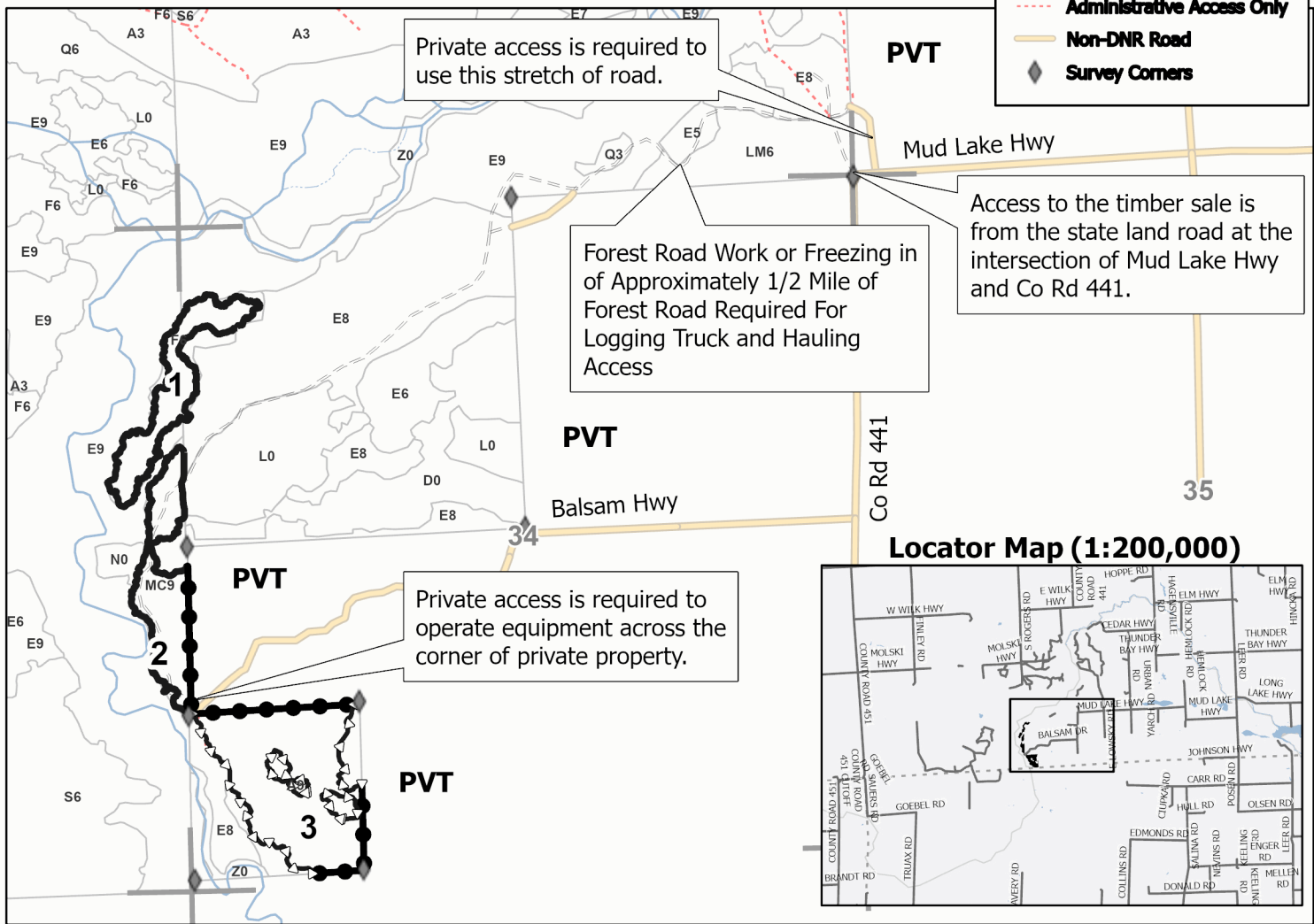
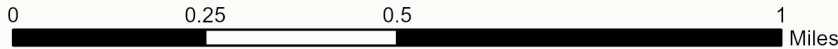

Locator Map (1:200,000)

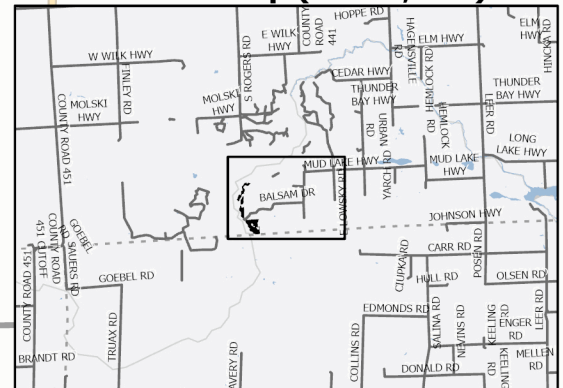

Road Challenge Mix (54-043-23)
T33N, R05E, SEC. 33; T33N, R05E, SEC. 34; Presque Isle COUNTY

In response to the notice of sale to be held 10:00 a.m. (local time) on May 21, 2024, I am hereby submitting my sealed bid (firm offer) for the following forest products to be cut. Bids for individual species must be at or above the advertised price. All non-responsive bid forms may be rejected.

<u>PRODUCTS & SPECIES</u>	<u>ESTIMATED VOLUME*</u>	<u>ADVERTISED PRICE</u>	<u>BID PRICE/UNIT</u>
Sawtimber			
Balsam Fir	32.8 MBF	\$ 28.00/MBF	\$ _____
Mixed Spruce	6.8 MBF	\$ 37.00/MBF	\$ _____
Red Maple	26.7 MBF	\$ 51.00/MBF	\$ _____
Pulpwood			
Balsam Fir	340 Cords	\$ 13.50/Cord	\$ _____
Mixed Aspen	258 Cords	\$ 16.65/Cord	\$ _____
Mixed Spruce	43 Cords	\$ 14.00/Cord	\$ _____
N. White Cedar	21 Cords	\$ 6.30/Cord	\$ _____
Paper Birch	35 Cords	\$ 10.75/Cord	\$ _____
Red Maple	657 Cords	\$ 16.60/Cord	\$ _____

*The volumes are statistically estimated within plus (+) or minus (-) 30.28 percent at 95% confidence level. These estimated volumes are final and not subject to adjustment. Prospective bidders are urged to examine this timber and to make their own estimates of quantity and quality.

I understand that any or all bids may be rejected. All bids must be signed and all bid items must be bid or the bid form may be rejected. I also understand that consideration and awarding a contract will be based upon my past performance and ability to complete the contract based upon equipment and staffing subject to my control.

FEDERAL ID: ____ - ____ - ____ or SOCIAL SECURITY NUMBER: ____ - ____ - ____

Company or individual bidding: _____

Company representative's name: _____

Address: _____

City: _____ State: _____ Zip: _____

IF AVAILABLE, PLEASE PLACE THE PERSONALIZED LABEL FROM YOUR PROSPECTUS IN THE ABOVE BOX.

Individual or company representative's signature: _____ Date: _____

Phone number : _____ Email (optional): _____

THE WINNING BIDDER MUST COMPLETE THE VERIFICATION OF WORKER'S DISABILITY COMPENSATION ACT COMPLIANCE (ON REVERSE SIDE IF DOUBLE SIDED) WITHIN 21 DAYS OF SALE AWARD DATE



FOR DEPARTMENT USE ONLY
Sale Number (XX – XXX – XX – XX)
Forest Management Unit:

TIMBER SALE VERIFICATION OF WORKER'S DISABILITY COMPENSATION ACT COMPLIANCE

*As required by Act 317, P.A. 1969 (Worker's Compensation) and
Part 5 of Act 451 of 1994, as amended.*

VERIFICATION OF WORKER'S DISABILITY COMPENSATION ACT COMPLIANCE

- This verification must be completed and submitted within 21 days of contract award and prior to the issuance of the timber sale contract.
- In addition, if boxes 2B or 2C are checked, then Notice of Exclusion or Certificate of Insurance must be submitted within twenty-one (21) days of the contract award and prior to the issuance of the timber sale contract.
- All information must be typed or printed except for written signatures.

Please Check Appropriate Categories:

1. My business is organized as (you **must** check one of the boxes below):
 - A. Sole Proprietorship (individual)
 - B. Partnership
 - C. Corporation
2. You **must** check one of the boxes below:
 - A. I certify my business is a sole proprietorship and it has no employees but the sole proprietor. I am not subject to the Worker's Compensation Laws.
 - B. I certify my business has satisfied its obligation to the Worker's Compensation Act through the use of an approved Notice of Exclusion (BWC-337, Rev. 5/96). I will provide a copy of the Notice of Exclusion within 21 days of the contract award. (For questions or a copy of the BWC-337, please call the Worker's Compensation Bureau at 517-322-1195).
 - C. I certify my business has a Worker's Compensation Policy. I will provide an original Certificate of Insurance within twenty-one (21) days of the contract award.
3. If you have checked item 2(A) or 2(B), you **must** indicate the number of **both** full-time and part-time employees, other than yourself, including family members and active partners (if none, you must enter "0").

_____ Full-time Employees

_____ Part-time Employees

Name of Business		Federal ID (or) Social Security No.	
Address		Telephone ()	
City	State	ZIP	

I hereby certify that the above information is true and correct. I agree to notify the Michigan DNR of any changes that occur in factors affecting my coverage during any of my present and future operations.

Signature of Owner or Authorized Representative

Title

Date

Please complete the "SEALED BID" information on the next page

Oh Deer Aspen (54-009-23)

T33N, R02E, SEC. 1; T33N, R02E, SEC. 11; T33N, R02E, SEC. 12; Presque Isle

In response to the notice of sale to be held 10:00 a.m. (local time) on May 21, 2024, I am hereby submitting my sealed bid (firm offer) for the following forest products to be cut. Bids for individual species must be at or above the advertised price. All non-responsive bid forms may be rejected.

<u>PRODUCTS & SPECIES</u>	<u>ESTIMATED VOLUME*</u>	<u>ADVERTISED PRICE</u>	<u>BID PRICE/UNIT</u>
Sawtimber			
Mixed Aspen	259.5 MBF	\$ 111.00/MBF	\$ _____
Red Oak	103.4 MBF	\$ 195.00/MBF	\$ _____
Red Pine	3.8 MBF	\$ 139.00/MBF	\$ _____
Sugar Maple	10.5 MBF	\$ 462.00/MBF	\$ _____
White Pine	11.5 MBF	\$ 127.00/MBF	\$ _____
Pulpwood			
Balsam Fir	351 Cords	\$ 20.20/Cord	\$ _____
Basswood	12 Cords	\$ 15.65/Cord	\$ _____
Mixed Aspen	2,718 Cords	\$ 25.00/Cord	\$ _____
Mixed Hardwood	492 Cords	\$ 24.90/Cord	\$ _____
Paper Birch	22 Cords	\$ 16.15/Cord	\$ _____
Red Oak	218 Cords	\$ 33.75/Cord	\$ _____
Red Pine	6 Cords	\$ 40.20/Cord	\$ _____
White Pine	170 Cords	\$ 27.90/Cord	\$ _____

*The volumes are statistically estimated within plus (+) or minus (-) 9.63 percent at 95% confidence level. These estimated volumes are final and not subject to adjustment. Prospective bidders are urged to examine this timber and to make their own estimates of quantity and quality.

I understand that any or all bids may be rejected. All bids must be signed and all bid items must be bid or the bid form may be rejected. I also understand that consideration and awarding a contract will be based upon my past performance and ability to complete the contract based upon equipment and staffing subject to my control.

FEDERAL ID: _____ or SOCIAL SECURITY NUMBER: _____

Company or individual bidding: _____

Company representative's name: _____

Address: _____

City: _____ State: _____ Zip: _____

IF AVAILABLE, PLEASE PLACE THE PERSONALIZED LABEL FROM YOUR PROSPECTUS IN THE ABOVE BOX.

Individual or company representative's signature: _____ Date: _____

Phone number : _____ Email (optional): _____

THE WINNING BIDDER MUST COMPLETE THE VERIFICATION OF WORKER'S DISABILITY COMPENSATION ACT COMPLIANCE (ON REVERSE SIDE IF DOUBLE SIDED) WITHIN 21 DAYS OF SALE AWARD DATE



TIMBER SALE VERIFICATION OF WORKER'S DISABILITY COMPENSATION ACT COMPLIANCE

As required by Act 317, P.A. 1969 (Worker's Compensation) and
Part 5 of Act 451 of 1994, as amended.

FOR DEPARTMENT USE ONLY	
Sale Number (XX - XXX - XX - XX)	
Forest Management Unit:	

VERIFICATION OF WORKER'S DISABILITY COMPENSATION ACT COMPLIANCE

- This verification must be completed and submitted within 21 days of contract award and prior to the issuance of the timber sale contract.
- In addition, if boxes 2B or 2C are checked, then Notice of Exclusion or Certificate of Insurance must be submitted within twenty-one (21) days of the contract award and prior to the issuance of the timber sale contract.
- All information must be typed or printed except for written signatures.

Please Check Appropriate Categories:

1. My business is organized as (you **must** check one of the boxes below):
 - A. Sole Proprietorship (individual)
 - B. Partnership
 - C. Corporation
2. You **must** check one of the boxes below:
 - A. I certify my business is a sole proprietorship and it has no employees but the sole proprietor. I am not subject to the Worker's Compensation Laws.
 - B. I certify my business has satisfied its obligation to the Worker's Compensation Act through the use of an approved Notice of Exclusion (BWC-337, Rev. 5/96). I will provide a copy of the Notice of Exclusion within 21 days of the contract award. (For questions or a copy of the BWC-337, please call the Worker's Compensation Bureau at 517-322-1195).
 - C. I certify my business has a Worker's Compensation Policy. I will provide an original Certificate of Insurance within twenty-one (21) days of the contract award.
3. If you have checked item 2(A) or 2(B), you **must** indicate the number of **both** full-time and part-time employees, other than yourself, including family members and active partners (if none, you must enter "0").

_____ Full-time Employees

_____ Part-time Employees

Name of Business		Federal ID (or) Social Security No.	
Address		Telephone ()	
City	State	ZIP	

I hereby certify that the above information is true and correct. I agree to notify the Michigan DNR of any changes that occur in factors affecting my coverage during any of my present and future operations.

Signature of Owner or Authorized Representative

Title

Date

Please complete the "SEALED BID" information on the next page

Stevens Springs Eternal (54-015-23)

T31N, R02E, SEC. 13; T31N, R02E, SEC. 24; T31N, R02E, SEC. 25; T31N, R03E,

In response to the notice of sale to be held 10:00 a.m. (local time) on May 21, 2024, I am hereby submitting my sealed bid (firm offer) for the following forest products to be cut. Bids for individual species must be at or above the advertised price. All non-responsive bid forms may be rejected.

<u>PRODUCTS & SPECIES</u>	<u>ESTIMATED VOLUME*</u>	<u>ADVERTISED PRICE</u>	<u>BID PRICE/UNIT</u>
Sawtimber			
Black/Red (Hybrid) Oak	82.6 MBF	\$ 124.00/MBF	\$ _____
Mixed Aspen	185.7 MBF	\$ 111.00/MBF	\$ _____
Red Maple	10.7 MBF	\$ 77.00/MBF	\$ _____
Red Oak	182.1 MBF	\$ 195.00/MBF	\$ _____
Red Pine	10.7 MBF	\$ 139.00/MBF	\$ _____
White Pine	49.7 MBF	\$ 127.00/MBF	\$ _____
Pulpwood			
Balsam Fir	172 Cords	\$ 20.20/Cord	\$ _____
Mixed Aspen	1,739 Cords	\$ 25.00/Cord	\$ _____
Mixed Hardwood	527 Cords	\$ 24.90/Cord	\$ _____
Mixed Oak	540 Cords	\$ 33.75/Cord	\$ _____
Paper Birch	34 Cords	\$ 16.15/Cord	\$ _____
Red Pine	15 Cords	\$ 40.20/Cord	\$ _____
Tamarack	17 Cords	\$ 20.10/Cord	\$ _____
White Pine	92 Cords	\$ 27.90/Cord	\$ _____

*The volumes are statistically estimated within plus (+) or minus (-) 9.64 percent at 95% confidence level. These estimated volumes are final and not subject to adjustment. Prospective bidders are urged to examine this timber and to make their own estimates of quantity and quality.

I understand that any or all bids may be rejected. All bids must be signed and all bid items must be bid or the bid form may be rejected. I also understand that consideration and awarding a contract will be based upon my past performance and ability to complete the contract based upon equipment and staffing subject to my control .

FEDERAL ID: _____ - _____ or SOCIAL SECURITY NUMBER: _____ - _____ - _____

Company or individual bidding: _____

Company representative's name: _____

Address: _____

City: _____ State: _____ Zip: _____

IF AVAILABLE, PLEASE PLACE THE PERSONALIZED LABEL FROM YOUR PROSPECTUS IN THE ABOVE BOX.

Individual or company representative's signature: _____ Date: _____

Phone number : _____ Email (optional): _____

THE WINNING BIDDER MUST COMPLETE THE VERIFICATION OF WORKER'S DISABILITY COMPENSATION ACT COMPLIANCE (ON REVERSE SIDE IF DOUBLE SIDED) WITHIN 21 DAYS OF SALE AWARD DATE



FOR DEPARTMENT USE ONLY
Sale Number (XX - XXX - XX - XX)
Forest Management Unit:

TIMBER SALE VERIFICATION OF WORKER'S DISABILITY COMPENSATION ACT COMPLIANCE

*As required by Act 317, P.A. 1969 (Worker's Compensation) and
Part 5 of Act 451 of 1994, as amended.*

VERIFICATION OF WORKER'S DISABILITY COMPENSATION ACT COMPLIANCE

- This verification must be completed and submitted within 21 days of contract award and prior to the issuance of the timber sale contract.
- In addition, if boxes 2B or 2C are checked, then Notice of Exclusion or Certificate of Insurance must be submitted within twenty-one (21) days of the contract award and prior to the issuance of the timber sale contract.
- All information must be typed or printed except for written signatures.

Please Check Appropriate Categories:

1. My business is organized as (you **must** check one of the boxes below):
 - A. Sole Proprietorship (individual)
 - B. Partnership
 - C. Corporation
2. You **must** check one of the boxes below:
 - A. I certify my business is a sole proprietorship and it has no employees but the sole proprietor. I am not subject to the Worker's Compensation Laws.
 - B. I certify my business has satisfied its obligation to the Worker's Compensation Act through the use of an approved Notice of Exclusion (BWC-337, Rev. 5/96). I will provide a copy of the Notice of Exclusion within 21 days of the contract award. (For questions or a copy of the BWC-337, please call the Worker's Compensation Bureau at 517-322-1195).
 - C. I certify my business has a Worker's Compensation Policy. I will provide an original Certificate of Insurance within twenty-one (21) days of the contract award.
3. If you have checked item 2(A) or 2(B), you **must** indicate the number of **both** full-time and part-time employees, other than yourself, including family members and active partners (if none, you must enter "0").

_____ Full-time Employees

_____ Part-time Employees

Name of Business		Federal ID (or) Social Security No.	
Address		Telephone ()	
City	State	ZIP	

I hereby certify that the above information is true and correct. I agree to notify the Michigan DNR of any changes that occur in factors affecting my coverage during any of my present and future operations.

Signature of Owner or Authorized Representative

Title

Date

Please complete the "SEALED BID" information on the next page

Kinzie Conversion Oak (54-016-23)
T31N, R02E, SEC. 23; Montmorency COUNTY

In response to the notice of sale to be held 10:00 a.m. (local time) on May 21, 2024, I am hereby submitting my sealed bid (firm offer) for the following forest products to be cut. Bids for individual species must be at or above the advertised price. All non-responsive bid forms may be rejected.

<u>PRODUCTS & SPECIES</u>	<u>ESTIMATED VOLUME*</u>	<u>ADVERTISED PRICE</u>	<u>BID PRICE/UNIT</u>
Sawtimber			
Basswood	11.4 MBF	\$ 89.00/MBF	\$ _____
Black/Red (Hybrid) Oak	11.4 MBF	\$ 124.00/MBF	\$ _____
Red Oak	271.8 MBF	\$ 195.00/MBF	\$ _____
Pulpwood			
Basswood	14 Cords	\$ 15.65/Cord	\$ _____
Mixed Aspen	168 Cords	\$ 25.00/Cord	\$ _____
Mixed Hardwood	129 Cords	\$ 24.90/Cord	\$ _____
Mixed Oak	602 Cords	\$ 33.75/Cord	\$ _____
Red Pine	6 Cords	\$ 40.20/Cord	\$ _____
White Pine	65 Cords	\$ 27.90/Cord	\$ _____

*The volumes are statistically estimated within plus (+) or minus (-) 14.97 percent at 95% confidence level. These estimated volumes are final and not subject to adjustment. Prospective bidders are urged to examine this timber and to make their own estimates of quantity and quality.

I understand that any or all bids may be rejected. All bids must be signed and all bid items must be bid or the bid form may be rejected. I also understand that consideration and awarding a contract will be based upon my past performance and ability to complete the contract based upon equipment and staffing subject to my control.

FEDERAL ID: ____ - ____ - ____ or SOCIAL SECURITY NUMBER: ____ - ____ - ____

Company or individual bidding: _____

Company representative's name: _____

Address: _____

City: _____ State: _____ Zip: _____

IF AVAILABLE, PLEASE PLACE THE PERSONALIZED LABEL FROM YOUR PROSPECTUS IN THE ABOVE BOX.

Individual or company representative's signature: _____ Date: _____

Phone number : _____ Email (optional): _____

THE WINNING BIDDER MUST COMPLETE THE VERIFICATION OF WORKER'S DISABILITY COMPENSATION ACT COMPLIANCE (ON REVERSE SIDE IF DOUBLE SIDED) WITHIN 21 DAYS OF SALE AWARD DATE



TIMBER SALE VERIFICATION OF WORKER'S DISABILITY COMPENSATION ACT COMPLIANCE

As required by Act 317, P.A. 1969 (Worker's Compensation) and
Part 5 of Act 451 of 1994, as amended.

FOR DEPARTMENT USE ONLY	
Sale Number (XX - XXX - XX - XX)	
Forest Management Unit:	

VERIFICATION OF WORKER'S DISABILITY COMPENSATION ACT COMPLIANCE

- This verification must be completed and submitted within 21 days of contract award and prior to the issuance of the timber sale contract.
- In addition, if boxes 2B or 2C are checked, then Notice of Exclusion or Certificate of Insurance must be submitted within twenty-one (21) days of the contract award and prior to the issuance of the timber sale contract.
- All information must be typed or printed except for written signatures.

Please Check Appropriate Categories:

1. My business is organized as (you **must** check one of the boxes below):
 - A. Sole Proprietorship (individual)
 - B. Partnership
 - C. Corporation
2. You **must** check one of the boxes below:
 - A. I certify my business is a sole proprietorship and it has no employees but the sole proprietor. I am not subject to the Worker's Compensation Laws.
 - B. I certify my business has satisfied its obligation to the Worker's Compensation Act through the use of an approved Notice of Exclusion (BWC-337, Rev. 5/96). I will provide a copy of the Notice of Exclusion within 21 days of the contract award. (For questions or a copy of the BWC-337, please call the Worker's Compensation Bureau at 517-322-1195).
 - C. I certify my business has a Worker's Compensation Policy. I will provide an original Certificate of Insurance within twenty-one (21) days of the contract award.
3. If you have checked item 2(A) or 2(B), you **must** indicate the number of **both** full-time and part-time employees, other than yourself, including family members and active partners (if none, you must enter "0").

_____ Full-time Employees

_____ Part-time Employees

Name of Business		Federal ID (or) Social Security No.	
Address		Telephone ()	
City	State	ZIP	

I hereby certify that the above information is true and correct. I agree to notify the Michigan DNR of any changes that occur in factors affecting my coverage during any of my present and future operations.

Signature of Owner or Authorized Representative

Title

Date

Please complete the "SEALED BID" information on the next page