



**DEPARTMENT OF NATURAL RESOURCES  
STATE OF MICHIGAN  
TIMBER SALE PROSPECTUS #7666**

**SCHEDULED SALE DATE AND TIME:** 3:00 p.m. (local time) on July 16, 2025.

**LOCATION:** ESCANABA MGMT UNIT, 6833 US-2, 41 & M-35, GLADSTONE, MI 49837.

**PROSPECTUS NOTE:** The bidder is advised to inspect the sale area and review the location, estimated volumes, operating costs and contract terms of proposed sales. Please be aware that some landowners may request 60 days or more notice for access across their land.

Notice is hereby given that bids will be received by the Unit Manager, ESCANABA MANAGEMENT UNIT, for certain timber on the following described lands:

**Bruised Eye Mix** (33-024-25) / T37N, R28W, SEC. 27, SESW,SWSE.

T37N, R28W, SEC. 34, NW,NWNE,N1/2SW.

Menominee County, Advertised Price \$29,557.65, 83.6 Acres, Aspen, White Pine.

SALE NOTE: The majority of the sale is upland and can be harvested during the non-winter months. The Purchaser must haul and spread gravel on this sale, per Sale Spec 4.1.8.

**Rusty Nelson** (33-025-25) / T36N, R24W, SEC. 5 , SESW,SWSE.

T36N, R24W, SEC. 7 , SENE,E1/2SE.

T36N, R24W, SEC. 8 , NW,NWSW.

Menominee County, Advertised Price \$12,823.10, 103.8 Acres, Hardwood, Spruce/Fir/Tamarack.

SALE NOTE: The Purchaser must haul and spread some gravel prior to wood being hauled from Payment Units 4 - 6, see spec 4.1.8 for details. The gravel pit is adjacent to the sale. A large portion of the sale can be harvested during a dry summer.

## BID INSTRUCTIONS (VER. 10/10/2022):

### 1. Scheduled Bid Location, Date, and Time (2/11)

Bids must be received by the Unit Manager, ESCANABA OFFICE, 6833 US-2, 41 & M-35, Gladstone, MI 49837, no later than 3:00 p.m. (local time) on July 16, 2025. For further information concerning this sale, contact Dan Racine at 906-789-8231.

### 2. Bidder's Qualifications (10/22)

If all or part of a timber sale was prepared by a private contractor, the contractor and that contractor's company are not permitted to bid on the timber sale. A person must be 18 years of age or older to purchase timber. Permanent employees of the Department of Natural Resources or members of their immediate household may not bid. Former employees, in the permanent or seasonal class, may not bid until 3 months after the last day of active duty. Bids will not be accepted from individuals or companies appearing on the DNR/FRD No-Bid List. This list contains the names of purchasers who previously failed to execute a contract within 21-days or who have a history of poor performance.

### 3. Preparation of Sealed Bids (5/16)

Bid Forms may be completed online thru Michigan DNR Timber Sale Online Bidding (OLB) at [www.michigan.gov/timberbidding](http://www.michigan.gov/timberbidding) or by completing the hardcopy Bid Form found in the Timber Sale Prospectus. Hardcopy Bid Forms shall be manually signed in ink. Registration in OLB is considered your 'signature' for all bids submitted thru that system. Bid prices must be entered for each species and product in the Bid Price column for all material subject to bidding and all fill-in blanks must be completed. If erasures or other changes appear on the hardcopy Bid Form, each erasure or change must be initialed by the person signing the bid.

### 4. Submission of Sealed Bids (5/16)

Bid forms may be obtained from the Unit Manager or thru OLB. Bids may be submitted hardcopy or thru OLB. All hardcopy bids must be submitted on the bid form and in an envelope clearly identified as described in this section. NOTE: Only one bid form per bid envelope. Sealed bids must be submitted to the Unit office designated in the prospectus and must be submitted at or prior to the time established in the prospectus. The envelope should show on the outside (a) the sale name or number and (b) the date and time of bid opening, as shown in the prospectus. Bids received after the time specified in the sale prospectus are late bids and will be rejected.

It is possible for a bidder to submit multiple bids on a single sale. For example, a bid may be submitted hardcopy and a bid may be submitted thru OLB. Or, two bidders from the same company could both submit bids on the same sale. If this were to happen, the State would accept all bids received and award the contract accordingly. All bidding and contractual requirements would apply to all bids received.

### 5. Public Opening of Sealed Bids (7/16)

If conditions permit, the sealed bids will be publicly opened and posted at the time and place set in the prospectus.

If a bidder, present at a bid opening, has submitted bids on more than one sale, that bidder may withdraw their unopened bid envelopes or announce the withdrawal of their online bid after being declared the successful bidder on one sale.

### 6. Award of Contract (1/11)

Award of the contract will be made to the Bidder whose bid, conforming to the prospectus, is most advantageous to the State of Michigan on the basis of total value at rates bid for the estimated quantities. The State reserves the right to reject any bid or waive any minor irregularity in bids received. A written award mailed (or otherwise furnished) to the successful Bidder shall be deemed to result in a binding contract without further action by either party.

### 7. Down Payment (1/11)

The Bidder to whom award is made must make a down payment within 21 days of the sale award. The amount of the down payment will be calculated as shown in the Bond and Payment Schedule of this prospectus. Only cash may be used to meet this requirement.

### 8. Performance Security (1/11)

As guarantee of faithful performance, a cash bond, certificate of deposit, surety bond or irrevocable letter of credit (LOC) is required within 21 days of the sale award. The amount of the performance security is shown in the Bond and

Payment Schedule of this prospectus. If an LOC or surety is used, the coverage must extend for at least 6 months beyond the contract expiration.

#### 9. Worker's Compensation (10/22)

Purchaser shall obtain worker's compensation insurance to cover claims under Michigan's Worker's Disability Compensation Act of 1969 or similar employee benefit act of any other state applicable to an employee. Verification of Worker's Disability Compensation Act Compliance must be completed and submitted within 21 days of contract award and prior to the issuance of the timber sale contract. In addition, if applicable, Notice of Exclusion or Certificate of Insurance must also be submitted.

#### 10. Timber Sale Contract (10/22)

Additional conditions and requirements common to all timber sales are listed on the timber sale contract (R4031) and are available on line at [www.michigan.gov/timber](http://www.michigan.gov/timber). Contact the Unit Manager for additional information or a sample contract. Within 21 days of the date of the award letter, the bidder must sign the contract and provide the required down payment, performance security, and verification of worker's disability compensation. The down payment and performance security shall be in accordance with the provisions of the timber sale contract, in the sums stated in this prospectus. If these actions are not taken, then the Bidder, the Bidder's corporation, and the corporation's principals may not be permitted to bid on State timber sales for a period of 3 months after the first offense, 6 months after the second offense, and 1 year after the third offense. An offense will only be counted against the Bidder for 5 years. In addition, the Bidder certifies that if awarded this contract, the Bidder will complete the timber sale contract in accordance with its terms and any modifications thereof including requirements to purchase, cut, and remove the included timber by the expiration date.

Payment Unit values in the State Forest Timber Sale Contract are calculated based on the advertised value of the Payment Unit as a percentage of the total advertised value of the contract. The advertised value of each Payment Unit is given in the Description of Timber by Payment Unit table on the Timber Sale Information page. For example, if the value of Payment Unit 1 is advertised as \$1,500 and the total Timber Sale value is advertised as \$10,000, the contract price for Payment Unit 1 will be 15% of the total bid price ( $\$1,500/\$10,000 * 100$ ).

#### 11. Disclaimer of Estimates and Bidder's Warranty of Inspection (10/22)

Before submitting this bid, the Bidder is advised and cautioned to inspect the sale area, review the requirements of the sale contract, and take other steps as may be reasonably necessary to ascertain the location, estimated volumes, construction estimates, and operating costs of the proposed sale. Failure to do so will not relieve the Bidder from responsibility for completing the contract.

The Bidder warrants that this bid is submitted solely on the basis of the Bidder's examination and inspection of the quality and quantity of the timber offered for sale and the Bidder's opinion of the value thereof and the costs of recovery. No reliance should be placed on the State of Michigan's estimates of timber quality, quantity or costs of recovery. Bidder further acknowledges that the State of Michigan: (i) expressly disclaims any warranty of fitness of timber for any purpose; (ii) offers this timber as is without any warranty of quality (merchantability) or quantity and (iii) expressly disclaims any warranty as to the quantity or quality of timber sold.

#### 12. Certification and Chain-of-Custody (10/22)

Unless otherwise indicated in the contract under section 7 – Other Conditions of the Sale Specific Conditions & Requirements, the area encompassed by this timber sale is certified to the standards of the Forest Stewardship Council (FSC) - Certificate #SCS-FM/COC-00090N and the Sustainable Forestry Initiative (SFI) - Certificate #NSF-SFIS-5Y031-SF5. Forest products from this sale may be delivered to the mill as "FSC 100% and / or SFI certified" as long as the contractor hauling the forest products is chain-of-custody (COC) certified or covered under a COC certificate from the destination mill. The purchaser is responsible for maintaining COC after leaving the sale area.

#### 13. Good Neighbor Authority (GNA) Requirements (10/22)

If the name of this timber sales contains the acronym GNA, it is authorized by the Good Neighbor Authority (GNA) and covered by various agreements between the U.S. Forest Service and the State. The timber sale occurs on federal land and the following conditions apply:

GNA contracts on US Forest Service land will not be awarded to purchasers on the Federal list of excluded parties. The System for Award Management (SAM) will be checked for active excluded parties prior to award of contract. In

addition, the Bidder to whom award is made must complete an Assurance Regarding Felony Conviction or Tax Delinquent Status for Corporate Applicants (AD-3031).

14. Good Neighbor Authority (GNA) Requirements, con't (10/22)

Bidder certifies, by signing this bid form, that to the best of Bidder's knowledge that the following representations are accurate and complete.

- a. That the Bidder and its principals are not presently debarred, suspended, proposed for debarment, declared ineligible, or voluntary excluded from timber sales (covered transactions) by any Federal department or agency.
- b. That the Bidder and its principals have not within a 3-year period preceding this bid been convicted of or had a civil judgment rendered against them for commission of fraud or a criminal offense in connection with obtaining , attempting to obtain, or performing a public (Federal, State, or local) transaction or contract under a public transaction; violation of Federal or State antitrust statutes or commission of embezzlement, theft, forgery, bribery, falsification or destruction of records, making false statements, or receiving stolen property.
- c. That the Bidder and its principals are not presently indicted for or otherwise criminally or civilly charged by a governmental entity (Federal, State, or local) with commission of any of the offenses enumerated in paragraph b of this certification.
- d. That the Bidder and its principals have not within a 3-year period preceding this bid had one or more public transactions (Federal, State, or local) terminated for breach or default of a timber or forest product contract.

Bidders that cannot certify this requirement, in whole or in part, shall submit an explanation with their bid.

Scott Bowen  
Director

## TIMBER SALE INFORMATION

### Bruised Eye Mix (33-024-25)

T37N, R28W, SEC. 27; T37N, R28W, SEC. 34.  
Menominee County (Advertised Price \$29,557.65)

**SALE NOTE:** The majority of the sale is upland and can be harvested during the non-winter months. The Purchaser must haul and spread gravel on this sale, per Sale Spec 4.1.8.

A timber sale contract for this lump sum, sealed bid timber sale will be awarded to the responsible bidder offering the highest sealed bid price. All units of volume listed below were estimated using the Inventory Manager computer program and the new Michigan taper model. Bids must be at or above the following advertised price for each product and species:

<u>PRODUCTS &amp; SPECIES</u>	<u>ESTIMATED UNITS*</u>	<u>ADVERTISED PRICE</u>
Sawtimber		
Red Oak	3.9 MBF	\$ 150.00 / MBF
Pulpwood		
Balsam Fir	96 Cords	\$ 8.10 / Cord
Mixed Aspen	814 Cords	\$ 25.15 / Cord
Mixed Hardwood	134 Cords	\$ 15.90 / Cord
Mixed Spruce	37 Cords	\$ 12.30 / Cord
N. White Cedar	6 Cords	\$ 6.45 / Cord
Red Pine	20 Cords	\$ 67.85 / Cord
Tamarack	5 Cords	\$ 9.70 / Cord
White Pine	233 Cords	\$ 15.85 / Cord

\* The total volume is statistically estimated within plus (+) or minus (-) 18.85 percent. There are an estimated 1,355 cords on this timber sale, plus or minus 256 cords at the 95% confidence level. The estimated units are final and not subject to adjustment. Prospective bidders are urged to examine this timber and to make their own estimates of quantity and quality.

### **BOND AND PAYMENT SCHEDULE:**

- A bond in the amount of \$1,478.00 to insure faithful performance of the conditions of the contract will be deposited by the successful bidder within 21 days of the sale award.
- Cutting in any sale or unit without the required advance payment would be considered a trespass.
- Total payment must be paid in advance or according to the following schedule :
  - Ten percent (10%) of the sale value must be paid within 21 days of the sale award.
  - The 10% down payment will be credited towards the first unit cut.
  - Payment for each of the following units must be made before cutting begins in that unit:
 

PAYMENT UNIT NUMBER	PERCENT OF TOTAL SALE VALUE
01	2.5%
02	26.3%
03	31.2%
04	3.0%
05	17.3%
06	19.7%
- If no cutting takes place, the 10% down payment will not be refunded.
- Operations on the contract issued will terminate on 09/30/2028.

### **SALE STATISTICS**

Volumes were calculated in cubic feet using the Michigan taper model. Cubic foot volume includes all wood inside bark for the product indicated. For display purposes, cubic feet were converted to cords and MBF using a simple conversion factor, e.g. 79 cubic feet per cord and 185 cubic feet per MBF. The cubic foot volumes are precise; the cords and MBF volumes are not. Cubic foot volume cannot be directly converted to cords or boards with precision.

### **SALE VOLUMES**

The total estimated sale volume may not equal the sum of the species/products due to the nature of statistical calculations associated with double sampling methodology.

VOLUME			STATISTICAL RANGE IN CORDS	
TOTAL CUBIC FEET	TOTAL CORDS	PERCENT ERROR	MINIMUM	MAXIMUM
107,084	1,355	18.85%	1,100	1,611

**VDU VOLUMES**

A VDU is a Volume Determination Unit. Volumes and their associated statistics are calculated at the VDU level and summarized to the sale level. There is often a one to one relationship between a VDU and a Payment Unit, but not always, depending on the cruise design. Refer to the VDU TO PAYMENT UNIT table.

	VOLUME			RANGE IN CORDS	
VDU	TOTAL CUBIC FEET	TOTAL CORDS	PERCENT ERROR	MINIMUM	MAXIMUM
3	4,165	53	45.67%	29	77
5	56,480	715	31.36%	491	939
7	5,112	65	59.10%	26	103
8	16,883	214	35.77%	137	290
9	24,444	309	30.74%	214	405
TOTAL:	107,084	1,355		897	1,814

**VDU TO PAYMENT UNIT**

When a VDU is associated with more than one Payment Unit (PU), the VDU volumes are assigned to the PU based on acres of the VDU within the PU.

VDU	VDU ACRES	PU	PU ACRES
3	11.0	1	11.0
5	24.0	2	11.0
		3	13.0
7	6.8	4	6.8
8	18.3	5	18.3
9	23.5	6	23.5
TOTAL:	83.6		83.6

**DESCRIPTION OF TIMBER BY PAYMENT UNIT (PU)**

PU	MARKET GROUP	PRODUCT	QUANTITY	UNIT	ACRES	ADVERTISE PRICE
1	Mixed Hardwood <i>Balsam Poplar</i> <i>Black Ash</i> <i>Paper Birch</i> <i>Red Maple</i> Mixed Spruce <i>Black Spruce</i> Tamarack White Pine	Pulpwood	32 4 21 5 2 11 11 5 3	Cords Cords Cords Cords Cords Cords Cords Cords Cords	11.0	\$740.15
2	Red Oak Balsam Fir Mixed Aspen <i>B. T. Aspen</i> <i>Quaking Aspen</i> Mixed Hardwood <i>Red Maple</i> <i>Red Oak</i> <i>Sugar Maple</i> Mixed Spruce <i>White Spruce</i> Red Pine White Pine	Sawtimber Pulpwood	0.6 6 272 182 90 30 24 4 2 2 2 1 14	MBF Cords Cords Cords Cords Cords Cords Cords Cords Cords Cords Cords Cords	11.0	\$7,770.75
3	Red Oak Balsam Fir Mixed Aspen <i>B. T. Aspen</i> <i>Quaking Aspen</i> Mixed Hardwood <i>Red Maple</i> <i>Red Oak</i> <i>Sugar Maple</i> Mixed Spruce <i>White Spruce</i> Red Pine White Pine	Sawtimber Pulpwood	0.8 8 322 215 107 36 29 5 2 2 2 1 17	MBF Cords Cords Cords Cords Cords Cords Cords Cords Cords Cords Cords Cords	13.0	\$9,217.40
4	Balsam Fir Mixed Aspen <i>Quaking Aspen</i> Mixed Hardwood <i>Red Oak</i> Mixed Spruce <i>White Spruce</i>	Pulpwood	38 18 18 2 2 7 7	Cords Cords Cords Cords Cords Cords Cords	6.8	\$878.40
5	Red Oak Balsam Fir Mixed Aspen <i>Quaking Aspen</i> Mixed Hardwood <i>Black Cherry</i> <i>Red Maple</i> <i>Red Oak</i> Mixed Spruce <i>White Spruce</i> Red Pine White Pine	Sawtimber Pulpwood	0.7 16 163 163 12 3 8 1 2 2 5 15	MBF Cords Cords Cords Cords Cords Cords Cords Cords Cords Cords Cords	18.3	\$5,126.45
6	Red Oak Balsam Fir	Sawtimber Pulpwood	1.8 28	MBF Cords	23.5	\$5,824.50

DESCRIPTION OF TIMBER BY PAYMENT UNIT (PU), CON'T

PU	MARKET GROUP	PRODUCT	QUANTITY	UNIT	ACRES	ADVERTISE PRICE
6 con't	Mixed Aspen	Pulpwood	39	Cords		
	<i>B. T. Aspen</i>		1	<i>Cords</i>		
	<i>Quaking Aspen</i>		38	<i>Cords</i>		
	Mixed Hardwood		22	Cords		
	<i>Balsam Poplar</i>		16	<i>Cords</i>		
	<i>Paper Birch</i>		1	<i>Cords</i>		
	<i>Red Maple</i>		3	<i>Cords</i>		
	<i>Red Oak</i>		2	<i>Cords</i>		
	Mixed Spruce		13	Cords		
	<i>White Spruce</i>		13	<i>Cords</i>		
	N. White Cedar		6	Cords		
	Red Pine		13	Cords		
	White Pine		184	Cords		
TOTAL:			3.9	MBF		
TOTAL:			1,345	Cords		



## Sale Specific Conditions & Requirements

**Sale Name: Bruised Eye Mix**

**Sale Number: 33-024-25 Seq#: 1**

### 1 - Sale Area

#### 1.2 - Boundaries

##### 1.2.1 - Painted Boundaries (9/19)

The sale boundary and Payment Unit boundaries are marked and identified by blue, red and yellow paint. Exterior sale boundary lines against private property are marked with blue paint. Exterior sale boundary lines against state are marked with red paint. Interior Payment Unit boundaries are marked with yellow paint. Retention patches are marked with red paint; no harvesting activities may occur within these areas. The painted boundary line trees are not Included Timber and are to be protected unless marked with orange paint. Yellow painted trees designating an interior Payment Unit boundary are only to be cut when all surrounding Payment Units have been paid for.

### 2 - Timber Specifications

#### 2.1 - Included Timber

##### 2.1.1 - Clearcut Unit(s) with Unmerchantable Trees (6/14)

Within Payment Unit(s) 1-3 and 5-6, cut all trees that are three (3) inches or more at DBH. Within Payment Unit 4, cut all trees that are two (2) inches or more at DBH. The following will apply:

Within Payment Unit 1, do not cut cedar.

Within Payment Units 2, 3, and 6, do not cut trees marked with green paint.

Within Payment Unit 5, do not cut trees marked with green paint or pine that are five (5) inches or less at DBH.

##### 2.1.9 - Harvest Exception (12/24)

Do not cut any cedar trees in Payment Unit 1. other than those that are necessary to remove in order to operate within the Sale Area. Every effort must be made to preserve the existing cedar and to leave an intact stand upon sale completion. All cut cedar shall be piled separately by product and scaled in the woods, unless other scaling arrangements are agreed to by the Unit Manager or his/her representative. Stumpage price for cedar shall be \$35.00 per cord from Payment Unit 1.

#### 2.2 - Utilization

##### 2.2.3 - Stump Heights (12/24)

Stump heights within Payment Unit 4 shall not exceed six (6) inches for all trees. This is in order to facilitate planting operations.

##### 2.2.4 - Skidding Length (12/24)

Skidding of unlimbed tops or lengths over 17 feet is not permissible within Payment Units 1 and 6.

### 3 - Payments

#### 3.3 - Pre-measured Sales

##### 3.3.4 - Dividing Payment Units (7/14)

Payment Unit(s) \$18,000 in value or greater may be divided at the request of the Purchaser and upon approval of the Unit Manager. Dividing Payment Units is a contract modification which requires a Timber Sale Contract Amendment. There will be only one division per Payment Unit.

### 4 - Transportation

#### 4.1 - Construction

##### 4.1.8 - Road Work (1) (8/07)

The following road work is required: The Purchaser must haul and spread a minimum of 220 cubic feet of gravel onto the access road off the old railroad grade heading south through Payment Units 2 and 6 and looping out to the Miscauna Creek

Road. All roadwork must be completed prior to any hauling from any of the Payment Units. Gravel is available from a state pit located on the Miscauna Road, about a mile from the sale.

#### 4.2 - Maintenance

##### 4.2.1 - Hauling Restriction (12/08)

Hauling may be restricted on forest roads by the Unit Manager or his/her representative. The restriction may occur during spring breakup or during other wet weather conditions.

##### 4.2.4 - Grading (10/16)

For completion of the sale, state forest roads must be graded. In general, this will require a road grader or bulldozer to shape up the roads after forest products have been hauled off site. This includes cleaning of drainage areas, grading, crowning and filling with gravel, if necessary. The grading equipment to be used must be approved by the Unit Manager or his/her representative.

### 5 - Operations

#### 5.2 - Conduct of Operations

##### 5.2.3 - Operating Restrictions

###### 5.2.3.1 - Operating Restrictions (9/11)

Within Payment Unit(s) 1, cutting and skidding are limited to the period of December 1 to March 31, unless there is an extended dry or frozen period, and the Sale Administrator allows harvesting during that period of time. This restriction is because of low wet ground throughout the Payment Unit.

###### 5.2.3.11 - Coppice Regeneration Protection (4/10)

To promote aspen regeneration, harvesting is limited to September 1 to April 15 in Payment Unit 5.

### 6 - Safety and Fire Prevention

#### 6.2 - Signing

##### 6.2.1 - Road Posting (10/20)

The Purchaser is responsible for posting and maintaining caution signs on the access road and old railroad grade prior to beginning operations. The road must be posted at appropriate distances from the Sale Area to warn of logging activity and truck traffic. Signs must be removed when harvest operations are suspended or completed. The Purchaser will provide these signs.

**TIMBER SALE MAP**

This information provided by authority of Part 525, 1994 PA 451, as amended.

Sale Number

**33-024-25**

Date

01/27/2025

Forest Management Unit

Escanaba Mgt Unit

County

Menominee

Mapped By: Beaudou

Cruised By: Salter, Beaudou

Scale

1:15,840

Page

1

Of

1

Township  
37NRange  
28W

Section(s) and

Subdivision(s) Sec. 27 SESW,SWSE; Sec. 34 NW,NWNE,N1/2SW;

**Cover Type**

A = Aspen	J = Jack Pine	O = Oak	U = Upland Brush
B = Paper Birch	K = Rock	P = Lowland Poplar	UM = Upland Mix Forest
C = Cedar	L = Lowland Brush	Q = Mixed Swamp Conifer	V = Bog or Marsh
D = Treed Bog	LM = Lowland Mix Forest	R = Red Pine	W = White Pine
E = Swamp Hardwoods	M = Maple, Beech, Birch	S = Black Spruce	X = Non Stocked
F = Spruce/Fir	MC = Mixed Conifer	T = Tamarack	Y = Sand
G = Grass	MD = Mixed Deciduous	Z = Water	
H = Hemlock	N = Marsh		

**Density**

0 = Non Stocked	5 = Pole Timber Medium
1 = Seedling Sapling Poor	6 = Pole Timber Well
2 = Seedling Sapling Medium	7 = Saw Timber Poor
3 = Seedling Sapling Well	8 = Saw Timber Medium
4 = Pole Timber Poor	9 = Saw Timber Well

Use QR Code to  
open Map in App

Payment Unit Number	Acres	Payment Unit Number	Acres
1	11	4	6.8
2	11	5	18.3
3	13	6	23.5

**Bruised Eye Mix**

Compartment 11

**83.6 Acres****Legend**

- Against State (Red)
- Private Line (Blue)
- Payment Unit (Yellow)
- Primary Forest Road
- Forest Access Route
- 27 Section Number
- County Gravel/Dirt Rd
- Private Gravel/Dirt
- PVT Private Property
- State Land Boundary

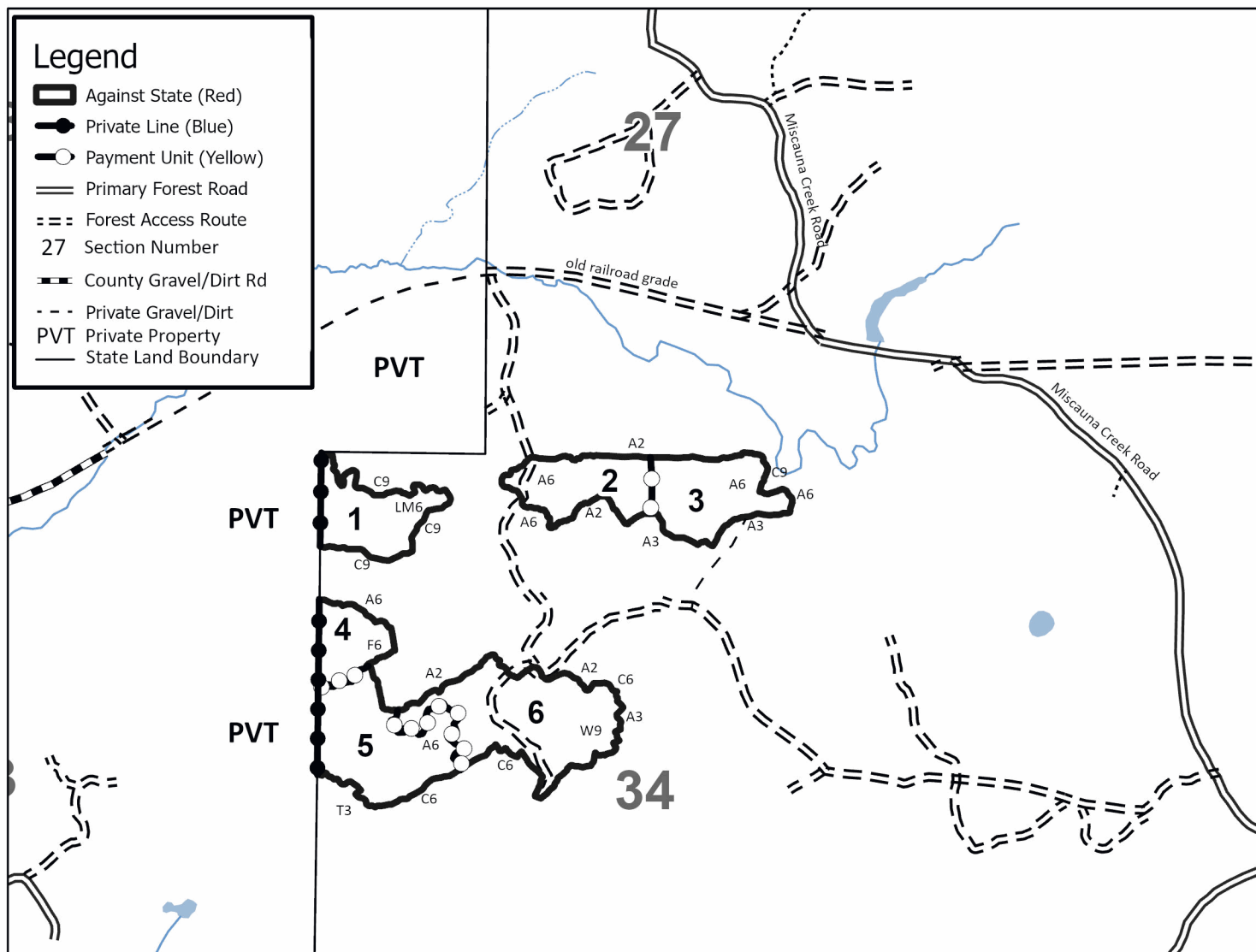

0 0.25 0.5 1 Miles



## TIMBER SALE INFORMATION

Rusty Nelson (33-025-25)

T36N, R24W, SEC. 5; T36N, R24W, SEC. 7; T36N, R24W, SEC. 8.  
Menominee County (Advertised Price \$12,823.10)

**SALE NOTE:** The Purchaser must haul and spread some gravel prior to wood being hauled from Payment Units 4 - 6, see spec 4.1.8 for details. The gravel pit is adjacent to the sale. A large portion of the sale can be harvested during a dry summer.

A timber sale contract for this lump sum, sealed bid timber sale will be awarded to the responsible bidder offering the highest sealed bid price. All units of volume listed below were estimated using the Inventory Manager computer program and the new Michigan taper model. Bids must be at or above the following advertised price for each product and species:

<u>PRODUCTS &amp; SPECIES</u>	<u>ESTIMATED UNITS*</u>	<u>ADVERTISED PRICE</u>
Sawtimber		
Basswood	2.3 MBF	\$ 64.00 / MBF
Paper Birch	1.1 MBF	\$ 81.00 / MBF
Red Maple	7.2 MBF	\$ 101.00 / MBF
Sugar Maple	5.2 MBF	\$ 220.00 / MBF
Yellow Birch	0.6 MBF	\$ 39.00 / MBF
Pulpwood		
Balsam Fir	81 Cords	\$ 8.10 / Cord
Misc. Species 1	290 Cords	\$ 7.50 / Cord
Mixed Hardwood	375 Cords	\$ 15.90 / Cord
Mixed Spruce	123 Cords	\$ 12.30 / Cord
N. White Cedar	52 Cords	\$ 6.45 / Cord
Quaking Aspen	2 Cords	\$ 25.15 / Cord

\* The total volume is statistically estimated within plus (+) or minus (-) 14.62 percent. There are an estimated 962 cords on this timber sale, plus or minus 141 cords at the 95% confidence level. The estimated units are final and not subject to adjustment. Prospective bidders are urged to examine this timber and to make their own estimates of quantity and quality.

### **BOND AND PAYMENT SCHEDULE:**

1. A bond in the amount of \$641.00 to insure faithful performance of the conditions of the contract will be deposited by the successful bidder within 21 days of the sale award.
2. Cutting in any sale or unit without the required advance payment would be considered a trespass.
3. Total payment must be paid in advance or according to the following schedule:
  - (a) Ten percent (10%) of the sale value must be paid within 21 days of the sale award.
  - (b) The 10% down payment will be credited towards the first unit cut.
  - (c) Payment for each of the following units must be made before cutting begins in that unit:

<u>PAYMENT UNIT NUMBER</u>	<u>PERCENT OF TOTAL SALE VALUE</u>
01	16.7%
02	15.0%
03	25.0%
04	11.9%
05	3.5%
06	27.9%

4. If no cutting takes place, the 10% down payment will not be refunded.
5. Operations on the contract issued will terminate on 09/30/2028.

### **SALE STATISTICS**

Volumes were calculated in cubic feet using the Michigan taper model. Cubic foot volume includes all wood inside bark for the product indicated. For display purposes, cubic feet were converted to cords and MBF using a simple conversion factor, e.g. 79 cubic feet per cord and 185 cubic feet per MBF. The cubic foot volumes are precise; the cords and MBF volumes are not. Cubic foot volume cannot be directly converted to cords or boards with precision.

SALE VOLUMES

The total estimated sale volume may not equal the sum of the species/products due to the nature of statistical calculations associated with double sampling methodology.

VOLUME			STATISTICAL RANGE IN CORDS	
TOTAL CUBIC FEET	TOTAL CORDS	PERCENT ERROR	MINIMUM	MAXIMUM
75,995	962	14.62%	821	1,103

VDU VOLUMES

A VDU is a Volume Determination Unit. Volumes and their associated statistics are calculated at the VDU level and summarized to the sale level. There is often a one to one relationship between a VDU and a Payment Unit, but not always, depending on the cruise design. Refer to the VDU TO PAYMENT UNIT table.

	VOLUME			RANGE IN CORDS	
VDU	TOTAL CUBIC FEET	TOTAL CORDS	PERCENT ERROR	MINIMUM	MAXIMUM
50	12,043	152	37.96%	95	210
54	30,752	389	22.55%	301	477
55	4,343	55	56.65%	24	86
57	11,418	145	34.92%	94	195
70	17,438	221	35.68%	142	299
TOTAL:	75,995	962		656	1,268

VDU TO PAYMENT UNIT

When a VDU is associated with more than one Payment Unit (PU), the VDU volumes are assigned to the PU based on acres of the VDU within the PU.

VDU	VDU ACRES	PU	PU ACRES
50	21.2	3	21.2
54	34.7	1	18.1
		2	16.6
55	8.3	5	8.3
57	23.2	4	23.2
70	16.4	6	16.4
TOTAL:	103.8		103.8

**DESCRIPTION OF TIMBER BY PAYMENT UNIT (PU)**

PU	MARKET GROUP	PRODUCT	QUANTITY	UNIT	ACRES	ADVERTISE PRICE
1	Red Maple	Sawtimber	0.5	MBF	18.1	\$2,136.55
	Balsam Fir	Pulpwood	6	Cords		
	Misc. Species 1		107	Cords		
	<i>Black Ash</i>		22	Cords		
	<i>Green Ash</i>		85	Cords		
	Mixed Hardwood		63	Cords		
	<i>Balsam Poplar</i>		37	Cords		
	<i>Ironwood</i>		1	Cords		
	<i>Paper Birch</i>		9	Cords		
	<i>Red Maple</i>		7	Cords		
	<i>Yellow Birch</i>		9	Cords		
	Mixed Spruce		9	Cords		
	<i>Black Spruce</i>		1	Cords		
	<i>White Spruce</i>		8	Cords		
	N. White Cedar		19	Cords		
2	Red Maple	Sawtimber	0.5	MBF	16.6	\$1,925.05
	Balsam Fir	Pulpwood	6	Cords		
	Misc. Species 1		97	Cords		
	<i>Black Ash</i>		20	Cords		
	<i>Green Ash</i>		77	Cords		
	Mixed Hardwood		56	Cords		
	<i>Balsam Poplar</i>		33	Cords		
	<i>Paper Birch</i>		8	Cords		
	<i>Red Maple</i>		7	Cords		
	<i>Yellow Birch</i>		8	Cords		
	Mixed Spruce		8	Cords		
	<i>Black Spruce</i>		1	Cords		
	<i>White Spruce</i>		7	Cords		
	N. White Cedar		17	Cords		
3	Basswood	Sawtimber	0.5	MBF	21.2	\$3,211.10
	Sugar Maple		5.2	MBF		
	Balsam Fir	Pulpwood	3	Cords		
	Misc. Species 1		9	Cords		
	<i>Black Ash</i>		4	Cords		
	<i>Green Ash</i>		5	Cords		
	Mixed Hardwood		115	Cords		
	<i>Basswood</i>		1	Cords		
	<i>Ironwood</i>		1	Cords		
	<i>Sugar Maple</i>		91	Cords		
	<i>White Ash</i>		22	Cords		
	N. White Cedar		10	Cords		
	Quaking Aspen		2	Cords		
4	Balsam Fir	Pulpwood	43	Cords	23.2	\$1,523.40
	Misc. Species 1		14	Cords		
	<i>Black Ash</i>		1	Cords		
	<i>Green Ash</i>		13	Cords		
	Mixed Spruce		87	Cords		
	<i>White Spruce</i>		87	Cords		
5	Balsam Fir	Pulpwood	11	Cords	8.3	\$453.30
	Misc. Species 1		27	Cords		
	<i>Black Ash</i>		4	Cords		
	<i>Green Ash</i>		23	Cords		
	Mixed Spruce		10	Cords		
	<i>White Spruce</i>		10	Cords		
	N. White Cedar		6	Cords		
6	Basswood	Sawtimber	1.8	MBF	16.4	\$3,573.70

**DESCRIPTION OF TIMBER BY PAYMENT UNIT (PU), CON'T**

PU	MARKET GROUP	PRODUCT	QUANTITY	UNIT	ACRES	ADVERTISE PRICE
6 con't	Paper Birch	Sawtimber	1.1	MBF		
	Red Maple		6.2	MBF		
	Yellow Birch		0.6	MBF		
	Balsam Fir		12	Cords		
	Misc. Species 1		36	Cords		
	Green Ash		36	Cords		
	Mixed Hardwood		141	Cords		
	Balsam Poplar		3	Cords		
	Basswood		22	Cords		
	Ironwood		3	Cords		
	Paper Birch		26	Cords		
	Red Maple		67	Cords		
	Sugar Maple		2	Cords		
	White Ash		15	Cords		
	Yellow Birch		3	Cords		
	Mixed Spruce		9	Cords		
	White Spruce		9	Cords		
TOTAL:			16.4	MBF		
TOTAL:			923	Cords		



## Sale Specific Conditions & Requirements

**Sale Name: Rusty Nelson**

**Sale Number: 33-025-25 Seq#: 1**

### 1 - Sale Area

#### 1.2 - Boundaries

##### 1.2.1 - Painted Boundaries (9/19)

The sale boundary and Payment Unit boundaries are marked and identified by blue, red and yellow paint. Exterior sale boundary lines against private property are marked with blue paint. Exterior sale boundary lines against state are marked with red paint. Interior Payment Unit boundaries are marked with yellow paint. Retention patches are marked with red paint; no harvesting activities may occur within these areas. The painted boundary line trees are not Included Timber and are to be protected unless marked with orange paint. Yellow painted trees designating an interior Payment Unit boundary are only to be cut when all surrounding Payment Units have been paid for.

### 2 - Timber Specifications

#### 2.1 - Included Timber

##### 2.1.1 - Clearcut Unit(s) with Unmerchantable Trees (6/14)

Within Payment Unit(s) 1, 2, and 5, cut all trees that are three (3) inches or more at DBH, with the following exceptions:

- Within Payment Units 1 and 2, do not cut any hemlock. In addition, do not cut any cedar that is 15 inches or more at DBH. Furthermore, do not cut any birch or maple that are six (6) inches or less at DBH. Also, do not cut any trees marked with green paint.

##### 2.1.2 - Clearcut Unit(s) w/o Unmerchantable Trees (8/11)

Within Payment Unit(s) 4, cut all balsam fir and spruce trees which meet minimum piece specifications in 2.2 Utilization. In addition, cut all ash that is six (6) inches or more at DBH.

##### 2.1.3 - Cut Tree Marked Unit(s) (12/08)

Within Payment Unit(s) 3, all trees are designated for cutting when marked with orange paint above and below stump height, regardless of merchantability.

In addition, cut all merchantable balsam fir and spruce.

##### 2.1.4 - Designated Timber Unit(s) (6/17)

Within Payment Unit(s) 6, all trees are designated for cutting which meet minimum piece specifications in 2.2 Utilization, except do not cut cedar, hemlock, or white pine. In addition, do not cut trees marked with green paint.

##### 2.1.9 - Harvest Exception (12/24)

Do not cut any cedar trees within Payment Unit 6, other than those that are necessary to remove in order to operate within the Sale Area. Every effort must be made to preserve the existing cedar and to leave an intact stand upon sale completion. All cut cedar shall be piled separately by product and scaled in the woods, unless other scaling arrangements are agreed to by the Unit Manager or his/her representative. Stumpage price for cedar shall be \$30.00 per cord.

##### 2.1.11 - Description of Timber Note (2/04)

Note that Miscellaneous Species 1 is a mix of green and black ash logs, bolts, and pulp. The ash is in various states of decline due to the emerald ash borer.

#### 2.2 - Utilization

##### 2.2.4 - Skidding Length (12/24)

Skidding of unlimbed tops or lengths over 17 feet is not permissible within Payment Unit 3.

### 3 - Payments

#### 3.3 - Pre-measured Sales

##### 3.3.4 - Dividing Payment Units (7/14)

Payment Unit(s) may be divided at the request of the Purchaser and upon approval of the Unit Manager. Dividing Payment Units is a contract modification which requires a Timber Sale Contract Amendment. There will be only one division per Payment Unit.

## **4 - Transportation**

### **4.1 - Construction**

#### **4.1.8 - Road Work (1) (8/07)**

The following road work is required: The Purchaser must haul and spread a minimum of 100 cubic yards of gravel on the access road running through Payment Unit 4. Portions of the this road will also need to be shaped up, prior to using it. All required road work will need to be completed, prior to any hauling from Payment Units 4 - 6. Gravel is available from a state pit on the north side of Payment Unit 3.

The Purchaser will also need to use/place crane mats over the large culverts between Payment Units 4 and 6, prior to skidding or hauling over the culverts. Crane mats will also be needed to cross a small drain between Payment 4 and the north end of Payment Unit 6, as shown on the Timber Sale Map.

### **4.2 - Maintenance**

#### **4.2.1 - Hauling Restriction (12/08)**

Hauling may be restricted on forest roads by the Unit Manager or his/her representative. The restriction may occur during spring breakup or during other wet weather conditions.

#### **4.2.4 - Grading (10/16)**

For completion of the sale, state forest roads must be graded. In general, this will require a road grader or bulldozer to shape up the roads after forest products have been hauled off site. This includes cleaning of drainage areas, grading, crowning and filling with gravel, if necessary. The grading equipment to be used must be approved by the Unit Manager or his/her representative.

## **5 - Operations**

### **5.2 - Conduct of Operations**

#### **5.2.3 - Operating Restrictions**

##### **5.2.3.1 - Operating Restrictions (9/11)**

Within Payment Unit(s) 1, 2, and 5, cutting and skidding are limited to the period of December 1 to March 31, unless there is an extended dry or frozen period, and the Sale Administrator allows harvesting during that period of time. This restriction is because of low wet ground within each of the Payment Units. Portions of Payment Units 1 and 2, have areas that can be harvested during a dry summer.

##### **5.2.3.3 - Bark Slippage Restriction (3/09)**

Within Payment Unit(s) 3, unless changed by written agreement, cutting and skidding are not permitted during the period of April 15 to July 15. This restriction is because of bark slippage.

#### **5.2.22 - Operating Caution**

##### **5.2.22.1 - Operating Caution (6/11)**

It is recommended, but not required, that within Payment Unit(s) 4 and 6, cutting and skidding, occur during dry summer or frozen winter conditions. The reason for the recommendation is because each Payment Unit has a few lower areas that need to be dry or frozen to harvest.

## **6 - Safety and Fire Prevention**

### **6.2 - Signing**

#### **6.2.1 - Road Posting (10/20)**

The Purchaser is responsible for posting and maintaining caution signs on the North Fox Road prior to beginning operations. The road must be posted at appropriate distances from the Sale Area to warn of logging activity and truck traffic. Signs must

be removed when harvest operations are suspended or completed. The Purchaser will provide these signs.

## **7 - Other Conditions**

### **7.5 - Loss**

#### **7.5.1 - Deteriorating Timber (7/09)**

The Sale Area has received damage from the emerald ash borer and the spruce budworm. The Purchaser should harvest the wood as soon as possible. The Department of Natural Resources is held free of responsibility of any further damage or deterioration due to delay in harvesting.



**TIMBER SALE MAP**

This information provided by authority of Part 525, 1994 PA 451, as amended.

Sale Number

**33-025-25**

Date

**02/14/2025**

Forest Management Unit

Escanaba Mgt Unit

County

Menominee

Mapped By: Beaudou

Cruised By: Beaudou

Scale

**1:15,840**

Page

**1**

Of

**1**

Township  
36N

Range  
24W

Section(s) and

Subdivision(s) Sec. 5 SESW,SWSE; Sec. 7 SENE,E1/2SE; Sec. 8 NW,NWSW;

**Cover Type**

A = Aspen	J = Jack Pine	O = Oak	U = Upland Brush
B = Paper Birch	K = Rock	P = Lowland Poplar	UM = Upland Mix Forest
C = Cedar	L = Lowland Brush	Q = Mixed Swamp Conifer	V = Bog or Marsh
D = Treed Bog	LM = Lowland Mix Forest	R = Red Pine	W = White Pine
E = Swamp Hardwoods	M = Maple, Beech, Birch	S = Black Spruce	X = Non Stocked
F = Spruce/Fir	MC = Mixed Conifer	T = Tamarack	Y = Sand
G = Grass	MD = Mixed Deciduous	Z = Water	
H = Hemlock	N = Marsh		

**Density**

0 = Non Stocked	5 = Pole Timber Medium
1 = Seedling Sapling Poor	6 = Pole Timber Well
2 = Seedling Sapling Medium	7 = Saw Timber Poor
3 = Seedling Sapling Well	8 = Saw Timber Medium
4 = Pole Timber Poor	9 = Saw Timber Well

Payment Unit Number	Acres	Payment Unit Number	Acres
1	18.1	4	23.2
2	16.6	5	8.3
3	21.2	6	16.4

**Rusty Nelson**

Compartment 37

**103.8 Acres**

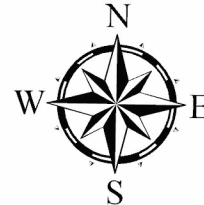

Use QR Code to  
open Map in App

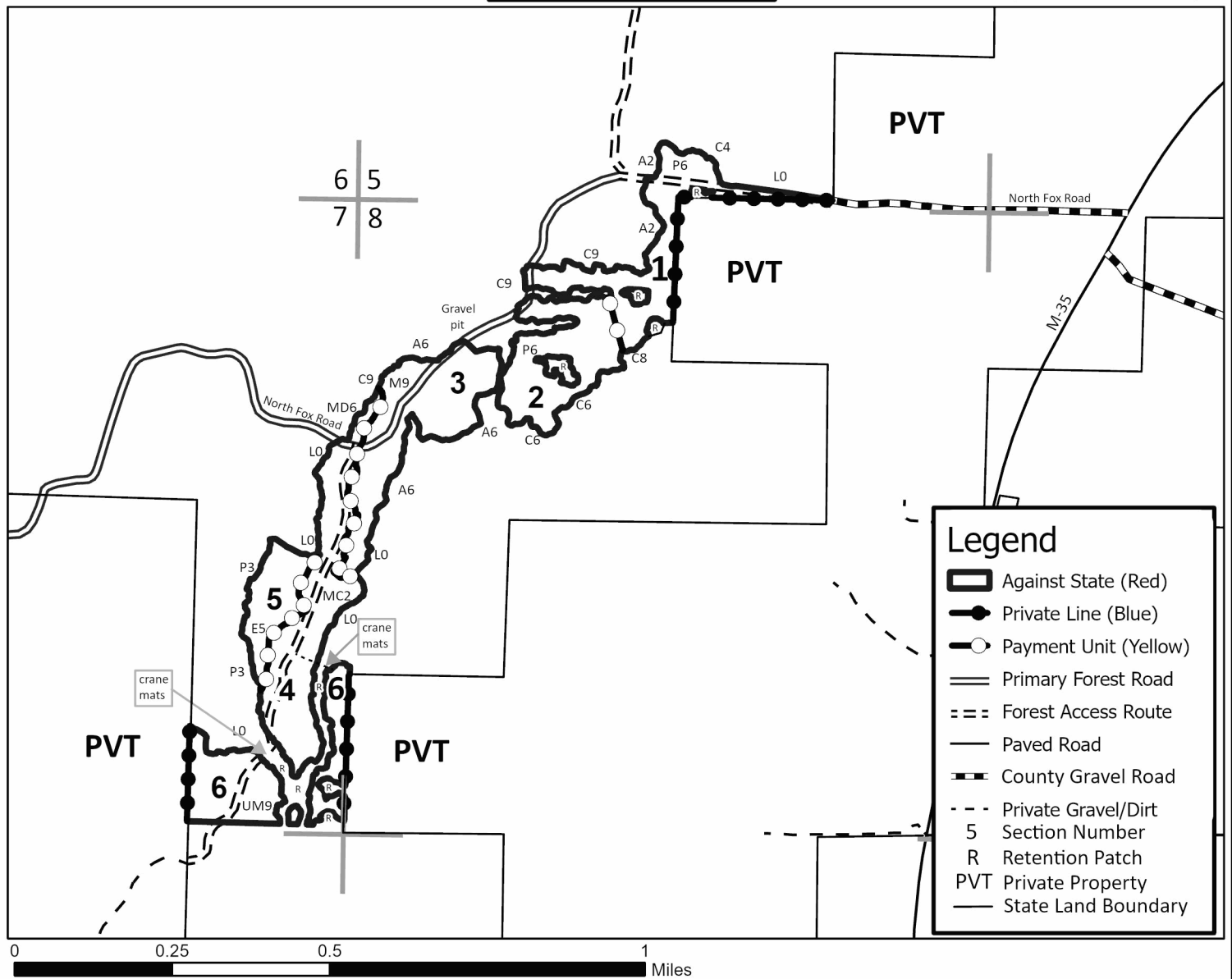

Bruised Eye Mix (33-024-25)  
T37N, R28W, SEC. 27; T37N, R28W, SEC. 34; Menominee COUNTY

In response to the notice of sale to be held 3:00 p.m. (local time) on July 16, 2025, I am hereby submitting my sealed bid ( firm offer) for the following forest products to be cut. Bids for individual species must be at or above the advertised price. All non-responsive bid forms may be rejected.

<u>PRODUCTS &amp; SPECIES</u>	<u>ESTIMATED VOLUME*</u>	<u>ADVERTISED PRICE</u>	<u>BID PRICE/UNIT</u>
Sawtimber			
Red Oak	3.9 MBF	\$ 150.00/MBF	\$ _____
Pulpwood			
Balsam Fir	96 Cords	\$ 8.10/Cord	\$ _____
Mixed Aspen	814 Cords	\$ 25.15/Cord	\$ _____
Mixed Hardwood	134 Cords	\$ 15.90/Cord	\$ _____
Mixed Spruce	37 Cords	\$ 12.30/Cord	\$ _____
N. White Cedar	6 Cords	\$ 6.45/Cord	\$ _____
Red Pine	20 Cords	\$ 67.85/Cord	\$ _____
Tamarack	5 Cords	\$ 9.70/Cord	\$ _____
White Pine	233 Cords	\$ 15.85/Cord	\$ _____

\*The volumes are statistically estimated within plus (+) or minus (-) 18.85 percent at 95% confidence level. These estimated volumes are final and not subject to adjustment. Prospective bidders are urged to examine this timber and to make their own estimates of quantity and quality.

I understand that any or all bids may be rejected. All bids must be signed and all bid items must be bid or the bid form may be rejected. I also understand that consideration and awarding a contract will be based upon my past performance and ability to complete the contract based upon equipment and staffing subject to my control .

FEDERAL ID: \_\_\_\_ - \_\_\_\_ - \_\_\_\_ or SOCIAL SECURITY NUMBER: \_\_\_\_ - \_\_\_\_ - \_\_\_\_

Company or individual bidding: \_\_\_\_\_

Company representative's name: \_\_\_\_\_

Address: \_\_\_\_\_

City: \_\_\_\_\_ State: \_\_\_\_\_ Zip: \_\_\_\_\_

IF AVAILABLE, PLEASE PLACE THE PERSONALIZED LABEL FROM YOUR PROSPECTUS IN THE ABOVE BOX.

Individual or company representative's signature: \_\_\_\_\_ Date: \_\_\_\_\_

Phone number : \_\_\_\_\_ Email (optional): \_\_\_\_\_

**THE WINNING BIDDER MUST COMPLETE THE VERIFICATION OF WORKER'S DISABILITY COMPENSATION ACT  
COMPLIANCE (ON REVERSE SIDE IF DOUBLE SIDED) WITHIN 21 DAYS OF SALE AWARD DATE**



## TIMBER SALE VERIFICATION OF WORKER'S DISABILITY COMPENSATION ACT COMPLIANCE

As required by Act 317, P.A. 1969 (Worker's Compensation) and  
Part 5 of Act 451 of 1994, as amended.

### FOR DEPARTMENT USE ONLY

Sale Number (XX - XXX - XX - XX)

Forest Management Unit:

### VERIFICATION OF WORKER'S DISABILITY COMPENSATION ACT COMPLIANCE

- This verification must be completed and submitted within 21 days of contract award and prior to the issuance of the timber sale contract.
- In addition, if boxes 2B or 2C are checked, then Notice of Exclusion or Certificate of Insurance must be submitted within twenty-one (21) days of the contract award and prior to the issuance of the timber sale contract.
- All information must be typed or printed except for written signatures.

Please Check Appropriate Categories:

1. My business is organized as (you **must** check one of the boxes below):
  - A. ☐ Sole Proprietorship (individual)
  - B. ☐ Partnership
  - C. ☐ Corporation
2. You **must** check one of the boxes below:
  - A. ☐ I certify my business is a sole proprietorship and it has no employees but the sole proprietor. I am not subject to the Worker's Compensation Laws.
  - B. ☐ I certify my business has satisfied its obligation to the Worker's Compensation Act through the use of an approved Notice of Exclusion (BWC-337, Rev. 5/96). I will provide a copy of the Notice of Exclusion within 21 days of the contract award. (For questions or a copy of the BWC-337, please call the Worker's Compensation Bureau at 517-322-1195).
  - C. ☐ I certify my business has a Worker's Compensation Policy. I will provide an original Certificate of Insurance within twenty-one (21) days of the contract award.
3. If you have checked item 2(A) or 2(B), you **must** indicate the number of **both** full-time and part-time employees, other than yourself, including family members and active partners (if none, you must enter "0").

\_\_\_\_\_ Full-time Employees

\_\_\_\_\_ Part-time Employees

Name of Business		Federal ID (or) Social Security No.
Address		Telephone (       )
City	State	ZIP

*I hereby certify that the above information is true and correct. I agree to notify the Michigan DNR of any changes that occur in factors affecting my coverage during any of my present and future operations.*

\_\_\_\_\_  
Signature of Owner or Authorized Representative

\_\_\_\_\_  
Title

\_\_\_\_\_  
Date

Please complete the "SEALED BID" information on the next page

Rusty Nelson (33-025-25)

T36N, R24W, SEC. 5; T36N, R24W, SEC. 7; T36N, R24W, SEC. 8; Menominee

In response to the notice of sale to be held 3:00 p.m. (local time) on July 16, 2025, I am hereby submitting my sealed bid ( firm offer) for the following forest products to be cut. Bids for individual species must be at or above the advertised price. All non-responsive bid forms may be rejected.

<u>PRODUCTS &amp; SPECIES</u>	<u>ESTIMATED VOLUME*</u>	<u>ADVERTISED PRICE</u>	<u>BID PRICE/UNIT</u>
<b>Sawtimber</b>			
Basswood	2.3 MBF	\$ 64.00/MBF	\$ _____
Paper Birch	1.1 MBF	\$ 81.00/MBF	\$ _____
Red Maple	7.2 MBF	\$ 101.00/MBF	\$ _____
Sugar Maple	5.2 MBF	\$ 220.00/MBF	\$ _____
Yellow Birch	0.6 MBF	\$ 39.00/MBF	\$ _____
<b>Pulpwood</b>			
Balsam Fir	81 Cords	\$ 8.10/Cord	\$ _____
Misc. Species 1	290 Cords	\$ 7.50/Cord	\$ _____
Mixed Hardwood	375 Cords	\$ 15.90/Cord	\$ _____
Mixed Spruce	123 Cords	\$ 12.30/Cord	\$ _____
N. White Cedar	52 Cords	\$ 6.45/Cord	\$ _____
Quaking Aspen	2 Cords	\$ 25.15/Cord	\$ _____

\*The volumes are statistically estimated within plus (+) or minus (-) 14.62 percent at 95% confidence level. These estimated volumes are final and not subject to adjustment. Prospective bidders are urged to examine this timber and to make their own estimates of quantity and quality.

I understand that any or all bids may be rejected. All bids must be signed and all bid items must be bid or the bid form may be rejected. I also understand that consideration and awarding a contract will be based upon my past performance and ability to complete the contract based upon equipment and staffing subject to my control .

FEDERAL ID: \_\_\_\_\_ or SOCIAL SECURITY NUMBER: \_\_\_\_\_

Company or individual bidding: \_\_\_\_\_

Company representative's name: \_\_\_\_\_

Address: \_\_\_\_\_

City: \_\_\_\_\_ State: \_\_\_\_\_ Zip: \_\_\_\_\_

IF AVAILABLE, PLEASE PLACE THE PERSONALIZED LABEL FROM YOUR PROSPECTUS IN THE ABOVE BOX.

Individual or company representative's signature: \_\_\_\_\_ Date: \_\_\_\_\_

Phone number : \_\_\_\_\_ Email (optional): \_\_\_\_\_

**THE WINNING BIDDER MUST COMPLETE THE VERIFICATION OF WORKER'S DISABILITY COMPENSATION ACT  
COMPLIANCE (ON REVERSE SIDE IF DOUBLE SIDED) WITHIN 21 DAYS OF SALE AWARD DATE**



## TIMBER SALE VERIFICATION OF WORKER'S DISABILITY COMPENSATION ACT COMPLIANCE

As required by Act 317, P.A. 1969 (Worker's Compensation) and  
Part 5 of Act 451 of 1994, as amended.

### FOR DEPARTMENT USE ONLY

Sale Number (XX - XXX - XX - XX)

Forest Management Unit:

### VERIFICATION OF WORKER'S DISABILITY COMPENSATION ACT COMPLIANCE

- This verification must be completed and submitted within 21 days of contract award and prior to the issuance of the timber sale contract.
- In addition, if boxes 2B or 2C are checked, then Notice of Exclusion or Certificate of Insurance must be submitted within twenty-one (21) days of the contract award and prior to the issuance of the timber sale contract.
- All information must be typed or printed except for written signatures.

Please Check Appropriate Categories:

1. My business is organized as (you **must** check one of the boxes below):
  - A. ☐ Sole Proprietorship (individual)
  - B. ☐ Partnership
  - C. ☐ Corporation
2. You **must** check one of the boxes below:
  - A. ☐ I certify my business is a sole proprietorship and it has no employees but the sole proprietor. I am not subject to the Worker's Compensation Laws.
  - B. ☐ I certify my business has satisfied its obligation to the Worker's Compensation Act through the use of an approved Notice of Exclusion (BWC-337, Rev. 5/96). I will provide a copy of the Notice of Exclusion within 21 days of the contract award. (For questions or a copy of the BWC-337, please call the Worker's Compensation Bureau at 517-322-1195).
  - C. ☐ I certify my business has a Worker's Compensation Policy. I will provide an original Certificate of Insurance within twenty-one (21) days of the contract award.
3. If you have checked item 2(A) or 2(B), you **must** indicate the number of **both** full-time and part-time employees, other than yourself, including family members and active partners (if none, you must enter "0").

\_\_\_\_\_ Full-time Employees

\_\_\_\_\_ Part-time Employees

Name of Business		Federal ID (or) Social Security No.
Address		Telephone (       )
City	State	ZIP

*I hereby certify that the above information is true and correct. I agree to notify the Michigan DNR of any changes that occur in factors affecting my coverage during any of my present and future operations.*

\_\_\_\_\_  
Signature of Owner or Authorized Representative

\_\_\_\_\_  
Title

\_\_\_\_\_  
Date

Please complete the "SEALED BID" information on the next page