



**DEPARTMENT OF NATURAL RESOURCES
STATE OF MICHIGAN
TIMBER SALE PROSPECTUS #7602**

SCHEDULED SALE DATE AND TIME: **9:00 a.m. (local time) on March 24, 2025.**

LOCATION: **GRAYLING MGMT UNIT, 1955 HARTWICK PINES ROAD, GRAYLING, MI 49738.**

PROSPECTUS NOTE: The bidder is advised to inspect the sale area and review the location, estimated volumes, operating costs and contract terms of proposed sales. Please be aware that some landowners may request 60 days or more notice for access across their land.

Notice is hereby given that bids will be received by the Unit Manager, GRAYLING MANAGEMENT UNIT, for certain timber on the following described lands:

Red Shouldered Pine Re-Do (72-004-25) / T28N, R03W, SEC. 31, S1/2NW,SW.
T28N, R03W, SEC. 33, E1/2NE,NESE.
Crawford County, Advertised Price \$57,250.35, 76.9 Acres, Red Pine.

SALE NOTE: Timber sale contains bark beetle and bark slippage restrictions .

Payment Unit 3 is a mortality pocket where all red pine (dead and alive) must be cut and removed regardless of merchantability.

No operations are to take place from March 15-July 15 within Payment Unit 4 due to the presence of a hawk nest.

Opening adjacent to Payment Unit 1 as show on timber sale map must be protected and may not be used for a landing.

If opertions take place along pipeline east of Payment Unit 1, contact DTE at (231) 258-3750.

An adjacent landowner uses the road through Payment Unit 1 for access year-round and maintains the road through an existing easement. This road must be maintained in 2-wheel drive condition and remain open throughout the duration of the contract.

Little Shop of Borers (72-601-25) / T27N, R01W, SEC. 7 , NENE,S1/2SE.
T27N, R01W, SEC. 8 , NWNW,S1/2NW,NWSW,SESW,SWSE.
Crawford County, Advertised Price \$90,941.40, 94.7 Acres, Red Pine, Jack Pine.

SALE NOTE: This sale falls on National Guard long-term lease lands and is subject to training restrictions and is non-certified. Furthermore, this sale must be chipped for this reason as well as for follow up planting operations. Payment Unit 3 is an applied raptor nest buffer that may be dropped if deemed active by the unit biologist. This contract is for two years and will not allow for extensions due to planting schedules.

Choppenheimer (72-620-24) / T28N, R02W, SEC. 10, E1/2NW,NE,NESW,NWSE.
Crawford County, Advertised Price \$56,366.90, 92.6 Acres, Aspen, Hardwood.

SALE NOTE: Please take note that this sale is on military land and that oak wilt specs apply. Oak wilt is being taken into consideration due to residual oak within the sale and oak component in adjacent stands. Due to these reasons, there is a 3 year contract to accommodate.

Raiders of the Lost Bark (72-626-24) / T28N, R02W, SEC. 11, SENE,E1/2SE.

T28N, R02W, SEC. 14, NENE.

Crawford County, Advertised Price \$76,031.40, 61.1 Acres, Hardwood, Red Oak.

SALE NOTE: This sale is on military lands, has potential operability concerns due to steep slope, and oak wilt restrictions. Sale contains soft oak wilt spec 5.2.3.5 however, the DNR may deny any requests to operate during the restricted time frame. Accommodating these issues by utilizing a 3 year contract. No chipping of tops and limbs will be allowed to assist with reforestation and slope protection. Sale minimum bid price was reduced to account for potential areas of inoperability; therefore, there will be no volume or acreage adjustments, nor will there be any penalties for failing to uncut timber.

Missin' Merle Mix (72-630-24) / T28N, R02W, SEC. 29, W1/2NW,NWSW.

T28N, R02W, SEC. 30, S1/2NW,SENE,N1/2SW,N1/2SE,SWSE.

Crawford County, Advertised Price \$48,190.65, 89.2 Acres, Hardwood, Red Pine.

SALE NOTE: Timber/composite mats required if trucking wood from Payment Unit 3 due to road crossing through lowland drain. Corduroyed slash may be used if skidding wood from Payment Unit 3 into Payment Unit 4 with Sale Administrator approval. Material must be cleaned out of drain and left rut free after wood has been skidded out.

Sale not on certified land. Military land, chipping required, contains standard military specs. Contract has 4-year duration due to military timing restrictions. Soft Oak wilt timing restrictions applied for Payment Units 3-5 however, the DNR may deny any requests to operate during the restricted time frame.

Up In Smoak (72-631-24) / T28N, R02W, SEC. 28, NW,N1/2SW,SESW.

T28N, R02W, SEC. 29, E1/2NE,NESE.

Crawford County, Advertised Price \$96,985.85, 156.9 Acres, Hardwood, White Pine.

SALE NOTE: Sale not on certified land. Military land, chipping required, contains standard military specs. Contract has 4 year duration due to military timing restrictions. Soft Oak wilt timing restrictions applied for Payment Units 1-8, however, the DNR may deny any requests to operate during the restricted time frame. Stick nest located in Payment Unit 3 during layout. If the biologist finds nest to be active, Payment Unit 3 will be removed from the Sale Area. An additional 5 chain timing restricted zone around the nest will be implemented in Payment Unit 3 where no operations can take place between March 15 and July 15.

BID INSTRUCTIONS (VER. 10/10/2022):

1. Scheduled Bid Location, Date, and Time (2/11)

Bids must be received by the Unit Manager, GRAYLING OFFICE, 1955 HARTWICK PINES ROAD, GRAYLING, MI 49738, no later than 9:00 a.m. (local time) on March 24, 2025. For further information concerning this sale, contact Scott McClarren at 989-348-6371 extension .

2. Bidder's Qualifications (10/22)

If all or part of a timber sale was prepared by a private contractor, the contractor and that contractor's company are not permitted to bid on the timber sale. A person must be 18 years of age or older to purchase timber. Permanent employees of the Department of Natural Resources or members of their immediate household may not bid. Former employees, in the permanent or seasonal class, may not bid until 3 months after the last day of active duty. Bids will not be accepted from individuals or companies appearing on the DNR/FRD No-Bid List. This list contains the names of purchasers who previously failed to execute a contract within 21-days or who have a history of poor performance.

3. Preparation of Sealed Bids (5/16)

Bid Forms may be completed online thru Michigan DNR Timber Sale Online Bidding (OLB) at www.michigan.gov/timberbidding or by completing the hardcopy Bid Form found in the Timber Sale Prospectus . Hardcopy Bid Forms shall be manually signed in ink. Registration in OLB is considered your 'signature' for all bids submitted thru that system. Bid prices must be entered for each species and product in the Bid Price column for all material subject to bidding and all fill-in blanks must be completed. If erasures or other changes appear on the hardcopy Bid Form, each erasure or change must be initialed by the person signing the bid.

4. Submission of Sealed Bids (5/16)

Bid forms may be obtained from the Unit Manager or thru OLB. Bids may be submitted hardcopy or thru OLB. All hardcopy bids must be submitted on the bid form and in an envelope clearly identified as described in this section. NOTE: Only one bid form per bid envelope. Sealed bids must be submitted to the Unit office designated in the prospectus and must be submitted at or prior to the time established in the prospectus. The envelope should show on the outside (a) the sale name or number and (b) the date and time of bid opening, as shown in the prospectus. Bids received after the time specified in the sale prospectus are late bids and will be rejected.

It is possible for a bidder to submit multiple bids on a single sale. For example, a bid may be submitted hardcopy and a bid may be submitted thru OLB. Or, two bidders from the same company could both submit bids on the same sale. If this were to happen, the State would accept all bids received and award the contract accordingly. All bidding and contractual requirements would apply to all bids received.

5. Public Opening of Sealed Bids (7/16)

If conditions permit, the sealed bids will be publicly opened and posted at the time and place set in the prospectus.

If a bidder, present at a bid opening, has submitted bids on more than one sale, that bidder may withdraw their unopened bid envelopes or announce the withdrawal of their online bid after being declared the successful bidder on one sale.

6. Award of Contract (1/11)

Award of the contract will be made to the Bidder whose bid, conforming to the prospectus, is most advantageous to the State of Michigan on the basis of total value at rates bid for the estimated quantities. The State reserves the right to reject any bid or waive any minor irregularity in bids received. A written award mailed (or otherwise furnished) to the successful Bidder shall be deemed to result in a binding contract without further action by either party.

7. Down Payment (1/11)

The Bidder to whom award is made must make a down payment within 21 days of the sale award. The amount of the down payment will be calculated as shown in the Bond and Payment Schedule of this prospectus. Only cash may be used to meet this requirement.

8. Performance Security (1/11)

As guarantee of faithful performance, a cash bond, certificate of deposit, surety bond or irrevocable letter of credit (LOC) is required within 21 days of the sale award. The amount of the performance security is shown in the Bond and

Payment Schedule of this prospectus. If an LOC or surety is used, the coverage must extend for at least 6 months beyond the contract expiration.

9. Worker's Compensation (10/22)

Purchaser shall obtain worker's compensation insurance to cover claims under Michigan's Worker's Disability Compensation Act of 1969 or similar employee benefit act of any other state applicable to an employee. Verification of Worker's Disability Compensation Act Compliance must be completed and submitted within 21 days of contract award and prior to the issuance of the timber sale contract. In addition, if applicable, Notice of Exclusion or Certificate of Insurance must also be submitted.

10. Timber Sale Contract (10/22)

Additional conditions and requirements common to all timber sales are listed on the timber sale contract (R4031) and are available on line at www.michigan.gov/timber. Contact the Unit Manager for additional information or a sample contract. Within 21 days of the date of the award letter, the bidder must sign the contract and provide the required down payment, performance security, and verification of worker's disability compensation. The down payment and performance security shall be in accordance with the provisions of the timber sale contract, in the sums stated in this prospectus. If these actions are not taken, then the Bidder, the Bidder's corporation, and the corporation's principals may not be permitted to bid on State timber sales for a period of 3 months after the first offense, 6 months after the second offense, and 1 year after the third offense. An offense will only be counted against the Bidder for 5 years. In addition, the Bidder certifies that if awarded this contract, the Bidder will complete the timber sale contract in accordance with its terms and any modifications thereof including requirements to purchase, cut, and remove the included timber by the expiration date.

Payment Unit values in the State Forest Timber Sale Contract are calculated based on the advertised value of the Payment Unit as a percentage of the total advertised value of the contract. The advertised value of each Payment Unit is given in the Description of Timber by Payment Unit table on the Timber Sale Information page. For example, if the value of Payment Unit 1 is advertised as \$1,500 and the total Timber Sale value is advertised as \$10,000, the contract price for Payment Unit 1 will be 15% of the total bid price ($\$1,500/\$10,000 * 100$).

11. Disclaimer of Estimates and Bidder's Warranty of Inspection (10/22)

Before submitting this bid, the Bidder is advised and cautioned to inspect the sale area, review the requirements of the sale contract, and take other steps as may be reasonably necessary to ascertain the location, estimated volumes, construction estimates, and operating costs of the proposed sale. Failure to do so will not relieve the Bidder from responsibility for completing the contract.

The Bidder warrants that this bid is submitted solely on the basis of the Bidder's examination and inspection of the quality and quantity of the timber offered for sale and the Bidder's opinion of the value thereof and the costs of recovery. No reliance should be placed on the State of Michigan's estimates of timber quality, quantity or costs of recovery. Bidder further acknowledges that the State of Michigan: (i) expressly disclaims any warranty of fitness of timber for any purpose; (ii) offers this timber as is without any warranty of quality (merchantability) or quantity and (iii) expressly disclaims any warranty as to the quantity or quality of timber sold.

12. Certification and Chain-of-Custody (10/22)

Unless otherwise indicated in the contract under section 7 – Other Conditions of the Sale Specific Conditions & Requirements, the area encompassed by this timber sale is certified to the standards of the Forest Stewardship Council (FSC) - Certificate #SCS-FM/COC-00090N and the Sustainable Forestry Initiative (SFI) - Certificate #NSF-SFIS-5Y031-SF5. Forest products from this sale may be delivered to the mill as "FSC 100% and / or SFI certified" as long as the contractor hauling the forest products is chain-of-custody (COC) certified or covered under a COC certificate from the destination mill. The purchaser is responsible for maintaining COC after leaving the sale area.

13. Good Neighbor Authority (GNA) Requirements (10/22)

If the name of this timber sales contains the acronym GNA, it is authorized by the Good Neighbor Authority (GNA) and covered by various agreements between the U.S. Forest Service and the State. The timber sale occurs on federal land and the following conditions apply:

GNA contracts on US Forest Service land will not be awarded to purchasers on the Federal list of excluded parties. The System for Award Management (SAM) will be checked for active excluded parties prior to award of contract. In

addition, the Bidder to whom award is made must complete an Assurance Regarding Felony Conviction or Tax Delinquent Status for Corporate Applicants (AD-3031).

14. Good Neighbor Authority (GNA) Requirements, con't (10/22)

Bidder certifies, by signing this bid form, that to the best of Bidder's knowledge that the following representations are accurate and complete.

- a. That the Bidder and its principals are not presently debarred, suspended, proposed for debarment, declared ineligible, or voluntary excluded from timber sales (covered transactions) by any Federal department or agency.
- b. That the Bidder and its principals have not within a 3-year period preceding this bid been convicted of or had a civil judgment rendered against them for commission of fraud or a criminal offense in connection with obtaining , attempting to obtain, or performing a public (Federal, State, or local) transaction or contract under a public transaction; violation of Federal or State antitrust statutes or commission of embezzlement, theft, forgery, bribery, falsification or destruction of records, making false statements, or receiving stolen property.
- c. That the Bidder and its principals are not presently indicted for or otherwise criminally or civilly charged by a governmental entity (Federal, State, or local) with commission of any of the offenses enumerated in paragraph b of this certification.
- d. That the Bidder and its principals have not within a 3-year period preceding this bid had one or more public transactions (Federal, State, or local) terminated for breach or default of a timber or forest product contract.

Bidders that cannot certify this requirement, in whole or in part, shall submit an explanation with their bid.

Scott Bowen
Director

TIMBER SALE INFORMATION

Red Shouldered Pine Re-Do (72-004-25)
 T28N, R03W, SEC. 31; T28N, R03W, SEC. 33.
 Crawford County (Advertised Price \$57,250.35)

SALE NOTE: Timber sale contains bark beetle and bark slippage restrictions .

Payment Unit 3 is a mortality pocket where all red pine (dead and alive) must be cut and removed regardless of merchantability.

No operations are to take place from March 15-July 15 within Payment Unit 4 due to the presence of a hawk nest.

Opening adjacent to Payment Unit 1 as show on timber sale map must be protected and may not be used for a landing.

If operations take place along pipeline east of Payment Unit 1, contact DTE at (231) 258-3750.

An adjacent landowner uses the road through Payment Unit 1 for access year-round and maintains the road through an existing easement. This road must be maintained in 2-wheel drive condition and remain open throughout the duration of the contract.

A timber sale contract for this lump sum, sealed bid timber sale will be awarded to the responsible bidder offering the highest sealed bid price. All units of volume listed below were estimated using the Inventory Manager computer program and the new Michigan taper model. Bids must be at or above the following advertised price for each product and species:

<u>PRODUCTS & SPECIES</u>	<u>ESTIMATED UNITS*</u>	<u>ADVERTISED PRICE</u>
Pulpwood		
Red Pine	1,189 Cords	\$ 48.15 / Cord

* The total volume is statistically estimated within plus (+) or minus (-) 14.31 percent. There are an estimated 1,189 cords on this timber sale, plus or minus 170 cords at the 95% confidence level. The estimated units are final and not subject to adjustment. Prospective bidders are urged to examine this timber and to make their own estimates of quantity and quality.

BOND AND PAYMENT SCHEDULE:

1. A bond in the amount of \$2,863.00 to insure faithful performance of the conditions of the contract will be deposited by the successful bidder within 21 days of the sale award.
 2. Cutting in any sale or unit without the required advance payment would be considered a trespass.
 3. Total payment must be paid in advance or according to the following schedule :
 - (a) Ten percent (10%) of the sale value must be paid within 21 days of the sale award.
 - (b) The 10% down payment will be credited towards the first unit cut.
 - (c) Payment for each of the following units must be made before cutting begins in that unit:
- | PAYMENT UNIT NUMBER | PERCENT OF TOTAL SALE VALUE |
|---------------------|-----------------------------|
| 01 | 53.7% |
| 02 | 22.8% |
| 03 | 6.3% |
| 04 | 17.2% |
4. If no cutting takes place, the 10% down payment will not be refunded.
 5. Operations on the contract issued will terminate on 09/30/2026.

SALE STATISTICS

Volumes were calculated in cubic feet using the Michigan taper model. Cubic foot volume includes all wood inside bark for the product indicated. For display purposes, cubic feet were converted to cords and MBF using a simple conversion factor, e.g. 79 cubic feet per cord and 185 cubic feet per MBF. The cubic foot volumes are precise; the cords and MBF volumes are not. Cubic foot volume cannot be directly converted to cords or boards with precision.

SALE VOLUMES

The total estimated sale volume may not equal the sum of the species/products due to the nature of statistical calculations associated with double sampling methodology.

VOLUME			STATISTICAL RANGE IN CORDS	
TOTAL CUBIC FEET	TOTAL CORDS	PERCENT ERROR	MINIMUM	MAXIMUM
93,946	1,189	14.31%	1,019	1,359

VDU VOLUMES

A VDU is a Volume Determination Unit. Volumes and their associated statistics are calculated at the VDU level and summarized to the sale level. There is often a one to one relationship between a VDU and a Payment Unit, but not always, depending on the cruise design. Refer to the VDU TO PAYMENT UNIT table.

VDU	VOLUME		PERCENT ERROR	RANGE IN CORDS	
	TOTAL CUBIC FEET	TOTAL CORDS		MINIMUM	MAXIMUM
8	50,384	638	18.32%	521	755
37	37,669	477	24.26%	361	592
38	5,894	75	75.82%	18	131
TOTAL:	93,946	1,189		900	1,478

VDU TO PAYMENT UNIT

When a VDU is associated with more than one Payment Unit (PU), the VDU volumes are assigned to the PU based on acres of the VDU within the PU.

VDU	VDU ACRES	PU	PU ACRES
8	42.9	1	42.9
37	32.6	2	18.5
37	32.6	4	14.1
38	1.4	3	1.4
TOTAL:	109.5		76.9

DESCRIPTION OF TIMBER BY PAYMENT UNIT (PU)

PU	MARKET GROUP	PRODUCT	QUANTITY	UNIT	ACRES	ADVERTISE PRICE
1	Red Pine	Pulpwood	638	Cords	42.9	\$30,719.70
	<i>Red Pine</i>		638	<i>Cords</i>		
2	Red Pine	Pulpwood	271	Cords	18.5	\$13,048.65
	<i>Red Pine</i>		270	<i>Cords</i>		
	<i>Scotch Pine</i>		1	<i>Cords</i>		
3	Red Pine	Pulpwood	75	Cords	1.4	\$3,611.25
	<i>Red Pine</i>		75	<i>Cords</i>		
4	Red Pine	Pulpwood	205	Cords	14.1	\$9,870.75
	<i>Red Pine</i>		205	<i>Cords</i>		
TOTAL:			1,189	Cords		

Sale Specific Conditions & Requirements

Sale Name: Red Shouldered Pine Re-Do

Sale Number: 72-004-25 Seq#: 1

1 - Sale Area

1.2 - Boundaries

1.2.1 - Painted Boundaries (9/19)

The sale boundary and Payment Unit boundaries are marked and identified by blue, red and purple paint. Exterior sale boundary lines against private property are marked with blue paint. Exterior sale boundary lines against state are marked with red paint except for a portion of Payment Unit 4 is identified with purple paint around the 330' stick nest buffer as identified on the Timber Sale Map. Interior Payment Unit boundary for Payment Unit 3 was marked with red X's and the interior Payment Unit boundary for Payment Unit 4 was marked with purple paint as identified on the Timber Sale Map. Retention patches are marked with red paint; no harvesting activities may occur within these areas. The painted boundary line trees are not Included Timber and are to be protected unless marked with orange paint.

2 - Timber Specifications

2.1 - Included Timber

2.1.3 - Cut Tree Marked Unit(s) (12/08)

Within Payment Unit(s) 1, 2, and 4, all trees are designated for cutting when marked with orange paint above and below stump height, regardless of merchantability.

2.1.4 - Designated Timber Unit(s) (6/17)

Within Payment Unit(s) 3, red pine, dead or alive, is designated for cutting, regardless of merchantability.

2.1.11 - Description of Timber Note (2/04)

Note that a minor component of aspen was marked to cut in Payment Unit 1 that was not captured in the cruise volume.

2.2 - Utilization

2.2.3 - Stump Heights (12/24)

Stump heights within the Sale Area shall not exceed six (6) inches for all trees. A written waiver of this requirement may be obtained if wet summer weather makes winter logging necessary.

2.2.5 - Limbed Tree Skidding (12/24)

The skidding of whole trees or tree segments with limbs attached is prohibited, unless approved by the Unit Manager or his/her representative.

3 - Payments

3.3 - Pre-measured Sales

3.3.4 - Dividing Payment Units (7/14)

Payment Unit(s) 1 may be divided at the request of the Purchaser and upon approval of the Unit Manager. Dividing Payment Units is a contract modification which requires a Timber Sale Contract Amendment.

3.4 - Damaged Timber

3.4.1 - Damaged Timber (12/24)

General Condition and Requirement 3.4 Damaged Timber, defines liquidated damages for undesignated live merchantable trees which are cut or injured. In addition, within Payment Unit 3 reasonable care should be taken to avoid damage to tree seedlings and saplings.

No damage is acceptable to undesignated live merchantable trees. Within the Sale Area, if more than 10% of trees (> 4.5" DBH) within a specified area of the sale are damaged, liquidated damages will be assessed for all trees damaged. Rates will be in accordance with General Condition and Requirement 3.4 Damaged Timber.

4 - Transportation

4.1 - Construction

4.1.6 - Road Construction (4/24)

Construction of new roads or improvements of existing roads shall be done in such a way as to minimize the environmental and visual impacts. Merchantable trees shall be cut and utilized unless otherwise directed. Non-merchantable trees shall be severed and laid flat on the ground. Slash shall be scattered, not left in windrows, and kept a minimum of 10 feet back from the road edge. Stumps shall be set upright, not left on edge, and be moved at least 10 feet away from the road edge. Disturbed soil shall be feathered into the woods and not left in berms or windrows.

4.1.7 - Road Closure (10/11)

All new roads built into the sale must be blocked to vehicle traffic upon completion of the sale. Overgrown roads that are reopened shall be considered new roads. In general, this will require constructing a four (4') foot high berm of stumps and logs covered with earth. Stumps and brush must be placed along the remainder of the trail. These roads must be rendered impassable to cars and trucks. All stumps from road building and landing construction must be reserved to block any newly constructed roads upon completion of the sale. These stumps must be scattered along the road system to prohibit vehicular movement. Contact the Sale Administrator for specific details of design and placement.

4.1.11 - Permits (2/12)

The Purchaser will secure any necessary permits that may be required.

4.2 - Maintenance

4.2.5 - Two Wheel Drive Condition (2/04)

All existing trail roads on and adjacent to the Sale Area must be passable by two-wheel drive traffic for the duration of the sale.

5 - Operations

5.1 - Notification

5.1.3 - Well Heads and Natural Gas Pipelines (11/15)

The Purchaser is responsible for contacting the gas or pipeline company prior to operating equipment in the vicinity of well heads or natural gas pipelines. Contact DTE at (231) 258-3750 to coordinate operations if needs to operate within the cleared pipeline corridor on the east edge of Payment Unit 1.

5.2 - Conduct of Operations

5.2.3 - Operating Restrictions

5.2.3.1 - Operating Restrictions (9/11)

Within Payment Unit(s) 4, unless changed by written agreement, cutting, skidding, and hauling are not permitted during the period of March 15 to July 15. This restriction is because an of the presence of an occupied hawk nest.

5.2.3.3 - Bark Slippage Restriction (3/09)

Within Payment Unit(s) 1, 2, and 4, unless approved by the Sale Administrator, cutting and skidding are not permitted during the period of April 15 to July 15. This restriction is because of bark slippage.

5.2.3.6 - Bark Beetle Restriction (1/25)

In the event drought creates a high risk of pine bark beetle infestation, pine is not to be cut during the period March 1 through July 1, unless all portions of trees greater than two (2) inches in diameter are removed from the Sale Area, reduced to chips, or treated to the satisfaction of the Unit Manager or his/her representative, within 15 days of being severed from the stump. Pine log decks, pulpwood piles and treetops that are piled for chipping in the fall or winter within a 1/4 mile of susceptible sites must be removed before March 15. Residual slash must not be placed in piles or rows and must be spread over the site for quick drying. The Department of Natural Resources will exercise this specification if the risk of damage warrants.

5.2.32 - Decking/Landing Restoration (9/13)

All decking and landing areas must have the surface area restored to a condition equal to or better than before. This is to ensure the proper regeneration of the stand. Wood debris, chips and "cookies" from trimmings must be removed or scattered away from landing and loading areas and may not be windrowed on the edge.

5.2.38 - No Decking Against Live Trees (2/04)

Cut products may not be decked against unmarked or designated leave trees.

5.2.43 - Opening Protection (2/21)

No activities are permitted in opening near Payment Unit 1 as identified on the Timber Sale Map. Any damage to the openings shall be repaired according to specifications of the Unit Manager or his/her representative.

5.8 - Protection of Endangered Species

5.8.3 - Red-shouldered Hawk or Goshawk (1) (1/25)

In the event that an active red shoulder hawk or goshawk nest is found, the contract may be amended to protect the nest site until the nest is determined to be inactive. The value of the trees in this excluded area will be refunded or credited to the Purchaser. The nest will be buffered with a five-chain radius (eight acre) protection area, centered on the nest tree, in which there will be no cutting or new roads constructed. Avoid human disturbance, including loading and skidding, in the protection area.

An additional zone of five chains (ten chains centered on the active nest tree) will be established in which there is no management activity from March 15 to July 15. Limit biomass harvesting and chipping operations within this ten-chain zone, retain the maximum one-third of residues per the Woody Biomass Harvesting Guidelines (Michigan DNR 2010). Nests determined to be inactive will be protected with a one-chain no-harvest buffer.

6 - Safety and Fire Prevention

6.2 - Signing

6.2.1 - Road Posting (10/20)

The Purchaser is responsible for posting and maintaining caution signs on County Road 612 and forest roads prior to beginning operations. The road must be posted at appropriate distances from the Sale Area to warn of logging activity and truck traffic. Signs must be removed when harvest operations are suspended or completed. The Purchaser will provide these signs.

7 - Other Conditions

7.2 - Extensions

7.2.4 - Limited Extensions (4/17)

Given justification, only one extension may be granted if the contract has been paid in full. The contract duration is less than 2 years due to the old fading paint, however, justification for an extension is valid if operations are delayed due to raptor timing restrictions in Payment Unit 4. This requires Unit Manager approval.



TIMBER SALE MAP

This information provided by authority of Part 525, 1994 PA 451, as amended.

Sale Number 72-004-25	Date 02/04/2025
Scale 1:7,920	Page 1
	Of 2

Forest Management Unit Grayling Mgt Unit	County Crawford	Mapped By: Derek Nellis
		Cruised By: Scott McClarren

Township 28N	Range 03W	Section(s) and Subdivision(s) Sec. 31 S1/2NW,SW; Sec. 33 E1/2NE,NESE;
-----------------	--------------	---

Cover Type			
A = Aspen	J = Jack Pine	O = Oak	U = Upland Brush
B = Paper Birch	K = Rock	P = Lowland Poplar	UM = Upland Mix Forest
C = Cedar	L = Lowland Brush	Q = Mixed Swamp Conifer	V = Bog or Marsh
D = Treed Bog	LM = Lowland Mix Forest	R = Red Pine	W = White Pine
E = Swamp Hardwoods	M = Maple, Beech, Birch	S = Black Spruce	X = Non Stocked
F = Spruce/Fir	MC = Mixed Conifer	T = Tamarack	Y = Sand
G = Grass	MD = Mixed Deciduous	Z = Water	
H = Hemlock	N = Marsh		

Density	
0 = Non Stocked	5 = Pole Timber Medium
1 = Seedling Sapling Poor	6 = Pole Timber Well
2 = Seedling Sapling Medium	7 = Saw Timber Poor
3 = Seedling Sapling Well	8 = Saw Timber Medium
4 = Pole Timber Poor	9 = Saw Timber Well

Use QR Code to open Map in App



Payment Unit Number	Acres
1	42.9
2	18.5
3	1.4
4	14.1

Red Shouldered Pine Re-Do

Comp 216

76.9 Acres

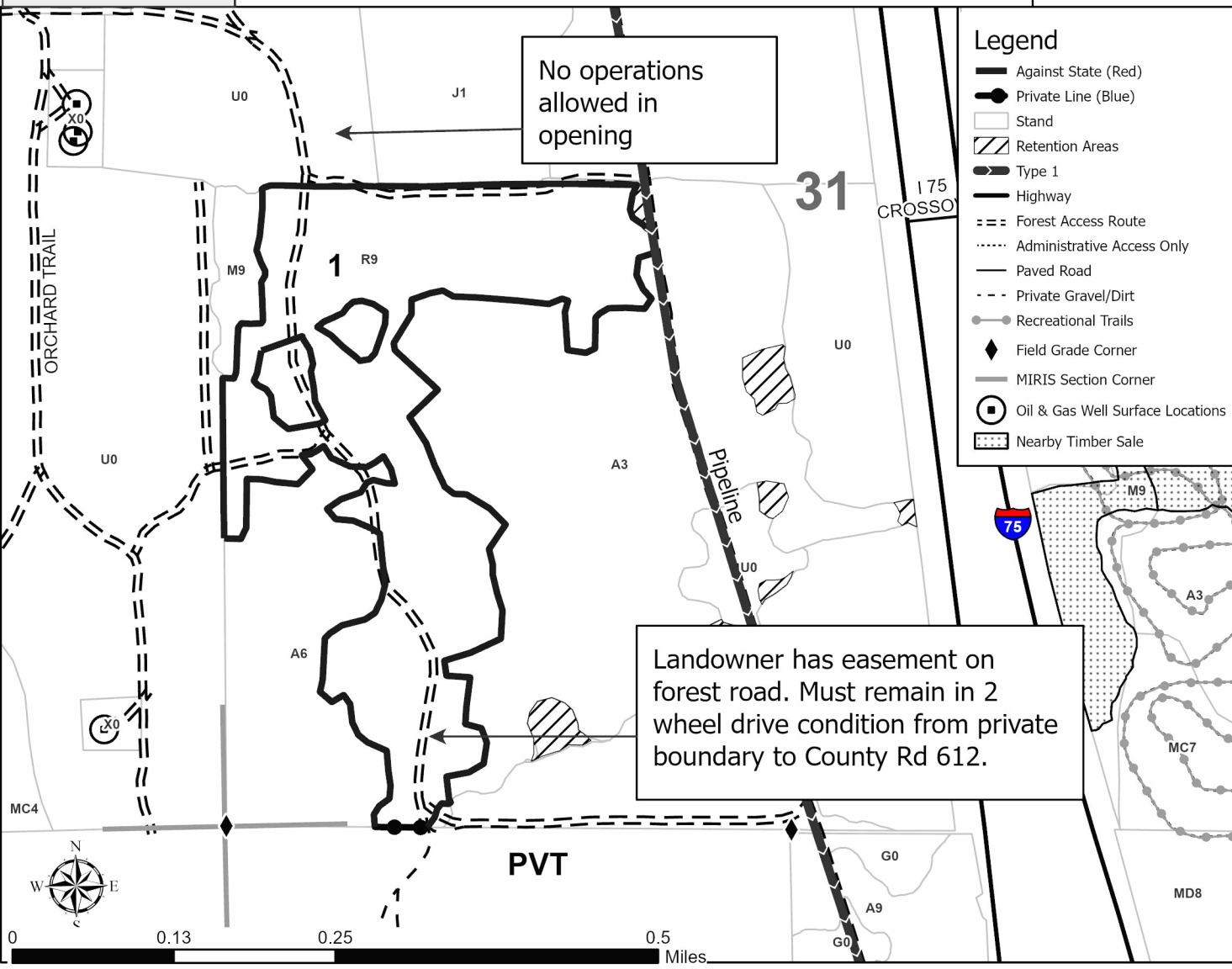



TIMBER SALE MAP

This information provided by authority of Part 525, 1994 PA 451, as amended.

Sale Number 72-004-25	Date 02/04/2025
Scale 1:7,920	Page 2
	Of 2

Forest Management Unit Grayling Mgt Unit	County Crawford	Mapped By: Derek Nellis
		Cruised By: Scott McClarren

Township 28N	Range 03W	Section(s) and Subdivision(s) Sec. 31 S1/2NW,SW; Sec. 33 E1/2NE,NESE;
-----------------	--------------	---

Cover Type			
A = Aspen	J = Jack Pine	O = Oak	U = Upland Brush
B = Paper Birch	K = Rock	P = Lowland Poplar	UM = Upland Mix Forest
C = Cedar	L = Lowland Brush	Q = Mixed Swamp Conifer	V = Bog or Marsh
D = Treed Bog	LM = Lowland Mix Forest	R = Red Pine	W = White Pine
E = Swamp Hardwoods	M = Maple, Beech, Birch	S = Black Spruce	X = Non Stocked
F = Spruce/Fir	MC = Mixed Conifer	T = Tamarack	Y = Sand
G = Grass	MD = Mixed Deciduous	Z = Water	
H = Hemlock	N = Marsh		

Density	
0 = Non Stocked	5 = Pole Timber Medium
1 = Seedling Sapling Poor	6 = Pole Timber Well
2 = Seedling Sapling Medium	7 = Saw Timber Poor
3 = Seedling Sapling Well	8 = Saw Timber Medium
4 = Pole Timber Poor	9 = Saw Timber Well

Payment Unit Number	Acres
1	42.9
2	18.5
3	1.4
4	14.1

Red Shouldered Pine Re-Do
Comp 216
76.9 Acres

Use QR Code to open Map in App

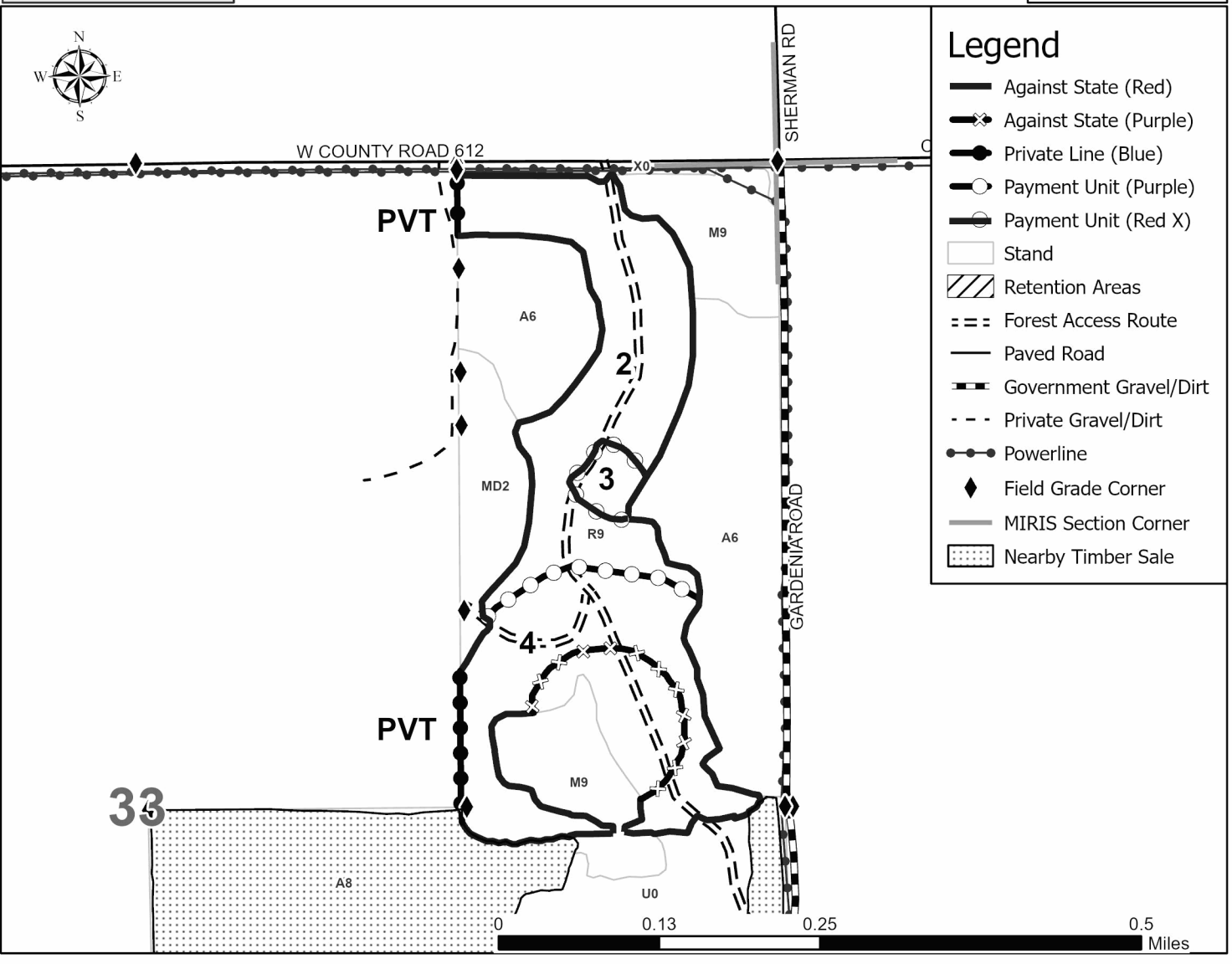

TIMBER SALE INFORMATION

Little Shop of Borers (72-601-25)
 T27N, R01W, SEC. 7; T27N, R01W, SEC. 8.
 Crawford County (Advertised Price \$90,941.40)

SALE NOTE: This sale falls on National Guard long-term lease lands and is subject to training restrictions and is non-certified. Furthermore, this sale must be chipped for this reason as well as for follow up planting operations. Payment Unit 3 is an applied raptor nest buffer that may be dropped if deemed active by the unit biologist. This contract is for two years and will not allow for extensions due to planting schedules.

A timber sale contract for this lump sum, sealed bid timber sale will be awarded to the responsible bidder offering the highest sealed bid price. All units of volume listed below were estimated using the Inventory Manager computer program and the new Michigan taper model. Bids must be at or above the following advertised price for each product and species:

<u>PRODUCTS & SPECIES</u>	<u>ESTIMATED UNITS*</u>	<u>ADVERTISED PRICE</u>
Sawtimber		
Black/Red (Hybrid) Oak	9.6 MBF	\$ 138.00 / MBF
Northern Pin Oak	5.3 MBF	\$ 138.00 / MBF
Pulpwood		
B. T. Aspen	21 Cords	\$ 26.15 / Cord
Black Cherry	1 Cords	\$ 32.15 / Cord
Jack Pine	278 Cords	\$ 23.35 / Cord
Misc. Species 2	7 Cords	\$ 5.00 / Cord
Mixed Oak	103 Cords	\$ 24.80 / Cord
Red Maple	8 Cords	\$ 32.15 / Cord
Red Pine	1,640 Cords	\$ 48.15 / Cord

* The total volume is statistically estimated within plus (+) or minus (-) 15.66 percent. There are an estimated 2,093 cords on this timber sale, plus or minus 328 cords at the 95% confidence level. The estimated units are final and not subject to adjustment. Prospective bidders are urged to examine this timber and to make their own estimates of quantity and quality.

BOND AND PAYMENT SCHEDULE:

1. A bond in the amount of \$4,547.00 to insure faithful performance of the conditions of the contract will be deposited by the successful bidder within 21 days of the sale award.
2. Cutting in any sale or unit without the required advance payment would be considered a trespass.
3. Total payment must be paid in advance or according to the following schedule :
 - (a) Ten percent (10%) of the sale value must be paid within 21 days of the sale award.
 - (b) The 10% down payment will be credited towards the first unit cut.
 - (c) Payment for each of the following units must be made before cutting begins in that unit:

PAYMENT UNIT NUMBER	PERCENT OF TOTAL SALE VALUE
01	38.3%
02	23.4%
03	4.5%
04	21.0%
05	12.8%

4. If no cutting takes place, the 10% down payment will not be refunded.
5. Operations on the contract issued will terminate on 03/31/2027.

SALE STATISTICS

Volumes were calculated in cubic feet using the Michigan taper model. Cubic foot volume includes all wood inside bark for the product indicated. For display purposes, cubic feet were converted to cords and MBF using a simple conversion factor, e.g. 79 cubic feet per cord and 185 cubic feet per MBF. The cubic foot volumes are precise; the cords and MBF volumes are not. Cubic foot volume cannot be directly converted to cords or boards with precision.

SALE VOLUMES

The total estimated sale volume may not equal the sum of the species/products due to the nature of statistical calculations associated with double sampling methodology.

VOLUME			STATISTICAL RANGE IN CORDS	
TOTAL CUBIC FEET	TOTAL CORDS	PERCENT ERROR	MINIMUM	MAXIMUM
165,323	2,093	15.66%	1,765	2,420

VDU VOLUMES

A VDU is a Volume Determination Unit. Volumes and their associated statistics are calculated at the VDU level and summarized to the sale level. There is often a one to one relationship between a VDU and a Payment Unit, but not always, depending on the cruise design. Refer to the VDU TO PAYMENT UNIT table.

	VOLUME			RANGE IN CORDS	
VDU	TOTAL CUBIC FEET	TOTAL CORDS	PERCENT ERROR	MINIMUM	MAXIMUM
33	32,913	417	29.60%	293	540
41	132,410	1,676	18.24%	1,370	1,982
TOTAL:	165,323	2,093		1,664	2,522

VDU TO PAYMENT UNIT

When a VDU is associated with more than one Payment Unit (PU), the VDU volumes are assigned to the PU based on acres of the VDU within the PU.

VDU	VDU ACRES	PU	PU ACRES
33	35.8	5	35.8
41	58.9	1	25.9
41	58.9	2	15.8
41	58.9	3	3.0
41	58.9	4	14.2
TOTAL:	271.4		94.7

DESCRIPTION OF TIMBER BY PAYMENT UNIT (PU)

PU	MARKET GROUP	PRODUCT	QUANTITY	UNIT	ACRES	ADVERTISE PRICE
1	Northern Pin Oak	Sawtimber	1.5	MBF	25.9	\$34,841.50
	Jack Pine	Pulpwood	20	Cords		
	Mixed Oak		7	Cords		
	<i>Northern Pin Oak</i>		7	<i>Cords</i>		
	Red Pine		706	Cords		
2	Northern Pin Oak	Sawtimber	0.9	MBF	15.8	\$21,281.05
	Jack Pine	Pulpwood	12	Cords		
	Mixed Oak		5	Cords		
	<i>Northern Pin Oak</i>		5	<i>Cords</i>		
	Red Pine		431	Cords		
3	Northern Pin Oak	Sawtimber	0.2	MBF	3.0	\$4,047.40
	Jack Pine	Pulpwood	2	Cords		
	Mixed Oak		1	Cords		
	<i>Northern Pin Oak</i>		1	<i>Cords</i>		
	Red Pine		82	Cords		
4	Northern Pin Oak	Sawtimber	0.8	MBF	14.2	\$19,100.50
	Jack Pine	Pulpwood	11	Cords		
	Mixed Oak		4	Cords		
	<i>Northern Pin Oak</i>		4	<i>Cords</i>		
	Red Pine		387	Cords		
5	Black/Red (Hybrid)	Sawtimber	9.6	MBF	35.8	\$11,670.95
	Northern Pin Oak		1.9	MBF		
	B. T. Aspen	Pulpwood	21	Cords		
	Black Cherry		1	Cords		
	Jack Pine		233	Cords		
	Misc. Species 2		7	Cords		
	Mixed Oak		86	Cords		
	<i>/Red (Hybrid) Oak</i>		64	<i>Cords</i>		
	<i>Northern Pin Oak</i>		11	<i>Cords</i>		
	<i>White Oak</i>		11	<i>Cords</i>		
	Red Maple		8	Cords		
	Red Pine		34	Cords		
TOTAL:			14.9	MBF		
TOTAL:			2,058	Cords		

Sale Specific Conditions & Requirements

Sale Name: Little Shop of Borers

Sale Number: 72-601-25 Seq#: 1

1 - Sale Area

1.2 - Boundaries

1.2.1 - Painted Boundaries (9/19)

The sale boundary and Payment Unit boundaries are marked and identified by blue, red, and yellow paint, as well as roads. Exterior sale boundary lines against private property are marked with blue paint. Exterior sale boundary lines against state are marked with red paint. Interior Payment Unit boundaries are marked with yellow paint, with the exception of the interior Payment Unit boundary between Payment Units 1 and 2 which is unpainted and designated by High Banks Road. Retention patches are marked with red paint; no harvesting activities may occur within these areas. Yellow painted trees designating an interior Payment Unit boundary are only to be cut when all surrounding Payment Units have been paid. The external red painted boundary line trees are not Included Timber and are to be protected unless marked with orange paint. However, the external boundary trees that are shared with the adjacent Timber Sale may be harvested. Work with the Sale Administrator to determine if these sale boundary trees may be removed, and how processing of the added volume will be handled. Legacy tree designation supersedes this designation and are to be retained.

2 - Timber Specifications

2.1 - Included Timber

2.1.1 - Clearcut Unit(s) with Unmerchantable Trees (6/14)

Within Payment Unit(s) 1-5, cut all trees that are two (2) inches or more at DBH, except do not cut any trees marked with green paint above and below stump height.

Special protection trees identified in accordance with condition 3.4.2, within clearcutting unit boundaries, are not Included Timber and are to be protected.

Special protection areas identified in accordance with condition 3.4.3, within clearcutting unit boundaries, are not Included Timber and are to be protected.

2.1.11 - Description of Timber Note (2/04)

Note that Misc. Species 2 is dead oak.

2.2 - Utilization

2.2.2 - Chipping Required (12/24)

Payment Units 1-5 must be chip harvested to facilitate subsequent planting operations and to meet National Guard requirements. However, the chipping requirement could be waived with military approval, if chip markets are depressed. The Purchaser has the option to produce sawlogs or pulpwood bolts, but the remaining portion of the trees must be chipped and hauled. The requirement to retain approximately 1/6 to 1/3 of treetops and limbs less than four (4) inches in diameter does not apply (G. C. & R. 2.2). This is because this is non-certified military land.

2.2.3 - Stump heights (4/07)

Stump heights within the Sale Area shall not exceed 6 inches for all trees. This is in order to facilitate both military and subsequent planting operations.

3 - Payments

3.4 - Damaged Timber

3.4.2 - Special Protection Trees (4/14)

The Purchaser shall not cut live or dead special protection trees within cutting units or clearings. Special protection trees are legacy trees designated with green paint above and below stump height. If the Purchaser's operations have cut or damaged special protection trees through carelessness, the Purchaser shall pay \$500 as fixed, agreed and liquidated damages for each special protection tree cut or damaged. Such payment does not constitute ownership of the undesignated timber.

3.4.3 - Special Protection Areas (8/11)

The Purchaser shall protect special protection areas from damage by the Purchaser's operations. Special protection areas are marked with a red boundary line and will be designated on the Timber Sale Map. The Purchaser shall not cut live or dead trees within special protection areas. If the Purchaser's operations have cut or damaged special protection areas through carelessness, the Purchaser shall pay \$1000 as fixed, agreed and liquidated damages for each acre or part thereof cut or damaged. Such payment does not constitute ownership of the undesignated timber.

4 - Transportation

4.1 - Construction

4.1.6 - Road Construction (4/24)

Construction of new roads or improvements of existing roads shall be done in such a way as to minimize the environmental and visual impacts. Merchantable trees shall be cut and utilized unless otherwise directed. Non-merchantable trees shall be severed and laid flat on the ground. Slash shall be chipped, utilized or otherwise removed from the sale. Stumps shall be set upright, not left on edge, and be moved at least 10 feet away from the road edge. Disturbed soil shall be feathered into the woods and not left in berms or windrows.

4.1.7 - Road Closure (10/11)

All new roads built into the sale must be blocked to vehicle traffic upon completion of the sale. Overgrown roads that are reopened shall be considered new roads. Temporary berms may be required if no sale activity occurs for 30 or more consecutive days. Contact the Sale Administrator for specific details of design and placement.

4.1.11 - Permits (2/12)

The Purchaser will secure any necessary permits that may be required.

5 - Operations

5.1 - Notification

5.1.5 - National Guard notification (2/15)

This sale is upon lands utilized for training by the Michigan National Guard - Camp Grayling. A minimum of five (5) business days prior to opening this sale, the producer must request that the sale administrator contact the military for information regarding training plans that may impact sale operations.

5.2 - Conduct of Operations

5.2.2 - Hazard Trees/Snags

5.2.2.1 - Den Trees (10/16)

Obvious hollow and/or den trees shall be protected and left standing unless they are a safety hazard.

5.2.3 - Operating Restrictions

5.2.3.7 - National Guard training restriction (1/09)

Operations on this contract may not be allowed during National Guard training operations. Typically, the restricted period is from May 1 to October 31. The contractor must check with the Unit Manager who will coordinate the cutting schedule with the Military.

5.2.32 - Decking/Landing Restoration (9/13)

All decking and landing areas must have the surface area restored to a condition equal to or better than before. This is to ensure the proper regeneration of the stand. Wood debris, chips and "cookies" from trimmings must be removed or scattered away from landing and loading areas and may not be windrowed on the edge.

5.2.38 - No Decking Against Live Trees (2/04)

Cut products may not be decked against unmarked or designated leave trees.

5.8 - Protection of Endangered Species

5.8.1 - Kirtland's Warbler (1) (4/24)

This sale is adjacent to a young jack pine stand which may be used by the Kirtland's Warbler. The Department reserves the

right to temporarily restrict all harvesting operations in a buffer zone of up to 500 feet if it is determined that Warbler territory has been established in the adjacent stand. The restricted period, if put into effect, would apply from May 1 to August 15.

5.8.5 - Protection of Raptor Nests (3/13)

All trees with raptor nests will be protected if found during harvesting operations. Notification will be made to the Unit Manager or his/her representative who will notify the Wildlife Biologist so an onsite evaluation and recommendation can be made, if necessary.

In addition, Payment Unit 3 reflects a potential buffer around a found raptor, stick nest. The Wildlife Division must verify that the nest isn't active prior to Payment Unit 3 being harvested. If it is found to be an active nest, a Timber Sale Contract Amendment will be processed to drop these acres from the sale.

6 - Safety and Fire Prevention

6.2 - Signing

6.2.1 - Road Posting (10/20)

The Purchaser is responsible for posting and maintaining caution signs on both High Banks Road and Bucks East and West Truck Trail prior to beginning operations. The road must be posted at appropriate distances from the Sale Area that are agreed upon by the Sale Administrator to warn of logging activity and truck traffic. Signs must be removed when harvest operations are suspended or completed. The Purchaser will provide these signs.

7 - Other Conditions

7.2 - Extensions

7.2.2 - No Extensions (3/09)

There will be no extensions granted on this contract. This is to align the planting treatment schedule of this sale with the adjacent Timber Sale's planting schedule.

7.10 - Certified Timber

7.10.1 - Non-Certified Timber (2/16)

The area encompassed by this timber sale is not certified to the standards of the Forest Stewardship Council (FSC) or the Sustainable Forestry Initiative (SFI). Forest products from this sale may not be delivered to the mill as "FSC and / or SFI certified". The lands within this sale are managed for military training.



TIMBER SALE MAP

This information provided by authority of Part 525, 1994 PA 451, as amended.

Sale Number

72-601-25

Date

01/10/2025

Forest Management Unit

Grayling Mgt Unit

County

Crawford

Mapped By: Jake Halabut

Cruised By: Jake Halabut

Scale

1:15,840

Page

1

Of

1

Township
27N

Range
01W

Section(s) and

Subdivision(s) Sec. 7 NENE,S1/2SE; Sec. 8 NWNW,S1/2NW,NWSW,SESW,SWSE;

Cover Type

A = Aspen	J = Jack Pine	O = Oak	U = Upland Brush
B = Paper Birch	K = Rock	P = Lowland Poplar	UM = Upland Mix Forest
C = Cedar	L = Lowland Brush	Q = Mixed Swamp Conifer	V = Bog or Marsh
D = Treed Bog	LM = Lowland Mix Forest	R = Red Pine	W = White Pine
E = Swamp Hardwoods	M = Maple, Beech, Birch	S = Black Spruce	X = Non Stocked
F = Spruce/Fir	MC = Mixed Conifer	T = Tamarack	Y = Sand
G = Grass	MD = Mixed Deciduous	Z = Water	
H = Hemlock	N = Marsh		

Density

0 = Non Stocked	5 = Pole Timber Medium
1 = Seedling Sapling Poor	6 = Pole Timber Well
2 = Seedling Sapling Medium	7 = Saw Timber Poor
3 = Seedling Sapling Well	8 = Saw Timber Medium
4 = Pole Timber Poor	9 = Saw Timber Well

Locator Map (1:200,000)



PU #	Acres
1	25.9
2	15.8
3	3
4	14.2
5	35.8

**Little Shop of Borers
94.7 Acres**

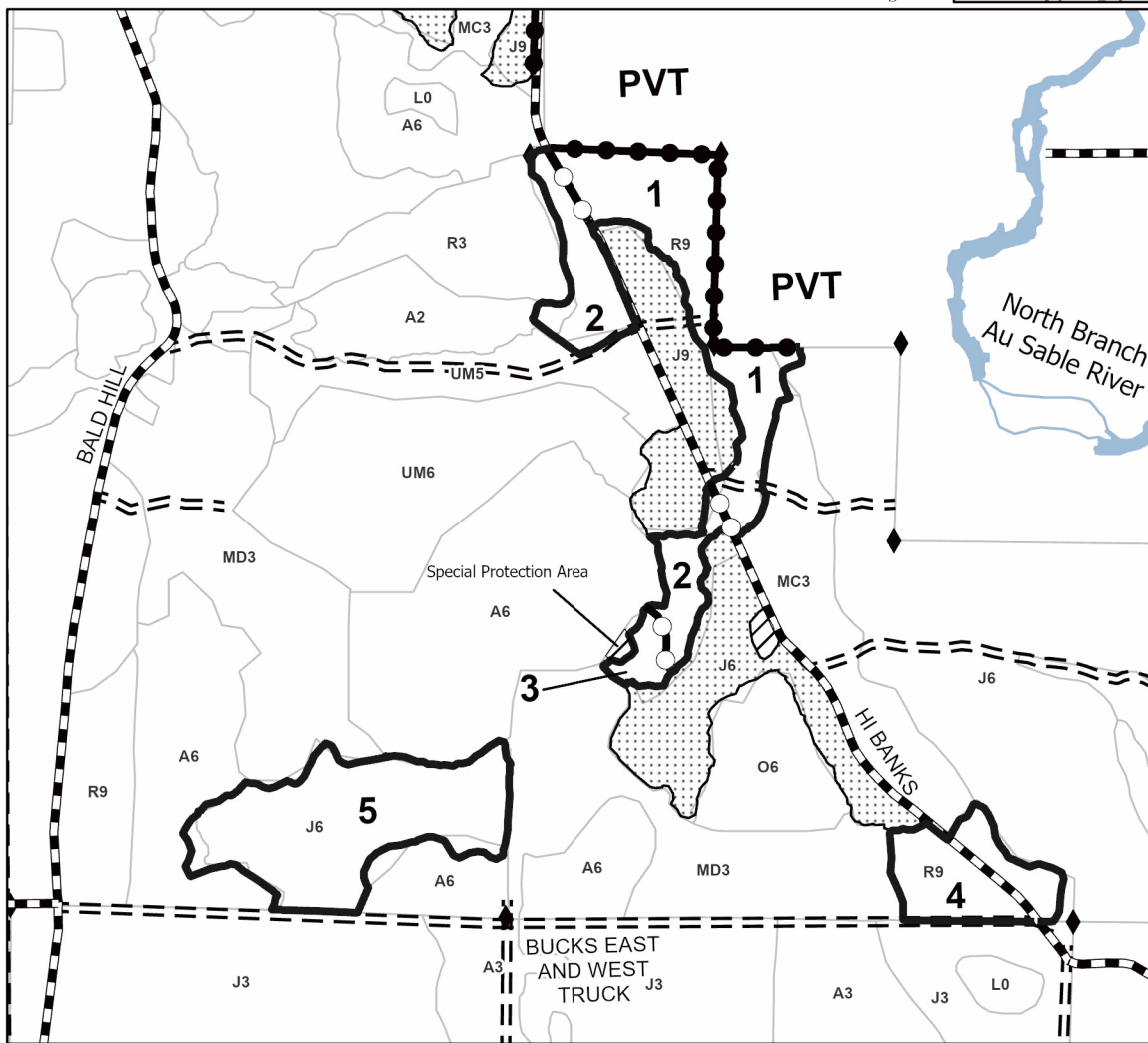
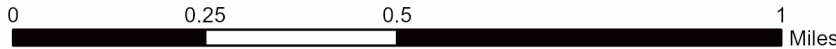

Legend

- Sale Boundary (Red/Unmarked Rd)
- Payment Unit (Yellow/Unmarked Rd)
- Private Line (Blue)
- Nearby Timber Sale
- Stand
- Primary Forest Road
- Forest Access Route
- Administrative Access Only
- Paved Road
- Government Gravel/Dirt
- Private Gravel/Dirt
- Field Grade Corner
- Retention Areas

Use QR Code to open Map in App



TIMBER SALE INFORMATION

Choppenheimer (72-620-24)

T28N, R02W, SEC. 10.

Crawford County (Advertised Price \$56,366.90)

SALE NOTE: Please take note that this sale is on military land and that oak wilt specs apply. Oak wilt is being taken into consideration due to residual oak within the sale and oak component in adjacent stands. Due to these reasons, there is a 3 year contract to accommodate.

A timber sale contract for this lump sum, sealed bid timber sale will be awarded to the responsible bidder offering the highest sealed bid price. All units of volume listed below were estimated using the Inventory Manager computer program and the new Michigan taper model. Bids must be at or above the following advertised price for each product and species:

<u>PRODUCTS & SPECIES</u>	<u>ESTIMATED UNITS*</u>	<u>ADVERTISED PRICE</u>
Sawtimber		
Mixed Oak	72.1 MBF	\$ 138.00 / MBF
Pulpwood		
Misc. Species 2	4 Cords	\$ 7.50 / Cord
Mixed Aspen	1,106 Cords	\$ 26.15 / Cord
Mixed Hardwood	221 Cords	\$ 32.15 / Cord
Mixed Oak	402 Cords	\$ 24.80 / Cord
White Pine	19 Cords	\$ 20.55 / Cord

* The total volume is statistically estimated within plus (+) or minus (-) 18.35 percent. There are an estimated 1,924 cords on this timber sale, plus or minus 353 cords at the 95% confidence level. The estimated units are final and not subject to adjustment. Prospective bidders are urged to examine this timber and to make their own estimates of quantity and quality.

BOND AND PAYMENT SCHEDULE:

1. A bond in the amount of \$2,818.00 to insure faithful performance of the conditions of the contract will be deposited by the successful bidder within 21 days of the sale award.
2. Cutting in any sale or unit without the required advance payment would be considered a trespass.
3. Total payment must be paid in advance or according to the following schedule :
 - (a) Ten percent (10%) of the sale value must be paid within 21 days of the sale award.
 - (b) The 10% down payment will be credited towards the first unit cut.
 - (c) Payment for each of the following units must be made before cutting begins in that unit:

PAYMENT UNIT NUMBER	PERCENT OF TOTAL SALE VALUE
01	49.2%
02	50.8%

4. If no cutting takes place, the 10% down payment will not be refunded.
5. Operations on the contract issued will terminate on 03/31/2028.

SALE STATISTICS

Volumes were calculated in cubic feet using the Michigan taper model. Cubic foot volume includes all wood inside bark for the product indicated. For display purposes, cubic feet were converted to cords and MBF using a simple conversion factor, e.g. 79 cubic feet per cord and 185 cubic feet per MBF. The cubic foot volumes are precise; the cords and MBF volumes are not. Cubic foot volume cannot be directly converted to cords or boards with precision.

SALE VOLUMES

The total estimated sale volume may not equal the sum of the species/products due to the nature of statistical calculations associated with double sampling methodology.

VOLUME		STATISTICAL RANGE IN CORDS		
TOTAL CUBIC FEET	TOTAL CORDS	PERCENT ERROR	MINIMUM	MAXIMUM
151,967	1,924	18.35%	1,571	2,277

VDU VOLUMES

A VDU is a Volume Determination Unit. Volumes and their associated statistics are calculated at the VDU level and summarized to the sale level. There is often a one to one relationship between a VDU and a Payment Unit, but not always, depending on the cruise design. Refer to the VDU TO PAYMENT UNIT table.

VDU	VOLUME		PERCENT ERROR	RANGE IN CORDS	
	TOTAL CUBIC FEET	TOTAL CORDS		MINIMUM	MAXIMUM
6	15,628	198	40.83%	117	279
8	109,392	1,385	22.45%	1,074	1,696
32	26,948	341	45.64%	185	497
TOTAL:	151,967	1,924		1,376	2,471

VDU TO PAYMENT UNIT

When a VDU is associated with more than one Payment Unit (PU), the VDU volumes are assigned to the PU based on acres of the VDU within the PU.

VDU	VDU ACRES	PU	PU ACRES
6	26.5	1	9.1
6	26.5	2	17.4
8	52.8	1	20.4
8	52.8	2	32.4
32	13.3	1	13.3
TOTAL:	171.9		92.6

DESCRIPTION OF TIMBER BY PAYMENT UNIT (PU)

PU	MARKET GROUP	PRODUCT	QUANTITY	UNIT	ACRES	ADVERTISE PRICE
1	Mixed Oak	Sawtimber	37.0	MBF	42.8	\$27,742.85
	<i>/Red (Hybrid) Oak</i>		1.7	<i>MBF</i>		
	<i>Red Oak</i>		35.3	<i>MBF</i>		
	Misc. Species 2	Pulpwood	1	Cords		
	Mixed Aspen		547	Cords		
	<i>B. T. Aspen</i>		454	<i>Cords</i>		
	<i>Quaking Aspen</i>		93	<i>Cords</i>		
	Mixed Hardwood		111	Cords		
	<i>Red Maple</i>	<i>Sawtimber</i>	6.6	<i>MBF</i>		
	<i>Black Cherry</i>	<i>Pulpwood</i>	3	<i>Cords</i>		
	<i>Red Maple</i>		95	<i>Cords</i>		
	Mixed Oak		186	Cords		
	<i>/Red (Hybrid) Oak</i>		3	<i>Cords</i>		
	<i>Northern Pin Oak</i>		2	<i>Cords</i>		
	<i>Red Oak</i>		181	<i>Cords</i>		
	White Pine		7	Cords		
2	Mixed Oak	Sawtimber	35.1	MBF	49.8	\$28,624.05
	<i>/Red (Hybrid) Oak</i>		3.3	<i>MBF</i>		
	<i>Red Oak</i>		31.8	<i>MBF</i>		
	Misc. Species 2	Pulpwood	3	Cords		
	Mixed Aspen		559	Cords		
	<i>B. T. Aspen</i>		460	<i>Cords</i>		
	<i>Quaking Aspen</i>		99	<i>Cords</i>		
	Mixed Hardwood		110	Cords		
	<i>Red Maple</i>	<i>Sawtimber</i>	1.9	<i>MBF</i>		
	<i>Black Cherry</i>	<i>Pulpwood</i>	5	<i>Cords</i>		
	<i>Red Maple</i>		101	<i>Cords</i>		
	Mixed Oak		216	Cords		
	<i>/Red (Hybrid) Oak</i>		7	<i>Cords</i>		
	<i>Northern Pin Oak</i>		5	<i>Cords</i>		
	<i>Red Oak</i>		204	<i>Cords</i>		
	White Pine		12	Cords		
TOTAL:			72.1	MBF		
TOTAL:			1,752	Cords		

Sale Specific Conditions & Requirements

Sale Name: Choppenheimer

Sale Number: 72-620-24 Seq#: 2

1 - Sale Area

1.2 - Boundaries

1.2.1 - Painted Boundaries (9/19)

The sale boundary and Payment Unit boundaries are marked and identified with red and yellow paint, as well as roads. Exterior sale boundary lines against state are marked with red paint, with the exception of stretches of sale boundary that border Lonesome Lake Road, which is unpainted and designated by the road. Interior Payment Unit boundaries are marked with yellow paint. Retention patches are marked with red paint; no harvesting activities may occur within these areas. The painted red, exterior boundary line trees are not Included Timber and are to be protected. Yellow painted trees designating an interior Payment Unit boundary are only to be cut when all surrounding Payment Units have been paid.

2 - Timber Specifications

2.1 - Included Timber

2.1.1 - Clearcut Unit(s) with Unmerchantable Trees (6/14)

Within Payment Unit(s) 1 and 2, cut all trees that are two (2) inches or more at DBH, except do not cut any white oak or paper birch. These two species are not Included Timber and are to be protected.

2.1.11 - Description of Timber Note (2/04)

Note that Misc species 2 is dead oak. Also, Mixed Aspen was cruised entirely as pulp.

2.2 - Utilization

2.2.2 - Chipping required (2/18)

The Sale Area must be chip harvested to meet National Guard requirements. However, the chipping requirement could be waived with military approval, if chip markets are depressed. The requirement to retain approximately 1/6 to 1/3 of tree tops and limbs less than four inches in diameter does not apply (G. C. & R. 2.2). This is because these are non-certified military long-term lease lands.

2.2.3 - Stump heights (4/07)

Stump heights within the Sale Area shall not exceed 6 inches for all trees. This is in order to facilitate military requirements.

3 - Payments

3.3 - Pre-measured Sales

3.3.4 - Dividing Payment Units (7/14)

Payment Unit(s) 1 and 2 may be divided at the request of the Purchaser and upon approval of the Unit Manager. Dividing Payment Units is a contract modification which requires a Timber Sale Contract Amendment. There will be only one division per Payment Unit.

3.4 - Damaged Timber

3.4.1 - Damaged timber (7/16)

General Condition and Requirement 3.4 Damaged Timber, defines liquidated damages for undesignated live merchantable trees which are cut or injured. No damage is acceptable to undesignated live merchantable trees. Rates will be in accordance with General Condition and Requirement 3.4 Damaged Timber.

4 - Transportation

4.1 - Construction

4.1.3 - Slash and Earthen Piles (8/04)

Piles or windrows of earth along roads and landings that have been widened or constructed shall be leveled. Slash from road maintenance or construction, including stumps, shall be chipped, utilized or otherwise removed from the sale.

4.1.6 - Road Construction (4/24)

Construction of new roads or improvements of existing roads shall be done in such a way as to minimize the environmental and visual impacts. Merchantable trees shall be cut and utilized unless otherwise directed. Non-merchantable trees shall be severed and laid flat on the ground. Slash shall be chipped, utilized or otherwise removed from the sale. Stumps shall be set upright, not left on edge, and be moved at least 10 feet away from the road edge. Disturbed soil shall be feathered into the woods and not left in berms or windrows.

4.1.7 - Road Closure (10/11)

All new roads built into the sale must be blocked to vehicle traffic upon completion of the sale. Overgrown roads that are reopened shall be considered new roads. Temporary berms may be required if no sale activity occurs for 30 or more consecutive days. Contact the Sale Administrator for specific details of design and placement.

4.1.11 - Permits (2/12)

The Purchaser will secure any necessary permits that may be required.

5 - Operations

5.1 - Notification

5.1.5 - National Guard notification (2/15)

This sale is upon lands utilized for training by the Michigan National Guard - Camp Grayling. A minimum of five (5) business days prior to opening this sale, the producer must request that the sale administrator contact the military for information regarding training plans that may impact sale operations.

5.2 - Conduct of Operations

5.2.2 - Hazard Trees/Snags

5.2.2.1 - Den Trees (10/16)

Obvious hollow and/or den trees shall be protected and left standing unless they are a safety hazard.

5.2.3 - Operating Restrictions

5.2.3.5 - Oak Wilt Restriction (1/18)

Within Payment Unit(s) 1 and 2, unless changed by written agreement, cutting, skidding, hauling within the sale and brushing of access roads to the sale are not permitted during the period of April 15 to July 15. Operations may be allowed if specific steps are taken to prevent damaging uncut oak during the high-risk period. Those steps may include completing all road brushing before April 15 and clearing a tree-length buffer along uncut oak cover before April 15. This is necessary to reduce the spread of oak wilt. For more information, contact the Unit Manager or his/her representative.

5.2.3.7 - National Guard training restriction (1/09)

Operations on this contract may not be allowed during National Guard training operations. Typically, the restricted period is from May 1 to October 31. The contractor must check with the Unit Manager who will coordinate the cutting schedule with the Military. All harvest equipment and timber products must be removed from the Sale Area during the period of May 1 to October 31, unless otherwise approved by the Unit Manager.

5.2.4 - Dead and Down Creation

5.2.4.1 - Dead and Down Creation, Marked Trees (10/13)

All trees marked with a band of orange paint must be felled and left on site for wildlife. These trees have been taken off the timber tally and are not Included Timber.

5.2.29 - Shrub Protection (1/20)

A reasonable effort should be made to protect from damage: hawthorn, hazelnut, or juneberry (serviceberry). These woody-shrub plants are highly beneficial to various wildlife species.

5.2.32 - Decking/Landing Restoration (9/13)

All decking and landing areas must have the surface area restored to a condition equal to or better than before. This is to ensure the proper regeneration of the stand. Wood debris, chips and "cookies" from trimmings must be removed or scattered away from landing and loading areas and may not be windrowed on the edge.

5.2.38 - No Decking Against Live Trees (2/04)

Cut products may not be decked against unmarked or designated leave trees.

5.4 - Soil Protection

5.4.1 - Rutting Restriction, General (7/16)

Operations are to cease immediately if equipment and weather conditions result in rutting of roads and/or skid trails which is 12 inches or greater in depth and 50 feet in length. The Unit Manager or his/her representative may restrict hauling and/or skidding if ruts exceed the specified depth. With the Unit Manager or his/her representative's approval, the Purchaser may return to the area when the risk of rutting has decreased.

5.4.2 - Skid Trails (2/04)

Skid trails up and down slopes should be avoided. If, however, this is unavoidable, these trails will be left in a non-erodible condition using water bars, logs, and slash. Placing of slash on these skid trails while logging is ongoing may alleviate need for any further action. At the direction of the Sale Administrator, seed, fertilizer, and mulch may also be required.

5.8 - Protection of Endangered Species

5.8.5 - Protection of Raptor Nests (3/13)

All trees with raptor nests will be protected if found during harvesting operations. Notification will be made to the Unit Manager or his/her representative who will notify the Wildlife Biologist so an onsite evaluation and recommendation can be made, if necessary.

6 - Safety and Fire Prevention

6.2 - Signing

6.2.1 - Road Posting (10/20)

The Purchaser is responsible for posting and maintaining caution signs on Lonesome Lake Road prior to beginning operations. The road must be posted at appropriate distances from the Sale Area that are approved by the Sale Administrator to warn of logging activity and truck traffic. Signs must be removed when harvest operations are suspended or completed. The Purchaser will provide these signs.

SKIP

6.4 - Unexploded Ordinance (7/15)

Be aware that the Sale Area could contain UXO (unexploded ordinances). Do not touch or drive over any metal objects. If any objects are found, please flag the area and notify the Unit Manager or his/her representative, so that they can make arrangements with the Military.

7 - Other Conditions

7.10 - Certified Timber

7.10.1 - Non-Certified Timber (2/16)

The area encompassed by this timber sale is not certified to the standards of the Forest Stewardship Council (FSC) or the Sustainable Forestry Initiative (SFI). Forest products from this sale may not be delivered to the mill as "FSC and / or SFI certified". The lands within this sale are managed for military training.



TIMBER SALE MAP

This information provided by authority of Part 525, 1994 PA 451, as amended.

Sale Number	Date	
72-620-24	01/10/2025	
Scale	Page	Of
1:20,000	1	1

Forest Management Unit	County	Mapped By: Jake Halabut
Grayling Mgt Unit	Crawford	Cruised By: Jake Halabut

Township	Range	Section(s) and Subdivision(s)
28N	02W	Sec. 10 E1/2NW,NE,NESW,NWSE; Sec. 3 SESW, SWSE

Cover Type			
A = Aspen	J = Jack Pine	O = Oak	U = Upland Brush
B = Paper Birch	K = Rock	P = Lowland Poplar	UM = Upland Mix Forest
C = Cedar	L = Lowland Brush	Q = Mixed Swamp Conifer	V = Bog or Marsh
D = Treed Bog	LM = Lowland Mix Forest	R = Red Pine	W = White Pine
E = Swamp Hardwoods	M = Maple, Beech, Birch	S = Black Spruce	X = Non Stocked
F = Spruce/Fir	MC = Mixed Conifer	T = Tamarack	Y = Sand
G = Grass	MD = Mixed Deciduous	Z = Water	
H = Hemlock	N = Marsh		

Density	
0 = Non Stocked	5 = Pole Timber Medium
1 = Seedling Sapling Poor	6 = Pole Timber Well
2 = Seedling Sapling Medium	7 = Saw Timber Poor
3 = Seedling Sapling Well	8 = Saw Timber Medium
4 = Pole Timber Poor	9 = Saw Timber Well

PU #	Acres
1	42.8
2	49.7

Choppenheimer
92.6 Acres
Compartment 268, 269

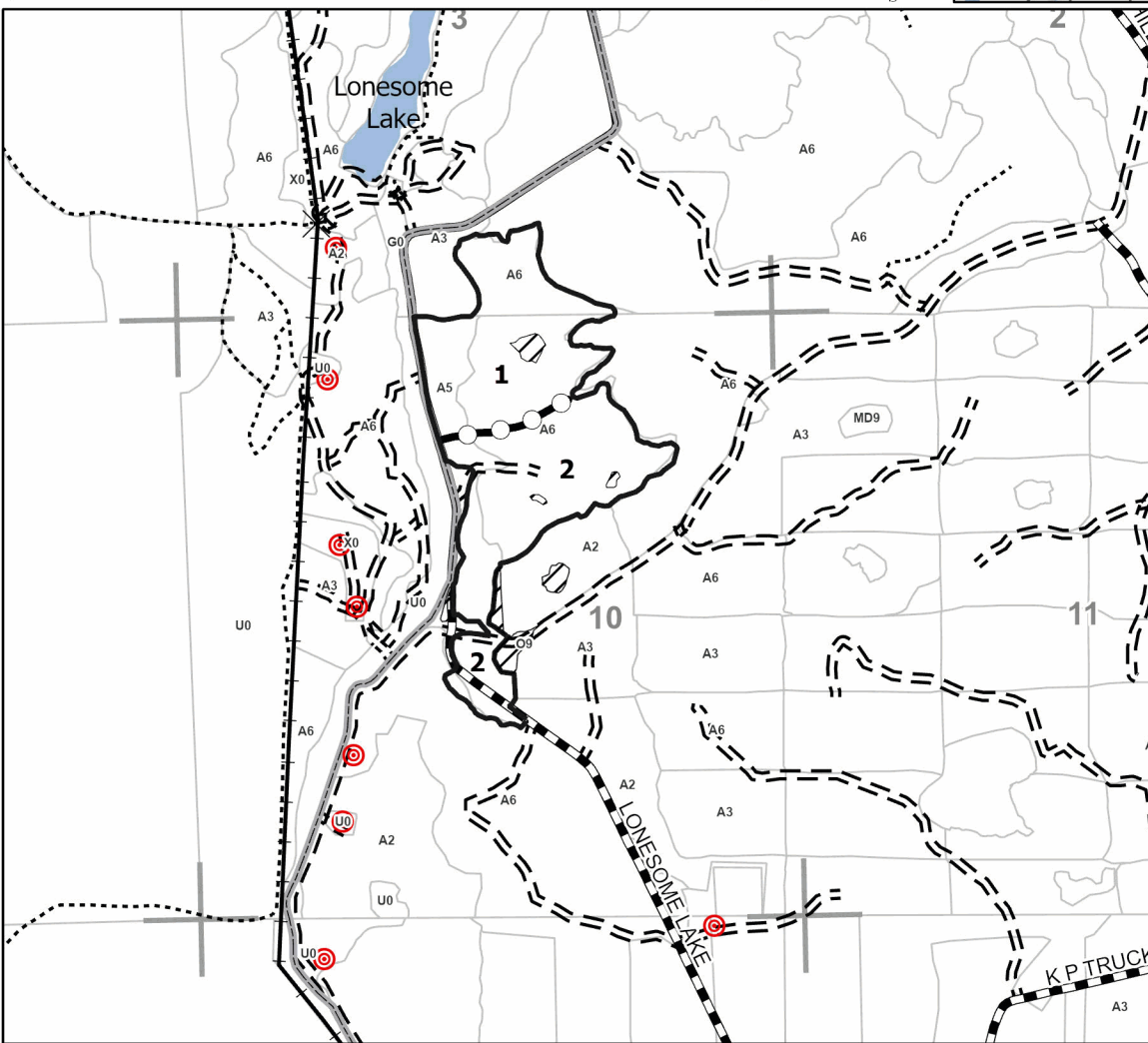
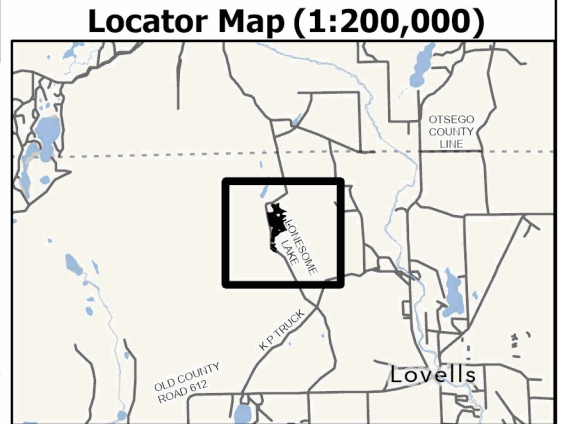

Legend

- Against State (Red/Unmarked Rd)
- Payment Unit (Yellow)
- Stand
- ▨ Retention Area
- Primary Forest Road
- - - Forest Access Route
- ⋯ Administrative Access Only
- Paved Road
- - - Government Gravel/Dirt
- - - Private Gravel/Dirt
- × CampGraylingGates
- CampGraylingFence
- ⊙ CampGraylingFiringPoint
- Lakes and Rivers
- MIRIS Section Corner

Use QR Code to open Map in App



TIMBER SALE INFORMATION

Raiders of the Lost Bark (72-626-24)
 T28N, R02W, SEC. 11; T28N, R02W, SEC. 14.
 Crawford County (Advertised Price \$76,031.40)

SALE NOTE: This sale is on military lands, has potential operability concerns due to steep slope, and oak wilt restrictions. Sale contains soft oak wilt spec 5.2.3.5 however, the DNR may deny any requests to operate during the restricted time frame. Accommodating these issues by utilizing a 3 year contract. No chipping of tops and limbs will be allowed to assist with reforestation and slope protection. Sale minimum bid price was reduced to account for potential areas of inoperability; therefore, there will be no volume or acreage adjustments, nor will there be any penalties for failing to uncut timber.

A timber sale contract for this lump sum, sealed bid timber sale will be awarded to the responsible bidder offering the highest sealed bid price. All units of volume listed below were estimated using the Inventory Manager computer program and the new Michigan taper model. Bids must be at or above the following advertised price for each product and species:

<u>PRODUCTS & SPECIES</u>	<u>ESTIMATED UNITS*</u>	<u>ADVERTISED PRICE</u>
Sawtimber		
Red Oak	279.3 MBF	\$ 110.00 / MBF
Pulpwood		
B. T. Aspen	230 Cords	\$ 20.90 / Cord
Misc. Species 2	35 Cords	\$ 5.00 / Cord
Misc. Species 3	49 Cords	\$ 4.00 / Cord
Mixed Hardwood	295 Cords	\$ 25.75 / Cord
Mixed Oak	1,639 Cords	\$ 19.85 / Cord

* The total volume is statistically estimated within plus (+) or minus (-) 13.17 percent. There are an estimated 2,902 cords on this timber sale, plus or minus 383 cords at the 95% confidence level. The estimated units are final and not subject to adjustment. Prospective bidders are urged to examine this timber and to make their own estimates of quantity and quality.

BOND AND PAYMENT SCHEDULE:

- A bond in the amount of \$3,802.00 to insure faithful performance of the conditions of the contract will be deposited by the successful bidder within 21 days of the sale award.
- Cutting in any sale or unit without the required advance payment would be considered a trespass.
- Total payment must be paid in advance or according to the following schedule :
 - Ten percent (10%) of the sale value must be paid within 21 days of the sale award.
 - The 10% down payment will be credited towards the first unit cut.
 - Payment for each of the following units must be made before cutting begins in that unit:

PAYMENT UNIT NUMBER	PERCENT OF TOTAL SALE VALUE
01	49.2%
02	50.8%
- If no cutting takes place, the 10% down payment will not be refunded.
- Operations on the contract issued will terminate on 03/31/2028.

SALE STATISTICS

Volumes were calculated in cubic feet using the Michigan taper model. Cubic foot volume includes all wood inside bark for the product indicated. For display purposes, cubic feet were converted to cords and MBF using a simple conversion factor, e.g. 79 cubic feet per cord and 185 cubic feet per MBF. The cubic foot volumes are precise; the cords and MBF volumes are not. Cubic foot volume cannot be directly converted to cords or boards with precision.

SALE VOLUMES

The total estimated sale volume may not equal the sum of the species/products due to the nature of statistical calculations associated with double sampling methodology.

VOLUME		STATISTICAL RANGE IN CORDS		
TOTAL CUBIC FEET	TOTAL CORDS	PERCENT ERROR	MINIMUM	MAXIMUM
229,285	2,902	13.17%	2,520	3,285

VDU VOLUMES

A VDU is a Volume Determination Unit. Volumes and their associated statistics are calculated at the VDU level and summarized to the sale level. There is often a one to one relationship between a VDU and a Payment Unit, but not always, depending on the cruise design. Refer to the VDU TO PAYMENT UNIT table.

VDU	VOLUME		PERCENT ERROR	RANGE IN CORDS	
	TOTAL CUBIC FEET	TOTAL CORDS		MINIMUM	MAXIMUM
49	229,285	2,902	13.18%	2,520	3,285
TOTAL:	229,285	2,902		2,520	3,285

VDU TO PAYMENT UNIT

When a VDU is associated with more than one Payment Unit (PU), the VDU volumes are assigned to the PU based on acres of the VDU within the PU.

VDU	VDU ACRES	PU	PU ACRES
49	61.1	1	30.1
49	61.1	2	31.0
TOTAL:	122.2		61.1

DESCRIPTION OF TIMBER BY PAYMENT UNIT (PU)

PU	MARKET GROUP	PRODUCT	QUANTITY	UNIT	ACRES	ADVERTISE PRICE
1	Red Oak	Sawtimber	137.6	MBF	30.1	\$37,431.40
	B. T. Aspen	Pulpwood	113	Cords		
	Misc. Species 2		17	Cords		
	Misc. Species 3		24	Cords		
	Mixed Hardwood		145	Cords		
	<i>Red Maple</i>	<i>Sawtimber</i>	0.4	<i>MBF</i>		
	<i>Beech</i>	<i>Pulpwood</i>	1	<i>Cords</i>		
	<i>Paper Birch</i>		2	<i>Cords</i>		
	<i>Red Maple</i>		94	<i>Cords</i>		
	<i>Sugar Maple</i>		47	<i>Cords</i>		
	Mixed Oak		807	Cords		
	<i>Red Oak</i>		802	<i>Cords</i>		
	<i>White Oak</i>		5	<i>Cords</i>		
2	Red Oak	Sawtimber	141.7	MBF	31.0	\$38,600.00
	B. T. Aspen	Pulpwood	117	Cords		
	Misc. Species 2		18	Cords		
	Misc. Species 3		25	Cords		
	Mixed Hardwood		150	Cords		
	<i>Red Maple</i>	<i>Sawtimber</i>	0.4	<i>MBF</i>		
	<i>Beech</i>	<i>Pulpwood</i>	1	<i>Cords</i>		
	<i>Paper Birch</i>		3	<i>Cords</i>		
	<i>Red Maple</i>		96	<i>Cords</i>		
	<i>Sugar Maple</i>		49	<i>Cords</i>		
	Mixed Oak		832	Cords		
	<i>Red Oak</i>		826	<i>Cords</i>		
	<i>White Oak</i>		6	<i>Cords</i>		
TOTAL:			279.3	MBF		
TOTAL:			2,248	Cords		

Sale Specific Conditions & Requirements

Sale Name: Raiders of the Lost Bark

Sale Number: 72-626-24 Seq#: 2

1 - Sale Area

1.2 - Boundaries

1.2.1 - Painted Boundaries (9/19)

Sale boundary and Payment Unit boundaries are marked and identified by red and yellow paint, as well as roads. Exterior sale boundary lines against state are marked with red paint, with the exception of the stretch of sale boundary along Ski Hill Road, which is unpainted and designated by the road. Interior Payment Unit boundaries are marked with yellow paint. Retention patches are marked with red paint; no harvesting activities may occur within these areas. The exterior, red painted boundary line trees are not Included Timber and are to be protected. Yellow painted trees designating an interior Payment Unit boundary are only to be cut when all surrounding Payment Units have been paid.

2 - Timber Specifications

2.1 - Included Timber

2.1.1 - Clearcut Unit(s) with Unmerchantable Trees (6/14)

Within Payment Unit(s) 1 and 2, cut all trees that are two (2) inches or more at DBH, except do not cut any red pine that are 12 inches or more at DBH. These trees are not Included Timber and are to be protected.

2.1.11 - Description of Timber Note (2/04)

Note that Misc. Species 2 is dead oak and Misc. Species 3 is dead aspen. These trees are designated for cutting.

2.2 - Utilization

2.2.5 - Limbed tree skidding (1/09)

The skidding of whole trees or tree segments with limbs attached is prohibited unless approved by the Unit Manager or his/her representative.

2.2.10 - No Chipping Tops and Limbs (8/16)

Within Payment Unit(s) 1 and 2, chipping of limbs or tops is not permitted. This is to allow slash to be used to help with protection against erosion along steep slopes. Limbs and the remaining top must be left on site and scattered.

3 - Payments

3.4 - Damaged Timber

3.4.1 - Damaged timber (7/16)

General Condition and Requirement 3.4 Damaged Timber, defines liquidated damages for undesignated live merchantable trees which are cut or injured. No damage is acceptable to undesignated live merchantable trees. Rates will be in accordance with General Condition and Requirement 3.4 Damaged Timber.

3.6 - Payment Unit Cutting Schedule

3.6.1 - Order of Cutting (1/09)

Payment Unit 1 shall be cut first, unless the sale is paid in full. This is due to the placement of the Payment Unit line, which was placed by design to allow for easier operability by starting with Payment Unit 1.

4 - Transportation

4.1 - Construction

4.1.3 - Slash and Earthen Piles (8/04)

Piles or windrows of earth along roads and landings that have been widened or constructed shall be leveled. Slash from road maintenance or construction, including stumps, shall be dispersed throughout the sale.

4.1.6 - Road Construction (4/24)

Construction of new roads or improvements of existing roads shall be done in such a way as to minimize the environmental

and visual impacts. Merchantable trees shall be cut and utilized unless otherwise directed. Non-merchantable trees shall be severed and laid flat on the ground. Slash shall be scattered, and not left in windrows and kept a minimum of 10 feet back from the road edge. Stumps shall be set upright, not left on edge, and be moved at least 10 feet away from the road edge. Disturbed soil shall be feathered into the woods and not left in berms or windrows.

4.1.7 - Road Closure (10/11)

All new roads built into the sale must be blocked to vehicle traffic upon completion of the sale. Overgrown roads that are reopened shall be considered new roads. Temporary berms may be required if no sale activity occurs for 30 or more consecutive days. Contact the Sale Administrator for specific details of design and placement.

4.1.11 - Permits (2/12)

The Purchaser will secure any necessary permits that may be required.

5 - Operations

5.1 - Notification

5.1.5 - National Guard notification (2/15)

This sale is upon lands utilized for training by the Michigan National Guard - Camp Grayling. A minimum of five (5) business days prior to opening this sale, the producer must request that the sale administrator contact the military for information regarding training plans that may impact sale operations.

5.2 - Conduct of Operations

5.2.1 - Slash

5.2.1.11 - Slash for Reforestation (3/21)

To facilitate reforestation, the Sale Area shall be left with slash evenly distributed. Bunched tops within the cutting area shall be broken up and scattered. Stumps shall be cut low to the ground. Processing sites shall not be left with a compacted layer of slash; tops from these sites shall be hauled back into the cut area and scattered.

5.2.2 - Hazard Trees/Snags

5.2.2.1 - Den Trees (10/16)

Obvious hollow and/or den trees shall be protected and left standing unless they are a safety hazard.

5.2.3 - Operating Restrictions

5.2.3.5 - Oak Wilt Restriction (1/18)

Within Payment Unit(s) 1 and 2, unless changed by written agreement, cutting, skidding, hauling within the sale and brushing of access roads to the sale are not permitted during the period of April 15 to July 15. Operations may be allowed if specific steps are taken to prevent damaging uncut oak during the high-risk period. Those steps may include completing all road brushing before April 15 and clearing a tree-length buffer along uncut oak cover before April 15. This is necessary to reduce the spread of oak wilt. For more information, contact the Unit Manager or his/her representative.

5.2.3.7 - National Guard training restriction (1/09)

Operations on this contract may not be allowed during National Guard training operations. Typically, the restricted period is from May 1 to October 31. The contractor must check with the Unit Manager who will coordinate the cutting schedule with the Military.

5.2.22 - Operating Caution

5.2.22.1 - Operating Caution (6/11)

It is recommended, but not required, that within Payment Unit(s) 1 and 2, cutting, skidding, and hauling occur during stable ground conditions, either dry summer or frozen winter. The reason for the recommendation is because efforts being made to reduce the erosion potential along slopes located within the Sale Area.

5.2.32 - Decking/Landing Restoration (9/13)

All decking and landing areas must have the surface area restored to a condition equal to or better than before. This is to ensure the proper regeneration of the stand. Wood debris, chips and "cookies" from trimmings must be removed or scattered away from landing and loading areas and may not be windrowed on the edge.

5.2.38 - No Decking Against Live Trees (2/04)

Cut products may not be decked against unmarked or designated leave trees.

5.4 - Soil Protection

5.4.1 - Rutting Restriction, General (7/16)

Operations are to cease immediately if equipment and weather conditions result in rutting of roads and/or skid trails which is 12 inches or greater in depth and 50 feet in length. The Unit Manager or his/her representative may restrict hauling and/or skidding if ruts exceed the specified depth. With the Unit Manager or his/her representative's approval, the Purchaser may return to the area when the risk of rutting has decreased.

5.4.2 - Skid Trails (2/04)

Skid trails up and down slopes should be avoided. If, however, this is unavoidable, these trails will be left in a non-erodible condition using water bars, logs, and slash. Placing of slash on these skid trails while logging is ongoing may alleviate need for any further action. At the direction of the Sale Administrator, seed, fertilizer, and mulch may also be required.

5.4.4 - Slope Protection (9/19)

Skid trails and roads on slopes shall be water barred with slash and stumps as soon as use is complete to prevent erosion.

5.8 - Protection of Endangered Species

5.8.5 - Protection of Raptor Nests (3/13)

All trees with raptor nests will be protected if found during harvesting operations. Notification will be made to the Unit Manager or his/her representative who will notify the Wildlife Biologist so an onsite evaluation and recommendation can be made, if necessary.

6 - Safety and Fire Prevention

6.2 - Signing

6.2.1 - Road Posting (10/20)

The Purchaser is responsible for posting and maintaining caution signs on Ski Hill Road and KP Truck Trail Road prior to beginning operations. The road must be posted at appropriate distances from the Sale Area to warn of logging activity and truck traffic. Signs must be removed when harvest operations are suspended or completed. The Purchaser will provide these signs.

SKIP

6.4 - Unexploded Ordinance (7/15)

Be aware that the Sale Area could contain UXO (unexploded ordinances). Do not touch or drive over any metal objects. If any objects are found, please flag the area and notify the Unit Manager or his/her representative, so that they can make arrangements with the Military.

7 - Other Conditions

7.10 - Certified Timber

7.10.1 - Non-Certified Timber (2/16)

The area encompassed by this timber sale is not certified to the standards of the Forest Stewardship Council (FSC) or the Sustainable Forestry Initiative (SFI). Forest products from this sale may not be delivered to the mill as "FSC and / or SFI certified". The lands within this sale are managed for military training.

8 - Performance and Settlement

8.3 - Uncompleted or Terminated Contracts

8.3.2 - Completion of Contract, Other (11/16)

Areas of this sale may be difficult to log. Per General Condition & Requirement 3.5 - Adjustment of Quantity, there will be no adjustment to contract volume, but unharvested timber may not be considered a violation of General Condition & Requirement 8.3 - Uncompleted or Terminated Contract. If the areas left unharvested are small enough, damages for not completing the Payment Unit would not be charged. These areas are located in Payment Unit 1 and are due to the steep

slopes that are present within the Sale Area.



TIMBER SALE MAP

This information provided by authority of Part 525, 1994 PA 451, as amended.

Sale Number 72-626-24	Date 09/30/2024
Scale 1:15,840	Page 1
	Of 1

Forest Management Unit Grayling Mgt Unit	County Crawford	Mapped By: Jake Halabut
		Cruised By: Jake Halabut

Township 28N	Range 02W	Section(s) and Subdivision(s) Sec. 11 SENE,E1/2SE; Sec. 14 NENE;
-----------------	--------------	--

Cover Type			
A = Aspen	J = Jack Pine	O = Oak	U = Upland Brush
B = Paper Birch	K = Rock	P = Lowland Poplar	UM = Upland Mix Forest
C = Cedar	L = Lowland Brush	Q = Mixed Swamp Conifer	V = Bog or Marsh
D = Treed Bog	LM = Lowland Mix Forest	R = Red Pine	W = White Pine
E = Swamp Hardwoods	M = Maple, Beech, Birch	S = Black Spruce	X = Non Stocked
F = Spruce/Fir	MC = Mixed Conifer	T = Tamarack	Y = Sand
G = Grass	MD = Mixed Deciduous	Z = Water	
H = Hemlock	N = Marsh		

Density	
0 = Non Stocked	5 = Pole Timber Medium
1 = Seedling Sapling Poor	6 = Pole Timber Well
2 = Seedling Sapling Medium	7 = Saw Timber Poor
3 = Seedling Sapling Well	8 = Saw Timber Medium
4 = Pole Timber Poor	9 = Saw Timber Well

PU #	Acres
1	30.1
2	31.1

Raiders of the Lost Bark 61.1 Acres

Locator Map (1:200,000)

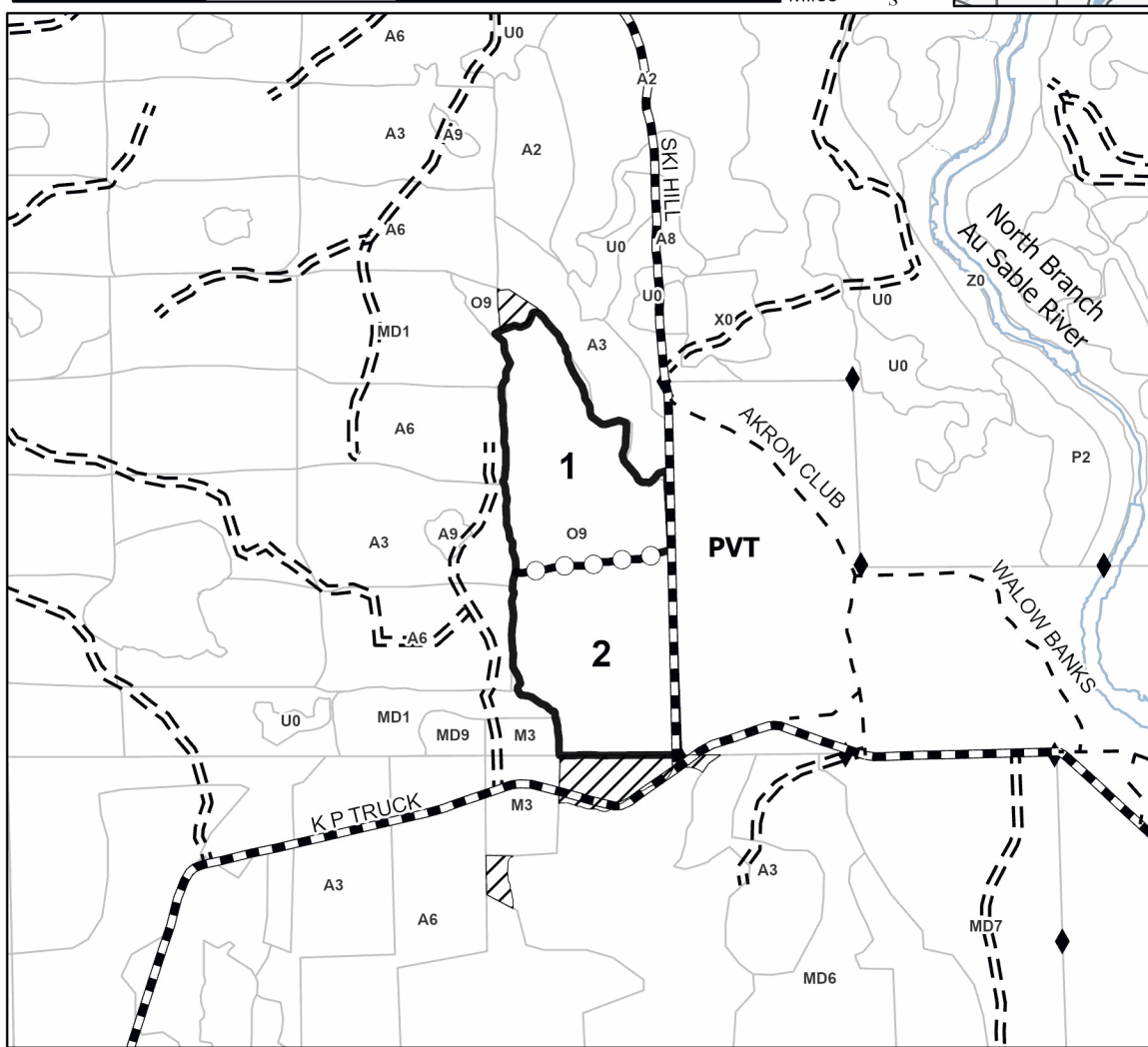
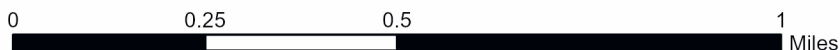
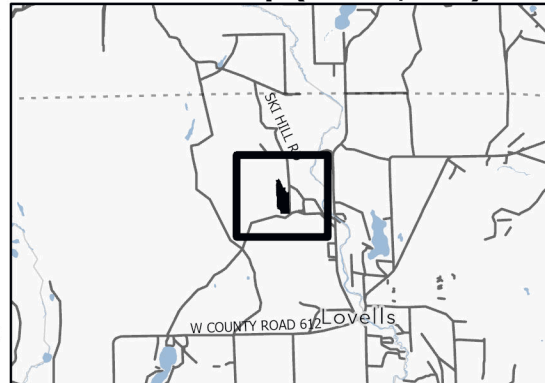

Legend

- Sale Boundary (Red/Unmarked Rd)
- Payment Unit (Yellow)
- Retention Area
- Stand
- Primary Forest Road
- Forest Access Route
- Administrative Access Only
- Paved Road
- Government Gravel/Dirt
- Private Gravel/Dirt
- Field Grade Corner

Use QR Code to open Map in App



TIMBER SALE INFORMATION

Missin' Merle Mix (72-630-24)
 T28N, R02W, SEC. 29; T28N, R02W, SEC. 30.
 Crawford County (Advertised Price \$48,190.65)

SALE NOTE: Timber/composite mats required if trucking wood from Payment Unit 3 due to road crossing through lowland drain. Corduroyed slash may be used if skidding wood from Payment Unit 3 into Payment Unit 4 with Sale Administrator approval. Material must be cleaned out of drain and left rut free after wood has been skidded out.

Sale not on certified land. Military land, chipping required, contains standard military specs. Contract has 4-year duration due to military timing restrictions. Soft Oak wilt timing restrictions applied for Payment Units 3-5 however, the DNR may deny any requests to operate during the restricted time frame.

A timber sale contract for this lump sum, sealed bid timber sale will be awarded to the responsible bidder offering the highest sealed bid price. All units of volume listed below were estimated using the Inventory Manager computer program and the new Michigan taper model. Bids must be at or above the following advertised price for each product and species:

<u>PRODUCTS & SPECIES</u>	<u>ESTIMATED UNITS*</u>	<u>ADVERTISED PRICE</u>
Sawtimber		
Black/Red (Hybrid) Oak	56.8 MBF	\$ 138.00 / MBF
Pulpwood		
Balsam Fir	24 Cords	\$ 24.10 / Cord
Jack Pine	66 Cords	\$ 23.35 / Cord
Mixed Aspen	195 Cords	\$ 26.15 / Cord
Mixed Hardwood	24 Cords	\$ 32.15 / Cord
Mixed Oak	450 Cords	\$ 24.80 / Cord
Red Pine	314 Cords	\$ 48.15 / Cord
White Pine	296 Cords	\$ 20.55 / Cord

* The total volume is statistically estimated within plus (+) or minus (-) 14.26 percent. There are an estimated 1,502 cords on this timber sale, plus or minus 214 cords at the 95% confidence level. The estimated units are final and not subject to adjustment. Prospective bidders are urged to examine this timber and to make their own estimates of quantity and quality.

BOND AND PAYMENT SCHEDULE:

1. A bond in the amount of \$2,410.00 to insure faithful performance of the conditions of the contract will be deposited by the successful bidder within 21 days of the sale award.
2. Cutting in any sale or unit without the required advance payment would be considered a trespass.
3. Total payment must be paid in advance or according to the following schedule :
 - (a) Ten percent (10%) of the sale value must be paid within 21 days of the sale award.
 - (b) The 10% down payment will be credited towards the first unit cut.
 - (c) Payment for each of the following units must be made before cutting begins in that unit:

PAYMENT UNIT NUMBER	PERCENT OF TOTAL SALE VALUE
01	22.7%
02	25.2%
03	9.1%
04	17.6%
05	25.4%

4. If no cutting takes place, the 10% down payment will not be refunded.
5. Operations on the contract issued will terminate on 03/31/2029.

SALE STATISTICS

Volumes were calculated in cubic feet using the Michigan taper model. Cubic foot volume includes all wood inside bark for the product indicated. For display purposes, cubic feet were converted to cords and MBF using a simple conversion factor, e.g. 79 cubic feet per cord and 185 cubic feet per MBF. The cubic foot volumes are precise; the cords and MBF volumes are not. Cubic foot volume cannot be directly converted to cords or boards with precision.

SALE VOLUMES

The total estimated sale volume may not equal the sum of the species/products due to the nature of statistical calculations associated with double sampling methodology.

VOLUME			STATISTICAL RANGE IN CORDS	
TOTAL CUBIC FEET	TOTAL CORDS	PERCENT ERROR	MINIMUM	MAXIMUM
118,684	1,502	14.26%	1,288	1,717

VDU VOLUMES

A VDU is a Volume Determination Unit. Volumes and their associated statistics are calculated at the VDU level and summarized to the sale level. There is often a one to one relationship between a VDU and a Payment Unit, but not always, depending on the cruise design. Refer to the VDU TO PAYMENT UNIT table.

	VOLUME			RANGE IN CORDS	
VDU	TOTAL CUBIC FEET	TOTAL CORDS	PERCENT ERROR	MINIMUM	MAXIMUM
11	54,837	694	24.30%	525	863
27	9,977	126	35.38%	82	171
39	53,870	682	19.11%	552	812
TOTAL:	118,684	1,502		1,159	1,846

VDU TO PAYMENT UNIT

When a VDU is associated with more than one Payment Unit (PU), the VDU volumes are assigned to the PU based on acres of the VDU within the PU.

VDU	VDU ACRES	PU	PU ACRES
11	21.2	1	10.1
11	21.2	2	11.1
27	15.7	3	15.7
39	52.3	4	21.3
39	52.3	5	31.0
TOTAL:	162.7		89.2

DESCRIPTION OF TIMBER BY PAYMENT UNIT (PU)

PU	MARKET GROUP	PRODUCT	QUANTITY	UNIT	ACRES	ADVERTISE PRICE
1	Balsam Fir	Pulpwood	10	Cords	10.1	\$10,937.95
	<i>Balsam Fir</i>		10	<i>Cords</i>		
	Jack Pine		22	Cords		
	Mixed Aspen		81	Cords		
	<i>B. T. Aspen</i>		40	<i>Cords</i>		
	<i>Quaking Aspen</i>		41	<i>Cords</i>		
	Mixed Hardwood		8	Cords		
	<i>Paper Birch</i>		1	<i>Cords</i>		
	<i>Red Maple</i>		7	<i>Cords</i>		
	Mixed Oak		5	Cords		
	<i>/Red (Hybrid) Oak</i>		5	<i>Cords</i>		
	Red Pine		128	Cords		
	White Pine		74	Cords		
	<i>White Pine</i>		74	<i>Cords</i>		
2	Balsam Fir	Pulpwood	12	Cords	11.1	\$12,149.00
	<i>Balsam Fir</i>		12	<i>Cords</i>		
	Jack Pine		25	Cords		
	Mixed Aspen		91	Cords		
	<i>B. T. Aspen</i>		45	<i>Cords</i>		
	<i>Quaking Aspen</i>		46	<i>Cords</i>		
	Mixed Hardwood		10	Cords		
	<i>Paper Birch</i>		2	<i>Cords</i>		
	<i>Red Maple</i>		8	<i>Cords</i>		
	Mixed Oak		6	Cords		
	<i>/Red (Hybrid) Oak</i>		6	<i>Cords</i>		
	Red Pine		140	Cords		
	White Pine		82	Cords		
	<i>White Pine</i>		82	<i>Cords</i>		
3	Black/Red (Hybrid)	Sawtimber	15.9	MBF	15.7	\$4,371.85
	Balsam Fir	Pulpwood	2	Cords		
	<i>Tamarack</i>		2	<i>Cords</i>		
	Jack Pine		3	Cords		
	Mixed Aspen		9	Cords		
	<i>Quaking Aspen</i>		9	<i>Cords</i>		
	Mixed Hardwood		6	Cords		
	<i>Black Cherry</i>		1	<i>Cords</i>		
	<i>Paper Birch</i>		5	<i>Cords</i>		
	Mixed Oak		55	Cords		
	<i>/Red (Hybrid) Oak</i>		55	<i>Cords</i>		
	White Pine		13	Cords		
	<i>White Pine</i>	Sawtimber	2.9	<i>MBF</i>		
	<i>White Pine</i>	<i>Pulpwood</i>	7	<i>Cords</i>		
4	Black/Red (Hybrid)	Sawtimber	16.7	MBF	21.3	\$8,477.20
	Jack Pine	Pulpwood	7	Cords		
	Mixed Aspen		6	Cords		
	<i>Quaking Aspen</i>		6	<i>Cords</i>		
	Mixed Oak		156	Cords		
	<i>White Oak</i>	Sawtimber	0.2	<i>MBF</i>		
	<i>/Red (Hybrid) Oak</i>	<i>Pulpwood</i>	154	<i>Cords</i>		
	<i>White Oak</i>		2	<i>Cords</i>		
	Red Pine		19	Cords		
	White Pine		52	Cords		
	<i>White Pine</i>		52	<i>Cords</i>		
5	Black/Red (Hybrid)	Sawtimber	24.2	MBF	31.0	\$12,254.65
	Jack Pine	Pulpwood	9	Cords		
	Mixed Aspen		8	Cords		

DESCRIPTION OF TIMBER BY PAYMENT UNIT (PU), CON'T

PU	MARKET GROUP	PRODUCT	QUANTITY	UNIT	ACRES	ADVERTISE PRICE
5 con't	<i>Quaking Aspen</i>	<i>Pulpwood</i>	8	<i>Cords</i>		
	Mixed Oak		228	Cords		
	<i>White Oak</i>	<i>Sawtimber</i>	0.3	<i>MBF</i>		
	<i>/Red (Hybrid) Oak</i>	<i>Pulpwood</i>	223	<i>Cords</i>		
	<i>White Oak</i>		4	<i>Cords</i>		
	Red Pine		27	Cords		
	White Pine		75	Cords		
	<i>White Pine</i>		75	<i>Cords</i>		
TOTAL:			56.8	MBF		
TOTAL:			1,369	Cords		

Sale Specific Conditions & Requirements

Sale Name: Missin' Merle Mix

Sale Number: 72-630-24 Seq#: 2

1 - Sale Area

1.2 - Boundaries

1.2.1 - Painted Boundaries (9/19)

The sale boundary and Payment Unit boundaries are marked and identified by blue, red and yellow paint, as well as roads. Exterior sale boundary lines against private property are marked with blue paint. Exterior sale boundary lines against state are marked with red paint. Interior Payment Unit boundaries are marked with yellow paint, with the exception of some sale boundaries that are unpainted and designated by existing roads as shown on the Timber Sale Map. Retention patches are marked with red paint; no harvesting activities may occur within these areas. The painted boundary line trees are not Included Timber and are to be protected. Yellow painted trees designating an interior Payment Unit boundary are only to be cut when all surrounding Payment Units have been paid.

2 - Timber Specifications

2.1 - Included Timber

2.1.1 - Clearcut Unit(s) with Unmerchantable Trees (6/14)

Within Payment Unit(s) 1, 2, 4, and 5, cut all trees that are two (2) inches or more at DBH, except do not cut trees that are 26 inches or more at DBH.

Special protection trees identified in accordance with condition 3.4.2. within clearcutting unit boundaries, are not included timber and are to be protected.

2.1.5 - Overstory Removal Unit(s) (8/11)

Within Payment Unit(s) 3, all trees which meet minimum piece specifications in 2.2 Utilization, are designated for cutting.

Special protection trees identified in accordance with condition 3.4.2, within clearcutting unit boundaries, are not Included Timber and are to be protected.

2.2 - Utilization

2.2.2 - Chipping required (2/18)

This area, Payment Unit(s) 1-5, must be chip harvested to meet National Guard requirements. However, the chipping requirement could be waived with military approval, if chip markets are depressed. The Purchaser has the option to produce sawlogs or pulpwood bolts, but the remaining portion of the trees must be chipped and hauled. The requirement to retain approximately 1/6 to 1/3 of tree tops and limbs less than four inches in diameter does not apply (G.C. & R. 2.2). This is because this is non-certified military land.

2.2.3 - Stump heights (4/07)

Stump heights within the Sale Area shall not exceed 6 inches for all trees. This is in order to facilitate military requirements.

3 - Payments

3.4 - Damaged Timber

3.4.1 - Damaged timber (7/16)

General Condition and Requirement 3.4 Damaged Timber, defines liquidated damages for undesignated live merchantable trees which are cut or injured. In addition, care should be taken to avoid damage to tree seedlings and saplings. Within Payment Unit 3, if more than 30% of the tree seedlings or saplings (1/4" to 4.5" DBH) within a specified portion of the Sale Area are damaged, liquidated damages will be assessed at \$400 per acre for all acreage within that specified portion of the Sale Area that was damaged. Trees cut cleanly for skid trails will not count as damaged.

3.4.2 - Special Protection Trees (1/25)

The Purchaser shall not cut live or dead special protection trees within cutting units or clearings. Special protection trees are marked with orange paint or any trees over 26" DBH. If Purchaser's operations have cut or damaged special protection trees through carelessness, the Purchaser shall pay \$500 as fixed, agreed and liquidated damages for each special protection tree

cut or damaged. Such payment does not constitute ownership of the undesignated timber.

4 - Transportation

4.1 - Construction

4.1.3 - Slash and Earthen Piles (8/04)

Piles or windrows of earth along roads and landings that have been widened or constructed shall be leveled. Slash from road maintenance or construction, including stumps, shall be chipped, utilized, or otherwise removed from the sale.

4.1.6 - Road Construction (4/24)

Improvements of existing roads shall be done in such a way as to minimize the environmental and visual impacts. Merchantable trees shall be cut and utilized unless otherwise directed. Non-merchantable trees shall be severed and laid flat on the ground. Slash shall be chipped, utilized, or otherwise removed from the sale. Stumps shall be set upright, not left on edge, and be moved at least 10 feet away from the road edge. Disturbed soil shall be feathered into the woods and not left in berms or windrows.

4.1.7 - Road Closure (10/11)

All new roads built into the sale must be blocked to vehicle traffic upon completion of the sale. Overgrown roads that are reopened shall be considered new roads. Some existing roads may also need to be closed. In general, this will require constructing a four (4') foot high berm of stumps and logs covered with earth. These roads must be rendered impassable to cars and trucks. All stumps from road building and landing construction must be reserved to block any newly constructed roads upon completion of the sale. These stumps must be scattered along the road system to prohibit vehicular movement. Temporary berms may be required if no sale activity occurs for 30 or more consecutive days. Contact the Sale Administrator for specific details of design and placement.

4.2 - Maintenance

4.2.1 - Hauling Restriction (12/08)

Hauling may be restricted on forest roads by the Unit Manager or his/her representative. The restriction may be placed on forest road accessing Payment Unit 3 from the east, and may occur during wet weather conditions.

5 - Operations

5.1 - Notification

5.1.4 - Post-Sale Conference (10/16)

A post-sale conference on site between the Purchaser and sale administrator is required 5 days prior to the completion of active logging operations to determine clean-up and repair of landings, road edges, and the fulfillment of other contract specifications.

5.1.5 - National Guard notification (2/15)

This sale is upon lands utilized for training by the Michigan National Guard - Camp Grayling. A minimum of five (5) business days prior to opening this sale, the producer must request that the sale administrator contact the military for information regarding training plans that may impact sale operations.

5.1.6 - Utility R.O.W. (4/19)

It is the responsibility of the Purchaser to obtain permission from the utility company to utilize the power line R.O.W. for operations.

5.2 - Conduct of Operations

5.2.2 - Hazard Trees/Snags

5.2.2.1 - Den Trees (10/16)

Obvious hollow and/or den trees shall be protected and left standing unless they are a safety hazard.

5.2.3 - Operating Restrictions

5.2.3.5 - Oak Wilt Restriction (1/18)

Within Payment Unit(s) 3-5, unless changed by written agreement, cutting, skidding, hauling within the sale and brushing of access roads to the sale are not permitted during the period of April 15 to July 15. Operations may be allowed if

specific steps are taken to prevent damaging uncut oak during the high-risk period. Those steps may include completing all road brushing before April 15 and clearing a tree-length buffer along uncut oak cover before April 15. This is necessary to reduce the spread of oak wilt. For more information, contact the Unit Manager or his/her representative.

5.2.3.7 - National Guard training restriction (1/09)

Operations on this contract may not be allowed during National Guard training operations. Typically, the restricted period is from May 1 to October 31. The contractor must check with the Unit Manager who will coordinate the cutting schedule with the Military.

5.2.4 - Dead and Down Creation

5.2.4.4 - Dead and Down Creation, Grouse (6/18)

To encourage grouse and other wildlife, in Payment Unit(s) 1 and 2 leave one 12-inch or larger diameter (or largest diameter trees within stand) whole tree on the ground for every 2 acres, preferably a hardwood species such as oak or maple or if no hardwoods are present, a pine species (white or red). These trees will be evenly scattered throughout the unit, preferably at least two chains from any roads, two-tracks, or trails open to vehicles. This can be an unmerchantable piece or a full tree.

5.2.17 - Timber Mats and Interlocking Composite Mats (5/23)

Some roads or skid trails may require extra protection such as that afforded by timber mats, interlocking composite mats, or another approved system. Approximately 75 feet of road or trail may need extra protection in Aspen stand between Payment Units 3 and 4. If available, mats may be borrowed from the DNR. A Timber Sale Contract Amendment will be used to document the Purchaser's use of the DNR's mats. Contact the Sale Administrator regarding availability and pick-up. Timber mats are available from various field offices. Composite mats are only available from the Grayling field office and the Marquette ICC. The Purchaser is responsible for picking up and hauling the mats to and from the site. The composite mats will require DNR staff onsite for installation and removal. Contact the Sale Administrator to schedule at least 30 days before desired install/removal date. All mats must be cleaned prior to drop off. This may include, but is not limited to, power washing and brushing to remove mud and debris. A charge of \$700.00 per timber mat and \$2,000.00 per composite mat will be assessed for all damaged or non-returned mats. Damage for the crane/timber mats is defined as three or more broken cants. Damage for the composite mats is defined as cracked or broken mats.

5.2.29 - Shrub Protection (1/20)

Reasonable care should be taken to avoid cutting hawthorn, dogwood or juneberry. These woody-shrub plants are highly beneficial to various wildlife species.

5.2.32 - Decking/Landing Restoration (9/13)

All decking and landing areas must have the surface area restored to a condition equal to or better than before. This is to ensure the proper regeneration of the stand. Wood debris, chips and "cookies" from trimmings must be removed or scattered away from landing and loading areas and may not be windrowed on the edge.

5.2.43 - Opening Protection (2/21)

No activities are permitted in openings marked on the Timber Sale Map with the letter "G". Any damage to the openings shall be repaired according to specifications of the Unit Manager or his/her representative.

5.8 - Protection of Endangered Species

5.8.5 - Protection of Raptor Nests (3/13)

All trees with raptor nests will be protected if found during harvesting operations. Notification will be made to the Unit Manager or his/her representative who will notify the Wildlife Biologist so an onsite evaluation and recommendation can be made, if necessary.

6 - Safety and Fire Prevention

6.2 - Signing

6.2.1 - Road Posting (10/20)

The Purchaser is responsible for posting and maintaining caution signs on County Road 612 and Kinney Road prior to beginning operations. The road must be posted at appropriate distances from the Sale Area to warn of logging activity and truck traffic. Signs must be removed when harvest operations are suspended or completed. The Purchaser will provide these signs.

7 - Other Conditions

7.10 - Certified Timber

7.10.1 - Non-Certified Timber (2/16)

The area encompassed by this timber sale is not certified to the standards of the Forest Stewardship Council (FSC) or the Sustainable Forestry Initiative (SFI). Forest products from this sale may not be delivered to the mill as "FSC and / or SFI certified". The lands within this sale are managed for military training.



TIMBER SALE MAP

This information provided by authority of Part 525, 1994 PA 451, as amended.

Sale Number
72-630-24

Date
01/15/2025

Forest Management Unit
Grayling Mgt Unit

County
Crawford

Mapped By: Porteous
Cruised By: Porteous

Scale
1:10,000

Page
1

Of
1

Township 28N Range 02W Section(s) and Subdivision(s) Sec. 29 W1/2NW,NWSW; Sec. 30 S1/2NW,SENE,N1/2SW,N1/2SE,SWSE;

Cover Type

A = Aspen	J = Jack Pine	O = Oak	U = Upland Brush
B = Paper Birch	K = Rock	P = Lowland Poplar	UM = Upland Mix Forest
C = Cedar	L = Lowland Brush	Q = Mixed Swamp Conifer	V = Bog or Marsh
D = Treed Bog	LM = Lowland Mix Forest	R = Red Pine	W = White Pine
E = Swamp Hardwoods	M = Maple, Beech, Birch	S = Black Spruce	X = Non Stocked
F = Spruce/Fir	MC = Mixed Conifer	T = Tamarack	Y = Sand
G = Grass	MD = Mixed Deciduous	Z = Water	
H = Hemlock	N = Marsh		

Density

0 = Non Stocked	5 = Pole Timber Medium
1 = Seedling Sapling Poor	6 = Pole Timber Well
2 = Seedling Sapling Medium	7 = Saw Timber Poor
3 = Seedling Sapling Well	8 = Saw Timber Medium
4 = Pole Timber Poor	9 = Saw Timber Well

Missin' Merle Mix

89.2 Acres

PU #	Acres	PU #	Acres
1	10.1	4	21.3
2	11.1	5	31.1
3	15.7		

LEGEND

- ◇ Field Grade Corner
- ⊙ Military Firing Point
- - - Forest Road
- ▬ County Road
- ⋯ Administrative Access Road
- Powerline
- MIRIS Section Corner
- ▬▬▬ Lowland Drain
- ▬ Lakes and Rivers
- ▨ Maintained Wildlife Opening
- ▬ Sale Boundary
- ▬ Against State (Red)
- ▬ Against State (Road)
- ▬ Private Line (Blue)
- Payment Unit (Yellow)
- Payment Unit (Road)
- ▨ Retention Areas

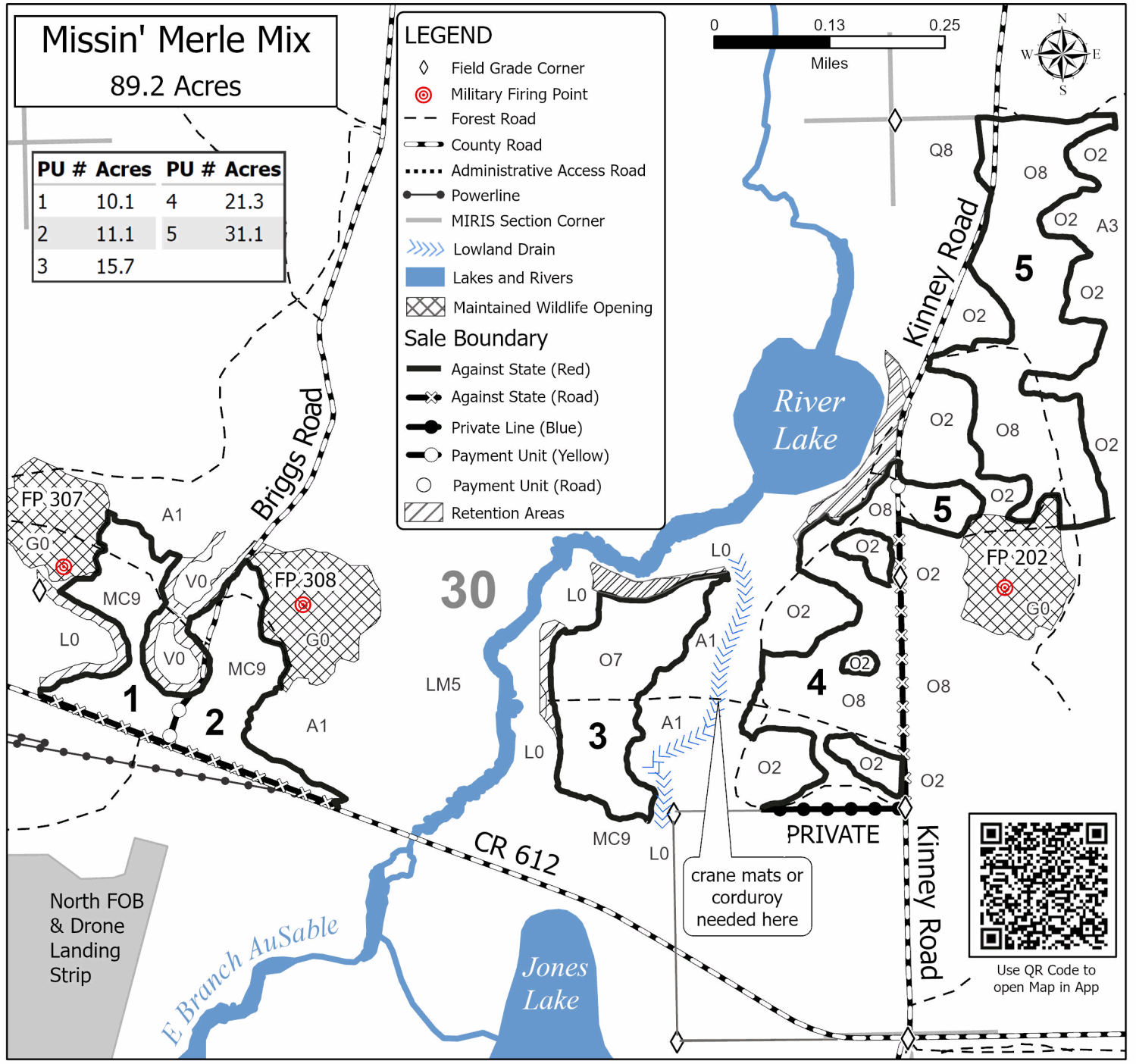
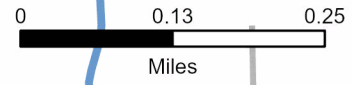

Use QR Code to open Map in App

TIMBER SALE INFORMATION

Up In Smoak (72-631-24)

T28N, R02W, SEC. 28; T28N, R02W, SEC. 29.
Crawford County (Advertised Price \$96,985.85)

SALE NOTE: Sale not on certified land. Military land, chipping required, contains standard military specs. Contract has 4 year duration due to military timing restrictions. Soft Oak will timing restrictions applied for Payment Units 1-8, however, the DNR may deny any requests to operate during the restricted time frame.

Stick nest located in Payment Unit 3 during layout. If the biologist finds nest to be active, Payment Unit 3 will be removed from the Sale Area. An additional 5 chain timing restricted zone around the nest will be implemented in Payment Unit 3 where no operations can take place between March 15 and July 15.

A timber sale contract for this lump sum, sealed bid timber sale will be awarded to the responsible bidder offering the highest sealed bid price. All units of volume listed below were estimated using the Inventory Manager computer program and the new Michigan taper model. Bids must be at or above the following advertised price for each product and species:

<u>PRODUCTS & SPECIES</u>	<u>ESTIMATED UNITS*</u>	<u>ADVERTISED PRICE</u>
Sawtimber		
Black/Red (Hybrid) Oak	317.9 MBF	\$ 138.00 / MBF
White Oak	59.9 MBF	\$ 121.00 / MBF
Pulpwood		
Mixed Aspen	38 Cords	\$ 26.15 / Cord
Mixed Hardwood	171 Cords	\$ 32.15 / Cord
Mixed Oak	1,477 Cords	\$ 24.80 / Cord
Red Pine	34 Cords	\$ 48.15 / Cord
White Pine	54 Cords	\$ 20.55 / Cord

* The total volume is statistically estimated within plus (+) or minus (-) 9.97 percent. There are an estimated 2,661 cords on this timber sale, plus or minus 265 cords at the 95% confidence level. The estimated units are final and not subject to adjustment. Prospective bidders are urged to examine this timber and to make their own estimates of quantity and quality.

BOND AND PAYMENT SCHEDULE:

1. A bond in the amount of \$4,849.00 to insure faithful performance of the conditions of the contract will be deposited by the successful bidder within 21 days of the sale award.
2. Cutting in any sale or unit without the required advance payment would be considered a trespass.
3. Total payment must be paid in advance or according to the following schedule :
 - (a) Ten percent (10%) of the sale value must be paid within 21 days of the sale award.
 - (b) The 10% down payment will be credited towards the first unit cut.
 - (c) Payment for each of the following units must be made before cutting begins in that unit:

PAYMENT UNIT NUMBER	PERCENT OF TOTAL SALE VALUE
01	6.5%
02	17.7%
03	3.7%
04	8.6%
05	7.8%
06	19.5%
07	12.4%
08	23.8%

4. If no cutting takes place, the 10% down payment will not be refunded.
5. Operations on the contract issued will terminate on 03/31/2029.

SALE STATISTICS

Volumes were calculated in cubic feet using the Michigan taper model. Cubic foot volume includes all wood inside bark for the product indicated. For display purposes, cubic feet were converted to cords and MBF using a simple conversion factor, e.g. 79 cubic feet per cord and 185 cubic feet per MBF. The cubic foot volumes are precise; the cords and MBF volumes are not. Cubic foot volume cannot be directly converted to cords or boards with precision.

SALE VOLUMES

The total estimated sale volume may not equal the sum of the species/products due to the nature of statistical calculations associated with double sampling methodology.

VOLUME			STATISTICAL RANGE IN CORDS	
TOTAL CUBIC FEET	TOTAL CORDS	PERCENT ERROR	MINIMUM	MAXIMUM
210,254	2,661	9.97%	2,396	2,927

VDU VOLUMES

A VDU is a Volume Determination Unit. Volumes and their associated statistics are calculated at the VDU level and summarized to the sale level. There is often a one to one relationship between a VDU and a Payment Unit, but not always, depending on the cruise design. Refer to the VDU TO PAYMENT UNIT table.

	VOLUME			RANGE IN CORDS	
VDU	TOTAL CUBIC FEET	TOTAL CORDS	PERCENT ERROR	MINIMUM	MAXIMUM
53	33,310	422	25.17%	316	528
54	40,013	506	29.51%	357	656
55	16,511	209	35.14%	136	282
59	90,673	1,148	14.29%	984	1,312
155	5,092	64	59.76%	26	103
159	24,654	312	23.65%	238	386
TOTAL:	210,254	2,661		2,056	3,267

VDU TO PAYMENT UNIT

When a VDU is associated with more than one Payment Unit (PU), the VDU volumes are assigned to the PU based on acres of the VDU within the PU.

VDU	VDU ACRES	PU	PU ACRES
53	42.0	1	17.9
53	42.0	4	24.1
54	20.7	2	19.3
54	20.7	3	1.4
55	29.8	5	29.8
59	46.0	6	20.8
59	46.0	8	25.2
155	8.6	3	8.6
159	9.8	7	9.8
TOTAL:	265.6		156.9

DESCRIPTION OF TIMBER BY PAYMENT UNIT (PU)

PU	MARKET GROUP	PRODUCT	QUANTITY	UNIT	ACRES	ADVERTISE PRICE				
1	Black/Red (Hybrid /Red (Hybrid) Oak Red Oak White Oak Mixed Aspen B. T. Aspen Quaking Aspen Mixed Hardwood Red Maple Red Maple Mixed Oak /Red (Hybrid) Oak Red Oak White Oak Red Pine White Pine Scotch Pine White Pine	Sawtimber	15.9	MBF	17.9	\$6,257.30				
			6.1	MBF						
			9.8	MBF						
			6.2	MBF						
		Pulpwood	9	Cords						
			8	Cords						
			1	Cords						
			25	Cords						
		Sawtimber	0.9	MBF						
		Pulpwood	23	Cords						
			74	Cords						
			35	Cords						
			25	Cords						
			14	Cords						
			1	Cords						
			19	Cords						
			14	Cords						
	5	Cords								
2	Black/Red (Hybrid /Red (Hybrid) Oak Northern Pin Oak White Oak Mixed Aspen B. T. Aspen Mixed Hardwood Red Maple Mixed Oak /Red (Hybrid) Oak Northern Pin Oak White Oak Red Pine White Pine White Pine	Sawtimber	65.5	MBF	19.3	\$17,169.25				
			2.8	MBF						
			62.7	MBF						
			0.7	MBF						
		Pulpwood	9	Cords						
			9	Cords						
			15	Cords						
			15	Cords						
			288	Cords						
			69	Cords						
			209	Cords						
			10	Cords						
			3	Cords						
			2	Cords						
			2	Cords						
		3	Black/Red (Hybrid /Red (Hybrid) Oak Northern Pin Oak Mixed Aspen B. T. Aspen Mixed Hardwood Red Maple Mixed Oak /Red (Hybrid) Oak Northern Pin Oak White Oak Red Pine White Pine White Pine White Pine	Sawtimber			10.0	MBF	10.0	\$3,590.00
							0.2	MBF		
	9.8			MBF						
Pulpwood	1			Cords						
	1			Cords						
	20			Cords						
	20			Cords						
	43			Cords						
	5			Cords						
	37			Cords						
	1			Cords						
	9			Cords						
	2			Cords						
Sawtimber	0.4			MBF						
Pulpwood	1			Cords						
4	Black/Red (Hybrid /Red (Hybrid) Oak Red Oak White Oak Mixed Aspen B. T. Aspen Quaking Aspen Mixed Hardwood			Sawtimber	21.4	MBF	24.1	\$8,364.35		
					8.2	MBF				
			13.2	MBF						
			8.4	MBF						
		Pulpwood	11	Cords						
			10	Cords						
			1	Cords						
			33	Cords						

DESCRIPTION OF TIMBER BY PAYMENT UNIT (PU), CON'T

PU	MARKET GROUP	PRODUCT	QUANTITY	UNIT	ACRES	ADVERTISE PRICE
4 con't	<i>Red Maple</i>	<i>Sawtimber</i>	1.1	<i>MBF</i>		
	<i>Red Maple</i>	<i>Pulpwood</i>	31	<i>Cords</i>		
	Mixed Oak		101	Cords		
	<i>/Red (Hybrid) Oak</i>		47	<i>Cords</i>		
	<i>Red Oak</i>		34	<i>Cords</i>		
	<i>White Oak</i>		20	<i>Cords</i>		
	Red Pine		1	Cords		
	White Pine		24	Cords		
	<i>Scotch Pine</i>		18	<i>Cords</i>		
	<i>White Pine</i>		6	<i>Cords</i>		
5	Black/Red (Hybrid)	Sawtimber	21.6	MBF	29.8	\$7,609.75
	<i>/Red (Hybrid) Oak</i>		3.1	<i>MBF</i>		
	<i>Northern Pin Oak</i>		1.4	<i>MBF</i>		
	<i>Red Oak</i>		17.1	<i>MBF</i>		
	White Oak		7.8	MBF		
	Mixed Hardwood	Pulpwood	29	Cords		
	<i>Black Cherry</i>		1	<i>Cords</i>		
	<i>Red Maple</i>		28	<i>Cords</i>		
	Mixed Oak		111	Cords		
	<i>/Red (Hybrid) Oak</i>		48	<i>Cords</i>		
	<i>Northern Pin Oak</i>		11	<i>Cords</i>		
	<i>Red Oak</i>		43	<i>Cords</i>		
	<i>White Oak</i>		9	<i>Cords</i>		
	6	Black/Red (Hybrid)	Sawtimber	60.9		
<i>/Red (Hybrid) Oak</i>			0.3	<i>MBF</i>		
<i>Red Oak</i>			60.6	<i>MBF</i>		
White Oak			14.2	MBF		
Mixed Aspen		Pulpwood	1	Cords		
<i>Quaking Aspen</i>			1	<i>Cords</i>		
Mixed Hardwood			17	Cords		
<i>Red Maple</i>			17	<i>Cords</i>		
Mixed Oak			313	Cords		
<i>/Red (Hybrid) Oak</i>			4	<i>Cords</i>		
<i>Red Oak</i>			212	<i>Cords</i>		
<i>White Oak</i>			97	<i>Cords</i>		
Red Pine			9	Cords		
White Pine			3	Cords		
<i>White Pine</i>			3	<i>Cords</i>		
7	Black/Red (Hybrid)	Sawtimber	48.8	MBF	9.8	\$12,058.65
	<i>Red Oak</i>		48.8	<i>MBF</i>		
	White Oak		5.3	MBF		
	Mixed Aspen	Pulpwood	5	Cords		
	<i>B. T. Aspen</i>		5	<i>Cords</i>		
	Mixed Hardwood		12	Cords		
	<i>Red Maple</i>		12	<i>Cords</i>		
	Mixed Oak		168	Cords		
	<i>Red Oak</i>		119	<i>Cords</i>		
	<i>White Oak</i>		49	<i>Cords</i>		
8	Black/Red (Hybrid)	Sawtimber	73.8	MBF	25.2	\$22,984.05
	<i>/Red (Hybrid) Oak</i>		0.3	<i>MBF</i>		
	<i>Red Oak</i>		73.5	<i>MBF</i>		
	White Oak		17.3	MBF		
	Mixed Aspen	Pulpwood	2	Cords		
	<i>Quaking Aspen</i>		2	<i>Cords</i>		
	Mixed Hardwood		20	Cords		
	<i>Red Maple</i>		20	<i>Cords</i>		

DESCRIPTION OF TIMBER BY PAYMENT UNIT (PU), CON'T

PU	MARKET GROUP	PRODUCT	QUANTITY	UNIT	ACRES	ADVERTISE PRICE
8 con't	Mixed Oak	Pulpwood	379	Cords		
	<i>/Red (Hybrid) Oak</i>		5	<i>Cords</i>		
	<i>Red Oak</i>		257	<i>Cords</i>		
	<i>White Oak</i>		117	<i>Cords</i>		
	Red Pine		11	Cords		
	White Pine		4	Cords		
	<i>White Pine</i>		4	<i>Cords</i>		
TOTAL:			377.8	MBF		
TOTAL:			1,774	Cords		

Sale Specific Conditions & Requirements

Sale Name: Up In Smoak

Sale Number: 72-631-24 Seq#: 2

1 - Sale Area

1.2 - Boundaries

1.2.1 - Painted Boundaries (9/19)

The sale boundary and Payment Unit boundaries are marked and identified by blue, red and yellow paint, as well as roads. Exterior sale boundary lines against private property are marked with blue paint. Exterior sale boundary lines against state are marked with red paint, with the exception of the sale boundary adjacent to County Road 612, which is unpainted and designated by the road, and the western boundary of Payment Units 1 and 4, which are unpainted and designated by the clearcut and existing forest road. Interior Payment Unit boundaries are marked with yellow paint. Retention patches are marked with red paint; no harvesting activities may occur within these areas. The painted boundary line trees are not Included Timber and are to be protected. Yellow painted trees designating an interior Payment Unit boundary are only to be cut when all surrounding Payment Units have been paid.

2 - Timber Specifications

2.1 - Included Timber

2.1.1 - Clearcut Unit(s) with Unmerchantable Trees (6/14)

Within Payment Unit(s) 2-3 and 6-8, cut all trees that are two (2) inches or more at DBH, except within Payment Units 2-3, do not cut any white oak.

2.1.2 - Clearcut Unit(s) w/o Unmerchantable Trees (8/11)

Within Payment Unit(s) 1 and 4-5, cut all trees which meet minimum piece specifications in 2.2 Utilization.

2.2 - Utilization

2.2.2 - Chipping required (2/18)

This area must be chip harvested to meet National Guard requirements. However, the chipping requirement could be waived with military approval, if chip markets are depressed. The Purchaser has the option to produce sawlogs or pulpwood bolts, but the remaining portion of the trees must be chipped and hauled. The requirement to retain approximately 1/6 to 1/3 of tree tops and limbs less than four inches in diameter does not apply (G. C. & R. 2.2).

2.2.3 - Stump heights (4/07)

Stump heights within the Sale Area shall not exceed 6 inches for all trees. This is in order to facilitate military requirements.

3 - Payments

3.4 - Damaged Timber

3.4.1 - Damaged timber (7/16)

General Condition and Requirement 3.4 Damaged Timber, defines liquidated damages for undesignated live merchantable trees which are cut or injured. In addition, reasonable care should be taken to avoid damage to tree seedlings and saplings within Payment Units 1 and 4-5. Within Payment Units 1, 4, and 5, if more than 30% of the tree seedlings or saplings (1/4" to 4.5" DBH) within a specified portion of the Sale Area are damaged, liquidated damages will be assessed at \$400 per acre for all acreage within that specified portion of the Sale Area that was damaged.

Trees cut cleanly for skid trails and operability will not count as damaged. Within Payment Units 2 and 3, if more than 5% of trees (>4.5" DBH) within a specified area of the sale are damaged, liquidated damages will be assessed for all trees damaged. Rates will be in accordance with General Condition and Requirement 3.4 Damaged Timber.

4 - Transportation

4.1 - Construction

4.1.3 - Slash and Earthen Piles (8/04)

Piles or windrows of earth along roads and landings that have been widened or constructed shall be leveled. Slash from road

maintenance or construction, including stumps, shall be chipped, utilized or otherwise removed from the sale.

4.1.6 - Road Construction (4/24)

Construction of new roads or improvements of existing roads shall be done in such a way as to minimize the environmental and visual impacts. Merchantable trees shall be cut and utilized unless otherwise directed. Non-merchantable trees shall be severed and laid flat on the ground. Slash shall be chipped, utilized or otherwise removed from the sale. Stumps shall be set upright, not left on edge, and be moved at least 10 feet away from the road edge. Disturbed soil shall be feathered into the woods and not left in berms or windrows.

4.1.7 - Road Closure (10/11)

All new roads built into the sale must be blocked to vehicle traffic upon completion of the sale. Overgrown roads that are reopened shall be considered new roads. Some existing roads may also need to be closed. In general, this will require constructing a four (4') foot high berm of stumps and logs covered with earth. These roads must be rendered impassable to cars and trucks. All stumps from road building and landing construction must be reserved to block any newly constructed roads upon completion of the sale. These stumps must be scattered along the road system to prohibit vehicular movement. Temporary berms may be required if no sale activity occurs for 30 or more consecutive days. Contact the Sale Administrator for specific details of design and placement.

5 - Operations

5.1 - Notification

5.1.4 - Post-Sale Conference (10/16)

A post-sale conference on site between the Purchaser and sale administrator is required 5 days prior to the completion of active logging operations to determine clean-up and repair of landings, road edges, and the fulfillment of other contract specifications.

5.1.5 - National Guard notification (2/15)

This sale is upon lands utilized for training by the Michigan National Guard - Camp Grayling. A minimum of five (5) business days prior to opening this sale, the producer must request that the sale administrator contact the military for information regarding training plans that may impact sale operations.

5.1.6 - Utility R.O.W. (4/19)

It is the responsibility of the Purchaser to obtain permission from the utility company to utilize the power line R.O.W. for operations.

5.2 - Conduct of Operations

5.2.2 - Hazard Trees/Snags

5.2.2.1 - Den Trees (10/16)

Obvious hollow and/or den trees shall be protected and left standing unless they are a safety hazard.

5.2.3 - Operating Restrictions

5.2.3.5 - Oak Wilt Restriction (1/18)

Within Payment Units 1-8, unless changed by written agreement, cutting, skidding, hauling within the sale and brushing of access roads to the sale are not permitted during the period of April 15 to July 15. Operations may be allowed if specific steps are taken to prevent damaging uncut oak during the high-risk period. Those steps may include completing all road brushing before April 15 and clearing a tree-length buffer along uncut oak cover before April 15. This is necessary to reduce the spread of oak wilt. For more information, contact the Unit Manager or his/her representative.

5.2.3.7 - National Guard training restriction (1/09)

Operations on this contract may not be allowed during National Guard training operations. Typically, the restricted period is from May 1 to October 31. The contractor must check with the Unit Manager who will coordinate the cutting schedule with the Military. All harvest equipment and timber products must be removed from the sale area during the period of May 1 to October 31.

5.2.29 - Shrub Protection (1/20)

Reasonable care should be taken to avoid cutting hawthorn or junberry. These woody-shrub plants are highly beneficial to various wildlife species.

5.2.32 - Decking/Landing Restoration (9/13)

All decking and landing areas must have the surface area restored to a condition equal to or better than before. This is to ensure the proper regeneration of the stand. Wood debris, chips and "cookies" from trimmings must be removed or scattered away from landing and loading areas and may not be windrowed on the edge.

5.2.38 - No Decking Against Live Trees (2/04)

Cut products may not be decked against unmarked or designated leave trees.

5.8 - Protection of Endangered Species

5.8.5 - Protection of Raptor Nests (3/13)

Payment Unit 3 has a stick nest and will need to be evaluated by Wildlife Biologist. If nest is determined to be active, removal of acres amendment will be needed, and the unit will be removed from the Sale Area. All trees with raptor nests will be protected if found during harvesting operations. Notification will be made to the Unit Manager or his/her representative who will notify the Wildlife Biologist so an onsite evaluation and recommendation can be made, if necessary. An additional zone of five chains (ten chains total centered on the active nest tree) will be established in which there is no management activity from March 15 to July 15. Limit biomass harvesting and chipping operations within this ten-chain zone, retain the maximum one-third of residues per the Woody Biomass Harvesting Guidelines (Michigan DNR 2010). Nests determined to be inactive will be protected with a one-chain no-harvest buffer.

6 - Safety and Fire Prevention

6.2 - Signing

6.2.1 - Road Posting (10/20)

The Purchaser is responsible for posting and maintaining caution signs on County Road 612 prior to beginning operations. The road must be posted at appropriate distances from the Sale Area to warn of logging activity and truck traffic. Signs must be removed when harvest operations are suspended or completed. The Purchaser will provide these signs.

7 - Other Conditions

7.10 - Certified Timber

7.10.1 - Non-Certified Timber (2/16)

The area encompassed by this timber sale is not certified to the standards of the Forest Stewardship Council (FSC) or the Sustainable Forestry Initiative (SFI). Forest products from this sale may not be delivered to the mill as "FSC and / or SFI certified". The lands within this sale are managed for military training.



TIMBER SALE MAP

This information provided by authority of Part 525, 1994 PA 451, as amended.

Sale Number 72-631-24	Date 02/18/2025
Scale 1:12,780	Page 1
	Of 1

Forest Management Unit Grayling Mgt Unit	County Crawford	Mapped By: Porteous Cruised By: Porteous/Michaud
---	--------------------	---

Township 28N	Range 02W	Section(s) and Subdivision(s) Sec. 28 NW,N1/2SW,SESW; Sec. 29 E1/2NE,NESE;
-----------------	--------------	--

Cover Type			
A = Aspen	J = Jack Pine	O = Oak	U = Upland Brush
B = Paper Birch	K = Rock	P = Lowland Poplar	UM = Upland Mix Forest
C = Cedar	L = Lowland Brush	Q = Mixed Swamp Conifer	V = Bog or Marsh
D = Treed Bog	LM = Lowland Mix Forest	R = Red Pine	W = White Pine
E = Swamp Hardwoods	M = Maple, Beech, Birch	S = Black Spruce	X = Non Stocked
F = Spruce/Fir	MC = Mixed Conifer	T = Tamarack	Y = Sand
G = Grass	MD = Mixed Deciduous	Z = Water	
H = Hemlock	N = Marsh		

Density	
0 = Non Stocked	5 = Pole Timber Medium
1 = Seedling Sapling Poor	6 = Pole Timber Well
2 = Seedling Sapling Medium	7 = Saw Timber Poor
3 = Seedling Sapling Well	8 = Saw Timber Medium
4 = Pole Timber Poor	9 = Saw Timber Well

Payment Unit Number	Acres	Payment Unit Number	Acres
1	17.9	5	29.8
2	19.3	6	20.8
3	10	7	9.8
4	24	8	25.2

Up In Smoak

Comp 250

156.9 Acres

Locator Map 1:200,000

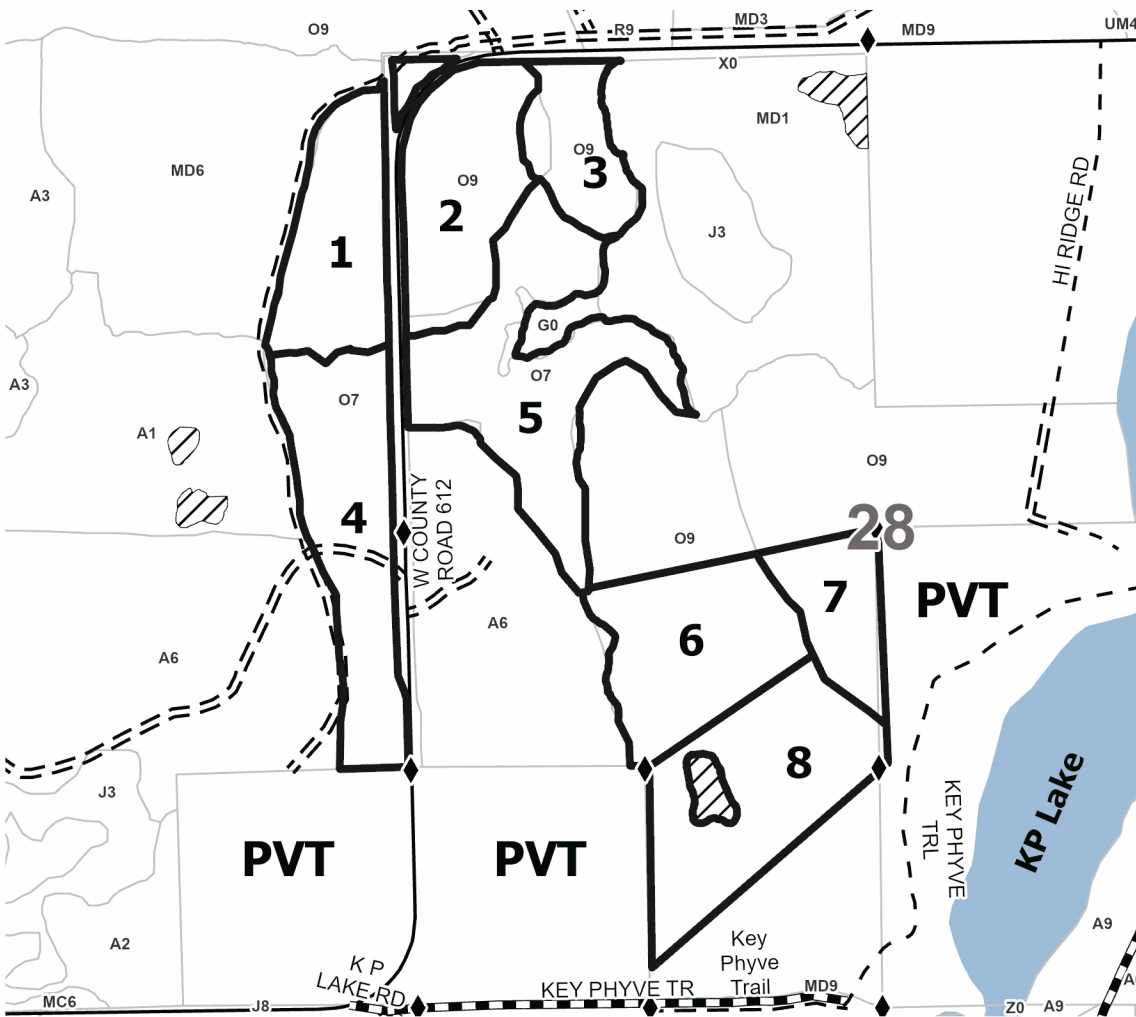
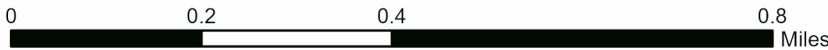
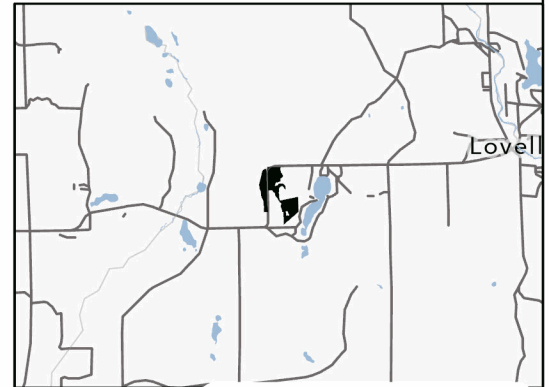

Legend

- Lakes and Rivers
- Forest Access Route
- Paved Road
- Government Gravel/Dirt
- Private Gravel/Dirt
- Recreational Trails
- Survey Corner
- Against State (Red)

Use QR Code to open Map in App



Little Shop of Borers (72-601-25)
T27N, R01W, SEC. 7; T27N, R01W, SEC. 8; Crawford COUNTY

In response to the notice of sale to be held 9:00 a.m. (local time) on March 24, 2025, I am hereby submitting my sealed bid (firm offer) for the following forest products to be cut. Bids for individual species must be at or above the advertised price. All non-responsive bid forms may be rejected.

<u>PRODUCTS & SPECIES</u>	<u>ESTIMATED VOLUME*</u>	<u>ADVERTISED PRICE</u>	<u>BID PRICE/UNIT</u>
Sawtimber			
Black/Red (Hybrid) Oak	9.6 MBF	\$ 138.00/MBF	\$ _____
Northern Pin Oak	5.3 MBF	\$ 138.00/MBF	\$ _____
Pulpwood			
B. T. Aspen	21 Cords	\$ 26.15/Cord	\$ _____
Black Cherry	1 Cords	\$ 32.15/Cord	\$ _____
Jack Pine	278 Cords	\$ 23.35/Cord	\$ _____
Misc. Species 2	7 Cords	\$ 5.00/Cord	\$ _____
Mixed Oak	103 Cords	\$ 24.80/Cord	\$ _____
Red Maple	8 Cords	\$ 32.15/Cord	\$ _____
Red Pine	1,640 Cords	\$ 48.15/Cord	\$ _____

*The volumes are statistically estimated within plus (+) or minus (-) 15.66 percent at 95% confidence level. These estimated volumes are final and not subject to adjustment. Prospective bidders are urged to examine this timber and to make their own estimates of quantity and quality.

I understand that any or all bids may be rejected. All bids must be signed and all bid items must be bid or the bid form may be rejected. I also understand that consideration and awarding a contract will be based upon my past performance and ability to complete the contract based upon equipment and staffing subject to my control.

FEDERAL ID: ____ - ____ - ____ or SOCIAL SECURITY NUMBER: ____ - ____ - ____

Company or individual bidding: _____

Company representative's name: _____

Address: _____

City: _____ State: _____ Zip: _____

IF AVAILABLE, PLEASE PLACE THE PERSONALIZED LABEL FROM YOUR PROSPECTUS IN THE ABOVE BOX.

Individual or company representative's signature: _____ Date: _____

Phone number : _____ Email (optional): _____

THE WINNING BIDDER MUST COMPLETE THE VERIFICATION OF WORKER'S DISABILITY COMPENSATION ACT COMPLIANCE (ON REVERSE SIDE IF DOUBLE SIDED) WITHIN 21 DAYS OF SALE AWARD DATE



FOR DEPARTMENT USE ONLY	
Sale Number (XX - XXX - XX - XX)	
Forest Management Unit:	

TIMBER SALE VERIFICATION OF WORKER'S DISABILITY COMPENSATION ACT COMPLIANCE

As required by Act 317, P.A. 1969 (Worker's Compensation) and
Part 5 of Act 451 of 1994, as amended.

VERIFICATION OF WORKER'S DISABILITY COMPENSATION ACT COMPLIANCE

- This verification must be completed and submitted within 21 days of contract award and prior to the issuance of the timber sale contract.
- In addition, if boxes 2B or 2C are checked, then Notice of Exclusion or Certificate of Insurance must be submitted within twenty-one (21) days of the contract award and prior to the issuance of the timber sale contract.
- All information must be typed or printed except for written signatures.

Please Check Appropriate Categories:

1. My business is organized as (you **must** check one of the boxes below):
 - A. Sole Proprietorship (individual)
 - B. Partnership
 - C. Corporation
2. You **must** check one of the boxes below:
 - A. I certify my business is a sole proprietorship and it has no employees but the sole proprietor. I am not subject to the Worker's Compensation Laws.
 - B. I certify my business has satisfied its obligation to the Worker's Compensation Act through the use of an approved Notice of Exclusion (BWC-337, Rev. 5/96). I will provide a copy of the Notice of Exclusion within 21 days of the contract award. (For questions or a copy of the BWC-337, please call the Worker's Compensation Bureau at 517-322-1195).
 - C. I certify my business has a Worker's Compensation Policy. I will provide an original Certificate of Insurance within twenty-one (21) days of the contract award.
3. If you have checked item 2(A) or 2(B), you **must** indicate the number of **both** full-time and part-time employees, other than yourself, including family members and active partners (if none, you must enter "0").

_____ Full-time Employees

_____ Part-time Employees

Name of Business		Federal ID (or) Social Security No.	
Address		Telephone ()	
City	State	ZIP	

I hereby certify that the above information is true and correct. I agree to notify the Michigan DNR of any changes that occur in factors affecting my coverage during any of my present and future operations.

Signature of Owner or Authorized Representative

Title

Date

Please complete the "SEALED BID" information on the next page

Choppenheimer (72-620-24)
T28N, R02W, SEC. 10; Crawford COUNTY

In response to the notice of sale to be held 9:00 a.m. (local time) on March 24, 2025, I am hereby submitting my sealed bid (firm offer) for the following forest products to be cut. Bids for individual species must be at or above the advertised price. All non-responsive bid forms may be rejected.

<u>PRODUCTS & SPECIES</u>	<u>ESTIMATED VOLUME*</u>	<u>ADVERTISED PRICE</u>	<u>BID PRICE/UNIT</u>
Sawtimber			
Mixed Oak	72.1 MBF	\$ 138.00/MBF	\$ _____
Pulpwood			
Misc. Species 2	4 Cords	\$ 7.50/Cord	\$ _____
Mixed Aspen	1,106 Cords	\$ 26.15/Cord	\$ _____
Mixed Hardwood	221 Cords	\$ 32.15/Cord	\$ _____
Mixed Oak	402 Cords	\$ 24.80/Cord	\$ _____
White Pine	19 Cords	\$ 20.55/Cord	\$ _____

*The volumes are statistically estimated within plus (+) or minus (-) 18.35 percent at 95% confidence level. These estimated volumes are final and not subject to adjustment. Prospective bidders are urged to examine this timber and to make their own estimates of quantity and quality.

I understand that any or all bids may be rejected. All bids must be signed and all bid items must be bid or the bid form may be rejected. I also understand that consideration and awarding a contract will be based upon my past performance and ability to complete the contract based upon equipment and staffing subject to my control.

FEDERAL ID: _____ - _____ or SOCIAL SECURITY NUMBER: _____ - _____ - _____

Company or individual bidding: _____

Company representative's name: _____

Address: _____

City: _____ State: _____ Zip: _____

IF AVAILABLE, PLEASE PLACE THE PERSONALIZED LABEL FROM YOUR PROSPECTUS IN THE ABOVE BOX.

Individual or company representative's signature: _____ Date: _____

Phone number : _____ Email (optional): _____

THE WINNING BIDDER MUST COMPLETE THE VERIFICATION OF WORKER'S DISABILITY COMPENSATION ACT COMPLIANCE (ON REVERSE SIDE IF DOUBLE SIDED) WITHIN 21 DAYS OF SALE AWARD DATE

Raiders of the Lost Bark (72-626-24)
T28N, R02W, SEC. 11; T28N, R02W, SEC. 14; Crawford COUNTY

In response to the notice of sale to be held 9:00 a.m. (local time) on March 24, 2025, I am hereby submitting my sealed bid (firm offer) for the following forest products to be cut. Bids for individual species must be at or above the advertised price. All non-responsive bid forms may be rejected.

<u>PRODUCTS & SPECIES</u>	<u>ESTIMATED VOLUME*</u>	<u>ADVERTISED PRICE</u>	<u>BID PRICE/UNIT</u>
Sawtimber			
Red Oak	279.3 MBF	\$ 110.00/MBF	\$ _____
Pulpwood			
B. T. Aspen	230 Cords	\$ 20.90/Cord	\$ _____
Misc. Species 2	35 Cords	\$ 5.00/Cord	\$ _____
Misc. Species 3	49 Cords	\$ 4.00/Cord	\$ _____
Mixed Hardwood	295 Cords	\$ 25.75/Cord	\$ _____
Mixed Oak	1,639 Cords	\$ 19.85/Cord	\$ _____

*The volumes are statistically estimated within plus (+) or minus (-) 13.17 percent at 95% confidence level. These estimated volumes are final and not subject to adjustment. Prospective bidders are urged to examine this timber and to make their own estimates of quantity and quality.

I understand that any or all bids may be rejected. All bids must be signed and all bid items must be bid or the bid form may be rejected. I also understand that consideration and awarding a contract will be based upon my past performance and ability to complete the contract based upon equipment and staffing subject to my control.

FEDERAL ID: _____ - _____ or SOCIAL SECURITY NUMBER: _____ - _____ - _____

Company or individual bidding: _____

Company representative's name: _____

Address: _____

City: _____ State: _____ Zip: _____

IF AVAILABLE, PLEASE PLACE THE PERSONALIZED LABEL FROM YOUR PROSPECTUS IN THE ABOVE BOX.

Individual or company representative's signature: _____ Date: _____

Phone number : _____ Email (optional): _____

THE WINNING BIDDER MUST COMPLETE THE VERIFICATION OF WORKER'S DISABILITY COMPENSATION ACT COMPLIANCE (ON REVERSE SIDE IF DOUBLE SIDED) WITHIN 21 DAYS OF SALE AWARD DATE



FOR DEPARTMENT USE ONLY
Sale Number (XX - XXX - XX - XX)
Forest Management Unit:

TIMBER SALE VERIFICATION OF WORKER'S DISABILITY COMPENSATION ACT COMPLIANCE

*As required by Act 317, P.A. 1969 (Worker's Compensation) and
Part 5 of Act 451 of 1994, as amended.*

VERIFICATION OF WORKER'S DISABILITY COMPENSATION ACT COMPLIANCE

- This verification must be completed and submitted within 21 days of contract award and prior to the issuance of the timber sale contract.
- In addition, if boxes 2B or 2C are checked, then Notice of Exclusion or Certificate of Insurance must be submitted within twenty-one (21) days of the contract award and prior to the issuance of the timber sale contract.
- All information must be typed or printed except for written signatures.

Please Check Appropriate Categories:

1. My business is organized as (you **must** check one of the boxes below):
 - A. Sole Proprietorship (individual)
 - B. Partnership
 - C. Corporation

2. You **must** check one of the boxes below:
 - A. I certify my business is a sole proprietorship and it has no employees but the sole proprietor. I am not subject to the Worker's Compensation Laws.
 - B. I certify my business has satisfied its obligation to the Worker's Compensation Act through the use of an approved Notice of Exclusion (BWC-337, Rev. 5/96). I will provide a copy of the Notice of Exclusion within 21 days of the contract award. (For questions or a copy of the BWC-337, please call the Worker's Compensation Bureau at 517-322-1195).
 - C. I certify my business has a Worker's Compensation Policy. I will provide an original Certificate of Insurance within twenty-one (21) days of the contract award.

3. If you have checked item 2(A) or 2(B), you **must** indicate the number of **both** full-time and part-time employees, other than yourself, including family members and active partners (if none, you must enter "0").

_____ Full-time Employees

_____ Part-time Employees

Name of Business		Federal ID (or) Social Security No.	
Address		Telephone ()	
City	State	ZIP	

I hereby certify that the above information is true and correct. I agree to notify the Michigan DNR of any changes that occur in factors affecting my coverage during any of my present and future operations.

Signature of Owner or Authorized Representative

Title

Date

Please complete the "SEALED BID" information on the next page

Up In Smoak (72-631-24)
T28N, R02W, SEC. 28; T28N, R02W, SEC. 29; Crawford COUNTY

In response to the notice of sale to be held 9:00 a.m. (local time) on March 24, 2025, I am hereby submitting my sealed bid (firm offer) for the following forest products to be cut. Bids for individual species must be at or above the advertised price. All non-responsive bid forms may be rejected.

<u>PRODUCTS & SPECIES</u>	<u>ESTIMATED VOLUME*</u>	<u>ADVERTISED PRICE</u>	<u>BID PRICE/UNIT</u>
Sawtimber			
Black/Red (Hybrid) Oak	317.9 MBF	\$ 138.00/MBF	\$ _____
White Oak	59.9 MBF	\$ 121.00/MBF	\$ _____
Pulpwood			
Mixed Aspen	38 Cords	\$ 26.15/Cord	\$ _____
Mixed Hardwood	171 Cords	\$ 32.15/Cord	\$ _____
Mixed Oak	1,477 Cords	\$ 24.80/Cord	\$ _____
Red Pine	34 Cords	\$ 48.15/Cord	\$ _____
White Pine	54 Cords	\$ 20.55/Cord	\$ _____

*The volumes are statistically estimated within plus (+) or minus (-) 9.97 percent at 95% confidence level. These estimated volumes are final and not subject to adjustment. Prospective bidders are urged to examine this timber and to make their own estimates of quantity and quality.

I understand that any or all bids may be rejected. All bids must be signed and all bid items must be bid or the bid form may be rejected. I also understand that consideration and awarding a contract will be based upon my past performance and ability to complete the contract based upon equipment and staffing subject to my control.

FEDERAL ID: _____ or SOCIAL SECURITY NUMBER: _____

Company or individual bidding: _____

Company representative's name: _____

Address: _____

City: _____ State: _____ Zip: _____

IF AVAILABLE, PLEASE PLACE THE PERSONALIZED LABEL FROM YOUR PROSPECTUS IN THE ABOVE BOX.

Individual or company representative's signature: _____ Date: _____

Phone number : _____ Email (optional): _____

THE WINNING BIDDER MUST COMPLETE THE VERIFICATION OF WORKER'S DISABILITY COMPENSATION ACT COMPLIANCE (ON REVERSE SIDE IF DOUBLE SIDED) WITHIN 21 DAYS OF SALE AWARD DATE



FOR DEPARTMENT USE ONLY	
Sale Number (XX - XXX - XX - XX)	
Forest Management Unit:	

TIMBER SALE VERIFICATION OF WORKER'S DISABILITY COMPENSATION ACT COMPLIANCE

As required by Act 317, P.A. 1969 (Worker's Compensation) and
Part 5 of Act 451 of 1994, as amended.

VERIFICATION OF WORKER'S DISABILITY COMPENSATION ACT COMPLIANCE

- This verification must be completed and submitted within 21 days of contract award and prior to the issuance of the timber sale contract.
- In addition, if boxes 2B or 2C are checked, then Notice of Exclusion or Certificate of Insurance must be submitted within twenty-one (21) days of the contract award and prior to the issuance of the timber sale contract.
- All information must be typed or printed except for written signatures.

Please Check Appropriate Categories:

1. My business is organized as (you **must** check one of the boxes below):
 - A. Sole Proprietorship (individual)
 - B. Partnership
 - C. Corporation
2. You **must** check one of the boxes below:
 - A. I certify my business is a sole proprietorship and it has no employees but the sole proprietor. I am not subject to the Worker's Compensation Laws.
 - B. I certify my business has satisfied its obligation to the Worker's Compensation Act through the use of an approved Notice of Exclusion (BWC-337, Rev. 5/96). I will provide a copy of the Notice of Exclusion within 21 days of the contract award. (For questions or a copy of the BWC-337, please call the Worker's Compensation Bureau at 517-322-1195).
 - C. I certify my business has a Worker's Compensation Policy. I will provide an original Certificate of Insurance within twenty-one (21) days of the contract award.
3. If you have checked item 2(A) or 2(B), you **must** indicate the number of **both** full-time and part-time employees, other than yourself, including family members and active partners (if none, you must enter "0").

_____ Full-time Employees

_____ Part-time Employees

Name of Business		Federal ID (or) Social Security No.	
Address		Telephone ()	
City	State	ZIP	

I hereby certify that the above information is true and correct. I agree to notify the Michigan DNR of any changes that occur in factors affecting my coverage during any of my present and future operations.

Signature of Owner or Authorized Representative

Title

Date

Please complete the "SEALED BID" information on the next page

Missin' Merle Mix (72-630-24)
T28N, R02W, SEC. 29; T28N, R02W, SEC. 30; Crawford COUNTY

In response to the notice of sale to be held 9:00 a.m. (local time) on March 24, 2025, I am hereby submitting my sealed bid (firm offer) for the following forest products to be cut. Bids for individual species must be at or above the advertised price. All non-responsive bid forms may be rejected.

<u>PRODUCTS & SPECIES</u>	<u>ESTIMATED VOLUME*</u>	<u>ADVERTISED PRICE</u>	<u>BID PRICE/UNIT</u>
Sawtimber			
Black/Red (Hybrid) Oak	56.8 MBF	\$ 138.00/MBF	\$ _____
Pulpwood			
Balsam Fir	24 Cords	\$ 24.10/Cord	\$ _____
Jack Pine	66 Cords	\$ 23.35/Cord	\$ _____
Mixed Aspen	195 Cords	\$ 26.15/Cord	\$ _____
Mixed Hardwood	24 Cords	\$ 32.15/Cord	\$ _____
Mixed Oak	450 Cords	\$ 24.80/Cord	\$ _____
Red Pine	314 Cords	\$ 48.15/Cord	\$ _____
White Pine	296 Cords	\$ 20.55/Cord	\$ _____

*The volumes are statistically estimated within plus (+) or minus (-) 14.26 percent at 95% confidence level. These estimated volumes are final and not subject to adjustment. Prospective bidders are urged to examine this timber and to make their own estimates of quantity and quality.

I understand that any or all bids may be rejected. All bids must be signed and all bid items must be bid or the bid form may be rejected. I also understand that consideration and awarding a contract will be based upon my past performance and ability to complete the contract based upon equipment and staffing subject to my control .

FEDERAL ID: ____ - ____ - ____ or SOCIAL SECURITY NUMBER: ____ - ____ - ____

Company or individual bidding: _____

Company representative's name: _____

Address: _____

City: _____ State: _____ Zip: _____

IF AVAILABLE, PLEASE PLACE THE PERSONALIZED LABEL FROM YOUR PROSPECTUS IN THE ABOVE BOX.

Individual or company representative's signature : _____ Date: _____

Phone number : _____ Email (optional): _____

THE WINNING BIDDER MUST COMPLETE THE VERIFICATION OF WORKER'S DISABILITY COMPENSATION ACT COMPLIANCE (ON REVERSE SIDE IF DOUBLE SIDED) WITHIN 21 DAYS OF SALE AWARD DATE



FOR DEPARTMENT USE ONLY	
Sale Number (XX - XXX - XX - XX)	
Forest Management Unit:	

TIMBER SALE VERIFICATION OF WORKER'S DISABILITY COMPENSATION ACT COMPLIANCE

As required by Act 317, P.A. 1969 (Worker's Compensation) and
Part 5 of Act 451 of 1994, as amended.

VERIFICATION OF WORKER'S DISABILITY COMPENSATION ACT COMPLIANCE

- This verification must be completed and submitted within 21 days of contract award and prior to the issuance of the timber sale contract.
- In addition, if boxes 2B or 2C are checked, then Notice of Exclusion or Certificate of Insurance must be submitted within twenty-one (21) days of the contract award and prior to the issuance of the timber sale contract.
- All information must be typed or printed except for written signatures.

Please Check Appropriate Categories:

1. My business is organized as (you **must** check one of the boxes below):
 - A. Sole Proprietorship (individual)
 - B. Partnership
 - C. Corporation
2. You **must** check one of the boxes below:
 - A. I certify my business is a sole proprietorship and it has no employees but the sole proprietor. I am not subject to the Worker's Compensation Laws.
 - B. I certify my business has satisfied its obligation to the Worker's Compensation Act through the use of an approved Notice of Exclusion (BWC-337, Rev. 5/96). I will provide a copy of the Notice of Exclusion within 21 days of the contract award. (For questions or a copy of the BWC-337, please call the Worker's Compensation Bureau at 517-322-1195).
 - C. I certify my business has a Worker's Compensation Policy. I will provide an original Certificate of Insurance within twenty-one (21) days of the contract award.
3. If you have checked item 2(A) or 2(B), you **must** indicate the number of **both** full-time and part-time employees, other than yourself, including family members and active partners (if none, you must enter "0").

_____ Full-time Employees

_____ Part-time Employees

Name of Business		Federal ID (or) Social Security No.	
Address		Telephone ()	
City	State	ZIP	

I hereby certify that the above information is true and correct. I agree to notify the Michigan DNR of any changes that occur in factors affecting my coverage during any of my present and future operations.

Signature of Owner or Authorized Representative

Title

Date

Please complete the "SEALED BID" information on the next page

Red Shouldered Pine Re-Do (72-004-25)
T28N, R03W, SEC. 31; T28N, R03W, SEC. 33; Crawford COUNTY

In response to the notice of sale to be held 9:00 a.m. (local time) on March 24, 2025, I am hereby submitting my sealed bid (firm offer) for the following forest products to be cut. Bids for individual species must be at or above the advertised price. All non-responsive bid forms may be rejected.

<u>PRODUCTS & SPECIES</u>	<u>ESTIMATED VOLUME*</u>	<u>ADVERTISED PRICE</u>	<u>BID PRICE/UNIT</u>
Pulpwood Red Pine	1,189 Cords	\$ 48.15/Cord	\$ _____

*The volumes are statistically estimated within plus (+) or minus (-) 14.31 percent at 95% confidence level. These estimated volumes are final and not subject to adjustment. Prospective bidders are urged to examine this timber and to make their own estimates of quantity and quality.

I understand that any or all bids may be rejected. All bids must be signed and all bid items must be bid or the bid form may be rejected. I also understand that consideration and awarding a contract will be based upon my past performance and ability to complete the contract based upon equipment and staffing subject to my control.

FEDERAL ID: ____ - ____ - ____ or SOCIAL SECURITY NUMBER: ____ - ____ - ____

Company or individual bidding: _____

Company representative's name: _____

Address: _____

City: _____ State: _____ Zip: _____

IF AVAILABLE, PLEASE PLACE THE PERSONALIZED LABEL FROM YOUR PROSPECTUS IN THE ABOVE BOX.

Individual or company representative's signature: _____ Date: _____

Phone number : _____ Email (optional): _____

THE WINNING BIDDER MUST COMPLETE THE VERIFICATION OF WORKER'S DISABILITY COMPENSATION ACT COMPLIANCE (ON REVERSE SIDE IF DOUBLE SIDED) WITHIN 21 DAYS OF SALE AWARD DATE



FOR DEPARTMENT USE ONLY	
Sale Number (XX - XXX - XX - XX)	
Forest Management Unit:	

TIMBER SALE VERIFICATION OF WORKER'S DISABILITY COMPENSATION ACT COMPLIANCE

As required by Act 317, P.A. 1969 (Worker's Compensation) and
Part 5 of Act 451 of 1994, as amended.

VERIFICATION OF WORKER'S DISABILITY COMPENSATION ACT COMPLIANCE

- This verification must be completed and submitted within 21 days of contract award and prior to the issuance of the timber sale contract.
- In addition, if boxes 2B or 2C are checked, then Notice of Exclusion or Certificate of Insurance must be submitted within twenty-one (21) days of the contract award and prior to the issuance of the timber sale contract.
- All information must be typed or printed except for written signatures.

Please Check Appropriate Categories:

1. My business is organized as (you **must** check one of the boxes below):
 - A. Sole Proprietorship (individual)
 - B. Partnership
 - C. Corporation
2. You **must** check one of the boxes below:
 - A. I certify my business is a sole proprietorship and it has no employees but the sole proprietor. I am not subject to the Worker's Compensation Laws.
 - B. I certify my business has satisfied its obligation to the Worker's Compensation Act through the use of an approved Notice of Exclusion (BWC-337, Rev. 5/96). I will provide a copy of the Notice of Exclusion within 21 days of the contract award. (For questions or a copy of the BWC-337, please call the Worker's Compensation Bureau at 517-322-1195).
 - C. I certify my business has a Worker's Compensation Policy. I will provide an original Certificate of Insurance within twenty-one (21) days of the contract award.
3. If you have checked item 2(A) or 2(B), you **must** indicate the number of **both** full-time and part-time employees, other than yourself, including family members and active partners (if none, you must enter "0").

_____ Full-time Employees

_____ Part-time Employees

Name of Business		Federal ID (or) Social Security No.	
Address		Telephone ()	
City	State	ZIP	

I hereby certify that the above information is true and correct. I agree to notify the Michigan DNR of any changes that occur in factors affecting my coverage during any of my present and future operations.

Signature of Owner or Authorized Representative

Title

Date

Please complete the "SEALED BID" information on the next page