



**DEPARTMENT OF NATURAL RESOURCES
STATE OF MICHIGAN
TIMBER SALE PROSPECTUS #7622**

SCHEDULED SALE DATE AND TIME: 9:00 a.m. (local time) on April 28, 2025.

LOCATION: GRAYLING MGMT UNIT, 1955 HARTWICK PINES ROAD, GRAYLING, MI 49738.

PROSPECTUS NOTE: The bidder is advised to inspect the sale area and review the location, estimated volumes, operating costs and contract terms of proposed sales. Please be aware that some landowners may request 60 days or more notice for access across their land.

Notice is hereby given that bids will be received by the Unit Manager, GRAYLING MANAGEMENT UNIT, for certain timber on the following described lands:

Big Creek Blues (72-009-24) / T28N, R01E, SEC. 26, S1/2NW, N1/2SW, SWSW.

T28N, R01E, SEC. 27, SE.

T28N, R01E, SEC. 34, NE.

Oscoda County, Advertised Price \$123,882.20, 158.0 Acres, Red Pine, Aspen, White Pine, Spruce/Fir/Tamarack.

SALE NOTE: Access into Sale Area is from Farrington Road which is a dirt/gravel road that is maintained. Farrington Road crosses East Branch Big Creek and has a culvert. This is an area of concern for erosion and damage to improvements. This sale has low ground in each of the Payment Units. Minimizing rutting is a priority. Accessing Payment Unit 3 will be done through existing but closed road that is accessed through Payment Unit 2 from the North Side of Farrington Road. There is a private line along the east side of the access road to Payment Units 1 and 2 South of Farrington Road. There is also Private line on the Northeast side of Payment Unit 3 which is a powerline. All payment units have diameter limit on Red and White pine. See specifications for those diameter limits. Most of these trees have been marked with green paint for reference.

Class Eh Mix (72-010-24) / T28N, R01E, SEC. 27, SENW, SW.

T28N, R01E, SEC. 33, SESE.

T28N, R01E, SEC. 34, NW, NWSW, S1/2SW.

Oscoda County, Advertised Price \$64,839.30, 160.1 Acres, Jack Pine, Red Pine.

SALE NOTE: Sale had been reduced to account for deteriorating timber and difficult operability. No material shall be fell or decked into wildlife opening adjacent to Payment Unit 3. Wildlife opening in Payment Unit 4 is to be cut and skid outside of opening to reduce slash and impact of operations. Rutting restrictions throughout Sale Area. Hard Oak wilt restriction on all Payment Units. Small portion of snowmobile trail shares access to Payment Unit 1.

A recreation site such as a trail, pathway, or campground is within the sale area or the vicinity. Certain restrictions/specifications may be applicable including time restrictions.

Runamok Lodge Mix (72-629-24) / T27N, R04W, SEC. 33, E1/2NW, W1/2NE.

Crawford County, Advertised Price \$18,777.85, 28.8 Acres, Hardwood, Aspen.

SALE NOTE: Sale not on certified land. Military land and specs apply. 3 year contract due to military timing restrictions. Soft Oak wilt timing restrictions applied for Payment Units 1 and 2, however the DNR may deny any requests to operate during the restricted timeframe. Access is on snowmobile trail, areas that are very sandy.

A recreation site such as a trail, pathway, or campground is within the sale area or the vicinity. Certain restrictions/specifications may be applicable including time restrictions.

C'mere Deer Mix (72-632-24) / T27N, R02W, SEC. 31, N1/2NE, SENE.

T27N, R02W, SEC. 32, N1/2NW, SWNW, SENE, N1/2SW, SESW.

T27N, R02W, SEC. 32, SWSE.

Crawford County, Advertised Price \$88,967.45, 218.0 Acres, Aspen, Hardwood.

SALE NOTE: Sale is on non-certified land. Standard military specifications, including possible unexploded ordinance.

Possible closures due to military training. Sandy access roads may require fill/more maintenance for trucking.

Oak wilt timing restrictions in Payment Units 1, 4, and 5.

BID INSTRUCTIONS (VER. 10/10/2022):

1. Scheduled Bid Location, Date, and Time (2/11)

Bids must be received by the Unit Manager, GRAYLING OFFICE, 1955 HARTWICK PINES ROAD, GRAYLING, MI 49738, no later than 9:00 a.m. (local time) on April 28, 2025. For further information concerning this sale, contact Scott McClarren at 989-348-6371 extension .

2. Bidder's Qualifications (10/22)

If all or part of a timber sale was prepared by a private contractor, the contractor and that contractor's company are not permitted to bid on the timber sale. A person must be 18 years of age or older to purchase timber. Permanent employees of the Department of Natural Resources or members of their immediate household may not bid. Former employees, in the permanent or seasonal class, may not bid until 3 months after the last day of active duty. Bids will not be accepted from individuals or companies appearing on the DNR/FRD No-Bid List. This list contains the names of purchasers who previously failed to execute a contract within 21-days or who have a history of poor performance.

3. Preparation of Sealed Bids (5/16)

Bid Forms may be completed online thru Michigan DNR Timber Sale Online Bidding (OLB) at www.michigan.gov/timberbidding or by completing the hardcopy Bid Form found in the Timber Sale Prospectus . Hardcopy Bid Forms shall be manually signed in ink. Registration in OLB is considered your 'signature' for all bids submitted thru that system. Bid prices must be entered for each species and product in the Bid Price column for all material subject to bidding and all fill-in blanks must be completed. If erasures or other changes appear on the hardcopy Bid Form, each erasure or change must be initialed by the person signing the bid.

4. Submission of Sealed Bids (5/16)

Bid forms may be obtained from the Unit Manager or thru OLB. Bids may be submitted hardcopy or thru OLB. All hardcopy bids must be submitted on the bid form and in an envelope clearly identified as described in this section. NOTE: Only one bid form per bid envelope. Sealed bids must be submitted to the Unit office designated in the prospectus and must be submitted at or prior to the time established in the prospectus. The envelope should show on the outside (a) the sale name or number and (b) the date and time of bid opening, as shown in the prospectus. Bids received after the time specified in the sale prospectus are late bids and will be rejected.

It is possible for a bidder to submit multiple bids on a single sale. For example, a bid may be submitted hardcopy and a bid may be submitted thru OLB. Or, two bidders from the same company could both submit bids on the same sale. If this were to happen, the State would accept all bids received and award the contract accordingly. All bidding and contractual requirements would apply to all bids received.

5. Public Opening of Sealed Bids (7/16)

If conditions permit, the sealed bids will be publicly opened and posted at the time and place set in the prospectus.

If a bidder, present at a bid opening, has submitted bids on more than one sale, that bidder may withdraw their unopened bid envelopes or announce the withdrawal of their online bid after being declared the successful bidder on one sale.

6. Award of Contract (1/11)

Award of the contract will be made to the Bidder whose bid, conforming to the prospectus, is most advantageous to the State of Michigan on the basis of total value at rates bid for the estimated quantities. The State reserves the right to reject any bid or waive any minor irregularity in bids received. A written award mailed (or otherwise furnished) to the successful Bidder shall be deemed to result in a binding contract without further action by either party.

7. Down Payment (1/11)

The Bidder to whom award is made must make a down payment within 21 days of the sale award. The amount of the down payment will be calculated as shown in the Bond and Payment Schedule of this prospectus. Only cash may be used to meet this requirement.

8. Performance Security (1/11)

As guarantee of faithful performance, a cash bond, certificate of deposit, surety bond or irrevocable letter of credit (LOC) is required within 21 days of the sale award. The amount of the performance security is shown in the Bond and

Payment Schedule of this prospectus. If an LOC or surety is used, the coverage must extend for at least 6 months beyond the contract expiration.

9. Worker's Compensation (10/22)

Purchaser shall obtain worker's compensation insurance to cover claims under Michigan's Worker's Disability Compensation Act of 1969 or similar employee benefit act of any other state applicable to an employee. Verification of Worker's Disability Compensation Act Compliance must be completed and submitted within 21 days of contract award and prior to the issuance of the timber sale contract. In addition, if applicable, Notice of Exclusion or Certificate of Insurance must also be submitted.

10. Timber Sale Contract (10/22)

Additional conditions and requirements common to all timber sales are listed on the timber sale contract (R4031) and are available on line at www.michigan.gov/timber. Contact the Unit Manager for additional information or a sample contract. Within 21 days of the date of the award letter, the bidder must sign the contract and provide the required down payment, performance security, and verification of worker's disability compensation. The down payment and performance security shall be in accordance with the provisions of the timber sale contract, in the sums stated in this prospectus. If these actions are not taken, then the Bidder, the Bidder's corporation, and the corporation's principals may not be permitted to bid on State timber sales for a period of 3 months after the first offense, 6 months after the second offense, and 1 year after the third offense. An offense will only be counted against the Bidder for 5 years. In addition, the Bidder certifies that if awarded this contract, the Bidder will complete the timber sale contract in accordance with its terms and any modifications thereof including requirements to purchase, cut, and remove the included timber by the expiration date.

Payment Unit values in the State Forest Timber Sale Contract are calculated based on the advertised value of the Payment Unit as a percentage of the total advertised value of the contract. The advertised value of each Payment Unit is given in the Description of Timber by Payment Unit table on the Timber Sale Information page. For example, if the value of Payment Unit 1 is advertised as \$1,500 and the total Timber Sale value is advertised as \$10,000, the contract price for Payment Unit 1 will be 15% of the total bid price ($\$1,500/\$10,000 * 100$).

11. Disclaimer of Estimates and Bidder's Warranty of Inspection (10/22)

Before submitting this bid, the Bidder is advised and cautioned to inspect the sale area, review the requirements of the sale contract, and take other steps as may be reasonably necessary to ascertain the location, estimated volumes, construction estimates, and operating costs of the proposed sale. Failure to do so will not relieve the Bidder from responsibility for completing the contract.

The Bidder warrants that this bid is submitted solely on the basis of the Bidder's examination and inspection of the quality and quantity of the timber offered for sale and the Bidder's opinion of the value thereof and the costs of recovery. No reliance should be placed on the State of Michigan's estimates of timber quality, quantity or costs of recovery. Bidder further acknowledges that the State of Michigan: (i) expressly disclaims any warranty of fitness of timber for any purpose; (ii) offers this timber as is without any warranty of quality (merchantability) or quantity and (iii) expressly disclaims any warranty as to the quantity or quality of timber sold.

12. Certification and Chain-of-Custody (10/22)

Unless otherwise indicated in the contract under section 7 – Other Conditions of the Sale Specific Conditions & Requirements, the area encompassed by this timber sale is certified to the standards of the Forest Stewardship Council (FSC) - Certificate #SCS-FM/COC-00090N and the Sustainable Forestry Initiative (SFI) - Certificate #NSF-SFIS-5Y031-SF5. Forest products from this sale may be delivered to the mill as "FSC 100% and / or SFI certified" as long as the contractor hauling the forest products is chain-of-custody (COC) certified or covered under a COC certificate from the destination mill. The purchaser is responsible for maintaining COC after leaving the sale area.

13. Good Neighbor Authority (GNA) Requirements (10/22)

If the name of this timber sales contains the acronym GNA, it is authorized by the Good Neighbor Authority (GNA) and covered by various agreements between the U.S. Forest Service and the State. The timber sale occurs on federal land and the following conditions apply:

GNA contracts on US Forest Service land will not be awarded to purchasers on the Federal list of excluded parties. The System for Award Management (SAM) will be checked for active excluded parties prior to award of contract. In

addition, the Bidder to whom award is made must complete an Assurance Regarding Felony Conviction or Tax Delinquent Status for Corporate Applicants (AD-3031).

14. Good Neighbor Authority (GNA) Requirements, con't (10/22)

Bidder certifies, by signing this bid form, that to the best of Bidder's knowledge that the following representations are accurate and complete.

- a. That the Bidder and its principals are not presently debarred, suspended, proposed for debarment, declared ineligible, or voluntary excluded from timber sales (covered transactions) by any Federal department or agency.
- b. That the Bidder and its principals have not within a 3-year period preceding this bid been convicted of or had a civil judgment rendered against them for commission of fraud or a criminal offense in connection with obtaining , attempting to obtain, or performing a public (Federal, State, or local) transaction or contract under a public transaction; violation of Federal or State antitrust statutes or commission of embezzlement, theft, forgery, bribery, falsification or destruction of records, making false statements, or receiving stolen property.
- c. That the Bidder and its principals are not presently indicted for or otherwise criminally or civilly charged by a governmental entity (Federal, State, or local) with commission of any of the offenses enumerated in paragraph b of this certification.
- d. That the Bidder and its principals have not within a 3-year period preceding this bid had one or more public transactions (Federal, State, or local) terminated for breach or default of a timber or forest product contract.

Bidders that cannot certify this requirement, in whole or in part, shall submit an explanation with their bid.

Scott Bowen
Director

TIMBER SALE INFORMATION

Big Creek Blues (72-009-24)

T28N, R01E, SEC. 26; T28N, R01E, SEC. 27; T28N, R01E, SEC. 34.

Oscoda County (Advertised Price \$123,882.20)

SALE NOTE: Access into Sale Area is from Farrington Road which is a dirt/gravel road that is maintained. Farrington Road crosses East Branch Big Creek and has a culvert. This is an area of concern for erosion and damage to improvements. This sale has low ground in each of the Payment Units. Minimizing rutting is a priority. Accessing Payment Unit 3 will be done through existing but closed road that is accessed through Payment Unit 2 from the North Side of Farrington Road. There is a private line along the east side of the access road to Payment Units 1 and 2 South of Farrington Road. There is also Private line on the Northeast side of Payment Unit 3 which is a powerline. All payment units have diameter limit on Red and White pine. See specifications for those diameter limits. Most of these trees have been marked with green paint for reference.

A timber sale contract for this lump sum, sealed bid timber sale will be awarded to the responsible bidder offering the highest sealed bid price. All units of volume listed below were estimated using the Inventory Manager computer program and the new Michigan taper model. Bids must be at or above the following advertised price for each product and species:

<u>PRODUCTS & SPECIES</u>	<u>ESTIMATED UNITS*</u>	<u>ADVERTISED PRICE</u>
Sawtimber		
Northern Pin Oak	5.6 MBF	\$ 122.00 / MBF
Red Maple	11.1 MBF	\$ 74.00 / MBF
White Pine	142.7 MBF	\$ 53.00 / MBF
Pulpwood		
Balsam Fir	170 Cords	\$ 18.80 / Cord
Jack Pine	52 Cords	\$ 20.20 / Cord
Mixed Aspen	1,175 Cords	\$ 21.45 / Cord
Mixed Hardwood	296 Cords	\$ 28.60 / Cord
Mixed Spruce	40 Cords	\$ 19.95 / Cord
Northern Pin Oak	11 Cords	\$ 21.95 / Cord
Paper Birch	9 Cords	\$ 23.00 / Cord
Red Pine	1,766 Cords	\$ 38.60 / Cord
White Pine	409 Cords	\$ 18.30 / Cord

* The total volume is statistically estimated within plus (+) or minus (-) 13.10 percent. There are an estimated 4,299 cords on this timber sale, plus or minus 563 cords at the 95% confidence level. The estimated units are final and not subject to adjustment. Prospective bidders are urged to examine this timber and to make their own estimates of quantity and quality.

BOND AND PAYMENT SCHEDULE:

1. A bond in the amount of \$6,194.00 to insure faithful performance of the conditions of the contract will be deposited by the successful bidder within 21 days of the sale award.
2. Cutting in any sale or unit without the required advance payment would be considered a trespass.
3. Total payment must be paid in advance or according to the following schedule :
 - (a) Ten percent (10%) of the sale value must be paid within 21 days of the sale award.
 - (b) The 10% down payment will be credited towards the first unit cut.
 - (c) Payment for each of the following units must be made before cutting begins in that unit:

<u>PAYMENT UNIT NUMBER</u>	<u>PERCENT OF TOTAL SALE VALUE</u>
01	13.5%
02	33.0%
03	15.2%
04	32.1%
05	6.2%

4. If no cutting takes place, the 10% down payment will not be refunded.
5. Operations on the contract issued will terminate on 06/30/2028.

SALE STATISTICS

Volumes were calculated in cubic feet using the Michigan taper model. Cubic foot volume includes all wood inside bark for the product indicated. For display purposes, cubic feet were converted to cords and MBF using a simple conversion factor, e.g. 79 cubic feet per cord and 185 cubic feet per MBF. The cubic foot volumes are precise; the cords and MBF volumes are not. Cubic foot volume cannot be directly converted to cords or boards with precision.

SALE VOLUMES

The total estimated sale volume may not equal the sum of the species/products due to the nature of statistical calculations associated with double sampling methodology.

VOLUME			STATISTICAL RANGE IN CORDS	
TOTAL CUBIC FEET	TOTAL CORDS	PERCENT ERROR	MINIMUM	MAXIMUM
339,619	4,299	13.10%	3,736	4,862

VDU VOLUMES

A VDU is a Volume Determination Unit. Volumes and their associated statistics are calculated at the VDU level and summarized to the sale level. There is often a one to one relationship between a VDU and a Payment Unit, but not always, depending on the cruise design. Refer to the VDU TO PAYMENT UNIT table.

	VOLUME			RANGE IN CORDS	
VDU	TOTAL CUBIC FEET	TOTAL CORDS	PERCENT ERROR	MINIMUM	MAXIMUM
15	11,154	141	53.28%	66	216
28	55,798	706	32.59%	476	936
31	52,877	669	40.94%	395	943
37	89,099	1,128	18.62%	918	1,338
41	13,021	165	51.31%	80	249
53	58,163	736	35.54%	475	998
85	59,506	753	37.54%	470	1,036
TOTAL:	339,619	4,299		2,881	5,717

VDU TO PAYMENT UNIT

When a VDU is associated with more than one Payment Unit (PU), the VDU volumes are assigned to the PU based on acres of the VDU within the PU.

VDU	VDU ACRES	PU	PU ACRES
28	19.9	3	19.9
31	20.9	4	20.9
37	63.6	2	63.6
41	7.4	5	7.4
53	29.4	1	29.4
85	14.0	4	14.0
15	2.8	5	2.8
TOTAL:	158.0		158.0

DESCRIPTION OF TIMBER BY PAYMENT UNIT (PU)

PU	MARKET GROUP	PRODUCT	QUANTITY	UNIT	ACRES	ADVERTISE PRICE
1	Balsam Fir Jack Pine Mixed Aspen <i>B. T. Aspen</i> <i>Quaking Aspen</i> Mixed Hardwood <i>Red Maple</i> Mixed Spruce <i>White Spruce</i> White Pine	Pulpwood	74 20 445 93 352 177 177 9 9 11	Cords Cords Cords <i>Cords</i> <i>Cords</i> Cords <i>Cords</i> Cords <i>Cords</i> Cords	29.4	\$16,783.50
2	Northern Pin Oak Red Maple White Pine Balsam Fir Jack Pine Mixed Aspen <i>Quaking Aspen</i> Mixed Hardwood <i>Black Cherry</i> <i>Red Maple</i> Northern Pin Oak Red Pine White Pine	Sawtimber Pulpwood	5.6 0.8 14.9 2 27 33 33 13 1 12 4 952 46	MBF MBF MBF Cords Cords Cords <i>Cords</i> Cords <i>Cords</i> <i>Cords</i> Cords Cords Cords	63.6	\$40,871.55
3	Red Maple White Pine Balsam Fir Jack Pine Mixed Aspen <i>Quaking Aspen</i> Mixed Hardwood <i>Red Maple</i> Mixed Spruce <i>Black Spruce</i> Paper Birch Red Pine White Pine	Sawtimber Pulpwood	5.7 25.2 43 5 281 281 5 5 26 26 5 219 51	MBF MBF Cords Cords Cords <i>Cords</i> Cords <i>Cords</i> Cords <i>Cords</i> Cords Cords Cords	19.9	\$18,857.65
4	Red Maple White Pine Balsam Fir Mixed Aspen <i>Quaking Aspen</i> Mixed Hardwood <i>Red Maple</i> Mixed Spruce <i>White Spruce</i> Northern Pin Oak Red Pine White Pine	Sawtimber Pulpwood	4.6 102.6 40 325 325 92 92 5 5 2 517 192	MBF MBF Cords Cords <i>Cords</i> Cords <i>Cords</i> Cords <i>Cords</i> Cords Cords Cords	34.9	\$39,746.10
5	Balsam Fir Mixed Aspen <i>Quaking Aspen</i> Mixed Hardwood <i>Red Maple</i> Northern Pin Oak Paper Birch Red Pine	Pulpwood	11 91 91 9 9 5 4 78	Cords Cords <i>Cords</i> Cords <i>Cords</i> Cords Cords Cords	10.2	\$7,623.40

DESCRIPTION OF TIMBER BY PAYMENT UNIT (PU), CON'T

PU	MARKET GROUP	PRODUCT	QUANTITY	UNIT	ACRES	ADVERTISE PRICE
5 con't	White Pine	Pulpwood	109	Cords		
TOTAL:			159.4	MBF		
TOTAL:			3,928	Cords		

Sale Specific Conditions & Requirements

Sale Name: Big Creek Blues

Sale Number: 72-009-24 Seq#: 2

1 - Sale Area

1.2 - Boundaries

1.2.1 - Painted Boundaries (9/19)

The sale boundary and Payment Unit boundaries are marked and identified by blue, red and yellow paint, along with unpainted boundaries. Exterior sale boundary lines against private property are marked with blue paint. Exterior sale boundary lines against state are marked with red paint. Interior Payment Unit boundaries are marked with yellow paint. Retention patches are marked with red paint; no harvesting activities may occur within these areas. The painted boundary line trees are not Included Timber and are to be protected unless marked with orange paint except cut red painted trees bordering the immature red pine plantation on the east edge of Payment Unit 4 and the west edge of Payment Unit 5. Yellow painted trees designating an interior Payment Unit boundary are only to be cut when all surrounding Payment Units have been paid.

2 - Timber Specifications

2.1 - Included Timber

2.1.1 - Clearcut Unit(s) with Unmerchantable Trees (6/14)

Within Payment Unit(s) 1 and 3-5, cut all trees that are two (2) inches or more at DBH. In addition, within Payment Unit 5, all boundary trees along the western boundary are designated for cutting, regardless of merchantability.

Within Payment Unit 2, cut all trees that are one (1) inch or more at DBH.

Within Payment Units 1-3, do not cut any red or white pine that are 20 inches or more at DBH (please note most of these have been marked with green paint for reference).

Within Payment Units 4-5, do not cut any red or white pine that are 24 inches or more at DBH (please note most of these have been marked with green paint for reference).

Within Payment Units 1 and 4, do not cut any oak.

Within Payment Units 1 and 3-5, protect all sub-merchantable fir, spruce, and white pine (see sale condition 3.4.1).

Special protection trees are identified in accordance with condition 3.4.2, within clearcutting unit boundaries, are not Included Timber and are to be protected.

Special protection areas identified in accordance with condition 3.4.3, within clearcutting unit boundaries, are not Included Timber and are to be protected.

2.1.9 - Harvest Exception (12/08)

Do not cut any cedar or hemlock trees other than those that are necessary to remove in order to operate within the sale area. Every effort must be made to preserve the existing cedar and hemlock and to leave an intact stand upon sale completion. All cut cedar and hemlock shall be piled separately by products and scaled in the woods unless other scaling arrangements are agreed to by the Unit Manager or his/her representative. Stumpage price for cedar and hemlock shall be \$50.00 per cord for posts and pulpwood, and \$100.00 per cord for bolts and sawlogs.

2.2 - Utilization

2.2.2 - Chipping required (2/18)

Payment Unit 2 must be chip harvested to facilitate subsequent planting operations. The Purchaser has the option to produce sawlogs or pulpwood bolts, but the remaining portion of the trees must be chipped and hauled. Products may be produced as roundwood and forwarded to decking areas in final product length, but the tops must be left intact and skidded to the landing for chipping in order to minimize the amount of residual slash. If market conditions limit the practicality of chipping, tops and slash must be arranged in a way that will not inhibit future planting operations, as directed by the Sale Administrator. Do not chip 1/6 to 1/3 of the slash from harvested trees (tree tops and limbs less than four inches in diameter).

2.2.3 - Stump heights (4/07)

Stump heights within Payment Unit 2 shall not exceed 6 inches for all trees. This is in order to facilitate planting operations.

2.2.9 - No Chipping Permitted (12/08)

Within Payment Unit(s) 1 and 3-5, no chipping is permitted.

3 - Payments

3.3 - Pre-measured Sales

3.3.4 - Dividing Payment Units (7/14)

Payment Unit(s) 2 and 4 may be divided at the request of the Purchaser and upon approval of the Unit Manager. Dividing Payment Units is a contract modification which requires a Timber Sale Contract Amendment. There will be only one division per Payment Unit.

3.4 - Damaged Timber

3.4.1 - Damaged timber (7/16)

General Condition and Requirement 3.4 Damaged Timber, defines liquidated damages for undesignated live merchantable trees which are cut or injured. In addition, reasonable care should be taken to avoid damage to tree seedlings and saplings less than 2 inches at DBH.

Within the Payment Units 1 and 3-5, if more than 50% of the fir, spruce and white pine seedlings or saplings less than 4.5 inches DBH within a specified portion of the Sale Area are damaged, liquidated damages will be assessed at \$300 per acre for all acreage within that specified portion of the Sale Area that was damaged. Operable paths will need to be cut through dense regen; If those paths are cut cleanly, they will not be considered damaged areas.

3.4.2 - Special Protection Trees (4/14)

The Purchaser shall not cut live or dead special protection trees within cutting units or clearings. Special protection trees are cedar or hemlock, any trees marked with green paint, red pine and white pine that are greater than 20 inches at DBH in Payment Units 1 and 3, and red pine and white pine that are greater than 24 inches at DBH in Payment Units 2, 4 and 5. If the Purchaser's operations have cut or damaged special protection trees through carelessness, the Purchaser shall pay \$200 as fixed, agreed and liquidated damages for each special protection tree cut or damaged. Such payment does not constitute ownership of the undesignated timber.

3.4.3 - Special Protection Areas (8/11)

The Purchaser shall protect special protection areas from damage by the Purchaser's operations. Special protection areas are marked with a red boundary line. The Purchaser shall not cut live or dead trees within special protection areas. If the Purchaser's operations have cut or damaged special protection areas through carelessness, the Purchaser shall pay \$500 as fixed, agreed and liquidated damages for each acre or part thereof cut or damaged. Such payment does not constitute ownership of the undesignated timber.

4 - Transportation

4.1 - Construction

4.1.6 - Road Construction (4/24)

Construction of new roads or improvements of existing roads shall be done in such a way as to minimize the environmental and visual impacts. Merchantable trees shall be cut and utilized unless otherwise directed. Non-merchantable trees shall be severed and laid flat on the ground. Slash shall be scattered and not left in windrows and kept a minimum of 10 feet back from the road edge. Stumps shall be set upright, not left on edge, and be moved at least 10 feet away from the road edge. Disturbed soil shall be feathered into the woods and not left in berms or windrows.

4.1.7 - Road Closure (10/11)

All new roads built into the sale must be blocked to vehicle traffic upon completion of the sale. Overgrown roads that are reopened shall be considered new roads. In general, this will require constructing a four (4') foot high berm of stumps and logs covered with earth. These roads must be rendered impassable to cars and trucks. All stumps from road building and landing construction must be reserved to block any newly constructed roads upon completion of the sale. These stumps must be scattered along the road system to prohibit vehicular movement. Temporary berms may be required if no sale activity occurs for 30 or more consecutive days. Contact the Sale Administrator for specific details of design and placement.

4.1.11 - Permits (2/12)

The Purchaser will secure any necessary permits that may be required.

5 - Operations

5.1 - Notification

5.1.1 - Pre-sale Conference (10/16)

A pre-sale conference on site between the Purchaser and Sale Administrator is required prior to beginning any operations to determine landing and road locations. The Unit Manager or his/her representative must be contacted at least 10 days in advance to schedule the conference.

5.1.3 - Well Heads and Natural Gas Pipelines (11/15)

The Purchaser is responsible for contacting the gas or pipeline company 30 days prior to operating equipment in the vicinity of well heads or natural gas pipelines. Written permission is required before harvest operations begin and must be submitted to the Unit Manager.

5.1.4 - Post-Sale Conference (10/16)

A post-sale conference on site between the Purchaser and sale administrator is required prior to the completion of active logging operations to determine clean-up and repair of landings, road edges, and the fulfillment of other contract specifications.

5.1.6 - Utility R.O.W. (4/19)

It is the responsibility of the Purchaser to obtain permission from the utility company to utilize the power line R.O.W. for operations.

5.2 - Conduct of Operations

5.2.1 - Slash

5.2.1.13 - Dispose of Slash as Directed (12/05)

Slash is to be disposed of as directed by the Sale Administrator.

5.2.2 - Hazard Trees/Snags

5.2.2.1 - Den Trees (10/16)

Obvious hollow and/or den trees shall be protected and left standing unless they are a safety hazard.

5.2.4 - Dead and Down Creation

5.2.4.4 - Dead and Down Creation, Grouse (6/18)

To encourage grouse and other wildlife, in Payment Unit(s) 1 and 3-5, leave one, 12-inch diameter or larger log-length (8 foot minimum) piece on the ground for every 2 acres or one 12-inch or larger diameter (or largest diameter trees within stand) whole tree on the ground for every 4 acres, preferably a hardwood species such as oak or maple or if no hardwoods are present, a pine species (white or red).

5.2.4.6 - Dead and Down Creation, Other (9/09)

To create eastern massasauga rattlesnake habitat, within Payment Units 1 and 5, one brush pile per 3 acres shall be constructed of 3-6 tops.

5.2.29 - Shrub Protection (1/20)

Reasonable care should be taken to avoid cutting or damaging hawthorn, witch-hazel, dogwood or junberry. These woody-shrub plants are highly beneficial to various wildlife species.

5.2.31 - Landing Locations (9/13)

In general, landings are limited to a turnaround which will accommodate a truck with a 50-foot trailer.

5.2.32 - Decking/Landing Restoration (9/13)

All decking and landing areas must have the surface area restored to a condition equal to or better than before. This is to ensure the proper regeneration of the stand. Wood debris, chips and "cookies" from trimmings must be removed or scattered away from landing and loading areas and may not be windrowed on the edge.

5.2.38 - No Decking Against Live Trees (2/04)

Cut products may not be decked against unmarked or designated leave trees.

5.4 - Soil Protection

5.4.1 - Rutting Restriction, General (7/16)

Operations are to cease immediately if equipment and weather conditions result in rutting of roads and/or skid trails which is 12 inches or greater in depth and 50 feet in length. The Unit Manager or his/her representative may restrict hauling and/or

skidding if ruts exceed the specified depth. With the Unit Manager or his/her representative's approval, the Purchaser may return to the area when the risk of rutting has decreased.

5.4.6 - Wet Area Protection (5/10)

No harvesting operations, including skidding and felling, are to take place within the vernal pond areas or dense patches of lowland shrub cover. Tag alder occupies the timber sale's most saturated ground where risk of rutting is the greatest. When harvesting occurs, there should be no disturbance to the vernal pond depression. All equipment, trees and tops should be kept out of this area. Within 100 feet of the pond, equipment should only be used when the soil is in a dry or frozen condition. Care must be taken by the Purchaser to identify and avoid operating in these areas of the timber sale.

5.8 - Protection of Endangered Species

5.8.3 - Red Shoulder Hawk or Goshawk (1) (2/16)

In the event that an active red shoulder hawk or goshawk nest is found, the contract may be amended to protect the nest site until the nest is determined to be inactive. The value of the trees in this excluded area will be refunded or credited to the Purchaser. The nest will be buffered with a five-chain radius (eight acre) protection area, centered on the nest tree, in which there will be no cutting or new roads constructed. Avoid human disturbance, including loading and skidding, in the protection area.

An additional zone of five chains (ten chains centered on the active nest tree) will be established in which there is no management activity from March 15 to July 15. Limit biomass harvesting and chipping operations within this ten-chain zone, retain the maximum one-third of residues per the Woody Biomass Harvesting Guidelines (Michigan DNR 2010). Nests determined to be inactive will be protected with a one-chain no-harvest buffer.

6 - Safety and Fire Prevention

6.2 - Signing

6.2.1 - Road Posting (10/20)

The Purchaser is responsible for posting and maintaining caution signs on Farrington Road prior to beginning operations. The road must be posted at appropriate distances from the Sale Area to warn of logging activity and truck traffic. Signs must be removed when harvest operations are suspended or completed. The Purchaser will provide these signs.



TIMBER SALE MAP

This information provided by authority of Part 525, 1994 PA 451, as amended.

Sale Number

72-009-24

Date

01/30/2025

Forest Management Unit

Grayling Mgt Unit

County

Oscoda

Mapped By: M. Lovelace

Cruised By: Lovelace, Price, Michaud

Scale

1:15,840

Page

1

Of

1

Township
28N

Range
01E

Section(s) and

Subdivision(s) Sec. 26 S1/2NW,N1/2SW,SWSW; Sec. 27 SE; Sec. 34 NE;

Cover Type

A = Aspen	J = Jack Pine	O = Oak	U = Upland Brush
B = Paper Birch	K = Rock	P = Lowland Poplar	UM = Upland Mix Forest
C = Cedar	L = Lowland Brush	Q = Mixed Swamp Conifer	V = Bog or Marsh
D = Treed Bog	LM = Lowland Mix Forest	R = Red Pine	W = White Pine
E = Swamp Hardwoods	M = Maple, Beech, Birch	S = Black Spruce	X = Non Stocked
F = Spruce/Fir	MC = Mixed Conifer	T = Tamarack	Y = Sand
G = Grass	MD = Mixed Deciduous		Z = Water
H = Hemlock	N = Marsh		

Density

0 = Non Stocked	5 = Pole Timber Medium
1 = Seedling Sapling Poor	6 = Pole Timber Well
2 = Seedling Sapling Medium	7 = Saw Timber Poor
3 = Seedling Sapling Well	8 = Saw Timber Medium
4 = Pole Timber Poor	9 = Saw Timber Well

Use QR Code to
open Map in App



Payment Unit Number	Acres
1	29.4
2	63.6
3	19.9
4	34.9
5	10.3

**Big Creek Blues
Compartment 72020
158.0 Acres**

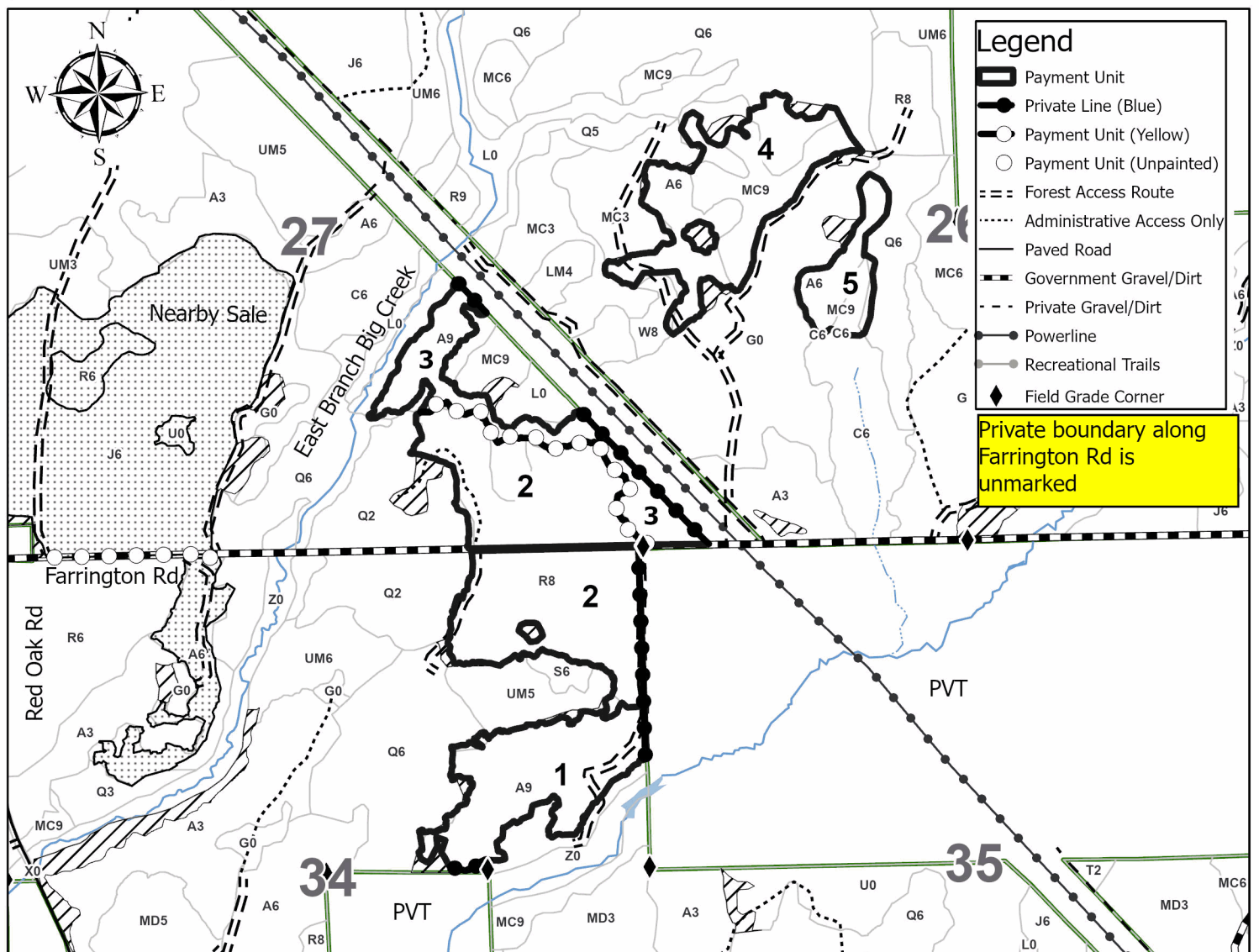
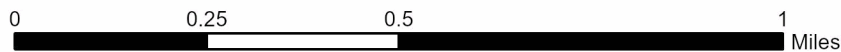

TIMBER SALE INFORMATION

Class Eh Mix (72-010-24)

T28N, R01E, SEC. 27; T28N, R01E, SEC. 33; T28N, R01E, SEC. 34.

Oscoda County (Advertised Price \$64,839.30)

SALE NOTE: Sale had been reduced to account for deteriorating timber and difficult operability. No material shall be felled or decked into wildlife opening adjacent to Payment Unit 3. Wildlife opening in Payment Unit 4 is to be cut and skid outside of opening to reduce slash and impact of operations. Rutting restrictions throughout Sale Area. Hard Oak wilt restriction on all Payment Units. Small portion of snowmobile trail shares access to Payment Unit 1.

A recreation site such as a trail, pathway, or campground is within the sale area or the vicinity. Certain restrictions/specifications may be applicable including time restrictions.

A timber sale contract for this lump sum, sealed bid timber sale will be awarded to the responsible bidder offering the highest sealed bid price. All units of volume listed below were estimated using the Inventory Manager computer program and the new Michigan taper model. Bids must be at or above the following advertised price for each product and species:

<u>PRODUCTS & SPECIES</u>	<u>ESTIMATED UNITS*</u>		<u>ADVERTISED PRICE</u>
Sawtimber			
Balsam Fir	10.0	MBF	\$ 62.00 / MBF
Northern Pin Oak	22.6	MBF	\$ 100.00 / MBF
White Pine	9.0	MBF	\$ 53.00 / MBF
Pulpwood			
Balsam Fir	62	Cords	\$ 18.80 / Cord
Jack Pine	1,141	Cords	\$ 20.20 / Cord
Mixed Hardwood	35	Cords	\$ 28.60 / Cord
Northern Pin Oak	143	Cords	\$ 21.95 / Cord
Quaking Aspen	379	Cords	\$ 21.45 / Cord
Red Pine	632	Cords	\$ 38.60 / Cord
White Pine	33	Cords	\$ 18.30 / Cord

* The total volume is statistically estimated within plus (+) or minus (-) 13.44 percent. There are an estimated 2,525 cords on this timber sale, plus or minus 340 cords at the 95% confidence level. The estimated units are final and not subject to adjustment. Prospective bidders are urged to examine this timber and to make their own estimates of quantity and quality.

BOND AND PAYMENT SCHEDULE:

1. A bond in the amount of \$3,242.00 to insure faithful performance of the conditions of the contract will be deposited by the successful bidder within 21 days of the sale award.
2. Cutting in any sale or unit without the required advance payment would be considered a trespass.
3. Total payment must be paid in advance or according to the following schedule:
 - (a) Ten percent (10%) of the sale value must be paid within 21 days of the sale award.
 - (b) The 10% down payment will be credited towards the first unit cut.
 - (c) Payment for each of the following units must be made before cutting begins in that unit:

<u>PAYMENT UNIT NUMBER</u>	<u>PERCENT OF TOTAL SALE VALUE</u>
01	12.7%
02	16.4%
03	18.6%
04	52.3%

4. If no cutting takes place, the 10% down payment will not be refunded.

5. Operations on the contract issued will terminate on 06/30/2028.

SALE STATISTICS

Volumes were calculated in cubic feet using the Michigan taper model. Cubic foot volume includes all wood inside bark for the product indicated. For display purposes, cubic feet were converted to cords and MBF using a simple conversion factor, e.g. 79 cubic feet per cord and 185 cubic feet per MBF. The cubic foot volumes are precise; the cords and MBF volumes are not. Cubic foot volume cannot be directly converted to cords or boards with precision.

SALE VOLUMES

The total estimated sale volume may not equal the sum of the species/products due to the nature of statistical calculations associated with double sampling methodology.

VOLUME			STATISTICAL RANGE IN CORDS	
TOTAL CUBIC FEET	TOTAL CORDS	PERCENT ERROR	MINIMUM	MAXIMUM
199,465	2,525	13.44%	2,185	2,864

VDU VOLUMES

A VDU is a Volume Determination Unit. Volumes and their associated statistics are calculated at the VDU level and summarized to the sale level. There is often a one to one relationship between a VDU and a Payment Unit, but not always, depending on the cruise design. Refer to the VDU TO PAYMENT UNIT table.

	VOLUME			RANGE IN CORDS	
VDU	TOTAL CUBIC FEET	TOTAL CORDS	PERCENT ERROR	MINIMUM	MAXIMUM
11	76,955	974	17.61%	803	1,146
36	37,605	476	44.23%	265	687
63	33,145	420	34.55%	275	565
66	25,890	328	39.85%	197	458
82	25,868	327	30.03%	229	426
TOTAL:	199,465	2,525		1,769	3,281

VDU TO PAYMENT UNIT

When a VDU is associated with more than one Payment Unit (PU), the VDU volumes are assigned to the PU based on acres of the VDU within the PU.

VDU	VDU ACRES	PU	PU ACRES
11	99.2	4	99.2
36	14.3	3	14.3
63	17.8	2	17.8
66	22.5	1	22.5
82	6.3	4	6.3
TOTAL:	160.1		160.1

DESCRIPTION OF TIMBER BY PAYMENT UNIT (PU)

PU	MARKET GROUP	PRODUCT	QUANTITY	UNIT	ACRES	ADVERTISE PRICE
1	Balsam Fir	Sawtimber	0.7	MBF	22.5	\$8,255.30
	Northern Pin Oak		8.2	MBF		
	Balsam Fir	Pulpwood	1	Cords		
	Jack Pine		60	Cords		
	Jack Pine	Sawtimber	1.4	MBF		
	Jack Pine	Pulpwood	57	Cords		
	Mixed Hardwood		4	Cords		
	Black Cherry	Sawtimber	0.3	MBF		
	Black Cherry	Pulpwood	3	Cords		
	Northern Pin Oak		67	Cords		
	Quaking Aspen		119	Cords		
	Red Pine		51	Cords		
	White Pine		3	Cords		
2	Northern Pin Oak	Sawtimber	14.4	MBF	17.8	\$10,634.40
	Jack Pine	Pulpwood	163	Cords		
	Jack Pine		163	Cords		
	Northern Pin Oak		76	Cords		
	Quaking Aspen		84	Cords		
	Red Pine		63	Cords		
3	Balsam Fir	Sawtimber	9.3	MBF	14.3	\$12,071.75
	White Pine		9.0	MBF		
	Balsam Fir	Pulpwood	61	Cords		
	Jack Pine		63	Cords		
	Jack Pine		63	Cords		
	Mixed Hardwood		13	Cords		
	Paper Birch	Sawtimber	1.9	MBF		
	Paper Birch	Pulpwood	3	Cords		
	Red Maple		6	Cords		
	Quaking Aspen		151	Cords		
	Red Pine		115	Cords		
	White Pine		30	Cords		
	4	Jack Pine	Pulpwood	855		
Jack Pine			855	Cords		
Mixed Hardwood			18	Cords		
Black Cherry			18	Cords		
Quaking Aspen			25	Cords		
Red Pine			403	Cords		
TOTAL:			41.6	MBF		
TOTAL:			2,425	Cords		

Sale Specific Conditions & Requirements

Sale Name: Class Eh Mix

Sale Number: 72-010-24 Seq#: 2

1 - Sale Area

1.2 - Boundaries

1.2.1 - Painted Boundaries (9/19)

The sale boundary and Payment Unit boundaries are marked and identified by blue, red and yellow paint along with roads (see Timber Sale Map). Exterior sale boundary lines against private property are marked with blue paint, with the exception of the private boundary along 489, Town Hall, and Farrington Roads, which are unpainted and designated by the roads. Exterior sale boundary lines against state are marked with red paint. Interior Payment Unit boundaries are marked with yellow paint. Yellow painted trees designating an interior Payment Unit boundary are only to be cut when all surrounding Payment Units have been paid. The painted boundary line trees are not Included Timber and are to be protected unless painted with orange paint. Retention patches are marked with red paint; no harvesting activities may occur within these areas.

2 - Timber Specifications

2.1 - Included Timber

2.1.1 - Clearcut Unit(s) with Unmerchantable Trees (6/14)

Within Payment Unit(s) 1-4, cut all trees that are two (2) inches or more at DBH, except do not cut hemlock or cedar. In addition, within Payment Units 3 and 4, do not cut any red or white pine that are 20 inches or more at DBH (most have been marked with green paint for reference). Further, across the Sale Area, patches of saplings that are two (2) inches or more at DBH may be left uncut if they are intact (not bent/broken) and located away from aspen.

Special protection trees identified in accordance with condition 3.4.2, within clearcutting unit boundaries, are not Included Timber and are to be protected.

2.2 - Utilization

2.2.9 - No Chipping Permitted (12/08)

Within Payment Unit(s) 4, no chipping of tops will be permitted to encourage oak regeneration.

3 - Payments

3.3 - Pre-measured Sales

3.3.4 - Dividing Payment Units (7/14)

Payment Unit(s) 4 may be divided at the request of the Purchaser and upon approval of the Unit Manager. Dividing Payment Units is a contract modification which requires a Timber Sale Contract Amendment. There will be only one division per Payment Unit.

3.4 - Damaged Timber

3.4.1 - Damaged Timber (12/24)

General Condition and Requirement 3.4 Damaged Timber, defines liquidated damages for undesignated live merchantable trees which are cut or injured. In addition, reasonable care should be taken to avoid cutting white pine and oak seedlings and saplings less than 2 inches at DBH.

Within the Sale Area, if more than 20% of the white pine and oak seedlings and saplings (less than 2 inches DBH) within a specified portion of the Sale Area are damaged, liquidated damages will be assessed at \$250 per acre for all acreage within that specified portion of the Sale Area that was damaged.

Operable paths will need to be cut through dense regen; if those paths are cut cleanly, they will not be considered damaged areas.

3.4.2 - Special Protection Trees (1/25)

The Purchaser shall not cut live or dead special protection trees within cutting units or clearings. Special protection trees are

red pine and white pine that are 20 inches or more at DBH (most have been marked with green paint for reference). If Purchaser's operations have cut or damaged special protection trees through carelessness, the Purchaser shall pay \$200 as fixed, agreed and liquidated damages for each special protection tree cut or damaged. Such payment does not constitute ownership of the undesignated timber.

4 - Transportation

4.1 - Construction

4.1.3 - Slash and Earthen Piles (8/04)

Piles or windrows of earth along roads and landings that have been widened or constructed shall be leveled. Slash from road maintenance or construction, including stumps, shall be scattered and feathered 10 feet off the shoulders of the road or hauled to a location approved by Sale Administrator.

4.1.6 - Road Construction (4/24)

Construction of new roads and landings or improvement of existing roads shall be done in such a way as to minimize the environmental and visual impacts. Merchantable trees shall be cut and utilized unless otherwise directed. Non-merchantable trees shall be severed and laid flat on the ground. Slash shall be scattered, and not left in windrows and kept a minimum of 10 feet back from the road edge. Stumps shall be set upright, not left on edge, and be moved at least 10 feet away from the road edge. Disturbed soil shall be feathered into the woods and not left in berms or windrows.

4.1.7 - Road Closure (10/11)

All new roads built into the sale must be blocked to vehicle traffic upon completion of the sale. Overgrown roads that are reopened shall be considered new roads. In general, this will require constructing a four (4') foot high berm of stumps and logs covered with earth. Stumps and brush must be placed along the remainder of the trail. Contact the Sale Administrator for specific details of design and placement.

4.1.11 - Permits (2/12)

The Purchaser will secure any necessary permits that may be required.

5 - Operations

5.1 - Notification

5.1.4 - Post-Sale Conference (10/16)

A post-sale conference on site between the Purchaser and sale administrator is required prior to the completion of active logging operations to determine clean-up and repair of landings, road edges, and the fulfillment of other contract specifications.

5.2 - Conduct of Operations

5.2.1 - Slash

5.2.1.10 - No Slash in Openings (5/10)

No brush or logging debris is to be left in the maintained wildlife openings which is indicated by G0 on the Timber Sale Map. Any damage to the opening shall be repaired according to specifications of the Unit Manager or his/her representative.

5.2.1.11 - Slash for Reforestation (3/21)

To facilitate reforestation, Payment Unit 4 shall be left with slash evenly distributed. Bunched tops within the cutting area shall be broken up and scattered. Stumps shall be cut low to the ground. Processing sites shall not be left with a compacted layer of slash; tops from these sites shall be hauled back into the cut area and scattered.

5.2.2 - Hazard Trees/Snags

5.2.2.1 - Den Trees (10/16)

Obvious hollow and/or den trees shall be protected and left standing unless they are a safety hazard.

5.2.3 - Operating Restrictions

5.2.3.5 - Oak Wilt Restriction (1/18)

Within Payment Units 1-4, unless changed by written agreement, cutting, skidding, hauling within the sale and brushing of access roads to the sale are not permitted during the period of April 15 to July 15. Operations may be allowed if specific

steps are taken to prevent damaging uncut oak during the high-risk period. Those steps may include completing all road brushing before April 15 and clearing a tree-length buffer along uncut oak cover before April 15. This is necessary to reduce the spread of oak wilt. For more information, contact the Unit Manager or his/her representative.

5.2.4 - Dead and Down Creation

5.2.4.4 - Dead and Down Creation, Grouse (6/18)

To encourage grouse and other wildlife, in Payment Unit(s) 1-3, leave one, 12-inch diameter or larger log-length (8 foot minimum) piece on the ground for every 2 acres or one 12-inch or larger diameter (or largest diameter trees within stand) whole tree on the ground for every 2 acres, preferably a hardwood species such as oak or maple or if no hardwoods are present, a pine species (white or red). These trees will be evenly scattered throughout the unit, preferably at least two chains from any roads, two tracks, or trails open to vehicles.

5.2.22 - Operating Caution

5.2.22.1 - Operating Caution (6/11)

It is recommended, but not required, that within Payment Unit(s) 3 and 4, cutting, skidding, and hauling occur during dry summer or frozen winter conditions. The reason for the recommendation in Payment Unit 3 is to reduce the risk of rutting. The reason for the recommendation in Payment Unit 4 is to encourage red oak regeneration.

5.2.29 - Shrub Protection (1/20)

Reasonable care should be taken to avoid cutting or damaging hawthorn, dogwood or junberry. These woody-shrub plants are highly beneficial to various wildlife species.

5.2.32 - Decking/Landing Restoration (9/13)

All decking and landing areas must have the surface area restored to a condition equal to or better than before. This is to ensure the proper regeneration of the stand. Wood debris, chips and "cookies" from trimmings must be removed or scattered away from landing and loading areas and may not be windrowed on the edge.

5.2.38 - No Decking Against Live Trees (2/04)

Cut products may not be decked against unmarked or designated leave trees.

5.2.43 - Opening Protection (2/21)

No activities are permitted in openings marked on the Timber Sale Map with the letter "G". Any damage to the openings shall be repaired according to specifications of the Unit Manager or his/her representative.

5.4 - Soil Protection

5.4.1 - Rutting Restriction, General (7/16)

Withing Payment Unit 3 operations are to cease immediately if equipment and weather conditions result in rutting of roads and/or skid trails which is 6 inches or greater in depth and 25 feet in length. The Unit Manager or his/her representative may restrict hauling and/or skidding if ruts exceed the specified depth. With the Unit Manager or his/her representative's approval, the Purchaser may return to the area when the risk of rutting has decreased.

6 - Safety and Fire Prevention

6.2 - Signing

6.2.1 - Road Posting (10/20)

The Purchaser is responsible for posting and maintaining caution signs on Town Hall Road, Red Oak Road, and Farrington Road prior to beginning operations. The road must be posted at appropriate distances from the Sale Area to warn of logging activity and truck traffic. Signs must be removed when harvest operations are suspended or completed. The Purchaser will provide these signs.

7 - Other Conditions

7.5 - Loss

7.5.1 - Deteriorating Timber (7/09)

The Sale Area has received damage from windthrow or jack pine budworm. The Purchaser should harvest the wood as soon as possible. The Department of Natural Resources is held free of responsibility of any further damage or deterioration due to delay in harvesting.



TIMBER SALE MAP

This information provided by authority of Part 525, 1994 PA 451, as amended.

Sale Number

72-010-24

Date

03/18/2025

Forest Management Unit

County

Mapped By: M. Lovelace

Scale

Page

Of

Grayling Mgt Unit

Oscoda

Cruised By: M. Lovelace, G. Price

1:20,000

1

1

Township
28N

Range
01E

Section(s) and

Subdivision(s) Sec. 27 SENW,SW; Sec. 33 SESE; Sec. 34 NW,NWSW,S1/2SW;

Cover Type

A = Aspen	J = Jack Pine	O = Oak	U = Upland Brush
B = Paper Birch	K = Rock	P = Lowland Poplar	UM = Upland Mix Forest
C = Cedar	L = Lowland Brush	Q = Mixed Swamp Conifer	V = Bog or Marsh
D = Treed Bog	LM = Lowland Mix Forest	R = Red Pine	W = White Pine
E = Swamp Hardwoods	M = Maple, Beech, Birch	S = Black Spruce	X = Non Stocked
F = Spruce/Fir	MC = Mixed Conifer	T = Tamarack	Y = Sand
G = Grass	MD = Mixed Deciduous		Z = Water
H = Hemlock	N = Marsh		

Density

0 = Non Stocked	5 = Pole Timber Medium
1 = Seedling Sapling Poor	6 = Pole Timber Well
2 = Seedling Sapling Medium	7 = Saw Timber Poor
3 = Seedling Sapling Well	8 = Saw Timber Medium
4 = Pole Timber Poor	9 = Saw Timber Well

Use QR Code to
open Map in App

Class Eh Mix

160.1 Acres

Compartment 72020

Payment Unit Number	Acres
1	22.5
2	17.8
3	14.3
4	105.6



0 0.25 0.5 1 Miles



28
PVT

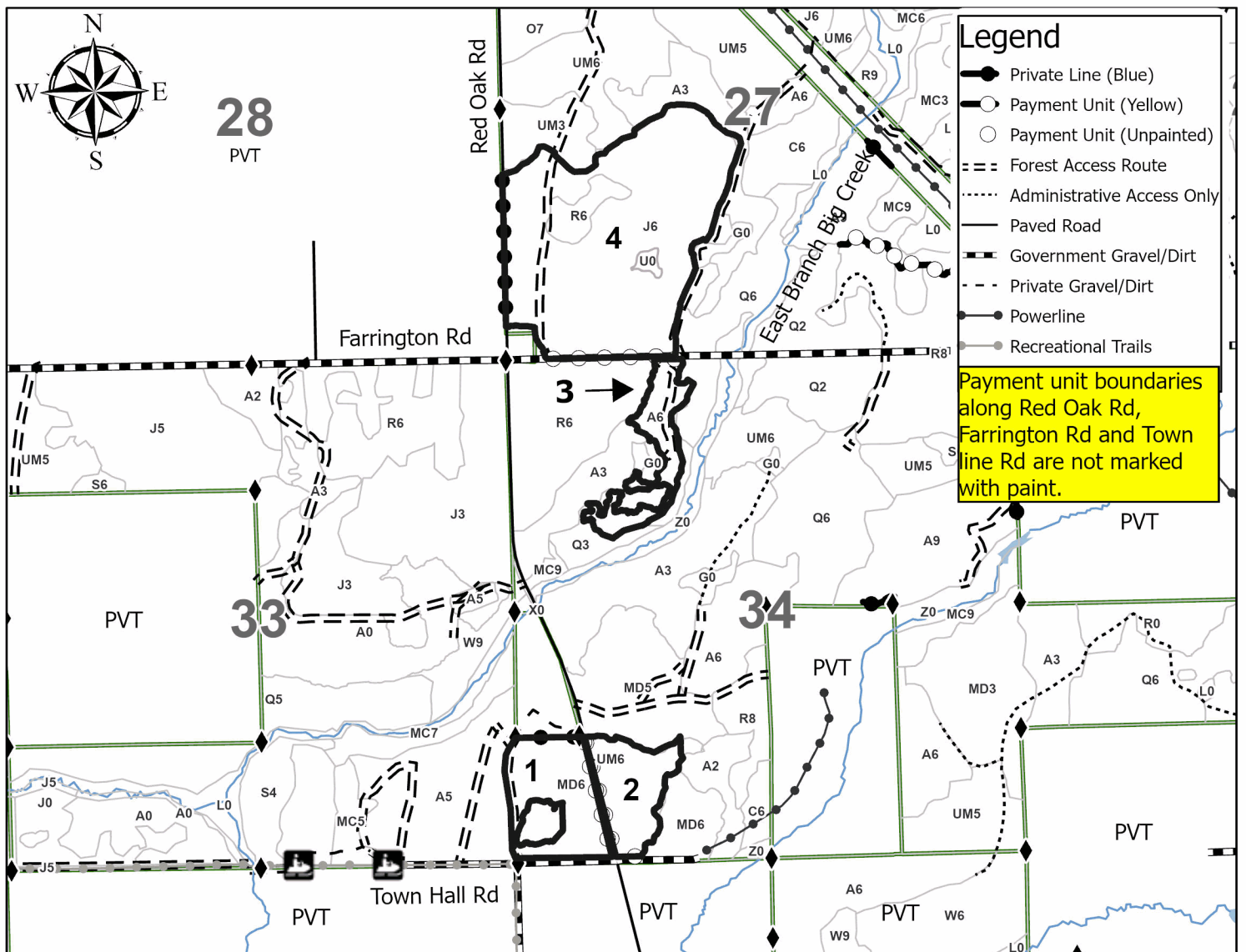

Legend

- Private Line (Blue)
- Payment Unit (Yellow)
- Payment Unit (Unpainted)
- Forest Access Route
- Administrative Access Only
- Paved Road
- Government Gravel/Dirt
- Private Gravel/Dirt
- Powerline
- Recreational Trails

Payment unit boundaries
along Red Oak Rd,
Farrington Rd and Town
line Rd are not marked
with paint.

TIMBER SALE INFORMATION

Runamok Lodge Mix (72-629-24)

T27N, R04W, SEC. 33.

Crawford County (Advertised Price \$18,777.85)

SALE NOTE: Sale not on certified land. Military land and specs apply. 3 year contract due to military timing restrictions. Soft Oak wilt timing restrictions applied for Payment Units 1 and 2, however the DNR may deny any requests to operate during the restricted timeframe. Access is on snowmobile trail, areas that are very sandy.

A recreation site such as a trail, pathway, or campground is within the sale area or the vicinity. Certain restrictions/specifications may be applicable including time restrictions.

A timber sale contract for this lump sum, sealed bid timber sale will be awarded to the responsible bidder offering the highest sealed bid price. All units of volume listed below were estimated using the Inventory Manager computer program and the new Michigan taper model. Bids must be at or above the following advertised price for each product and species:

<u>PRODUCTS & SPECIES</u>	<u>ESTIMATED UNITS*</u>	<u>ADVERTISED PRICE</u>
Sawtimber		
Red Maple	14.6 MBF	\$ 85.00 / MBF
Pulpwood		
Black Cherry	20 Cords	\$ 33.00 / Cord
Jack Pine	70 Cords	\$ 23.30 / Cord
Mixed Oak	41 Cords	\$ 25.35 / Cord
Quaking Aspen	206 Cords	\$ 24.75 / Cord
Red Maple	276 Cords	\$ 33.00 / Cord

* The total volume is statistically estimated within plus (+) or minus (-) 28.74 percent. There are an estimated 650 cords on this timber sale, plus or minus 187 cords at the 95% confidence level. The estimated units are final and not subject to adjustment. Prospective bidders are urged to examine this timber and to make their own estimates of quantity and quality.

BOND AND PAYMENT SCHEDULE:

1. A bond in the amount of \$939.00 to insure faithful performance of the conditions of the contract will be deposited by the successful bidder within 21 days of the sale award.
 2. Cutting in any sale or unit without the required advance payment would be considered a trespass.
 3. Total payment must be paid in advance or according to the following schedule :
 - (a) Ten percent (10%) of the sale value must be paid within 21 days of the sale award.
 - (b) The 10% down payment will be credited towards the first unit cut.
 - (c) Payment for each of the following units must be made before cutting begins in that unit:
- | PAYMENT UNIT NUMBER | PERCENT OF TOTAL SALE VALUE |
|---------------------|-----------------------------|
| 01 | 51.3% |
| 02 | 48.7% |

4. If no cutting takes place, the 10% down payment will not be refunded.
5. Operations on the contract issued will terminate on 06/30/2028.

SALE STATISTICS

Volumes were calculated in cubic feet using the Michigan taper model. Cubic foot volume includes all wood inside bark for the product indicated. For display purposes, cubic feet were converted to cords and MBF using a simple conversion factor, e.g. 79 cubic feet per cord and 185 cubic feet per MBF. The cubic foot volumes are precise; the cords and MBF volumes are not. Cubic foot volume cannot be directly converted to cords or boards with precision.

SALE VOLUMES

The total estimated sale volume may not equal the sum of the species/products due to the nature of statistical calculations associated with double sampling methodology.

VOLUME		STATISTICAL RANGE IN CORDS		
TOTAL CUBIC FEET	TOTAL CORDS	PERCENT ERROR	MINIMUM	MAXIMUM
51,354	650	28.74%	463	837

VDU VOLUMES

A VDU is a Volume Determination Unit. Volumes and their associated statistics are calculated at the VDU level and summarized to the sale level. There is often a one to one relationship between a VDU and a Payment Unit, but not always, depending on the cruise design. Refer to the VDU TO PAYMENT UNIT table.

VDU	VOLUME		PERCENT ERROR	RANGE IN CORDS	
	TOTAL CUBIC FEET	TOTAL CORDS		MINIMUM	MAXIMUM
26	51,354	650	28.74%	463	837
TOTAL:	51,354	650		463	837

VDU TO PAYMENT UNIT

When a VDU is associated with more than one Payment Unit (PU), the VDU volumes are assigned to the PU based on acres of the VDU within the PU.

VDU	VDU ACRES	PU	PU ACRES
26	28.8	1	14.8
26	28.8	2	14.0
TOTAL:	57.6		28.8

DESCRIPTION OF TIMBER BY PAYMENT UNIT (PU)

PU	MARKET GROUP	PRODUCT	QUANTITY	UNIT	ACRES	ADVERTISE PRICE
1	Red Maple	Sawtimber	7.5	MBF	14.8	\$9,648.15
	Black Cherry	Pulpwood	10	Cords		
	Jack Pine		36	Cords		
	Jack Pine	Sawtimber	0.8	MBF		
	Jack Pine	Pulpwood	34	Cords		
	Mixed Oak		21	Cords		
	/Red (Hybrid) Oak	Sawtimber	3.4	MBF		
	/Red (Hybrid) Oak	Pulpwood	13	Cords		
	White Oak		1	Cords		
	Quaking Aspen		106	Cords		
	Red Maple		142	Cords		
2	Red Maple	Sawtimber	7.1	MBF	14.0	\$9,153.00
	Black Cherry	Pulpwood	10	Cords		
	Jack Pine		35	Cords		
	Jack Pine	Sawtimber	0.8	MBF		
	Jack Pine	Pulpwood	33	Cords		
	Mixed Oak		20	Cords		
	/Red (Hybrid) Oak	Sawtimber	3.2	MBF		
	/Red (Hybrid) Oak	Pulpwood	13	Cords		
	White Oak		1	Cords		
	Quaking Aspen		100	Cords		
	Red Maple		134	Cords		
TOTAL:			14.6	MBF		
TOTAL:			614	Cords		

Sale Specific Conditions & Requirements

Sale Name: Runamok Lodge Mix

Sale Number: 72-629-24 Seq#: 2

1 - Sale Area

1.2 - Boundaries

1.2.1 - Painted Boundaries (9/19)

The sale boundary and Payment Unit boundaries are marked and identified by blue, red and yellow paint. Exterior sale boundary lines against private property are marked with blue paint. Exterior sale boundary lines against state are marked with red paint. Interior Payment Unit boundaries are marked with yellow paint. Retention patches are marked with red paint; no harvesting activities may occur within these areas. The painted boundary line trees are not Included Timber and are to be protected. Yellow painted trees designating an interior Payment Unit boundary are only to be cut when all surrounding Payment Units have been paid.

2 - Timber Specifications

2.1 - Included Timber

2.1.1 - Clearcut Unit(s) with Unmerchantable Trees (6/14)

Within Payment Unit(s) 1 and 2, cut all trees that are two (2) inches or more at DBH, except do not cut any white oak that are 26 inches or more at DBH.

Special protection trees identified in accordance with condition 3.4.2, within clearcutting unit boundaries, are not Included Timber and are to be protected.

2.2 - Utilization

2.2.2 - Chipping required (2/18)

Payment Units 1 and 2 must be chip harvested to meet National Guard requirements. However, the chipping requirement could be waived with military approval, if chip markets are depressed. The Purchaser has the option to produce sawlogs or pulpwood bolts, but the remaining portion of the trees must be chipped and hauled. The requirement to retain approximately 1/6 to 1/3 of tree tops and limbs less than four inches in diameter does not apply (G. C. & R. 2.2). This is to fulfill military requirements.

2.2.3 - Stump heights (4/07)

Stump heights within the Sale Area shall not exceed 6 inches for all trees. This is in order to facilitate military requirements.

3 - Payments

3.4 - Damaged Timber

3.4.1 - Damaged timber (7/16)

General Condition and Requirement 3.4 Damaged Timber, defines liquidated damages for undesignated live merchantable trees which are cut or injured.

No damage is acceptable to undesignated live merchantable trees. Within the Sale Area, if more than 10 % of trees (> 4.5" DBH) within a specified area of the sale are damaged, liquidated damages will be assessed for all trees damaged.

3.4.2 - Special Protection Trees (1/25)

The Purchaser shall not cut live or dead special protection trees within cutting units or clearings. Special protection trees are 26 inches or more at DBH. If Purchaser's operations have cut or damaged special protection trees through carelessness, the Purchaser shall pay \$500 as fixed, agreed and liquidated damages for each special protection tree cut or damaged. Such payment does not constitute ownership of the undesignated timber.

4 - Transportation

4.1 - Construction

4.1.3 - Slash and Earthen Piles (8/04)

Piles or windrows of earth along roads and landings that have been widened or constructed shall be leveled. Slash from road

maintenance or construction, including stumps, shall be chipped, utilized or otherwise removed from the sale.

4.1.6 - Road Construction (4/24)

Construction/improvements of existing roads shall be done in such a way as to minimize the environmental and visual impacts. Merchantable trees shall be cut and utilized unless otherwise directed. Non-merchantable trees shall be severed and laid flat on the ground. Slash shall be chipped, utilized or otherwise removed from the sale. Stumps shall be set upright, not left on edge, and be moved at least 10 feet away from the road edge. Disturbed soil shall be feathered into the woods and not left in berms or windrows.

4.1.7 - Road Closure (10/11)

All new roads built into the sale must be blocked to vehicle traffic upon completion of the sale. Overgrown roads that are reopened shall be considered new roads. Some existing roads may also need to be closed, see the Timber Sale Map for locations. In general, this will require constructing a four (4') foot high berm of stumps and logs covered with earth. Stumps and brush must be placed along the remainder of the trail. These roads must be rendered impassable to cars and trucks. All stumps from road building and landing construction must be reserved to block any newly constructed roads upon completion of the sale. These stumps must be scattered along the road system to prohibit vehicular movement. Temporary berms may be required if no sale activity occurs for 30 or more consecutive days. Contact the Sale Administrator for specific details of design and placement.

4.1.11 - Permits (2/12)

The Purchaser will secure any necessary permits that may be required.

5 - Operations

5.1 - Notification

5.1.4 - Post-Sale Conference (10/16)

A post-sale conference on site between the Purchaser and sale administrator is required 5 days prior to the completion of active logging operations to determine clean-up and repair of landings, road edges, and the fulfillment of other contract specifications.

5.1.5 - National Guard Notification (1/25)

This sale is upon lands utilized for training by the Michigan National Guard - Camp Grayling. A minimum of five (5) business days prior to opening this sale, the Purchaser must request that the Sale Administrator contact the military for information regarding training plans that may impact sale operations.

5.2 - Conduct of Operations

5.2.2 - Hazard Trees/Snags

5.2.2.1 - Den Trees (10/16)

Obvious hollow and/or den trees shall be protected and left standing unless they are a safety hazard.

5.2.3 - Operating Restrictions

5.2.3.5 - Oak Wilt Restriction (1/18)

Within Payment Units 1 and 2, unless changed by written agreement, cutting, skidding, hauling within the sale and brushing of access roads to the sale are not permitted during the period of April 15 to July 15. Operations may be allowed if specific steps are taken to prevent damaging uncut oak during the high-risk period. Those steps may include completing all road brushing before April 15 and clearing a tree-length buffer along uncut oak cover before April 15. This is necessary to reduce the spread of oak wilt. For more information, contact the Unit Manager or his/her representative.

5.2.4 - Dead and Down Creation

5.2.4.4 - Dead and Down Creation, Grouse (6/18)

To encourage grouse and other wildlife, in Payment Unit(s) 1 and 2, leave one 12-inch or larger diameter (or largest diameter trees within stand) whole tree on the ground for every two (2) acres, preferably a hardwood species such as oak or maple or if no hardwoods are present, a pine species (white or red). These will be evenly scattered throughout the Payment Unit. This can be an unmerchantable piece or a full tree.

5.2.29 - Shrub Protection (1/20)

Reasonable care should be taken not to cut hawthorn, dogwood or juneberry. These woody-shrub plants are highly beneficial to various wildlife species.

5.2.32 - Decking/Landing Restoration (9/13)

All decking and landing areas must have the surface area restored to a condition equal to or better than before. This is to ensure the proper regeneration of the stand. Wood debris, chips and "cookies" from trimmings must be removed or scattered away from landing and loading areas and may not be windrowed on the edge.

5.2.38 - No Decking Against Live Trees (2/04)

Cut products may not be decked against unmarked or designated leave trees.

5.2.41 - Snowmobile Trail Protection (9/11)

Trail #79 is a snowmobile trail and is shown on the Timber Sale Map. Do not cut or damage posts with orange trail markers or traffic control signs. If the trail is used, it must be maintained and restored to a condition equal to or better than before the sale. The road maintenance/restoration must be done prior to December 1. If the trail is used for hauling, it must be graded to the satisfaction of the Unit Manager or his/her representative prior to December 1. The snowmobile trail may not be used for any timber sale operations from December 1 to March 31 without written approval of Unit Manager. If the trail road is to be used for hauling during the snowmobile season, then a snow-covered base must be left on the trail. The snowmobile trail may only be crossed at right angles. Maintain a 20-foot-wide slash, debris, and rut free zone daily using the snowmobile trail as the centerline. No decking of forest products will be permitted along the snowmobile trail. In addition, any trees cut within 5 feet of the trail must be cut flush at ground level.

5.8 - Protection of Endangered Species

5.8.5 - Protection of Raptor Nests (3/13)

All trees with raptor nests will be protected if found during harvesting operations. Notification will be made to the Unit Manager or his/her representative who will notify the Wildlife Biologist so an onsite evaluation and recommendation can be made, if necessary.

6 - Safety and Fire Prevention

6.2 - Signing

6.2.2 - Snowmobile Trail Posting (10/20)

The Purchaser is responsible for posting and maintaining caution signs on Snowmobile Trail #79 prior to beginning operations during the snowmobile season (approximately December 1 to March 31). The trail must be posted at appropriate distances from the Sale Area to warn of logging activity and truck traffic. Signs must be removed when harvest operations are suspended or completed. The Purchaser will provide these signs.

SKIP

6.4 - Unexploded Ordinance (7/15)

Be aware that the Sale Area could contain UXO (unexploded ordinances). Do not touch or drive over any metal objects. If any objects are found, please flag the area and notify the Unit Manager or his/her representative, so that they can make arrangements with the Military.

7 - Other Conditions

7.10 - Certified Timber

7.10.1 - Non-Certified Timber (2/16)

The area encompassed by this timber sale is not certified to the standards of the Forest Stewardship Council (FSC) or the Sustainable Forestry Initiative (SFI). Forest products from this sale may not be delivered to the mill as "FSC and / or SFI certified". The lands within this sale are managed for military training.

**TIMBER SALE MAP**

This information provided by authority of Part 525, 1994 PA 451, as amended.

Sale Number

72-629-24

Date

01/22/2025

Forest Management Unit

Grayling Mgt Unit

County

Crawford

Mapped By: Porteous

Cruised By: Porteous

Scale

1:10,000

Page

1

Of

1Township
27NRange
04WSection(s) and
Subdivision(s) Sec. 33 E1/2NW,W1/2NE;**Cover Type**

A = Aspen	J = Jack Pine	O = Oak	U = Upland Brush
B = Paper Birch	K = Rock	P = Lowland Poplar	UM = Upland Mix Forest
C = Cedar	L = Lowland Brush	Q = Mixed Swamp Conifer	V = Bog or Marsh
D = Treed Bog	LM = Lowland Mix Forest	R = Red Pine	W = White Pine
E = Swamp Hardwoods	M = Maple, Beech, Birch	S = Black Spruce	X = Non Stocked
F = Spruce/Fir	MC = Mixed Conifer	T = Tamarack	Y = Sand
G = Grass	MD = Mixed Deciduous	Z = Water	
H = Hemlock	N = Marsh		

Density

0 = Non Stocked	5 = Pole Timber Medium
1 = Seedling Sapling Poor	6 = Pole Timber Well
2 = Seedling Sapling Medium	7 = Saw Timber Poor
3 = Seedling Sapling Well	8 = Saw Timber Medium
4 = Pole Timber Poor	9 = Saw Timber Well

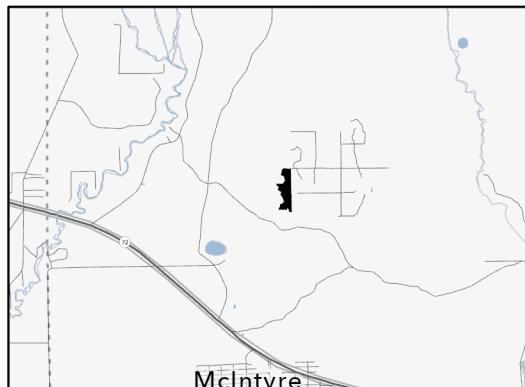
Locator Map 1:125,000**Payment Unit Acres**

1	14.8
2	14.1

**Runamok
Lodge Mix****Cmpt 180****28.8 Acres**

0 0.15 0.3 0.6 Miles

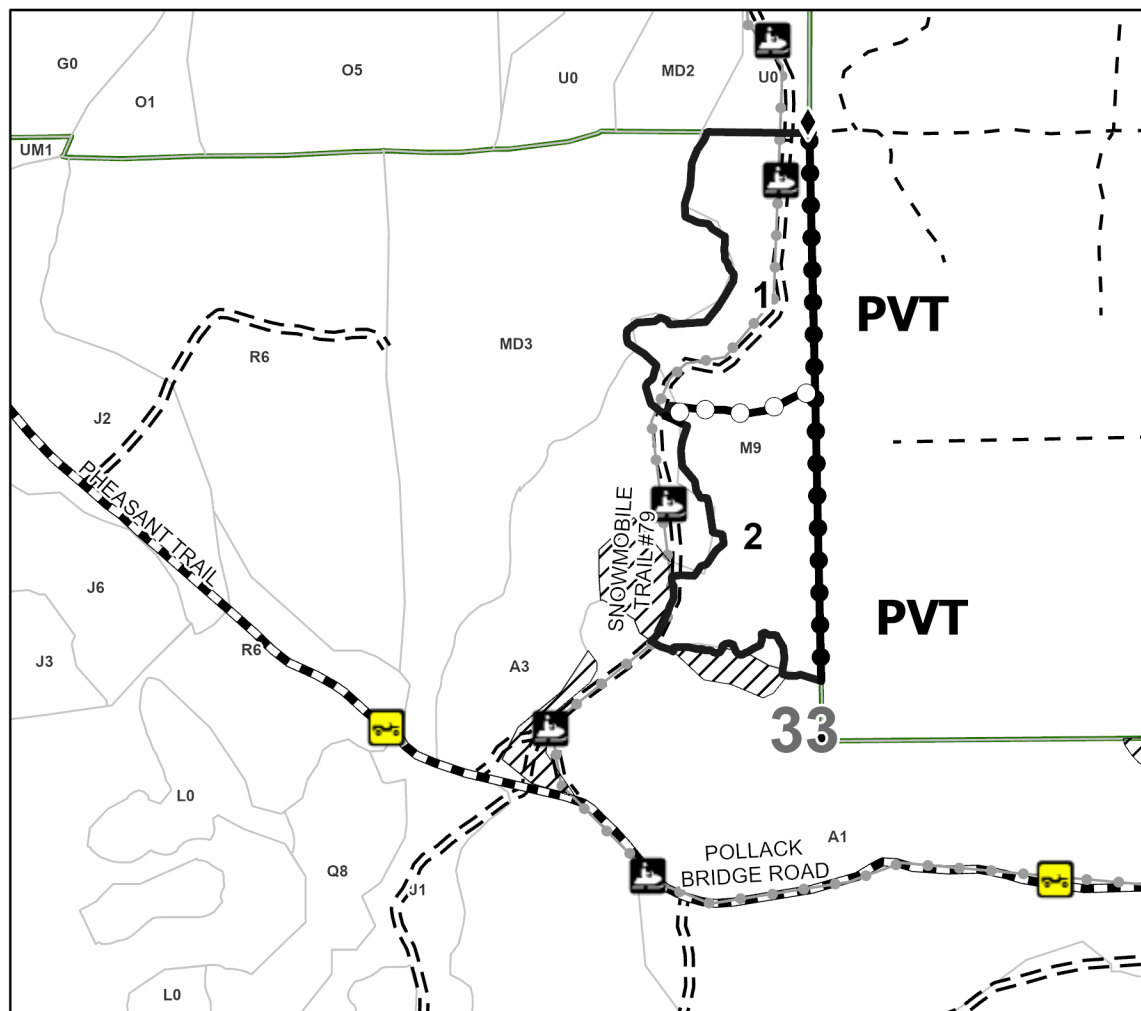
**Legend**

- Against State (Red)
- Private Line (Blue)
- Payment Unit (Yellow)
- Retention Areas
- Forest Access Route
- Government Gravel/Dirt
- Private Gravel/Dirt
- Recreational Trails
- ORV Route
- Snowmobile
- Survey Corner

Use QR Code to
open Map in App

TIMBER SALE INFORMATION

C'mere Deer Mix (72-632-24)
T27N, R02W, SEC. 31; T27N, R02W, SEC. 32.
Crawford County (Advertised Price \$88,967.45)

SALE NOTE: Sale is on non-certified land. Standard military specifications, including possible unexploded ordinance. Possible closures due to military training. Sandy access roads may require fill/more maintenance for trucking. Oak wilt timing restrictions in Payment Units 1, 4, and 5.

A timber sale contract for this lump sum, sealed bid timber sale will be awarded to the responsible bidder offering the highest sealed bid price. All units of volume listed below were estimated using the Inventory Manager computer program and the new Michigan taper model. Bids must be at or above the following advertised price for each product and species:

<u>PRODUCTS & SPECIES</u>	<u>ESTIMATED UNITS*</u>	<u>ADVERTISED PRICE</u>
Sawtimber		
Mixed Oak	79.2 MBF	\$ 141.00 / MBF
White Oak	35.6 MBF	\$ 126.00 / MBF
Pulpwood		
Jack Pine	901 Cords	\$ 23.30 / Cord
Mixed Aspen	1,165 Cords	\$ 24.75 / Cord
Mixed Hardwood	80 Cords	\$ 33.00 / Cord
Mixed Oak	780 Cords	\$ 25.35 / Cord
Red Pine	17 Cords	\$ 44.55 / Cord
White Pine	15 Cords	\$ 21.15 / Cord

* The total volume is statistically estimated within plus (+) or minus (-) 9.53 percent. There are an estimated 3,224 cords on this timber sale, plus or minus 307 cords at the 95% confidence level. The estimated units are final and not subject to adjustment. Prospective bidders are urged to examine this timber and to make their own estimates of quantity and quality.

BOND AND PAYMENT SCHEDULE:

1. A bond in the amount of \$4,448.00 to insure faithful performance of the conditions of the contract will be deposited by the successful bidder within 21 days of the sale award.
2. Cutting in any sale or unit without the required advance payment would be considered a trespass.
3. Total payment must be paid in advance or according to the following schedule :
 - (a) Ten percent (10%) of the sale value must be paid within 21 days of the sale award.
 - (b) The 10% down payment will be credited towards the first unit cut.
 - (c) Payment for each of the following units must be made before cutting begins in that unit:

<u>PAYMENT UNIT NUMBER</u>	<u>PERCENT OF TOTAL SALE VALUE</u>
01	13.6%
02	15.9%
03	16.3%
04	19.9%
05	7.2%
06	10.2%
07	10.8%
08	1.5%
09	4.6%

4. If no cutting takes place, the 10% down payment will not be refunded.
5. Operations on the contract issued will terminate on 06/30/2029.

SALE STATISTICS

Volumes were calculated in cubic feet using the Michigan taper model. Cubic foot volume includes all wood inside bark for the product indicated. For display purposes, cubic feet were converted to cords and MBF using a simple conversion factor, e.g. 79 cubic feet per cord and 185 cubic feet per MBF. The cubic foot volumes are precise; the cords and MBF volumes are not. Cubic foot volume cannot be directly converted to cords or boards with precision.

SALE VOLUMES

The total estimated sale volume may not equal the sum of the species/products due to the nature of statistical calculations associated with double sampling methodology.

VOLUME			STATISTICAL RANGE IN CORDS	
TOTAL CUBIC FEET	TOTAL CORDS	PERCENT ERROR	MINIMUM	MAXIMUM
254,695	3,224	9.53%	2,917	3,531

VDU VOLUMES

A VDU is a Volume Determination Unit. Volumes and their associated statistics are calculated at the VDU level and summarized to the sale level. There is often a one to one relationship between a VDU and a Payment Unit, but not always, depending on the cruise design. Refer to the VDU TO PAYMENT UNIT table.

	VOLUME			RANGE IN CORDS	
VDU	TOTAL CUBIC FEET	TOTAL CORDS	PERCENT ERROR	MINIMUM	MAXIMUM
7	62,976	797	18.42%	650	944
8	38,626	489	26.24%	361	617
15	41,816	529	26.60%	389	670
16	10,726	136	56.29%	59	212
17	2,751	35	83.47%	6	64
18	20,233	256	22.59%	198	314
19	31,265	396	25.21%	296	496
20	29,616	375	33.29%	250	500
45	4,533	57	74.37%	15	100
51	12,151	154	41.34%	90	217
TOTAL:	254,695	3,224		2,314	4,134

VDU TO PAYMENT UNIT

When a VDU is associated with more than one Payment Unit (PU), the VDU volumes are assigned to the PU based on acres of the VDU within the PU.

VDU	VDU ACRES	PU	PU ACRES
7	39.9	1	17.9
7	39.9	2	12.3
7	39.9	3	9.7
8	26.4	2	11.2
8	26.4	3	15.2
15	25.7	4	25.7
16	15.9	4	15.9
17	7.6	4	4.7
17	7.6	5	2.9
18	26.3	5	26.3
19	33.3	7	33.3
20	30.3	6	30.3
45	6.3	8	6.3
51	6.3	9	6.3
TOTAL:	331.8		218.0

DESCRIPTION OF TIMBER BY PAYMENT UNIT (PU)

PU	MARKET GROUP	PRODUCT	QUANTITY	UNIT	ACRES	ADVERTISE PRICE
1	Mixed Oak	Sawtimber	27.7	MBF	17.9	\$12,076.30
	/Red (Hybrid) Oak		0.5	MBF		
	Red Oak		27.2	MBF		
	White Oak	Pulpwood	9.7	MBF		
	Jack Pine		2	Cords		
	Mixed Aspen		79	Cords		
	B. T. Aspen		79	Cords		
	Mixed Hardwood		17	Cords		
	Red Maple		17	Cords		
	Mixed Oak		173	Cords		
	/Red (Hybrid) Oak		11	Cords		
	Red Oak		90	Cords		
	White Oak		72	Cords		
2	Mixed Oak	Sawtimber	24.0	MBF	23.5	\$14,165.50
	/Red (Hybrid) Oak		0.7	MBF		
	Red Oak		23.3	MBF		
	White Oak	Pulpwood	9.6	MBF		
	Jack Pine		5	Cords		
	Mixed Aspen		158	Cords		
	B. T. Aspen		158	Cords		
	Mixed Hardwood		19	Cords		
	Red Maple		19	Cords		
	Mixed Oak		194	Cords		
	/Red (Hybrid) Oak		12	Cords		
	Red Oak		118	Cords		
	White Oak		64	Cords		
3	Mixed Oak	Sawtimber	21.8	MBF	24.9	\$14,502.00
	/Red (Hybrid) Oak		0.8	MBF		
	Red Oak		21.0	MBF		
	White Oak	Pulpwood	9.3	MBF		
	Jack Pine		6	Cords		
	Mixed Aspen		184	Cords		
	B. T. Aspen		184	Cords		
	Mixed Hardwood		18	Cords		
	Red Maple		18	Cords		
	Mixed Oak		196	Cords		
	/Red (Hybrid) Oak		12	Cords		
	Red Oak		125	Cords		
	White Oak		59	Cords		
4	Mixed Oak	Sawtimber	2.6	MBF	46.3	\$17,706.55
	/Red (Hybrid) Oak		1.8	MBF		
	Red Oak		0.8	MBF		
	White Oak	Pulpwood	6.4	MBF		
	Jack Pine		101	Cords		
	Mixed Aspen		467	Cords		
	B. T. Aspen		465	Cords		
	Quaking Aspen		2	Cords		
	Mixed Hardwood		18	Cords		
	Red Maple		18	Cords		
	Mixed Oak		80	Cords		
	/Red (Hybrid) Oak		34	Cords		
	Red Oak		15	Cords		
	White Oak		31	Cords		
5	Jack Pine	Pulpwood	203	Cords	29.2	\$6,406.30
	Mixed Aspen		20	Cords		
	Quaking Aspen		20	Cords		

DESCRIPTION OF TIMBER BY PAYMENT UNIT (PU), CON'T

PU	MARKET GROUP	PRODUCT	QUANTITY	UNIT	ACRES	ADVERTISE PRICE			
5 con't	Mixed Hardwood	Pulpwood	2	Cords					
	Black Cherry		2	Cords					
	Mixed Oak		44	Cords					
	/Red (Hybrid) Oak		38	Cords					
	White Oak		6	Cords					
6	Mixed Oak	Sawtimber	0.8	MBF	30.3	\$9,042.55			
	/Red (Hybrid) Oak		0.8	MBF					
	Jack Pine	Pulpwood	224	Cords					
	Mixed Aspen		111	Cords					
	B. T. Aspen		10	Cords					
	Quaking Aspen		101	Cords					
	Mixed Oak		38	Cords					
	/Red (Hybrid) Oak		34	Cords					
	White Oak		4	Cords					
	7		Mixed Oak	Sawtimber			2.3	MBF	33.3
/Red (Hybrid) Oak			2.3	MBF					
White Oak			0.6	MBF					
Jack Pine		Pulpwood	303	Cords					
Mixed Aspen			25	Cords					
B. T. Aspen			25	Cords					
Mixed Hardwood			6	Cords					
Black Cherry			6	Cords					
Mixed Oak			53	Cords					
/Red (Hybrid) Oak			41	Cords					
Red Oak			5	Cords					
White Oak			7	Cords					
8			Jack Pine	Pulpwood	57	Cords	6.3	\$1,328.10	
9		Mixed Aspen	Pulpwood	121	Cords	6.3	\$4,120.05		
	Quaking Aspen	121		Cords					
	Mixed Oak	2		Cords					
	/Red (Hybrid) Oak	2		Cords					
	Red Pine	17		Cords					
	White Pine	15		Cords					
TOTAL:			114.8	MBF					
TOTAL:			2,958	Cords					

Sale Specific Conditions & Requirements

Sale Name: C'mere Deer Mix

Sale Number: 72-632-24 Seq#: 2

1 - Sale Area

1.2 - Boundaries

1.2.1 - Painted Boundaries (9/19)

The sale boundary and Payment Unit boundaries are marked and identified by red, yellow, and blue paint, as well as roads (see Timber Sale Map). Exterior sale boundary lines against state are marked with red paint, with the exception of certain sale boundaries against roads as identified on the Timber Sale Map. Interior Payment Unit boundaries are marked with yellow paint, with the exception of certain interior Payment Unit boundaries against roads as identified on the Timber Sale Map. Retention patches are marked with red paint; no harvesting activities may occur within these areas. The painted boundary line trees are not Included Timber and are to be protected. Yellow painted trees designating an interior Payment Unit boundary are only to be cut when all surrounding Payment Units have been paid.

2 - Timber Specifications

2.1 - Included Timber

2.1.1 - Clearcut Unit(s) with Unmerchantable Trees (6/14)

Within Payment Unit(s) 1-5 and 7-9, cut all trees that are two (2) inches or more at DBH, except for the following:

- Within Payment Units 1-5 and 7, do not cut any red or white pine.
- Within Payment Unit 9, do not cut any pine that are 26 inches or more at DBH.

2.1.7 - Leave Tree Marked Unit(s) (6/14)

Within Payment Unit(s) 6, cut all trees that are two (2) inches or more at DBH, except do not cut any white oak that are 12 inches or more at DBH or any trees marked with green paint.

2.2 - Utilization

2.2.2 - Chipping required (2/18)

This area must be chip harvested to meet National Guard requirements. The Purchaser has the option to produce sawlogs or pulpwood bolts, but the remaining portion of the trees must be chipped and hauled. The requirement to retain approximately 1/6 to 1/3 of tree tops and limbs less than four inches in diameter does not apply (G. C. & R. 2.2). This is because this is non-certified Military land.

2.2.3 - Stump heights (4/07)

Stump heights within the Sale Area shall not exceed 6 inches for all trees. This is in order to facilitate military requirements.

3 - Payments

3.4 - Damaged Timber

3.4.1 - Damaged timber (7/16)

General Condition and Requirement 3.4 Damaged Timber, defines liquidated damages for undesignated live merchantable trees which are cut or injured.

Within the Sale Area, if more than 10% of trees greater than 4.5" DBH within a specified portion of the Sale Area are damaged, liquidated damages will be assessed for all acreage within that specified portion of the Sale Area that was damaged.

No damage is acceptable to undesignated live merchantable trees. Liquidated damages will be assessed for all trees damaged. Rates will be in accordance with General Condition and Requirement 3.4.

3.4.2 - Special Protection Trees (1/25)

The Purchaser shall not cut live or dead special protection trees within cutting units or clearings. Special protection trees are marked with green paint or any tree that is 26 inches or more at DBH. If Purchaser's operations have cut or damaged special protection trees through carelessness, the Purchaser shall pay \$500 as fixed, agreed and liquidated damages for each special protection tree cut or damaged. Such payment does not constitute ownership of the undesignated timber.

4 - Transportation

4.1 - Construction

4.1.3 - Slash and Earthen Piles (8/04)

Piles or windrows of earth along roads and landings that have been widened or constructed shall be leveled. Slash from road maintenance or construction, including stumps, shall be chipped, utilized or otherwise removed from the sale.

4.1.6 - Road Construction (4/24)

Construction of new roads or improvements of existing roads shall be done in such a way as to minimize the environmental and visual impacts. Merchantable trees shall be cut and utilized unless otherwise directed. Non-merchantable trees shall be severed and laid flat on the ground. Slash shall be chipped, utilized or otherwise removed from the sale. Stumps shall be set upright, not left on edge, and be moved at least 10 feet away from the road edge. Disturbed soil shall be feathered into the woods and not left in berms or windrows.

4.1.7 - Road Closure (10/11)

All new roads built into the sale must be blocked to vehicle traffic upon completion of the sale. Overgrown roads that are reopened shall be considered new roads. Some existing roads may also need to be closed. In general, this will require constructing a four (4') foot high berm of stumps and logs covered with earth. These roads must be rendered impassable to cars and trucks. All stumps from road building and landing construction must be reserved to block any newly constructed roads upon completion of the sale. These stumps must be scattered along the road system to prohibit vehicular movement. Temporary berms may be required if no sale activity occurs for 30 or more consecutive days. Contact the Sale Administrator for specific details of design and placement.

4.1.11 - Permits (2/12)

The Purchaser will secure any necessary permits that may be required.

4.2 - Maintenance

4.2.2 - Fill Material (4/07)

To maintain roads, fill material may be needed in areas where "holes" exist or may be expected to develop. This fill material should be placed before trucking begins.

5 - Operations

5.1 - Notification

5.1.4 - Post-Sale Conference (10/16)

A post-sale conference on site between the Purchaser and sale administrator is required 5 days prior to the completion of active logging operations to determine clean-up and repair of landings, road edges, and the fulfillment of other contract specifications.

5.1.5 - National Guard notification (2/15)

This sale is upon lands utilized for training by the Michigan National Guard - Camp Grayling. A minimum of five (5) business days prior to opening this sale, the producer must request that the sale administrator contact the military for information regarding training plans that may impact sale operations.

5.2 - Conduct of Operations

5.2.2 - Hazard Trees/Snags

5.2.2.1 - Den Trees (10/16)

Obvious hollow and/or den trees shall be protected and left standing unless they are a safety hazard.

5.2.3 - Operating Restrictions

5.2.3.5 - Oak Wilt Restriction (1/18)

Within Payment Units 1 and 3-5, unless changed by written agreement, cutting, skidding, hauling within the sale and brushing of access roads to the sale are not permitted during the period of April 15 to July 15. Operations may be allowed if specific steps are taken to prevent damaging uncut oak during the high-risk period. Those steps may include completing all road brushing before April 15 and clearing a tree-length buffer along uncut oak cover before April 15. This is

necessary to reduce the spread of oak wilt. For more information, contact the Unit Manager or his/her representative.

5.2.3.7 - National Guard training restriction (1/09)

Operations on this contract may not be allowed during National Guard training operations. Typically, the restricted period is from May 1 to October 31. The contractor must check with the Unit Manager who will coordinate the cutting schedule with the Military.

5.2.4 - Dead and Down Creation

5.2.4.4 - Dead and Down Creation, Grouse (6/18)

To encourage grouse and other wildlife, in Payment Unit(s) 1-5 and 9, leave one 12-inch or larger diameter (or largest diameter trees within stand) whole tree on the ground for every two (2) acres, preferably a hardwood species such as oak or maple or if no hardwoods are present, a pine species (white or red). These will be evenly scattered throughout the Payment Unit. This can be an unmerchantable piece or a full tree.

5.2.29 - Shrub Protection (1/20)

Reasonable care should be taken to avoid cutting hawthorn, dogwood or juneberry. These woody-shrub plants are highly beneficial to various wildlife species.

5.2.32 - Decking/Landing Restoration (9/13)

All decking and landing areas must have the surface area restored to a condition equal to or better than before. This is to ensure the proper regeneration of the stand. Wood debris, chips and "cookies" from trimmings must be removed or scattered away from landing and loading areas and may not be windrowed on the edge.

5.2.37 - No Decking Areas (12/08)

No decking is allowed in areas identified on the Timber Sale Map due to the presence of sensitive species.

5.2.38 - No Decking Against Live Trees (2/04)

Cut products may not be decked against unmarked or designated leave trees.

5.8 - Protection of Endangered Species

5.8.5 - Protection of Raptor Nests (3/13)

All trees with raptor nests will be protected if found during harvesting operations. Notification will be made to the Unit Manager or his/her representative who will notify the Wildlife Biologist so an onsite evaluation and recommendation can be made, if necessary.

6 - Safety and Fire Prevention

6.2 - Signing

6.2.1 - Road Posting (10/20)

The Purchaser is responsible for posting and maintaining caution signs on Stephan Bridge Road prior to beginning operations. The road must be posted at appropriate distances from the Sale Area to warn of logging activity and truck traffic. Signs must be removed when harvest operations are suspended or completed. The Purchaser will provide these signs.

SKIP

6.4 - Unexploded Ordinance (7/15)

Be aware that the Sale Area could contain UXO (unexploded ordinances). Do not touch or drive over any metal objects. If any objects are found, please flag the area and notify the Unit Manager or his/her representative, so that they can make arrangements with the Military.

7 - Other Conditions

7.10 - Certified Timber

7.10.1 - Non-Certified Timber (2/16)

The area encompassed by this timber sale is not certified to the standards of the Forest Stewardship Council (FSC) or the Sustainable Forestry Initiative (SFI). Forest products from this sale may not be delivered to the mill as "FSC and / or SFI certified". The lands within this sale are managed for military training.



TIMBER SALE MAP

This information provided by authority of Part 525, 1994 PA 451, as amended.

Sale Number

72-632-24

Date

02/26/2025

Forest Management Unit

County

Mapped By: Porteous

Scale

Page

Of

Grayling Mgt Unit

Crawford

Cruised By: Porteous

1:17,650

1

1

Township
27N

Range
02W

Section(s) and
Subdivision(s)

Sec. 31 N1/2NE,SENE; Sec. 32 N1/2NW,SWNW,SENE,N1/2SW,SESW; Sec. 32 SWSE;

Cover Type

A = Aspen	J = Jack Pine	O = Oak	U = Upland Brush
B = Paper Birch	K = Rock	P = Lowland Poplar	UM = Upland Mix Forest
C = Cedar	L = Lowland Brush	Q = Mixed Swamp Conifer	V = Bog or Marsh
D = Treed Bog	LM = Lowland Mix Forest	R = Red Pine	W = White Pine
E = Swamp Hardwoods	M = Maple, Beech, Birch	S = Black Spruce	X = Non Stocked
F = Spruce/Fir	MC = Mixed Conifer	T = Tamarack	Y = Sand
G = Grass	MD = Mixed Deciduous		Z = Water
H = Hemlock	N = Marsh		

Density

0 = Non Stocked	5 = Pole Timber Medium
1 = Seedling Sapling Poor	6 = Pole Timber Well
2 = Seedling Sapling Medium	7 = Saw Timber Poor
3 = Seedling Sapling Well	8 = Saw Timber Medium
4 = Pole Timber Poor	9 = Saw Timber Well

Locator Map 1:200,000



Payment Unit Number	Acres	Payment Unit Number	Acres
1	17.9	6	30.3
2	23.4	7	33.3
3	25	8	6.3
4	46.4	9	6.3
5	29.2		

C'mere Deer Mix

Comp 257

218.0 Acres

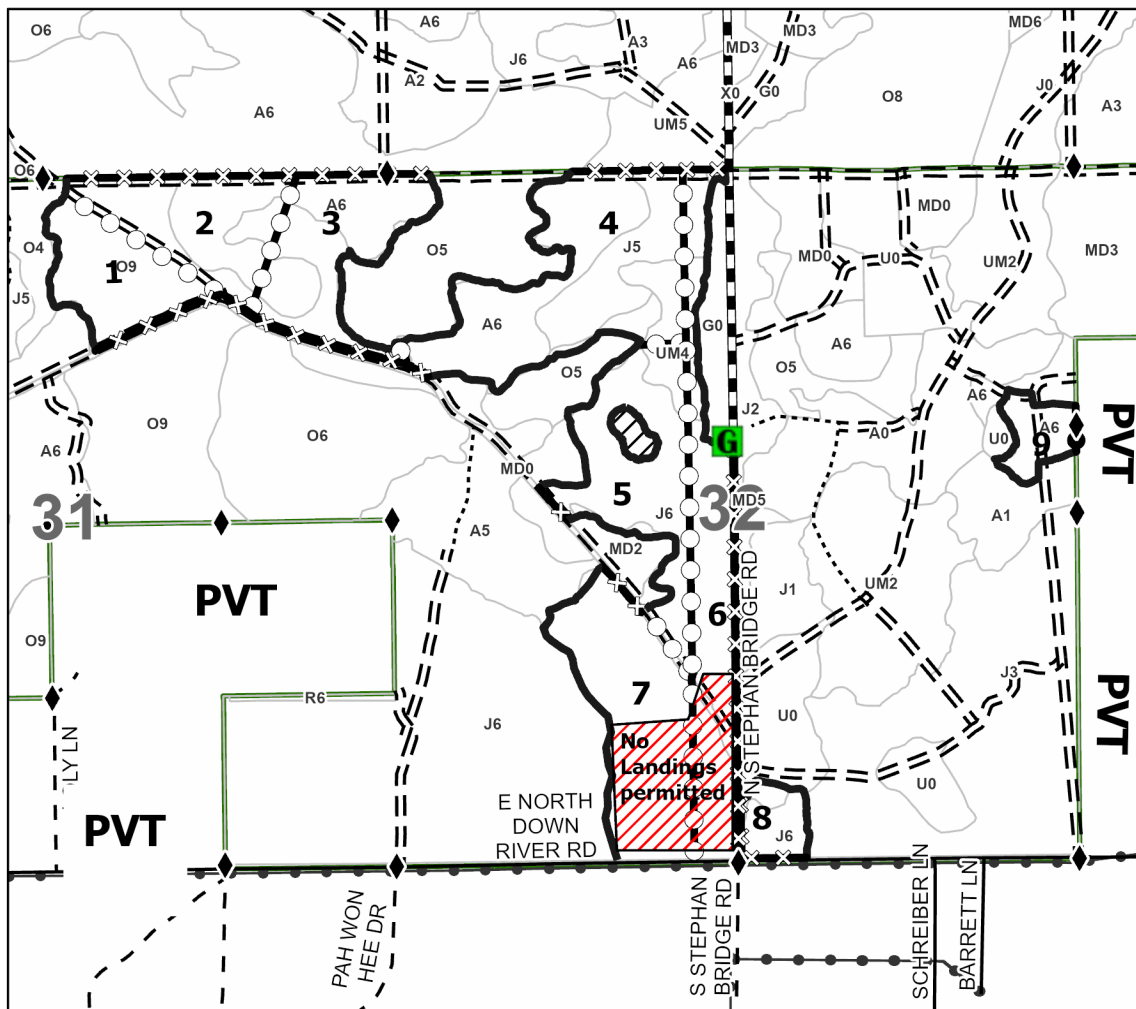
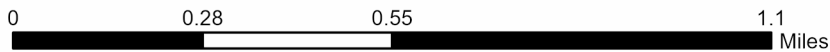

Legend

- Against State (Red)
- Against State (Unpainted)
- Private Line (Blue)
- Payment Unit (Yellow)
- Payment Unit (Unpainted)
- ▨ Retention Areas
- == Forest Access Route
- ... Administrative Access Only
- Paved Road
- Government Gravel/Dirt
- Private Gravel/Dirt
- Powerline
- Recreational Trails
- ◆ Survey Corner
- G** Gate

Use QR Code to open Map in App



Big Creek Blues (72-009-24)

T28N, R01E, SEC. 26; T28N, R01E, SEC. 27; T28N, R01E, SEC. 34; Oscoda

In response to the notice of sale to be held 9:00 a.m. (local time) on April 28, 2025, I am hereby submitting my sealed bid (firm offer) for the following forest products to be cut. Bids for individual species must be at or above the advertised price. All non-responsive bid forms may be rejected.

<u>PRODUCTS & SPECIES</u>	<u>ESTIMATED VOLUME*</u>	<u>ADVERTISED PRICE</u>	<u>BID PRICE/UNIT</u>
Sawtimber			
Northern Pin Oak	5.6 MBF	\$ 122.00/MBF	\$ _____
Red Maple	11.1 MBF	\$ 74.00/MBF	\$ _____
White Pine	142.7 MBF	\$ 53.00/MBF	\$ _____
Pulpwood			
Balsam Fir	170 Cords	\$ 18.80/Cord	\$ _____
Jack Pine	52 Cords	\$ 20.20/Cord	\$ _____
Mixed Aspen	1,175 Cords	\$ 21.45/Cord	\$ _____
Mixed Hardwood	296 Cords	\$ 28.60/Cord	\$ _____
Mixed Spruce	40 Cords	\$ 19.95/Cord	\$ _____
Northern Pin Oak	11 Cords	\$ 21.95/Cord	\$ _____
Paper Birch	9 Cords	\$ 23.00/Cord	\$ _____
Red Pine	1,766 Cords	\$ 38.60/Cord	\$ _____
White Pine	409 Cords	\$ 18.30/Cord	\$ _____

*The volumes are statistically estimated within plus (+) or minus (-) 13.10 percent at 95% confidence level. These estimated volumes are final and not subject to adjustment. Prospective bidders are urged to examine this timber and to make their own estimates of quantity and quality.

I understand that any or all bids may be rejected. All bids must be signed and all bid items must be bid or the bid form may be rejected. I also understand that consideration and awarding a contract will be based upon my past performance and ability to complete the contract based upon equipment and staffing subject to my control.

FEDERAL ID: ____ - ____ - ____ or SOCIAL SECURITY NUMBER: ____ - ____ - ____

Company or individual bidding: _____

Company representative's name: _____

Address: _____

City: _____ State: _____ Zip: _____

IF AVAILABLE, PLEASE PLACE THE PERSONALIZED LABEL FROM YOUR PROSPECTUS IN THE ABOVE BOX.

Individual or company representative's signature: _____ Date: _____

Phone number : _____ Email (optional): _____

**THE WINNING BIDDER MUST COMPLETE THE VERIFICATION OF WORKER'S DISABILITY COMPENSATION ACT
COMPLIANCE (ON REVERSE SIDE IF DOUBLE SIDED) WITHIN 21 DAYS OF SALE AWARD DATE**



TIMBER SALE VERIFICATION OF WORKER'S DISABILITY COMPENSATION ACT COMPLIANCE

As required by Act 317, P.A. 1969 (Worker's Compensation) and
Part 5 of Act 451 of 1994, as amended.

FOR DEPARTMENT USE ONLY

Sale Number (XX - XXX - XX - XX)

Forest Management Unit:

VERIFICATION OF WORKER'S DISABILITY COMPENSATION ACT COMPLIANCE

- This verification must be completed and submitted within 21 days of contract award and prior to the issuance of the timber sale contract.
- In addition, if boxes 2B or 2C are checked, then Notice of Exclusion or Certificate of Insurance must be submitted within twenty-one (21) days of the contract award and prior to the issuance of the timber sale contract.
- All information must be typed or printed except for written signatures.

Please Check Appropriate Categories:

1. My business is organized as (you **must** check one of the boxes below):
 - A. ☐ Sole Proprietorship (individual)
 - B. ☐ Partnership
 - C. ☐ Corporation
2. You **must** check one of the boxes below:
 - A. ☐ I certify my business is a sole proprietorship and it has no employees but the sole proprietor. I am not subject to the Worker's Compensation Laws.
 - B. ☐ I certify my business has satisfied its obligation to the Worker's Compensation Act through the use of an approved Notice of Exclusion (BWC-337, Rev. 5/96). I will provide a copy of the Notice of Exclusion within 21 days of the contract award. (For questions or a copy of the BWC-337, please call the Worker's Compensation Bureau at 517-322-1195).
 - C. ☐ I certify my business has a Worker's Compensation Policy. I will provide an original Certificate of Insurance within twenty-one (21) days of the contract award.
3. If you have checked item 2(A) or 2(B), you **must** indicate the number of **both** full-time and part-time employees, other than yourself, including family members and active partners (if none, you must enter "0").

_____ Full-time Employees

_____ Part-time Employees

Name of Business		Federal ID (or) Social Security No.
Address		Telephone ()
City	State	ZIP

I hereby certify that the above information is true and correct. I agree to notify the Michigan DNR of any changes that occur in factors affecting my coverage during any of my present and future operations.

Signature of Owner or Authorized Representative

Title

Date

Please complete the "SEALED BID" information on the next page

C'mere Deer Mix (72-632-24)
T27N, R02W, SEC. 31; T27N, R02W, SEC. 32; Crawford COUNTY

In response to the notice of sale to be held 9:00 a.m. (local time) on April 28, 2025, I am hereby submitting my sealed bid (firm offer) for the following forest products to be cut. Bids for individual species must be at or above the advertised price. All non-responsive bid forms may be rejected.

<u>PRODUCTS & SPECIES</u>	<u>ESTIMATED VOLUME*</u>	<u>ADVERTISED PRICE</u>	<u>BID PRICE/UNIT</u>
Sawtimber			
Mixed Oak	79.2 MBF	\$ 141.00/MBF	\$ _____
White Oak	35.6 MBF	\$ 126.00/MBF	\$ _____
Pulpwood			
Jack Pine	901 Cords	\$ 23.30/Cord	\$ _____
Mixed Aspen	1,165 Cords	\$ 24.75/Cord	\$ _____
Mixed Hardwood	80 Cords	\$ 33.00/Cord	\$ _____
Mixed Oak	780 Cords	\$ 25.35/Cord	\$ _____
Red Pine	17 Cords	\$ 44.55/Cord	\$ _____
White Pine	15 Cords	\$ 21.15/Cord	\$ _____

*The volumes are statistically estimated within plus (+) or minus (-) 9.53 percent at 95% confidence level. These estimated volumes are final and not subject to adjustment. Prospective bidders are urged to examine this timber and to make their own estimates of quantity and quality.

I understand that any or all bids may be rejected. All bids must be signed and all bid items must be bid or the bid form may be rejected. I also understand that consideration and awarding a contract will be based upon my past performance and ability to complete the contract based upon equipment and staffing subject to my control.

FEDERAL ID: ____ - ____ - ____ or SOCIAL SECURITY NUMBER: ____ - ____ - ____
Company or individual bidding: _____
Company representative's name: _____
Address: _____
City: _____ State: _____ Zip: _____

IF AVAILABLE, PLEASE PLACE THE PERSONALIZED LABEL FROM YOUR PROSPECTUS IN THE ABOVE BOX.

Individual or company representative's signature: _____ Date: _____

Phone number : _____ Email (optional): _____

**THE WINNING BIDDER MUST COMPLETE THE VERIFICATION OF WORKER'S DISABILITY COMPENSATION ACT
COMPLIANCE (ON REVERSE SIDE IF DOUBLE SIDED) WITHIN 21 DAYS OF SALE AWARD DATE**



TIMBER SALE VERIFICATION OF WORKER'S DISABILITY COMPENSATION ACT COMPLIANCE

As required by Act 317, P.A. 1969 (Worker's Compensation) and
Part 5 of Act 451 of 1994, as amended.

FOR DEPARTMENT USE ONLY

Sale Number (XX - XXX - XX - XX)

Forest Management Unit:

VERIFICATION OF WORKER'S DISABILITY COMPENSATION ACT COMPLIANCE

- This verification must be completed and submitted within 21 days of contract award and prior to the issuance of the timber sale contract.
- In addition, if boxes 2B or 2C are checked, then Notice of Exclusion or Certificate of Insurance must be submitted within twenty-one (21) days of the contract award and prior to the issuance of the timber sale contract.
- All Information must be typed or printed except for written signatures.

Please Check Appropriate Categories:

1. My business is organized as (you **must** check one of the boxes below):
 - A. ☐ Sole Proprietorship (individual)
 - B. ☐ Partnership
 - C. ☐ Corporation
2. You **must** check one of the boxes below:
 - A. ☐ I certify my business is a sole proprietorship and it has no employees but the sole proprietor. I am not subject to the Worker's Compensation Laws.
 - B. ☐ I certify my business has satisfied its obligation to the Worker's Compensation Act through the use of an approved Notice of Exclusion (BWC-337, Rev. 5/96). I will provide a copy of the Notice of Exclusion within 21 days of the contract award. (For questions or a copy of the BWC-337, please call the Worker's Compensation Bureau at 517-322-1195).
 - C. ☐ I certify my business has a Worker's Compensation Policy. I will provide an original Certificate of Insurance within twenty-one (21) days of the contract award.
3. If you have checked item 2(A) or 2(B), you **must** indicate the number of **both** full-time and part-time employees, other than yourself, including family members and active partners (if none, you must enter "0").

_____ Full-time Employees

_____ Part-time Employees

Name of Business		Federal ID (or) Social Security No.
Address		Telephone ()
City	State	ZIP

I hereby certify that the above information is true and correct. I agree to notify the Michigan DNR of any changes that occur in factors affecting my coverage during any of my present and future operations.

Signature of Owner or Authorized Representative

Title

Date

Please complete the "SEALED BID" information on the next page

Runamok Lodge Mix (72-629-24)
T27N, R04W, SEC. 33; Crawford COUNTY

In response to the notice of sale to be held 9:00 a.m. (local time) on April 28, 2025, I am hereby submitting my sealed bid (firm offer) for the following forest products to be cut. Bids for individual species must be at or above the advertised price. All non-responsive bid forms may be rejected.

<u>PRODUCTS & SPECIES</u>	<u>ESTIMATED VOLUME*</u>	<u>ADVERTISED PRICE</u>	<u>BID PRICE/UNIT</u>
Sawtimber			
Red Maple	14.6 MBF	\$ 85.00/MBF	\$ _____
Pulpwood			
Black Cherry	20 Cords	\$ 33.00/Cord	\$ _____
Jack Pine	70 Cords	\$ 23.30/Cord	\$ _____
Mixed Oak	41 Cords	\$ 25.35/Cord	\$ _____
Quaking Aspen	206 Cords	\$ 24.75/Cord	\$ _____
Red Maple	276 Cords	\$ 33.00/Cord	\$ _____

*The volumes are statistically estimated within plus (+) or minus (-) 28.74 percent at 95% confidence level. These estimated volumes are final and not subject to adjustment. Prospective bidders are urged to examine this timber and to make their own estimates of quantity and quality.

I understand that any or all bids may be rejected. All bids must be signed and all bid items must be bid or the bid form may be rejected. I also understand that consideration and awarding a contract will be based upon my past performance and ability to complete the contract based upon equipment and staffing subject to my control.

FEDERAL ID: ____ - ____ - ____ or SOCIAL SECURITY NUMBER: ____ - ____ - ____
Company or individual bidding: _____
Company representative's name: _____
Address: _____
City: _____ State: _____ Zip: _____

IF AVAILABLE, PLEASE PLACE THE PERSONALIZED LABEL FROM YOUR PROSPECTUS IN THE ABOVE BOX.

Individual or company representative's signature: _____ Date: _____

Phone number : _____ Email (optional): _____

**THE WINNING BIDDER MUST COMPLETE THE VERIFICATION OF WORKER'S DISABILITY COMPENSATION ACT
COMPLIANCE (ON REVERSE SIDE IF DOUBLE SIDED) WITHIN 21 DAYS OF SALE AWARD DATE**



TIMBER SALE VERIFICATION OF WORKER'S DISABILITY COMPENSATION ACT COMPLIANCE

As required by Act 317, P.A. 1969 (Worker's Compensation) and
Part 5 of Act 451 of 1994, as amended.

FOR DEPARTMENT USE ONLY

Sale Number (XX - XXX - XX - XX)

Forest Management Unit:

VERIFICATION OF WORKER'S DISABILITY COMPENSATION ACT COMPLIANCE

- This verification must be completed and submitted within 21 days of contract award and prior to the issuance of the timber sale contract.
- In addition, if boxes 2B or 2C are checked, then Notice of Exclusion or Certificate of Insurance must be submitted within twenty-one (21) days of the contract award and prior to the issuance of the timber sale contract.
- All Information must be typed or printed except for written signatures.

Please Check Appropriate Categories:

1. My business is organized as (you **must** check one of the boxes below):
 - A. ☐ Sole Proprietorship (individual)
 - B. ☐ Partnership
 - C. ☐ Corporation
2. You **must** check one of the boxes below:
 - A. ☐ I certify my business is a sole proprietorship and it has no employees but the sole proprietor. I am not subject to the Worker's Compensation Laws.
 - B. ☐ I certify my business has satisfied its obligation to the Worker's Compensation Act through the use of an approved Notice of Exclusion (BWC-337, Rev. 5/96). I will provide a copy of the Notice of Exclusion within 21 days of the contract award. (For questions or a copy of the BWC-337, please call the Worker's Compensation Bureau at 517-322-1195).
 - C. ☐ I certify my business has a Worker's Compensation Policy. I will provide an original Certificate of Insurance within twenty-one (21) days of the contract award.
3. If you have checked item 2(A) or 2(B), you **must** indicate the number of **both** full-time and part-time employees, other than yourself, including family members and active partners (if none, you must enter "0").

_____ Full-time Employees

_____ Part-time Employees

Name of Business		Federal ID (or) Social Security No.
Address		Telephone ()
City	State	ZIP

I hereby certify that the above information is true and correct. I agree to notify the Michigan DNR of any changes that occur in factors affecting my coverage during any of my present and future operations.

Signature of Owner or Authorized Representative

Title

Date

Please complete the "SEALED BID" information on the next page

Class Eh Mix (72-010-24)

T28N, R01E, SEC. 27; T28N, R01E, SEC. 33; T28N, R01E, SEC. 34; Oscoda

In response to the notice of sale to be held 9:00 a.m. (local time) on April 28, 2025, I am hereby submitting my sealed bid (firm offer) for the following forest products to be cut. Bids for individual species must be at or above the advertised price. All non-responsive bid forms may be rejected.

<u>PRODUCTS & SPECIES</u>	<u>ESTIMATED VOLUME*</u>	<u>ADVERTISED PRICE</u>	<u>BID PRICE/UNIT</u>
Sawtimber			
Balsam Fir	10.0 MBF	\$ 62.00/MBF	\$ _____
Northern Pin Oak	22.6 MBF	\$ 100.00/MBF	\$ _____
White Pine	9.0 MBF	\$ 53.00/MBF	\$ _____
Pulpwood			
Balsam Fir	62 Cords	\$ 18.80/Cord	\$ _____
Jack Pine	1,141 Cords	\$ 20.20/Cord	\$ _____
Mixed Hardwood	35 Cords	\$ 28.60/Cord	\$ _____
Northern Pin Oak	143 Cords	\$ 21.95/Cord	\$ _____
Quaking Aspen	379 Cords	\$ 21.45/Cord	\$ _____
Red Pine	632 Cords	\$ 38.60/Cord	\$ _____
White Pine	33 Cords	\$ 18.30/Cord	\$ _____

*The volumes are statistically estimated within plus (+) or minus (-) 13.44 percent at 95% confidence level. These estimated volumes are final and not subject to adjustment. Prospective bidders are urged to examine this timber and to make their own estimates of quantity and quality.

I understand that any or all bids may be rejected. All bids must be signed and all bid items must be bid or the bid form may be rejected. I also understand that consideration and awarding a contract will be based upon my past performance and ability to complete the contract based upon equipment and staffing subject to my control.

FEDERAL ID: ____ - ____ - ____ or SOCIAL SECURITY NUMBER: ____ - ____ - ____

Company or individual bidding: _____

Company representative's name: _____

Address: _____

City: _____ State: _____ Zip: _____

IF AVAILABLE, PLEASE PLACE THE PERSONALIZED LABEL FROM YOUR PROSPECTUS IN THE ABOVE BOX.

Individual or company representative's signature: _____ Date: _____

Phone number : _____ Email (optional): _____

THE WINNING BIDDER MUST COMPLETE THE VERIFICATION OF WORKER'S DISABILITY COMPENSATION ACT COMPLIANCE (ON REVERSE SIDE IF DOUBLE SIDED) WITHIN 21 DAYS OF SALE AWARD DATE



TIMBER SALE VERIFICATION OF WORKER'S DISABILITY COMPENSATION ACT COMPLIANCE

As required by Act 317, P.A. 1969 (Worker's Compensation) and
Part 5 of Act 451 of 1994, as amended.

FOR DEPARTMENT USE ONLY

Sale Number (XX - XXX - XX - XX)

Forest Management Unit:

VERIFICATION OF WORKER'S DISABILITY COMPENSATION ACT COMPLIANCE

- This verification must be completed and submitted within 21 days of contract award and prior to the issuance of the timber sale contract.
- In addition, if boxes 2B or 2C are checked, then Notice of Exclusion or Certificate of Insurance must be submitted within twenty-one (21) days of the contract award and prior to the issuance of the timber sale contract.
- All Information must be typed or printed except for written signatures.

Please Check Appropriate Categories:

1. My business is organized as (you **must** check one of the boxes below):
 - A. ☐ Sole Proprietorship (individual)
 - B. ☐ Partnership
 - C. ☐ Corporation
2. You **must** check one of the boxes below:
 - A. ☐ I certify my business is a sole proprietorship and it has no employees but the sole proprietor. I am not subject to the Worker's Compensation Laws.
 - B. ☐ I certify my business has satisfied its obligation to the Worker's Compensation Act through the use of an approved Notice of Exclusion (BWC-337, Rev. 5/96). I will provide a copy of the Notice of Exclusion within 21 days of the contract award. (For questions or a copy of the BWC-337, please call the Worker's Compensation Bureau at 517-322-1195).
 - C. ☐ I certify my business has a Worker's Compensation Policy. I will provide an original Certificate of Insurance within twenty-one (21) days of the contract award.
3. If you have checked item 2(A) or 2(B), you **must** indicate the number of **both** full-time and part-time employees, other than yourself, including family members and active partners (if none, you must enter "0").

_____ Full-time Employees

_____ Part-time Employees

Name of Business		Federal ID (or) Social Security No.
Address		Telephone ()
City	State	ZIP

I hereby certify that the above information is true and correct. I agree to notify the Michigan DNR of any changes that occur in factors affecting my coverage during any of my present and future operations.

Signature of Owner or Authorized Representative

Title

Date

Please complete the "SEALED BID" information on the next page