



**DEPARTMENT OF NATURAL RESOURCES
STATE OF MICHIGAN
TIMBER SALE PROSPECTUS #7692**

SCHEDULED SALE DATE AND TIME: 9:00 a.m. (local time) on September 15, 2025.

LOCATION: GRAYLING MGMT UNIT, 1955 HARTWICK PINES ROAD, GRAYLING, MI 49738.

PROSPECTUS NOTE: The sales on this Prospectus have received damage from the Ice Storm in late March 2025. The Purchaser should harvest the wood as soon as possible.

The bidder is advised to inspect the sale area and review the location, estimated volumes, operating costs and contract terms of proposed sales. Please be aware that some landowners may request 60 days or more notice for access across their land.

Notice is hereby given that bids will be received by the Unit Manager, GRAYLING MANAGEMENT UNIT, for certain timber on the following described lands:

Ice- Leonardo DeSaprio (72-014-25) / T28N, R02E, SEC. 4 , SWNW,SW.

T28N, R02E, SEC. 5 , S1/2NW,SWNE,SW,SE.

T28N, R02E, SEC. 6 , SE.

T28N, R02E, SEC. 7 , NENW,NE.

T28N, R02E, SEC. 8 , N1/2NW,N1/2NE.

T28N, R02E, SEC. 9 , NWNW.

Oscoda County, Advertised Price \$64,347.20, 645.6 Acres, Jack Pine, Aspen.

SALE NOTE: This is an ice storm jack pine salvage sale.

Note that this is a two-year contract. This should be cut as soon as possible. No extensions for this sale will be granted.

A recreation site such as a trail, pathway, or campground is within the sale area or the vicinity. Certain restrictions/specifications may be applicable including time restrictions.

Ice-Pineway Robbery (72-016-25) / T28N, R04E, SEC. 1 , S1/2SE.

T28N, R04E, SEC. 12, E1/2NW,NE,NESW,N1/2SE.

Oscoda County, Advertised Price \$18,085.05, 166.0 Acres, Jack Pine, Red Pine.

SALE NOTE: This is an ice storm jack pine salvage sale. Note that this is a 1-year contract. This sale should be harvested as soon as possible. No extensions for this sale will be granted.

Producer should use georeferenced map as guide as there are no visual markers of some sale boundaries other than timber type changes or roads.

Note that Misc. Species 3 is jack pine that was snapped off.

Ice Walsh Pickerel JP (72-019-25) / T28N, R01E, SEC. 19, SESW.

T28N, R01E, SEC. 30, NW,SWNE,N1/2SW.

T28N, R01W, SEC. 12, S1/2NE,NESW,NWSE.

T28N, R01W, SEC. 26, SENW,SWNE,NESW.

Crawford County, Advertised Price \$15,077.85, 117.7 Acres, Jack Pine, Hardwood.

SALE NOTE: This salvage sale encompasses jack pine that was damaged by the spring 2025 ice storm. The sale is short duration with no extensions.

A free one-year extension will be granted that can be applied to a different qualifying sale (see Spec 7.2.3).

A recreation site such as a trail, pathway, or campground is within the sale area or the vicinity. Certain restrictions/specifications may be applicable including time restrictions.

Ice North Camp Barrens (72-617-25) / T27N, R02W, SEC. 15, NW,NESW,N1/2SE.

T27N, R02W, SEC. 16, NE,NESW,W1/2SE.

T27N, R02W, SEC. 21, N1/2NE.

T27N, R02W, SEC. 8 , NW.

Crawford County, Advertised Price \$18,820.60, 239.5 Acres, Jack Pine, Hardwood.

SALE NOTE: This salvage sale encompasses jack pine that was damaged by the spring 2025 ice storm. The sale is short duration with no extensions.

This sale is upon lands utilized for training by the Michigan National Guard - Camp Grayling. See Sale Spec 5.1.5 for details.

Operations on this contract may not be allowed during National Guard training operations. Typically, the restricted period is from May 1 to October 31. See Sale Spec 5.2.3.7 for restrictions.

Be aware that the Sale Area could contain UXO (unexploded ordinances). See Sale Spec 6.4 for additional details.

BID INSTRUCTIONS (VER. 10/10/2022):

1. Scheduled Bid Location, Date, and Time (2/11)

Bids must be received by the Unit Manager, GRAYLING OFFICE, 1955 HARTWICK PINES ROAD, GRAYLING, MI 49738, no later than 9:00 a.m. (local time) on September 15, 2025. For further information concerning this sale, contact Tom Barnes at 231-384-7732 extension .

2. Bidder's Qualifications (10/22)

If all or part of a timber sale was prepared by a private contractor, the contractor and that contractor's company are not permitted to bid on the timber sale. A person must be 18 years of age or older to purchase timber. Permanent employees of the Department of Natural Resources or members of their immediate household may not bid. Former employees, in the permanent or seasonal class, may not bid until 3 months after the last day of active duty. Bids will not be accepted from individuals or companies appearing on the DNR/FRD No-Bid List. This list contains the names of purchasers who previously failed to execute a contract within 21-days or who have a history of poor performance.

3. Preparation of Sealed Bids (5/16)

Bid Forms may be completed online thru Michigan DNR Timber Sale Online Bidding (OLB) at www.michigan.gov/timberbidding or by completing the hardcopy Bid Form found in the Timber Sale Prospectus . Hardcopy Bid Forms shall be manually signed in ink. Registration in OLB is considered your 'signature' for all bids submitted thru that system. Bid prices must be entered for each species and product in the Bid Price column for all material subject to bidding and all fill-in blanks must be completed. If erasures or other changes appear on the hardcopy Bid Form, each erasure or change must be initialed by the person signing the bid.

4. Submission of Sealed Bids (5/16)

Bid forms may be obtained from the Unit Manager or thru OLB. Bids may be submitted hardcopy or thru OLB. All hardcopy bids must be submitted on the bid form and in an envelope clearly identified as described in this section. NOTE: Only one bid form per bid envelope. Sealed bids must be submitted to the Unit office designated in the prospectus and must be submitted at or prior to the time established in the prospectus. The envelope should show on the outside (a) the sale name or number and (b) the date and time of bid opening, as shown in the prospectus. Bids received after the time specified in the sale prospectus are late bids and will be rejected.

It is possible for a bidder to submit multiple bids on a single sale. For example, a bid may be submitted hardcopy and a bid may be submitted thru OLB. Or, two bidders from the same company could both submit bids on the same sale. If this were to happen, the State would accept all bids received and award the contract accordingly. All bidding and contractual requirements would apply to all bids received.

5. Public Opening of Sealed Bids (7/16)

If conditions permit, the sealed bids will be publicly opened and posted at the time and place set in the prospectus.

If a bidder, present at a bid opening, has submitted bids on more than one sale, that bidder may withdraw their unopened bid envelopes or announce the withdrawal of their online bid after being declared the successful bidder on one sale.

6. Award of Contract (1/11)

Award of the contract will be made to the Bidder whose bid, conforming to the prospectus, is most advantageous to the State of Michigan on the basis of total value at rates bid for the estimated quantities. The State reserves the right to reject any bid or waive any minor irregularity in bids received. A written award mailed (or otherwise furnished) to the successful Bidder shall be deemed to result in a binding contract without further action by either party.

7. Down Payment (1/11)

The Bidder to whom award is made must make a down payment within 21 days of the sale award. The amount of the down payment will be calculated as shown in the Bond and Payment Schedule of this prospectus. Only cash may be used to meet this requirement.

8. Performance Security (1/11)

As guarantee of faithful performance, a cash bond, certificate of deposit, surety bond or irrevocable letter of credit (LOC) is required within 21 days of the sale award. The amount of the performance security is shown in the Bond and

Payment Schedule of this prospectus. If an LOC or surety is used, the coverage must extend for at least 6 months beyond the contract expiration.

9. Worker's Compensation (10/22)

Purchaser shall obtain worker's compensation insurance to cover claims under Michigan's Worker's Disability Compensation Act of 1969 or similar employee benefit act of any other state applicable to an employee. Verification of Worker's Disability Compensation Act Compliance must be completed and submitted within 21 days of contract award and prior to the issuance of the timber sale contract. In addition, if applicable, Notice of Exclusion or Certificate of Insurance must also be submitted.

10. Timber Sale Contract (10/22)

Additional conditions and requirements common to all timber sales are listed on the timber sale contract (R4031) and are available on line at www.michigan.gov/timber. Contact the Unit Manager for additional information or a sample contract. Within 21 days of the date of the award letter, the bidder must sign the contract and provide the required down payment, performance security, and verification of worker's disability compensation. The down payment and performance security shall be in accordance with the provisions of the timber sale contract, in the sums stated in this prospectus. If these actions are not taken, then the Bidder, the Bidder's corporation, and the corporation's principals may not be permitted to bid on State timber sales for a period of 3 months after the first offense, 6 months after the second offense, and 1 year after the third offense. An offense will only be counted against the Bidder for 5 years. In addition, the Bidder certifies that if awarded this contract, the Bidder will complete the timber sale contract in accordance with its terms and any modifications thereof including requirements to purchase, cut, and remove the included timber by the expiration date.

Payment Unit values in the State Forest Timber Sale Contract are calculated based on the advertised value of the Payment Unit as a percentage of the total advertised value of the contract. The advertised value of each Payment Unit is given in the Description of Timber by Payment Unit table on the Timber Sale Information page. For example, if the value of Payment Unit 1 is advertised as \$1,500 and the total Timber Sale value is advertised as \$10,000, the contract price for Payment Unit 1 will be 15% of the total bid price ($\$1,500/\$10,000 * 100$).

11. Disclaimer of Estimates and Bidder's Warranty of Inspection (10/22)

Before submitting this bid, the Bidder is advised and cautioned to inspect the sale area, review the requirements of the sale contract, and take other steps as may be reasonably necessary to ascertain the location, estimated volumes, construction estimates, and operating costs of the proposed sale. Failure to do so will not relieve the Bidder from responsibility for completing the contract.

The Bidder warrants that this bid is submitted solely on the basis of the Bidder's examination and inspection of the quality and quantity of the timber offered for sale and the Bidder's opinion of the value thereof and the costs of recovery. No reliance should be placed on the State of Michigan's estimates of timber quality, quantity or costs of recovery. Bidder further acknowledges that the State of Michigan: (i) expressly disclaims any warranty of fitness of timber for any purpose; (ii) offers this timber as is without any warranty of quality (merchantability) or quantity and (iii) expressly disclaims any warranty as to the quantity or quality of timber sold.

12. Certification and Chain-of-Custody (10/22)

Unless otherwise indicated in the contract under section 7 – Other Conditions of the Sale Specific Conditions & Requirements, the area encompassed by this timber sale is certified to the standards of the Forest Stewardship Council (FSC) - Certificate #SCS-FM/COC-00090N and the Sustainable Forestry Initiative (SFI) - Certificate #NSF-SFIS-5Y031-SF5. Forest products from this sale may be delivered to the mill as "FSC 100% and / or SFI certified" as long as the contractor hauling the forest products is chain-of-custody (COC) certified or covered under a COC certificate from the destination mill. The purchaser is responsible for maintaining COC after leaving the sale area.

13. Good Neighbor Authority (GNA) Requirements (10/22)

If the name of this timber sales contains the acronym GNA, it is authorized by the Good Neighbor Authority (GNA) and covered by various agreements between the U.S. Forest Service and the State. The timber sale occurs on federal land and the following conditions apply:

GNA contracts on US Forest Service land will not be awarded to purchasers on the Federal list of excluded parties. The System for Award Management (SAM) will be checked for active excluded parties prior to award of contract. In

addition, the Bidder to whom award is made must complete an Assurance Regarding Felony Conviction or Tax Delinquent Status for Corporate Applicants (AD-3031).

14. Good Neighbor Authority (GNA) Requirements, con't (10/22)

Bidder certifies, by signing this bid form, that to the best of Bidder's knowledge that the following representations are accurate and complete.

- a. That the Bidder and its principals are not presently debarred, suspended, proposed for debarment, declared ineligible, or voluntary excluded from timber sales (covered transactions) by any Federal department or agency.
- b. That the Bidder and its principals have not within a 3-year period preceding this bid been convicted of or had a civil judgment rendered against them for commission of fraud or a criminal offense in connection with obtaining , attempting to obtain, or performing a public (Federal, State, or local) transaction or contract under a public transaction; violation of Federal or State antitrust statutes or commission of embezzlement, theft, forgery, bribery, falsification or destruction of records, making false statements, or receiving stolen property.
- c. That the Bidder and its principals are not presently indicted for or otherwise criminally or civilly charged by a governmental entity (Federal, State, or local) with commission of any of the offenses enumerated in paragraph b of this certification.
- d. That the Bidder and its principals have not within a 3-year period preceding this bid had one or more public transactions (Federal, State, or local) terminated for breach or default of a timber or forest product contract.

Bidders that cannot certify this requirement, in whole or in part, shall submit an explanation with their bid.

Scott Bowen
Director

TIMBER SALE INFORMATION

Ice- Leonardo DeSaprio (72-014-25)

T28N, R02E, SEC. 4; T28N, R02E, SEC. 5; T28N, R02E, SEC. 6; T28N, R02E, SEC. 7; T28N, R02E, SEC. 8; T28N, R02E, SEC. 9.
Oscoda County (Advertised Price \$64,347.20)

SALE NOTE: This is an ice storm jack pine salvage sale.

Note that this is a two-year contract. This should be cut as soon as possible. No extensions for this sale will be granted.

A recreation site such as a trail, pathway, or campground is within the sale area or the vicinity. Certain restrictions/specifications may be applicable including time restrictions.

A timber sale contract for this scaled, sealed bid timber sale will be awarded to the responsible bidder offering the highest sealed bid price. All units of volume listed below were estimated using the Inventory Manager computer program and the new Michigan taper model. Bids must be at or above the following advertised price for each product and species:

<u>PRODUCTS & SPECIES</u>	<u>ESTIMATED UNITS*</u>	<u>ADVERTISED PRICE</u>
Pulpwood		
Black Cherry	56 Cords	\$ 13.95 / Cord
Black/Red (Hybrid) Oak	13 Cords	\$ 10.05 / Cord
Jack Pine	5,823 Cords	\$ 9.70 / Cord
Northern Pin Oak	111 Cords	\$ 10.05 / Cord
Quaking Aspen	439 Cords	\$ 10.70 / Cord
Red Maple	53 Cords	\$ 13.95 / Cord
Red Pine	21 Cords	\$ 19.05 / Cord

* The total volume is statistically estimated within plus (+) or minus (-) 13.78 percent. There are an estimated 6,515 cords on this timber sale, plus or minus 898 cords at the 95% confidence level. The estimated units are final and not subject to adjustment. Prospective bidders are urged to examine this timber and to make their own estimates of quantity and quality.

BOND AND PAYMENT SCHEDULE:

1. A bond in the amount of \$3,217.00 to insure faithful performance of the conditions of the contract will be deposited by the successful bidder within 21 days of the sale award.
 2. Cutting in any sale or unit without the required advance payment would be considered a trespass.
 3. Total payment must be paid in advance or according to the following schedule :
 - (a) Ten percent (10%) of the sale value must be paid within 21 days of the sale award.
 - (b) The 10% down payment will be credited towards the first unit cut.
 - (c) Payment for each of the following units must be made before cutting begins in that unit:
- | PAYMENT UNIT NUMBER | PERCENT OF TOTAL SALE VALUE |
|---------------------|-----------------------------|
| 01 | 27.5% |
| 02 | 61.0% |
| 03 | 11.5% |
4. If no cutting takes place, the 10% down payment will not be refunded.
 5. Operations on the contract issued will terminate on 12/31/2027.

SALE STATISTICS

Volumes were calculated in cubic feet using the Michigan taper model. Cubic foot volume includes all wood inside bark for the product indicated. For display purposes, cubic feet were converted to cords and MBF using a simple conversion factor, e.g. 79 cubic feet per cord and 185 cubic feet per MBF. The cubic foot volumes are precise; the cords and MBF volumes are not. Cubic foot volume cannot be directly converted to cords or boards with precision.

SALE VOLUMES

The total estimated sale volume may not equal the sum of the species/products due to the nature of statistical calculations associated with double sampling methodology.

VOLUME		STATISTICAL RANGE IN CORDS		
TOTAL CUBIC FEET	TOTAL CORDS	PERCENT ERROR	MINIMUM	MAXIMUM
514,697	6,515	13.78%	5,617	7,413

VDU VOLUMES

A VDU is a Volume Determination Unit. Volumes and their associated statistics are calculated at the VDU level and summarized to the sale level. There is often a one to one relationship between a VDU and a Payment Unit, but not always, depending on the cruise design. Refer to the VDU TO PAYMENT UNIT table.

	VOLUME			RANGE IN CORDS	
VDU	TOTAL CUBIC FEET	TOTAL CORDS	PERCENT ERROR	MINIMUM	MAXIMUM
10	292,018	3,696	18.12%	3,026	4,366
18	23,649	299	57.39%	128	471
21	59,453	753	42.29%	434	1,071
30	139,577	1,767	29.94%	1,238	2,296
TOTAL:	514,697	6,515		4,826	8,204

VDU TO PAYMENT UNIT

When a VDU is associated with more than one Payment Unit (PU), the VDU volumes are assigned to the PU based on acres of the VDU within the PU.

VDU	VDU ACRES	PU	PU ACRES
TOTAL:			

DESCRIPTION OF TIMBER BY PAYMENT UNIT (PU)

PU	MARKET GROUP	PRODUCT	QUANTITY	UNIT	ACRES	ADVERTISE PRICE
1	Black Cherry	Pulpwood	26	Cords	183.4	\$17,680.30
	Black/Red (Hybrid		13	Cords		
	Jack Pine		1,478	Cords		
	Quaking Aspen		229	Cords		
	Red Pine		21	Cords		
2	Black Cherry	Pulpwood	17	Cords	391.1	\$39,252.85
	Jack Pine		3,649	Cords		
	Northern Pin Oak		111	Cords		
	Quaking Aspen		165	Cords		
	Red Maple		53	Cords		
3	Black Cherry	Pulpwood	13	Cords	71.1	\$7,414.05
	Jack Pine		696	Cords		
	Quaking Aspen		45	Cords		
TOTAL:			6,516	Cords		

Sale Specific Conditions & Requirements

Sale Name: Ice- Leonardo DeSaprio

Sale Number: 72-014-25 Seq#: 2

1 - Sale Area

1.2 - Boundaries

1.2.1 - Painted Boundaries (9/19)

The sale boundary and Payment Unit boundaries are marked and identified by blue and red paint or are unmarked and identified by existing roads or changes in cover type as shown on the Timber Sale Map. Exterior sale boundary lines against private property are marked with blue paint. Exterior sale boundary lines against state are marked with red paint, except along existing roads or changes in cover type as shown on the Timber Sale Map. The painted boundary line trees are not Included Timber and are to be protected.

2 - Timber Specifications

2.1 - Included Timber

2.1.1 - Clearcut Unit(s) with Unmerchantable Trees (6/14)

Within Payment Unit(s) 1, 2 and 3, cut all trees that are two (2) inches or more at DBH except do not cut red pine or white oak.

2.2 - Utilization

2.2.3 - Stump Heights (12/24)

Stump heights within the Sale Area shall not exceed six (6) inches for all trees. This is in order to facilitate planting operations.

3 - Payments

3.4 - Damaged Timber

3.4.1 - Damaged Timber (12/24)

General Condition and Requirement 3.4 Damaged Timber, defines liquidated damages for undesignated live merchantable trees which are cut or injured.

No damage is acceptable to undesignated live merchantable trees. Within the Sale Area, if more than 10% of trees (> 4.5" DBH) within a specified area of the sale are damaged, liquidated damages will be assessed for all trees damaged. Rates will be in accordance with General Condition and Requirement 3.4 Damaged Timber.

4 - Transportation

4.1 - Construction

4.1.3 - Slash and Earthen Piles (8/04)

Piles or windrows of earth along roads and landings that have been widened or constructed shall be leveled. Slash from road maintenance or construction, including stumps, shall be chipped, utilized or otherwise removed from the sale.

4.1.6 - Road Construction (4/24)

Construction of new roads or improvements of existing roads shall be done in such a way as to minimize the environmental and visual impacts. Merchantable trees shall be cut and utilized unless otherwise directed. Non-merchantable trees shall be severed and laid flat on the ground. Slash shall be chipped, utilized or otherwise removed from the sale. Stumps shall be set upright, not left on edge, and be moved at least 10 feet away from the road edge. Disturbed soil shall be feathered into the woods and not left in berms or windrows.

4.1.7 - Road Closure (10/11)

All new roads built into the sale must be blocked to vehicle traffic upon completion of the sale. Overgrown roads that are reopened shall be considered new roads. In general, this will require constructing a four (4') foot high berm of stumps and logs covered with earth. Stumps and brush must be placed along the remainder of the trail. These roads must be rendered impassable to cars and trucks. All stumps from road building and landing construction must be reserved to block any newly

constructed roads upon completion of the sale. These stumps must be scattered along the road system to prohibit vehicular movement. Contact the Sale Administrator for specific details of design and placement.

4.1.11 - Permits (2/12)

The Purchaser will secure any necessary permits that may be required.

5 - Operations

5.1 - Notification

5.1.3 - Well Heads and Natural Gas Pipelines (11/15)

The Purchaser is responsible for contacting the gas or pipeline company prior to operating equipment in the vicinity of well heads or natural gas pipelines. Written permission is required before harvest operations begin and must be submitted to the Unit Manager.

5.2 - Conduct of Operations

5.2.1 - Slash

5.2.1.11 - Slash for Reforestation (3/21)

Within the Sale Area, chipping is encouraged as it is the most effective and efficient way to mitigate slash for reforestation. Other tactics to mitigate slash for site preparation would need to be approved by the Unit Manager or his/her representative. Liquidated damages may be assessed at \$250 per acre if it is determined that slash mitigation was inadequate and mastication is needed for the DNR to conduct site preparation for planting.

5.2.32 - Decking/Landing Restoration (9/13)

All decking and landing areas must have the surface area restored to a condition equal to or better than before. This is to ensure the proper regeneration of the stand. Wood debris, chips and "cookies" from trimmings must be chipped, utilized, or removed from Sale Area.

5.2.33 - Gas Well Revegetation (12/08)

In the event that the gas well is utilized for a landing, the site must be revegetated with a seeding mixture specified by the Unit Manager or his/her representative.

5.2.39 - ORV Trail/Route Protection (4/18)

Hunt Creek Motorcycle Trail is an ORV trail or route and is shown on the Timber Sale Map. Do not cut trees or damage posts with yellow ORV markers. All stumps within five (5) feet of the trail must be cut flush with the ground. Maintain a 20-foot-wide slash, debris, and rut free zone daily using the ORV trail or route as the centerline. Do not run equipment down the ORV trail or route. Skidding across the trail or route may only occur in locations approved by the Sale Administrator.

5.8 - Protection of Endangered Species

5.8.5 - Protection of Raptor Nests (3/13)

All trees with raptor nests will be protected if found during harvesting operations. Notification will be made to the Unit Manager or his/her representative who will notify the Wildlife Biologist so an onsite evaluation and recommendation can be made, if necessary.

6 - Safety and Fire Prevention

6.2 - Signing

6.2.1 - Road Posting (10/20)

The Purchaser is responsible for posting and maintaining caution signs on Eastwood Road prior to beginning operations. The road must be posted at appropriate distances from the Sale Area to warn of logging activity and truck traffic. Signs must be removed when harvest operations are suspended or completed. The Purchaser will provide these signs.

6.2.3 - Recreational Trail Posting (10/20)

The Purchaser is responsible for posting and maintaining caution signs on Hunt Creek Motorcycles Trail prior to beginning operations. The trail must be posted at appropriate distances from the Sale Area to warn of logging activity and truck traffic at both ends of the trail. Signs must be removed when harvest operations are

suspended or completed. The Purchaser will provide these signs.

7 - Other Conditions

7.2 - Extensions

7.2.2 - No Extensions (3/09)

This is an ice storm jack pine salvage harvest. There will be no extensions granted on this contract.

7.5 - Loss

7.5.1 - Deteriorating Timber (7/09)

The Sale Area has received damage from an ice storm that occurred in late March 2025. The Purchaser should harvest the wood as soon as possible. The Department of Natural Resources is held free of responsibility of any further damage or deterioration due to delay in harvesting.

**TIMBER SALE MAP**

This information provided by authority of Part 525, 1994 PA 451, as amended.

Sale Number

72-014-25

Date

05/29/2025

Forest Management Unit

Grayling Mgt Unit

County

Oscoda

Mapped By: Whitsett

Cruised By: Whitsett & Michaud

Scale

1:24,000

Page

1

Of

1Township
28NRange
02ESection(s) and Subdivision(s) N1/2NW,N1/2NE; Sec. 9 NWNW;
Sec. 4 SWNW,SW; Sec. 5 S1/2NW,SWNE,SW,SE; Sec. 6 SE; Sec. 7 NENW,NE; Sec. 8**Cover Type**

A = Aspen	J = Jack Pine	O = Oak	U = Upland Brush
B = Paper Birch	K = Rock	P = Lowland Poplar	UM = Upland Mix Forest
C = Cedar	L = Lowland Brush	Q = Mixed Swamp Conifer	V = Bog or Marsh
D = Treed Bog	LM = Lowland Mix Forest	R = Red Pine	W = White Pine
E = Swamp Hardwoods	M = Maple, Beech, Birch	S = Black Spruce	X = Non Stocked
F = Spruce/Fir	MC = Mixed Conifer	T = Tamarack	Y = Sand
G = Grass	MD = Mixed Deciduous	Z = Water	
H = Hemlock	N = Marsh		

Density

0 = Non Stocked	5 = Pole Timber Medium
1 = Seedling Sapling Poor	6 = Pole Timber Well
2 = Seedling Sapling Medium	7 = Saw Timber Poor
3 = Seedling Sapling Well	8 = Saw Timber Medium
4 = Pole Timber Poor	9 = Saw Timber Well

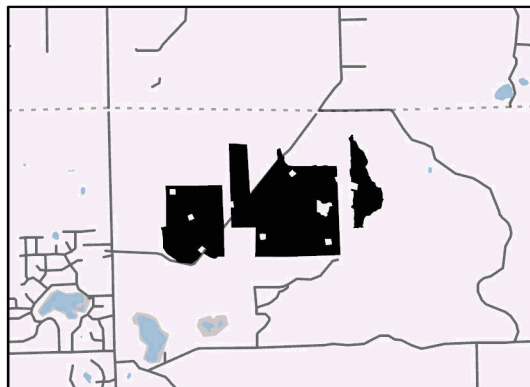
Locator Map 1:100,000**Payment Unit Acres**

1	183.4
2	391.1
3	71.1

**Ice-
Leonardo
DeSaprio****645.6 Acres**

0 0.25 0.5 1 Miles

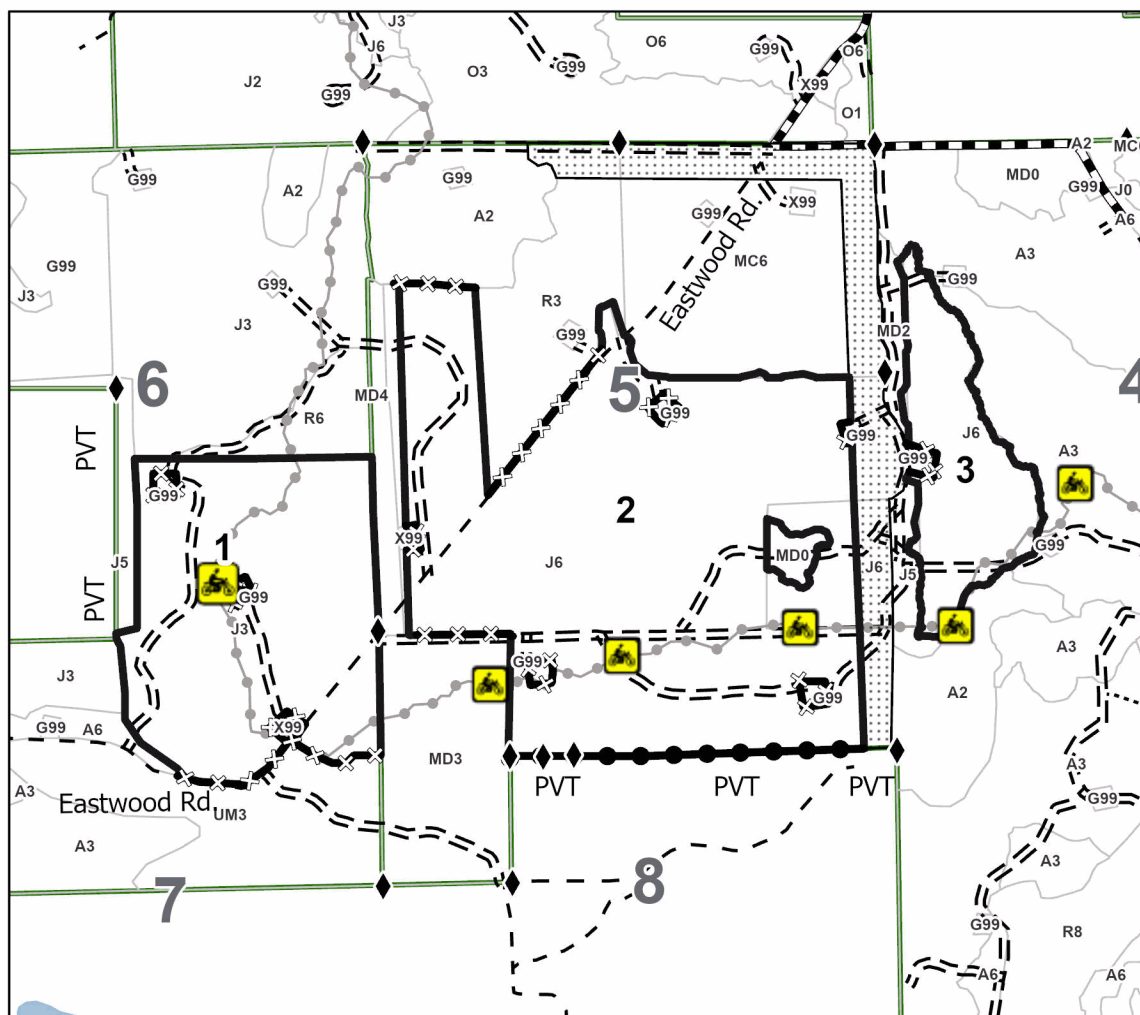
**Legend**

- Against State (Red)
- Against State (Unpainted)
- Against State (Cover Type Change)
- Private Line (Blue)
- Forest Access Route
- Administrative Access Only
- Government Gravel/Dirt
- Private Gravel/Dirt
- Recreational Trails
- Survey Corners

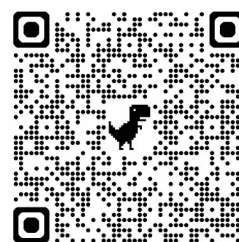
Use QR Code to
open Map in App

TIMBER SALE INFORMATION

Ice-Pineway Robbery (72-016-25)
T28N, R04E, SEC. 1; T28N, R04E, SEC. 12.
Oscoda County (Advertised Price \$18,085.05)

SALE NOTE: This is an ice storm jack pine salvage sale. Note that this is a 1-year contract. This sale should be harvested as soon as possible. No extensions for this sale will be granted.

Producer should use georeferenced map as guide as there are no visual markers of some sale boundaries other than timber type changes or roads.

Note that Misc. Species 3 is jack pine that was snapped off.

A timber sale contract for this lump sum, sealed bid timber sale will be awarded to the responsible bidder offering the highest sealed bid price. All units of volume listed below were estimated using the Inventory Manager computer program and the new Michigan taper model. Bids must be at or above the following advertised price for each product and species:

<u>PRODUCTS & SPECIES</u>	<u>ESTIMATED UNITS*</u>	<u>ADVERTISED PRICE</u>
Pulpwood		
Black Cherry	10 Cords	\$ 13.95 / Cord
Black/Red (Hybrid) Oak	17 Cords	\$ 10.05 / Cord
Jack Pine	1,019 Cords	\$ 9.70 / Cord
Misc. Species 3	709 Cords	\$ 9.70 / Cord
Mixed Aspen	12 Cords	\$ 10.70 / Cord
Red Pine	44 Cords	\$ 19.05 / Cord
White Pine	6 Cords	\$ 7.75 / Cord

* The total volume is statistically estimated within plus (+) or minus (-) 19.58 percent. There are an estimated 1,821 cords on this timber sale, plus or minus 357 cords at the 95% confidence level. The estimated units are final and not subject to adjustment. Prospective bidders are urged to examine this timber and to make their own estimates of quantity and quality.

BOND AND PAYMENT SCHEDULE:

- A bond in the amount of \$904.00 to insure faithful performance of the conditions of the contract will be deposited by the successful bidder within 21 days of the sale award.
- Cutting in any sale or unit without the required advance payment would be considered a trespass.
- Total payment must be paid in advance or according to the following schedule :
 - Ten percent (10%) of the sale value must be paid within 21 days of the sale award.
 - The 10% down payment will be credited towards the first unit cut.
 - Payment for each of the following units must be made before cutting begins in that unit:

PAYMENT UNIT NUMBER	PERCENT OF TOTAL SALE VALUE
01	88.4%
02	11.6%
- If no cutting takes place, the 10% down payment will not be refunded.
- Operations on the contract issued will terminate on 09/30/2026.

SALE STATISTICS

Volumes were calculated in cubic feet using the Michigan taper model. Cubic foot volume includes all wood inside bark for the product indicated. For display purposes, cubic feet were converted to cords and MBF using a simple conversion factor, e.g. 79 cubic feet per cord and 185 cubic feet per MBF. The cubic foot volumes are precise; the cords and MBF volumes are not. Cubic foot volume cannot be directly converted to cords or boards with precision.

SALE VOLUMES

The total estimated sale volume may not equal the sum of the species/products due to the nature of statistical calculations associated with double sampling methodology.

VOLUME		STATISTICAL RANGE IN CORDS		
TOTAL CUBIC FEET	TOTAL CORDS	PERCENT ERROR	MINIMUM	MAXIMUM
143,855	1,821	19.58%	1,464	2,178

VDU VOLUMES

A VDU is a Volume Determination Unit. Volumes and their associated statistics are calculated at the VDU level and summarized to the sale level. There is often a one to one relationship between a VDU and a Payment Unit, but not always, depending on the cruise design. Refer to the VDU TO PAYMENT UNIT table.

VDU	VOLUME		PERCENT ERROR	RANGE IN CORDS	
	TOTAL CUBIC FEET	TOTAL CORDS		MINIMUM	MAXIMUM
2	126,956	1,607	21.73%	1,258	1,956
23	16,898	214	38.46%	132	296
TOTAL:	143,855	1,821		1,390	2,252

VDU TO PAYMENT UNIT

When a VDU is associated with more than one Payment Unit (PU), the VDU volumes are assigned to the PU based on acres of the VDU within the PU.

VDU	VDU ACRES	PU	PU ACRES
TOTAL:			

DESCRIPTION OF TIMBER BY PAYMENT UNIT (PU)

PU	MARKET GROUP	PRODUCT	QUANTITY	UNIT	ACRES	ADVERTISE PRICE
1	Black Cherry	Pulpwood	6	Cords	139.5	\$15,995.95
	<i>Pin Cherry</i>		6	<i>Cords</i>		
	Black/Red (Hybrid		17	Cords		
	/Red (Hybrid) Oak	<i>Sawtimber</i>	3.3	<i>MBF</i>		
	/Red (Hybrid) Oak	<i>Pulpwood</i>	10	<i>Cords</i>		
	Jack Pine		874	Cords		
	Misc. Species 3		651	Cords		
	<i>Misc. Species 2</i>		9	<i>Cords</i>		
	<i>Misc. Species 3</i>		642	<i>Cords</i>		
	Mixed Aspen		6	Cords		
	<i>Quaking Aspen</i>		6	<i>Cords</i>		
	Red Pine		44	Cords		
	<i>Red Pine</i>	<i>Sawtimber</i>	5.6	<i>MBF</i>		
	<i>Red Pine</i>	<i>Pulpwood</i>	33	<i>Cords</i>		
	White Pine		6	Cords		
2	Black Cherry	Pulpwood	4	Cords	26.5	\$2,089.10
	<i>Black Cherry</i>	<i>Sawtimber</i>	0.6	<i>MBF</i>		
	<i>Black Cherry</i>	<i>Pulpwood</i>	3	<i>Cords</i>		
	Jack Pine		145	Cords		
	Misc. Species 3		58	Cords		
	<i>Misc. Species 3</i>		58	<i>Cords</i>		
	Mixed Aspen		6	Cords		
	<i>B. T. Aspen</i>		6	<i>Cords</i>		
TOTAL:			1,817	Cords		

Sale Specific Conditions & Requirements

Sale Name: Ice-Pineway Robbery

Sale Number: 72-016-25 Seq#: 1

1 - Sale Area

1.2 - Boundaries

1.2.1 - Painted Boundaries (9/19)

The sale boundary and Payment Unit boundaries are marked and identified by blue, red and yellow paint. Exterior sale boundary lines against private property are marked with blue paint except in areas indicated on the sale map. Unmarked private boundaries include part of the private line to the north which follows the gas line ROW. Exterior sale boundary lines against state are marked with red paint. Except for locations specified in the timber sale map. Interior Payment Unit boundaries are marked with yellow paint except the south line between payment units 1 and 2 which is unpainted and identified by the gas well access road. See timber sale map for specific locations. The painted boundary line trees are not Included Timber and are to be protected. Yellow painted trees designating an interior Payment Unit boundary are only to be cut when all surrounding Payment Units have been paid.

2 - Timber Specifications

2.1 - Included Timber

2.1.1 - Clearcut Unit(s) with Unmerchantable Trees (6/14)

Within Payment Unit(s) 1 & 2, cut all trees that are two (2) inches or more at DBH except for white oak.

2.2 - Utilization

2.2.3 - Stump Heights (12/24)

Stump heights within the Sale Area shall not exceed six (6) inches for all trees. This is in order to facilitate planting operations.

3 - Payments

3.4 - Damaged Timber

3.4.1 - Damaged Timber (12/24)

General Condition and Requirement 3.4 Damaged Timber, defines liquidated damages for undesignated live merchantable trees which are cut or injured.

No damage is acceptable to undesignated live merchantable trees. Within the Sale Area, if more than 5% of trees (> 4.5" DBH) within a specified area of the sale are damaged, liquidated damages will be assessed for all trees damaged.

4 - Transportation

4.1 - Construction

4.1.3 - Slash and Earthen Piles (8/04)

Piles or windrows of earth along roads and landings that have been widened or constructed shall be leveled. Slash from road maintenance or construction, including stumps, shall be chipped, utilized or otherwise removed from the sale.

4.1.6 - Road Construction (4/24)

Construction of new roads or improvements of existing roads shall be done in such a way as to minimize the environmental and visual impacts. Merchantable trees shall be cut and utilized unless otherwise directed. Non-merchantable trees shall be severed and laid flat on the ground. Slash shall be chipped, utilized or otherwise removed from the sale. Stumps shall be set upright, not left on edge, and be moved at least 10 feet away from the road edge. Disturbed soil shall be feathered into the woods and not left in berms or windrows.

4.1.7 - Road Closure (10/11)

All new roads built into the sale must be blocked to vehicle traffic upon completion of the sale. Overgrown roads that are reopened shall be considered new roads. In general, this will require constructing a four (4') foot high berm of stumps and logs covered with earth. Stumps and brush must be placed along the remainder of the trail. These roads must be rendered

impassable to cars and trucks. All stumps from road building and landing construction must be reserved to block any newly constructed roads upon completion of the sale. These stumps must be scattered along the road system to prohibit vehicular movement. Contact the Sale Administrator for specific details of design and placement.

4.1.11 - Permits (2/12)

The Purchaser will secure any necessary permits that may be required.

5 - Operations

5.1 - Notification

5.1.3 - Well Heads and Natural Gas Pipelines (11/15)

The Purchaser is responsible for contacting the gas or pipeline company 30 days prior to operating equipment in the vicinity of well heads or natural gas pipelines. Contact Moe Larry Curley with Riverside Energy Michigan LLC at (989) 705-7665.

Written permission is required before harvest operations begin and must be submitted to the Unit Manager.

5.2 - Conduct of Operations

5.2.1 - Slash

5.2.1.11 - Slash for Reforestation (3/21)

Within the Sale Area, chipping is encouraged as it is the most effective and efficient way to mitigate slash for reforestation. Other tactics to mitigate slash for site preparation would need to be approved by the Unit Manager or his/her representative. Liquidated damages may be assessed at \$250 per acre if it is determined that slash mitigation was inadequate and mastication is needed for the DNR to conduct site preparation for planting.

5.2.32 - Decking/Landing Restoration (9/13)

All decking and landing areas must have the surface area restored to a condition equal to or better than before. This is to ensure the proper regeneration of the stand. Wood debris, chips and "cookies" from trimmings must be chipped, utilized, or removed from the sale area.

5.2.33 - Gas Well Revegetation (12/08)

In the event that the gas well is utilized for a landing, the site must be revegetated with a seeding mixture specified by the Unit Manager or his/her representative.

5.8 - Protection of Endangered Species

5.8.5 - Protection of Raptor Nests (3/13)

All trees with raptor nests will be protected if found during harvesting operations. Notification will be made to the Unit Manager or his/her representative who will notify the Wildlife Biologist so an onsite evaluation and recommendation can be made, if necessary.

6 - Safety and Fire Prevention

6.2 - Signing

6.2.1 - Road Posting (10/20)

The Purchaser is responsible for posting and maintaining caution signs on Flynn Valley Rd. prior to beginning operations. The road must be posted at appropriate distances from the Sale Area to warn of logging activity and truck traffic. Signs must be removed when harvest operations are suspended or completed. The Purchaser will provide these signs.

7 - Other Conditions

7.2 - Extensions

7.2.2 - No Extensions (3/09)

This is an ice storm salvage harvest. There will be no extensions granted on this contract.

7.2.3 - Salvage Extension (6/13)

This is a salvage sale with a short contract length. The sale must be harvested promptly. One (1), twelve (12) month extension can be applied to one (1) other State Forest Timber Sale Contract owned by the purchaser or owned by one (1) designated sub-contractor of the Purchaser that works this contract. To qualify, the contract expiration date of the contract to

be extended must be within twelve (12) months from the issue date of this contract. If this is the first extension on the other State Forest Timber Sale Contract, then the 5% extension fee will be waived. If this is an additional extension, the 10% fee will be reduced to 5%. The salvage extension must be used before this contract is closed-out. This specification does not alleviate the purchaser from any contractual obligations of the extended State Forest Timber Sale Contract. Per General Condition & Requirement 7.2, extensions are at the sole discretion of the DNR.

7.5 - Loss

7.5.1 - Deteriorating Timber (7/09)

The Sale Area has received damage from the 2025 ice storm. The Purchaser should harvest the wood as soon as possible. The Department of Natural Resources is held free of responsibility of any further damage or deterioration due to delay in harvesting.



TIMBER SALE MAP

This information provided by authority of Part 525, 1994 PA 451, as amended.

Sale Number

72-016-25

Date

08/05/2025

Forest Management Unit

Grayling Mgt Unit

County

Oscoda

Mapped By: Collin Whitsett

Cruised By: Whitsett & Michaud

Scale

1:15,840

Page

1

Of

1

Township
28N

Range
04E

Section(s) and

Subdivision(s) Sec. 1 S1/2SE; Sec. 12 E1/2NW,NE,NESW,N1/2SE;

Cover Type

A = Aspen	J = Jack Pine	O = Oak	U = Upland Brush
B = Paper Birch	K = Rock	P = Lowland Poplar	UM = Upland Mix Forest
C = Cedar	L = Lowland Brush	Q = Mixed Swamp Conifer	V = Bog or Marsh
D = Treed Bog	LM = Lowland Mix Forest	R = Red Pine	W = White Pine
E = Swamp Hardwoods	M = Maple, Beech, Birch	S = Black Spruce	X = Non Stocked
F = Spruce/Fir	MC = Mixed Conifer	T = Tamarack	Y = Sand
G = Grass	MD = Mixed Deciduous	Z = Water	
H = Hemlock	N = Marsh		

Density

0 = Non Stocked	5 = Pole Timber Medium
1 = Seedling Sapling Poor	6 = Pole Timber Well
2 = Seedling Sapling Medium	7 = Saw Timber Poor
3 = Seedling Sapling Well	8 = Saw Timber Medium
4 = Pole Timber Poor	9 = Saw Timber Well

Payment Unit Number	Acres
1	139.5
2	26.5

Ice-Pineway Robbery

Compartment 28

166.0 Acres

Locator Map 1:100,000

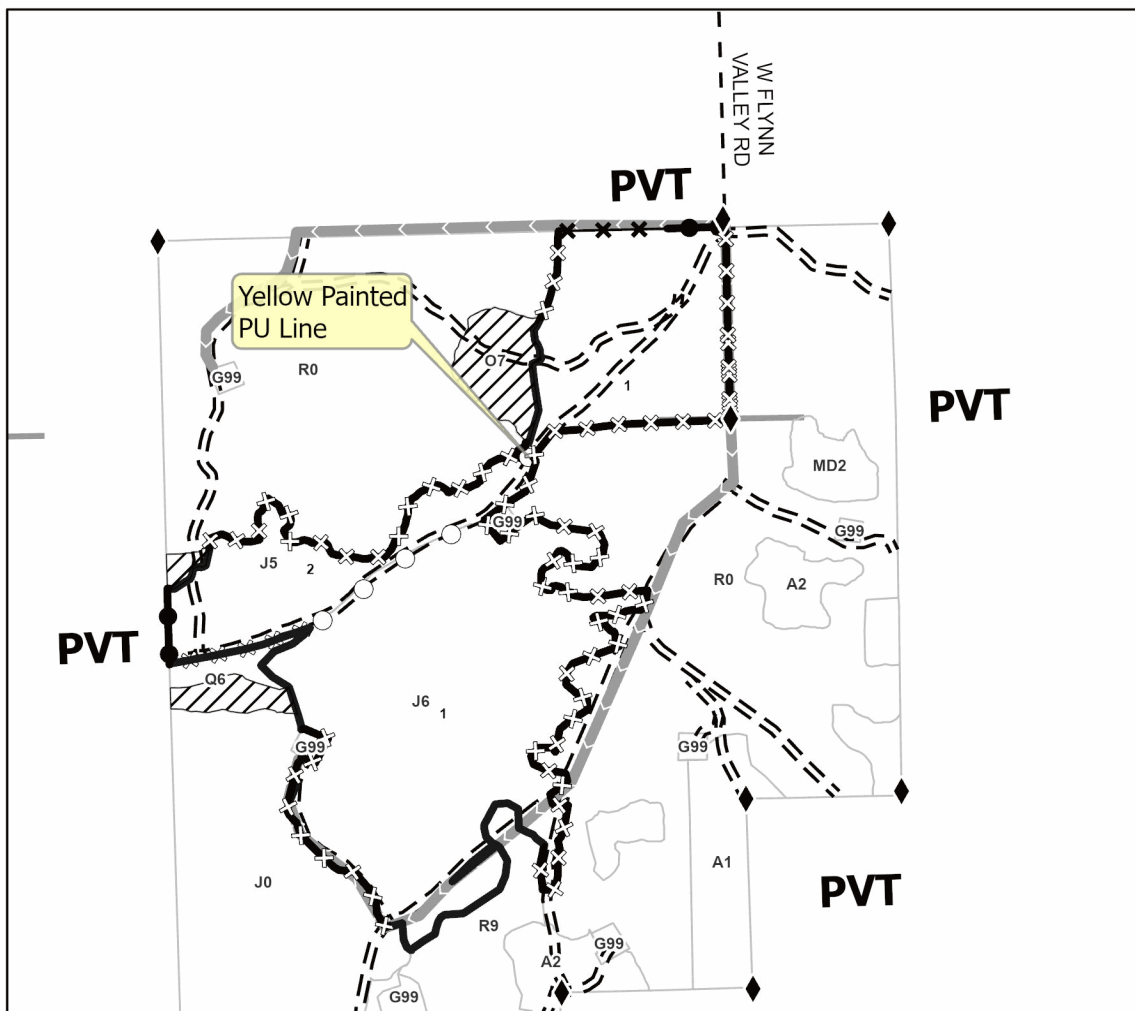
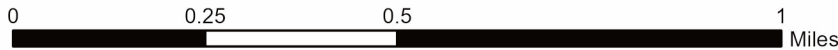
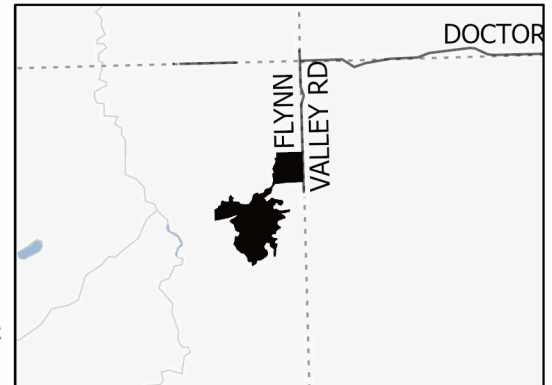

Legend

- Against State (Red)
- Against State (Unpainted)
- Private Line (Unpainted)
- Private Line (Blue)
- Payment Unit (Yellow)
- Payment Unit (Road)
- ▨ Retention Area
- Stand
- Oil And Gas Lines
- Forest Access Route
- Private Gravel/Dirt
- ◆ Field Grade Corner

Use QR Code to
open Map in App



TIMBER SALE INFORMATION

Ice Walsh Pickerel JP (72-019-25)

T28N, R01E, SEC. 19; T28N, R01E, SEC. 30; T28N, R01W, SEC. 12; T28N, R01W, SEC. 26.
Crawford County (Advertised Price \$15,077.85)

SALE NOTE: This salvage sale encompasses jack pine that was damaged by the spring 2025 ice storm. The sale is short duration with no extensions.

A free one-year extension will be granted that can be applied to a different qualifying sale (see Spec 7.2.3).

A recreation site such as a trail, pathway, or campground is within the sale area or the vicinity. Certain restrictions/specifications may be applicable including time restrictions.

A timber sale contract for this lump sum, sealed bid timber sale will be awarded to the responsible bidder offering the highest sealed bid price. All units of volume listed below were estimated using the Inventory Manager computer program and the new Michigan taper model. Bids must be at or above the following advertised price for each product and species:

<u>PRODUCTS & SPECIES</u>	<u>ESTIMATED UNITS*</u>	<u>ADVERTISED PRICE</u>
Pulpwood		
Balsam Fir	13 Cords	\$ 7.85 / Cord
Jack Pine	1,040 Cords	\$ 8.40 / Cord
Misc. Species 2	20 Cords	\$ 11.10 / Cord
Misc. Species 3	262 Cords	\$ 8.50 / Cord
Mixed Hardwood	44 Cords	\$ 13.95 / Cord
Mixed Oak	49 Cords	\$ 10.05 / Cord
Quaking Aspen	81 Cords	\$ 10.70 / Cord
Red Pine	82 Cords	\$ 19.05 / Cord
White Pine	33 Cords	\$ 7.75 / Cord

* The total volume is statistically estimated within plus (+) or minus (-) 14.45 percent. There are an estimated 1,630 cords on this timber sale, plus or minus 236 cords at the 95% confidence level. The estimated units are final and not subject to adjustment. Prospective bidders are urged to examine this timber and to make their own estimates of quantity and quality.

BOND AND PAYMENT SCHEDULE:

1. A bond in the amount of \$1,000.00 to insure faithful performance of the conditions of the contract will be deposited by the successful bidder within 21 days of the sale award.
2. Cutting in any sale or unit without the required advance payment would be considered a trespass.
3. Total payment must be paid in advance or according to the following schedule :
 - (a) Ten percent (10%) of the sale value must be paid within 21 days of the sale award.
 - (b) The 10% down payment will be credited towards the first unit cut.
 - (c) Payment for each of the following units must be made before cutting begins in that unit:

<u>PAYMENT UNIT NUMBER</u>	<u>PERCENT OF TOTAL SALE VALUE</u>
01	12.8%
02	19.1%
03	24.7%
04	23.9%
05	19.5%

4. If no cutting takes place, the 10% down payment will not be refunded.
5. Operations on the contract issued will terminate on 09/30/2026.

SALE STATISTICS

Volumes were calculated in cubic feet using the Michigan taper model. Cubic foot volume includes all wood inside bark for the product indicated. For display purposes, cubic feet were converted to cords and MBF using a simple conversion factor, e.g. 79 cubic feet per cord and 185 cubic feet per MBF. The cubic foot volumes are precise; the cords and MBF volumes are not. Cubic foot volume cannot be directly converted to cords or boards with precision.

SALE VOLUMES

The total estimated sale volume may not equal the sum of the species/products due to the nature of statistical calculations associated with double sampling methodology.

VOLUME			STATISTICAL RANGE IN CORDS	
TOTAL CUBIC FEET	TOTAL CORDS	PERCENT ERROR	MINIMUM	MAXIMUM
128,783	1,630	14.45%	1,394	1,866

VDU VOLUMES

A VDU is a Volume Determination Unit. Volumes and their associated statistics are calculated at the VDU level and summarized to the sale level. There is often a one to one relationship between a VDU and a Payment Unit, but not always, depending on the cruise design. Refer to the VDU TO PAYMENT UNIT table.

	VOLUME			RANGE IN CORDS	
VDU	TOTAL CUBIC FEET	TOTAL CORDS	PERCENT ERROR	MINIMUM	MAXIMUM
8	22,637	287	28.16%	206	367
23	17,785	225	30.38%	157	294
55	67,484	854	21.01%	675	1,034
57	20,877	264	46.70%	141	388
TOTAL:	128,783	1,630		1,178	2,082

VDU TO PAYMENT UNIT

When a VDU is associated with more than one Payment Unit (PU), the VDU volumes are assigned to the PU based on acres of the VDU within the PU.

VDU	VDU ACRES	PU	PU ACRES
TOTAL:			

PU	MARKET GROUP	PRODUCT	QUANTITY	UNIT	ACRES	ADVERTISE PRICE
1	Jack Pine Mixed Hardwood <i>Black Cherry</i>	Pulpwood	221 5 5	Cords Cords <i>Cords</i>	20.3	\$1,926.15
2	Jack Pine Mixed Oak <i>Northern Pin Oak</i> Red Pine <i>Red Pine</i> White Pine	Pulpwood	221 23 23 40 40 3	Cords Cords <i>Cords</i> Cords <i>Cords</i> Cords	18.0	\$2,872.80
3	Balsam Fir Jack Pine Misc. Species 2 Misc. Species 3 Mixed Hardwood <i>Red Maple</i> <i>Black Cherry</i> Mixed Oak <i>/Red (Hybrid) Oak</i> <i>/Red (Hybrid) Oak</i> Quaking Aspen Red Pine <i>Red Pine</i> <i>Red Pine</i> White Pine	Pulpwood <i>Sawtimber</i> <i>Pulpwood</i> <i>Sawtimber</i> <i>Pulpwood</i> <i>Sawtimber</i> <i>Pulpwood</i>	6 223 9 92 13 0.6 12 10 2.1 6 38 10 4.5 1 4	Cords Cords Cords Cords Cords <i>MBF</i> <i>Cords</i> Cords <i>MBF</i> <i>Cords</i> Cords Cords <i>MBF</i> <i>Cords</i> Cords	27.4	\$3,712.15
4	Balsam Fir Jack Pine Misc. Species 2 Misc. Species 3 Mixed Hardwood <i>Red Maple</i> <i>Black Cherry</i> <i>Red Maple</i> Mixed Oak <i>/Red (Hybrid) Oak</i> <i>/Red (Hybrid) Oak</i> Quaking Aspen Red Pine <i>Red Pine</i> <i>Red Pine</i> White Pine	Pulpwood <i>Sawtimber</i> <i>Pulpwood</i> <i>Sawtimber</i> <i>Pulpwood</i> <i>Sawtimber</i> <i>Pulpwood</i>	6 217 10 89 13 0.6 11 1 10 2.1 6 37 9 4.0 1 3	Cords Cords Cords Cords Cords <i>MBF</i> <i>Cords</i> <i>Cords</i> Cords <i>MBF</i> <i>Cords</i> Cords Cords <i>MBF</i> <i>Cords</i> Cords	26.3	\$3,609.85
5	Balsam Fir Jack Pine Misc. Species 2 Misc. Species 3 Mixed Hardwood <i>Red Maple</i> <i>Black Cherry</i> Mixed Oak <i>/Red (Hybrid) Oak</i> <i>/Red (Hybrid) Oak</i> Quaking Aspen Red Pine <i>Red Pine</i> <i>Red Pine</i> White Pine	Pulpwood <i>Sawtimber</i> <i>Pulpwood</i> <i>Sawtimber</i> <i>Pulpwood</i> <i>Sawtimber</i> <i>Pulpwood</i>	1 158 1 81 12 0.1 12 6 0.3 5 6 23 10.7 2 23	Cords Cords Cords Cords Cords <i>MBF</i> <i>Cords</i> Cords <i>MBF</i> <i>Cords</i> Cords Cords <i>MBF</i> <i>Cords</i> Cords	25.7	\$2,942.95

TOTAL:	1,623	Cords
--------	-------	-------

Sale Specific Conditions & Requirements

Sale Name: Ice Walsh Pickerel JP

Sale Number: 72-019-25 Seq#: 1

1 - Sale Area

1.2 - Boundaries

1.2.1 - Painted Boundaries (9/19)

The sale boundary and Payment Unit boundaries are marked and identified by blue and red paint, as well as by roads and cover type boundaries. Exterior sale boundary lines against private property are marked with blue paint. Exterior sale boundary lines against state are marked with red paint. In addition, there is an unpainted boundary on the northeast of Payment Unit 4 that is designated as the Wildlife Opening edge, an unpainted southern boundary of Payment Unit 3 that is designated as Pickerel Lake Road, and an unpainted east boundary of Payment Unit 5 that is designated as Farrington Road. Interior Payment Unit boundaries are unpainted and designated as Pickerel Lake Road. The blue painted boundary line trees are not Included Timber and are to be protected. Cut the merchantable red painted boundary line trees. If the red painted tree is in a multiple-stem clump, cut all trees within the clump.

2 - Timber Specifications

2.1 - Included Timber

2.1.1 - Clearcut Unit(s) with Unmerchantable Trees (6/14)

Within Payment Unit(s) 1, cut all trees that are two (2) inches or more at DBH.

Within Payment Units 3 and 4, cut all trees that are two (2) inches or more at DBH, except do not cut Red Pine that are 24 inches or greater at DBH.

Within Payment Unit 5, cut all trees that are two (2) inches or more at DBH, except do not cut Red Pine that are 24 inches or greater at DBH or White Oak.

2.1.2 - Clearcut Unit(s) w/o Unmerchantable Trees (8/11)

Within Payment Unit(s) 2, cut all trees which meet minimum piece specifications in 2.2 Utilization.

2.1.11 - Description of Timber Note (2/04)

Note that this is an ice storm salvage sale. Chipping will not be required but is encouraged, except for in the northwest three (3) acres of Payment Unit 4 where chipping is prohibited.

On Payment Units 1 and 2, all species were cruised as pulp.

In Payment Units 3-5, Misc Species 2 is designated as Quaking Aspen with broken tops, and Misc Species 3 is designated as Jack Pine with broken tops. In Payment Units 1 and 2, trees with broken tops were not split out as Misc Species.

2.2 - Utilization

2.2.3 - Stump Heights (12/24)

Stump heights within the Sale Area shall not exceed six (6) inches for all trees.

2.2.9 - No Chipping Permitted (12/08)

Within Payment Unit(s) 4, in the northwest three (3) acres, no chipping or skidding may occur. This area is shown on the Timber Sale Map as Shortwood Operations Only. All wood must be removed as roundwood.

3 - Payments

3.4 - Damaged Timber

3.4.2 - Special Protection Trees (1/25)

The Purchaser shall not cut live or dead special protection trees within cutting units or clearings. Special protection trees are designated as Red Pine that are 24 inches or greater at DBH on Payment Units 3-5. If Purchaser's operations have cut or damaged special protection trees through carelessness, the Purchaser shall pay \$500 as fixed, agreed and liquidated damages for each special protection tree cut or damaged. Such payment does not constitute ownership of the undesignated timber.

4 - Transportation

4.1 - Construction

4.1.3 - Slash and Earthen Piles (8/04)

Piles or windrows of earth along roads and landings that have been widened or constructed shall be leveled. Slash from road maintenance or construction, including stumps, shall be scattered into the sale or utilized. Residual slash piles at landings shall be spread out to less than two feet deep.

4.1.6 - Road Construction (4/24)

Construction of new roads or improvements of existing roads shall be done in such a way as to minimize the environmental and visual impacts. Merchantable trees shall be cut and utilized unless otherwise directed. Non-merchantable trees shall be severed and laid flat on the ground. Slash shall be chipped, utilized or scattered into the sale. Stumps shall be set upright, not left on edge, and be moved at least 10 feet away from the road edge. Disturbed soil shall be feathered into the woods and not left in berms or windrows.

4.1.7 - Road Closure (10/11)

All new roads built into the sale must be blocked to vehicle traffic upon completion of the sale. Overgrown roads that are reopened shall be considered new roads. In general, this will require constructing a four (4') foot high berm of stumps and logs covered with earth. Stumps and brush may also need to be placed along the remainder of the trail. Contact the Sale Administrator for specific details of design and placement.

4.1.11 - Permits (2/12)

The Purchaser will secure any necessary permits that may be required.

5 - Operations

5.1 - Notification

5.1.1 - Pre-sale Conference (10/16)

A pre-sale conference on site between the Purchaser and Sale Administrator is required prior to beginning any operations to determine landing and road locations. The Unit Manager or his/her representative must be contacted at least five (5) days in advance to schedule the conference. Note the 10-day advance notice required for contacting the oil and gas company in specification 5.1.3.

5.1.3 - Well Heads and Natural Gas Pipelines (11/15)

The Purchaser is responsible for contacting the gas or pipeline company at least 10 days prior to operating equipment in the vicinity of well heads or natural gas pipelines. Contact Riverside Energy at 989-705-7665 or 231-922-7302 (emergency contact) to coordinate access plans and allow the oilfield operating company time to take any necessary steps to protect their installations, such as hauling in gravel to cap pipeline crossings.

5.1.4 - Post-Sale Conference (10/16)

A post-sale conference on site between the Purchaser and sale administrator is required prior to the completion of active logging operations to determine clean-up and repair of landings, road edges, and the fulfillment of other contract specifications.

5.2 - Conduct of Operations

5.2.38 - No Decking Against Live Trees (2/04)

Cut products may not be decked against unmarked or designated leave trees.

5.2.40 - Pathway Protection (10/10)

The Shore to Shore Trail is a hiking and horse trail and is shown on the Timber Sale Map. Do not cut trees or damage posts with blue pathway markers. The trail runs down Pickerel Lake Road, except for 200 feet of trail that cuts the corner near Farrington Road.

5.2.41 - Snowmobile Trail Protection (9/11)

Trail 4 is a snowmobile trail and is shown on the Timber Sale Map. Do not cut or damage posts with orange trail markers or traffic control signs. If the trail is used, it must be maintained and restored to a condition equal to or better than before the sale. The road maintenance/restoration must be done prior to December 1. If the trail road is to be used for hauling during the snowmobile season, then a snow-covered base must be left on the trail. The snowmobile trail may only be crossed at right

angles. Maintain a 20-foot-wide slash, debris, and rut free zone daily using the snowmobile trail as the centerline. No decking of forest products will be permitted along the snowmobile trail. All stumps within five (50 feet of the snowmobile trail edge must be cut at ground level.

5.2.43 - Opening Protection (2/21)

No activities are permitted in openings marked on the Timber Sale Map with a Wildlife Opening label. Any damage to the openings shall be repaired according to specifications of the Unit Manager or his/her representative.

6 - Safety and Fire Prevention

6.2 - Signing

6.2.1 - Road Posting (10/20)

The Purchaser is responsible for posting and maintaining caution signs on the forest road haul routes for Payment Units 1 and 2, and the county roads that cross through Payment Units 3-5 prior to beginning operations. The road must be posted at appropriate distances from the Sale Area to warn of logging activity and truck traffic. Signs must be removed when harvest operations are suspended or completed. The Purchaser will provide these signs.

6.2.2 - Snowmobile Trail Posting (10/20)

The Purchaser is responsible for posting and maintaining caution signs on Trail 4 prior to beginning operations during the snowmobile season (approximately December 1 to March 31). The trail must be posted at appropriate distances from the Sale Area to warn of logging activity and truck traffic. Signs must be removed when harvest operations are suspended or completed. The Purchaser will provide these signs.

6.2.3 - Recreational Trail Posting (10/20)

The Purchaser is responsible for posting and maintaining caution signs on the Shore to Shore Trail prior to beginning operations. The trail must be posted at appropriate distances from the Sale Area to warn of logging activity and truck traffic at both ends of the trail. Signs must be removed when harvest operations are suspended or completed. The Purchaser will provide these signs.

7 - Other Conditions

7.2 - Extensions

7.2.2 - No Extensions (3/09)

This is an ice storm jack pine salvage harvest. There will be no extensions granted on this contract.

7.5 - Loss

7.5.1 - Deteriorating Timber (7/09)

The Sale Area has received damage from an Ice Storm that occurred in late March 2025. The Purchaser should harvest the wood as soon as possible. The Department of Natural Resources is held free of responsibility of any further damage or deterioration due to delay in harvesting.

**TIMBER SALE MAP**

This information provided by authority of Part 525, 1994 PA 451, as amended.

Sale Number

72-019-25

Date

06/10/2025

Forest Management Unit

Grayling Mgt Unit

County

Crawford

Mapped By: Charlebois (PU 1 & 2)

Cruised By: Charlebois (PU 1 & 2)

Scale

1:12,000

Page

2

Of

3Township
28NRange
01E / 01WSection(s) and
Subdivision(s)

NW,SWNE,N1/2SW;

Sec. 12 S1/2NE,NESW,NWSE; Sec. 19 SESW; Sec. 26 SENW,SWNE,NESW; Sec. 30

Cover Type

A = Aspen	J = Jack Pine	O = Oak	U = Upland Brush
B = Paper Birch	K = Rock	P = Lowland Poplar	UM = Upland Mix Forest
C = Cedar	L = Lowland Brush	Q = Mixed Swamp Conifer	V = Bog or Marsh
D = Treed Bog	LM = Lowland Mix Forest	R = Red Pine	W = White Pine
E = Swamp Hardwoods	M = Maple, Beech, Birch	S = Black Spruce	X = Non Stocked
F = Spruce/Fir	MC = Mixed Conifer	T = Tamarack	Y = Sand
G = Grass	MD = Mixed Deciduous		Z = Water
H = Hemlock	N = Marsh		

Density

0 = Non Stocked	5 = Pole Timber Medium
1 = Seedling Sapling Poor	6 = Pole Timber Well
2 = Seedling Sapling Medium	7 = Saw Timber Poor
3 = Seedling Sapling Well	8 = Saw Timber Medium
4 = Pole Timber Poor	9 = Saw Timber Well

Ice Walsh Pickerel JP

117.7 Acres

**Payment Unit
Number**

Payment Unit Number	Acres
1	20.3
2	18
3	27.3
4	26.3
5	25.8

Legend**Sale Boundary**

- Against State (Red paint)
- Private Line (Blue paint)
- County Gravel Road
- DNR Forest Road
- DNR Closed Road
- - - Private Road
- Horse-Hiking Trail
- Snowmobile Trail
- ◇ Field Grade Corner
- Overhead Powerline
- Lakes and Rivers

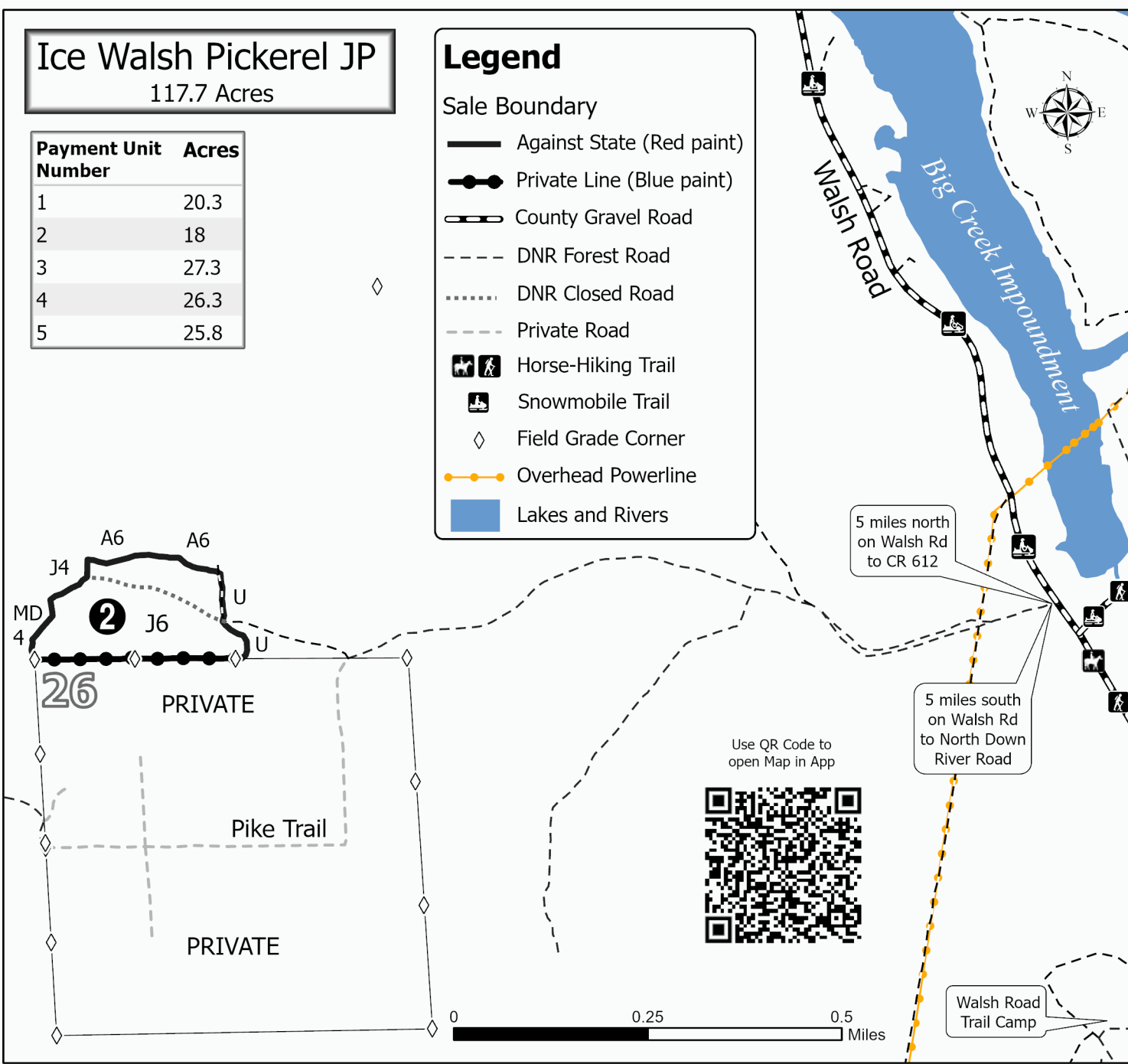



TIMBER SALE MAP

This information provided by authority of Part 525, 1994 PA 451, as amended.

Sale Number

72-019-25

Date

06/23/2025

Forest Management Unit

County

Mapped By: Porteous (PU 3-5)

Scale

Page

Of

Grayling Mgt Unit

Crawford

Cruised By: Porteous (PU 3-5)

1:9,000

3

3

Township
28N

Range
01E / 01W

Section(s) and NW,SWNE,N1/2SW;
Subdivision(s) Sec. 12 S1/2NE,NESW,NWSE; Sec. 19 SESW; Sec. 26 SENW,SWNE,NESW; Sec. 30

Cover Type

A = Aspen	J = Jack Pine	O = Oak	U = Upland Brush
B = Paper Birch	K = Rock	P = Lowland Poplar	UM = Upland Mix Forest
C = Cedar	L = Lowland Brush	Q = Mixed Swamp Conifer	V = Bog or Marsh
D = Treed Bog	LM = Lowland Mix Forest	R = Red Pine	W = White Pine
E = Swamp Hardwoods	M = Maple, Beech, Birch	S = Black Spruce	X = Non Stocked
F = Spruce/Fir	MC = Mixed Conifer	T = Tamarack	Y = Sand
G = Grass	MD = Mixed Deciduous		Z = Water
H = Hemlock	N = Marsh		

Density

0 = Non Stocked	5 = Pole Timber Medium
1 = Seedling Sapling Poor	6 = Pole Timber Well
2 = Seedling Sapling Medium	7 = Saw Timber Poor
3 = Seedling Sapling Well	8 = Saw Timber Medium
4 = Pole Timber Poor	9 = Saw Timber Well

Payment Unit Acres

1	20.3
2	18
3	27.3
4	26.3
5	25.8

Use QR Code to
open Map in App



Ice Walsh Pickerel JP

117.7 Acres

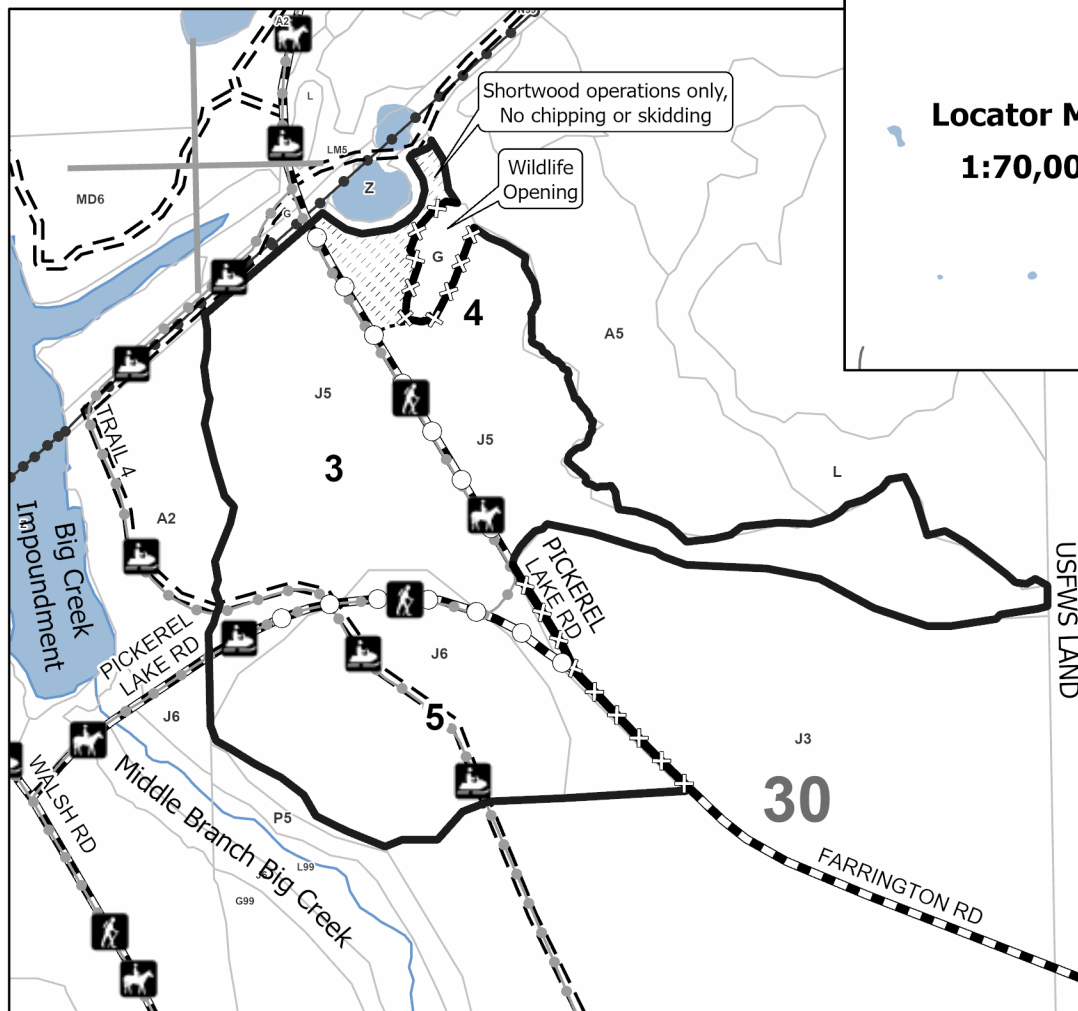
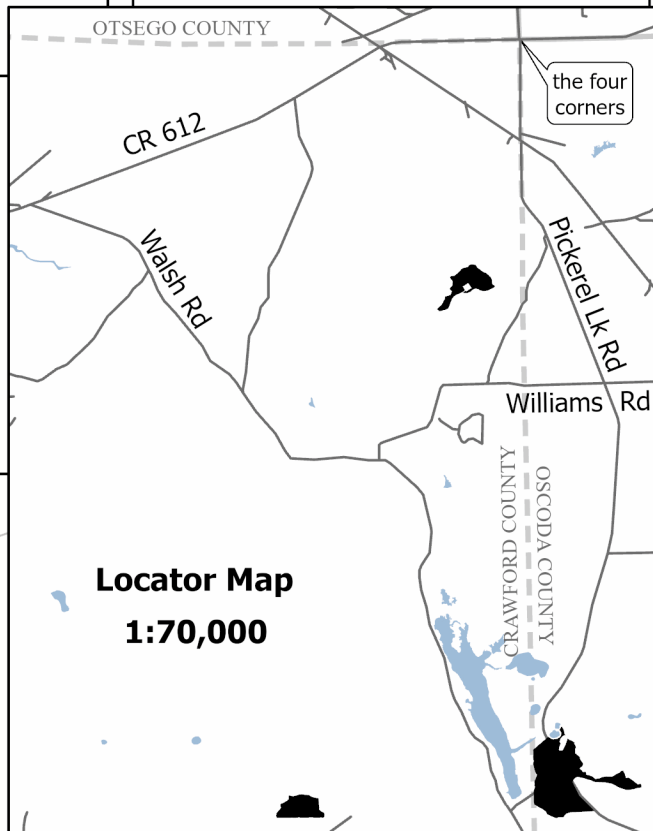
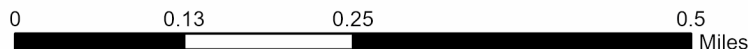

Legend

- Against State (Red)
- Against State (Unpainted)
- Payment Unit (Road)
- No Chip or Skid Area
- Stand
- Lakes and Rivers
- Powerline
- Recreational Trails
- Perennial River
- MIRIS Section Corner
- Forest Access Route
- Administrative Access Only
- Government Gravel/Dirt

**TIMBER SALE MAP**

This information provided by authority of Part 525, 1994 PA 451, as amended.

Sale Number

72-019-25

Date

07/28/2025

Forest Management Unit		County	Mapped By: Charlebois (PU 1 & 2)	Scale	Page	Of
Grayling Mgt Unit		Crawford	Cruised By: Charlebois (PU 1 & 2)	1:10,000	1	3
Township	Range	Section(s) and Subdivision(s) NW,SWNE,N1/2SW; Sec. 12 S1/2NE,NESW,NWSE; Sec. 19 SESW; Sec. 26 SENW,SWNE,NESW; Sec. 30				
28N	01E / 01W					

Cover Type

A = Aspen	J = Jack Pine	O = Oak	U = Upland Brush
B = Paper Birch	K = Rock	P = Lowland Poplar	UM = Upland Mix Forest
C = Cedar	L = Lowland Brush	Q = Mixed Swamp Conifer	V = Bog or Marsh
D = Treed Bog	LM = Lowland Mix Forest	R = Red Pine	W = White Pine
E = Swamp Hardwoods	M = Maple, Beech, Birch	S = Black Spruce	X = Non Stocked
F = Spruce/Fir	MC = Mixed Conifer	T = Tamarack	Y = Sand
G = Grass	MD = Mixed Deciduous		Z = Water
H = Hemlock	N = Marsh		

Density

0 = Non Stocked	5 = Pole Timber Medium
1 = Seedling Sapling Poor	6 = Pole Timber Well
2 = Seedling Sapling Medium	7 = Saw Timber Poor
3 = Seedling Sapling Well	8 = Saw Timber Medium
4 = Pole Timber Poor	9 = Saw Timber Well

Ice Walsh Pickerel JP
117.7 Acres**Legend**

- Sale Boundary
- Against State (Red paint)
- - - DNR Forest Road
- County Road
- + + Buried Pipeline
- ⚡ Gas Well Site
- ◇ Field Grade Corner
- 🚶 Hiking Trail
- 🐎 Horse Trail

12

Riverside Energy
gas well site
State Lovells
7-12 (B3-12)
was excluded
from the sale
& cruise area

Payment Unit Number	Acres
1	20.3
2	18
3	27.3
4	26.3
5	25.8

Use QR Code to
open Map in App

2 miles north on
Pickerel Lk Rd to
CR 612 at the
four corners

Chief's Trail

PRIVATE

Williams Rd

0 0.25 0.5 Miles

TIMBER SALE INFORMATION

Ice North Camp Barrens (72-617-25)

T27N, R02W, SEC. 15; T27N, R02W, SEC. 16; T27N, R02W, SEC. 21; T27N, R02W, SEC. 8.
Crawford County (Advertised Price \$18,820.60)

SALE NOTE: This salvage sale encompasses jack pine that was damaged by the spring 2025 ice storm. The sale is short duration with no extensions.

This sale is upon lands utilized for training by the Michigan National Guard - Camp Grayling. See Sale Spec 5.1.5 for details.

Operations on this contract may not be allowed during National Guard training operations. Typically, the restricted period is from May 1 to October 31. See Sale Spec 5.2.3.7 for restrictions.

Be aware that the Sale Area could contain UXO (unexploded ordinances). See Sale Spec 6.4 for additional details.

A timber sale contract for this lump sum, sealed bid timber sale will be awarded to the responsible bidder offering the highest sealed bid price. All units of volume listed below were estimated using the Inventory Manager computer program and the new Michigan taper model. Bids must be at or above the following advertised price for each product and species:

<u>PRODUCTS & SPECIES</u>	<u>ESTIMATED UNITS*</u>	<u>ADVERTISED PRICE</u>
Pulpwood		
Jack Pine	2,019 Cords	\$ 7.70 / Cord
Mixed Aspen	31 Cords	\$ 10.60 / Cord
Mixed Hardwood	25 Cords	\$ 14.00 / Cord
Northern Pin Oak	257 Cords	\$ 10.10 / Cord

* The total volume is statistically estimated within plus (+) or minus (-) 10.82 percent. There are an estimated 2,333 cords on this timber sale, plus or minus 253 cords at the 95% confidence level. The estimated units are final and not subject to adjustment. Prospective bidders are urged to examine this timber and to make their own estimates of quantity and quality.

BOND AND PAYMENT SCHEDULE:

1. A bond in the amount of \$941.00 to insure faithful performance of the conditions of the contract will be deposited by the successful bidder within 21 days of the sale award.
2. Cutting in any sale or unit without the required advance payment would be considered a trespass.
3. Total payment must be paid in advance or according to the following schedule:
 - (a) Ten percent (10%) of the sale value must be paid within 21 days of the sale award.
 - (b) The 10% down payment will be credited towards the first unit cut.

(c) Payment for each of the following units must be made before cutting begins in that unit:

<u>PAYMENT UNIT NUMBER</u>	<u>PERCENT OF TOTAL SALE VALUE</u>
01	21.4%
02	40.0%
03	22.8%
04	15.8%

4. If no cutting takes place, the 10% down payment will not be refunded.
5. Operations on the contract issued will terminate on 12/31/2027.

SALE STATISTICS

Volumes were calculated in cubic feet using the Michigan taper model. Cubic foot volume includes all wood inside bark for the product indicated. For display purposes, cubic feet were converted to cords and MBF using a simple conversion factor, e.g. 79 cubic feet per cord and 185 cubic feet per MBF. The cubic foot volumes are precise; the cords and MBF volumes are not. Cubic foot volume cannot be directly converted to cords or boards with precision.

SALE VOLUMES

The total estimated sale volume may not equal the sum of the species/products due to the nature of statistical calculations associated with double sampling methodology.

<u>VOLUME</u>		<u>STATISTICAL RANGE IN CORDS</u>		
<u>TOTAL CUBIC FEET</u>	<u>TOTAL CORDS</u>	<u>PERCENT ERROR</u>	<u>MINIMUM</u>	<u>MAXIMUM</u>
184,295	2,333	10.82%	2,080	2,585

VDU VOLUMES

A VDU is a Volume Determination Unit. Volumes and their associated statistics are calculated at the VDU level and summarized to the sale level. There is often a one to one relationship between a VDU and a Payment Unit, but not always, depending on the cruise design. Refer to the VDU TO PAYMENT UNIT table.

	VOLUME			RANGE IN CORDS	
VDU	TOTAL CUBIC FEET	TOTAL CORDS	PERCENT ERROR	MINIMUM	MAXIMUM
3	2,832	36	89.26%	4	68
5	62,868	796	24.20%	603	988
8	20,467	259	27.64%	187	331
24	40,317	510	12.86%	445	576
28	8,644	109	66.25%	37	182
54	49,166	622	19.32%	502	743
TOTAL:	184,295	2,333		1,778	2,887

VDU TO PAYMENT UNIT

When a VDU is associated with more than one Payment Unit (PU), the VDU volumes are assigned to the PU based on acres of the VDU within the PU.

VDU	VDU ACRES	PU	PU ACRES
TOTAL:			

DESCRIPTION OF TIMBER BY PAYMENT UNIT (PU)

PU	MARKET GROUP	PRODUCT	QUANTITY	UNIT	ACRES	ADVERTISE PRICE
1	Jack Pine	Pulpwood	468	Cords	46.6	\$4,024.60
	Jack Pine		468	Cords		
	Mixed Aspen		6	Cords		
	B. T. Aspen		6	Cords		
	Mixed Hardwood		1	Cords		
	Black Cherry		1	Cords		
	Northern Pin Oak		34	Cords		
2	Jack Pine	Pulpwood	701	Cords	88.8	\$7,519.10
	Jack Pine		701	Cords		
	Mixed Aspen		5	Cords		
	B. T. Aspen		5	Cords		
	Mixed Hardwood		15	Cords		
	Red Maple		15	Cords		
	Northern Pin Oak		184	Cords		
3	Jack Pine	Pulpwood	487	Cords	66.6	\$4,300.20
	Jack Pine		385	Cords		
	Misc. Species 3		102	Cords		
	Mixed Aspen		8	Cords		
	Quaking Aspen		8	Cords		
	Mixed Hardwood		8	Cords		
	Black Cherry		5	Cords		
	Red Maple		3	Cords		
	Northern Pin Oak		35	Cords		
4	Jack Pine	Pulpwood	363	Cords	37.5	\$2,976.70
	Jack Pine		295	Cords		
	Misc. Species 3		68	Cords		
	Mixed Aspen		12	Cords		
	Quaking Aspen		12	Cords		
	Mixed Hardwood		1	Cords		
	Black Cherry		1	Cords		
	Northern Pin Oak		4	Cords		
TOTAL:			2,332	Cords		

Sale Specific Conditions & Requirements

Sale Name: Ice North Camp Barrens

Sale Number: 72-617-25 Seq#: 1

1 - Sale Area

1.2 - Boundaries

1.2.1 - Painted Boundaries (9/19)

The sale boundary and Payment Unit boundaries are marked and identified by red paint as well as by roads and cover type boundaries. Exterior sale boundary lines against state are marked with red paint, unpainted boundary segments designated as mapped roads, fire control lanes, and cover type boundaries shown on the Timber Sale Map. Interior retention patches are marked with red paint; no harvesting activities may occur within these areas. Cut the merchantable red painted boundary line trees. If the red painted tree is in a multiple-stem clump, cut all trees within the clump.

2 - Timber Specifications

2.1 - Included Timber

2.1.1 - Clearcut Unit(s) with Unmerchantable Trees (6/14)

Within Payment Unit(s) 1-4, cut all trees that are two (2) inches or more at DBH, except leave all red pine, white pine, and white oak.

2.1.11 - Description of Timber Note (2/04)

Note that this is an ice storm salvage. All species were cruised as pulp. In Payment Units 3 and 4, jack pine that had snapped off below 4 inches diameter outside bark were cruised as Misc Species 3. In Payment Units 1 and 2, jack pine with broken tops were not split out as Misc Species.

2.2 - Utilization

2.2.2 - Chipping Required (12/24)

This area must be chip harvested to meet National Guard requirements and facilitate planned prescribed burning. The Purchaser has the option to produce sawlogs or pulpwood bolts, but the remaining portion of the trees must be chipped and hauled. Slash from the ice storm does not have to be chipped. The requirement to retain approximately 1/6 to 1/3 of treetops and limbs less than four (4) inches in diameter does not apply (G. C. & R. 2.2) because the sale is on Military lands.

2.2.3 - Stump Heights (12/24)

Stump heights within the Sale Area shall not exceed six (6) inches for all trees. This is in order to facilitate military requirements.

4 - Transportation

4.1 - Construction

4.1.3 - Slash and Earthen Piles (8/04)

Piles or windrows of earth along roads and landings that have been widened or constructed shall be leveled. Slash from road maintenance or construction, including stumps, shall be chipped, utilized or dispersed into the sale.

4.1.6 - Road Construction (4/24)

Construction of new roads or improvements of existing roads shall be done in such a way as to minimize the environmental and visual impacts. Merchantable trees shall be cut and utilized unless otherwise directed. Non-merchantable trees shall be severed and laid flat on the ground. Slash shall be chipped, utilized or otherwise removed from the sale. Stumps shall be set upright, not left on edge, and be moved at least 10 feet away from the road edge. Disturbed soil shall be feathered into the woods and not left in berms or windrows.

4.1.7 - Road Closure (10/11)

All new roads built into the sale must be blocked to vehicle traffic upon completion of the sale. Overgrown roads that are reopened shall be considered new roads. In general, this will require constructing a four (4') foot high berm of stumps and logs covered with earth. Stumps and brush may need to be placed along the remainder of the trail. Contact the Sale Administrator for specific details of design and placement.

4.1.11 - Permits (2/12)

The Purchaser will secure any necessary permits that may be required.

5 - Operations

5.1 - Notification

5.1.1 - Pre-sale Conference (10/16)

A pre-sale conference on site between the Purchaser and Sale Administrator is required prior to beginning any operations to determine landing and road locations. The Unit Manager or his/her representative must be contacted at least 5 days in advance to schedule the conference.

5.1.4 - Post-Sale Conference (10/16)

A post-sale conference on site between the Purchaser and sale administrator is required prior to the completion of active logging operations to determine clean-up and repair of landings, road edges, and the fulfillment of other contract specifications.

5.1.5 - National Guard Notification (1/25)

This sale is upon lands utilized for training by the Michigan National Guard - Camp Grayling. A minimum of five (5) business days prior to opening this sale, the Purchaser must request that the Sale Administrator contact the military for information regarding training plans that may impact sale operations.

5.2 - Conduct of Operations

5.2.3 - Operating Restrictions

5.2.3.7 - National Guard Training Restriction (1/25)

Operations on this contract may not be allowed during National Guard training operations. Typically, the restricted period is from May 1 to October 31. The Purchaser must check with the Unit Manager, who will coordinate the cutting schedule with the Military. All harvest equipment and timber products may need to be removed from the Sale Area during the period of May 1 to October 31.

5.2.29 - Shrub Protection (1/20)

Do not cut or damage hawthorn, junberry, or plum. These woody-shrub plants are highly beneficial to various wildlife species.

5.2.38 - No Decking Against Live Trees (2/04)

Cut products may not be decked against unmarked or designated leave trees.

5.4 - Soil Protection

5.4.2 - Skid Trails (2/04)

Skid trails up and down slopes should be avoided. If, however, this is unavoidable, these trails will be left in a non-erodible condition using water bars, logs, and slash. Placing of slash on these skid trails while logging is ongoing may alleviate need for any further action. At the direction of the Sale Administrator, seed, fertilizer, and mulch may also be required.

5.5 - Protection of Improvements

5.5.3 - Protection of Improvements Detail (10/13)

Protect the Military gates and staked monitor plots.

6 - Safety and Fire Prevention

6.2 - Signing

6.2.1 - Road Posting (10/20)

The Purchaser is responsible for posting and maintaining caution signs on Stephan Bridge Road and Bucks East-West Truck Trail prior to beginning operations. The road must be posted at appropriate distances from the Sale Area when felling is ongoing near the road corridor to warn of logging activity and truck traffic. Signs must be removed when harvest operations are suspended or completed. The Purchaser will provide these signs.

SKIP

6.4 - Unexploded Ordinance (7/15)

Be aware that the Sale Area could contain UXO (unexploded ordinances). Do not touch or drive over any metal objects. If any objects are found, please flag the area and notify the Unit Manager or his/her representative, so that they can make arrangements with the Military.

7 - Other Conditions

7.2 - Extensions

7.2.2 - No Extensions (3/09)

This is an ice storm jack pine salvage harvest. There will be no extensions granted on this contract.

7.5 - Loss

7.5.1 - Deteriorating Timber (7/09)

The Sale Area has received damage from the spring 2025 Ice Storm, in addition to age-related decline and mortality. The Purchaser should harvest the wood as soon as possible. The Department of Natural Resources is held free of responsibility of any further damage or deterioration due to delay in harvesting.

7.10 - Certified Timber

7.10.1 - Non-Certified Timber (2/16)

The area encompassed by this timber sale is not certified to the standards of the Forest Stewardship Council (FSC) or the Sustainable Forestry Initiative (SFI). Forest products from this sale may not be delivered to the mill as "FSC and / or SFI certified". The lands within this sale are managed for military training.

**TIMBER SALE MAP**

This information provided by authority of Part 525, 1994 PA 451, as amended.

Sale Number

72-617-25

Date

07/16/2025

Forest Management Unit

Grayling Mgt Unit

County

Crawford

Mapped By: Charlebois, McClarren

Cruised By: Charlebois

Scale

1:25,000

Page

1

Of

1Township
27NRange
02W

Section(s) and

Subdivision(s) Sec. 15 NW,NESW,N1/2SE; Sec. 16 NE,NESW,W1/2SE; Sec. 21 N1/2NE; Sec. 8 NW;

Cover Type

A = Aspen	J = Jack Pine	O = Oak	U = Upland Brush
B = Paper Birch	K = Rock	P = Lowland Poplar	UM = Upland Mix Forest
C = Cedar	L = Lowland Brush	Q = Mixed Swamp Conifer	V = Bog or Marsh
D = Treed Bog	LM = Lowland Mix Forest	R = Red Pine	W = White Pine
E = Swamp Hardwoods	M = Maple, Beech, Birch	S = Black Spruce	X = Non Stocked
F = Spruce/Fir	MC = Mixed Conifer	T = Tamarack	Y = Sand
G = Grass	MD = Mixed Deciduous		Z = Water
H = Hemlock	N = Marsh		

Density

0 = Non Stocked	5 = Pole Timber Medium
1 = Seedling Sapling Poor	6 = Pole Timber Well
2 = Seedling Sapling Medium	7 = Saw Timber Poor
3 = Seedling Sapling Well	8 = Saw Timber Medium
4 = Pole Timber Poor	9 = Saw Timber Well

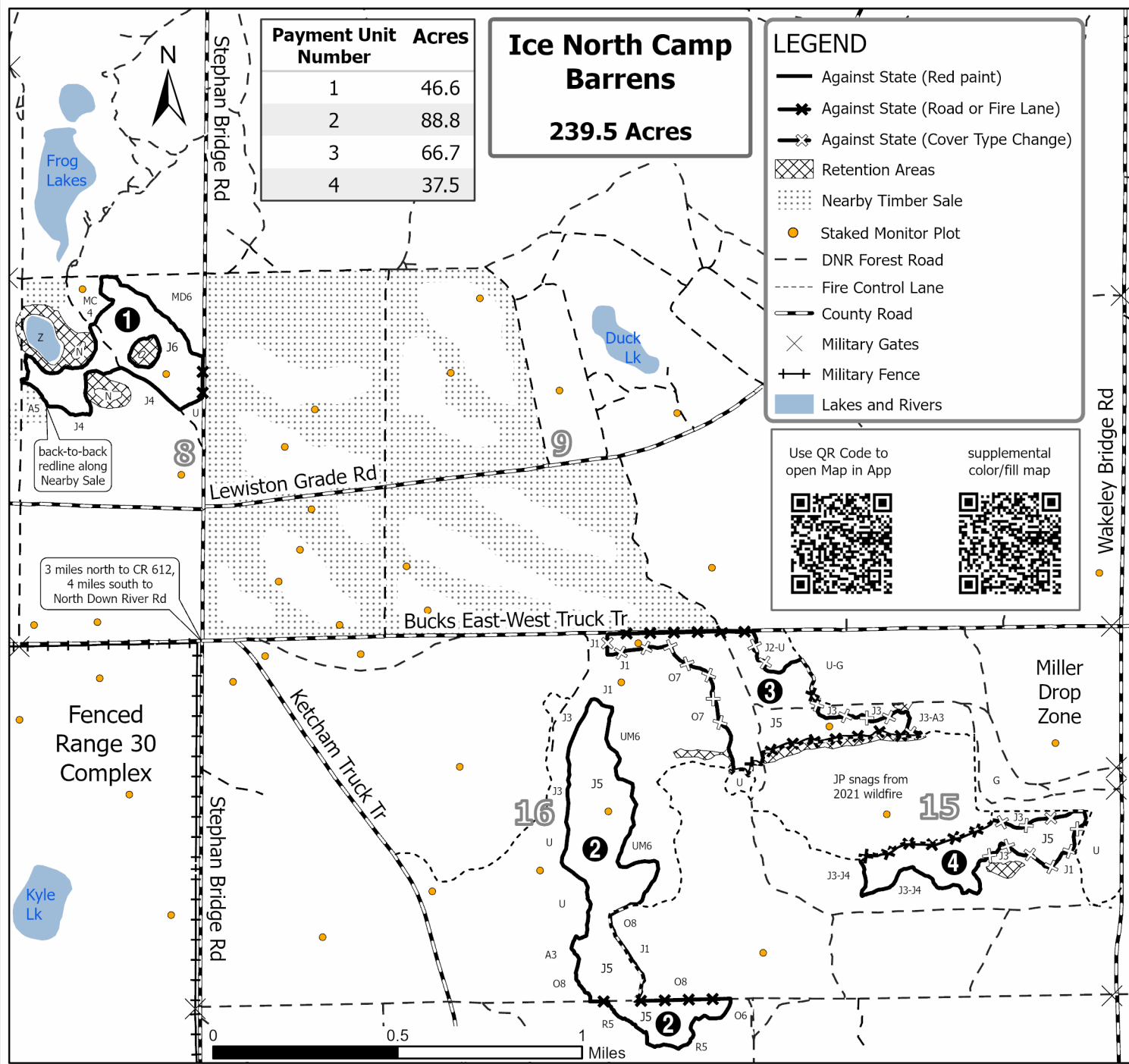

Ice-Pineway Robbery (72-016-25)
T28N, R04E, SEC. 1; T28N, R04E, SEC. 12; Oscoda COUNTY

In response to the notice of sale to be held 9:00 a.m. (local time) on September 15, 2025, I am hereby submitting my sealed bid (firm offer) for the following forest products to be cut. Bids for individual species must be at or above the advertised price. All non-responsive bid forms may be rejected.

<u>PRODUCTS & SPECIES</u>	<u>ESTIMATED VOLUME*</u>	<u>ADVERTISED PRICE</u>	<u>BID PRICE/UNIT</u>
Pulpwood			
Black Cherry	10 Cords	\$ 13.95/Cord	\$ _____
Black/Red (Hybrid) Oak	17 Cords	\$ 10.05/Cord	\$ _____
Jack Pine	1,019 Cords	\$ 9.70/Cord	\$ _____
Misc. Species 3	709 Cords	\$ 9.70/Cord	\$ _____
Mixed Aspen	12 Cords	\$ 10.70/Cord	\$ _____
Red Pine	44 Cords	\$ 19.05/Cord	\$ _____
White Pine	6 Cords	\$ 7.75/Cord	\$ _____

*The volumes are statistically estimated within plus (+) or minus (-) 19.58 percent at 95% confidence level. These estimated volumes are final and not subject to adjustment. Prospective bidders are urged to examine this timber and to make their own estimates of quantity and quality.

I understand that any or all bids may be rejected. All bids must be signed and all bid items must be bid or the bid form may be rejected. I also understand that consideration and awarding a contract will be based upon my past performance and ability to complete the contract based upon equipment and staffing subject to my control.

FEDERAL ID: ____-____-____ or SOCIAL SECURITY NUMBER: ____-____-____
Company or individual bidding: _____
Company representative's name: _____
Address: _____
City: _____ State: _____ Zip: _____

IF AVAILABLE, PLEASE PLACE THE PERSONALIZED LABEL FROM YOUR PROSPECTUS IN THE ABOVE BOX.

Individual or company representative's signature: _____ Date: _____

Phone number : _____ Email (optional): _____

**THE WINNING BIDDER MUST COMPLETE THE VERIFICATION OF WORKER'S DISABILITY COMPENSATION ACT
COMPLIANCE (ON REVERSE SIDE IF DOUBLE SIDED) WITHIN 21 DAYS OF SALE AWARD DATE**



TIMBER SALE VERIFICATION OF WORKER'S DISABILITY COMPENSATION ACT COMPLIANCE

As required by Act 317, P.A. 1969 (Worker's Compensation) and
Part 5 of Act 451 of 1994, as amended.

FOR DEPARTMENT USE ONLY

Sale Number (XX - XXX - XX - XX)

Forest Management Unit:

VERIFICATION OF WORKER'S DISABILITY COMPENSATION ACT COMPLIANCE

- This verification must be completed and submitted within 21 days of contract award and prior to the issuance of the timber sale contract.
- In addition, if boxes 2B or 2C are checked, then Notice of Exclusion or Certificate of Insurance must be submitted within twenty-one (21) days of the contract award and prior to the issuance of the timber sale contract.
- All Information must be typed or printed except for written signatures.

Please Check Appropriate Categories:

1. My business is organized as (you **must** check one of the boxes below):
 - A. ☐ Sole Proprietorship (individual)
 - B. ☐ Partnership
 - C. ☐ Corporation
2. You **must** check one of the boxes below:
 - A. ☐ I certify my business is a sole proprietorship and it has no employees but the sole proprietor. I am not subject to the Worker's Compensation Laws.
 - B. ☐ I certify my business has satisfied its obligation to the Worker's Compensation Act through the use of an approved Notice of Exclusion (BWC-337, Rev. 5/96). I will provide a copy of the Notice of Exclusion within 21 days of the contract award. (For questions or a copy of the BWC-337, please call the Worker's Compensation Bureau at 517-322-1195).
 - C. ☐ I certify my business has a Worker's Compensation Policy. I will provide an original Certificate of Insurance within twenty-one (21) days of the contract award.
3. If you have checked item 2(A) or 2(B), you **must** indicate the number of **both** full-time and part-time employees, other than yourself, including family members and active partners (if none, you must enter "0").

_____ Full-time Employees

_____ Part-time Employees

Name of Business		Federal ID (or) Social Security No.
Address		Telephone ()
City	State	ZIP

I hereby certify that the above information is true and correct. I agree to notify the Michigan DNR of any changes that occur in factors affecting my coverage during any of my present and future operations.

Signature of Owner or Authorized Representative

Title

Date

Please complete the "SEALED BID" information on the next page

Ice Walsh Pickerel JP (72-019-25)

T28N, R01E, SEC. 19; T28N, R01E, SEC. 30; T28N, R01W, SEC. 12; T28N, R01W,

In response to the notice of sale to be held 9:00 a.m. (local time) on September 15, 2025, I am hereby submitting my sealed bid (firm offer) for the following forest products to be cut. Bids for individual species must be at or above the advertised price. All non-responsive bid forms may be rejected.

<u>PRODUCTS & SPECIES</u>	<u>ESTIMATED VOLUME*</u>	<u>ADVERTISED PRICE</u>	<u>BID PRICE/UNIT</u>
Pulpwood			
Balsam Fir	13 Cords	\$ 7.85/Cord	\$ _____
Jack Pine	1,040 Cords	\$ 8.40/Cord	\$ _____
Misc. Species 2	20 Cords	\$ 11.10/Cord	\$ _____
Misc. Species 3	262 Cords	\$ 8.50/Cord	\$ _____
Mixed Hardwood	44 Cords	\$ 13.95/Cord	\$ _____
Mixed Oak	49 Cords	\$ 10.05/Cord	\$ _____
Quaking Aspen	81 Cords	\$ 10.70/Cord	\$ _____
Red Pine	82 Cords	\$ 19.05/Cord	\$ _____
White Pine	33 Cords	\$ 7.75/Cord	\$ _____

*The volumes are statistically estimated within plus (+) or minus (-) 14.45 percent at 95% confidence level. These estimated volumes are final and not subject to adjustment. Prospective bidders are urged to examine this timber and to make their own estimates of quantity and quality.

I understand that any or all bids may be rejected. All bids must be signed and all bid items must be bid or the bid form may be rejected. I also understand that consideration and awarding a contract will be based upon my past performance and ability to complete the contract based upon equipment and staffing subject to my control.

FEDERAL ID: ____ - ____ - ____ or SOCIAL SECURITY NUMBER: ____ - ____ - ____

Company or individual bidding: _____

Company representative's name: _____

Address: _____

City: _____ State: _____ Zip: _____

IF AVAILABLE, PLEASE PLACE THE PERSONALIZED LABEL FROM YOUR PROSPECTUS IN THE ABOVE BOX.

Individual or company representative's signature: _____ Date: _____

Phone number : _____ Email (optional): _____

**THE WINNING BIDDER MUST COMPLETE THE VERIFICATION OF WORKER'S DISABILITY COMPENSATION ACT
COMPLIANCE (ON REVERSE SIDE IF DOUBLE SIDED) WITHIN 21 DAYS OF SALE AWARD DATE**



TIMBER SALE VERIFICATION OF WORKER'S DISABILITY COMPENSATION ACT COMPLIANCE

As required by Act 317, P.A. 1969 (Worker's Compensation) and
Part 5 of Act 451 of 1994, as amended.

FOR DEPARTMENT USE ONLY

Sale Number (XX - XXX - XX - XX)

Forest Management Unit:

VERIFICATION OF WORKER'S DISABILITY COMPENSATION ACT COMPLIANCE

- This verification must be completed and submitted within 21 days of contract award and prior to the issuance of the timber sale contract.
- In addition, if boxes 2B or 2C are checked, then Notice of Exclusion or Certificate of Insurance must be submitted within twenty-one (21) days of the contract award and prior to the issuance of the timber sale contract.
- All information must be typed or printed except for written signatures.

Please Check Appropriate Categories:

1. My business is organized as (you **must** check one of the boxes below):
 - A. ☐ Sole Proprietorship (individual)
 - B. ☐ Partnership
 - C. ☐ Corporation
2. You **must** check one of the boxes below:
 - A. ☐ I certify my business is a sole proprietorship and it has no employees but the sole proprietor. I am not subject to the Worker's Compensation Laws.
 - B. ☐ I certify my business has satisfied its obligation to the Worker's Compensation Act through the use of an approved Notice of Exclusion (BWC-337, Rev. 5/96). I will provide a copy of the Notice of Exclusion within 21 days of the contract award. (For questions or a copy of the BWC-337, please call the Worker's Compensation Bureau at 517-322-1195).
 - C. ☐ I certify my business has a Worker's Compensation Policy. I will provide an original Certificate of Insurance within twenty-one (21) days of the contract award.
3. If you have checked item 2(A) or 2(B), you **must** indicate the number of **both** full-time and part-time employees, other than yourself, including family members and active partners (if none, you must enter "0").

_____ Full-time Employees

_____ Part-time Employees

Name of Business		Federal ID (or) Social Security No.
Address		Telephone ()
City	State	ZIP

I hereby certify that the above information is true and correct. I agree to notify the Michigan DNR of any changes that occur in factors affecting my coverage during any of my present and future operations.

Signature of Owner or Authorized Representative

Title

Date

Please complete the "SEALED BID" information on the next page

Ice- Leonardo DeSaprio (72-014-25)

T28N, R02E, SEC. 4; T28N, R02E, SEC. 5; T28N, R02E, SEC. 6; T28N, R02E,

In response to the notice of sale to be held 9:00 a.m. (local time) on September 15, 2025, I am hereby submitting my sealed bid (firm offer) for the following forest products to be cut. Bids for individual species must be at or above the advertised price. All non-responsive bid forms may be rejected.

<u>PRODUCTS & SPECIES</u>	<u>ESTIMATED VOLUME*</u>	<u>ADVERTISED PRICE</u>	<u>BID PRICE/UNIT</u>
Pulpwood			
Black Cherry	56 Cords	\$ 13.95/Cord	\$ _____
Black/Red (Hybrid) Oak	13 Cords	\$ 10.05/Cord	\$ _____
Jack Pine	5,823 Cords	\$ 9.70/Cord	\$ _____
Northern Pin Oak	111 Cords	\$ 10.05/Cord	\$ _____
Quaking Aspen	439 Cords	\$ 10.70/Cord	\$ _____
Red Maple	53 Cords	\$ 13.95/Cord	\$ _____
Red Pine	21 Cords	\$ 19.05/Cord	\$ _____

*The volumes are statistically estimated within plus (+) or minus (-) 13.78 percent at 95% confidence level. These estimated volumes are final and not subject to adjustment. Prospective bidders are urged to examine this timber and to make their own estimates of quantity and quality.

I understand that any or all bids may be rejected. All bids must be signed and all bid items must be bid or the bid form may be rejected. I also understand that consideration and awarding a contract will be based upon my past performance and ability to complete the contract based upon equipment and staffing subject to my control.

FEDERAL ID: ____ - ____ - ____ or SOCIAL SECURITY NUMBER: ____ - ____ - ____
Company or individual bidding: _____
Company representative's name: _____
Address: _____
City: _____ State: _____ Zip: _____

IF AVAILABLE, PLEASE PLACE THE PERSONALIZED LABEL FROM YOUR PROSPECTUS IN THE ABOVE BOX.

Individual or company representative's signature: _____ Date: _____

Phone number : _____ Email (optional): _____

**THE WINNING BIDDER MUST COMPLETE THE VERIFICATION OF WORKER'S DISABILITY COMPENSATION ACT
COMPLIANCE (ON REVERSE SIDE IF DOUBLE SIDED) WITHIN 21 DAYS OF SALE AWARD DATE**



TIMBER SALE VERIFICATION OF WORKER'S DISABILITY COMPENSATION ACT COMPLIANCE

As required by Act 317, P.A. 1969 (Worker's Compensation) and
Part 5 of Act 451 of 1994, as amended.

FOR DEPARTMENT USE ONLY

Sale Number (XX - XXX - XX - XX)

Forest Management Unit:

VERIFICATION OF WORKER'S DISABILITY COMPENSATION ACT COMPLIANCE

- This verification must be completed and submitted within 21 days of contract award and prior to the issuance of the timber sale contract.
- In addition, if boxes 2B or 2C are checked, then Notice of Exclusion or Certificate of Insurance must be submitted within twenty-one (21) days of the contract award and prior to the issuance of the timber sale contract.
- All information must be typed or printed except for written signatures.

Please Check Appropriate Categories:

1. My business is organized as (you **must** check one of the boxes below):
 - A. ☐ Sole Proprietorship (individual)
 - B. ☐ Partnership
 - C. ☐ Corporation
2. You **must** check one of the boxes below:
 - A. ☐ I certify my business is a sole proprietorship and it has no employees but the sole proprietor. I am not subject to the Worker's Compensation Laws.
 - B. ☐ I certify my business has satisfied its obligation to the Worker's Compensation Act through the use of an approved Notice of Exclusion (BWC-337, Rev. 5/96). I will provide a copy of the Notice of Exclusion within 21 days of the contract award. (For questions or a copy of the BWC-337, please call the Worker's Compensation Bureau at 517-322-1195).
 - C. ☐ I certify my business has a Worker's Compensation Policy. I will provide an original Certificate of Insurance within twenty-one (21) days of the contract award.
3. If you have checked item 2(A) or 2(B), you **must** indicate the number of **both** full-time and part-time employees, other than yourself, including family members and active partners (if none, you must enter "0").

_____ Full-time Employees

_____ Part-time Employees

Name of Business		Federal ID (or) Social Security No.
Address		Telephone ()
City	State	ZIP

I hereby certify that the above information is true and correct. I agree to notify the Michigan DNR of any changes that occur in factors affecting my coverage during any of my present and future operations.

Signature of Owner or Authorized Representative

Title

Date

Please complete the "SEALED BID" information on the next page

Ice North Camp Barrens (72-617-25)

T27N, R02W, SEC. 15; T27N, R02W, SEC. 16; T27N, R02W, SEC. 21; T27N,

In response to the notice of sale to be held 9:00 a.m. (local time) on September 15, 2025, I am hereby submitting my sealed bid (firm offer) for the following forest products to be cut. Bids for individual species must be at or above the advertised price. All non-responsive bid forms may be rejected.

<u>PRODUCTS & SPECIES</u>	<u>ESTIMATED VOLUME*</u>	<u>ADVERTISED PRICE</u>	<u>BID PRICE/UNIT</u>
Pulpwood			
Jack Pine	2,019 Cords	\$ 7.70/Cord	\$ _____
Mixed Aspen	31 Cords	\$ 10.60/Cord	\$ _____
Mixed Hardwood	25 Cords	\$ 14.00/Cord	\$ _____
Northern Pin Oak	257 Cords	\$ 10.10/Cord	\$ _____

*The volumes are statistically estimated within plus (+) or minus (-) 10.82 percent at 95% confidence level. These estimated volumes are final and not subject to adjustment. Prospective bidders are urged to examine this timber and to make their own estimates of quantity and quality.

I understand that any or all bids may be rejected. All bids must be signed and all bid items must be bid or the bid form may be rejected. I also understand that consideration and awarding a contract will be based upon my past performance and ability to complete the contract based upon equipment and staffing subject to my control.

FEDERAL ID: ____ - ____ - ____ or SOCIAL SECURITY NUMBER: ____ - ____ - ____

Company or individual bidding: _____

Company representative's name: _____

Address: _____

City: _____ State: _____ Zip: _____

IF AVAILABLE, PLEASE PLACE THE PERSONALIZED LABEL FROM YOUR PROSPECTUS IN THE ABOVE BOX.

Individual or company representative's signature: _____ Date: _____

Phone number : _____ Email (optional): _____

**THE WINNING BIDDER MUST COMPLETE THE VERIFICATION OF WORKER'S DISABILITY COMPENSATION ACT
COMPLIANCE (ON REVERSE SIDE IF DOUBLE SIDED) WITHIN 21 DAYS OF SALE AWARD DATE**



TIMBER SALE VERIFICATION OF WORKER'S DISABILITY COMPENSATION ACT COMPLIANCE

As required by Act 317, P.A. 1969 (Worker's Compensation) and
Part 5 of Act 451 of 1994, as amended.

FOR DEPARTMENT USE ONLY

Sale Number (XX - XXX - XX - XX)

Forest Management Unit:

VERIFICATION OF WORKER'S DISABILITY COMPENSATION ACT COMPLIANCE

- This verification must be completed and submitted within 21 days of contract award and prior to the issuance of the timber sale contract.
- In addition, if boxes 2B or 2C are checked, then Notice of Exclusion or Certificate of Insurance must be submitted within twenty-one (21) days of the contract award and prior to the issuance of the timber sale contract.
- All Information must be typed or printed except for written signatures.

Please Check Appropriate Categories:

1. My business is organized as (you **must** check one of the boxes below):
 - A. ☐ Sole Proprietorship (individual)
 - B. ☐ Partnership
 - C. ☐ Corporation
2. You **must** check one of the boxes below:
 - A. ☐ I certify my business is a sole proprietorship and it has no employees but the sole proprietor. I am not subject to the Worker's Compensation Laws.
 - B. ☐ I certify my business has satisfied its obligation to the Worker's Compensation Act through the use of an approved Notice of Exclusion (BWC-337, Rev. 5/96). I will provide a copy of the Notice of Exclusion within 21 days of the contract award. (For questions or a copy of the BWC-337, please call the Worker's Compensation Bureau at 517-322-1195).
 - C. ☐ I certify my business has a Worker's Compensation Policy. I will provide an original Certificate of Insurance within twenty-one (21) days of the contract award.
3. If you have checked item 2(A) or 2(B), you **must** indicate the number of **both** full-time and part-time employees, other than yourself, including family members and active partners (if none, you must enter "0").

_____ Full-time Employees

_____ Part-time Employees

Name of Business		Federal ID (or) Social Security No.
Address		Telephone ()
City	State	ZIP

I hereby certify that the above information is true and correct. I agree to notify the Michigan DNR of any changes that occur in factors affecting my coverage during any of my present and future operations.

Signature of Owner or Authorized Representative

Title

Date

Please complete the "SEALED BID" information on the next page