



**DEPARTMENT OF NATURAL RESOURCES
STATE OF MICHIGAN
TIMBER SALE PROSPECTUS #7793**

SCHEDULED SALE DATE AND TIME: 9:00 a.m. (local time) on February 12, 2026.

LOCATION: ATLANTA MGMT UNIT, 13501 M 33, ATLANTA, MI 49709.

PROSPECTUS NOTE: The bidder is advised to inspect the sale area and review the location, estimated volumes, operating costs and contract terms of proposed sales. Please be aware that some landowners may request 60 days or more notice for access across their land.

Notice is hereby given that bids will be received by the Unit Manager, ATLANTA MANAGEMENT UNIT, for certain timber on the following described lands:

Rummaging Ruminant Aspen (54-001-26) / T31N, R01E, SEC. 10, NENW,NWNE.

T31N, R01E, SEC. 15, E1/2NW,NESW.

T31N, R01E, SEC. 16, SENW,NENE,SWNE,N1/2SW,NWSE.

T31N, R01E, SEC. 9 , SESE.

Montmorency County, Advertised Price \$44,697.55, 133.7 Acres, Aspen, Hardwood.

SALE NOTE: All stands contain some damage from the March 2025 Ice Storm. Stands were cruised accordingly and represent the current volume as is.

Oak Wilt Spec with no exceptions on Payment Unit 1 due to the confirmed presence of Oak Wilt within the unit. Because of this, Payment Unit 1 MUST be harvested first before any other units can be opened outside the Oak Wilt restriction period (April 15th - July 15th).

Overall good access and operating terrain. There will be NO extensions for this contract due to the multi management unit elk browse study.

A recreation site such as a trail, pathway, or campground is within the sale area or the vicinity. Certain restrictions/specifications may be applicable including time restrictions. Access may be through private or other public land.

Ice KW JP (54-006-26) / T32N, R02E, SEC. 22, NE,N1/2SE,SWSE.

T32N, R02E, SEC. 27, E1/2NW,W1/2NE,NESW,NWSE.

Montmorency County, Advertised Price \$193.70, 193.7 Acres, Jack Pine.

SALE NOTE: This sale is being sold by the acre due to borderline merchantability.

The Sale Area has received damage from Ice Storm in late March 2025. The Purchaser should harvest the wood as soon as possible.

This sale is adjacent to a young jack pine stand which may be used by the Kirtland's Warbler. See Sale Spec 5.8.1 for restrictions.

This is a 2-year contract. There will be no extensions granted on this contract.

A recreation site such as a trail, pathway, or campground is within the sale area or the vicinity. Certain restrictions/specifications may be applicable including time restrictions.

Ice James Rd Red Pine Salvage (54-008-26) / T31N, R05E, SEC. 23, N1/2NE.

Alpena County, Advertised Price \$4,652.55, 6.2 Acres, Red Pine.

SALE NOTE: -This is an ice storm damaged salvage sale. Refer to timber sale specs 2.1.11, 7.2.2, and 7.5.1 for details.

-The use of a feller buncher is not allowed for the protecting of regeneration. Refer to timber sale specs 2.2.6 and 3.4.1 for details.

-Any questions related to this ice storm damage salvage sale can be directed to MI DNR Forester Dale Parris at (989) 590-1204 or parrisd2@michigan.gov.

BID INSTRUCTIONS (VER. 10/10/2022):

1. Scheduled Bid Location, Date, and Time (2/11)

Bids must be received by the Unit Manager, ATLANTA OFFICE, 13501 M 33, ATLANTA, MI 49709, no later than 9:00 a.m. (local time) on February 12, 2026. For further information concerning this sale, contact Matt Foster at 989-619-5921 extension .

2. Bidder's Qualifications (10/22)

If all or part of a timber sale was prepared by a private contractor, the contractor and that contractor's company are not permitted to bid on the timber sale. A person must be 18 years of age or older to purchase timber. Permanent employees of the Department of Natural Resources or members of their immediate household may not bid. Former employees, in the permanent or seasonal class, may not bid until 3 months after the last day of active duty. Bids will not be accepted from individuals or companies appearing on the DNR/FRD No-Bid List. This list contains the names of purchasers who previously failed to execute a contract within 21-days or who have a history of poor performance.

3. Preparation of Sealed Bids (5/16)

Bid Forms may be completed online thru Michigan DNR Timber Sale Online Bidding (OLB) at www.michigan.gov/timberbidding or by completing the hardcopy Bid Form found in the Timber Sale Prospectus . Hardcopy Bid Forms shall be manually signed in ink. Registration in OLB is considered your 'signature' for all bids submitted thru that system. Bid prices must be entered for each species and product in the Bid Price column for all material subject to bidding and all fill-in blanks must be completed. If erasures or other changes appear on the hardcopy Bid Form, each erasure or change must be initialed by the person signing the bid.

4. Submission of Sealed Bids (5/16)

Bid forms may be obtained from the Unit Manager or thru OLB. Bids may be submitted hardcopy or thru OLB. All hardcopy bids must be submitted on the bid form and in an envelope clearly identified as described in this section. NOTE: Only one bid form per bid envelope. Sealed bids must be submitted to the Unit office designated in the prospectus and must be submitted at or prior to the time established in the prospectus. The envelope should show on the outside (a) the sale name or number and (b) the date and time of bid opening, as shown in the prospectus. Bids received after the time specified in the sale prospectus are late bids and will be rejected.

It is possible for a bidder to submit multiple bids on a single sale. For example, a bid may be submitted hardcopy and a bid may be submitted thru OLB. Or, two bidders from the same company could both submit bids on the same sale. If this were to happen, the State would accept all bids received and award the contract accordingly. All bidding and contractual requirements would apply to all bids received.

5. Public Opening of Sealed Bids (7/16)

If conditions permit, the sealed bids will be publicly opened and posted at the time and place set in the prospectus.

If a bidder, present at a bid opening, has submitted bids on more than one sale, that bidder may withdraw their unopened bid envelopes or announce the withdrawal of their online bid after being declared the successful bidder on one sale.

6. Award of Contract (1/11)

Award of the contract will be made to the Bidder whose bid, conforming to the prospectus, is most advantageous to the State of Michigan on the basis of total value at rates bid for the estimated quantities. The State reserves the right to reject any bid or waive any minor irregularity in bids received. A written award mailed (or otherwise furnished) to the successful Bidder shall be deemed to result in a binding contract without further action by either party.

7. Down Payment (1/11)

The Bidder to whom award is made must make a down payment within 21 days of the sale award. The amount of the down payment will be calculated as shown in the Bond and Payment Schedule of this prospectus. Only cash may be used to meet this requirement.

8. Performance Security (1/11)

As guarantee of faithful performance, a cash bond, certificate of deposit, surety bond or irrevocable letter of credit (LOC) is required within 21 days of the sale award. The amount of the performance security is shown in the Bond and

Payment Schedule of this prospectus. If an LOC or surety is used, the coverage must extend for at least 6 months beyond the contract expiration.

9. Worker's Compensation (10/22)

Purchaser shall obtain worker's compensation insurance to cover claims under Michigan's Worker's Disability Compensation Act of 1969 or similar employee benefit act of any other state applicable to an employee. Verification of Worker's Disability Compensation Act Compliance must be completed and submitted within 21 days of contract award and prior to the issuance of the timber sale contract. In addition, if applicable, Notice of Exclusion or Certificate of Insurance must also be submitted.

10. Timber Sale Contract (10/22)

Additional conditions and requirements common to all timber sales are listed on the timber sale contract (R4031) and are available on line at www.michigan.gov/timber. Contact the Unit Manager for additional information or a sample contract. Within 21 days of the date of the award letter, the bidder must sign the contract and provide the required down payment, performance security, and verification of worker's disability compensation. The down payment and performance security shall be in accordance with the provisions of the timber sale contract, in the sums stated in this prospectus. If these actions are not taken, then the Bidder, the Bidder's corporation, and the corporation's principals may not be permitted to bid on State timber sales for a period of 3 months after the first offense, 6 months after the second offense, and 1 year after the third offense. An offense will only be counted against the Bidder for 5 years. In addition, the Bidder certifies that if awarded this contract, the Bidder will complete the timber sale contract in accordance with its terms and any modifications thereof including requirements to purchase, cut, and remove the included timber by the expiration date.

Payment Unit values in the State Forest Timber Sale Contract are calculated based on the advertised value of the Payment Unit as a percentage of the total advertised value of the contract. The advertised value of each Payment Unit is given in the Description of Timber by Payment Unit table on the Timber Sale Information page. For example, if the value of Payment Unit 1 is advertised as \$1,500 and the total Timber Sale value is advertised as \$10,000, the contract price for Payment Unit 1 will be 15% of the total bid price ($\$1,500/\$10,000 * 100$).

11. Disclaimer of Estimates and Bidder's Warranty of Inspection (10/22)

Before submitting this bid, the Bidder is advised and cautioned to inspect the sale area, review the requirements of the sale contract, and take other steps as may be reasonably necessary to ascertain the location, estimated volumes, construction estimates, and operating costs of the proposed sale. Failure to do so will not relieve the Bidder from responsibility for completing the contract.

The Bidder warrants that this bid is submitted solely on the basis of the Bidder's examination and inspection of the quality and quantity of the timber offered for sale and the Bidder's opinion of the value thereof and the costs of recovery. No reliance should be placed on the State of Michigan's estimates of timber quality, quantity or costs of recovery. Bidder further acknowledges that the State of Michigan: (i) expressly disclaims any warranty of fitness of timber for any purpose; (ii) offers this timber as is without any warranty of quality (merchantability) or quantity and (iii) expressly disclaims any warranty as to the quantity or quality of timber sold.

12. Certification and Chain-of-Custody (10/22)

Unless otherwise indicated in the contract under section 7 – Other Conditions of the Sale Specific Conditions & Requirements, the area encompassed by this timber sale is certified to the standards of the Forest Stewardship Council (FSC) - Certificate #SCS-FM/COC-00090N and the Sustainable Forestry Initiative (SFI) - Certificate #NSF-SFIS-5Y031-SF5. Forest products from this sale may be delivered to the mill as "FSC 100% and / or SFI certified" as long as the contractor hauling the forest products is chain-of-custody (COC) certified or covered under a COC certificate from the destination mill. The purchaser is responsible for maintaining COC after leaving the sale area.

13. Good Neighbor Authority (GNA) Requirements (10/22)

If the name of this timber sales contains the acronym GNA, it is authorized by the Good Neighbor Authority (GNA) and covered by various agreements between the U.S. Forest Service and the State. The timber sale occurs on federal land and the following conditions apply:

GNA contracts on US Forest Service land will not be awarded to purchasers on the Federal list of excluded parties. The System for Award Management (SAM) will be checked for active excluded parties prior to award of contract. In

addition, the Bidder to whom award is made must complete an Assurance Regarding Felony Conviction or Tax Delinquent Status for Corporate Applicants (AD-3031).

14. Good Neighbor Authority (GNA) Requirements, con't (10/22)

Bidder certifies, by signing this bid form, that to the best of Bidder's knowledge that the following representations are accurate and complete.

- a. That the Bidder and its principals are not presently debarred, suspended, proposed for debarment, declared ineligible, or voluntary excluded from timber sales (covered transactions) by any Federal department or agency.
- b. That the Bidder and its principals have not within a 3-year period preceding this bid been convicted of or had a civil judgment rendered against them for commission of fraud or a criminal offense in connection with obtaining , attempting to obtain, or performing a public (Federal, State, or local) transaction or contract under a public transaction; violation of Federal or State antitrust statutes or commission of embezzlement, theft, forgery, bribery, falsification or destruction of records, making false statements, or receiving stolen property.
- c. That the Bidder and its principals are not presently indicted for or otherwise criminally or civilly charged by a governmental entity (Federal, State, or local) with commission of any of the offenses enumerated in paragraph b of this certification.
- d. That the Bidder and its principals have not within a 3-year period preceding this bid had one or more public transactions (Federal, State, or local) terminated for breach or default of a timber or forest product contract.

Bidders that cannot certify this requirement, in whole or in part, shall submit an explanation with their bid.

Scott Bowen
Director

TIMBER SALE INFORMATION

Rummaging Ruminant Aspen (54-001-26)

T31N, R01E, SEC. 10; T31N, R01E, SEC. 15; T31N, R01E, SEC. 16; T31N, R01E, SEC. 9.

Montmorency County (Advertised Price \$44,697.55)

SALE NOTE: All stands contain some damage from the March 2025 Ice Storm. Stands were cruised accordingly and represent the current volume as is.

Oak Wilt Spec with no exceptions on Payment Unit 1 due to the confirmed presence of Oak Wilt within the unit. Because of this, Payment Unit 1 MUST be harvested first before any other units can be opened outside the Oak Wilt restriction period (April 15th - July 15th).

Overall good access and operating terrain. There will be NO extensions for this contract due to the multi management unit elk browse study.

A recreation site such as a trail, pathway, or campground is within the sale area or the vicinity. Certain restrictions/specifications may be applicable including time restrictions. Access may be through private or other public land.

A timber sale contract for this lump sum, sealed bid timber sale will be awarded to the responsible bidder offering the highest sealed bid price. All units of volume listed below were estimated using the Inventory Manager computer program and the new Michigan taper model. Bids must be at or above the following advertised price for each product and species:

<u>PRODUCTS & SPECIES</u>	<u>ESTIMATED UNITS*</u>	<u>ADVERTISED PRICE</u>
Sawtimber		
Basswood	8.1 MBF	\$ 28.00 / MBF
Red Maple	6.5 MBF	\$ 28.00 / MBF
Red Oak	103.6 MBF	\$ 100.00 / MBF
Red Pine	21.5 MBF	\$ 53.00 / MBF
Sugar Maple	20.4 MBF	\$ 118.00 / MBF
White Pine	4.6 MBF	\$ 36.00 / MBF
Pulpwood		
Balsam Fir	3 Cords	\$ 9.80 / Cord
Basswood	71 Cords	\$ 11.20 / Cord
Mixed Aspen	2,660 Cords	\$ 8.10 / Cord
Mixed Hardwood	447 Cords	\$ 10.20 / Cord
Paper Birch	7 Cords	\$ 7.40 / Cord
Red Oak	167 Cords	\$ 17.05 / Cord
Red Pine	12 Cords	\$ 26.60 / Cord
White Pine	6 Cords	\$ 11.35 / Cord

* The total volume is statistically estimated within plus (+) or minus (-) 13.67 percent. There are an estimated 3,760 cords on this timber sale, plus or minus 514 cords at the 95% confidence level. The estimated units are final and not subject to adjustment. Prospective bidders are urged to examine this timber and to make their own estimates of quantity and quality.

BOND AND PAYMENT SCHEDULE:

1. A bond in the amount of \$2,235.00 to insure faithful performance of the conditions of the contract will be deposited by the successful bidder within 21 days of the sale award.
2. Cutting in any sale or unit without the required advance payment would be considered a trespass.
3. Total payment must be paid in advance or according to the following schedule :
 - (a) Ten percent (10%) of the sale value must be paid within 21 days of the sale award.
 - (b) The 10% down payment will be credited towards the first unit cut.
 - (c) Payment for each of the following units must be made before cutting begins in that unit:

<u>PAYMENT UNIT NUMBER</u>	<u>PERCENT OF TOTAL SALE VALUE</u>
01	12.4%
02	19.2%
03	19.2%
04	7.6%
05	8.4%
06	9.9%
07	23.3%

4. If no cutting takes place, the 10% down payment will not be refunded.
5. Operations on the contract issued will terminate on 06/30/2028.

SALE STATISTICS

Volumes were calculated in cubic feet using the Michigan taper model. Cubic foot volume includes all wood inside bark for the product indicated. For display purposes, cubic feet were converted to cords and MBF using a simple conversion factor, e.g. 79 cubic feet per cord and 185 cubic feet per MBF. The cubic foot volumes are precise; the cords and MBF volumes are not. Cubic foot volume cannot be directly converted to cords or boards with precision.

SALE VOLUMES

The total estimated sale volume may not equal the sum of the species/products due to the nature of statistical calculations associated with double sampling methodology.

VOLUME			STATISTICAL RANGE IN CORDS	
TOTAL CUBIC FEET	TOTAL CORDS	PERCENT ERROR	MINIMUM	MAXIMUM
297,044	3,760	13.67%	3,246	4,274

VDU VOLUMES

A VDU is a Volume Determination Unit. Volumes and their associated statistics are calculated at the VDU level and summarized to the sale level. There is often a one to one relationship between a VDU and a Payment Unit, but not always, depending on the cruise design. Refer to the VDU TO PAYMENT UNIT table.

	VOLUME			RANGE IN CORDS	
VDU	TOTAL CUBIC FEET	TOTAL CORDS	PERCENT ERROR	MINIMUM	MAXIMUM
5	12,398	157	71.77%	44	270
22	21,740	275	44.94%	152	399
23	142,044	1,798	21.62%	1,409	2,187
71	27,012	342	38.47%	210	473
80	13,176	167	44.81%	92	242
83	27,717	351	51.08%	172	530
103	18,690	237	43.37%	134	339
108	34,266	434	44.14%	242	625
TOTAL:	297,044	3,760		2,455	5,065

VDU TO PAYMENT UNIT

When a VDU is associated with more than one Payment Unit (PU), the VDU volumes are assigned to the PU based on acres of the VDU within the PU.

VDU	VDU ACRES	PU	PU ACRES
TOTAL:			

DESCRIPTION OF TIMBER BY PAYMENT UNIT (PU)

PU	MARKET GROUP	PRODUCT	QUANTITY	UNIT	ACRES	ADVERTISE PRICE
1	Red Oak	Sawtimber	47.8	MBF	5.6	\$5,547.25
	Red Oak	Pulpwood	45	Cords		
2	Red Oak	Sawtimber	11.3	MBF	29.8	\$8,601.95
	Red Pine		10.3	MBF		
	White Pine		2.2	MBF		
	Mixed Aspen	Pulpwood	718	Cords		
	<i>B. T. Aspen</i>		605	Cords		
	<i>Quaking Aspen</i>		113	Cords		
	Mixed Hardwood		73	Cords		
	<i>Red Maple</i>		67	Cords		
	<i>Sugar Maple</i>		6	Cords		
	Red Oak		9	Cords		
	Red Pine		5	Cords		
3	Red Oak	Sawtimber	11.2	MBF	29.7	\$8,592.15
	Red Pine		10.3	MBF		
	White Pine		2.2	MBF		
	Mixed Aspen	Pulpwood	716	Cords		
	<i>B. T. Aspen</i>		603	Cords		
	<i>Quaking Aspen</i>		113	Cords		
	Mixed Hardwood		72	Cords		
	<i>Red Maple</i>		66	Cords		
	<i>Sugar Maple</i>		6	Cords		
	Red Oak		9	Cords		
	Red Pine		6	Cords		
4	Red Maple	Sawtimber	6.5	MBF	18.7	\$3,415.70
	Red Oak		4.4	MBF		
	Red Pine		0.9	MBF		
	White Pine		0.2	MBF		
	Balsam Fir	Pulpwood	3	Cords		
	Mixed Aspen		293	Cords		
	<i>B. T. Aspen</i>		168	Cords		
	<i>Quaking Aspen</i>		125	Cords		
	Mixed Hardwood		27	Cords		
	<i>Red Maple</i>		26	Cords		
	<i>Sugar Maple</i>		1	Cords		
	Red Oak		2	Cords		
	Red Pine		1	Cords		
5	Red Oak	Sawtimber	8.9	MBF	6.3	\$3,755.20
	Sugar Maple		5.5	MBF		
	Mixed Aspen	Pulpwood	115	Cords		
	<i>B. T. Aspen</i>		115	Cords		
	Mixed Hardwood		29	Cords		
	<i>Red Maple</i>		14	Cords		
	<i>Sugar Maple</i>		15	Cords		
	Red Oak		58	Cords		
6	Red Oak	Sawtimber	6.9	MBF	11.4	\$4,434.90
	Basswood	Pulpwood	19	Cords		
	Mixed Aspen		281	Cords		
	<i>B. T. Aspen</i>		239	Cords		
	<i>Quaking Aspen</i>		42	Cords		
	Mixed Hardwood		98	Cords		
	<i>Ironwood</i>		4	Cords		
	<i>Sugar Maple</i>		88	Cords		
	<i>White Ash</i>		6	Cords		
	Paper Birch		7	Cords		
	Red Oak		12	Cords		

DESCRIPTION OF TIMBER BY PAYMENT UNIT (PU), CON'T

PU	MARKET GROUP	PRODUCT	QUANTITY	UNIT	ACRES	ADVERTISE PRICE
7	Basswood	Sawtimber	8.1	MBF	32.2	\$10,350.40
	Red Oak		13.1	MBF		
	Sugar Maple		14.9	MBF		
	Basswood	Pulpwood	52	Cords		
	Mixed Aspen		537	Cords		
	<i>B. T. Aspen</i>		286	<i>Cords</i>		
	<i>Quaking Aspen</i>		251	<i>Cords</i>		
	Mixed Hardwood		148	Cords		
	<i>Black Cherry</i>		11	<i>Cords</i>		
	<i>Ironwood</i>		19	<i>Cords</i>		
	<i>Sugar Maple</i>		118	<i>Cords</i>		
	Red Oak		32	Cords		
	White Pine		6	Cords		
TOTAL:			164.7	MBF		
TOTAL:			3,373	Cords		

Sale Specific Conditions & Requirements

Sale Name: Rummaging Ruminant Aspen

Sale Number: 54-001-26 Seq#: 2

1 - Sale Area

1.2 - Boundaries

1.2.1 - Painted Boundaries (9/19)

The sale boundary and Payment Unit boundaries are marked and identified by blue, purple, red and yellow paint or are unmarked and identified by a road. Exterior sale boundary lines against private property are marked with blue paint.

Within Payment Unit 1, exterior sale boundary lines against state are marked with purple paint. Within Payment Units 2-7, exterior sale boundary lines against state are marked with red paint. The east boundary of Payment Unit 7 is unpainted and designated as Camp 30 Rd.

Interior Payment Unit boundaries are marked with yellow paint. The Payment Unit lines between units 2 & 3, and 3 & 4 are unpainted and designated as the forest roads. Retention patches are marked with red paint; no harvesting activities may occur within these areas.

The painted boundary line trees are not Included Timber with the exception:

- Within Payment Unit 1, any painted oak boundary trees are to be cut
- Within Payment Unit 7, any painted aspen boundary trees are to be cut.

Yellow painted trees designating an interior Payment Unit boundary are only to be cut when all surrounding Payment Units have been paid.

2 - Timber Specifications

2.1 - Included Timber

2.1.1 - Clearcut Unit(s) with Unmerchantable Trees (6/14)

Within Payment Unit(s) 2-7, cut all trees that are two (2) inches or more at DBH, except do not cut any trees marked with green paint. In addition, within Payment Unit 4, do not cut any red or white pine.

2.1.4 - Designated Timber Unit(s) (6/17)

Within Payment Unit(s) 1, all oak are designated for cutting regardless of merchantability. This will include harvesting of dead oak trees (no live crown, peeling/missing bark). Contact the Sale Administrator if other trees need to be harvested for operability purposes.

2.1.14 - Dead Oak (12/24)

Dead oak (defined as loose bark and no live branches) may be cut throughout the Sale Area. If cut, it must be skid and piled separately on the landing. The Sale Administrator will measure the dead oak, and the wood cannot be hauled prior to scaling. The Purchaser will be invoiced at \$5.00 per cord. The Purchaser has 30 days from the date of the invoice to pay. This will only apply to Payment Unit 1.

3 - Payments

3.3 - Pre-measured Sales

3.3.4 - Dividing Payment Units (7/14)

Payment Unit(s) with a value of \$25,000 or greater may be divided at the request of the Purchaser and upon approval of the Unit Manager. Dividing Payment Units is a contract modification which requires a Timber Sale Contract Amendment. There will be only one division per Payment Unit.

3.4 - Damaged Timber

3.4.1 - Damaged Timber (12/24)

General Condition and Requirement 3.4 Damaged Timber, defines liquidated damages for undesigned live merchantable

trees which are cut or injured. In addition, extreme care should be taken to avoid damage to tree seedlings and saplings.

Within Payment Units 2, 3 & 5, if more than 50% of the tree seedlings or saplings (1/4" to 2" DBH) within a specified portion of the Sale Area are damaged, liquidated damages will be assessed at \$500 per acre for all acreage within that specified portion of the Sale Area that was damaged.

No damage is acceptable to undesignated live merchantable trees. Within the Sale Area, if more than 5% of trees (> 4.5" DBH) within a specified area of the sale are damaged, liquidated damages will be assessed for all trees damaged. Rates will be in accordance with General Condition and Requirement 3.4 Damaged Timber.

3.6 - Payment Unit Cutting Schedule

3.6.1 - Order of Cutting (1/09)

Payment Unit 1 must be harvested first before any other unit is opened outside of the oak wilt restriction period (April 15 to July 15). No exceptions. Also, all wood on the landing for Payment Unit 1 must be hauled within 30 days of harvesting.

4 - Transportation

4.1 - Construction

4.1.3 - Slash and Earthen Piles (8/04)

Piles or windrows of earth along roads and landings that have been widened or constructed shall be leveled. Slash from road maintenance or construction, including stumps, shall be dispersed throughout the sale, chipped, utilized or otherwise removed from the sale.

4.1.6 - Road Construction (4/24)

Improvements of existing roads shall be done in such a way as to minimize the environmental and visual impacts.

Merchantable trees shall be cut and utilized unless otherwise directed. Non-merchantable trees shall be severed and laid flat on the ground. Slash shall be chipped, utilized or otherwise removed from the sale. Stumps shall be set upright, not left on edge, and be moved at least 10 feet away from the road edge. Disturbed soil shall be feathered into the woods and not left in berms or windrows.

4.1.11 - Permits (2/12)

The Purchaser will secure any necessary permits that may be required.

4.1.12 - No New Roads (1/12)

No new roads will be permitted in any Payment Unit. All operations are limited to existing roads. Only skid trails and landings will be allowed.

4.2 - Maintenance

4.2.2 - Fill Material (4/07)

To maintain roads, fill material may be needed in areas where "holes" exist or may be expected to develop. This fill material should be placed before trucking begins. Note: Elkview Trl is not a county road and is designated as a forest road. Fill/gravel may be required for hauling if deemed necessary by Sale Administrator.

4.4 - Access

4.4.3 - Access gate (12/08)

Access into Payment Unit 1 is through a locked gate through private property. This gate must be locked at the completion of each day unless otherwise approved by the Unit Manager or his/her representative.

If harvesting occurs between October 1 & December 31, the gate may be required to be locked at all times.

5 - Operations

5.1 - Notification

5.1.3 - Well Heads and Natural Gas Pipelines (11/15)

The Purchaser is responsible for contacting the gas or pipeline company 14 days prior to operating equipment in the vicinity of well heads or natural gas pipelines. It is not required but recommended to contact MISS DIG for the location and depth of

buried utility lines.

5.1.4 - Post-Sale Conference (10/16)

A post-sale conference on site between the Purchaser and sale administrator is required 5 days prior to the completion of active logging operations to determine clean-up and repair of landings, road edges, and the fulfillment of other contract specifications.

5.2 - Conduct of Operations

5.2.1 - Slash

5.2.1.8 - Slash Height (12/08)

No slash or tree tops may exceed 24 inches in height.

5.2.1.10 - No Slash in Openings (5/10)

No brush or logging debris is to be left in the maintained wildlife opening which is indicated by G or U on the Timber Sale Map. Any damage to the opening shall be repaired according to specifications of the Unit Manager or his/her representative. These areas may be used for landings but will be required to be restored at the Sale Administrator's discretion.

5.2.2 - Hazard Trees/Snags

5.2.2.1 - Den Trees (10/16)

Obvious hollow and/or den trees shall be protected and left standing unless they are a safety hazard.

5.2.3 - Operating Restrictions

5.2.3.4 - Oak Wilt Restriction, No Exceptions (1/18)

Within Payment Unit 1, cutting, skidding, hauling within the sale and brushing of access roads to the sale are not permitted during the period of April 15 to July 15. No exceptions will be granted. This is necessary to reduce the spread of oak wilt.

5.2.4 - Dead and Down Creation

5.2.4.4 - Dead and Down Creation, Grouse (6/18)

To encourage grouse and other wildlife, in Payment Unit(s) 2-7, leave one 12" or larger diameter (or largest diameter trees within stand) whole tree on the ground for every two (2) acres, preferably a hardwood species such as oak or maple or if no hardwoods are present, a pine species (white or red). These trees will be evenly scattered throughout the Payment Unit, preferably at least two chains from any roads, two-tracks, or trails open to vehicles. This can be an unmerchantable piece or a full tree.

5.2.32 - Decking/Landing Restoration (9/13)

All decking and landing areas must have the surface area restored to a condition equal to or better than before. This is to ensure the proper regeneration of the stand. Wood debris, chips and "cookies" from trimmings must be removed or scattered away from landing and loading areas and may not be windrowed on the edge.

5.2.38 - No Decking Against Live Trees (2/04)

Cut products may not be decked against unmarked or designated leave trees.

5.2.40 - Pathway Protection (10/10)

The High Country Pathway is a non-motorized trail that runs through Payment Units 2, 3 & 5. It is shown on the Timber Sale Map. Do not cut or damage posts with blue pathway markers. Any trees with the blue pathway markers can be cut above the blue mark. Maintain a 20-foot-wide slash, debris, and rut free zone daily, using the pathway as the centerline. Do not run equipment down the pathway. Skidding across the trail within Payment Units 2 & 3 will be limited to 2-3 crossings per unit. Skidding across the trail within Payment Unit 5 will be limited to 1 crossing. If any damage to the trail occurs from harvesting operations, the Purchaser will be required to clear, fix, repair and/or re-establish the trail as needed.

5.8 - Protection of Endangered Species

5.8.5 - Protection of Raptor Nests (3/13)

All trees with raptor nests will be protected if found during harvesting operations. Notification will be made to the Unit Manager or his/her representative who will notify the Wildlife Biologist so an onsite evaluation and recommendation can be

made, if necessary.

6 - Safety and Fire Prevention

6.2 - Signing

6.2.1 - Road Posting (10/20)

The Purchaser is responsible for posting and maintaining caution signs on Elkview Trl prior to beginning operations. The road must be posted at appropriate distances from the Sale Area to warn of logging activity and truck traffic. Signs must be removed when harvest operations are suspended or completed. The Purchaser will provide these signs.

6.2.3 - Recreational Trail Posting (10/20)

The Purchaser is responsible for posting and maintaining caution signs on the High Country Pathway prior to beginning operations. The trail must be posted at appropriate distances from the Sale Area to warn of logging activity and truck traffic at both ends of the trail. Signs must be removed when harvest operations are suspended or completed. The Purchaser will provide these signs.

7 - Other Conditions

7.2 - Extensions

7.2.2 - No Extensions (3/09)

There will be no extensions granted on this contract due to this sale being a part of a large scale Elk management/forest regeneration project.

**TIMBER SALE MAP**

This information provided by authority of Part 525, 1994 PA 451, as amended.

Sale Number

54-001-26

Date

10/22/2025

Forest Management Unit

Atlanta Mgt Unit

County

Montmorency

Mapped By: Kubitskey

Cruised By: Kubitskey

Scale

1:10,000

Page

1

Of

2Township
31NRange
01ESection(s) and SESE;
Subdivision(s)

Sec. 10 NENW,NWNE; Sec. 15 E1/2NW,NESW; Sec. 16 SENW,NENE,SWNE,N1/2SW,NWSE; Sec. 9

Cover Type

A = Aspen	J = Jack Pine	O = Oak	U = Upland Brush
B = Paper Birch	K = Rock	P = Lowland Poplar	UM = Upland Mix Forest
C = Cedar	L = Lowland Brush	Q = Mixed Swamp Conifer	V = Bog or Marsh
D = Treed Bog	LM = Lowland Mix Forest	R = Red Pine	W = White Pine
E = Swamp Hardwoods	M = Maple, Beech, Birch	S = Black Spruce	X = Non Stocked
F = Spruce/Fir	MC = Mixed Conifer	T = Tamarack	Y = Sand
G = Grass	MD = Mixed Deciduous	Z = Water	
H = Hemlock	N = Marsh		

Density

0 = Non Stocked	5 = Pole Timber Medium
1 = Seedling Sapling Poor	6 = Pole Timber Well
2 = Seedling Sapling Medium	7 = Saw Timber Poor
3 = Seedling Sapling Well	8 = Saw Timber Medium
4 = Pole Timber Poor	9 = Saw Timber Well

Payment Unit Number	Acres	Payment Unit Number	Acres
1	5.6	5	6.3
2	29.8	6	11.4
3	29.7	7	32.2
4	18.7		

Rummaging Ruminant Aspen**133.7 Acres**

Access to this unit is through a locked gate on Private Property at the end of Growler Club. The DNR does have a management easement through the property so access is already acquired.

LAT/LONG for Unit 1: 84.2965200°W
45.0969606°N

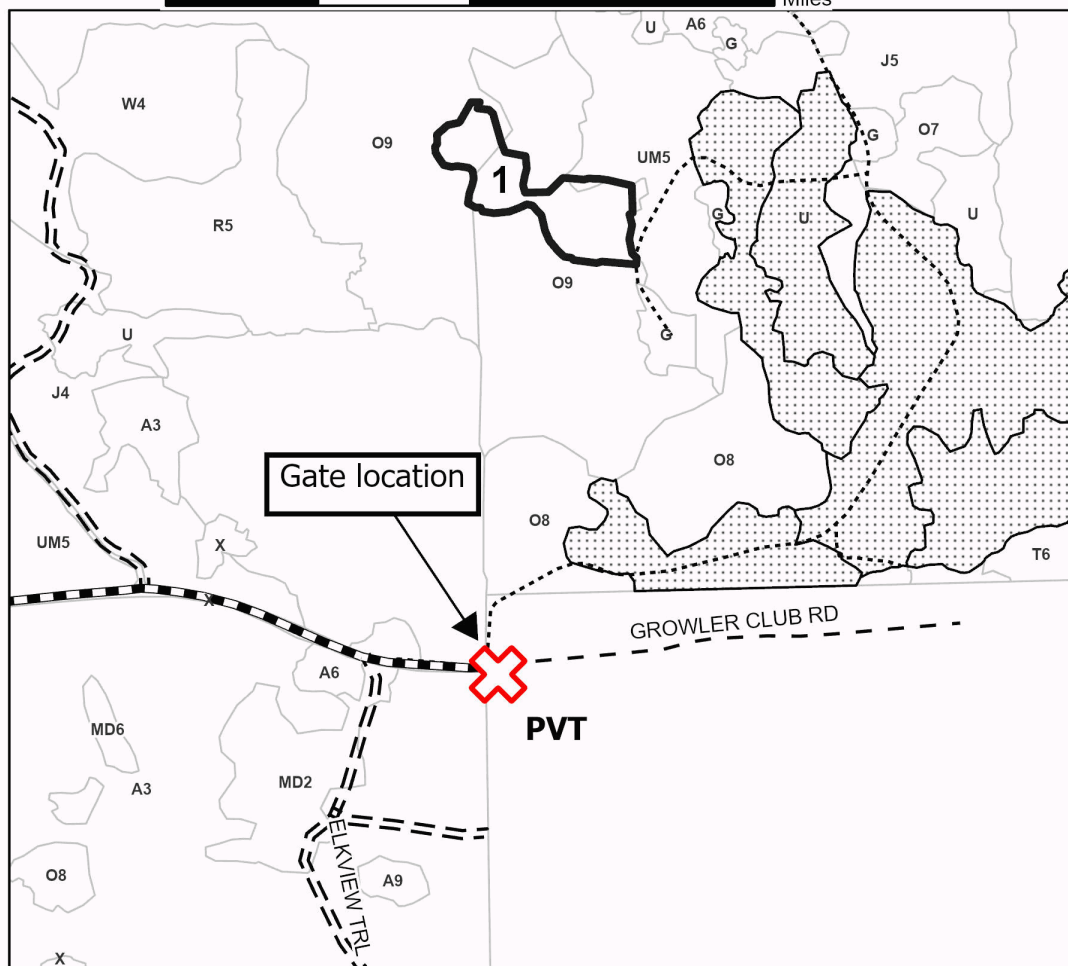

0 0.13 0.25 0.5 Miles

**Legend**

- Against State (Purple)
- Forest Access Route
- Administrative Access Only
- Government Gravel/Dirt
- Private Gravel/Dirt
- Recreational Trails
- Nearby Timber Sale
- Retention Areas

Scan here for cruise data & Avenza map





TIMBER SALE MAP

This information provided by authority of Part 525, 1994 PA 451, as amended.

Sale Number

54-001-26

Date

10/22/2025

Forest Management Unit

County

Mapped By: Kubitskey

Scale

1:15,840

Page

2

Of

2

Atlanta Mgt Unit

Montmorency

Cruised By: Kubitskey / Neff

Township
31N

Range
01E

Section(s) and SESE;
Subdivision(s) Sec. 10 NENW,NWNE; Sec. 15 E1/2NW,NESW; Sec. 16 SENW,NENE,SWNE,N1/2SW,NWSE; Sec. 9

Cover Type

A = Aspen	J = Jack Pine	O = Oak	U = Upland Brush
B = Paper Birch	K = Rock	P = Lowland Poplar	UM = Upland Mix Forest
C = Cedar	L = Lowland Brush	Q = Mixed Swamp Conifer	V = Bog or Marsh
D = Treed Bog	LM = Lowland Mix Forest	R = Red Pine	W = White Pine
E = Swamp Hardwoods	M = Maple, Beech, Birch	S = Black Spruce	X = Non Stocked
F = Spruce/Fir	MC = Mixed Conifer	T = Tamarack	Y = Sand
G = Grass	MD = Mixed Deciduous	Z = Water	
H = Hemlock	N = Marsh		

Density

0 = Non Stocked	5 = Pole Timber Medium
1 = Seedling Sapling Poor	6 = Pole Timber Well
2 = Seedling Sapling Medium	7 = Saw Timber Poor
3 = Seedling Sapling Well	8 = Saw Timber Medium
4 = Pole Timber Poor	9 = Saw Timber Well

Locator Map 1:100,000

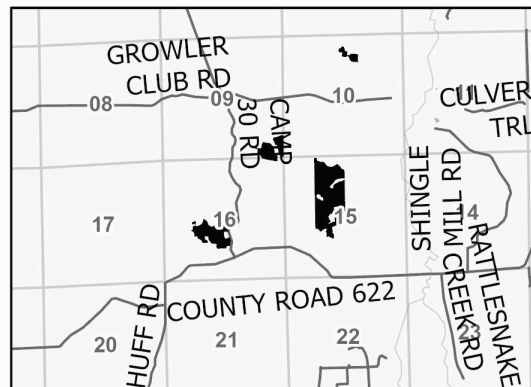

Rummaging Ruminant Aspen

133.7 Acres

Payment Unit Number	Acres	Payment Unit Number	Acres
1	5.6	5	6.3
2	29.8	6	11.4
3	29.7	7	32.2
4	18.7		

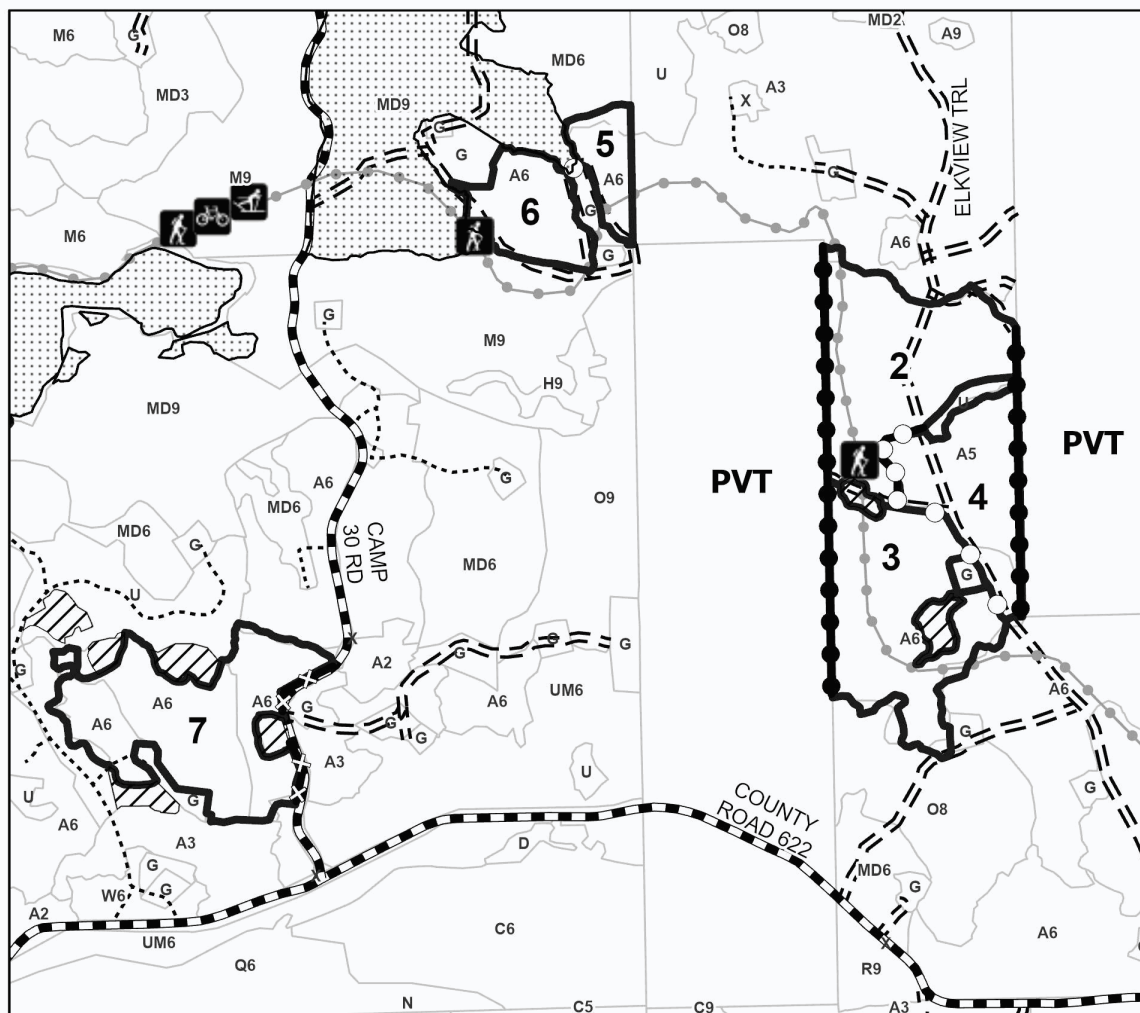
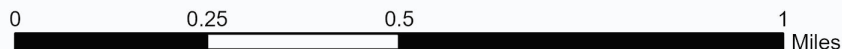

Legend

- Against State (Red)
- Against State (Unpainted)
- Private Line (Blue)
- Payment Unit (Yellow)
- Payment Unit (Road)
- Recreational Trails
- Forest Access Route
- Administrative Access Only
- Government Gravel/Dirt
- Nearby Timber Sale
- Retention Areas

Scan here for cruise data & Avenza map



TIMBER SALE INFORMATION

Ice KW JP (54-006-26)

T32N, R02E, SEC. 22; T32N, R02E, SEC. 27.
Montmorency County (Advertised Price \$193.70)

SALE NOTE: This sale is being sold by the acre due to borderline merchantability.

The Sale Area has received damage from Ice Storm in late March 2025. The Purchaser should harvest the wood as soon as possible.

This sale is adjacent to a young jack pine stand which may be used by the Kirtland's Warbler. See Sale Spec 5.8.1 for restrictions.

This is a 2-year contract. There will be no extensions granted on this contract.

A recreation site such as a trail, pathway, or campground is within the sale area or the vicinity. Certain restrictions/specifications may be applicable including time restrictions.

A timber sale contract for this lump sum, sealed bid timber sale will be awarded to the responsible bidder offering the highest sealed bid price. All units of volume listed below were estimated using the Inventory Manager computer program and the new Michigan taper model. Bids must be at or above the following advertised price for each product and species:

<u>PRODUCTS & SPECIES</u>	<u>ESTIMATED UNITS*</u>	<u>ADVERTISED PRICE</u>
Pulpwood		
Misc. Species 1	193.7 Acres	\$ 1.00 / Acre

* The total volume is statistically estimated within plus (+) or minus (-) 41.08 percent. There are an estimated 417 cords on this timber sale, plus or minus 171 cords at the 95% confidence level. The estimated units are final and not subject to adjustment. Prospective bidders are urged to examine this timber and to make their own estimates of quantity and quality.

BOND AND PAYMENT SCHEDULE:

1. A bond in the amount of \$1,000.00 to insure faithful performance of the conditions of the contract will be deposited by the successful bidder within 21 days of the sale award.
 2. Cutting in any sale or unit without the required advance payment would be considered a trespass.
 3. Total payment must be paid in advance or according to the following schedule :
 - (a) Ten percent (10%) of the sale value must be paid within 21 days of the sale award.
 - (b) The remainder is due before cutting begins.
 - (c) Payment for each of the following units must be made before cutting begins in that unit:
- | <u>PAYMENT UNIT NUMBER</u> | <u>PERCENT OF TOTAL SALE VALUE</u> |
|----------------------------|------------------------------------|
| 01 | 100.0% |
4. If no cutting takes place, the 10% down payment will not be refunded.
 5. Operations on the contract issued will terminate on 03/31/2028.

SALE STATISTICS

Volumes were calculated in cubic feet using the Michigan taper model. Cubic foot volume includes all wood inside bark for the product indicated. For display purposes, cubic feet were converted to cords and MBF using a simple conversion factor, e.g. 79 cubic feet per cord and 185 cubic feet per MBF. The cubic foot volumes are precise; the cords and MBF volumes are not. Cubic foot volume cannot be directly converted to cords or boards with precision.

SALE VOLUMES

The total estimated sale volume may not equal the sum of the species/products due to the nature of statistical calculations associated with double sampling methodology.

<u>VOLUME</u>		<u>STATISTICAL RANGE IN CORDS</u>		
<u>TOTAL CUBIC FEET</u>	<u>TOTAL CORDS</u>	<u>PERCENT ERROR</u>	<u>MINIMUM</u>	<u>MAXIMUM</u>
32,966	417	N/A	246	589
193.70 acres are being sold by the acre and do not have cubic foot or cord volumes.				

VDU VOLUMES

A VDU is a Volume Determination Unit. Volumes and their associated statistics are calculated at the VDU level and summarized to the sale level. There is often a one to one relationship between a VDU and a Payment Unit, but not always, depending on the cruise design. Refer to the VDU TO PAYMENT UNIT table.

	VOLUME			RANGE IN CORDS	
VDU	TOTAL CUBIC FEET	TOTAL CORDS	PERCENT ERROR	MINIMUM	MAXIMUM
195 *			N/A		
TOTAL:	N/A	N/A		N/A	N/A

* This VDU is being sold by the acre. There are no cruise statistics available.

VDU TO PAYMENT UNIT

When a VDU is associated with more than one Payment Unit (PU), the VDU volumes are assigned to the PU based on acres of the VDU within the PU.

VDU	VDU ACRES	PU	PU ACRES
TOTAL:			

DESCRIPTION OF TIMBER BY PAYMENT UNIT (PU)

PU	MARKET GROUP	PRODUCT	QUANTITY	UNIT	ACRES	ADVERTISE PRICE
1	Misc. Species 1	Pulpwood	193.7	Acres	193.7	\$193.70
	Misc. Species 1		193.7	Acres		
TOTAL:			387.4	Acres		

Sale Specific Conditions & Requirements

Sale Name: Ice KW JP

Sale Number: 54-006-26 Seq#: 2

1 - Sale Area

1.2 - Boundaries

1.2.1 - Painted Boundaries (9/19)

The Sale boundary and Payment Unit boundaries are marked and identified by red paint and roads (see Timber Sale Map). Exterior sale boundary lines against state are marked with red paint and unmarked roads. Retention patches are marked with red paint; no harvesting activities may occur within these areas. The painted boundary line trees are not Included Timber and are to be protected.

2 - Timber Specifications

2.1 - Included Timber

2.1.1 - Clearcut Unit(s) with Unmerchantable Trees (6/14)

Within Payment Unit(s) # 1, cut all trees that are two (2) inches or more at DBH

2.1.11 - Description of Timber Note (2/04)

Note that Misc Species 1 is Jack Pine (average 4" DBH). This sale is being sold by the acre.

2.2 - Utilization

2.2.2 - Chipping Required (12/24)

The Sale Area must be chip harvested to meet Kirtland's warbler habitat requirements. The Purchaser has the option to produce sawlogs or pulpwood bolts, but the remaining portion of the trees must be chipped and hauled. Products may be produced as roundwood and forwarded to decking areas in final product length, but the tops must be left intact and skidded to the landing for chipping in order to minimize the amount of residual slash. If market conditions limit the practicality of chipping, tops and slash must be arranged in a way that will not inhibit future planting operations, as directed by the Sale Administrator. A chipping exemption can be obtained if proposed operations are determined to be suitable for planting by reforestation staff. This exemption must be granted in writing. The requirement to retain approximately 1/6 to 1/3 of treetops and limbs less than four (4) inches in diameter does not apply (G. C. & R. 2.2). This is because the site is being planted to meet Kirtland's warbler habitat requirements and does not require that slash be left.

2.2.3 - Stump Heights (12/24)

Stump heights within the Sale Area shall not exceed six (6) inches for all trees. This is in order to facilitate planting operations.

4 - Transportation

4.1 - Construction

4.1.3 - Slash and Earthen Piles (8/04)

Piles or windrows of earth along roads and landings that have been widened or constructed shall be leveled. Slash from road maintenance or construction, including stumps, shall be dispersed throughout the sale.

4.1.11 - Permits (2/12)

The Purchaser will secure any necessary highway permits that may be required.

4.1.12 - No New Roads (1/12)

No new roads will be permitted in Sale Area. All operations are limited to existing roads. Only Skid trails will be allowed.

5 - Operations

5.1 - Notification

5.1.1 - Pre-sale Conference (10/25)

A pre-sale conference on site between the Purchaser and Sale Administrator is required prior to beginning any operations to determine landing and road locations. The Unit Manager or his/her representative must be contacted at least 5 days in

advance to schedule the conference.

5.1.4 - Post-Sale Conference (10/16)

A post-sale conference on site between the Purchaser and sale administrator is required five (5) days prior to the completion of active logging operations to determine clean-up and repair of landings, road edges, and the fulfillment of other contract specifications.

5.2 - Conduct of Operations

5.2.32 - Decking/Landing Restoration (9/13)

All decking and landing areas must have the surface area restored to a condition equal to or better than before. This is to ensure the proper regeneration of the stand. Wood debris, chips and "cookies" from trimmings must be removed or scattered away from landing and loading areas and may not be windrowed on the edge.

5.2.38 - No Decking Against Live Trees (2/04)

Cut products may not be decked against unmarked or designated leave trees.

5.2.39 - ORV Trail/Route Protection (4/18)

The MCCCT Trail, Atlanta ORV Route, and Atlanta ATV Trail is shown on the Timber Sale Map. Do not cut trees or damage posts with yellow ORV markers. Trees with yellow ORV markers shall be cut off above the markers and at least five (5) feet above ground. All stumps within five (5) feet of the trail must be cut flush with the ground. Maintain a 20-foot-wide slash, debris, and rut free zone daily using the ORV trail or route as the centerline. Do not run equipment down the ORV trail or route. Skidding across the trail or route may only occur in locations approved by the Sale Administrator.

5.2.40 - Pathway Protection (10/10)

The High Country Pathway is a bike and hiking trail present in Sale Area and is shown on the Timber Sale Map. Do not cut trees or damage posts with blue pathway markers. Maintain a 20-foot-wide slash, debris, and rut free zone daily, using the pathway as the centerline. Do not run equipment down the pathway. Skidding across the trail may only occur in 1 location approved by the Sale Administrator.

5.2.41 - Snowmobile Trail Protection (9/11)

The LP_9 is a snowmobile trail and is shown on the Timber Sale Map. Do not cut or damage posts with orange trail markers or traffic control signs. If the trail is used, it must be maintained and restored to a condition equal to or better than before the sale. The road maintenance/restoration must be done prior to December 1. If the trail is used for hauling, it must be graded to the satisfaction of the Unit Manager or his/her representative prior to December 1. If the trail road is to be used for hauling during the snowmobile season, then a snow-covered base must be left on the trail. The snowmobile trail may only be crossed at right angles. Maintain a 20-foot-wide slash, debris, and rut free zone daily using the snowmobile trail as the centerline. No decking of forest products will be permitted along the snowmobile trail. All stumps within 20 feet of the snowmobile trail must be cut at ground level.

5.8 - Protection of Endangered Species

5.8.1 - Kirtland's Warbler (1) (4/24)

This sale is adjacent to a young jack pine stand which may be used by the Kirtland's Warbler. The Department reserves the right to temporarily restrict all harvesting operations in a buffer zone of up to 500 feet if it is determined that Warbler territory has been established in the adjacent stand. The restricted period, if put into effect, would apply from May 1 to August 15. The 500 ft buffer is shown along the North portion of Sale Area on the Timber Sale Map.

6 - Safety and Fire Prevention

6.2 - Signing

6.2.2 - Snowmobile Trail Posting (10/20)

The Purchaser is responsible for posting and maintaining caution signs on LP_9 prior to beginning operations during the snowmobile season (approximately December 1 to March 31). The trail must be posted at appropriate distances from the Sale Area to warn of logging activity and truck traffic. Signs must be removed when harvest operations are suspended or completed. The Purchaser will provide these signs.

6.2.3 - Recreational Trail Posting (10/20)

The Purchaser is responsible for posting and maintaining caution signs on High Country Pathway, MCCCT Trail, Atlanta Trail, and Atlanta Route prior to beginning operations. The trail must be posted at appropriate distances from the Sale Area to warn

of logging activity and truck traffic at both ends of the trail. Signs must be removed when harvest operations are suspended or completed. The Purchaser will provide these signs.

7 - Other Conditions

7.2 - Extensions

7.2.2 - No Extensions (3/09)

There will be no extensions granted on this contract. The purpose of this sale is to create habitat for the endangered Kirtland's Warbler.

7.5 - Loss

7.5.1 - Deteriorating Timber (7/09)

The Sale Area has received damage from Ice Storm in late March 2025. The Purchaser should harvest the wood as soon as possible. The Department of Natural Resources is held free of responsibility of any further damage or deterioration due to delay in harvesting.



TIMBER SALE MAP

This information provided by authority of Part 525, 1994 PA 451, as amended.

Sale Number

54-006-26

Date

11/12/2025

Forest Management Unit

County

Mapped By: Neff

Scale

Page

Of

Atlanta Mgt Unit

Montmorency

Cruised By: Neff

1:20,000

1

1

Township
32N

Range
02E

Section(s) and

Subdivision(s) Sec. 22 NE,N1/2SE,SWSE; Sec. 27 E1/2NW,W1/2NE,NESW,NWSE;

Cover Type

A = Aspen	J = Jack Pine	O = Oak	U = Upland Brush
B = Paper Birch	K = Rock	P = Lowland Poplar	UM = Upland Mix Forest
C = Cedar	L = Lowland Brush	Q = Mixed Swamp Conifer	V = Bog or Marsh
D = Treed Bog	LM = Lowland Mix Forest	R = Red Pine	W = White Pine
E = Swamp Hardwoods	M = Maple, Beech, Birch	S = Black Spruce	X = Non Stocked
F = Spruce/Fir	MC = Mixed Conifer	T = Tamarack	Y = Sand
G = Grass	MD = Mixed Deciduous	Z = Water	
H = Hemlock	N = Marsh		

Density

0 = Non Stocked	5 = Pole Timber Medium
1 = Seedling Sapling Poor	6 = Pole Timber Well
2 = Seedling Sapling Medium	7 = Saw Timber Poor
3 = Seedling Sapling Well	8 = Saw Timber Medium
4 = Pole Timber Poor	9 = Saw Timber Well

**Payment Unit
Number**

1 193.7

Ice KW JP

193.7 Acres

Locator Map 1:100,000



0 0.25 0.5 1 Miles



Area located within the 500 ft buffer
(May 1st - August 15th)

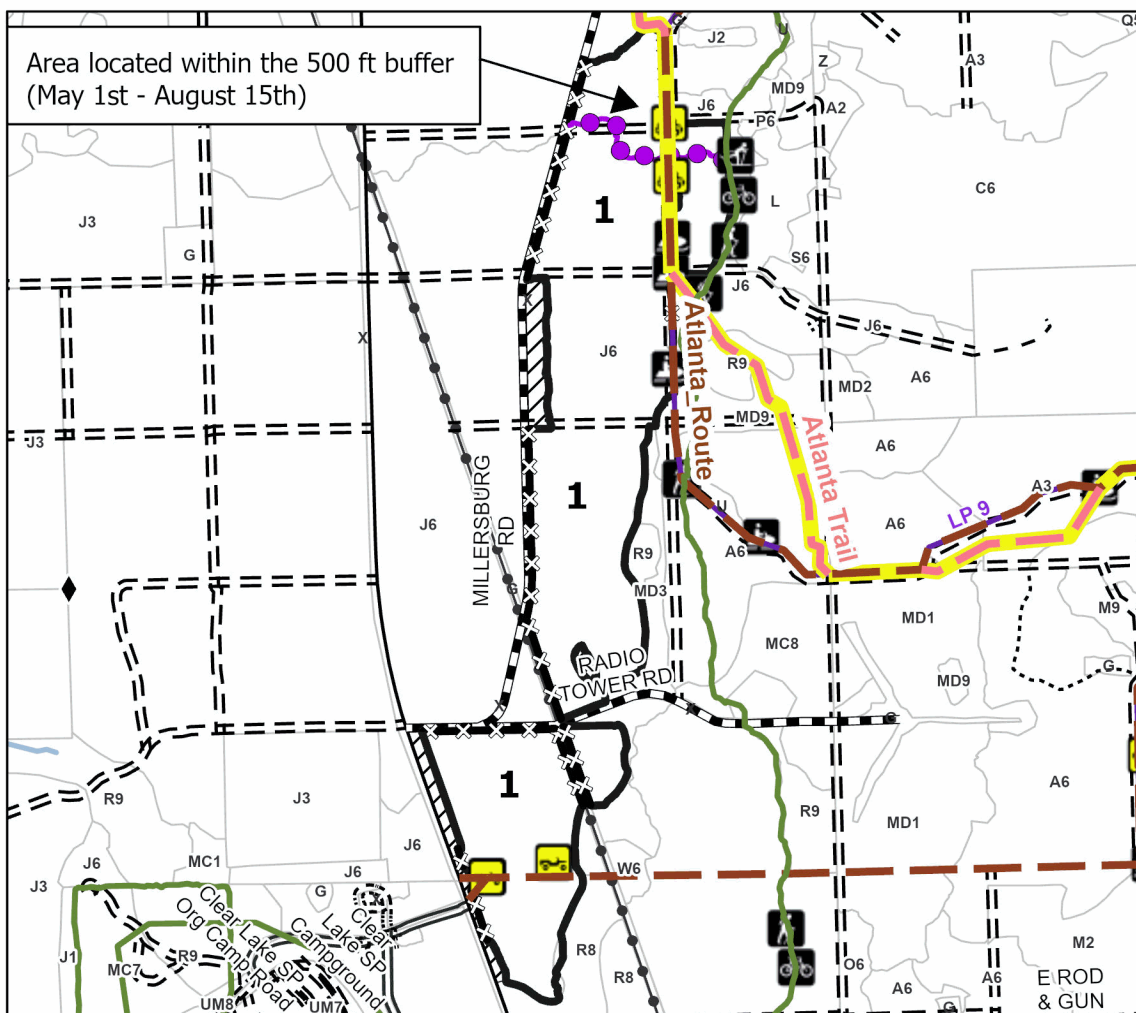

Legend

- Payment Unit
- Against State (Red)
- Against State (Unpainted)
- Against State (Unpainted)
- Retention Areas
- Primary Forest Road
- Forest Access Route
- Administrative Access Only
- Paved Road
- Government Gravel/Dirt
- Private Gravel/Dirt
- Field Grade Corner
- High Country Pathway
- ATV Trail
- ORV Route
- MCCCT
- Snowmobile

Use QR Code to
open Map in App



TIMBER SALE INFORMATION

Ice James Rd Red Pine Salvage (54-008-26)

T31N, R05E, SEC. 23.

Alpena County (Advertised Price \$4,652.55)

SALE NOTE: -This is an ice storm damaged salvage sale. Refer to timber sale specs 2.1. 11, 7.2.2, and 7.5.1 for details.

-The use of a feller buncher is not allowed for the protecting of regeneration. Refer to timber sale specs 2.2.6 and 3.4.1 for details.

-Any questions related to this ice storm damage salvage sale can be directed to MI DNR Forester Dale Parris at (989) 590-1204 or parrisd2@michigan.gov.

A timber sale contract for this lump sum, sealed bid timber sale will be awarded to the responsible bidder offering the highest sealed bid price. All units of volume listed below were estimated using the Inventory Manager computer program and the new Michigan taper model. Bids must be at or above the following advertised price for each product and species:

<u>PRODUCTS & SPECIES</u>	<u>ESTIMATED UNITS*</u>	<u>ADVERTISED PRICE</u>
Sawtimber		
Red Pine	48.3 MBF	\$ 59.00 / MBF
Pulpwood		
Austrian Pine	10 Cords	\$ 14.90 / Cord
Misc. Species 2	45 Cords	\$ 5.00 / Cord
Misc. Species 3	8 Cords	\$ 5.00 / Cord
Red Pine	47 Cords	\$ 29.55 / Cord

* The total volume is statistically estimated within plus (+) or minus (-) 28.90 percent. There are an estimated 224 cords on this timber sale, plus or minus 65 cords at the 95% confidence level. The estimated units are final and not subject to adjustment. Prospective bidders are urged to examine this timber and to make their own estimates of quantity and quality.

BOND AND PAYMENT SCHEDULE:

1. A bond in the amount of \$1,000.00 to insure faithful performance of the conditions of the contract will be deposited by the successful bidder within 21 days of the sale award.
2. Cutting in any sale or unit without the required advance payment would be considered a trespass.
3. Total payment must be paid in advance or according to the following schedule :
 - (a) Ten percent (10%) of the sale value must be paid within 21 days of the sale award.
 - (b) The remainder is due before cutting begins.
 - (c) Payment for each of the following units must be made before cutting begins in that unit:

PAYMENT UNIT NUMBER	PERCENT OF TOTAL SALE VALUE
01	100.0%
4. If no cutting takes place, the 10% down payment will not be refunded.
5. Operations on the contract issued will terminate on 06/30/2028.

SALE STATISTICS

Volumes were calculated in cubic feet using the Michigan taper model. Cubic foot volume includes all wood inside bark for the product indicated. For display purposes, cubic feet were converted to cords and MBF using a simple conversion factor, e.g. 79 cubic feet per cord and 185 cubic feet per MBF. The cubic foot volumes are precise; the cords and MBF volumes are not. Cubic foot volume cannot be directly converted to cords or boards with precision.

SALE VOLUMES

The total estimated sale volume may not equal the sum of the species/products due to the nature of statistical calculations associated with double sampling methodology.

VOLUME		STATISTICAL RANGE IN CORDS		
TOTAL CUBIC FEET	TOTAL CORDS	PERCENT ERROR	MINIMUM	MAXIMUM
17,697	224	28.90%	159	289

VDU VOLUMES

A VDU is a Volume Determination Unit. Volumes and their associated statistics are calculated at the VDU level and summarized to the sale level. There is often a one to one relationship between a VDU and a Payment Unit, but not always, depending on the cruise design. Refer to the VDU TO PAYMENT UNIT table.

	VOLUME			RANGE IN CORDS	
VDU	TOTAL CUBIC FEET	TOTAL CORDS	PERCENT ERROR	MINIMUM	MAXIMUM
21	17,697	224	28.91%	159	289
TOTAL:	17,697	224		159	289

VDU TO PAYMENT UNIT

When a VDU is associated with more than one Payment Unit (PU), the VDU volumes are assigned to the PU based on acres of the VDU within the PU.

VDU	VDU ACRES	PU	PU ACRES
TOTAL:			

DESCRIPTION OF TIMBER BY PAYMENT UNIT (PU)

PU	MARKET GROUP	PRODUCT	QUANTITY	UNIT	ACRES	ADVERTISE PRICE
1	Red Pine	Sawtimber	48.3	MBF	6.2	\$4,652.55
	Austrian Pine	Pulpwood	10	Cords		
	Austrian Pine	Sawtimber	1.8	MBF		
	Austrian Pine	Pulpwood	4	Cords		
	Scotch Pine		2	Cords		
	Misc. Species 2		45	Cords		
	Misc. Species 3		8	Cords		
	Red Pine		47	Cords		
TOTAL:			48.3	MBF		
TOTAL:			110	Cords		

Sale Specific Conditions & Requirements

Sale Name: Ice James Rd Red Pine Salvage

Sale Number: 54-008-26 Seq#: 1

1 - Sale Area

1.2 - Boundaries

1.2.1 - Painted Boundaries (9/19)

The sale boundaries are marked and identified with red paint and James Road. Exterior sale boundary lines against state are marked with red paint and James Road. The painted boundary line trees are not included timber with the exception of red pine, Austrian Pine, and Scotch pine boundary line trees. Red pine, Austrian pine, and Scotch pine red painted boundary line trees are included timber and are to be harvested.

2 - Timber Specifications

2.1 - Included Timber

2.1.1 - Clearcut Unit(s) with Unmerchantable Trees (6/14)

Within Payment Unit(s) 1, cut all trees that are two (2) inches or more at DBH, except protect and do not cut sub-merchantable oak and pine in accordance with sale spec 3.4.1.

2.1.11 - Description of Timber Note (2/04)

Note that this is an ice storm salvage sale.

All timber standing, fallen, snapped, and/or broken timber is designated for harvest, except those trees designated for leave as detailed in timber sale specs 2.1.1 and 3.4.1.

This sale was cruised, and timber volumes estimated, using standard methods used by the Michigan DNR. Advertised prices were reduced accordingly, to reflect the current ice storm damaged condition of the stand.

Misc. species 2 is standing damaged red pine with minimal to no remaining foliage to promote future tree growth and prevent decay.

Misc. species 3 is standing damaged Austrian pine with minimal to no remaining foliage to promote future tree growth and prevent decay.

All merchantable tree volume, whether standing, snapped off, or fallen, is included timber and is to be harvested and removed from the sale site.

All general timber determined to be dead before the ice storm of late March 2025 was not included in the cruised timber volume.

2.2 - Utilization

2.2.6 - Roundwood Operation Required (3/21)

The skidding of whole trees or tree segments with limbs attached is prohibited. All products must be produced as roundwood and forwarded to existing roads or landing areas in final product length. Trees must be harvested with a processor (the use of a feller buncher will not be allowed) in order to retain existing understory.

3 - Payments

3.4 - Damaged Timber

3.4.1 - Damaged Timber (12/24)

General Condition and Requirement 3.4 Damaged Timber, defines liquidated damages for undesignated live merchantable trees which are cut or injured. In addition, extreme care should be taken to avoid damage to tree seedlings and saplings.

Within the Sale Area, if more than 25% of the oak and/or pine tree seedlings or saplings (1/4" to 4.5" DBH) within a specified portion of the Sale Area are damaged, liquidated damages will be assessed at \$250 per acre for all acreage within that

specified portion of the Sale Area that was damaged.

4 - Transportation

4.1 - Construction

4.1.3 - Slash and Earthen Piles (8/04)

Piles or windrows of earth along roads and landings that have been widened or constructed shall be leveled. Slash from road maintenance or construction, including stumps, shall be dispersed throughout the sale.

4.1.6 - Road Construction (4/24)

Improvements of existing roads shall be done in such a way as to minimize the environmental and visual impacts.

Merchantable trees shall be cut and utilized unless otherwise directed. Non-merchantable trees shall be severed and laid flat on the ground. Slash shall be scattered, not left in windrows, and kept a minimum of 10 feet back from the road edge.

Stumps shall be set upright, not left on edge, and be moved at least 10 feet away from the road edge. Disturbed soil shall be feathered into the woods and not left in berms or windrows.

4.1.12 - No New Roads (1/12)

No new roads will be permitted in any Payment Unit. All operations are limited to existing roads. Only Skid trails will be allowed.

4.2 - Maintenance

4.2.5 - Two Wheel Drive Condition (2/04)

All existing trail roads on and adjacent to the Sale Area must be passable by two-wheel drive traffic for the duration of the sale.

5 - Operations

5.1 - Notification

5.1.1 - Pre-sale Conference (10/25)

A pre-sale conference on site between the Purchaser and Sale Administrator is required prior to beginning any operations a Payment Unit to determine landing and road locations. The Unit Manager or his/her representative must be contacted at least 5 days in advance to schedule the conference.

5.1.4 - Post-Sale Conference (10/16)

A post-sale conference on site between the Purchaser and sale administrator is required 5 days prior to the completion of active logging operations to determine clean-up and repair of landings, road edges, and the fulfillment of other contract specifications.

5.2 - Conduct of Operations

5.2.1 - Slash

5.2.1.10 - No Slash in Openings (5/10)

No brush or logging debris is to be left in the maintained wildlife opening which is indicated by G on the Timber Sale Map. Any damage to the opening shall be repaired according to specifications of the Unit Manager or his/her representative.

5.2.2 - Hazard Trees/Snags

5.2.2.1 - Den Trees (10/16)

Obvious hollow and/or den trees shall be protected and left standing unless they are a safety hazard.

5.2.3 - Operating Restrictions

5.2.3.11 - Coppice Regeneration Protection (4/10)

Timber harvesting in any Payment Unit must be completed before significant tree sprouting occurs in that Payment Unit, so as to minimize damage to the new regeneration. Any post-harvest operations, such as chipping, must be completed before sprouting of regeneration occurs. If it is anticipated that chipping will be delayed, then tops shall be carried to one central location or left unchipped. The Unit Manager or his/her representative may cease such operations if sprouting occurs before the operation is complete.

5.2.32 - Decking/Landing Restoration (9/13)

All decking and landing areas must have the surface area restored to a condition equal to or better than before. This is to ensure the proper regeneration of the stand. Wood debris, chips and "cookies" from trimmings must be removed or scattered away from landing and loading areas and may not be windrowed on the edge.

5.2.38 - No Decking Against Live Trees (2/04)

Cut products may not be decked against unmarked or designated leave trees.

5.4 - Soil Protection

5.4.1 - Rutting Restriction, General (7/16)

Operations are to cease immediately if equipment and weather conditions result in rutting of roads and/or skid trails which are 12 inches or greater in depth and 50 feet in length. The Unit Manager or his/her representative may restrict hauling and/or skidding if ruts exceed the specified depth. With the Unit Manager or his/her representative's approval, the Purchaser may return to the area when the risk of rutting has decreased.

5.8 - Protection of Endangered Species

5.8.5 - Protection of Raptor Nests (3/13)

All trees with raptor nests will be protected if found during harvesting operations. Notification will be made to the Unit Manager or his/her representative who will notify the Wildlife Biologist so an onsite evaluation and recommendation can be made, if necessary.

6 - Safety and Fire Prevention

6.2 - Signing

6.2.1 - Road Posting (10/20)

The Purchaser is responsible for posting and maintaining caution signs on forest roads prior to beginning operations. The road must be posted at appropriate distances from the Sale Area to warn of logging activity and truck traffic. Signs must be removed when harvest operations are suspended or completed. The Purchaser will provide these signs.

7 - Other Conditions

7.2 - Extensions

7.2.2 - No Extensions (3/09)

There will be no extensions granted on this contract. Ice storm damaged timber must be processed and utilized in a timely manner for minimizing deterioration of wood product.

7.5 - Loss

7.5.1 - Deteriorating Timber (7/09)

The Sale Area has received damage from the late March 2025 Ice Storm. The Purchaser should harvest the wood as soon as possible. The Department of Natural Resources is held free of responsibility of any further damage or deterioration due to delay in harvesting.



TIMBER SALE MAP

This information provided by authority of Part 525, 1994 PA 451, as amended.

Sale Number

54-008-26

Date

01/05/2026

Forest Management Unit

Atlanta Mgt Unit

County

Alpena

Mapped By: D. Parris

Cruised By: D. Parris

Scale

1:7,920

Page

1

Of

1

Township
31N

Range
05E

Section(s) and
Subdivision(s) Sec. 23 N1/2NE;

Cover Type

A = Aspen	J = Jack Pine	O = Oak	U = Upland Brush
B = Paper Birch	K = Rock	P = Lowland Poplar	UM = Upland Mix Forest
C = Cedar	L = Lowland Brush	Q = Mixed Swamp Conifer	V = Bog or Marsh
D = Treed Bog	LM = Lowland Mix Forest	R = Red Pine	W = White Pine
E = Swamp Hardwoods	M = Maple, Beech, Birch	S = Black Spruce	X = Non Stocked
F = Spruce/Fir	MC = Mixed Conifer	T = Tamarack	Y = Sand
G = Grass	MD = Mixed Deciduous	Z = Water	
H = Hemlock	N = Marsh		

Density

0 = Non Stocked	5 = Pole Timber Medium
1 = Seedling Sapling Poor	6 = Pole Timber Well
2 = Seedling Sapling Medium	7 = Saw Timber Poor
3 = Seedling Sapling Well	8 = Saw Timber Medium
4 = Pole Timber Poor	9 = Saw Timber Well

**Payment Unit
Number**

1 6.2

**Ice James Rd
Red Pine
Salvage**

Compartment 98

6.2 Acres



0 0.13 0.25 0.5 Miles

Locator Map 1:100,000

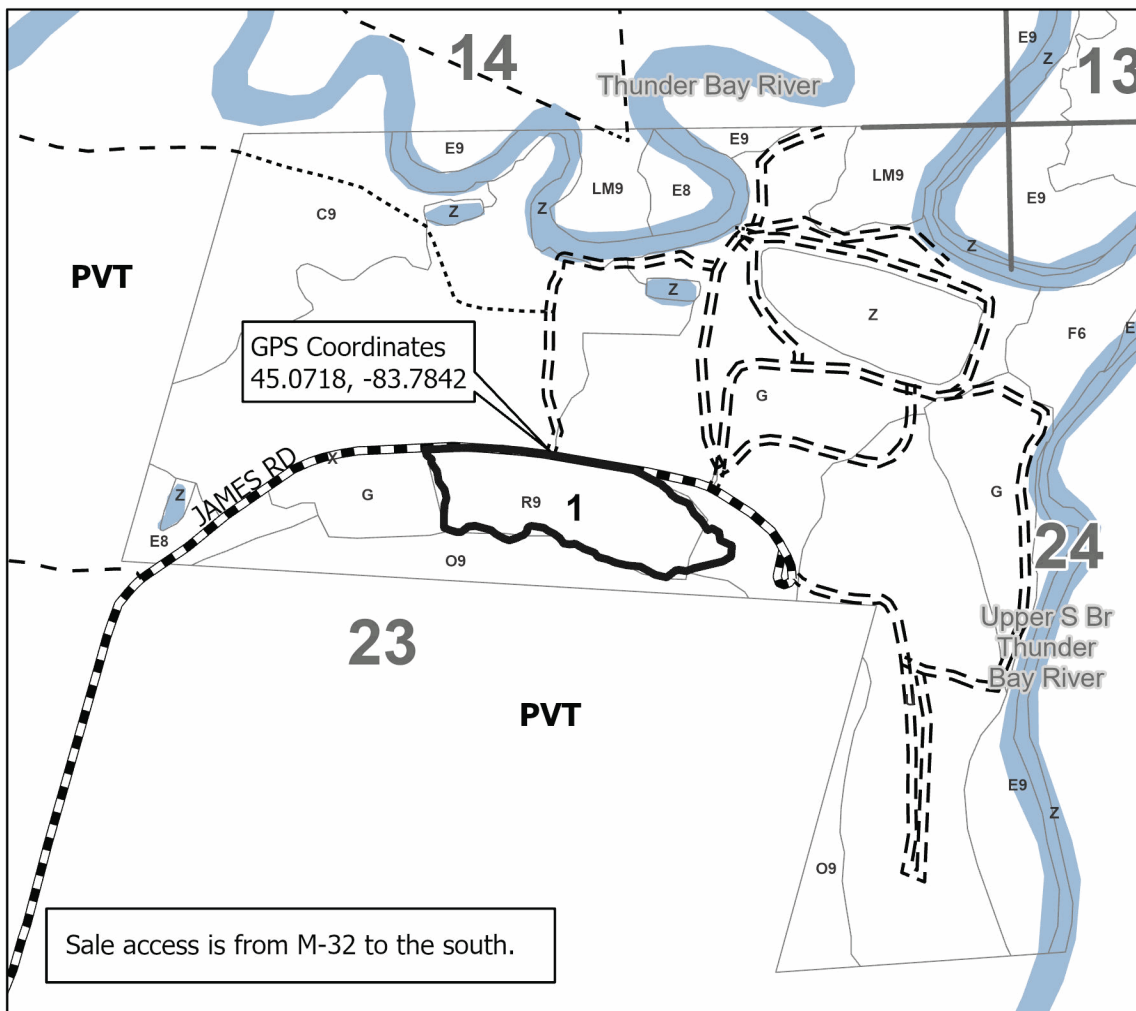
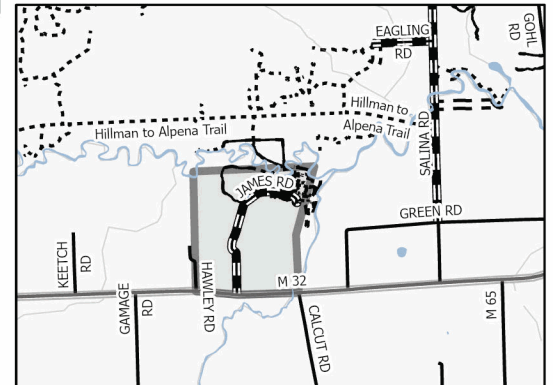

Legend

- Payment Unit
- Sale Boundary
- Against State (Red)
- Stand Boundaries
- Lakes and Rivers
- Streams
- Forest Access Route
- Administrative Access Only
- Government Gravel/Dirt
- Private Gravel/Dirt
- Section Corners

Use QR Code to
open Map in App



Ice James Rd Red Pine Salvage (54-008-26)
T31N, R05E, SEC. 23; Alpena COUNTY

In response to the notice of sale to be held 9:00 a.m. (local time) on February 12, 2026, I am hereby submitting my sealed bid (firm offer) for the following forest products to be cut. Bids for individual species must be at or above the advertised price. All non-responsive bid forms may be rejected.

<u>PRODUCTS & SPECIES</u>	<u>ESTIMATED VOLUME*</u>	<u>ADVERTISED PRICE</u>	<u>BID PRICE/UNIT</u>
Sawtimber			
Red Pine	48.3 MBF	\$ 59.00/MBF	\$ _____
Pulpwood			
Austrian Pine	10 Cords	\$ 14.90/Cord	\$ _____
Misc. Species 2	45 Cords	\$ 5.00/Cord	\$ _____
Misc. Species 3	8 Cords	\$ 5.00/Cord	\$ _____
Red Pine	47 Cords	\$ 29.55/Cord	\$ _____

*The volumes are statistically estimated within plus (+) or minus (-) 28.90 percent at 95% confidence level. These estimated volumes are final and not subject to adjustment. Prospective bidders are urged to examine this timber and to make their own estimates of quantity and quality.

I understand that any or all bids may be rejected. All bids must be signed and all bid items must be bid or the bid form may be rejected. I also understand that consideration and awarding a contract will be based upon my past performance and ability to complete the contract based upon equipment and staffing subject to my control .

FEDERAL ID: ____ - ____ - ____ or SOCIAL SECURITY NUMBER: ____ - ____ - ____
Company or individual bidding: _____
Company representative's name: _____
Address: _____
City: _____ State: _____ Zip: _____

IF AVAILABLE, PLEASE PLACE THE PERSONALIZED LABEL FROM YOUR PROSPECTUS IN THE ABOVE BOX.

Individual or company representative's signature: _____ Date: _____

Phone number : _____ Email (optional): _____

**THE WINNING BIDDER MUST COMPLETE THE VERIFICATION OF WORKER'S DISABILITY COMPENSATION ACT
COMPLIANCE (ON REVERSE SIDE IF DOUBLE SIDED) WITHIN 21 DAYS OF SALE AWARD DATE**



TIMBER SALE VERIFICATION OF WORKER'S DISABILITY COMPENSATION ACT COMPLIANCE

As required by Act 317, P.A. 1969 (Worker's Compensation) and
Part 5 of Act 451 of 1994, as amended.

FOR DEPARTMENT USE ONLY

Sale Number (XX - XXX - XX - XX)

Forest Management Unit:

VERIFICATION OF WORKER'S DISABILITY COMPENSATION ACT COMPLIANCE

- This verification must be completed and submitted within 21 days of contract award and prior to the issuance of the timber sale contract.
- In addition, if boxes 2B or 2C are checked, then Notice of Exclusion or Certificate of Insurance must be submitted within twenty-one (21) days of the contract award and prior to the issuance of the timber sale contract.
- All information must be typed or printed except for written signatures.

Please Check Appropriate Categories:

1. My business is organized as (you **must** check one of the boxes below):
 - A. ☐ Sole Proprietorship (individual)
 - B. ☐ Partnership
 - C. ☐ Corporation
2. You **must** check one of the boxes below:
 - A. ☐ I certify my business is a sole proprietorship and it has no employees but the sole proprietor. I am not subject to the Worker's Compensation Laws.
 - B. ☐ I certify my business has satisfied its obligation to the Worker's Compensation Act through the use of an approved Notice of Exclusion (BWC-337, Rev. 5/96). I will provide a copy of the Notice of Exclusion within 21 days of the contract award. (For questions or a copy of the BWC-337, please call the Worker's Compensation Bureau at 517-322-1195).
 - C. ☐ I certify my business has a Worker's Compensation Policy. I will provide an original Certificate of Insurance within twenty-one (21) days of the contract award.
3. If you have checked item 2(A) or 2(B), you **must** indicate the number of **both** full-time and part-time employees, other than yourself, including family members and active partners (if none, you must enter "0").

_____ Full-time Employees

_____ Part-time Employees

Name of Business		Federal ID (or) Social Security No.
Address		Telephone ()
City	State	ZIP

I hereby certify that the above information is true and correct. I agree to notify the Michigan DNR of any changes that occur in factors affecting my coverage during any of my present and future operations.

Signature of Owner or Authorized Representative

Title

Date

Please complete the "SEALED BID" information on the next page

Ice KW JP (54-006-26)

T32N, R02E, SEC. 22; T32N, R02E, SEC. 27; Montmorency COUNTY

In response to the notice of sale to be held 9:00 a.m. (local time) on February 12, 2026, I am hereby submitting my sealed bid (firm offer) for the following forest products to be cut. Bids for individual species must be at or above the advertised price. All non-responsive bid forms may be rejected.

<u>PRODUCTS & SPECIES</u>	<u>ESTIMATED VOLUME*</u>	<u>ADVERTISED PRICE</u>	<u>BID PRICE/UNIT</u>
Pulpwood			
Misc. Species 1	193.7 Acres	\$ 1.00/Acres	\$ _____

*The volumes are statistically estimated within plus (+) or minus (-) 41.08 percent at 95% confidence level. These estimated volumes are final and not subject to adjustment. Prospective bidders are urged to examine this timber and to make their own estimates of quantity and quality.

I understand that any or all bids may be rejected. All bids must be signed and all bid items must be bid or the bid form may be rejected. I also understand that consideration and awarding a contract will be based upon my past performance and ability to complete the contract based upon equipment and staffing subject to my control.

FEDERAL ID: ____-____-____ or SOCIAL SECURITY NUMBER: ____-____-____

Company or individual bidding: _____

Company representative's name: _____

Address: _____

City: _____ State: _____ Zip: _____

IF AVAILABLE, PLEASE PLACE THE PERSONALIZED LABEL FROM YOUR PROSPECTUS IN THE ABOVE BOX.

Individual or company representative's signature: _____ Date: _____

Phone number : _____ Email (optional): _____

**THE WINNING BIDDER MUST COMPLETE THE VERIFICATION OF WORKER'S DISABILITY COMPENSATION ACT
COMPLIANCE (ON REVERSE SIDE IF DOUBLE SIDED) WITHIN 21 DAYS OF SALE AWARD DATE**



TIMBER SALE VERIFICATION OF WORKER'S DISABILITY COMPENSATION ACT COMPLIANCE

As required by Act 317, P.A. 1969 (Worker's Compensation) and
Part 5 of Act 451 of 1994, as amended.

FOR DEPARTMENT USE ONLY

Sale Number (XX - XXX - XX - XX)

Forest Management Unit:

VERIFICATION OF WORKER'S DISABILITY COMPENSATION ACT COMPLIANCE

- This verification must be completed and submitted within 21 days of contract award and prior to the issuance of the timber sale contract.
- In addition, if boxes 2B or 2C are checked, then Notice of Exclusion or Certificate of Insurance must be submitted within twenty-one (21) days of the contract award and prior to the issuance of the timber sale contract.
- All information must be typed or printed except for written signatures.

Please Check Appropriate Categories:

1. My business is organized as (you **must** check one of the boxes below):
 - A. ☐ Sole Proprietorship (individual)
 - B. ☐ Partnership
 - C. ☐ Corporation
2. You **must** check one of the boxes below:
 - A. ☐ I certify my business is a sole proprietorship and it has no employees but the sole proprietor. I am not subject to the Worker's Compensation Laws.
 - B. ☐ I certify my business has satisfied its obligation to the Worker's Compensation Act through the use of an approved Notice of Exclusion (BWC-337, Rev. 5/96). I will provide a copy of the Notice of Exclusion within 21 days of the contract award. (For questions or a copy of the BWC-337, please call the Worker's Compensation Bureau at 517-322-1195).
 - C. ☐ I certify my business has a Worker's Compensation Policy. I will provide an original Certificate of Insurance within twenty-one (21) days of the contract award.
3. If you have checked item 2(A) or 2(B), you **must** indicate the number of **both** full-time and part-time employees, other than yourself, including family members and active partners (if none, you must enter "0").

_____ Full-time Employees

_____ Part-time Employees

Name of Business		Federal ID (or) Social Security No.
Address		Telephone ()
City	State	ZIP

I hereby certify that the above information is true and correct. I agree to notify the Michigan DNR of any changes that occur in factors affecting my coverage during any of my present and future operations.

Signature of Owner or Authorized Representative

Title

Date

Please complete the "SEALED BID" information on the next page

Rummaging Ruminant Aspen (54-001-26)

T31N, R01E, SEC. 10; T31N, R01E, SEC. 15; T31N, R01E, SEC. 16; T31N, R01E,

In response to the notice of sale to be held 9:00 a.m. (local time) on February 12, 2026, I am hereby submitting my sealed bid (firm offer) for the following forest products to be cut. Bids for individual species must be at or above the advertised price. All non-responsive bid forms may be rejected.

<u>PRODUCTS & SPECIES</u>	<u>ESTIMATED VOLUME*</u>	<u>ADVERTISED PRICE</u>	<u>BID PRICE/UNIT</u>
Sawtimber			
Basswood	8.1 MBF	\$ 28.00/MBF	\$ _____
Red Maple	6.5 MBF	\$ 28.00/MBF	\$ _____
Red Oak	103.6 MBF	\$ 100.00/MBF	\$ _____
Red Pine	21.5 MBF	\$ 53.00/MBF	\$ _____
Sugar Maple	20.4 MBF	\$ 118.00/MBF	\$ _____
White Pine	4.6 MBF	\$ 36.00/MBF	\$ _____
Pulpwood			
Balsam Fir	3 Cords	\$ 9.80/Cord	\$ _____
Basswood	71 Cords	\$ 11.20/Cord	\$ _____
Mixed Aspen	2,660 Cords	\$ 8.10/Cord	\$ _____
Mixed Hardwood	447 Cords	\$ 10.20/Cord	\$ _____
Paper Birch	7 Cords	\$ 7.40/Cord	\$ _____
Red Oak	167 Cords	\$ 17.05/Cord	\$ _____
Red Pine	12 Cords	\$ 26.60/Cord	\$ _____
White Pine	6 Cords	\$ 11.35/Cord	\$ _____

*The volumes are statistically estimated within plus (+) or minus (-) 13.67 percent at 95% confidence level. These estimated volumes are final and not subject to adjustment. Prospective bidders are urged to examine this timber and to make their own estimates of quantity and quality.

I understand that any or all bids may be rejected. All bids must be signed and all bid items must be bid or the bid form may be rejected. I also understand that consideration and awarding a contract will be based upon my past performance and ability to complete the contract based upon equipment and staffing subject to my control.

FEDERAL ID: ____ - ____ - ____ or SOCIAL SECURITY NUMBER: ____ - ____ - ____

Company or individual bidding: _____

Company representative's name: _____

Address: _____

City: _____ State: _____ Zip: _____

IF AVAILABLE, PLEASE PLACE THE PERSONALIZED LABEL FROM YOUR PROSPECTUS IN THE ABOVE BOX.

Individual or company representative's signature: _____ Date: _____

Phone number : _____ Email (optional): _____

THE WINNING BIDDER MUST COMPLETE THE VERIFICATION OF WORKER'S DISABILITY COMPENSATION ACT COMPLIANCE (ON REVERSE SIDE IF DOUBLE SIDED) WITHIN 21 DAYS OF SALE AWARD DATE



TIMBER SALE
VERIFICATION OF WORKER'S DISABILITY
COMPENSATION ACT COMPLIANCE

*As required by Act 317, P.A. 1969 (Worker's Compensation) and
Part 5 of Act 451 of 1994, as amended.*

FOR DEPARTMENT USE ONLY

Sale Number (XX – XXX – XX – XX)

Forest Management Unit:

VERIFICATION OF WORKER'S DISABILITY COMPENSATION ACT COMPLIANCE

- This verification must be completed and submitted within 21 days of contract award and prior to the issuance of the timber sale contract.
- In addition, if boxes 2B or 2C are checked, then Notice of Exclusion or Certificate of Insurance must be submitted within twenty-one (21) days of the contract award and prior to the issuance of the timber sale contract.
- All Information must be typed or printed except for written signatures.

Please Check Appropriate Categories:

1. My business is organized as (you **must** check one of the boxes below):
 - A. ☐ Sole Proprietorship (individual)
 - B. ☐ Partnership
 - C. ☐ Corporation
2. You **must** check one of the boxes below:
 - A. ☐ I certify my business is a sole proprietorship and it has no employees but the sole proprietor. I am not subject to the Worker's Compensation Laws.
 - B. ☐ I certify my business has satisfied its obligation to the Worker's Compensation Act through the use of an approved Notice of Exclusion (BWC-337, Rev. 5/96). I will provide a copy of the Notice of Exclusion within 21 days of the contract award. (For questions or a copy of the BWC-337, please call the Worker's Compensation Bureau at 517-322-1195).
 - C. ☐ I certify my business has a Worker's Compensation Policy. I will provide an original Certificate of Insurance within twenty-one (21) days of the contract award.
3. If you have checked item 2(A) or 2(B), you **must** indicate the number of **both** full-time and part-time employees, other than yourself, including family members and active partners (if none, you must enter "0").

_____ Full-time Employees

_____ Part-time Employees

Name of Business		Federal ID (or) Social Security No.
Address		Telephone ()
City	State	ZIP

I hereby certify that the above information is true and correct. I agree to notify the Michigan DNR of any changes that occur in factors affecting my coverage during any of my present and future operations.

Signature of Owner or Authorized Representative

Title

Date

Please complete the "SEALED BID" information on the next page