



**DEPARTMENT OF NATURAL RESOURCES
STATE OF MICHIGAN
TIMBER SALE PROSPECTUS #7830**

SCHEDULED SALE DATE AND TIME: 9:00 a.m. (local time) on May 18, 2026.

LOCATION: GRAYLING MGMT UNIT, 1955 HARTWICK PINES ROAD, GRAYLING, MI 49738.

PROSPECTUS NOTE: The bidder is advised to inspect the sale area and review the location, estimated volumes, operating costs and contract terms of proposed sales. Please be aware that some landowners may request 60 days or more notice for access across their land.

Notice is hereby given that bids will be received by the Unit Manager, GRAYLING MANAGEMENT UNIT, for certain timber on the following described lands:

Joan of Arctic Mix (72-006-26) / T28N, R04W, SEC. 5 , W1/2NW,SWSW.

T28N, R04W, SEC. 6 , E1/2NE,SESE.

T28N, R04W, SEC. 8 , NWNW.

Crawford County, Advertised Price \$20,300.00, 87.3 Acres, Aspen, Red Pine.

SALE NOTE: This sale is within Eastern Massasauga Rattlesnake habitat. Special protection trees were not cruised. Note: Original sale was prepped in 2020. Sale was forfeited in 2025 without being cut. New sale created using old cruise data and specs to re-sell in 2026. Boundary paint is old and may be difficult to follow in places. Paint may need to be freshened up along boundaries by sale administrator prior to operations beginning.

A recreation site such as a trail, pathway, or campground is within the sale area or the vicinity. Certain restrictions/specifications may be applicable including time restrictions.

Ice-orcist (72-034-25) / T28N, R02E, SEC. 23, S1/2SE.

T28N, R02E, SEC. 25, NWNW.

T28N, R02E, SEC. 26, E1/2NW,NE,NESW,S1/2SW,N1/2SE.

T28N, R02E, SEC. 35, N1/2NW,SWNW,W1/2NE.

Oscoda County, Advertised Price \$18,195.10, 221.3 Acres, Aspen, Hardwood.

SALE NOTE: 7.5.1 - Deteriorating Timber (7/09) The Sale Area has received damage from the 2025 ice storm. The Purchaser should harvest the wood as soon as possible. Snowmobile trail and ORV trail specs included. This sale has a 2-year contract length with no extensions allowed. Oil and gas infrastructure is present within the vicinity of the sale area. Line locations are unknown and not identified on the ground or on the map. Therefore, the purchaser must contact Muzyl Oil Corporation at 989-732-8100 to identify infrastructure prior to operations beginning.

A recreation site such as a trail, pathway, or campground is within the sale area or the vicinity. Certain restrictions/specifications may be applicable including time restrictions.

Ice- Bark Souls (72-041-25) / T28N, R03E, SEC. 20, NWSW,S1/2SW,N1/2SE,SESE.
Oscoda County, Advertised Price \$6,428.75, 60.0 Acres, Aspen, Hardwood.

SALE NOTE: This is an ice storm salvage sale. Note that this is a 2-year contract.

This sale should be cut as soon as possible. No extensions for this sale will be granted.

It is recommended that the Purchaser use the provided georeferenced map as a guide as there are no visual markers of some sale boundaries other than timber type changes or roads.

The Purchaser should also be aware that some of the terrain in the sale is steep, and extra caution should be used while operating in those areas.

A recreation site such as a trail, pathway, or campground is within the sale area or the vicinity. Certain restrictions/specifications may be applicable including time restrictions.

Ice- Pigger Aspen (72-042-25) / T28N, R02E, SEC. 23, E1/2NW,W1/2NE,N1/2SW,SESW,NWSE.
Oscoda County, Advertised Price \$3,044.65, 43.7 Acres, Aspen, Hardwood.

SALE NOTE: 7.5.1 - Deteriorating Timber (7/09) The Sale Area has received damage from the 2025 ice storm. The Purchaser should harvest the wood as soon as possible. Snowmobile trail and ORV trail specs included. This sale has a 2-year contract length with no extensions allowed. Oil and gas infrastructure is present near the vicinity of the sale area. Therefore, the purchaser must contact pipeline company to identify infrastructure prior to operations beginning.

A recreation site such as a trail, pathway, or campground is within the sale area or the vicinity. Certain restrictions/specifications may be applicable including time restrictions.

Loggy Bottom Boys (72-008-24) / T27N, R01W, SEC. 1 , S1/2SW.
T27N, R01W, SEC. 2 , N1/2NW,SWNW,E1/2NE,NWSW,S1/2SW.
Crawford County, Advertised Price \$16,024.85, 99.9 Acres, Aspen, Jack Pine.

SALE NOTE: PU 1 and 2 were impacted by the spring 2025 ice storm. Three year contract due to operating cautions. Also, please take note of access for Payment Unit 6. KW restriction may also apply to this sale for Payment Unit 6, please check with the sale administrator regarding this. Also, please note that no chipping of limbs or tops will be allowed to assist with natural regeneration and protect sensitive soils.

A recreation site such as a trail, pathway, or campground is within the sale area or the vicinity. Certain restrictions/specifications may be applicable including time restrictions.

High Voltage Mix (72-017-24) / T27N, R02E, SEC. 28, S1/2NW,N1/2SW,SWSW.
T27N, R02E, SEC. 29, SENW,S1/2NE,NWSE.
Oscoda County, Advertised Price \$111,510.25, 109.3 Acres, Hardwood, Aspen.

SALE NOTE: Good access to this sale from Franks road. Portions of this sale are adjacent to the high voltage power line. Consumers Energy will need to be contacted before operations can begin. Good timber with some variable terrain. Some payment units have seasonal restrictions.

Access may be through private land.

BID INSTRUCTIONS (VER. 10/10/2022):

1. Scheduled Bid Location, Date, and Time (2/11)

Bids must be received by the Unit Manager, GRAYLING OFFICE, 1955 HARTWICK PINES ROAD, GRAYLING, MI 49738, no later than 9:00 a.m. (local time) on May 18, 2026. For further information concerning this sale, contact Tom Barnes at 231-384-7732 extension .

2. Bidder's Qualifications (10/22)

If all or part of a timber sale was prepared by a private contractor, the contractor and that contractor's company are not permitted to bid on the timber sale. A person must be 18 years of age or older to purchase timber. Permanent employees of the Department of Natural Resources or members of their immediate household may not bid. Former employees, in the permanent or seasonal class, may not bid until 3 months after the last day of active duty. Bids will not be accepted from individuals or companies appearing on the DNR/FRD No-Bid List. This list contains the names of purchasers who previously failed to execute a contract within 21-days or who have a history of poor performance.

3. Preparation of Sealed Bids (5/16)

Bid Forms may be completed online thru Michigan DNR Timber Sale Online Bidding (OLB) at www.michigan.gov/timberbidding or by completing the hardcopy Bid Form found in the Timber Sale Prospectus . Hardcopy Bid Forms shall be manually signed in ink. Registration in OLB is considered your 'signature' for all bids submitted thru that system. Bid prices must be entered for each species and product in the Bid Price column for all material subject to bidding and all fill-in blanks must be completed. If erasures or other changes appear on the hardcopy Bid Form, each erasure or change must be initialed by the person signing the bid.

4. Submission of Sealed Bids (5/16)

Bid forms may be obtained from the Unit Manager or thru OLB. Bids may be submitted hardcopy or thru OLB. All hardcopy bids must be submitted on the bid form and in an envelope clearly identified as described in this section. NOTE: Only one bid form per bid envelope. Sealed bids must be submitted to the Unit office designated in the prospectus and must be submitted at or prior to the time established in the prospectus. The envelope should show on the outside (a) the sale name or number and (b) the date and time of bid opening, as shown in the prospectus. Bids received after the time specified in the sale prospectus are late bids and will be rejected.

It is possible for a bidder to submit multiple bids on a single sale. For example, a bid may be submitted hardcopy and a bid may be submitted thru OLB. Or, two bidders from the same company could both submit bids on the same sale. If this were to happen, the State would accept all bids received and award the contract accordingly. All bidding and contractual requirements would apply to all bids received.

5. Public Opening of Sealed Bids (7/16)

If conditions permit, the sealed bids will be publicly opened and posted at the time and place set in the prospectus.

If a bidder, present at a bid opening, has submitted bids on more than one sale, that bidder may withdraw their unopened bid envelopes or announce the withdrawal of their online bid after being declared the successful bidder on one sale.

6. Award of Contract (1/11)

Award of the contract will be made to the Bidder whose bid, conforming to the prospectus, is most advantageous to the State of Michigan on the basis of total value at rates bid for the estimated quantities. The State reserves the right to reject any bid or waive any minor irregularity in bids received. A written award mailed (or otherwise furnished) to the successful Bidder shall be deemed to result in a binding contract without further action by either party.

7. Down Payment (1/11)

The Bidder to whom award is made must make a down payment within 21 days of the sale award. The amount of the down payment will be calculated as shown in the Bond and Payment Schedule of this prospectus. Only cash may be used to meet this requirement.

8. Performance Security (1/11)

As guarantee of faithful performance, a cash bond, certificate of deposit, surety bond or irrevocable letter of credit (LOC) is required within 21 days of the sale award. The amount of the performance security is shown in the Bond and

Payment Schedule of this prospectus. If an LOC or surety is used, the coverage must extend for at least 6 months beyond the contract expiration.

9. Worker's Compensation (10/22)

Purchaser shall obtain worker's compensation insurance to cover claims under Michigan's Worker's Disability Compensation Act of 1969 or similar employee benefit act of any other state applicable to an employee. Verification of Worker's Disability Compensation Act Compliance must be completed and submitted within 21 days of contract award and prior to the issuance of the timber sale contract. In addition, if applicable, Notice of Exclusion or Certificate of Insurance must also be submitted.

10. Timber Sale Contract (10/22)

Additional conditions and requirements common to all timber sales are listed on the timber sale contract (R4031) and are available on line at www.michigan.gov/timber. Contact the Unit Manager for additional information or a sample contract. Within 21 days of the date of the award letter, the bidder must sign the contract and provide the required down payment, performance security, and verification of worker's disability compensation. The down payment and performance security shall be in accordance with the provisions of the timber sale contract, in the sums stated in this prospectus. If these actions are not taken, then the Bidder, the Bidder's corporation, and the corporation's principals may not be permitted to bid on State timber sales for a period of 3 months after the first offense, 6 months after the second offense, and 1 year after the third offense. An offense will only be counted against the Bidder for 5 years. In addition, the Bidder certifies that if awarded this contract, the Bidder will complete the timber sale contract in accordance with its terms and any modifications thereof including requirements to purchase, cut, and remove the included timber by the expiration date.

Payment Unit values in the State Forest Timber Sale Contract are calculated based on the advertised value of the Payment Unit as a percentage of the total advertised value of the contract. The advertised value of each Payment Unit is given in the Description of Timber by Payment Unit table on the Timber Sale Information page. For example, if the value of Payment Unit 1 is advertised as \$1,500 and the total Timber Sale value is advertised as \$10,000, the contract price for Payment Unit 1 will be 15% of the total bid price ($\$1,500/\$10,000 * 100$).

11. Disclaimer of Estimates and Bidder's Warranty of Inspection (10/22)

Before submitting this bid, the Bidder is advised and cautioned to inspect the sale area, review the requirements of the sale contract, and take other steps as may be reasonably necessary to ascertain the location, estimated volumes, construction estimates, and operating costs of the proposed sale. Failure to do so will not relieve the Bidder from responsibility for completing the contract.

The Bidder warrants that this bid is submitted solely on the basis of the Bidder's examination and inspection of the quality and quantity of the timber offered for sale and the Bidder's opinion of the value thereof and the costs of recovery. No reliance should be placed on the State of Michigan's estimates of timber quality, quantity or costs of recovery. Bidder further acknowledges that the State of Michigan: (i) expressly disclaims any warranty of fitness of timber for any purpose; (ii) offers this timber as is without any warranty of quality (merchantability) or quantity and (iii) expressly disclaims any warranty as to the quantity or quality of timber sold.

12. Certification and Chain-of-Custody (10/22)

Unless otherwise indicated in the contract under section 7 – Other Conditions of the Sale Specific Conditions & Requirements, the area encompassed by this timber sale is certified to the standards of the Forest Stewardship Council (FSC) - Certificate #SCS-FM/COC-00090N and the Sustainable Forestry Initiative (SFI) - Certificate #NSF-SFIS-5Y031-SF5. Forest products from this sale may be delivered to the mill as "FSC 100% and / or SFI certified" as long as the contractor hauling the forest products is chain-of-custody (COC) certified or covered under a COC certificate from the destination mill. The purchaser is responsible for maintaining COC after leaving the sale area.

13. Good Neighbor Authority (GNA) Requirements (10/22)

If the name of this timber sales contains the acronym GNA, it is authorized by the Good Neighbor Authority (GNA) and covered by various agreements between the U.S. Forest Service and the State. The timber sale occurs on federal land and the following conditions apply:

GNA contracts on US Forest Service land will not be awarded to purchasers on the Federal list of excluded parties. The System for Award Management (SAM) will be checked for active excluded parties prior to award of contract. In

addition, the Bidder to whom award is made must complete an Assurance Regarding Felony Conviction or Tax Delinquent Status for Corporate Applicants (AD-3031).

14. Good Neighbor Authority (GNA) Requirements, con't (10/22)

Bidder certifies, by signing this bid form, that to the best of Bidder's knowledge that the following representations are accurate and complete.

- a. That the Bidder and its principals are not presently debarred, suspended, proposed for debarment, declared ineligible, or voluntary excluded from timber sales (covered transactions) by any Federal department or agency.
- b. That the Bidder and its principals have not within a 3-year period preceding this bid been convicted of or had a civil judgment rendered against them for commission of fraud or a criminal offense in connection with obtaining , attempting to obtain, or performing a public (Federal, State, or local) transaction or contract under a public transaction; violation of Federal or State antitrust statutes or commission of embezzlement, theft, forgery, bribery, falsification or destruction of records, making false statements, or receiving stolen property.
- c. That the Bidder and its principals are not presently indicted for or otherwise criminally or civilly charged by a governmental entity (Federal, State, or local) with commission of any of the offenses enumerated in paragraph b of this certification.
- d. That the Bidder and its principals have not within a 3-year period preceding this bid had one or more public transactions (Federal, State, or local) terminated for breach or default of a timber or forest product contract.

Bidders that cannot certify this requirement, in whole or in part, shall submit an explanation with their bid.

Scott Bowen
Director

TIMBER SALE INFORMATION

Joan of Arctic Mix (72-006-26)
 T28N, R04W, SEC. 5; T28N, R04W, SEC. 6; T28N, R04W, SEC. 8.
 Crawford County (Advertised Price \$20,300.00)

SALE NOTE: This sale is within Eastern Massasauga Rattlesnake habitat. Special protection trees were not cruised. Note: Original sale was prepped in 2020. Sale was forfeited in 2025 without being cut. New sale created using old cruise data and specs to re-sell in 2026. Boundary paint is old and may be difficult to follow in places. Paint may need to be freshened up along boundaries by sale administrator prior to operations beginning.

A recreation site such as a trail, pathway, or campground is within the sale area or the vicinity. Certain restrictions/specifications may be applicable including time restrictions.

A timber sale contract for this lump sum, sealed bid timber sale will be awarded to the responsible bidder offering the highest sealed bid price. All units of volume listed below were estimated using the T-Sale computer program and our traditional volume equations. Bids must be at or above the following advertised price for each product and species:

<u>PRODUCTS & SPECIES</u>	<u>ESTIMATED UNITS*</u>	<u>ADVERTISED PRICE</u>
Sawtimber		
Red Pine	36.9 MBF	\$ 120.00 / MBF
Pulpwood		
Balsam Fir	17 Cords	\$ 16.10 / Cord
Jack Pine	63 Cords	\$ 10.50 / Cord
Mixed Aspen	476 Cords	\$ 16.85 / Cord
Mixed Hardwood	16 Cords	\$ 19.45 / Cord
Red Oak	11 Cords	\$ 16.70 / Cord
Red Pine	128 Cords	\$ 40.00 / Cord
White Pine	91 Cords	\$ 14.30 / Cord

* The total volume is statistically estimated within plus (+) or minus (-) 17.43 percent. There are an estimated 875 cords on this timber sale, plus or minus 153 cords at the 95% confidence level. The estimated units are final and not subject to adjustment. Prospective bidders are urged to examine this timber and to make their own estimates of quantity and quality.

BOND AND PAYMENT SCHEDULE:

1. A bond in the amount of \$1,015.00 to insure faithful performance of the conditions of the contract will be deposited by the successful bidder within 21 days of the sale award.
2. Cutting in any sale or unit without the required advance payment would be considered a trespass.
3. Total payment must be paid in advance or according to the following schedule :
 - (a) Ten percent (10%) of the sale value must be paid within 21 days of the sale award.
 - (b) The 10% down payment will be credited towards the first unit cut.
 - (c) Payment for each of the following units must be made before cutting begins in that unit:

PAYMENT UNIT NUMBER	PERCENT OF TOTAL SALE VALUE
01	17.1%
02	44.5%
03	38.4%
4. If no cutting takes place, the 10% down payment will not be refunded.
5. Operations on the contract issued will terminate on 06/30/2028.

SALE STATISTICS

SALE VOLUMES

VOLUME			STATISTICAL RANGE IN CORDS	
TOTAL CUBIC FEET	TOTAL CORDS	PERCENT ERROR	MINIMUM	MAXIMUM
69,142	875	17.43%	723	1,028

VDU VOLUMES

A VDU is a Volume Determination Unit. Volumes and their associated statistics are calculated at the VDU level and summarized to the sale level. There is often a one to one relationship between a VDU and a Payment Unit, but not always, depending on the cruise design. Refer to the VDU TO PAYMENT UNIT table.

VDU	VOLUME		PERCENT ERROR	RANGE IN CORDS	
	TOTAL CUBIC FEET	TOTAL CORDS		MINIMUM	MAXIMUM
29	0	0	19.57%	0	0
32	0	0	19.46%	0	0
TOTAL:	0	0		0	0

VDU TO PAYMENT UNIT

When a VDU is associated with more than one Payment Unit (PU), the VDU volumes are assigned to the PU based on acres of the VDU within the PU.

VDU	VDU ACRES	PU	PU ACRES
TOTAL:			

DESCRIPTION OF TIMBER BY PAYMENT UNIT (PU)

PU	MARKET GROUP	PRODUCT	QUANTITY	UNIT	ACRES	ADVERTISE PRICE
1	Red Pine	Sawtimber	3.5	MBF	18.3	\$3,480.40
	Balsam Fir	Pulpwood	4	Cords		
	Jack Pine		7	Cords		
	Mixed Aspen		109	Cords		
	<i>B. T. Aspen</i>	<i>Sawtimber</i>	2.1	<i>MBF</i>		
	<i>B. T. Aspen</i>	<i>Pulpwood</i>	50	<i>Cords</i>		
	<i>Quaking Aspen</i>		55	<i>Cords</i>		
	Mixed Hardwood		3	Cords		
	<i>Red Maple</i>	<i>Sawtimber</i>	0.2	<i>MBF</i>		
	<i>Red Maple</i>	<i>Pulpwood</i>	3	<i>Cords</i>		
	Red Oak		3	Cords		
	<i>Red Oak</i>	<i>Sawtimber</i>	0.3	<i>MBF</i>		
	<i>Red Oak</i>	<i>Pulpwood</i>	2	<i>Cords</i>		
	Red Pine		18	Cords		
	White Pine		18	Cords		
	<i>White Pine</i>	<i>Sawtimber</i>	0.2	<i>MBF</i>		
	<i>White Pine</i>	<i>Pulpwood</i>	18	<i>Cords</i>		
2	Red Pine	Sawtimber	25.6	MBF	28.0	\$9,008.10
	Balsam Fir	Pulpwood	4	Cords		
	Jack Pine		41	Cords		
	Mixed Aspen		122	Cords		
	<i>B. T. Aspen</i>	<i>Sawtimber</i>	2.4	<i>MBF</i>		
	<i>B. T. Aspen</i>	<i>Pulpwood</i>	55	<i>Cords</i>		
	<i>Quaking Aspen</i>		62	<i>Cords</i>		
	Mixed Hardwood		4	Cords		
	<i>Red Maple</i>	<i>Sawtimber</i>	0.2	<i>MBF</i>		
	<i>Paper Birch</i>	<i>Pulpwood</i>	1	<i>Cords</i>		
	<i>Red Maple</i>		3	<i>Cords</i>		
	Red Oak		3	Cords		
	<i>Red Oak</i>	<i>Sawtimber</i>	0.4	<i>MBF</i>		
	<i>Red Oak</i>	<i>Pulpwood</i>	2	<i>Cords</i>		
	Red Pine		70	Cords		
	White Pine		32	Cords		
	<i>White Pine</i>	<i>Sawtimber</i>	0.3	<i>MBF</i>		
<i>White Pine</i>	<i>Pulpwood</i>	31	<i>Cords</i>			
3	Red Pine	Sawtimber	7.8	MBF	41.0	\$7,792.05
	Balsam Fir	Pulpwood	9	Cords		
	Jack Pine		15	Cords		
	Mixed Aspen		245	Cords		
	<i>B. T. Aspen</i>	<i>Sawtimber</i>	4.8	<i>MBF</i>		
	<i>B. T. Aspen</i>	<i>Pulpwood</i>	111	<i>Cords</i>		
	<i>Quaking Aspen</i>		124	<i>Cords</i>		
	Mixed Hardwood		8	Cords		
	<i>Red Maple</i>	<i>Sawtimber</i>	0.5	<i>MBF</i>		
	<i>Paper Birch</i>	<i>Pulpwood</i>	1	<i>Cords</i>		
	<i>Red Maple</i>		6	<i>Cords</i>		
	Red Oak		5	Cords		
	<i>Red Oak</i>	<i>Sawtimber</i>	0.7	<i>MBF</i>		
	<i>Red Oak</i>	<i>Pulpwood</i>	4	<i>Cords</i>		
	Red Pine		40	Cords		
	White Pine		41	Cords		
	<i>White Pine</i>	<i>Sawtimber</i>	0.5	<i>MBF</i>		
<i>White Pine</i>	<i>Pulpwood</i>	40	<i>Cords</i>			
TOTAL:			36.9	MBF		
TOTAL:			801	Cords		

Sale Specific Conditions & Requirements

Sale Name: Joan of Arctic Mix

Sale Number: 72-006-26 Seq#: 1

1 - Sale Area

1.2 - Boundaries

1.2.1 - Painted Boundaries (9/19)

The sale boundary and Payment Unit boundaries are marked and identified by blue, red and yellow paint, and Manistee River Rd. Exterior sale boundaries against private property are marked with blue paint. Exterior sale boundaries against state are marked with red paint. Manistee River Rd is the east boundary of the sale and is unpainted. Interior Payment Unit boundaries are marked with yellow paint. The painted boundary line trees are not Included Timber and are to be protected. Yellow painted trees designating an interior Payment Unit boundary are only to be cut when all surrounding Payment Units have been paid.

2 - Timber Specifications

2.1 - Included Timber

2.1.1 - Clearcut Unit(s) with Unmerchantable Trees (6/14)

Within Payment Unit(s) 1-3, cut all trees that are two (2) inches or more at DBH. Special protection trees identified in accordance with condition 3.4.2, within clearcutting unit boundaries, are not Included Timber and are to be protected.

3 - Payments

3.3 - Pre-measured Sales

3.3.4 - Dividing Payment Units (7/14)

Payment Unit(s) may be divided at the request of the Purchaser and upon approval of the Unit Manager. Dividing Payment Units is a contract modification which requires a Timber Sale Contract Amendment. There will be only one division per Payment Unit.

3.4 - Damaged Timber

3.4.2 - Special Protection Trees (1/25)

The Purchaser shall not cut live or dead special protection trees within cutting units or clearings. Special protection trees are oaks that are 18 inches or more at DBH and red pine that are 26 inches or more at DBH. If Purchaser's operations have cut or damaged special protection trees through carelessness, the Purchaser shall pay \$200 as fixed, agreed and liquidated damages for each special protection tree cut or damaged. Such payment does not constitute ownership of the undesignated timber.

4 - Transportation

4.1 - Construction

4.1.3 - Slash and Earthen Piles (8/04)

Piles or windrows of earth along roads and landings that have been widened or constructed shall be leveled. Slash from road maintenance or construction, including stumps, shall be utilized or dispersed throughout the sale.

4.1.6 - Road Construction (4/24)

Construction of new roads or improvements of existing roads shall be done in such a way as to minimize the environmental and visual impacts. Merchantable trees shall be cut and utilized unless otherwise directed. Non-merchantable trees shall be severed and laid flat on the ground. Slash shall be scattered, not left in windrows and kept a minimum of 10 feet back from the road edge. Stumps shall be set upright, not left on edge, and be moved at least 10 feet away from the road edge. Disturbed soil shall be feathered into the woods and not left in berms or windrows.

4.1.7 - Road Closure (10/11)

All new roads built into the sale must be blocked to vehicle traffic upon completion of the sale. In general, this will require constructing a four (4') foot high berm of stumps and logs covered with earth. Stumps and brush must be placed along the remainder of the trail. Contact the sale administrator for specific details of design and placement.

4.1.11 - Permits (2/12)

The Purchaser will secure any necessary permits that may be required.

5 - Operations

5.1 - Notification

5.1.1 - Pre-sale Conference (10/16)

A pre-sale conference between the Purchaser and Sale Administrator is required prior to beginning any operations to determine landing and road locations. The Unit Manager or his/her representative must be contacted at least 3 days in advance to schedule the conference.

5.1.3 - Well Heads and Natural Gas Pipelines (11/15)

The Purchaser is responsible for contacting the pipeline company prior to operating equipment in the vicinity of well heads or natural gas pipelines. Contact Breitburn Oil and Gas.

5.2 - Conduct of Operations

5.2.1 - Slash

5.2.1.10 - No Slash in Openings (5/10)

No brush or logging debris is to be left in the openings which are indicated by G0 on the Timber Sale Map. Any damage to the opening shall be repaired according to specifications of the Unit Manager or his/her representative.

5.2.1.13 - Dispose of Slash as Directed (12/05)

Slash is to be disposed of as directed by the sale administrator, i.e. flattening taller slash piles near the private property boundary, and well-travelled roads and paths.

5.2.2 - Hazard Trees/Snags

5.2.2.1 - Den Trees (10/16)

Obvious hollow and/or den trees shall be protected and left standing unless they are a safety hazard.

5.2.3 - Operating Restrictions

5.2.3.1 - Operating Restrictions (9/11)

Within Payment Unit(s) 1-3, unless changed by written agreement, cutting and skidding are limited to when the ground is dry or frozen. This restriction is needed to minimize rutting and compaction within lands that are managed for Eastern Massasauga Rattlesnake habitat.

5.2.4 - Dead and Down Creation

5.2.4.6 - Dead and Down Creation, Other (9/09)

The Purchaser is to create no less than 25 slash piles (at least 8 feet long and 4 feet tall) in the west half of the sale, except do not locate brush piles within 50 feet of the parking lot or closed road on the northwest edge of Payment Unit 3.

5.2.29 - Shrub Protection (1/20)

Do not cut or damage hawthorn, witch-hazel, dogwood or juneberry. These woody-shrub plants are highly beneficial to various wildlife species.

5.2.31 - Landing Locations (9/13)

Landing locations will be limited to the east side of the harvest area.

5.2.32 - Decking/Landing Restoration (9/13)

All decking and landing areas must have the surface area restored to a condition equal to or better than before. This is to ensure the proper regeneration of the stand. Wood debris, chips and "cookies" from trimmings must be removed or scattered away from landing and loading areas and may not be windrowed on the edge.

5.2.38 - No Decking Against Live Trees (2/04)

Cut products may not be decked against unmarked or designated leave trees.

5.4 - Soil Protection

5.4.1 - Rutting Restriction, General (7/16)

The Unit Manager or his/her representative may restrict hauling and/or skidding if ruts exceed the specified depth. With the Unit Manager or his/her representative's approval, the Purchaser may return to the area when the risk of rutting has decreased.

6 - Safety and Fire Prevention

6.2 - Signing

6.2.1 - Road posting (9/09)

The Purchaser is responsible for posting and maintaining caution signs on Manistee River Road prior to beginning operations. The road must be posted at appropriate distances from the sale area to warn of logging activity and truck traffic. Signs must be removed when harvest operations are suspended or completed. The Purchaser will provide these signs.



TIMBER SALE MAP

This information provided by authority of Part 525, 1994 PA 451, as amended.

Sale Number	Year
72 - 004	20

Forest Management Unit Grayling	County Crawford	Mapped By Mittig	Date 12/15/2020	Page 1	of 1
Township 28N	Range 04W	Section(s) and Subdivision(s) Sec 5: W1/2NW, SWSW and Sec 6: E1/2NE, SESE	Scale 1:15,840		

Cover Type				Density			
A = Aspen	H = Hemlock	N = Marsh	U = Upland Brush	0 = Non Stocked	5 = Pole Timber Medium		
B = Paper Birch	J = Jack Pine	O = Oak	UM = Upland Mixed	1 = Seedling Sapling Poor	6 = Pole Timber Well		
C = Cedar	L = Lowland Brush	P = Lowland Poplar	V = Bog or Marsh	2 = Seedling Sapling Medium	7 = Saw Timber Poor		
D = Treed Bog	LM = Lowland Mixed	Q = Mixed Swamp Conifer	W = White Pine	3 = Seedling Sapling Well	8 = Saw Timber Medium		
E = Swamp Hdwoods	M = Mpl, Bch, Brch	R = Red Pine	X = Non Stocked	4 = Pole Timber Poor	9 = Saw Timber Well		
F = Spruce Fir	MC = Mixed Conifer	S = Black Spruce	Z = Water				
G = Grass	MD = Mixed Deciduous	T = Tamarack					

PU	Acres
1	18.3
2	28
3	41



Joan of Arctic Mix

Compartment 169

87.3 Acres

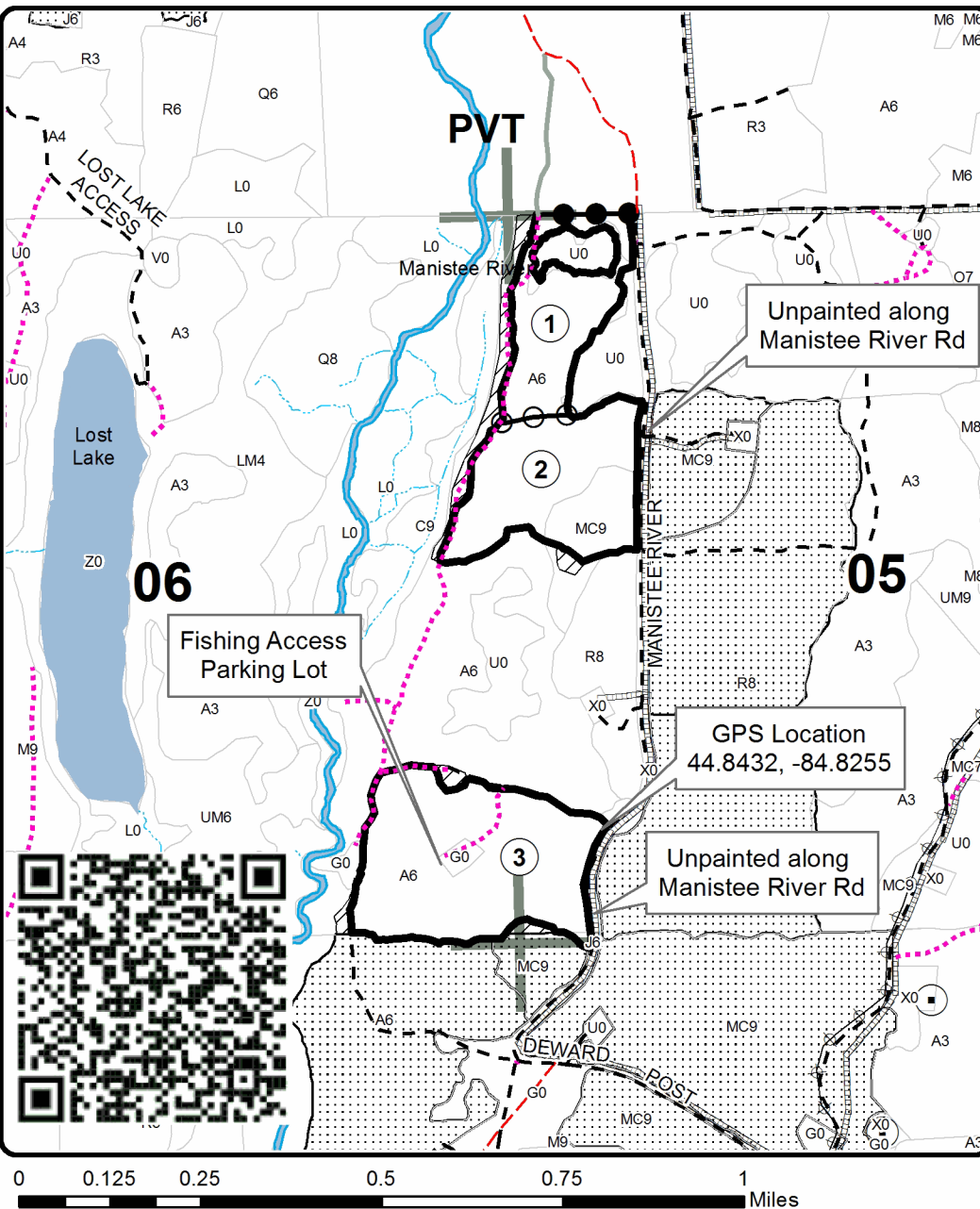

Legend

- Against State (Red)
- Payment Unit (Yellow)
- Private Line (Blue)
- Payment Unit
- Retention Area
- Nearby Timber Sales
- Stand Boundaries
- Oil & Gas Well Surface Locations
- Pipeline
- Powerline
- Forest Access Route
- County Road - Seasonal
- Private
- Temporary Management Access
- Intermittent Stream
- Perennial River
- Lakes and Rivers
- Section Corners

Locator Map

1:100,000

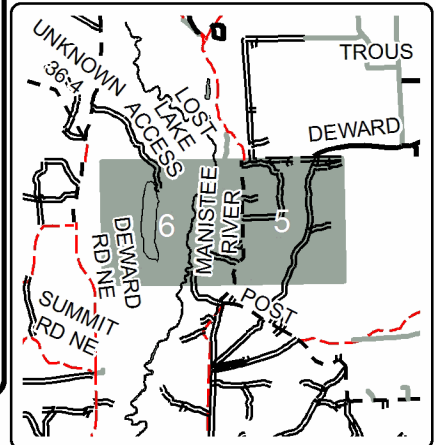

TIMBER SALE INFORMATION

Ice-orcist (72-034-25)

T28N, R02E, SEC. 23; T28N, R02E, SEC. 25; T28N, R02E, SEC. 26; T28N, R02E, SEC. 35.
Oscoda County (Advertised Price \$18,195.10)

SALE NOTE: 7.5.1 - Deteriorating Timber (7/09) The Sale Area has received damage from the 2025 ice storm. The Purchaser should harvest the wood as soon as possible. Snowmobile trail and ORV trail specs included. This sale has a 2-year contract length with no extensions allowed. Oil and gas infrastructure is present within the vicinity of the sale area. Line locations are unknown and not identified on the ground or on the map. Therefore, the purchaser must contact Muzyl Oil Corporation at 989-732-8100 to identify infrastructure prior to operations beginning.

A recreation site such as a trail, pathway, or campground is within the sale area or the vicinity. Certain restrictions/specifications may be applicable including time restrictions.

A timber sale contract for this lump sum, sealed bid timber sale will be awarded to the responsible bidder offering the highest sealed bid price. All units of volume listed below were estimated using the Inventory Manager computer program and the new Michigan taper model. Bids must be at or above the following advertised price for each product and species:

<u>PRODUCTS & SPECIES</u>	<u>ESTIMATED UNITS*</u>		<u>ADVERTISED PRICE</u>	
Sawtimber				
Black/Red (Hybrid) Oak	12.9	MBF	\$	27.00 / MBF
Pulpwood				
Jack Pine	42	Cords	\$	2.80 / Cord
Mixed Aspen	2,534	Cords	\$	4.50 / Cord
Mixed Hardwood	374	Cords	\$	5.20 / Cord
Mixed Oak	231	Cords	\$	4.45 / Cord
Red Pine	185	Cords	\$	10.65 / Cord
White Pine	364	Cords	\$	3.80 / Cord

* The total volume is statistically estimated within plus (+) or minus (-) 26.38 percent. There are an estimated 3,766 cords on this timber sale, plus or minus 994 cords at the 95% confidence level. The estimated units are final and not subject to adjustment. Prospective bidders are urged to examine this timber and to make their own estimates of quantity and quality.

BOND AND PAYMENT SCHEDULE:

1. A bond in the amount of \$1,000.00 to insure faithful performance of the conditions of the contract will be deposited by the successful bidder within 21 days of the sale award.
2. Cutting in any sale or unit without the required advance payment would be considered a trespass.
3. Total payment must be paid in advance or according to the following schedule :
 - (a) Ten percent (10%) of the sale value must be paid within 21 days of the sale award.
 - (b) The 10% down payment will be credited towards the first unit cut.
 - (c) Payment for each of the following units must be made before cutting begins in that unit:

PAYMENT UNIT NUMBER	PERCENT OF TOTAL SALE VALUE
01	41.8%
02	13.7%
03	44.5%
4. If no cutting takes place, the 10% down payment will not be refunded.
5. Operations on the contract issued will terminate on 06/30/2028.

SALE STATISTICS

Volumes were calculated in cubic feet using the Michigan taper model. Cubic foot volume includes all wood inside bark for the product indicated. For display purposes, cubic feet were converted to cords and MBF using a simple conversion factor, e.g. 79 cubic feet per cord and 185 cubic feet per MBF. The cubic foot volumes are precise; the cords and MBF volumes are not. Cubic foot volume cannot be directly converted to cords or boards with precision.

SALE VOLUMES

The total estimated sale volume may not equal the sum of the species/products due to the nature of statistical calculations associated with double sampling methodology.

VOLUME		STATISTICAL RANGE IN CORDS		
TOTAL CUBIC FEET	TOTAL CORDS	PERCENT ERROR	MINIMUM	MAXIMUM
297,548	3,766	26.38%	2,772	4,760

VDU VOLUMES

A VDU is a Volume Determination Unit. Volumes and their associated statistics are calculated at the VDU level and summarized to the sale level. There is often a one to one relationship between a VDU and a Payment Unit, but not always, depending on the cruise design. Refer to the VDU TO PAYMENT UNIT table.

VDU	VOLUME		PERCENT ERROR	RANGE IN CORDS	
	TOTAL CUBIC FEET	TOTAL CORDS		MINIMUM	MAXIMUM
57	98,032	1,241	58.74%	512	1,970
58	24,732	313	86.10%	44	583
62	69,324	878	59.77%	353	1,402
64	50,250	636	54.73%	288	984
68	32,879	416	42.05%	241	591
80	13,552	172	111.08%	0	362
962	8,778	111	67.73%	36	186
TOTAL:	297,548	3,766		1,474	6,078

VDU TO PAYMENT UNIT

When a VDU is associated with more than one Payment Unit (PU), the VDU volumes are assigned to the PU based on acres of the VDU within the PU.

VDU	VDU ACRES	PU	PU ACRES
TOTAL:			

DESCRIPTION OF TIMBER BY PAYMENT UNIT (PU)

PU	MARKET GROUP	PRODUCT	QUANTITY	UNIT	ACRES	ADVERTISE PRICE
1	Black/Red (Hybrid)	Sawtimber	12.8	MBF	139.6	\$7,596.70
	Jack Pine	Pulpwood	42	Cords		
	Mixed Aspen		883	Cords		
	<i>B. T. Aspen</i>		589	Cords		
	<i>Quaking Aspen</i>		294	Cords		
	Mixed Hardwood		170	Cords		
	<i>Red Maple</i>	Sawtimber	2.7	MBF		
	<i>Black Cherry</i>	Pulpwood	57	Cords		
	<i>Red Maple</i>		108	Cords		
	Mixed Oak		151	Cords		
	<i>/Red (Hybrid) Oak</i>		151	Cords		
	Red Pine		121	Cords		
	White Pine		83	Cords		
	2	Black/Red (Hybrid)	Sawtimber	0.1		
Mixed Aspen		Pulpwood	428	Cords		
<i>B. T. Aspen</i>			224	Cords		
<i>Quaking Aspen</i>			204	Cords		
Mixed Hardwood			41	Cords		
<i>Red Maple</i>		Sawtimber	1.8	MBF		
<i>Black Cherry</i>		Pulpwood	8	Cords		
<i>Red Maple</i>			29	Cords		
Mixed Oak			26	Cords		
<i>/Red (Hybrid) Oak</i>			26	Cords		
White Pine			64	Cords		
3	Mixed Aspen	Pulpwood	1,223	Cords	63.5	\$8,097.60
	<i>B. T. Aspen</i>		198	Cords		
	<i>Balsam Poplar</i>		101	Cords		
	<i>Quaking Aspen</i>		924	Cords		
	Mixed Hardwood		163	Cords		
	<i>Paper Birch</i>	Sawtimber	5.0	MBF		
	<i>Red Maple</i>		3.1	MBF		
	<i>Black Cherry</i>	Pulpwood	60	Cords		
	<i>Paper Birch</i>		13	Cords		
	<i>Red Maple</i>		74	Cords		
	Mixed Oak		54	Cords		
	<i>/Red (Hybrid) Oak</i>		3	Cords		
	<i>Red Oak</i>		51	Cords		
	Red Pine		64	Cords		
	White Pine		217	Cords		
TOTAL:			12.9	MBF		
TOTAL:			3,730	Cords		

Sale Specific Conditions & Requirements

Sale Name: Ice-orcist

Sale Number: 72-034-25 Seq#: 3

1 - Sale Area

1.2 - Boundaries

1.2.1 - Painted Boundaries (9/19)

The sale boundary and Payment Unit boundaries are marked and identified by red paint, designated cover-type changes, and designated un-marked road as identified on the Timber Sale Map. Exterior sale boundary lines against state are marked with red paint, designated cover-type changes, and designated un-marked roads. Interior Payment Unit boundaries are designated by un-marked, un-named two track. Retention patches are marked with red paint; no harvesting activities may occur within these areas. The painted boundary line trees are not Included Timber and are to be protected.

2 - Timber Specifications

2.1 - Included Timber

2.1.1 - Clearcut Unit(s) with Unmerchantable Trees (6/14)

Within Payment Unit(s) 1-3, cut all trees that are two (2) inches or more at DBH, except do not cut any trees that are designated with green paint. In addition, do not cut any oak or pine that are 26" or greater at DBH; these are considered legacy trees and fall under Special Protection Trees. Special protection trees identified in accordance with condition 3.4.2, within clearcutting unit boundaries, are not Included Timber and are to be protected.

3 - Payments

3.4 - Damaged Timber

3.4.1 - Damaged Timber (12/24)

General Condition and Requirement 3.4 Damaged Timber, defines liquidated damages for undesignated live merchantable trees which are cut or injured. No damage is acceptable to undesignated live merchantable trees. Within the Sale Area, if more than 10% of trees (> 4.5" DBH) within a specified area of the sale are damaged, liquidated damages will be assessed for all trees damaged. Rates will be in accordance with General Condition and Requirement 3.4 Damaged Timber.

3.4.2 - Special Protection Trees (1/25)

The Purchaser shall not cut live or dead special protection trees within cutting units or clearings. Special protection trees are the non-aspen species that are 26" or greater at DBH. If Purchaser's operations have cut or damaged special protection trees through carelessness, the Purchaser shall pay \$500 as fixed, agreed and liquidated damages for each special protection tree cut or damaged. Such payment does not constitute ownership of the undesignated timber.

4 - Transportation

4.1 - Construction

4.1.3 - Slash and Earthen Piles (8/04)

Piles or windrows of earth along roads and landings that have been widened or constructed shall be leveled. Slash from road maintenance or construction, including stumps, shall be dispersed throughout the sale.

4.1.6 - Road Construction (4/24)

Construction of new roads or improvements of existing roads shall be done in such a way as to minimize the environmental and visual impacts. Merchantable trees shall be cut and utilized unless otherwise directed. Non-merchantable trees shall be severed and laid flat on the ground. Slash shall be scattered, not left in windrows, and kept a minimum of 10 feet back from the road edge. Stumps shall be set upright, not left on edge, and be moved at least 10 feet away from the road edge. Disturbed soil shall be feathered into the woods and not left in berms or windrows.

4.1.7 - Road Closure (10/11)

All new roads built into the sale must be blocked to vehicle traffic upon completion of the sale. Overgrown roads that are reopened shall be considered new roads. In general, this will require constructing a four (4') foot high berm of stumps and logs covered with earth. These roads must be rendered impassable to cars and trucks. Temporary berms may be required if no sale activity occurs for 30 or more consecutive days. Contact the Sale Administrator for specific details of design and

placement.

4.1.11 - Permits (2/12)

The Purchaser will secure any necessary permits that may be required.

5 - Operations

5.1 - Notification

5.1.3 - Well Heads and Natural Gas Pipelines (11/15)

The Purchaser is responsible for contacting the gas company prior to operating equipment in the vicinity of well heads or natural gas pipelines. Line locations are unknown and not identified on the ground or on the map. Therefore, the purchaser must contact Muzyl Oil Corporation at 989-732-8100 to identify infrastructure prior to operations beginning.

5.2 - Conduct of Operations

5.2.2 - Hazard Trees/Snags

5.2.2.1 - Den Trees (10/16)

Obvious hollow and/or den trees shall be protected and left standing unless they are a safety hazard.

5.2.4 - Dead and Down Creation

5.2.4.4 - Dead and Down Creation, Grouse (6/18)

To encourage grouse and other wildlife, in Payment Unit(s) 1-3, leave one, 12" diameter or larger log-length (8 foot minimum) piece on the ground for every two (2) acres. These will be evenly scattered throughout each Payment Unit. These trees will be evenly scattered throughout the Payment Unit, preferably at least two chains from any roads, two-tracks, or trails open to vehicles. This can be an unmerchantable piece or a full tree.

5.2.29 - Shrub Protection (1/20)

Reasonable care shall be taken to avoid damage to Juneberry (Serviceberry) and Hawthorn within the sale area. These woody-shrub plants are highly beneficial to various wildlife species.

5.2.32 - Decking/Landing Restoration (9/13)

All decking and landing areas must have the surface area restored to a condition equal to or better than before. This is to ensure the proper regeneration of the stand. Wood debris, chips and "cookies" from trimmings must be removed or scattered away from landing and loading areas and may not be windrowed on the edge.

5.2.38 - No Decking Against Live Trees (2/04)

Cut products may not be decked against unmarked or designated leave trees.

5.2.41 - Snowmobile Trail Protection (9/11)

The Mio ORV Route/Snowmobile Trail 4/9 is a snowmobile/ORV trail and is shown on the Timber Sale Map. Do not cut or damage posts with orange trail markers or traffic control signs. If the trail is used, it must be maintained and restored to a condition equal to or better than before the sale. The road maintenance/restoration must be done prior to December 1. If the trail is used for hauling, it must be graded to the satisfaction of the Unit Manager or his/her representative prior to December 1. If the trail road is to be used for hauling during the snowmobile season, then a snow-covered base must be left on the trail. The snowmobile trail may only be crossed at right angles. Maintain a 20-foot-wide slash, debris, and rut free zone daily using the snowmobile trail as the centerline. No decking of forest products will be permitted along the snowmobile trail. All stumps within 5 feet of the snowmobile trail must be cut at ground level.

5.4 - Soil Protection

5.4.2 - Skid Trails (2/04)

Skid trails up and down slopes should be avoided. If, however, this is unavoidable, these trails will be left in a non-erodible condition using water bars, logs, and slash. Placing of slash on these skid trails while logging is ongoing may alleviate need for any further action. At the direction of the Sale Administrator, seed, fertilizer, and mulch may also be required.

5.8 - Protection of Endangered Species

5.8.5 - Protection of Raptor Nests (3/13)

All trees with raptor nests will be protected if found during harvesting operations. Notification will be made to the Unit

Manager or his/her representative who will notify the Wildlife Biologist so an onsite evaluation and recommendation can be made, if necessary.

6 - Safety and Fire Prevention

6.2 - Signing

6.2.1 - Road Posting (10/20)

The Purchaser is responsible for posting and maintaining caution signs on Pennsylvania Crossing Road prior to beginning operations. The road must be posted at appropriate distances from the Sale Area to warn of logging activity and truck traffic. Signs must be removed when harvest operations are suspended or completed. The Purchaser will provide these signs.

6.2.3 - Recreational Trail Posting (10/20)

The Purchaser is responsible for posting and maintaining caution signs on Mio ORV Route/Snowmobile Trail 4/9 prior to beginning operations. The trail must be posted at appropriate distances from the Sale Area to warn of logging activity and truck traffic at both ends of the trail. Signs must be removed when harvest operations are suspended or completed. The Purchaser will provide these signs.

7 - Other Conditions

7.2 - Extensions

7.2.2 - No Extensions (3/09)

There will be no extensions granted on this contract. This is due to this being a salvage sale as a direct result of the spring 2025 Ice Storm.

7.5 - Loss

7.5.1 - Deteriorating Timber (7/09)

The Sale Area has received damage from the spring 2025 ice storm. The Purchaser should harvest the wood as soon as possible. The Department of Natural Resources is held free of responsibility of any further damage or deterioration due to delay in harvesting.



TIMBER SALE MAP

This information provided by authority of Part 525, 1994 PA 451, as amended.

Sale Number

72-034-25

Date

09/18/2025

Forest Management Unit

County

Mapped By: Halabut, McClarren

Scale

Page

Of

Grayling Mgt Unit

Oscoda

Cruised By: Halabut, McClarren, Porteous

1:15,840

1

1

Township
28N

Range
02E

Section(s) and
Subdivision(s) N1/2NW,SWNW,W1/2NE;

Sec. 23 S1/2SE; Sec. 25 NWNW; Sec. 26 E1/2NW,NE,NESW,S1/2SW,N1/2SE; Sec. 35

Cover Type

A = Aspen	J = Jack Pine	O = Oak	U = Upland Brush
B = Paper Birch	K = Rock	P = Lowland Poplar	UM = Upland Mix Forest
C = Cedar	L = Lowland Brush	Q = Mixed Swamp Conifer	V = Bog or Marsh
D = Treed Bog	LM = Lowland Mix Forest	R = Red Pine	W = White Pine
E = Swamp Hardwoods	M = Maple, Beech, Birch	S = Black Spruce	X = Non Stocked
F = Spruce/Fir	MC = Mixed Conifer	T = Tamarack	Y = Sand
G = Grass	MD = Mixed Deciduous	Z = Water	
H = Hemlock	N = Marsh		

Density

0 = Non Stocked	5 = Pole Timber Medium
1 = Seedling Sapling Poor	6 = Pole Timber Well
2 = Seedling Sapling Medium	7 = Saw Timber Poor
3 = Seedling Sapling Well	8 = Saw Timber Medium
4 = Pole Timber Poor	9 = Saw Timber Well

Payment Unit Number

Acres

1	139.6
2	18.2
3	63.5

The Ice-orcist
221.3 Acres

Legend

- Payment Unit
- Against State (Red)
- Against State (Unpainted Road)
- Against State (Cover Type Change)
- Payment Unit (Unpainted Road)
- Retention Areas
- Nearby Timber Sale
- Secondary Forest Road
- Forest Access Route
- Administrative Access Only
- Non-DNR Road
- Well Site

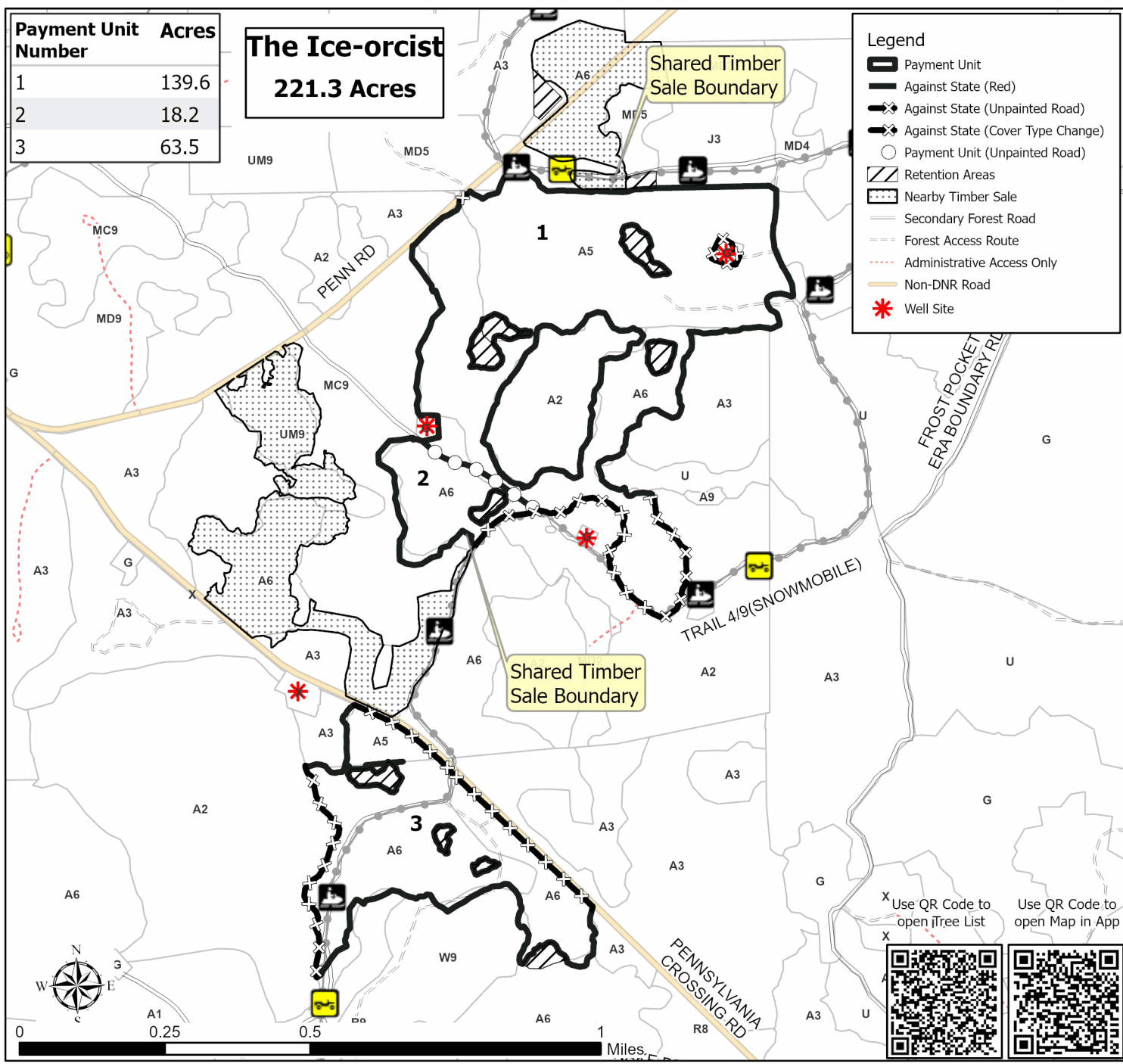

TIMBER SALE INFORMATION

Ice- Bark Souls (72-041-25)
T28N, R03E, SEC. 20.
Oscoda County (Advertised Price \$6,428.75)

SALE NOTE: This is an ice storm salvage sale. Note that this is a 2-year contract.

This sale should be cut as soon as possible. No extensions for this sale will be granted.

It is recommended that the Purchaser use the provided georeferenced map as a guide as there are no visual markers of some sale boundaries other than timber type changes or roads.

The Purchaser should also be aware that some of the terrain in the sale is steep, and extra caution should be used while operating in those areas.

A recreation site such as a trail, pathway, or campground is within the sale area or the vicinity. Certain restrictions/specifications may be applicable including time restrictions.

A timber sale contract for this lump sum, sealed bid timber sale will be awarded to the responsible bidder offering the highest sealed bid price. All units of volume listed below were estimated using the Inventory Manager computer program and the new Michigan taper model. Bids must be at or above the following advertised price for each product and species:

<u>PRODUCTS & SPECIES</u>	<u>ESTIMATED UNITS*</u>	<u>ADVERTISED PRICE</u>
Sawtimber		
Sugar Maple	14.0 MBF	\$ 49.00 / MBF
Pulpwood		
Black/Red (Hybrid) Oak	5 Cords	\$ 4.45 / Cord
Mixed Aspen	1,055 Cords	\$ 4.50 / Cord
Mixed Hardwood	182 Cords	\$ 5.20 / Cord
White Pine	7 Cords	\$ 3.80 / Cord

* The total volume is statistically estimated within plus (+) or minus (-) 24.87 percent. There are an estimated 1,282 cords on this timber sale, plus or minus 319 cords at the 95% confidence level. The estimated units are final and not subject to adjustment. Prospective bidders are urged to examine this timber and to make their own estimates of quantity and quality.

BOND AND PAYMENT SCHEDULE:

1. A bond in the amount of \$1,000.00 to insure faithful performance of the conditions of the contract will be deposited by the successful bidder within 21 days of the sale award.
2. Cutting in any sale or unit without the required advance payment would be considered a trespass.
3. Total payment must be paid in advance or according to the following schedule :
 - (a) Ten percent (10%) of the sale value must be paid within 21 days of the sale award.
 - (b) The 10% down payment will be credited towards the first unit cut.
 - (c) Payment for each of the following units must be made before cutting begins in that unit:

PAYMENT UNIT NUMBER	PERCENT OF TOTAL SALE VALUE
01	26.9%
02	73.1%

4. If no cutting takes place, the 10% down payment will not be refunded.
5. Operations on the contract issued will terminate on 06/30/2028.

SALE STATISTICS

Volumes were calculated in cubic feet using the Michigan taper model. Cubic foot volume includes all wood inside bark for the product indicated. For display purposes, cubic feet were converted to cords and MBF using a simple conversion factor, e.g. 79 cubic feet per cord and 185 cubic feet per MBF. The cubic foot volumes are precise; the cords and MBF volumes are not. Cubic foot volume cannot be directly converted to cords or boards with precision.

SALE VOLUMES

The total estimated sale volume may not equal the sum of the species/products due to the nature of statistical calculations associated with double sampling methodology.

VOLUME			STATISTICAL RANGE IN CORDS	
TOTAL CUBIC FEET	TOTAL CORDS	PERCENT ERROR	MINIMUM	MAXIMUM
101,265	1,282	24.87%	963	1,601

VDU VOLUMES

A VDU is a Volume Determination Unit. Volumes and their associated statistics are calculated at the VDU level and summarized to the sale level. There is often a one to one relationship between a VDU and a Payment Unit, but not always, depending on the cruise design. Refer to the VDU TO PAYMENT UNIT table.

	VOLUME			RANGE IN CORDS	
VDU	TOTAL CUBIC FEET	TOTAL CORDS	PERCENT ERROR	MINIMUM	MAXIMUM
19	30,094	381	37.01%	240	522
24	71,171	901	32.10%	612	1,190
TOTAL:	101,265	1,282		852	1,712

VDU TO PAYMENT UNIT

When a VDU is associated with more than one Payment Unit (PU), the VDU volumes are assigned to the PU based on acres of the VDU within the PU.

VDU	VDU ACRES	PU	PU ACRES
TOTAL:			

DESCRIPTION OF TIMBER BY PAYMENT UNIT (PU)

PU	MARKET GROUP	PRODUCT	QUANTITY	UNIT	ACRES	ADVERTISE PRICE				
1	Black/Red (Hybrid)	Pulpwood	2	Cords	16.1	\$1,731.20				
	Mixed Aspen		355	Cords						
	<i>B. T. Aspen</i>		355	<i>Cords</i>						
	Mixed Hardwood		24	Cords						
	<i>Basswood</i>		3	<i>Cords</i>						
	<i>Black Cherry</i>		2	<i>Cords</i>						
	<i>Sugar Maple</i>		4	<i>Cords</i>						
	<i>White Ash</i>		15	<i>Cords</i>						
	2		Sugar Maple	Sawtimber			14.0	MBF	43.9	\$4,697.55
Black/Red (Hybrid)		Pulpwood	3	Cords						
Mixed Aspen			700	Cords						
<i>B. T. Aspen</i>			602	<i>Cords</i>						
<i>Balsam Poplar</i>			39	<i>Cords</i>						
<i>Quaking Aspen</i>			59	<i>Cords</i>						
Mixed Hardwood			158	Cords						
<i>Beech</i>			<i>Sawtimber</i>	1.1	<i>MBF</i>					
<i>Black Cherry</i>			1.5	<i>MBF</i>						
<i>Basswood</i>			<i>Pulpwood</i>	12	<i>Cords</i>					
<i>Beech</i>			2	<i>Cords</i>						
<i>Black Cherry</i>			7	<i>Cords</i>						
<i>Ironwood</i>			16	<i>Cords</i>						
<i>Red Maple</i>			2	<i>Cords</i>						
<i>Sugar Maple</i>			60	<i>Cords</i>						
<i>White Ash</i>			54	<i>Cords</i>						
White Pine			7	Cords						
TOTAL:			14.0	MBF						
TOTAL:			1,249	Cords						

Sale Specific Conditions & Requirements

Sale Name: Ice- Bark Souls

Sale Number: 72-041-25 Seq#: 3

1 - Sale Area

1.2 - Boundaries

1.2.1 - Painted Boundaries (9/19)

The sale boundaries are marked and identified by blue and red paint as well as by roads and cover type changes. Exterior sale boundary lines against private property are marked with blue paint, except along certain sections of the road that are unpainted and indicated on the Timber Sale Map. Exterior sale boundary lines against state are marked with red paint, except along certain cover type changes that are unpainted and indicated on the Timber Sale Map. Retention patches are marked with red paint; no harvesting activities may occur within these areas. The painted boundary line trees are not Included Timber and are to be protected.

2 - Timber Specifications

2.1 - Included Timber

2.1.1 - Clearcut Unit(s) with Unmerchantable Trees (6/14)

Within Payment Unit(s) 1 and 2, cut all trees that are two (2) inches or more at DBH, except do not cut green marked trees and do not cut trees that are larger than 26" at DBH. In addition, within Payment Unit 1, do not cut any red pine or white pine. Special protection trees identified in accordance with condition 3.4.2, within the unit boundaries, are Not Included Timber and are to be protected.

3 - Payments

3.4 - Damaged Timber

3.4.2 - Special Protection Trees (1/25)

The Purchaser shall not cut live or dead special protection trees within cutting units or clearings. Special protection trees are any tree that is larger than 26" at DBH, and trees that are marked with green paint. If Purchaser's operations have cut or damaged special protection trees through carelessness, the Purchaser shall pay \$500 as fixed, agreed and liquidated damages for each special protection tree cut or damaged. Such payment does not constitute ownership of the undesignated timber.

4 - Transportation

4.1 - Construction

4.1.3 - Slash and Earthen Piles (8/04)

Piles or windrows of earth along roads and landings that have been widened or constructed shall be leveled. Slash from road maintenance or construction, including stumps, shall be dispersed throughout the sale.

4.1.6 - Road Construction (4/24)

Construction of new roads or improvements of existing roads shall be done in such a way as to minimize the environmental and visual impacts. Merchantable trees shall be cut and utilized unless otherwise directed. Non-merchantable trees shall be severed and laid flat on the ground. Slash shall be scattered, not left in windrows, and kept a minimum of 10 feet back from the road edge. Stumps shall be set upright, not left on edge, and be moved at least 10 feet away from the road edge. Disturbed soil shall be feathered into the woods and not left in berms or windrows.

4.1.7 - Road Closure (10/11)

All new roads built into the sale must be blocked to vehicle traffic upon completion of the sale. Overgrown roads that are reopened shall be considered new roads. In general, this will require constructing a four (4') foot high berm of stumps and logs covered with earth. Stumps and brush must be placed along the remainder of the trail. These roads must be rendered impassable to cars and trucks. All stumps from road building and landing construction must be reserved to block any newly constructed roads upon completion of the sale. These stumps must be scattered along the road system to prohibit vehicular movement. Contact the Sale Administrator for specific details of design and placement.

4.1.11 - Permits (2/12)

The Purchaser will secure any necessary permits that may be required.

5 - Operations

5.1 - Notification

5.1.3 - Well Heads and Natural Gas Pipelines (11/15)

The Purchaser is responsible for contacting the gas or pipeline company prior to operating equipment in the vicinity of well heads or natural gas pipelines. Lambda Energy Resources LLC can be contacted at (800) 328-7430. Gas well openings cannot be used for harvesting operations without permission from the lease holding company.

5.2 - Conduct of Operations

5.2.2 - Hazard Trees/Snags

5.2.2.1 - Den Trees (10/16)

Obvious hollow and/or den trees shall be protected and left standing unless they are a safety hazard.

5.2.4 - Dead and Down Creation

5.2.4.4 - Dead and Down Creation, Grouse (6/18)

To encourage grouse and other wildlife, in Payment Unit(s) 1 and 2 leave one 12" or larger diameter (or largest diameter trees within stand) whole tree on the ground for every two (2) acres, preferably a hardwood species such as oak or maple or if no hardwoods are present, a pine species (white or red). These trees will be evenly scattered throughout the Payment Unit, preferably at least two chains from any roads, two-tracks, or trails open to vehicles.

5.2.22 - Operating Caution

5.2.22.1 - Operating Caution (6/11)

It is recommended, but not required, that within Payment Unit(s) 1, cutting, skidding, and hauling occur during dry summer or frozen winter conditions. The reason for the recommendation is because of the presence of a high water table, and soft ground being located in areas throughout the payment unit. It is recommended that the producer uses slash and tops to cross over soft ground as needed.

5.2.29 - Shrub Protection (1/20)

Reasonable care should be taken to avoid cutting or damaging hawthorn, dogwood or junberry. These woody-shrub plants are highly beneficial to various wildlife species.

5.2.32 - Decking/Landing Restoration (9/13)

All decking and landing areas must have the surface area restored to a condition equal to or better than before. This is to ensure the proper regeneration of the stand. Wood debris, chips and "cookies" from trimmings must be removed or scattered away from landing and loading areas and may not be windrowed on the edge.

5.2.38 - No Decking Against Live Trees (2/04)

Cut products may not be decked against unmarked or designated leave trees.

5.2.39 - ORV Trail/Route Protection (4/18)

The Mio Trail is an ORV trail or route and is shown on the Timber Sale Map. Do not cut trees or damage posts with yellow ORV markers. All stumps within five (5) feet of the trail must be cut flush with the ground. Maintain a 20-foot-wide slash, debris, and rut free zone daily using the ORV trail or route as the centerline. Do not run equipment down the ORV trail or route. Skidding across the trail or route may only occur in locations approved by the Sale Administrator.

5.2.43 - Opening Protection (2/21)

No activities are permitted in openings marked on the Timber Sale Map with the letter "G". Any damage to the openings shall be repaired according to specifications of the Unit Manager or his/her representative.

5.4 - Soil Protection

5.4.2 - Skid Trails (2/04)

Skid trails up and down slopes should be avoided. If, however, this is unavoidable, these trails will be left in a non-erodible condition using water bars, logs, and slash. Placing of slash on these skid trails while logging is ongoing may alleviate need for any further action. At the direction of the Sale Administrator, seed, fertilizer, and mulch may also be required.

5.8 - Protection of Endangered Species

5.8.5 - Protection of Raptor Nests (3/13)

All trees with raptor nests will be protected if found during harvesting operations. Notification will be made to the Unit Manager or his/her representative who will notify the Wildlife Biologist so an onsite evaluation and recommendation can be made, if necessary.

6 - Safety and Fire Prevention

6.2 - Signing

6.2.1 - Road Posting (10/20)

The Purchaser is responsible for posting and maintaining caution signs on Bailey Rd. & Cedar Run Rd. prior to beginning operations. The road must be posted at appropriate distances from the Sale Area to warn of logging activity and truck traffic. Signs must be removed when harvest operations are suspended or completed. The Purchaser will provide these signs.

6.2.3 - Recreational Trail Posting (10/20)

The Purchaser is responsible for posting and maintaining caution signs on Mio Trail prior to beginning operations. The trail must be posted at appropriate distances from the Sale Area to warn of logging activity and truck traffic at both ends of the trail. Signs must be removed when harvest operations are suspended or completed. The Purchaser will provide these signs.

7 - Other Conditions

7.2 - Extensions

7.2.2 - No Extensions (3/09)

This is an ice storm salvage sale. There will be no extensions granted on this contract.

7.5 - Loss

7.5.1 - Deteriorating Timber (7/09)

The Sale Area has received damage from the 2025 ice storm. The Purchaser should harvest the wood as soon as possible. The Department of Natural Resources is held free of responsibility of any further damage or deterioration due to delay in harvesting.



TIMBER SALE MAP

This information provided by authority of Part 525, 1994 PA 451, as amended.

Sale Number 72-041-25	Date 10/09/2025
Scale 1:15,840	Page 1
	Of 1

Forest Management Unit Grayling Mgt Unit	County Oscoda	Mapped By: Collin Whitsett
		Cruised By: Collin Whitsett

Township 28N	Range 03E	Section(s) and Subdivision(s) Sec. 20 NWSW,S1/2SW,N1/2SE,SESE;
-----------------	--------------	--

Cover Type			
A = Aspen	J = Jack Pine	O = Oak	U = Upland Brush
B = Paper Birch	K = Rock	P = Lowland Poplar	UM = Upland Mix Forest
C = Cedar	L = Lowland Brush	Q = Mixed Swamp Conifer	V = Bog or Marsh
D = Treed Bog	LM = Lowland Mix Forest	R = Red Pine	W = White Pine
E = Swamp Hardwoods	M = Maple, Beech, Birch	S = Black Spruce	X = Non Stocked
F = Spruce/Fir	MC = Mixed Conifer	T = Tamarack	Y = Sand
G = Grass	MD = Mixed Deciduous	Z = Water	
H = Hemlock	N = Marsh		

Density	
0 = Non Stocked	5 = Pole Timber Medium
1 = Seedling Sapling Poor	6 = Pole Timber Well
2 = Seedling Sapling Medium	7 = Saw Timber Poor
3 = Seedling Sapling Well	8 = Saw Timber Medium
4 = Pole Timber Poor	9 = Saw Timber Well

Payment Unit Number	Acres
1	16.1
2	43.9

Ice- Bark Souls

60.0 Acres

Locator Map 1:50,000

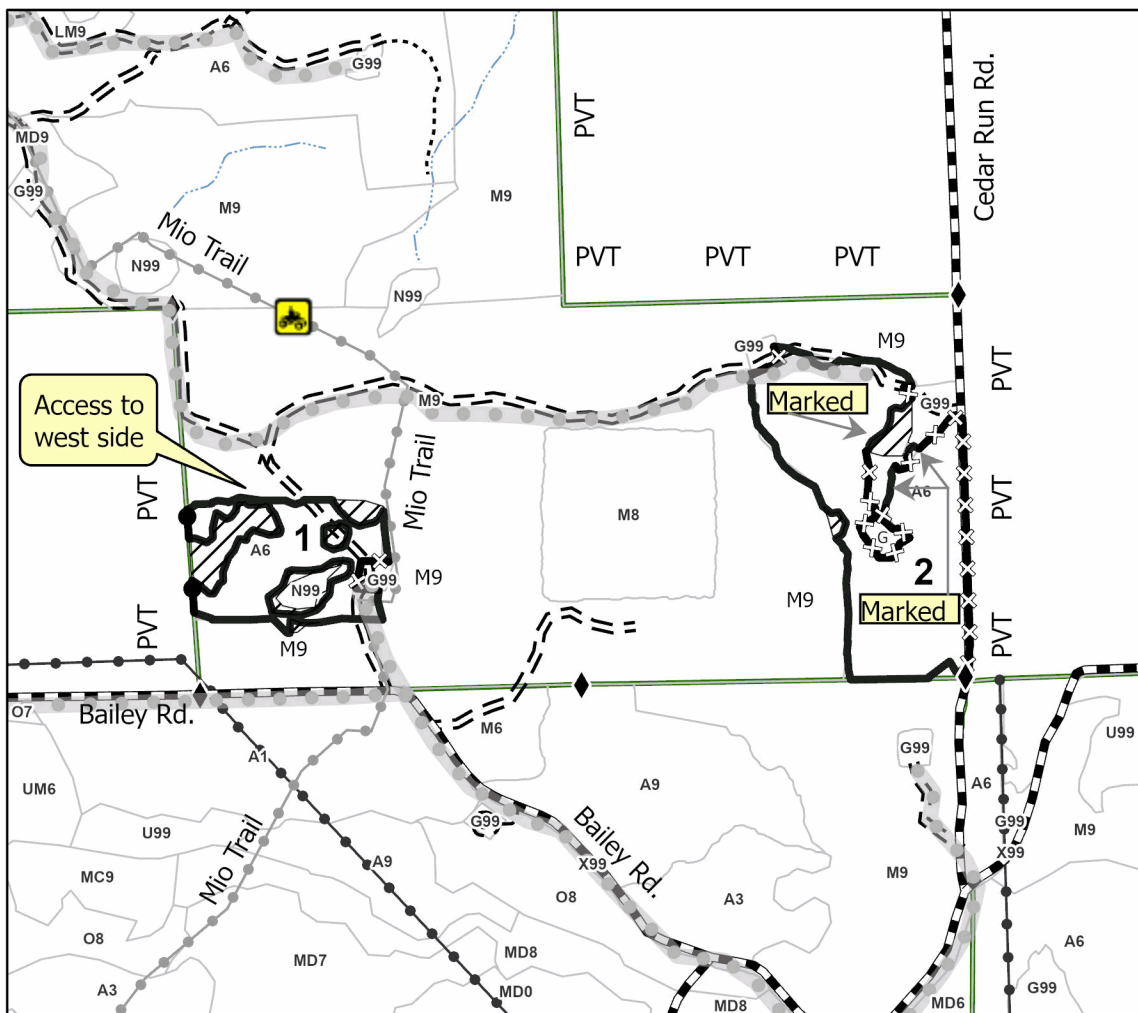
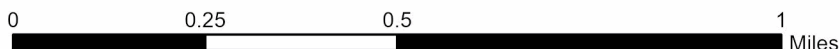
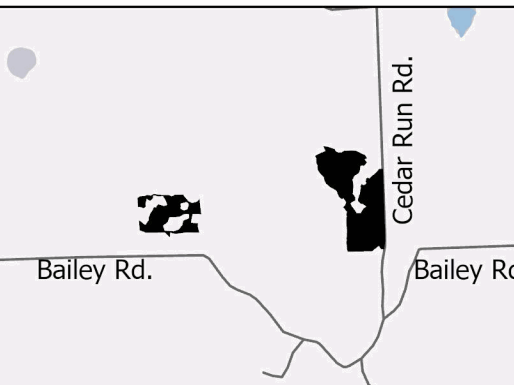

Legend

- Payment Unit
- Against State (Red)
- Against State (Unpainted)
- Private Line (Blue)
- Forest Access Route
- Administrative Access Only
- Government Gravel/Dirt
- Powerline
- Recreational Trails
- ORV Trail
- Survey Corners
- Retention
- Gas Pipeline

Use QR Code to open Map in App



Use QR Code to open cruise tree list



TIMBER SALE INFORMATION

Ice- Pigpen Aspen (72-042-25)

T28N, R02E, SEC. 23.

Oscoda County (Advertised Price \$3,044.65)

SALE NOTE: 7.5.1 - Deteriorating Timber (7/09) The Sale Area has received damage from the 2025 ice storm. The Purchaser should harvest the wood as soon as possible. Snowmobile trail and ORV trail specs included. This sale has a 2-year contract length with no extensions allowed. Oil and gas infrastructure is present near the vicinity of the sale area. Therefore, the purchaser must contact pipeline company to identify infrastructure prior to operations beginning.

A recreation site such as a trail, pathway, or campground is within the sale area or the vicinity. Certain restrictions/specifications may be applicable including time restrictions.

A timber sale contract for this lump sum, sealed bid timber sale will be awarded to the responsible bidder offering the highest sealed bid price. All units of volume listed below were estimated using the Inventory Manager computer program and the new Michigan taper model. Bids must be at or above the following advertised price for each product and species:

<u>PRODUCTS & SPECIES</u>	<u>ESTIMATED UNITS*</u>	<u>ADVERTISED PRICE</u>
Pulpwood		
B. T. Aspen	401 Cords	\$ 4.50 / Cord
Black/Red (Hybrid) Oak	163 Cords	\$ 4.45 / Cord
Mixed Hardwood	99 Cords	\$ 5.20 / Cord

* The total volume is statistically estimated within plus (+) or minus (-) 39.11 percent. There are an estimated 666 cords on this timber sale, plus or minus 260 cords at the 95% confidence level. The estimated units are final and not subject to adjustment. Prospective bidders are urged to examine this timber and to make their own estimates of quantity and quality.

BOND AND PAYMENT SCHEDULE:

- A bond in the amount of \$1,000.00 to insure faithful performance of the conditions of the contract will be deposited by the successful bidder within 21 days of the sale award.
- Cutting in any sale or unit without the required advance payment would be considered a trespass.
- Total payment must be paid in advance or according to the following schedule :
 - Ten percent (10%) of the sale value must be paid within 21 days of the sale award.
 - The 10% down payment will be credited towards the first unit cut.
 - Payment for each of the following units must be made before cutting begins in that unit:

PAYMENT UNIT NUMBER	PERCENT OF TOTAL SALE VALUE
01	56.9%
02	43.1%
- If no cutting takes place, the 10% down payment will not be refunded.
- Operations on the contract issued will terminate on 06/30/2028.

SALE STATISTICS

Volumes were calculated in cubic feet using the Michigan taper model. Cubic foot volume includes all wood inside bark for the product indicated. For display purposes, cubic feet were converted to cords and MBF using a simple conversion factor, e.g. 79 cubic feet per cord and 185 cubic feet per MBF. The cubic foot volumes are precise; the cords and MBF volumes are not. Cubic foot volume cannot be directly converted to cords or boards with precision.

SALE VOLUMES

The total estimated sale volume may not equal the sum of the species/products due to the nature of statistical calculations associated with double sampling methodology.

VOLUME		STATISTICAL RANGE IN CORDS		
TOTAL CUBIC FEET	TOTAL CORDS	PERCENT ERROR	MINIMUM	MAXIMUM
52,612	666	39.11%	406	926

VDU VOLUMES

A VDU is a Volume Determination Unit. Volumes and their associated statistics are calculated at the VDU level and summarized to the sale level. There is often a one to one relationship between a VDU and a Payment Unit, but not always, depending on the cruise design. Refer to the VDU TO PAYMENT UNIT table.

VDU	VOLUME		PERCENT ERROR	RANGE IN CORDS	
	TOTAL CUBIC FEET	TOTAL CORDS		MINIMUM	MAXIMUM
11	22,418	284	50.60%	140	427
26	30,193	382	61.19%	148	616
TOTAL:	52,612	666		289	1,043

VDU TO PAYMENT UNIT

When a VDU is associated with more than one Payment Unit (PU), the VDU volumes are assigned to the PU based on acres of the VDU within the PU.

VDU	VDU ACRES	PU	PU ACRES
TOTAL:			

DESCRIPTION OF TIMBER BY PAYMENT UNIT (PU)

PU	MARKET GROUP	PRODUCT	QUANTITY	UNIT	ACRES	ADVERTISE PRICE
1	B. T. Aspen	Pulpwood	264	Cords	18.9	\$1,732.65
	Black/Red (Hybrid		85	Cords		
	/Red (Hybrid) Oak	Sawtimber	3.4	MBF		
	/Red (Hybrid) Oak	Pulpwood	78	Cords		
	Mixed Hardwood		32	Cords		
	Black Cherry		32	Cords		
2	B. T. Aspen	Pulpwood	137	Cords	24.8	\$1,312.00
	Black/Red (Hybrid		78	Cords		
	/Red (Hybrid) Oak	Sawtimber	2.4	MBF		
	/Red (Hybrid) Oak	Pulpwood	73	Cords		
	Mixed Hardwood		67	Cords		
	Red Maple	Sawtimber	2.7	MBF		
	Red Maple	Pulpwood	62	Cords		
	TOTAL:			663		

Sale Specific Conditions & Requirements

Sale Name: Ice- Pigpen Aspen

Sale Number: 72-042-25 Seq#: 2

1 - Sale Area

1.2 - Boundaries

1.2.1 - Painted Boundaries (9/19)

The sale boundary and Payment Unit boundaries are marked and identified by red paint. Exterior sale boundary lines against state are marked with red paint. Retention patches are marked with red paint; no harvesting activities may occur within these areas. The painted boundary line trees are not Included Timber and are to be protected.

2 - Timber Specifications

2.1 - Included Timber

2.1.1 - Clearcut Unit(s) with Unmerchantable Trees (6/14)

Within Payment Unit(s) 1 and 2, cut all trees that are two (2) inches or more at DBH. Within Payment Unit 2, do not cut any pine species greater than 15" (inches) at DBH. Special protection trees identified in accordance with condition 3.4.2, within clearcutting unit boundaries, are not Included Timber and are to be protected.

3 - Payments

3.4 - Damaged Timber

3.4.1 - Damaged Timber (12/24)

General Condition and Requirement 3.4 Damaged Timber, defines liquidated damages for undesignated live merchantable trees which are cut or injured. No damage is acceptable to undesignated live merchantable trees. Within the Sale Area, if more than 10 % of trees (> 4.5" DBH) within a specified area of the sale are damaged, liquidated damages will be assessed for all trees damaged. Rates will be in accordance with General Condition and Requirement 3.4 Damaged Timber.

3.4.2 - Special Protection Trees (1/25)

The Purchaser shall not cut live or dead special protection trees within cutting units or clearings. Special protection trees are any non-Aspen species greater than 26" (inches) DBH. If Purchaser's operations have cut or damaged special protection trees through carelessness, the Purchaser shall pay \$500 as fixed, agreed and liquidated damages for each special protection tree cut or damaged. Such payment does not constitute ownership of the undesignated timber.

4 - Transportation

4.1 - Construction

4.1.3 - Slash and Earthen Piles (8/04)

Piles or windrows of earth along roads and landings that have been widened or constructed shall be leveled. Slash from road maintenance or construction, including stumps, shall be dispersed throughout the sale.

4.1.6 - Road Construction (4/24)

Construction of new roads or improvements of existing roads shall be done in such a way as to minimize the environmental and visual impacts. Merchantable trees shall be cut and utilized unless otherwise directed. Non-merchantable trees shall be severed and laid flat on the ground. Slash shall be scattered, not left in windrows, and kept a minimum of 10 feet back from the road edge. Stumps shall be set upright, not left on edge, and be moved at least 10 feet away from the road edge. Disturbed soil shall be feathered into the woods and not left in berms or windrows.

4.1.7 - Road Closure (10/11)

All new roads built into the sale must be blocked to vehicle traffic upon completion of the sale. In general, this will require constructing a four (4') foot high berm of stumps and logs covered with earth. Overgrown roads that are reopened shall be considered new roads. These roads must be rendered impassable to cars and trucks. Temporary berms may be required if no sale activity occurs for 30 or more consecutive days. Contact the Sale Administrator for specific details of design and placement.

4.1.11 - Permits (2/12)

The Purchaser will secure any necessary permits that may be required.

5 - Operations

5.1 - Notification

5.1.3 - Well Heads and Natural Gas Pipelines (11/15)

The Purchaser is responsible for contacting the gas or pipeline company prior to operating equipment in the vicinity of well heads or natural gas pipelines. Line locations are unknown and not identified on the ground or on the map. Therefore, the purchaser must contact pipeline company to identify infrastructure prior to operations beginning.

5.2 - Conduct of Operations

5.2.2 - Hazard Trees/Snags

5.2.2.1 - Den Trees (10/16)

Obvious hollow and/or den trees shall be protected and left standing unless they are a safety hazard.

5.2.4 - Dead and Down Creation

5.2.4.4 - Dead and Down Creation, Grouse (6/18)

To encourage grouse and other wildlife, in Payment Unit(s) 1-2, leave one 12" or larger diameter (or largest diameter trees within stand) whole tree on the ground for every two (2) acres, preferably a hardwood species such as oak or maple or if no hardwoods are present, a pine species (white or red). These will be evenly scattered throughout the Payment Unit. These trees will be evenly scattered throughout the Payment Unit, preferably at least two chains from any roads, two-tracks, or trails open to vehicles.

5.2.29 - Shrub Protection (1/20)

Reasonable care should be taken to avoid cutting or damaging Hawthorn or Juneberry (Serviceberry). These woody-shrub plants are highly beneficial to various wildlife species.

5.2.32 - Decking/Landing Restoration (9/13)

All decking and landing areas must have the surface area restored to a condition equal to or better than before. This is to ensure the proper regeneration of the stand. Wood debris, chips and "cookies" from trimmings must be removed or scattered away from landing and loading areas and may not be windrowed on the edge.

5.2.38 - No Decking Against Live Trees (2/04)

Cut products may not be decked against unmarked or designated leave trees.

5.2.40 - Pathway Protection (10/10)

The Mio MCCCT is a cycle trail and is shown on the Timber Sale Map. Do not cut trees or damage posts with blue pathway markers. Maintain a 20-foot-wide slash, debris, and rut free zone daily, using the pathway as the centerline. Do not run equipment down the pathway. Skidding across the trail may only occur in locations approved by the Sale Administrator.

5.2.41 - Snowmobile Trail Protection (9/11)

The Mio ORV Route/Snowmobile Trail 4/9 is a snowmobile trail and is shown on the Timber Sale Map. Do not cut or damage posts with orange trail markers or traffic control signs. If the trail is used, it must be maintained and restored to a condition equal to or better than before the sale. The road maintenance/restoration must be done prior to December 1. The snowmobile trail may not be used for any timber sale operations from December 1 to March 31 without written permission from the Unit Manager or his/her representative. If the trail road is to be used for hauling during the snowmobile season, then a snow-covered base must be left on the trail. The snowmobile trail may only be crossed at right angles. Maintain a 20-foot-wide slash, debris, and rut free zone daily using the snowmobile trail as the centerline. No decking of forest products will be permitted along the snowmobile trail. All stumps within 20 feet of the snowmobile trail must be cut at ground level.

5.4 - Soil Protection

5.4.2 - Skid Trails (2/04)

Skid trails up and down slopes should be avoided. If, however, this is unavoidable, these trails will be left in a non-erodible condition using water bars, logs, and slash. Placing of slash on these skid trails while logging is ongoing may alleviate need for any further action. At the direction of the Sale Administrator, seed, fertilizer, and mulch may also be required.

5.8 - Protection of Endangered Species

5.8.5 - Protection of Raptor Nests (3/13)

All trees with raptor nests will be protected if found during harvesting operations. Notification will be made to the Unit Manager or his/her representative who will notify the Wildlife Biologist so an onsite evaluation and recommendation can be made, if necessary.

6 - Safety and Fire Prevention

6.2 - Signing

6.2.1 - Road Posting (10/20)

The Purchaser is responsible for posting and maintaining caution signs on Penn Rd prior to beginning operations. The road must be posted at appropriate distances from the Sale Area to warn of logging activity and truck traffic. Signs must be removed when harvest operations are suspended or completed. The Purchaser will provide these signs.

6.2.3 - Recreational Trail Posting (10/20)

The Purchaser is responsible for posting and maintaining caution signs on Mio ORV Route/Snowmobile Trail 4/9 prior to beginning operations. The trail must be posted at appropriate distances from the Sale Area to warn of logging activity and truck traffic at both ends of the trail. Signs must be removed when harvest operations are suspended or completed. The Purchaser will provide these signs.

7 - Other Conditions

7.2 - Extensions

7.2.2 - No Extensions (3/09)

There will be no extensions granted on this contract. This is due to this being a salvage sale as a direct result of the spring 2025 Ice Storm.

7.5 - Loss

7.5.1 - Deteriorating Timber (7/09)

The Sale Area has received damage from the spring 2025 ice storm. The Purchaser should harvest the wood as soon as possible. The Department of Natural Resources is held free of responsibility of any further damage or deterioration due to delay in harvesting.



TIMBER SALE MAP

This information provided by authority of Part 525, 1994 PA 451, as amended.

Sale Number

72-042-25

Date

09/29/2025

Forest Management Unit

Grayling Mgt Unit

County

Oscoda

Mapped By: Vic Porteous, Scott McClarren

Cruised By: Vic Porteous, Scott McClarren

Scale

1:10,000

Page

1

Of

1

Township
28N

Range
02E

Section(s) and
Subdivision(s) Sec. 23 E1/2NW,W1/2NE,N1/2SW,SESW,NWSE;

Cover Type

A = Aspen	J = Jack Pine	O = Oak	U = Upland Brush
B = Paper Birch	K = Rock	P = Lowland Poplar	UM = Upland Mix Forest
C = Cedar	L = Lowland Brush	Q = Mixed Swamp Conifer	V = Bog or Marsh
D = Treed Bog	LM = Lowland Mix Forest	R = Red Pine	W = White Pine
E = Swamp Hardwoods	M = Maple, Beech, Birch	S = Black Spruce	X = Non Stocked
F = Spruce/Fir	MC = Mixed Conifer	T = Tamarack	Y = Sand
G = Grass	MD = Mixed Deciduous	Z = Water	
H = Hemlock	N = Marsh		

Density

0 = Non Stocked	5 = Pole Timber Medium
1 = Seedling Sapling Poor	6 = Pole Timber Well
2 = Seedling Sapling Medium	7 = Saw Timber Poor
3 = Seedling Sapling Well	8 = Saw Timber Medium
4 = Pole Timber Poor	9 = Saw Timber Well

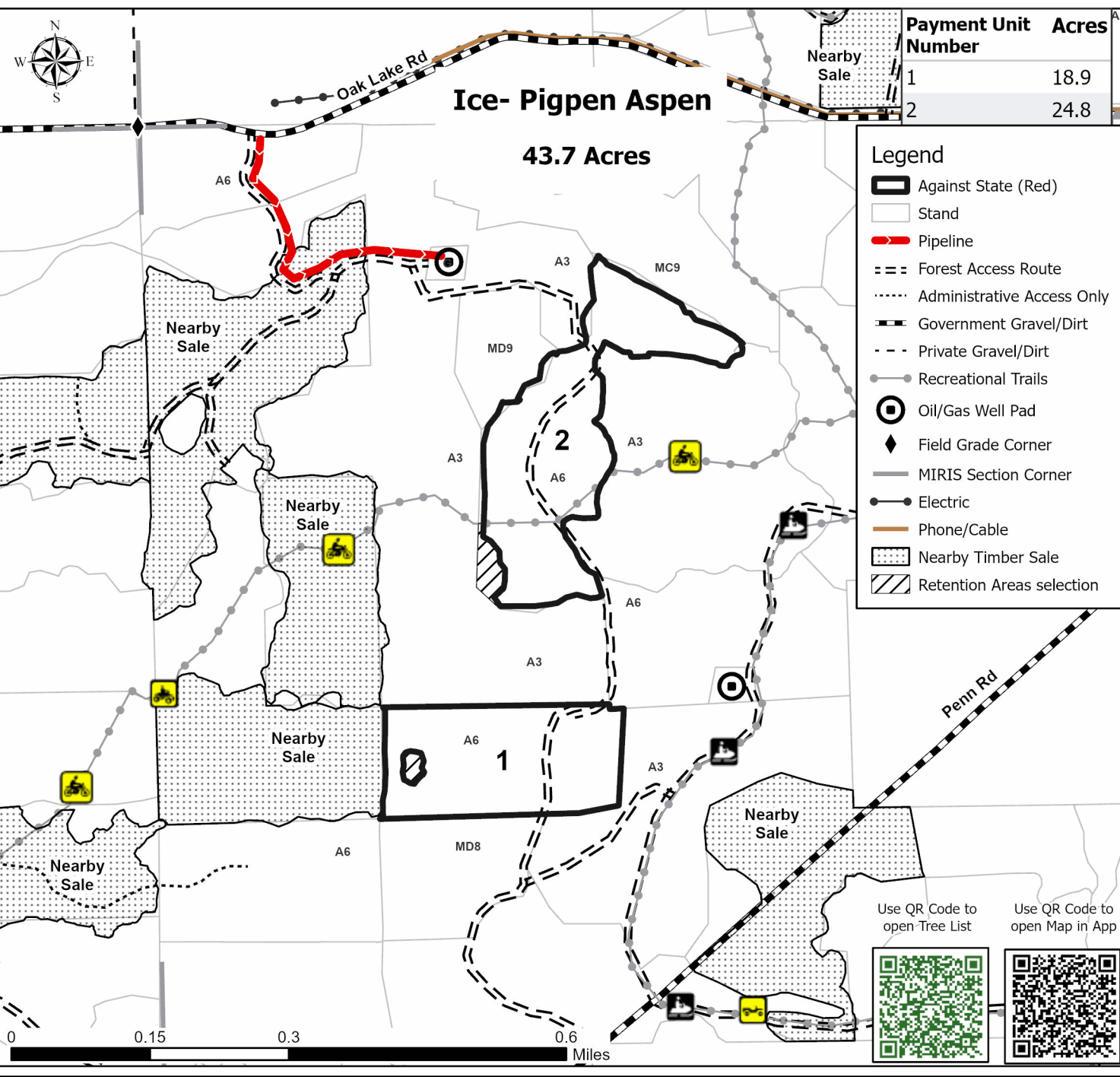

TIMBER SALE INFORMATION

Loggy Bottom Boys (72-008-24)
T27N, R01W, SEC. 1; T27N, R01W, SEC. 2.
Crawford County (Advertised Price \$16,024.85)

SALE NOTE: PU 1 and 2 were impacted by the spring 2025 ice storm. Three year contract due to operating cautions. Also, please take note of access for Payment Unit 6. KW restriction may also apply to this sale for Payment Unit 6, please check with the sale administrator regarding this. Also, please note that no chipping of limbs or tops will be allowed to assist with natural regeneration and protect sensitive soils.

A recreation site such as a trail, pathway, or campground is within the sale area or the vicinity. Certain restrictions/specifications may be applicable including time restrictions.

A timber sale contract for this lump sum, sealed bid timber sale will be awarded to the responsible bidder offering the highest sealed bid price. All units of volume listed below were estimated using the Inventory Manager computer program and the new Michigan taper model. Bids must be at or above the following advertised price for each product and species:

<u>PRODUCTS & SPECIES</u>	<u>ESTIMATED UNITS*</u>	<u>ADVERTISED PRICE</u>
Pulpwood		
Balsam Fir	59 Cords	\$ 10.70 / Cord
Black Cherry	17 Cords	\$ 13.00 / Cord
Jack Pine	286 Cords	\$ 7.00 / Cord
Misc. Species 1	425 Cords	\$ 6.50 / Cord
Mixed Aspen	685 Cords	\$ 11.20 / Cord
Northern Pin Oak	66 Cords	\$ 11.15 / Cord
Red Maple	51 Cords	\$ 13.00 / Cord
Red Pine	11 Cords	\$ 26.65 / Cord
White Pine	87 Cords	\$ 9.55 / Cord
White Spruce	21 Cords	\$ 10.15 / Cord

* The total volume is statistically estimated within plus (+) or minus (-) 14.68 percent. There are an estimated 1,707 cords on this timber sale, plus or minus 251 cords at the 95% confidence level. The estimated units are final and not subject to adjustment. Prospective bidders are urged to examine this timber and to make their own estimates of quantity and quality.

BOND AND PAYMENT SCHEDULE:

1. A bond in the amount of \$801.00 to insure faithful performance of the conditions of the contract will be deposited by the successful bidder within 21 days of the sale award.
2. Cutting in any sale or unit without the required advance payment would be considered a trespass.
3. Total payment must be paid in advance or according to the following schedule :
 - (a) Ten percent (10%) of the sale value must be paid within 21 days of the sale award.
 - (b) The 10% down payment will be credited towards the first unit cut.
 - (c) Payment for each of the following units must be made before cutting begins in that unit:

PAYMENT UNIT NUMBER	PERCENT OF TOTAL SALE VALUE
01	21.5%
02	16.1%
03	10.0%
04	41.2%
05	7.5%
06	3.7%

4. If no cutting takes place, the 10% down payment will not be refunded.
5. Operations on the contract issued will terminate on 06/30/2029.

SALE STATISTICS

Volumes were calculated in cubic feet using the Michigan taper model. Cubic foot volume includes all wood inside bark for the product indicated. For display purposes, cubic feet were converted to cords and MBF using a simple conversion factor, e.g. 79 cubic feet per cord and 185 cubic feet per MBF. The cubic foot volumes are precise; the cords and MBF volumes are not. Cubic foot volume cannot be directly converted to cords or boards with precision.

SALE VOLUMES

The total estimated sale volume may not equal the sum of the species/products due to the nature of statistical calculations associated with double sampling methodology.

VOLUME			STATISTICAL RANGE IN CORDS	
TOTAL CUBIC FEET	TOTAL CORDS	PERCENT ERROR	MINIMUM	MAXIMUM
134,863	1,707	14.68%	1,456	1,958

VDU VOLUMES

A VDU is a Volume Determination Unit. Volumes and their associated statistics are calculated at the VDU level and summarized to the sale level. There is often a one to one relationship between a VDU and a Payment Unit, but not always, depending on the cruise design. Refer to the VDU TO PAYMENT UNIT table.

	VOLUME			RANGE IN CORDS	
VDU	TOTAL CUBIC FEET	TOTAL CORDS	PERCENT ERROR	MINIMUM	MAXIMUM
1	44,002	557	24.31%	422	692
4	14,355	182	60.54%	72	292
22	46,614	590	26.58%	433	747
24	12,866	163	34.80%	106	220
43	3,905	49	57.85%	21	78
51	13,122	166	50.07%	83	249
TOTAL:	134,863	1,707		1,136	2,278

VDU TO PAYMENT UNIT

When a VDU is associated with more than one Payment Unit (PU), the VDU volumes are assigned to the PU based on acres of the VDU within the PU.

VDU	VDU ACRES	PU	PU ACRES
TOTAL:			

DESCRIPTION OF TIMBER BY PAYMENT UNIT (PU)

PU	MARKET GROUP	PRODUCT	QUANTITY	UNIT	ACRES	ADVERTISE PRICE
1	Black Cherry	Pulpwood	3	Cords	26.1	\$3,450.95
	Misc. Species 1		284	Cords		
	<i>Jack Pine</i>		284	Cords		
	Mixed Aspen		96	Cords		
	<i>B. T. Aspen</i>		51	Cords		
	<i>Quaking Aspen</i>		45	Cords		
	Northern Pin Oak		32	Cords		
	<i>Northern Pin Oak</i>		0.2	MBF		
	<i>Northern Pin Oak</i>		32	Cords		
	Red Maple		4	Cords		
	Red Pine		2	Cords		
	White Pine		3	Cords		
2	Black Cherry	Pulpwood	1	Cords	17.9	\$2,577.80
	Misc. Species 1		174	Cords		
	<i>Jack Pine</i>		174	Cords		
	Mixed Aspen		84	Cords		
	<i>B. T. Aspen</i>		59	Cords		
	<i>Quaking Aspen</i>		25	Cords		
	Northern Pin Oak		33	Cords		
	<i>Northern Pin Oak</i>		0.3	MBF		
	<i>Northern Pin Oak</i>		32	Cords		
	Red Maple		2	Cords		
	Red Pine		3	Cords		
	White Pine		2	Cords		
3	Black Cherry	Pulpwood	5	Cords	14.8	\$1,606.55
	Jack Pine		103	Cords		
	Mixed Aspen		69	Cords		
	<i>Quaking Aspen</i>		69	Cords		
	White Pine		5	Cords		
4	Balsam Fir	Pulpwood	44	Cords	19.3	\$6,574.30
	Black Cherry		6	Cords		
	Mixed Aspen		409	Cords		
	<i>Quaking Aspen</i>		409	Cords		
	Red Maple		45	Cords		
	Red Pine		2	Cords		
	White Pine		77	Cords		
	White Spruce		7	Cords		
	<i>White Spruce</i>		1.9	MBF		
	<i>White Spruce</i>		3	Cords		
5	Balsam Fir	Pulpwood	2	Cords	15.5	\$1,198.15
	Black Cherry		2	Cords		
	Jack Pine		150	Cords		
	Mixed Aspen		8	Cords		
	<i>Quaking Aspen</i>		8	Cords		
	Northern Pin Oak		1	Cords		
	<i>Northern Pin Oak</i>		1	Cords		
6	Balsam Fir	Pulpwood	13	Cords	6.3	\$600.60
	Mixed Aspen		19	Cords		
	<i>Quaking Aspen</i>		19	Cords		
	Red Pine		4	Cords		
	White Spruce		14	Cords		
	<i>White Spruce</i>		14	Cords		
TOTAL:			1,708	Cords		

Sale Specific Conditions & Requirements

Sale Name: Loggy Bottom Boys

Sale Number: 72-008-24 Seq#: 3

1 - Sale Area

1.2 - Boundaries

1.2.1 - Painted Boundaries (9/19)

The sale boundary and Payment Unit boundaries are marked and identified by red paint or are unmarked and identified by a road or utility ROW. Exterior sale boundary lines against state are marked with red paint. Except for those stretches of sale boundary that border either Townline Rd or Thunder Mug Rd; these stretches are unmarked boundary. This includes unmarked private line against Thunder Mug Rd along Payment Units 1 and 3. Payment Unit 6 has unmarked sale boundary against the utility ROW. Interior Payment Unit boundary between Payment Units 1 and 2 are unmarked; instead, the access road is being used to separate these two units. Retention patches are marked with red paint; no harvesting activities may occur within these areas. The red painted exterior boundary line trees are not Included Timber and are to be protected.

2 - Timber Specifications

2.1 - Included Timber

2.1.1 - Clearcut Unit(s) with Unmerchantable Trees (6/14)

Within Payment Unit(s) 1-6, cut all trees that are two (2) inches or more at DBH, except for trees designated with green paint above and below stump height. In addition, within Payment Units 1, 2, 3 and 5 do not cut any red pine unless they are designated with orange paint. Any red pine designated with orange paint above and below stump height are included timber. Designated red pine are only present in Payment Units 1 and 2.

2.1.11 - Description of Timber Note (2/04)

Note that Miscellaneous species 1 is damaged jack pine due to the spring 2025 ice storm.

2.2 - Utilization

2.2.10 - No Chipping Tops and Limbs (8/16)

Within Payment Unit(s) 1-6, chipping of limbs or tops is not permitted. Limbs and the remaining top must be left on site and scattered. This is to assist with management objective of natural regeneration for all units, in addition to protecting sensitive soils in Payment Units 4 and 6.

3 - Payments

3.4 - Damaged Timber

3.4.1 - Damaged Timber (12/24)

General Condition and Requirement 3.4 Damaged Timber, defines liquidated damages for undesignated live merchantable trees which are cut or injured. No damage is acceptable to undesignated live merchantable trees. Within the Sale Area, if more than 10% of trees (> 4.5" DBH) within a specified area of the sale are damaged, liquidated damages will be assessed for all trees damaged. Rates will be in accordance with General Condition and Requirement 3.4 Damaged Timber.

4 - Transportation

4.1 - Construction

4.1.3 - Slash and Earthen Piles (8/04)

Piles or windrows of earth along roads and landings that have been widened or constructed shall be leveled. Slash from road maintenance or construction, including stumps, shall be dispersed throughout the sale.

4.1.6 - Road Construction (4/24)

Construction of new roads or improvements of existing roads shall be done in such a way as to minimize the environmental and visual impacts. Merchantable trees shall be cut and utilized unless otherwise directed. Non-merchantable trees shall be severed and laid flat on the ground. Slash shall be scattered, and not left in windrows and kept a minimum of 10 feet back from the road edge. Stumps shall be set upright, not left on edge, and be moved at least 10 feet away from the road edge. Disturbed soil shall be feathered into the woods and not left in berms or windrows.

4.1.7 - Road Closure (10/11)

All new roads built into the sale must be blocked to vehicle traffic upon completion of the sale. Overgrown roads that are reopened shall be considered new roads. Temporary berms may be required if no sale activity occurs for 30 or more consecutive days. Contact the Sale Administrator for specific details of design and placement.

5 - Operations

5.1 - Notification

5.1.6 - Utility R.O.W. (4/19)

It is the responsibility of the Purchaser to obtain permission from the utility company to utilize the power line R.O.W. for operations.

5.2 - Conduct of Operations

5.2.1 - Slash

5.2.1.11 - Slash for Reforestation (3/21)

To facilitate reforestation, the Sale Area shall be left with slash evenly distributed. Bunched tops within the cutting area shall be broken up and scattered. Stumps shall be cut low to the ground. Processing sites shall not be left with a compacted layer of slash; tops from these sites shall be hauled back into the cut area and scattered.

5.2.2 - Hazard Trees/Snags

5.2.2.1 - Den Trees (10/16)

Obvious hollow and/or den trees shall be protected and left standing unless they are a safety hazard.

5.2.4 - Dead and Down Creation

5.2.4.1 - Dead and Down Creation, Marked Trees (10/13)

To encourage grouse and other wildlife, all trees designated with either orange or pink paint, not including red pine per Spec 2.1.1, must be left until all merchantable timber has been cut and taken to the landing. Pink paint was utilized in Payment Units 1, 2 and 6; while orange paint was utilized in Payment Units 3 and 4. At which time, they are to be cut, felled, and left on the ground directly next to the stump. These trees are not included timber.

5.2.22 - Operating Caution

5.2.22.1 - Operating Caution (6/11)

It is recommended, but not required, that within Payment Unit(s) 4, cutting, skidding, and hauling occur during times of the year that promote stable ground conditions (dry or frozen). The reason for the recommendation is due to the presence of sensitive, organic soils found in this Payment Unit that are more prone to rutting.

5.2.32 - Decking/Landing Restoration (9/13)

All decking and landing areas must have the surface area restored to a condition equal to or better than before. This is to ensure the proper regeneration of the stand. Wood debris, chips and "cookies" from trimmings must be removed or scattered away from landing and loading areas and may not be windrowed on the edge.

5.2.38 - No Decking Against Live Trees (2/04)

Cut products may not be decked against unmarked or designated leave trees.

5.2.41 - Snowmobile Trail Protection (9/11)

The 409 is a snowmobile trail and is shown on the Timber Sale Map. Do not cut or damage posts with orange trail markers or traffic control signs. If the trail is used, it must be maintained and restored to a condition equal to or better than before the sale. If the trail is used for hauling, it must be graded to the satisfaction of the Unit Manager or his/her representative prior to December 1. If the trail road is to be used for hauling during the snowmobile season, then a snow-covered base must be left on the trail. The snowmobile trail is not to be used without written approval from the Unit Manager. The snowmobile trail may only be crossed at right angles. Maintain a 20-foot-wide slash, debris, and rut free zone daily using the snowmobile trail as the centerline. No decking of forest products will be permitted along the snowmobile trail. All stumps within 20 feet of the snowmobile trail must be cut at ground level.

5.4 - Soil Protection

5.4.1 - Rutting Restriction, General (7/16)

Operations are to cease immediately if equipment and weather conditions result in rutting of roads and/or skid trails which is 12 inches or greater in depth and 25 feet in length. The Unit Manager or his/her representative may restrict hauling and/or skidding if ruts exceed the specified depth. With the Unit Manager or his/her representative's approval, the Purchaser may return to the area when the risk of rutting has decreased.

5.4.5 - Soil Caution (11/04)

Care must be taken to minimize soil damage due to potentially saturated soils in Payment Unit 4.

5.8 - Protection of Endangered Species

5.8.1 - Kirtland's Warbler (1) (4/24)

This sale is adjacent to a young jack pine stand which may be used by the Kirtland's Warbler. The Department reserves the right to temporarily restrict all harvesting operations in a buffer zone of up to 500 feet if it is determined that Warbler territory has been established in the adjacent stand. The restricted period, if put into effect, would apply from May 1 to August 15. Please have your Sale Administrator check if this restriction applies to the affected Payment Unit (6) prior to operations.

6 - Safety and Fire Prevention

6.2 - Signing

6.2.1 - Road Posting (10/20)

The Purchaser is responsible for posting and maintaining caution signs on E Townline Rd and Thunder Mug Rd prior to beginning operations. The road must be posted at appropriate distances from the Sale Area to warn of logging activity and truck traffic. Signs must be removed when harvest operations are suspended or completed. The Purchaser will provide these signs.

6.2.3 - Recreational Trail Posting (10/20)

The Purchaser is responsible for posting and maintaining caution signs on 409 prior to beginning operations. The trail must be posted at appropriate distances from the Sale Area to warn of logging activity and truck traffic at both ends of the trail. Signs must be removed when harvest operations are suspended or completed. The Purchaser will provide these signs.

7 - Other Conditions

7.2 - Extensions

7.2.5 - Weather-Related Extension (1/13)

If weather conditions during the operating period of this contract prevent harvesting, this sale may qualify for a weather-related extension. If approved, the normal extension fee would be waived. To qualify, there must be a documented attempt each year to harvest in the difficult portion of the sale.

7.5 - Loss

7.5.1 - Deteriorating Timber (7/09)

The Sale Area has received damage from spring 2025 ice storm. The Purchaser should harvest the wood as soon as possible. The Department of Natural Resources is held free of responsibility of any further damage or deterioration due to delay in harvesting.



TIMBER SALE MAP

This information provided by authority of Part 525, 1994 PA 451, as amended.

Sale Number

72-008-24

Date

12/02/2024

Forest Management Unit

Grayling Mgt Unit

County

Crawford

Mapped By: Jake Halabut

Cruised By: Jake Halabut

Scale

1:20,000

Page

1

Of

1

Township
27N

Range
01W

Section(s) and
Subdivision(s) Sec. 1 S1/2SW; Sec. 2 N1/2NW,SWNW,E1/2NE,NWSW,S1/2SW;

Cover Type

A = Aspen	J = Jack Pine	O = Oak	U = Upland Brush
B = Paper Birch	K = Rock	P = Lowland Poplar	UM = Upland Mix Forest
C = Cedar	L = Lowland Brush	Q = Mixed Swamp Conifer	V = Bog or Marsh
D = Treed Bog	LM = Lowland Mix Forest	R = Red Pine	W = White Pine
E = Swamp Hardwoods	M = Maple, Beech, Birch	S = Black Spruce	X = Non Stocked
F = Spruce/Fir	MC = Mixed Conifer	T = Tamarack	Y = Sand
G = Grass	MD = Mixed Deciduous	Z = Water	
H = Hemlock	N = Marsh		

Density

0 = Non Stocked	5 = Pole Timber Medium
1 = Seedling Sapling Poor	6 = Pole Timber Well
2 = Seedling Sapling Medium	7 = Saw Timber Poor
3 = Seedling Sapling Well	8 = Saw Timber Medium
4 = Pole Timber Poor	9 = Saw Timber Well

Locator Map (1:200,000)

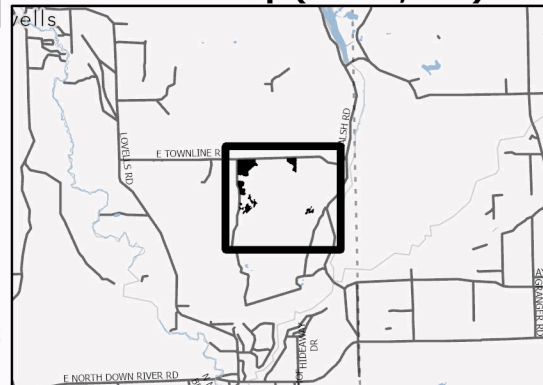

PU #	Acres	PU #	Acres
1	26.1	4	19.3
2	17.9	5	15.5
3	14.8	6	6.3

**Loggy Bottom
Boys**
99.9 Acres
Comp 287

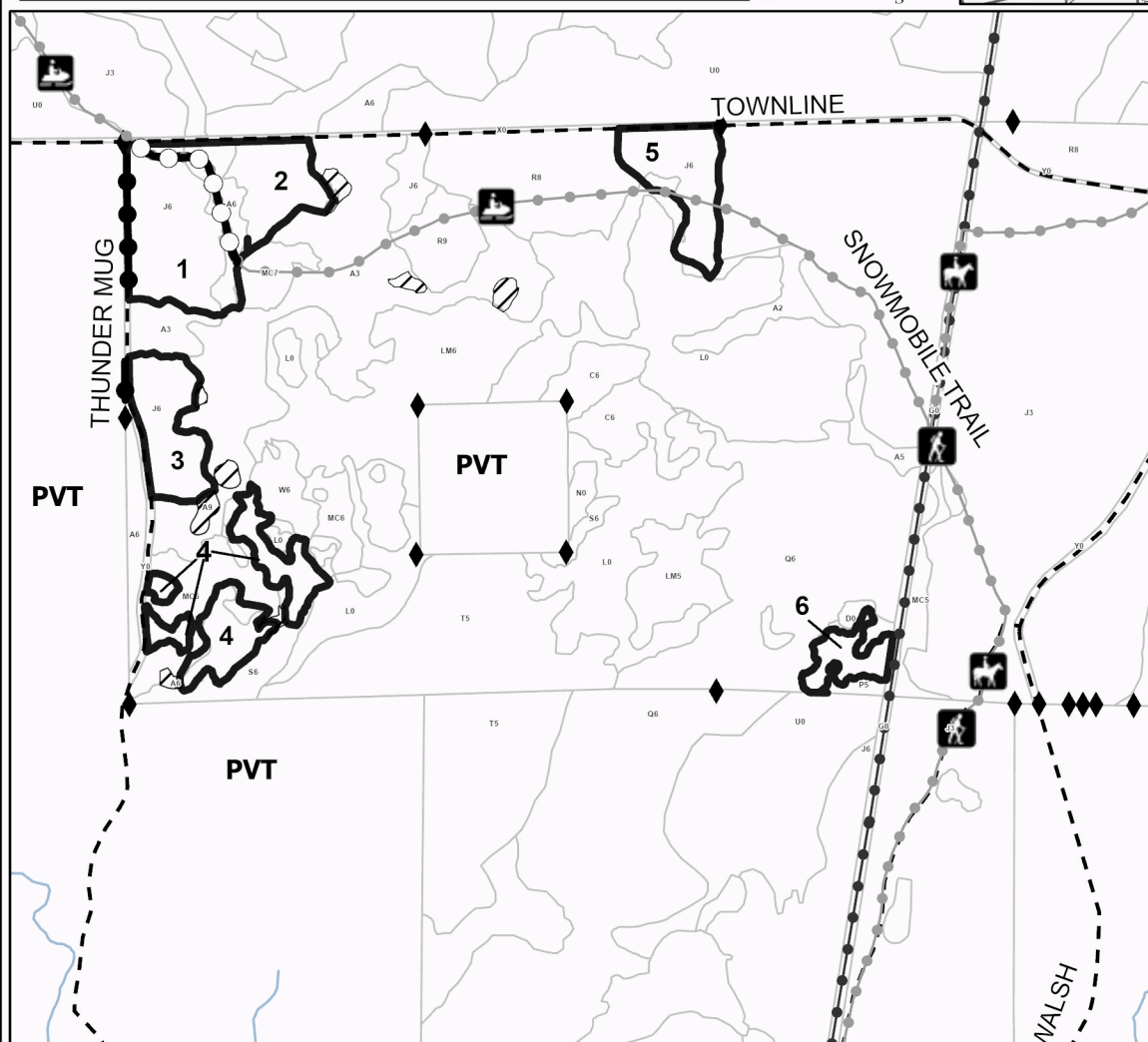
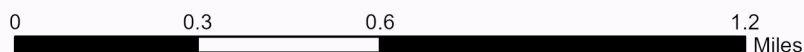

Legend

- Sale Boundary (Red/Unmarked Rd)
- Stand
- Payment Unit (Unmarked Rd)
- Private Line (Unmarked Rd)
- Recreational Trail
- Gravel Road
- Powerline
- Field Grade Corner
- Retention Areas

Use QR Code to open Map in App



TIMBER SALE INFORMATION

High Voltage Mix (72-017-24)
T27N, R02E, SEC. 28; T27N, R02E, SEC. 29.
Oscoda County (Advertised Price \$111,510.25)

SALE NOTE: Good access to this sale from Franks road. Portions of this sale are adjacent to the high voltage power line. Consumers Energy will need to be contacted before operations can begin. Good timber with some variable terrain. Some payment units have seasonal restrictions.

Access may be through private land.

A timber sale contract for this lump sum, sealed bid timber sale will be awarded to the responsible bidder offering the highest sealed bid price. All units of volume listed below were estimated using the Inventory Manager computer program and the new Michigan taper model. Bids must be at or above the following advertised price for each product and species:

<u>PRODUCTS & SPECIES</u>	<u>ESTIMATED UNITS*</u>	<u>ADVERTISED PRICE</u>
Sawtimber		
Black/Red (Hybrid) Oak	481.4 MBF	\$ 122.00 / MBF
Red Maple	28.9 MBF	\$ 69.00 / MBF
Pulpwood		
B. T. Aspen	1,021 Cords	\$ 20.20 / Cord
Mixed Hardwood	523 Cords	\$ 23.35 / Cord
Mixed Oak	598 Cords	\$ 20.05 / Cord
Red Pine	122 Cords	\$ 48.00 / Cord
White Pine	6 Cords	\$ 17.20 / Cord

* The total volume is statistically estimated within plus (+) or minus (-) 15.63 percent. There are an estimated 3,472 cords on this timber sale, plus or minus 543 cords at the 95% confidence level. The estimated units are final and not subject to adjustment. Prospective bidders are urged to examine this timber and to make their own estimates of quantity and quality.

BOND AND PAYMENT SCHEDULE:

1. A bond in the amount of \$5,576.00 to insure faithful performance of the conditions of the contract will be deposited by the successful bidder within 21 days of the sale award.
2. Cutting in any sale or unit without the required advance payment would be considered a trespass.
3. Total payment must be paid in advance or according to the following schedule :
 - (a) Ten percent (10%) of the sale value must be paid within 21 days of the sale award.
 - (b) The 10% down payment will be credited towards the first unit cut.
 - (c) Payment for each of the following units must be made before cutting begins in that unit:

PAYMENT UNIT NUMBER	PERCENT OF TOTAL SALE VALUE
01	8.4%
02	25.1%
03	25.7%
04	23.6%
05	17.2%

4. If no cutting takes place, the 10% down payment will not be refunded.
5. Operations on the contract issued will terminate on 06/30/2029.

SALE STATISTICS

Volumes were calculated in cubic feet using the Michigan taper model. Cubic foot volume includes all wood inside bark for the product indicated. For display purposes, cubic feet were converted to cords and MBF using a simple conversion factor, e.g. 79 cubic feet per cord and 185 cubic feet per MBF. The cubic foot volumes are precise; the cords and MBF volumes are not. Cubic foot volume cannot be directly converted to cords or boards with precision.

SALE VOLUMES

The total estimated sale volume may not equal the sum of the species/products due to the nature of statistical calculations associated with double sampling methodology.

VOLUME		STATISTICAL RANGE IN CORDS		
TOTAL CUBIC FEET	TOTAL CORDS	PERCENT ERROR	MINIMUM	MAXIMUM
274,327	3,472	15.63%	2,930	4,015

VDU VOLUMES

A VDU is a Volume Determination Unit. Volumes and their associated statistics are calculated at the VDU level and summarized to the sale level. There is often a one to one relationship between a VDU and a Payment Unit, but not always, depending on the cruise design. Refer to the VDU TO PAYMENT UNIT table.

VDU	VOLUME		PERCENT ERROR	RANGE IN CORDS	
	TOTAL CUBIC FEET	TOTAL CORDS		MINIMUM	MAXIMUM
65	19,290	244	27.47%	177	311
69	57,104	723	26.60%	531	915
80	54,300	687	35.69%	442	933
81	143,633	1,818	24.78%	1,368	2,269
TOTAL:	274,327	3,472		2,517	4,428

VDU TO PAYMENT UNIT

When a VDU is associated with more than one Payment Unit (PU), the VDU volumes are assigned to the PU based on acres of the VDU within the PU.

VDU	VDU ACRES	PU	PU ACRES
TOTAL:			

DESCRIPTION OF TIMBER BY PAYMENT UNIT (PU)

PU	MARKET GROUP	PRODUCT	QUANTITY	UNIT	ACRES	ADVERTISE PRICE		
1	Black/Red (Hybrid	Sawtimber	57.7	MBF	23.7	\$9,386.50		
	Red Oak		57.7	MBF				
	Red Maple	2.4	MBF					
	B. T. Aspen	Pulpwood	1	Cords				
	Mixed Hardwood		30	Cords				
	Red Maple		30	Cords				
	Mixed Oak		72	Cords				
	Red Oak		72	Cords				
	White Pine		1	Cords				
White Pine	1		Cords					
2	Black/Red (Hybrid	Sawtimber	178.5	MBF	25.1	\$27,956.95		
	/Red (Hybrid) Oak		5.0	MBF				
	Red Oak		173.5	MBF				
	Red Maple	2.3	MBF					
	B. T. Aspen	Pulpwood	11	Cords				
	Mixed Hardwood		50	Cords				
	Sugar Maple		Sawtimber	5.4			MBF	
	Beech			Pulpwood			2	Cords
	Black Cherry						4	Cords
	Red Maple						22	Cords
	Sugar Maple		11				Cords	
	Mixed Oak		231				Cords	
	/Red (Hybrid) Oak		15				Cords	
	Red Oak		216	Cords				
3	Black/Red (Hybrid	Sawtimber	95.7	MBF	24.7	\$28,642.10		
	/Red (Hybrid) Oak		75.0	MBF				
	Red Oak		20.7	MBF				
	Red Maple	7.6	MBF					
	B. T. Aspen	Pulpwood	397	Cords				
	Mixed Hardwood		139	Cords				
	Red Maple		139	Cords				
	Mixed Oak		105	Cords				
	/Red (Hybrid) Oak		80	Cords				
	Northern Pin Oak		10	Cords				
	Red Oak		15	Cords				
Red Pine	64		Cords					
4	Black/Red (Hybrid	Sawtimber	88.0	MBF	22.7	\$26,329.70		
	/Red (Hybrid) Oak		68.9	MBF				
	Red Oak		19.1	MBF				
	Red Maple	7.0	MBF					
	B. T. Aspen	Pulpwood	365	Cords				
	Mixed Hardwood		128	Cords				
	Red Maple		128	Cords				
	Mixed Oak		98	Cords				
	/Red (Hybrid) Oak		74	Cords				
	Northern Pin Oak		10	Cords				
Red Oak	14		Cords					
Red Pine	58	Cords						
5	Black/Red (Hybrid	Sawtimber	61.5	MBF	13.1	\$19,195.00		
	Red Oak		61.5	MBF				
	Red Maple	9.6	MBF					
	B. T. Aspen	Pulpwood	247	Cords				
	Mixed Hardwood		176	Cords				
	Red Maple		176	Cords				
	Mixed Oak		92	Cords				
Red Oak	92		Cords					

DESCRIPTION OF TIMBER BY PAYMENT UNIT (PU), CON'T

PU	MARKET GROUP	PRODUCT	QUANTITY	UNIT	ACRES	ADVERTISE PRICE
5 con't	White Pine	Pulpwood	5	Cords		
	<i>White Pine</i>	<i>Sawtimber</i>	1.1	<i>MBF</i>		
	<i>White Pine</i>	<i>Pulpwood</i>	3	<i>Cords</i>		
TOTAL:			510.3	MBF		
TOTAL:			2,270	Cords		

Sale Specific Conditions & Requirements

Sale Name: High Voltage Mix

Sale Number: 72-017-24 Seq#: 3

1 - Sale Area

1.2 - Boundaries

1.2.1 - Painted Boundaries (9/19)

The sale boundary and Payment Unit boundaries are marked and identified by blue, red and yellow paint or are unmarked and designated on the Timber Sale Map. Exterior sale boundary lines against private property are marked with blue paint. Exterior sale boundary lines against state are marked with red paint with the exception of the northwest portion of Payment Unit 1, which is unpainted and identified by the cover type change, the eastern boundary of Payment Unit 3, which is unpainted and identified by the north/south forest two track. Also, the north line of Payment Unit 4, is unpainted and identified by the young aspen stand. The western portion of Payment Unit 5 is also unpainted and identified by the cover type change. See Timber Sale Map for locations. Interior Payment Unit boundaries are marked with yellow paint. Retention patches are marked with red paint; no harvesting activities may occur within these areas. The painted boundary line trees are not Included Timber and are to be protected. Yellow painted trees designating an interior Payment Unit boundary are only to be cut when all surrounding Payment Units have been paid.

2 - Timber Specifications

2.1 - Included Timber

2.1.1 - Clearcut Unit(s) with Unmerchantable Trees (6/14)

Within Payment Unit(s) 2-5, cut all trees that are two (2) inches or more at DBH, except in Payment Units 3-5, do not cut oak, white pine, or red pine greater than 26 inches DBH. Within Payment Unit 2, DO NOT CUT ANY CONIFER SPECIES.

2.1.2 - Clearcut Unit(s) w/o Unmerchantable Trees (8/11)

Within Payment Unit(s) 1, cut all trees which meet minimum piece specifications in 2.2 Utilization. Everything 2 inches and up in the operational pathways, such as skid trails are to be cut clean.

2.2 - Utilization

2.2.10 - No Chipping Tops and Limbs (8/16)

Within Payment Unit(s) 2, chipping of the bole, two (2) inches in diameter or greater, is allowed. Chipping of limbs or portions of the tree less than two (2) inches in diameter is not permitted. Limbs and the remaining top must be left on site and scattered.

3 - Payments

3.3 - Pre-measured Sales

3.3.4 - Dividing Payment Units (7/14)

Payment Unit(s) may be divided at the request of the Purchaser and upon approval of the Unit Manager. Dividing Payment Units is a contract modification which requires a Timber Sale Contract Amendment. There will be only one division per Payment Unit.

3.4 - Damaged Timber

3.4.1 - Damaged Timber (12/24)

General Condition and Requirement 3.4 Damaged Timber, defines liquidated damages for undesignated live merchantable trees which are cut or injured. In addition, reasonable care should be taken to avoid damage to tree seedlings and saplings within Payment Unit 1.

Within the Payment Unit 1, if more than 30% of the tree seedlings or saplings (1/4" to 4.5" DBH) within a specified portion of the Sale Area are damaged, liquidated damages will be assessed at \$250 per acre for all acreage within that specified portion of the Sale Area that was damaged. Seedlings and saplings cut cleanly in skid trails and for operational purposes will not be counted as damage.

No damage is acceptable to undesignated live merchantable trees. Within the Sale Area, if more than 10% of trees (> 4.5" DBH) within a specified area of the sale are damaged, liquidated damages will be assessed for all trees damaged. Rates will be in accordance with General Condition and Requirement 3.4 Damaged Timber.

3.4.2 - Special Protection Trees (1/25)

The Purchaser shall not cut live or dead special protection trees within cutting units or clearings. Special protection trees are oak, white pine, and red pine over 26 inches DBH. If Purchaser's operations have cut or damaged special protection trees through carelessness, the Purchaser shall pay \$500 as fixed, agreed and liquidated damages for each special protection tree cut or damaged. Such payment does not constitute ownership of the undesignated timber.

4 - Transportation

4.1 - Construction

4.1.3 - Slash and Earthen Piles (8/04)

Piles or windrows of earth along roads and landings that have been widened or constructed shall be leveled. Slash from road maintenance or construction, including stumps, shall be dispersed throughout the sale.

4.1.6 - Road Construction (4/24)

Construction of new roads or improvements of existing roads shall be done in such a way as to minimize the environmental and visual impacts. Merchantable trees shall be cut and utilized unless otherwise directed. Non-merchantable trees shall be severed and laid flat on the ground. Slash shall be scattered, and not left in windrows and kept a minimum of 10 feet back from the road edge. Stumps shall be set upright, not left on edge, and be moved at least 10 feet away from the road edge. Disturbed soil shall be feathered into the woods and not left in berms or windrows.

4.1.7 - Road Closure (10/11)

All new roads built into the sale must be blocked to vehicle traffic upon completion of the sale. Overgrown roads that are reopened shall be considered new roads. In general, this will require constructing double earthen berms at strategic locations. Stumps and brush must be placed along the remainder of the trail. These roads must be rendered impassable to cars and trucks. All stumps from road building and landing construction must be reserved to block any newly constructed roads upon completion of the sale. These stumps must be scattered along the road system to prohibit vehicular movement. Temporary berms may be required if no sale activity occurs for 30 or more consecutive days. Contact the Sale Administrator for specific details of design and placement.

4.1.11 - Permits (2/12)

The Purchaser will secure any necessary permits that may be required.

5 - Operations

5.1 - Notification

5.1.4 - Post-Sale Conference (10/16)

A post-sale conference on site between the Purchaser and sale administrator is required 5 days prior to the completion of active logging operations to determine clean-up and repair of landings, road edges, and the fulfillment of other contract specifications.

5.1.6 - Utility R.O.W. (4/19)

It is the responsibility of the Purchaser to obtain permission from the utility company to utilize the power line R.O.W. for operations. Contact Consumers Energy before timber harvesting operations begin.

5.2 - Conduct of Operations

5.2.2 - Hazard Trees/Snags

5.2.2.1 - Den Trees (10/16)

Obvious hollow and/or den trees shall be protected and left standing unless they are a safety hazard.

5.2.3 - Operating Restrictions

5.2.3.5 - Oak Wilt Restriction (1/18)

Within Payment Unit(s) 1-5, unless changed by written agreement, cutting, skidding, hauling within the sale and brushing

of access roads to the sale are not permitted during the period of April 15 to July 15. Operations may be allowed if specific steps are taken to prevent damaging uncut oak during the high-risk period. Those steps may include completing all road brushing before April 15 and clearing a tree-length buffer along uncut oak cover before April 15. This is necessary to reduce the spread of oak wilt. For more information, contact the Unit Manager or his/her representative.

5.2.4 - Dead and Down Creation

5.2.4.4 - Dead and Down Creation, Grouse (6/18)

To encourage grouse and other wildlife, in Payment Unit(s) 3-5, leave one 12" or larger diameter (or largest diameter trees within stand) whole tree on the ground for every 2 acres, preferably a hardwood species such as oak or maple or if no hardwoods are present, a pine species (white or red). These trees will be evenly scattered throughout the unit, preferably at least two chains from any roads, two-tracks, or trails open to vehicles.

5.2.22 - Operating Caution

5.2.22.1 - Operating Caution (6/11)

It is recommended, but not required, that within Payment Unit(s) 5, cutting, skidding, and hauling occur during dry summer or frozen winter conditions. The reason for the recommendation is because of steeper terrain.

5.2.29 - Shrub Protection (1/20)

Reasonable care should be taken to avoid cutting any hawthorn, dogwood or juneberry. These woody-shrub plants are highly beneficial to various wildlife species.

5.2.32 - Decking/Landing Restoration (9/13)

All decking and landing areas must have the surface area restored to a condition equal to or better than before. This is to ensure the proper regeneration of the stand. Wood debris, chips and "cookies" from trimmings must be removed or scattered away from landing and loading areas and may not be windrowed on the edge.

5.2.38 - No Decking Against Live Trees (2/04)

Cut products may not be decked against unmarked or designated leave trees.

5.4 - Soil Protection

5.4.2 - Skid Trails (2/04)

Skid trails up and down slopes should be avoided. If, however, this is unavoidable, these trails will be left in a non-erodible condition using water bars, logs, and slash. Placing of slash on these skid trails while logging is ongoing may alleviate need for any further action. At the direction of the Sale Administrator, seed, fertilizer, and mulch may also be required.

5.8 - Protection of Endangered Species

5.8.5 - Protection of Raptor Nests (3/13)

All trees with raptor nests will be protected if found during harvesting operations. Notification will be made to the Unit Manager or his/her representative who will notify the Wildlife Biologist so an onsite evaluation and recommendation can be made, if necessary.

6 - Safety and Fire Prevention

6.2 - Signing

6.2.1 - Road Posting (10/20)

The Purchaser is responsible for posting and maintaining caution signs on Franks Road prior to beginning operations. The road must be posted at appropriate distances from the Sale Area to warn of logging activity and truck traffic. Signs must be removed when harvest operations are suspended or completed. The Purchaser will provide these signs.



TIMBER SALE MAP

This information provided by authority of Part 525, 1994 PA 451, as amended.

Sale Number

72-017-24

Date

10/27/2025

Forest Management Unit

Grayling Mgt Unit

County

Oscoda

Mapped By: Michaud

Cruised By: Michaud

Scale

1:15,840

Page

1

Of

1

Township
27N

Range
02E

Section(s) and
Subdivision(s) Sec. 28 S1/2NW,N1/2SW,SWSW; Sec. 29 SENW,S1/2NE,NWSE;

Cover Type

A = Aspen	J = Jack Pine	O = Oak	U = Upland Brush
B = Paper Birch	K = Rock	P = Lowland Poplar	UM = Upland Mix Forest
C = Cedar	L = Lowland Brush	Q = Mixed Swamp Conifer	V = Bog or Marsh
D = Treed Bog	LM = Lowland Mix Forest	R = Red Pine	W = White Pine
E = Swamp Hardwoods	M = Maple, Beech, Birch	S = Black Spruce	X = Non Stocked
F = Spruce/Fir	MC = Mixed Conifer	T = Tamarack	Y = Sand
G = Grass	MD = Mixed Deciduous	Z = Water	
H = Hemlock	N = Marsh		

Density

0 = Non Stocked	5 = Pole Timber Medium
1 = Seedling Sapling Poor	6 = Pole Timber Well
2 = Seedling Sapling Medium	7 = Saw Timber Poor
3 = Seedling Sapling Well	8 = Saw Timber Medium
4 = Pole Timber Poor	9 = Saw Timber Well

Payment Unit Number	Acres
1	23.7
2	25.1
3	24.7
4	22.7
5	13.1

High Voltage Mix

109.3 Acres

Locator Map 1:100,000

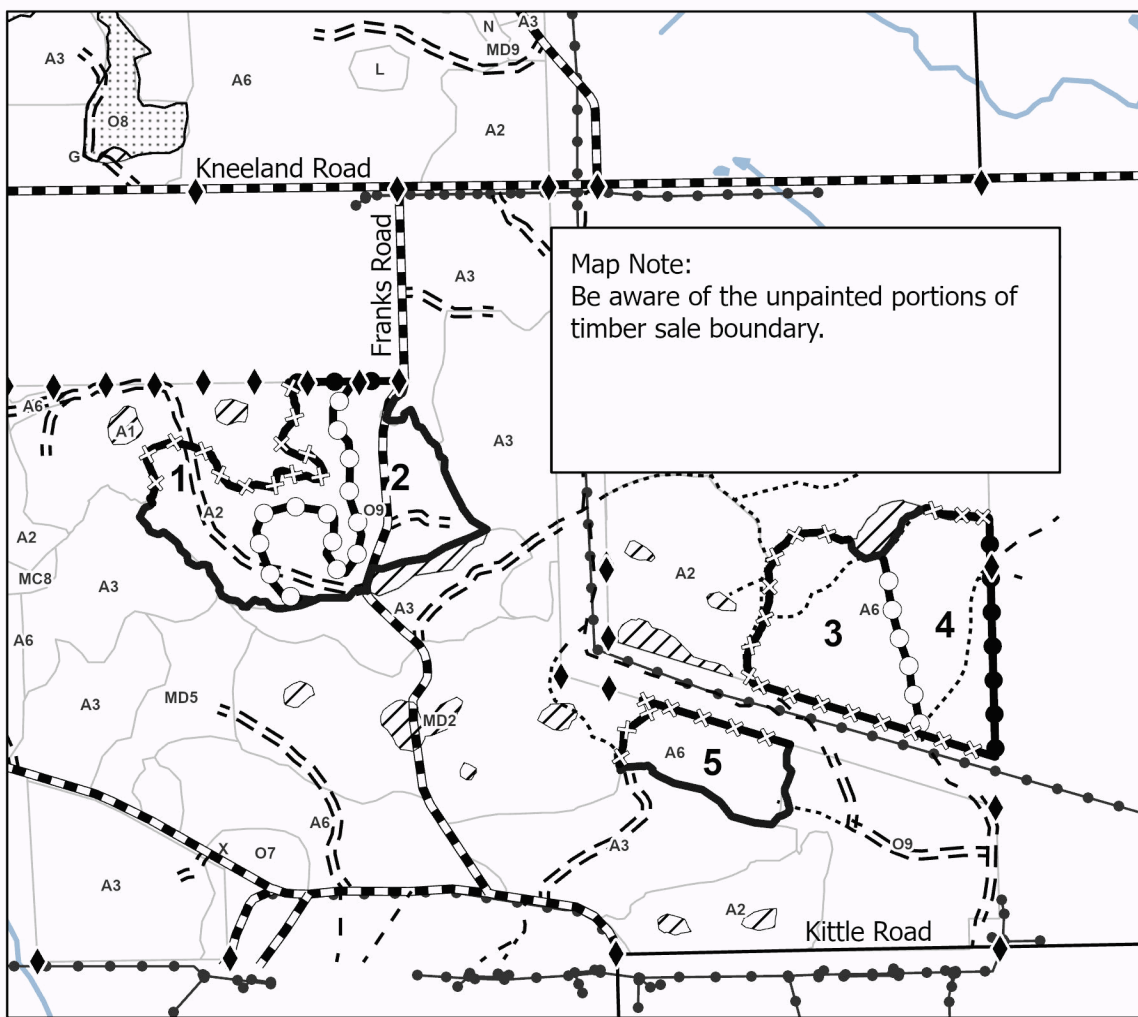
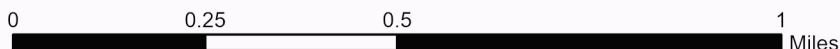
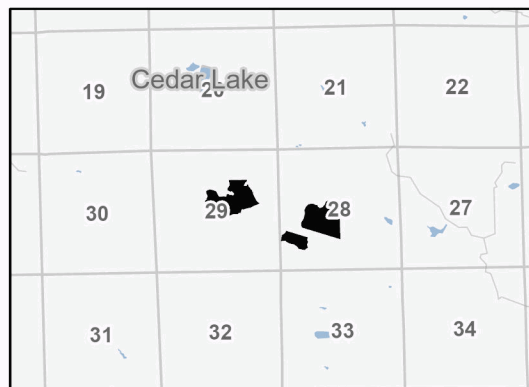

Map Note:
Be aware of the unpainted portions of timber sale boundary.

Legend

- Against state (Red)
- Against State (Unpainted)
- Private Line (Blue)
- Payment Unit (Yellow)
- Nearby Timber Sale
- Forest Access Route
- Administrative Access Only
- Paved Road
- Government Gravel/Dirt
- Private Gravel/Dirt
- Field Grade Corner

Use QR Code to open Map in App

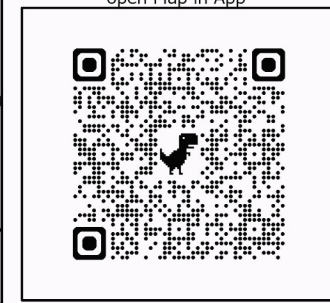

Ice-orcist (72-034-25)

T28N, R02E, SEC. 23; T28N, R02E, SEC. 25; T28N, R02E, SEC. 26; T28N, R02E,

In response to the notice of sale to be held 9:00 a.m. (local time) on May 18, 2026, I am hereby submitting my sealed bid (firm offer) for the following forest products to be cut. Bids for individual species must be at or above the advertised price. All non-responsive bid forms may be rejected.

<u>PRODUCTS & SPECIES</u>	<u>ESTIMATED VOLUME*</u>	<u>ADVERTISED PRICE</u>	<u>BID PRICE/UNIT</u>
Sawtimber			
Black/Red (Hybrid) Oak	12.9 MBF	\$ 27.00/MBF	\$ _____
Pulpwood			
Jack Pine	42 Cords	\$ 2.80/Cord	\$ _____
Mixed Aspen	2,534 Cords	\$ 4.50/Cord	\$ _____
Mixed Hardwood	374 Cords	\$ 5.20/Cord	\$ _____
Mixed Oak	231 Cords	\$ 4.45/Cord	\$ _____
Red Pine	185 Cords	\$ 10.65/Cord	\$ _____
White Pine	364 Cords	\$ 3.80/Cord	\$ _____

*The volumes are statistically estimated within plus (+) or minus (-) 26.38 percent at 95% confidence level. These estimated volumes are final and not subject to adjustment. Prospective bidders are urged to examine this timber and to make their own estimates of quantity and quality.

I understand that any or all bids may be rejected. All bids must be signed and all bid items must be bid or the bid form may be rejected. I also understand that consideration and awarding a contract will be based upon my past performance and ability to complete the contract based upon equipment and staffing subject to my control.

FEDERAL ID: _____ or SOCIAL SECURITY NUMBER: _____
 Company or individual bidding: _____
 Company representative's name: _____
 Address: _____
 City: _____ State: _____ Zip: _____

IF AVAILABLE, PLEASE PLACE THE PERSONALIZED LABEL FROM YOUR PROSPECTUS IN THE ABOVE BOX.

Individual or company representative's signature: _____ Date: _____

Phone number : _____ Email (optional): _____

THE WINNING BIDDER MUST COMPLETE THE VERIFICATION OF WORKER'S DISABILITY COMPENSATION ACT COMPLIANCE (ON REVERSE SIDE IF DOUBLE SIDED) WITHIN 21 DAYS OF SALE AWARD DATE

Ice- Bark Souls (72-041-25)
T28N, R03E, SEC. 20; Oscoda COUNTY

In response to the notice of sale to be held 9:00 a.m. (local time) on May 18, 2026, I am hereby submitting my sealed bid (firm offer) for the following forest products to be cut. Bids for individual species must be at or above the advertised price. All non-responsive bid forms may be rejected.

<u>PRODUCTS & SPECIES</u>	<u>ESTIMATED VOLUME*</u>	<u>ADVERTISED PRICE</u>	<u>BID PRICE/UNIT</u>
Sawtimber			
Sugar Maple	14.0 MBF	\$ 49.00/MBF	\$ _____
Pulpwood			
Black/Red (Hybrid) Oak	5 Cords	\$ 4.45/Cord	\$ _____
Mixed Aspen	1,055 Cords	\$ 4.50/Cord	\$ _____
Mixed Hardwood	182 Cords	\$ 5.20/Cord	\$ _____
White Pine	7 Cords	\$ 3.80/Cord	\$ _____

*The volumes are statistically estimated within plus (+) or minus (-) 24.87 percent at 95% confidence level. These estimated volumes are final and not subject to adjustment. Prospective bidders are urged to examine this timber and to make their own estimates of quantity and quality.

I understand that any or all bids may be rejected. All bids must be signed and all bid items must be bid or the bid form may be rejected. I also understand that consideration and awarding a contract will be based upon my past performance and ability to complete the contract based upon equipment and staffing subject to my control .

FEDERAL ID: ____ - ____ or SOCIAL SECURITY NUMBER: ____ - ____ - ____

Company or individual bidding: _____

Company representative's name: _____

Address: _____

City: _____ State: _____ Zip: _____

IF AVAILABLE, PLEASE PLACE THE PERSONALIZED LABEL FROM YOUR PROSPECTUS IN THE ABOVE BOX.

Individual or company representative's signature: _____ Date: _____

Phone number : _____ Email (optional): _____

THE WINNING BIDDER MUST COMPLETE THE VERIFICATION OF WORKER'S DISABILITY COMPENSATION ACT COMPLIANCE (ON REVERSE SIDE IF DOUBLE SIDED) WITHIN 21 DAYS OF SALE AWARD DATE

Ice- Pigpen Aspen (72-042-25)
T28N, R02E, SEC. 23; Oscoda COUNTY

In response to the notice of sale to be held 9:00 a.m. (local time) on May 18, 2026, I am hereby submitting my sealed bid (firm offer) for the following forest products to be cut. Bids for individual species must be at or above the advertised price. All non-responsive bid forms may be rejected.

<u>PRODUCTS & SPECIES</u>	<u>ESTIMATED VOLUME*</u>	<u>ADVERTISED PRICE</u>	<u>BID PRICE/UNIT</u>
Pulpwood			
B. T. Aspen	401 Cords	\$ 4.50/Cord	\$ _____
Black/Red (Hybrid) Oak	163 Cords	\$ 4.45/Cord	\$ _____
Mixed Hardwood	99 Cords	\$ 5.20/Cord	\$ _____

*The volumes are statistically estimated within plus (+) or minus (-) 39.11 percent at 95% confidence level. These estimated volumes are final and not subject to adjustment. Prospective bidders are urged to examine this timber and to make their own estimates of quantity and quality.

I understand that any or all bids may be rejected. All bids must be signed and all bid items must be bid or the bid form may be rejected. I also understand that consideration and awarding a contract will be based upon my past performance and ability to complete the contract based upon equipment and staffing subject to my control.

FEDERAL ID: ____ - ____ - ____ or SOCIAL SECURITY NUMBER: ____ - ____ - ____

Company or individual bidding: _____

Company representative's name: _____

Address: _____

City: _____ State: _____ Zip: _____

IF AVAILABLE, PLEASE PLACE THE PERSONALIZED LABEL FROM YOUR PROSPECTUS IN THE ABOVE BOX.

Individual or company representative's signature: _____ Date: _____

Phone number : _____ Email (optional): _____

THE WINNING BIDDER MUST COMPLETE THE VERIFICATION OF WORKER'S DISABILITY COMPENSATION ACT COMPLIANCE (ON REVERSE SIDE IF DOUBLE SIDED) WITHIN 21 DAYS OF SALE AWARD DATE



FOR DEPARTMENT USE ONLY	
Sale Number (XX - XXX - XX - XX)	
Forest Management Unit:	

TIMBER SALE VERIFICATION OF WORKER'S DISABILITY COMPENSATION ACT COMPLIANCE

As required by Act 317, P.A. 1969 (Worker's Compensation) and
Part 5 of Act 451 of 1994, as amended.

VERIFICATION OF WORKER'S DISABILITY COMPENSATION ACT COMPLIANCE

- This verification must be completed and submitted within 21 days of contract award and prior to the issuance of the timber sale contract.
- In addition, if boxes 2B or 2C are checked, then Notice of Exclusion or Certificate of Insurance must be submitted within twenty-one (21) days of the contract award and prior to the issuance of the timber sale contract.
- All information must be typed or printed except for written signatures.

Please Check Appropriate Categories:

1. My business is organized as (you **must** check one of the boxes below):
 - A. Sole Proprietorship (individual)
 - B. Partnership
 - C. Corporation
2. You **must** check one of the boxes below:
 - A. I certify my business is a sole proprietorship and it has no employees but the sole proprietor. I am not subject to the Worker's Compensation Laws.
 - B. I certify my business has satisfied its obligation to the Worker's Compensation Act through the use of an approved Notice of Exclusion (BWC-337, Rev. 5/96). I will provide a copy of the Notice of Exclusion within 21 days of the contract award. (For questions or a copy of the BWC-337, please call the Worker's Compensation Bureau at 517-322-1195).
 - C. I certify my business has a Worker's Compensation Policy. I will provide an original Certificate of Insurance within twenty-one (21) days of the contract award.
3. If you have checked item 2(A) or 2(B), you **must** indicate the number of **both** full-time and part-time employees, other than yourself, including family members and active partners (if none, you must enter "0").

_____ Full-time Employees

_____ Part-time Employees

Name of Business		Federal ID (or) Social Security No.	
Address		Telephone ()	
City	State	ZIP	

I hereby certify that the above information is true and correct. I agree to notify the Michigan DNR of any changes that occur in factors affecting my coverage during any of my present and future operations.

Signature of Owner or Authorized Representative

Title

Date

Please complete the "SEALED BID" information on the next page

Loggy Bottom Boys (72-008-24)
T27N, R01W, SEC. 1; T27N, R01W, SEC. 2; Crawford COUNTY

In response to the notice of sale to be held 9:00 a.m. (local time) on May 18, 2026, I am hereby submitting my sealed bid (firm offer) for the following forest products to be cut. Bids for individual species must be at or above the advertised price. All non-responsive bid forms may be rejected.

<u>PRODUCTS & SPECIES</u>	<u>ESTIMATED VOLUME*</u>	<u>ADVERTISED PRICE</u>	<u>BID PRICE/UNIT</u>
Pulpwood			
Balsam Fir	59 Cords	\$ 10.70/Cord	\$ _____
Black Cherry	17 Cords	\$ 13.00/Cord	\$ _____
Jack Pine	286 Cords	\$ 7.00/Cord	\$ _____
Misc. Species 1	425 Cords	\$ 6.50/Cord	\$ _____
Mixed Aspen	685 Cords	\$ 11.20/Cord	\$ _____
Northern Pin Oak	66 Cords	\$ 11.15/Cord	\$ _____
Red Maple	51 Cords	\$ 13.00/Cord	\$ _____
Red Pine	11 Cords	\$ 26.65/Cord	\$ _____
White Pine	87 Cords	\$ 9.55/Cord	\$ _____
White Spruce	21 Cords	\$ 10.15/Cord	\$ _____

*The volumes are statistically estimated within plus (+) or minus (-) 14.68 percent at 95% confidence level. These estimated volumes are final and not subject to adjustment. Prospective bidders are urged to examine this timber and to make their own estimates of quantity and quality.

I understand that any or all bids may be rejected. All bids must be signed and all bid items must be bid or the bid form may be rejected. I also understand that consideration and awarding a contract will be based upon my past performance and ability to complete the contract based upon equipment and staffing subject to my control.

FEDERAL ID: ____ - ____ - ____ or SOCIAL SECURITY NUMBER: ____ - ____ - ____

Company or individual bidding: _____

Company representative's name: _____

Address: _____

City: _____ State: _____ Zip: _____

IF AVAILABLE, PLEASE PLACE THE PERSONALIZED LABEL FROM YOUR PROSPECTUS IN THE ABOVE BOX.

Individual or company representative's signature: _____ Date: _____

Phone number : _____ Email (optional): _____

THE WINNING BIDDER MUST COMPLETE THE VERIFICATION OF WORKER'S DISABILITY COMPENSATION ACT COMPLIANCE (ON REVERSE SIDE IF DOUBLE SIDED) WITHIN 21 DAYS OF SALE AWARD DATE



FOR DEPARTMENT USE ONLY	
Sale Number (XX - XXX - XX - XX)	
Forest Management Unit:	

TIMBER SALE VERIFICATION OF WORKER'S DISABILITY COMPENSATION ACT COMPLIANCE

As required by Act 317, P.A. 1969 (Worker's Compensation) and
Part 5 of Act 451 of 1994, as amended.

VERIFICATION OF WORKER'S DISABILITY COMPENSATION ACT COMPLIANCE

- This verification must be completed and submitted within 21 days of contract award and prior to the issuance of the timber sale contract.
- In addition, if boxes 2B or 2C are checked, then Notice of Exclusion or Certificate of Insurance must be submitted within twenty-one (21) days of the contract award and prior to the issuance of the timber sale contract.
- All information must be typed or printed except for written signatures.

Please Check Appropriate Categories:

1. My business is organized as (you **must** check one of the boxes below):
 - A. Sole Proprietorship (individual)
 - B. Partnership
 - C. Corporation
2. You **must** check one of the boxes below:
 - A. I certify my business is a sole proprietorship and it has no employees but the sole proprietor. I am not subject to the Worker's Compensation Laws.
 - B. I certify my business has satisfied its obligation to the Worker's Compensation Act through the use of an approved Notice of Exclusion (BWC-337, Rev. 5/96). I will provide a copy of the Notice of Exclusion within 21 days of the contract award. (For questions or a copy of the BWC-337, please call the Worker's Compensation Bureau at 517-322-1195).
 - C. I certify my business has a Worker's Compensation Policy. I will provide an original Certificate of Insurance within twenty-one (21) days of the contract award.
3. If you have checked item 2(A) or 2(B), you **must** indicate the number of **both** full-time and part-time employees, other than yourself, including family members and active partners (if none, you must enter "0").

_____ Full-time Employees

_____ Part-time Employees

Name of Business		Federal ID (or) Social Security No.	
Address		Telephone ()	
City	State	ZIP	

I hereby certify that the above information is true and correct. I agree to notify the Michigan DNR of any changes that occur in factors affecting my coverage during any of my present and future operations.

Signature of Owner or Authorized Representative

Title

Date

Please complete the "SEALED BID" information on the next page

High Voltage Mix (72-017-24)
T27N, R02E, SEC. 28; T27N, R02E, SEC. 29; Oscoda COUNTY

In response to the notice of sale to be held 9:00 a.m. (local time) on May 18, 2026, I am hereby submitting my sealed bid (firm offer) for the following forest products to be cut. Bids for individual species must be at or above the advertised price. All non-responsive bid forms may be rejected.

<u>PRODUCTS & SPECIES</u>	<u>ESTIMATED VOLUME*</u>	<u>ADVERTISED PRICE</u>	<u>BID PRICE/UNIT</u>
Sawtimber			
Black/Red (Hybrid) Oak	481.4 MBF	\$ 122.00/MBF	\$ _____
Red Maple	28.9 MBF	\$ 69.00/MBF	\$ _____
Pulpwood			
B. T. Aspen	1,021 Cords	\$ 20.20/Cord	\$ _____
Mixed Hardwood	523 Cords	\$ 23.35/Cord	\$ _____
Mixed Oak	598 Cords	\$ 20.05/Cord	\$ _____
Red Pine	122 Cords	\$ 48.00/Cord	\$ _____
White Pine	6 Cords	\$ 17.20/Cord	\$ _____

*The volumes are statistically estimated within plus (+) or minus (-) 15.63 percent at 95% confidence level. These estimated volumes are final and not subject to adjustment. Prospective bidders are urged to examine this timber and to make their own estimates of quantity and quality.

I understand that any or all bids may be rejected. All bids must be signed and all bid items must be bid or the bid form may be rejected. I also understand that consideration and awarding a contract will be based upon my past performance and ability to complete the contract based upon equipment and staffing subject to my control.

FEDERAL ID: _____ or SOCIAL SECURITY NUMBER: _____

Company or individual bidding: _____

Company representative's name: _____

Address: _____

City: _____ State: _____ Zip: _____

IF AVAILABLE, PLEASE PLACE THE PERSONALIZED LABEL FROM YOUR PROSPECTUS IN THE ABOVE BOX.

Individual or company representative's signature: _____ Date: _____
Phone number : _____ Email (optional): _____

THE WINNING BIDDER MUST COMPLETE THE VERIFICATION OF WORKER'S DISABILITY COMPENSATION ACT COMPLIANCE (ON REVERSE SIDE IF DOUBLE SIDED) WITHIN 21 DAYS OF SALE AWARD DATE



FOR DEPARTMENT USE ONLY
Sale Number (XX - XXX - XX - XX)
Forest Management Unit:

TIMBER SALE VERIFICATION OF WORKER'S DISABILITY COMPENSATION ACT COMPLIANCE

*As required by Act 317, P.A. 1969 (Worker's Compensation) and
Part 5 of Act 451 of 1994, as amended.*

VERIFICATION OF WORKER'S DISABILITY COMPENSATION ACT COMPLIANCE

- This verification must be completed and submitted within 21 days of contract award and prior to the issuance of the timber sale contract.
- In addition, if boxes 2B or 2C are checked, then Notice of Exclusion or Certificate of Insurance must be submitted within twenty-one (21) days of the contract award and prior to the issuance of the timber sale contract.
- All information must be typed or printed except for written signatures.

Please Check Appropriate Categories:

1. My business is organized as (you **must** check one of the boxes below):
 - A. Sole Proprietorship (individual)
 - B. Partnership
 - C. Corporation

2. You **must** check one of the boxes below:
 - A. I certify my business is a sole proprietorship and it has no employees but the sole proprietor. I am not subject to the Worker's Compensation Laws.
 - B. I certify my business has satisfied its obligation to the Worker's Compensation Act through the use of an approved Notice of Exclusion (BWC-337, Rev. 5/96). I will provide a copy of the Notice of Exclusion within 21 days of the contract award. (For questions or a copy of the BWC-337, please call the Worker's Compensation Bureau at 517-322-1195).
 - C. I certify my business has a Worker's Compensation Policy. I will provide an original Certificate of Insurance within twenty-one (21) days of the contract award.

3. If you have checked item 2(A) or 2(B), you **must** indicate the number of **both** full-time and part-time employees, other than yourself, including family members and active partners (if none, you must enter "0").

_____ Full-time Employees

_____ Part-time Employees

Name of Business		Federal ID (or) Social Security No.	
Address		Telephone ()	
City	State	ZIP	

I hereby certify that the above information is true and correct. I agree to notify the Michigan DNR of any changes that occur in factors affecting my coverage during any of my present and future operations.

Signature of Owner or Authorized Representative

Title

Date

Please complete the "SEALED BID" information on the next page

Joan of Arctic Mix (72-006-26)
T28N, R04W, SEC. 5; T28N, R04W, SEC. 6; T28N, R04W, SEC. 8; Crawford

In response to the notice of sale to be held 9:00 a.m. (local time) on May 18, 2026, I am hereby submitting my sealed bid (firm offer) for the following forest products to be cut. Bids for individual species must be at or above the advertised price. All non-responsive bid forms may be rejected.

<u>PRODUCTS & SPECIES</u>	<u>ESTIMATED VOLUME*</u>	<u>ADVERTISED PRICE</u>	<u>BID PRICE/UNIT</u>
Sawtimber			
Red Pine	36.9 MBF	\$ 120.00/MBF	\$ _____
Pulpwood			
Balsam Fir	17 Cords	\$ 16.10/Cord	\$ _____
Jack Pine	63 Cords	\$ 10.50/Cord	\$ _____
Mixed Aspen	476 Cords	\$ 16.85/Cord	\$ _____
Mixed Hardwood	16 Cords	\$ 19.45/Cord	\$ _____
Red Oak	11 Cords	\$ 16.70/Cord	\$ _____
Red Pine	128 Cords	\$ 40.00/Cord	\$ _____
White Pine	91 Cords	\$ 14.30/Cord	\$ _____

*The volumes are statistically estimated within plus (+) or minus (-) 17.43 percent at 95% confidence level. These estimated volumes are final and not subject to adjustment. Prospective bidders are urged to examine this timber and to make their own estimates of quantity and quality.

I understand that any or all bids may be rejected. All bids must be signed and all bid items must be bid or the bid form may be rejected. I also understand that consideration and awarding a contract will be based upon my past performance and ability to complete the contract based upon equipment and staffing subject to my control .

FEDERAL ID: ____ - ____ - ____ or SOCIAL SECURITY NUMBER: ____ - ____ - ____

Company or individual bidding: _____

Company representative's name: _____

Address: _____

City: _____ State: _____ Zip: _____

IF AVAILABLE, PLEASE PLACE THE PERSONALIZED LABEL FROM YOUR PROSPECTUS IN THE ABOVE BOX.

Individual or company representative's signature : _____ Date: _____

Phone number : _____ Email (optional): _____

THE WINNING BIDDER MUST COMPLETE THE VERIFICATION OF WORKER'S DISABILITY COMPENSATION ACT COMPLIANCE (ON REVERSE SIDE IF DOUBLE SIDED) WITHIN 21 DAYS OF SALE AWARD DATE



FOR DEPARTMENT USE ONLY	
Sale Number (XX - XXX - XX - XX)	
Forest Management Unit:	

TIMBER SALE VERIFICATION OF WORKER'S DISABILITY COMPENSATION ACT COMPLIANCE

As required by Act 317, P.A. 1969 (Worker's Compensation) and
Part 5 of Act 451 of 1994, as amended.

VERIFICATION OF WORKER'S DISABILITY COMPENSATION ACT COMPLIANCE

- This verification must be completed and submitted within 21 days of contract award and prior to the issuance of the timber sale contract.
- In addition, if boxes 2B or 2C are checked, then Notice of Exclusion or Certificate of Insurance must be submitted within twenty-one (21) days of the contract award and prior to the issuance of the timber sale contract.
- All information must be typed or printed except for written signatures.

Please Check Appropriate Categories:

1. My business is organized as (you **must** check one of the boxes below):
 - A. Sole Proprietorship (individual)
 - B. Partnership
 - C. Corporation
2. You **must** check one of the boxes below:
 - A. I certify my business is a sole proprietorship and it has no employees but the sole proprietor. I am not subject to the Worker's Compensation Laws.
 - B. I certify my business has satisfied its obligation to the Worker's Compensation Act through the use of an approved Notice of Exclusion (BWC-337, Rev. 5/96). I will provide a copy of the Notice of Exclusion within 21 days of the contract award. (For questions or a copy of the BWC-337, please call the Worker's Compensation Bureau at 517-322-1195).
 - C. I certify my business has a Worker's Compensation Policy. I will provide an original Certificate of Insurance within twenty-one (21) days of the contract award.
3. If you have checked item 2(A) or 2(B), you **must** indicate the number of **both** full-time and part-time employees, other than yourself, including family members and active partners (if none, you must enter "0").

_____ Full-time Employees

_____ Part-time Employees

Name of Business		Federal ID (or) Social Security No.	
Address		Telephone ()	
City	State	ZIP	

I hereby certify that the above information is true and correct. I agree to notify the Michigan DNR of any changes that occur in factors affecting my coverage during any of my present and future operations.

Signature of Owner or Authorized Representative

Title

Date

Please complete the "SEALED BID" information on the next page