



**DEPARTMENT OF NATURAL RESOURCES
STATE OF MICHIGAN
TIMBER SALE PROSPECTUS #7756**

SCHEDULED SALE DATE AND TIME: 9:00 a.m. (local time) on January 20, 2026.

LOCATION: ROSCOMMON MGMT UNIT, 8717B N ROSCOMMON RD., ROSCOMMON, MI 48653.

PROSPECTUS NOTE: The bidder is advised to inspect the sale area and review the location, estimated volumes, operating costs and contract terms of proposed sales. Please be aware that some landowners may request 60 days or more notice for access across their land.

Notice is hereby given that bids will be received by the Unit Manager, ROSCOMMON MANAGEMENT UNIT, for certain timber on the following described lands:

Antler Drip Oak (71-010-25) / T21N, R01W, SEC. 4 , N1/2SW,NWSE.

T21N, R01W, SEC. 6 , NW.

T22N, R01W, SEC. 32, E1/2NE,N1/2SW,N1/2SE.

T22N, R01W, SEC. 33, N1/2SE.

T22N, R01W, SEC. 33, NWNW,S1/2NW,S1/2NE,N1/2SW.

Roscommon County, Advertised Price \$122,431.50, 279.7 Acres, Hardwood, Red Oak.

SALE NOTE: Misc. Species 1 is standing dead oak.

The sale consists of three (3) thinning units and 11 clearcut units.

See oak wilt restrictions.

61 Thin (71-011-25) / T24N, R01W, SEC. 30, NWNW.

T24N, R01W, SEC. 31, NENW,N1/2NE.

T24N, R02W, SEC. 24, SESE.

T24N, R02W, SEC. 25, E1/2NE.

Roscommon County, Advertised Price \$35,187.40, 70.3 Acres, Red Pine, Hardwood.

SALE NOTE: A recreation site such as a trail, pathway, or campground is within the sale area or the vicinity. Certain restrictions/specifications may be applicable including time restrictions.

BID INSTRUCTIONS (VER. 10/10/2022):

1. Scheduled Bid Location, Date, and Time (2/11)

Bids must be received by the Unit Manager, ROSCOMMON OFFICE, 8717B N Roscommon Rd., Roscommon, MI 48653, no later than 9:00 a.m. (local time) on January 20, 2026. For further information concerning this sale, contact Jason Lewicki at 989-745-5870 extension .

2. Bidder's Qualifications (10/22)

If all or part of a timber sale was prepared by a private contractor, the contractor and that contractor's company are not permitted to bid on the timber sale. A person must be 18 years of age or older to purchase timber. Permanent employees of the Department of Natural Resources or members of their immediate household may not bid. Former employees, in the permanent or seasonal class, may not bid until 3 months after the last day of active duty. Bids will not be accepted from individuals or companies appearing on the DNR/FRD No-Bid List. This list contains the names of purchasers who previously failed to execute a contract within 21-days or who have a history of poor performance.

3. Preparation of Sealed Bids (5/16)

Bid Forms may be completed online thru Michigan DNR Timber Sale Online Bidding (OLB) at www.michigan.gov/timberbidding or by completing the hardcopy Bid Form found in the Timber Sale Prospectus . Hardcopy Bid Forms shall be manually signed in ink. Registration in OLB is considered your 'signature' for all bids submitted thru that system. Bid prices must be entered for each species and product in the Bid Price column for all material subject to bidding and all fill-in blanks must be completed. If erasures or other changes appear on the hardcopy Bid Form, each erasure or change must be initialed by the person signing the bid.

4. Submission of Sealed Bids (5/16)

Bid forms may be obtained from the Unit Manager or thru OLB. Bids may be submitted hardcopy or thru OLB. All hardcopy bids must be submitted on the bid form and in an envelope clearly identified as described in this section. NOTE: Only one bid form per bid envelope. Sealed bids must be submitted to the Unit office designated in the prospectus and must be submitted at or prior to the time established in the prospectus. The envelope should show on the outside (a) the sale name or number and (b) the date and time of bid opening, as shown in the prospectus. Bids received after the time specified in the sale prospectus are late bids and will be rejected.

It is possible for a bidder to submit multiple bids on a single sale. For example, a bid may be submitted hardcopy and a bid may be submitted thru OLB. Or, two bidders from the same company could both submit bids on the same sale. If this were to happen, the State would accept all bids received and award the contract accordingly. All bidding and contractual requirements would apply to all bids received.

5. Public Opening of Sealed Bids (7/16)

If conditions permit, the sealed bids will be publicly opened and posted at the time and place set in the prospectus.

If a bidder, present at a bid opening, has submitted bids on more than one sale, that bidder may withdraw their unopened bid envelopes or announce the withdrawal of their online bid after being declared the successful bidder on one sale.

6. Award of Contract (1/11)

Award of the contract will be made to the Bidder whose bid, conforming to the prospectus, is most advantageous to the State of Michigan on the basis of total value at rates bid for the estimated quantities. The State reserves the right to reject any bid or waive any minor irregularity in bids received. A written award mailed (or otherwise furnished) to the successful Bidder shall be deemed to result in a binding contract without further action by either party.

7. Down Payment (1/11)

The Bidder to whom award is made must make a down payment within 21 days of the sale award. The amount of the down payment will be calculated as shown in the Bond and Payment Schedule of this prospectus. Only cash may be used to meet this requirement.

8. Performance Security (1/11)

As guarantee of faithful performance, a cash bond, certificate of deposit, surety bond or irrevocable letter of credit (LOC) is required within 21 days of the sale award. The amount of the performance security is shown in the Bond and

Payment Schedule of this prospectus. If an LOC or surety is used, the coverage must extend for at least 6 months beyond the contract expiration.

9. Worker's Compensation (10/22)

Purchaser shall obtain worker's compensation insurance to cover claims under Michigan's Worker's Disability Compensation Act of 1969 or similar employee benefit act of any other state applicable to an employee. Verification of Worker's Disability Compensation Act Compliance must be completed and submitted within 21 days of contract award and prior to the issuance of the timber sale contract. In addition, if applicable, Notice of Exclusion or Certificate of Insurance must also be submitted.

10. Timber Sale Contract (10/22)

Additional conditions and requirements common to all timber sales are listed on the timber sale contract (R4031) and are available on line at www.michigan.gov/timber. Contact the Unit Manager for additional information or a sample contract. Within 21 days of the date of the award letter, the bidder must sign the contract and provide the required down payment, performance security, and verification of worker's disability compensation. The down payment and performance security shall be in accordance with the provisions of the timber sale contract, in the sums stated in this prospectus. If these actions are not taken, then the Bidder, the Bidder's corporation, and the corporation's principals may not be permitted to bid on State timber sales for a period of 3 months after the first offense, 6 months after the second offense, and 1 year after the third offense. An offense will only be counted against the Bidder for 5 years. In addition, the Bidder certifies that if awarded this contract, the Bidder will complete the timber sale contract in accordance with its terms and any modifications thereof including requirements to purchase, cut, and remove the included timber by the expiration date.

Payment Unit values in the State Forest Timber Sale Contract are calculated based on the advertised value of the Payment Unit as a percentage of the total advertised value of the contract. The advertised value of each Payment Unit is given in the Description of Timber by Payment Unit table on the Timber Sale Information page. For example, if the value of Payment Unit 1 is advertised as \$1,500 and the total Timber Sale value is advertised as \$10,000, the contract price for Payment Unit 1 will be 15% of the total bid price ($\$1,500/\$10,000 * 100$).

11. Disclaimer of Estimates and Bidder's Warranty of Inspection (10/22)

Before submitting this bid, the Bidder is advised and cautioned to inspect the sale area, review the requirements of the sale contract, and take other steps as may be reasonably necessary to ascertain the location, estimated volumes, construction estimates, and operating costs of the proposed sale. Failure to do so will not relieve the Bidder from responsibility for completing the contract.

The Bidder warrants that this bid is submitted solely on the basis of the Bidder's examination and inspection of the quality and quantity of the timber offered for sale and the Bidder's opinion of the value thereof and the costs of recovery. No reliance should be placed on the State of Michigan's estimates of timber quality, quantity or costs of recovery. Bidder further acknowledges that the State of Michigan: (i) expressly disclaims any warranty of fitness of timber for any purpose; (ii) offers this timber as is without any warranty of quality (merchantability) or quantity and (iii) expressly disclaims any warranty as to the quantity or quality of timber sold.

12. Certification and Chain-of-Custody (10/22)

Unless otherwise indicated in the contract under section 7 – Other Conditions of the Sale Specific Conditions & Requirements, the area encompassed by this timber sale is certified to the standards of the Forest Stewardship Council (FSC) - Certificate #SCS-FM/COC-00090N and the Sustainable Forestry Initiative (SFI) - Certificate #NSF-SFIS-5Y031-SF5. Forest products from this sale may be delivered to the mill as "FSC 100% and / or SFI certified" as long as the contractor hauling the forest products is chain-of-custody (COC) certified or covered under a COC certificate from the destination mill. The purchaser is responsible for maintaining COC after leaving the sale area.

13. Good Neighbor Authority (GNA) Requirements (10/22)

If the name of this timber sales contains the acronym GNA, it is authorized by the Good Neighbor Authority (GNA) and covered by various agreements between the U.S. Forest Service and the State. The timber sale occurs on federal land and the following conditions apply:

GNA contracts on US Forest Service land will not be awarded to purchasers on the Federal list of excluded parties. The System for Award Management (SAM) will be checked for active excluded parties prior to award of contract. In

addition, the Bidder to whom award is made must complete an Assurance Regarding Felony Conviction or Tax Delinquent Status for Corporate Applicants (AD-3031).

14. Good Neighbor Authority (GNA) Requirements, con't (10/22)

Bidder certifies, by signing this bid form, that to the best of Bidder's knowledge that the following representations are accurate and complete.

- a. That the Bidder and its principals are not presently debarred, suspended, proposed for debarment, declared ineligible, or voluntary excluded from timber sales (covered transactions) by any Federal department or agency.
- b. That the Bidder and its principals have not within a 3-year period preceding this bid been convicted of or had a civil judgment rendered against them for commission of fraud or a criminal offense in connection with obtaining , attempting to obtain, or performing a public (Federal, State, or local) transaction or contract under a public transaction; violation of Federal or State antitrust statutes or commission of embezzlement, theft, forgery, bribery, falsification or destruction of records, making false statements, or receiving stolen property.
- c. That the Bidder and its principals are not presently indicted for or otherwise criminally or civilly charged by a governmental entity (Federal, State, or local) with commission of any of the offenses enumerated in paragraph b of this certification.
- d. That the Bidder and its principals have not within a 3-year period preceding this bid had one or more public transactions (Federal, State, or local) terminated for breach or default of a timber or forest product contract.

Bidders that cannot certify this requirement, in whole or in part, shall submit an explanation with their bid.

Scott Bowen
Director

TIMBER SALE INFORMATION

Antler Drip Oak (71-010-25)

T21N, R01W, SEC. 4; T21N, R01W, SEC. 6; T22N, R01W, SEC. 32; T22N, R01W, SEC. 33.
Roscommon County (Advertised Price \$122,431.50)

SALE NOTE: Misc. Species 1 is standing dead oak.

The sale consists of three (3) thinning units and 11 clearcut units.

See oak wilt restrictions.

A timber sale contract for this lump sum, sealed bid timber sale will be awarded to the responsible bidder offering the highest sealed bid price. All units of volume listed below were estimated using the Inventory Manager computer program and the new Michigan taper model. Bids must be at or above the following advertised price for each product and species:

<u>PRODUCTS & SPECIES</u>	<u>ESTIMATED UNITS*</u>		<u>ADVERTISED PRICE</u>
Sawtimber			
Black/Red (Hybrid) Oak	221.5	MBF	\$ 122.00 / MBF
Mixed Aspen	115.9	MBF	\$ 87.00 / MBF
Red Maple	18.8	MBF	\$ 73.00 / MBF
Red Oak	227.1	MBF	\$ 142.00 / MBF
Red Pine	6.0	MBF	\$ 71.00 / MBF
White Oak	144.8	MBF	\$ 83.00 / MBF
White Pine	12.2	MBF	\$ 67.00 / MBF
Pulpwood			
Jack Pine	4	Cords	\$ 21.15 / Cord
Misc. Species 1	837	Cords	\$ 7.50 / Cord
Mixed Aspen	125	Cords	\$ 33.90 / Cord
Mixed Hardwood	136	Cords	\$ 22.05 / Cord
Mixed Oak	1,165	Cords	\$ 20.45 / Cord
Red Pine	9	Cords	\$ 44.85 / Cord
White Pine	18	Cords	\$ 34.25 / Cord

* The total volume is statistically estimated within plus (+) or minus (-) 8.34 percent. There are an estimated 4,831 cords on this timber sale, plus or minus 403 cords at the 95% confidence level. The estimated units are final and not subject to adjustment. Prospective bidders are urged to examine this timber and to make their own estimates of quantity and quality.

BOND AND PAYMENT SCHEDULE:

1. A bond in the amount of \$12,243.00 to insure faithful performance of the conditions of the contract will be deposited by the successful bidder within 21 days of the sale award.
2. Cutting in any sale or unit without the required advance payment would be considered a trespass.
3. Total payment must be paid in advance or according to the following schedule :
 - (a) Ten percent (10%) of the sale value must be paid within 21 days of the sale award.
 - (b) The 10% down payment will be credited towards the first unit cut.
 - (c) Payment for each of the following units must be made before cutting begins in that unit:

<u>PAYMENT UNIT NUMBER</u>	<u>PERCENT OF TOTAL SALE VALUE</u>
01	15.8%
02	5.9%
03	5.5%
04	9.6%
05	2.9%
06	3.5%
07	6.9%
08	1.3%
09	4.7%
10	2.9%
11	4.0%
12	10.8%
13	2.5%
14	23.7%

- 4. If no cutting takes place, the 10% down payment will not be refunded.
- 5. Operations on the contract issued will terminate on 03/31/2028.

SALE STATISTICS

Volumes were calculated in cubic feet using the Michigan taper model. Cubic foot volume includes all wood inside bark for the product indicated. For display purposes, cubic feet were converted to cords and MBF using a simple conversion factor, e.g. 79 cubic feet per cord and 185 cubic feet per MBF. The cubic foot volumes are precise; the cords and MBF volumes are not. Cubic foot volume cannot be directly converted to cords or boards with precision.

SALE VOLUMES

The total estimated sale volume may not equal the sum of the species/products due to the nature of statistical calculations associated with double sampling methodology.

VOLUME			STATISTICAL RANGE IN CORDS	
TOTAL CUBIC FEET	TOTAL CORDS	PERCENT ERROR	MINIMUM	MAXIMUM
381,651	4,831	8.34%	4,428	5,234

VDU VOLUMES

A VDU is a Volume Determination Unit. Volumes and their associated statistics are calculated at the VDU level and summarized to the sale level. There is often a one to one relationship between a VDU and a Payment Unit, but not always, depending on the cruise design. Refer to the VDU TO PAYMENT UNIT table.

	VOLUME			RANGE IN CORDS	
VDU	TOTAL CUBIC FEET	TOTAL CORDS	PERCENT ERROR	MINIMUM	MAXIMUM
2	59,904	758	25.40%	566	951
6	60,748	769	20.94%	608	930
21	9,237	117	52.83%	55	179
43	4,141	52	47.98%	27	78
44	20,271	257	29.43%	181	332
53	19,175	243	41.70%	142	344
55	12,374	157	45.49%	85	228
57	26,351	334	39.45%	202	465
62	24,895	315	33.18%	211	420
66	18,751	237	37.20%	149	326
68	12,511	158	49.73%	80	237
69	10,673	135	38.43%	83	187
76	26,254	332	36.04%	213	452
80	14,930	189	28.07%	136	242
105	56,113	710	19.59%	571	849
661	5,141	65	75.92%	16	114
761	183	2	0.00%	2	2
TOTAL:	381,651	4,831		3,326	6,336

VDU TO PAYMENT UNIT

When a VDU is associated with more than one Payment Unit (PU), the VDU volumes are assigned to the PU based on acres of the VDU within the PU.

VDU	VDU ACRES	PU	PU ACRES
TOTAL:			

DESCRIPTION OF TIMBER BY PAYMENT UNIT (PU)

PU	MARKET GROUP	PRODUCT	QUANTITY	UNIT	ACRES	ADVERTISE PRICE
1	Black/Red (Hybrid	Sawtimber	80.2	MBF	28.7	\$19,325.05
	Mixed Aspen		4.3	MBF		
	<i>B. T. Aspen</i>		2.4	<i>MBF</i>		
	<i>Quaking Aspen</i>		1.9	<i>MBF</i>		
	Red Maple		4.1	MBF		
	Red Pine		2.3	MBF		
	White Oak		32.4	MBF		
	White Pine		6.3	MBF		
	Jack Pine	Pulpwood	4	Cords		
	Misc. Species 1		115	Cords		
	<i>Misc. Species 1</i>	<i>Sawtimber</i>	57.5	<i>MBF</i>		
	<i>Misc. Species 1</i>	<i>Pulpwood</i>	114.0	<i>Acres</i>		
	Mixed Aspen		2	Cords		
	<i>B. T. Aspen</i>		1	<i>Cords</i>		
	<i>Quaking Aspen</i>		1	<i>Cords</i>		
	Mixed Hardwood		23	Cords		
	<i>Pin Cherry</i>		4	<i>Cords</i>		
	<i>Red Maple</i>		19	<i>Cords</i>		
	Mixed Oak		177	Cords		
	<i>/Red (Hybrid) Oak</i>		108	<i>Cords</i>		
	<i>White Oak</i>		69	<i>Cords</i>		
	Red Pine		7	Cords		
	White Pine		4	Cords		
2	Black/Red (Hybrid	Sawtimber	31.9	MBF	13.8	\$7,231.85
	Mixed Aspen		2.5	MBF		
	<i>Quaking Aspen</i>		2.5	<i>MBF</i>		
	Red Maple		1.8	MBF		
	White Oak		10.3	MBF		
	White Pine		1.6	MBF		
	Misc. Species 1	Pulpwood	65	Cords		
	<i>Misc. Species 1</i>	<i>Sawtimber</i>	32.6	<i>MBF</i>		
	<i>Misc. Species 1</i>	<i>Pulpwood</i>	74.0	<i>Acres</i>		
	Mixed Aspen		2	Cords		
	<i>Quaking Aspen</i>		2	<i>Cords</i>		
	Mixed Hardwood		5	Cords		
	<i>Pin Cherry</i>		2	<i>Cords</i>		
	<i>Red Maple</i>		3	<i>Cords</i>		
	Mixed Oak		65	Cords		
	<i>/Red (Hybrid) Oak</i>		36	<i>Cords</i>		
	<i>White Oak</i>		29	<i>Cords</i>		
	White Pine		1	Cords		
3	Black/Red (Hybrid	Sawtimber	37.6	MBF	9.0	\$6,784.35
	Mixed Aspen		2.7	MBF		
	<i>B. T. Aspen</i>		2.7	<i>MBF</i>		
	White Oak		2.1	MBF		
	Misc. Species 1	Pulpwood	73	Cords		
	<i>Misc. Species 1</i>	<i>Sawtimber</i>	36.7	<i>MBF</i>		
	<i>Misc. Species 1</i>	<i>Pulpwood</i>	71.0	<i>Acres</i>		
	Mixed Aspen		1	Cords		
	<i>B. T. Aspen</i>		1	<i>Cords</i>		
	Mixed Oak		59	Cords		
	<i>/Red (Hybrid) Oak</i>		48	<i>Cords</i>		
	<i>White Oak</i>		11	<i>Cords</i>		
4	Black/Red (Hybrid	Sawtimber	9.7	MBF	13.9	\$11,765.35
	Mixed Aspen		31.7	MBF		
	<i>B. T. Aspen</i>		31.7	<i>MBF</i>		

DESCRIPTION OF TIMBER BY PAYMENT UNIT (PU), CON'T

PU	MARKET GROUP	PRODUCT	QUANTITY	UNIT	ACRES	ADVERTISE PRICE
4 con't	Red Maple	Sawtimber	8.1	MBF		
	Red Oak		19.7	MBF		
	White Oak		11.3	MBF		
	Mixed Aspen	Pulpwood	36	Cords		
	<i>B. T. Aspen</i>		36	<i>Cords</i>		
	Mixed Hardwood		30	Cords		
	<i>Pin Cherry</i>		2	<i>Cords</i>		
	<i>Red Maple</i>		28	<i>Cords</i>		
	Mixed Oak		79	Cords		
	<i>/Red (Hybrid) Oak</i>		14	<i>Cords</i>		
	<i>Red Oak</i>		32	<i>Cords</i>		
	<i>White Oak</i>		33	<i>Cords</i>		
5	Black/Red (Hybrid)	Sawtimber	2.3	MBF	7.9	\$3,497.75
	Red Oak		9.0	MBF		
	White Oak		7.5	MBF		
	Misc. Species 1	Pulpwood	36	Cords		
	<i>Misc. Species 1</i>	<i>Sawtimber</i>	18.1	<i>MBF</i>		
	<i>Misc. Species 1</i>	<i>Pulpwood</i>	24.0	<i>Acres</i>		
	Mixed Aspen		6	Cords		
	<i>Quaking Aspen</i>		6	<i>Cords</i>		
	Mixed Hardwood		3	Cords		
	<i>Pin Cherry</i>		3	<i>Cords</i>		
	Mixed Oak		38	Cords		
	<i>/Red (Hybrid) Oak</i>		11	<i>Cords</i>		
	<i>Red Oak</i>		1	<i>Cords</i>		
	<i>White Oak</i>		26	<i>Cords</i>		
6	Black/Red (Hybrid)	Sawtimber	8.5	MBF	7.8	\$4,239.40
	Mixed Aspen		7.9	MBF		
	<i>B. T. Aspen</i>		2.4	<i>MBF</i>		
	<i>Quaking Aspen</i>		5.5	<i>MBF</i>		
	White Oak		12.4	MBF		
	Misc. Species 1	Pulpwood	57	Cords		
	<i>Misc. Species 1</i>	<i>Sawtimber</i>	28.5	<i>MBF</i>		
	<i>Misc. Species 1</i>	<i>Pulpwood</i>	60.0	<i>Acres</i>		
	Mixed Aspen		3	Cords		
	<i>B. T. Aspen</i>		1	<i>Cords</i>		
	<i>Quaking Aspen</i>		2	<i>Cords</i>		
	Mixed Hardwood		10	Cords		
	<i>Pin Cherry</i>		4	<i>Cords</i>		
	<i>Red Maple</i>		6	<i>Cords</i>		
	Mixed Oak		36	Cords		
	<i>/Red (Hybrid) Oak</i>		5	<i>Cords</i>		
	<i>White Oak</i>		31	<i>Cords</i>		
7	Black/Red (Hybrid)	Sawtimber	9.2	MBF	25.4	\$8,473.95
	Mixed Aspen		9.1	MBF		
	<i>B. T. Aspen</i>		9.1	<i>MBF</i>		
	Red Oak		21.2	MBF		
	White Oak		2.3	MBF		
	Mixed Aspen	Pulpwood	9	Cords		
	<i>B. T. Aspen</i>		9	<i>Cords</i>		
	Mixed Hardwood		4	Cords		
	<i>Red Maple</i>		4	<i>Cords</i>		
	Mixed Oak		145	Cords		
	<i>/Red (Hybrid) Oak</i>		18	<i>Cords</i>		
	<i>Red Oak</i>		68	<i>Cords</i>		
	<i>White Oak</i>		59	<i>Cords</i>		

DESCRIPTION OF TIMBER BY PAYMENT UNIT (PU), CON'T

PU	MARKET GROUP	PRODUCT	QUANTITY	UNIT	ACRES	ADVERTISE PRICE
8	Black/Red (Hybrid	Sawtimber	1.1	MBF	4.4	\$1,618.95
	Red Oak		3.3	MBF		
	White Oak		7.2	MBF		
	Misc. Species 1	Pulpwood	4	Cords		
	Misc. Species 1	Sawtimber	1.8	MBF		
	Misc. Species 1	Pulpwood	2.0	Acres		
	Mixed Oak		19	Cords		
	/Red (Hybrid) Oak		1	Cords		
	Red Oak		3	Cords		
	White Oak		15	Cords		
9	Black/Red (Hybrid	Sawtimber	8.1	MBF	16.8	\$5,798.25
	Mixed Aspen		3.1	MBF		
	Quaking Aspen		3.1	MBF		
	Red Maple		1.3	MBF		
	Red Oak		8.4	MBF		
	White Oak		14.8	MBF		
	Misc. Species 1	Pulpwood	78	Cords		
	Misc. Species 1	Sawtimber	39.0	MBF		
	Misc. Species 1	Pulpwood	59.0	Acres		
	Mixed Aspen		1	Cords		
	Quaking Aspen		1	Cords		
	Mixed Hardwood		22	Cords		
	Pin Cherry		10	Cords		
	Red Maple		12	Cords		
	Mixed Oak		45	Cords		
	/Red (Hybrid) Oak		16	Cords		
	Red Oak		3	Cords		
	White Oak		26	Cords		
10	Black/Red (Hybrid	Sawtimber	0.6	MBF	14.9	\$3,590.10
	Red Oak		15.6	MBF		
	White Oak		3.3	MBF		
	Misc. Species 1	Pulpwood	47	Cords		
	Misc. Species 1	Sawtimber	23.6	MBF		
	Misc. Species 1	Pulpwood	28.0	Acres		
	Mixed Aspen		4	Cords		
	B. T. Aspen		4	Cords		
	Mixed Hardwood		5	Cords		
	Pin Cherry		2	Cords		
	Red Maple		3	Cords		
	Mixed Oak		21	Cords		
	/Red (Hybrid) Oak		3	Cords		
	Red Oak		10	Cords		
	White Oak		8	Cords		
11	Black/Red (Hybrid	Sawtimber	0.7	MBF	16.4	\$4,851.45
	Red Maple		2.1	MBF		
	Red Oak		19.9	MBF		
	White Oak		2.8	MBF		
	Mixed Hardwood	Pulpwood	13	Cords		
	Red Maple		13	Cords		
	Mixed Oak		62	Cords		
	/Red (Hybrid) Oak		1	Cords		
	Red Oak		34	Cords		
	White Oak		27	Cords		
12	Black/Red (Hybrid	Sawtimber	11.6	MBF	40.6	\$13,240.65
	Mixed Aspen		34.7	MBF		
	B. T. Aspen		10.8	MBF		

DESCRIPTION OF TIMBER BY PAYMENT UNIT (PU), CON'T

PU	MARKET GROUP	PRODUCT	QUANTITY	UNIT	ACRES	ADVERTISE PRICE
12 con't	<i>Quaking Aspen</i>	<i>Sawtimber</i>	23.9	<i>MBF</i>		
	Red Oak		3.1	MBF		
	White Oak		20.6	MBF		
	White Pine		1.8	MBF		
	Misc. Species 1	Pulpwood	281	Cords		
	<i>Misc. Species 1</i>	<i>Sawtimber</i>	140.5	<i>MBF</i>		
	<i>Misc. Species 1</i>	<i>Pulpwood</i>	191.0	<i>Acres</i>		
	Mixed Aspen		42	Cords		
	<i>B. T. Aspen</i>		6	<i>Cords</i>		
	<i>Quaking Aspen</i>		36	<i>Cords</i>		
	Mixed Hardwood		16	Cords		
	<i>Pin Cherry</i>		16	<i>Cords</i>		
	Mixed Oak		128	Cords		
	<i>/Red (Hybrid) Oak</i>		32	<i>Cords</i>		
	<i>Red Oak</i>		4	<i>Cords</i>		
	<i>White Oak</i>		92	<i>Cords</i>		
	White Pine		1	Cords		
13	Black/Red (Hybrid)	Sawtimber	12.8	MBF	14.6	\$3,102.75
	White Oak		3.3	MBF		
	White Pine		1.4	MBF		
	Misc. Species 1	Pulpwood	81	Cords		
	<i>Misc. Species 1</i>	<i>Sawtimber</i>	40.5	<i>MBF</i>		
	<i>Misc. Species 1</i>	<i>Pulpwood</i>	27.0	<i>Acres</i>		
	Mixed Oak		26	Cords		
	<i>/Red (Hybrid) Oak</i>		16	<i>Cords</i>		
	<i>White Oak</i>		10	<i>Cords</i>		
	White Pine		1	Cords		
14	Black/Red (Hybrid)	Sawtimber	7.2	MBF	65.5	\$28,911.65
	Mixed Aspen		19.9	MBF		
	<i>B. T. Aspen</i>		19.9	<i>MBF</i>		
	Red Maple		1.4	MBF		
	Red Oak		126.9	MBF		
	Red Pine		3.7	MBF		
	White Oak		14.5	MBF		
	White Pine		1.1	MBF		
	Mixed Aspen	Pulpwood	19	Cords		
	<i>B. T. Aspen</i>		19	<i>Cords</i>		
	Mixed Hardwood		5	Cords		
	<i>Red Maple</i>		5	<i>Cords</i>		
	Mixed Oak		265	Cords		
	<i>/Red (Hybrid) Oak</i>		4	<i>Cords</i>		
	<i>Red Oak</i>		183	<i>Cords</i>		
	<i>White Oak</i>		78	<i>Cords</i>		
	Red Pine		2	Cords		
	White Pine		11	Cords		
TOTAL:			746.3	MBF		
TOTAL:			2,294	Cords		
TOTAL:			650.0	Acres		

Sale Specific Conditions & Requirements

Sale Name: Antler Drip Oak

Sale Number: 71-010-25 Seq#: 1

1 - Sale Area

1.2 - Boundaries

1.2.1 - Painted Boundaries (9/19)

The sale boundary and Payment Unit boundaries are marked and identified by blue, red and yellow paint. Exterior sale boundary lines against private property are marked with blue paint. Exterior sale boundary lines against state are marked with red paint. Interior Payment Unit boundaries are marked with yellow paint. Retention patches are marked with red paint; no harvesting activities may occur within these areas. The painted boundary line trees are not Included Timber and are to be protected unless marked with orange paint. Yellow painted trees designating an interior Payment Unit boundary are only to be cut when all surrounding Payment Units have been paid.

2 - Timber Specifications

2.1 - Included Timber

2.1.1 - Clearcut Unit(s) with Unmerchantable Trees (6/14)

Within Payment Unit(s) 1, 2, 3, 5, 6, 8, 9, 10, 12, and 13, cut all trees that are one (1) inch or more at DBH.

2.1.3 - Cut Tree Marked Unit(s) (12/08)

Within Payment Unit(s) 7, 11, and 14, all trees are designated for cutting when marked with orange paint above and below stump height, regardless of merchantability.

2.1.7 - Leave Tree Marked Unit(s) (6/14)

Within Payment Unit(s) 4, cut all trees that are one (1) inch or more at DBH except do not cut white pine and red pine or trees marked with green paint above and below stump height.

2.1.11 - Description of Timber Note (2/04)

Note that Misc. Species 1 is standing dead oak.

2.2 - Utilization

2.2.2 - Chipping Required (12/24)

Payment Units 1, 2, 3, 5, 6, 8, 9, 10, 12, and 13 must be chip harvested to facilitate subsequent planting operations. The Purchaser has the option to produce sawlogs or pulpwood bolts, but the remaining portion of the trees must be chipped and hauled. Products may be produced as roundwood and forwarded to decking areas in final product length, but the tops must be left intact and skidded to the landing for chipping in order to minimize the amount of residual slash. If market conditions limit the practicality of chipping, tops and slash must be arranged in a way that will not inhibit future planting operations, as directed by the Sale Administrator. A chipping exemption can be obtained if proposed operations are determined to be suitable for planting by reforestation staff. This exemption must be granted in writing. If market conditions limit the practicality of chipping, the Purchaser may skid all remaining topwood out of these Payment Units and scatter in locations approved by the Sale Administrator. If the deadline is not met, damages will be collected determined by the cost to complete this work. The requirement to retain approximately 1/6 to 1/3 of treetops and limbs less than four (4) inches in diameter is still applicable (G. C. & R. 2.2).

2.2.3 - Stump Heights (12/24)

Stump heights within Payment Unit(s) 1, 2, 3, 5, 6, 8, 9, 10, 12, and 13 shall not exceed six (6) inches for all trees. This is in order to facilitate planting operations. Stump heights within Payment Unit(s) 4, 7, 11, and 14 shall not exceed 12 inches for trees greater than 10 inches at DBH and four (4) inches for trees smaller than 10 inches at DBH.

3 - Payments

3.3 - Pre-measured Sales

3.3.4 - Dividing Payment Units (7/14)

Payment Unit(s) may be divided at the request of the Purchaser and upon approval of the Unit Manager. Dividing Payment Units is a contract modification which requires a Timber Sale Contract Amendment. There will be only one division per

Payment Unit.

3.4 - Damaged Timber

3.4.1 - Damaged Timber (12/24)

General Condition and Requirement 3.4 Damaged Timber, defines liquidated damages for undesignated live merchantable trees which are cut or injured. In addition, extreme care should be taken to avoid damage to tree seedlings and saplings.

No damage is acceptable to undesignated live merchantable trees. Within the Sale Area, if more than 5% of trees (> 4.5" DBH) within a specified area of the sale are damaged, liquidated damages will be assessed for all trees damaged. Rates will be in accordance with General Condition and Requirement 3.4 Damaged Timber.

4 - Transportation

4.1 - Construction

4.1.6 - Road Construction (4/24)

Construction of new roads or improvements of existing roads shall be done in such a way as to minimize the environmental and visual impacts. Merchantable trees shall be cut and utilized unless otherwise directed. Non-merchantable trees shall be severed and laid flat on the ground. Slash shall be scattered, not left in windrows, and kept a minimum of 10 feet back from the road edge. Stumps shall be set upright, not left on edge, and be moved at least 10 feet away from the road edge. Disturbed soil shall be feathered into the woods and not left in berms or windrows.

4.1.7 - Road Closure (10/11)

All new roads built into the sale must be blocked to vehicle traffic upon completion of the sale. Overgrown roads that are reopened shall be considered new roads. In general, this will require constructing a four (4') foot high berm of stumps and logs covered with earth. These roads must be rendered impassable to cars and trucks. Contact the Sale Administrator for specific details of design and placement.

4.2 - Maintenance

4.2.5 - Two Wheel Drive Condition (2/04)

All existing trail roads on and adjacent to the Sale Area must be passable by two-wheel drive traffic for the duration of the sale.

5 - Operations

5.1 - Notification

5.1.1 - Pre-sale Conference (10/16)

A pre-sale conference on site between the Purchaser and Sale Administrator is required prior to beginning any operations to determine landing and road locations. The Unit Manager or his/her representative must be contacted at least 10 days in advance to schedule the conference.

5.1.4 - Post-Sale Conference (10/16)

A post-sale conference on site between the Purchaser and sale administrator is required five (5) days prior to the completion of active logging operations to determine clean-up and repair of landings, road edges, and the fulfillment of other contract specifications.

5.2 - Conduct of Operations

5.2.1 - Slash

5.2.1.8 - Slash Height (12/08)

No slash or tree tops may exceed 24 inches in height.

5.2.3 - Operating Restrictions

5.2.3.4 - Oak Wilt Restriction, No Exceptions (1/18)

Within Payment Unit(s) 7, 11, and 14, cutting, skidding, hauling within the sale and brushing of access roads to the sale are not permitted during the period of April 15 to July 15. No exceptions will be granted. This is necessary to reduce the spread of oak wilt.

5.2.3.11 - Coppice Regeneration Protection (4/10)

Timber harvesting in Payment Unit 4 must be completed before significant aspen sprouting occurs in that Payment Unit, so as to minimize damage to the new regeneration. Any post-harvest operations, such as chipping, must be completed before sprouting of regeneration occurs. If it is anticipated that chipping will be delayed, then tops shall be carried to one central location or left unchipped. The Unit Manager or his/her representative may cease such operations if sprouting occurs before the operation is complete.

5.2.3.15 - Oak Wilt Restriction, Access Roads (11/23)

Brushing of access roads to Payment Unit(s) 8 must be completed prior to April 15 in order to use these roads for hauling timber or moving machinery between April 15 and July 15. No exceptions will be granted. This is necessary to reduce the spread of oak wilt.

5.2.32 - Decking/Landing Restoration (9/13)

All decking and landing areas must have the surface area restored to a condition equal to or better than before. This is to ensure the proper regeneration of the stand. Wood debris, chips and "cookies" from trimmings must be removed or scattered away from landing and loading areas and may not be windrowed on the edge.

5.2.38 - No Decking Against Live Trees (2/04)

Cut products may not be decked against unmarked or designated leave trees.

5.4 - Soil Protection

5.4.1 - Rutting Restriction, General (7/16)

Operations are to cease immediately if equipment and weather conditions result in rutting of roads and/or skid trails which are 12 inches or greater in depth and 50 feet in length. The Unit Manager or his/her representative may restrict hauling and/or skidding if ruts exceed the specified depth. With the Unit Manager or his/her representative's approval, the Purchaser may return to the area when the risk of rutting has decreased.

6 - Safety and Fire Prevention

6.2 - Signing

6.2.1 - Road Posting (10/20)

The Purchaser is responsible for posting and maintaining caution signs on Campground Road prior to beginning operations. The road must be posted at appropriate distances from the Sale Area to warn of logging activity and truck traffic. Signs must be removed when harvest operations are suspended or completed. The Purchaser will provide these signs.



TIMBER SALE MAP

This information provided by authority of Part 525, 1994 PA 451, as amended.

Sale Number

71-010-25

Date

10/07/2025

Forest Management Unit

County

Mapped By: Sanborn

Scale

Page

Of

Roscommon Mgt Unit

Roscommon

Cruised By: Sanborn

1:6,720

4

4

Township
21N / 22N

Range
01W

Section(s) and N1/2SW,NWSE; Sec. 6 NW;
Subdivision(s) Sec. 32 E1/2NE,N1/2SW,N1/2SE; Sec. 33 N1/2SE; Sec. 33 NWNW,S1/2NW,S1/2NE,N1/2SW; Sec. 4

Cover Type

A = Aspen	J = Jack Pine	O = Oak	U = Upland Brush
B = Paper Birch	K = Rock	P = Lowland Poplar	UM = Upland Mix Forest
C = Cedar	L = Lowland Brush	Q = Mixed Swamp Conifer	V = Bog or Marsh
D = Treed Bog	LM = Lowland Mix Forest	R = Red Pine	W = White Pine
E = Swamp Hardwoods	M = Maple, Beech, Birch	S = Black Spruce	X = Non Stocked
F = Spruce/Fir	MC = Mixed Conifer	T = Tamarack	Y = Sand
G = Grass	MD = Mixed Deciduous	Z = Water	
H = Hemlock	N = Marsh		

Density

0 = Non Stocked	5 = Pole Timber Medium
1 = Seedling Sapling Poor	6 = Pole Timber Well
2 = Seedling Sapling Medium	7 = Saw Timber Poor
3 = Seedling Sapling Well	8 = Saw Timber Medium
4 = Pole Timber Poor	9 = Saw Timber Well

279.7 Acres

Payment Unit Number	Acres	Payment Unit Number	Acres	Payment Unit Number	Acres
1	28.7	6	7.8	11	16.4
2	13.8	7	25.4	12	40.6
3	9	8	4.4	13	14.6
4	13.9	9	16.8	14	65.5
5	7.9	10	14.9		

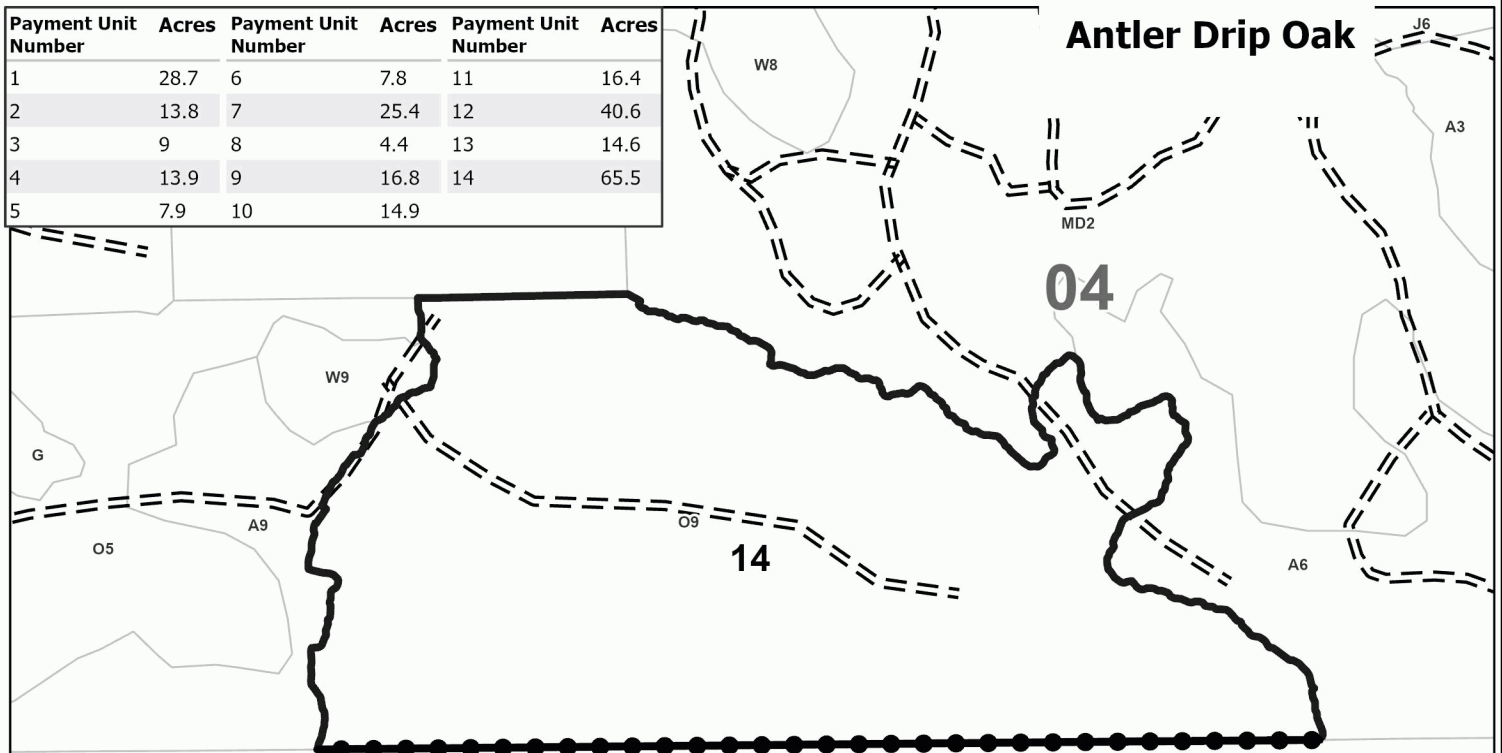

Legend

- Against State (Red)
- Forest Access Route
- Recreational Trails
- MIRIS Section Corner
- Private Line (Blue)

PVT

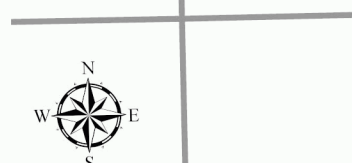

0 0.1 0.2 0.4 Miles

Use QR Code to
open Map in App





TIMBER SALE MAP

This information provided by authority of Part 525, 1994 PA 451, as amended.

Sale Number

71-010-25

Date

10/08/2025

Forest Management Unit

County

Mapped By: Sanborn

Scale

Page

Of

Roscommon Mgt Unit

Roscommon

Cruised By: Sanborn

1:6,720

3

4

Township
21N / 22N

Range
01W

Section(s) and N1/2SW,NWSE; Sec. 6 NW;
Subdivision(s) Sec. 32 E1/2NE,N1/2SW,N1/2SE; Sec. 33 N1/2SE; Sec. 33 NWNW,S1/2NW,S1/2NE,N1/2SW; Sec. 4

Cover Type

A = Aspen	J = Jack Pine	O = Oak	U = Upland Brush
B = Paper Birch	K = Rock	P = Lowland Poplar	UM = Upland Mix Forest
C = Cedar	L = Lowland Brush	Q = Mixed Swamp Conifer	V = Bog or Marsh
D = Treed Bog	LM = Lowland Mix Forest	R = Red Pine	W = White Pine
E = Swamp Hardwoods	M = Maple, Beech, Birch	S = Black Spruce	X = Non Stocked
F = Spruce/Fir	MC = Mixed Conifer	T = Tamarack	Y = Sand
G = Grass	MD = Mixed Deciduous	Z = Water	
H = Hemlock	N = Marsh		

Density

0 = Non Stocked	5 = Pole Timber Medium
1 = Seedling Sapling Poor	6 = Pole Timber Well
2 = Seedling Sapling Medium	7 = Saw Timber Poor
3 = Seedling Sapling Well	8 = Saw Timber Medium
4 = Pole Timber Poor	9 = Saw Timber Well

279.7 Acres

Payment Unit Number	Acres	Payment Unit Number	Acres	Payment Unit Number	Acres
1	28.7	6	7.8	11	16.4
2	13.8	7	25.4	12	40.6
3	9	8	4.4	13	14.6
4	13.9	9	16.8	14	65.5
5	7.9	10	14.9		

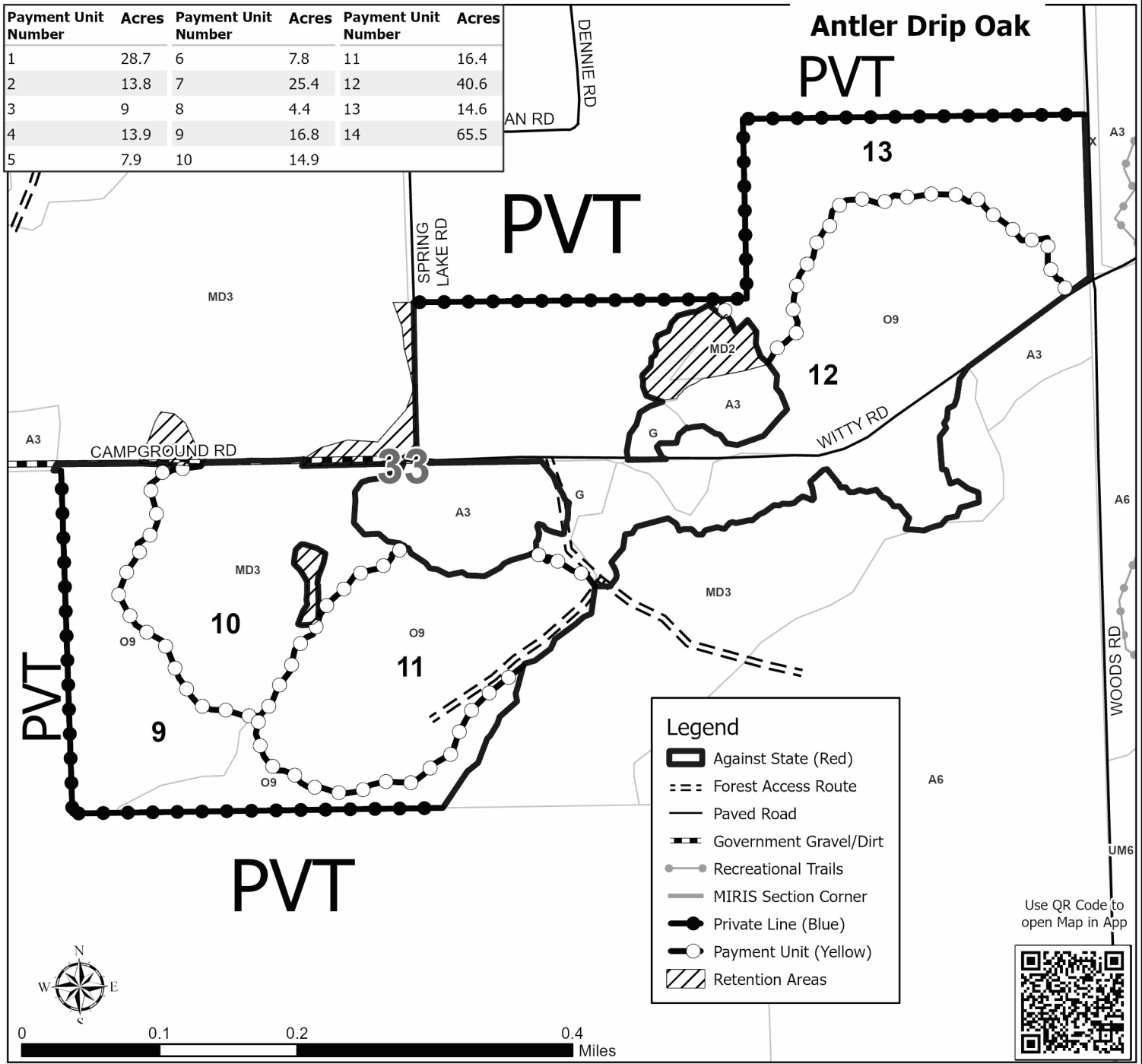



TIMBER SALE MAP

This information provided by authority of Part 525, 1994 PA 451, as amended.

Sale Number

71-010-25

Date

10/08/2025

Forest Management Unit

County

Mapped By: Sanborn

Scale

Page

Of

Roscommon Mgt Unit

Roscommon

Cruised By: Sanborn

1:11,210

2

4

Township
21N / 22N

Range
01W

Section(s) and N1/2SW,NWSE; Sec. 6 NW;
Subdivision(s) Sec. 32 E1/2NE,N1/2SW,N1/2SE; Sec. 33 N1/2SE; Sec. 33 NWNW,S1/2NW,S1/2NE,N1/2SW; Sec. 4

Cover Type

A = Aspen	J = Jack Pine	O = Oak	U = Upland Brush
B = Paper Birch	K = Rock	P = Lowland Poplar	UM = Upland Mix Forest
C = Cedar	L = Lowland Brush	Q = Mixed Swamp Conifer	V = Bog or Marsh
D = Treed Bog	LM = Lowland Mix Forest	R = Red Pine	W = White Pine
E = Swamp Hardwoods	M = Maple, Beech, Birch	S = Black Spruce	X = Non Stocked
F = Spruce/Fir	MC = Mixed Conifer	T = Tamarack	Y = Sand
G = Grass	MD = Mixed Deciduous		Z = Water
H = Hemlock	N = Marsh		

Density

0 = Non Stocked	5 = Pole Timber Medium
1 = Seedling Sapling Poor	6 = Pole Timber Well
2 = Seedling Sapling Medium	7 = Saw Timber Poor
3 = Seedling Sapling Well	8 = Saw Timber Medium
4 = Pole Timber Poor	9 = Saw Timber Well

279.7 Acres

Payment Unit Number	Acres	Payment Unit Number	Acres	Payment Unit Number	Acres
1	28.7	6	7.8	11	16.4
2	13.8	7	25.4	12	40.6
3	9	8	4.4	13	14.6
4	13.9	9	16.8	14	65.5
5	7.9	10	14.9		

Antler Drip Oak

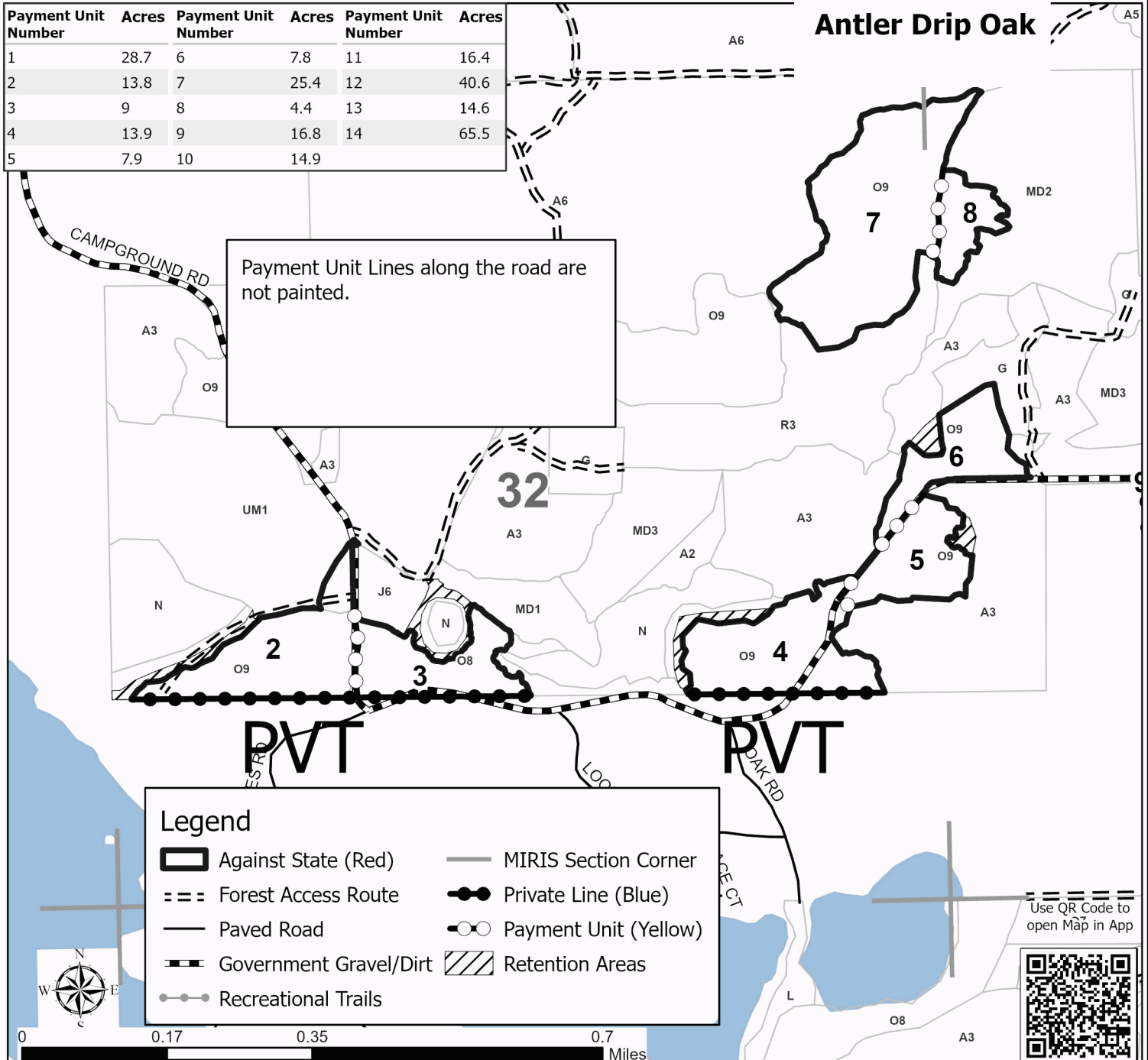



TIMBER SALE MAP

This information provided by authority of Part 525, 1994 PA 451, as amended.

Sale Number

71-010-25

Date

10/08/2025

Forest Management Unit

County

Mapped By: Sanborn

Scale

Page

Of

Roscommon Mgt Unit

Roscommon

Cruised By: Sanborn

1:5,000

1

4

Township
21N / 22N

Range
01W

Section(s) and Subdivision(s) N1/2SW,NWSE; Sec. 6 NW;
Sec. 32 E1/2NE,N1/2SW,N1/2SE; Sec. 33 N1/2SE; Sec. 33 NWNW,S1/2NW,S1/2NE,N1/2SW; Sec. 4

Cover Type

A = Aspen	J = Jack Pine	O = Oak	U = Upland Brush
B = Paper Birch	K = Rock	P = Lowland Poplar	UM = Upland Mix Forest
C = Cedar	L = Lowland Brush	Q = Mixed Swamp Conifer	V = Bog or Marsh
D = Treed Bog	LM = Lowland Mix Forest	R = Red Pine	W = White Pine
E = Swamp Hardwoods	M = Maple, Beech, Birch	S = Black Spruce	X = Non Stocked
F = Spruce/Fir	MC = Mixed Conifer	T = Tamarack	Y = Sand
G = Grass	MD = Mixed Deciduous	Z = Water	
H = Hemlock	N = Marsh		

Density

0 = Non Stocked	5 = Pole Timber Medium
1 = Seedling Sapling Poor	6 = Pole Timber Well
2 = Seedling Sapling Medium	7 = Saw Timber Poor
3 = Seedling Sapling Well	8 = Saw Timber Medium
4 = Pole Timber Poor	9 = Saw Timber Well

279.7 Acres

Payment Unit Number	Acres	Payment Unit Number	Acres	Payment Unit Number	Acres
1	28.7	6	7.8	11	16.4
2	13.8	7	25.4	12	40.6
3	9	8	4.4	13	14.6
4	13.9	9	16.8	14	65.5
5	7.9	10	14.9		

Antler Drip Oak

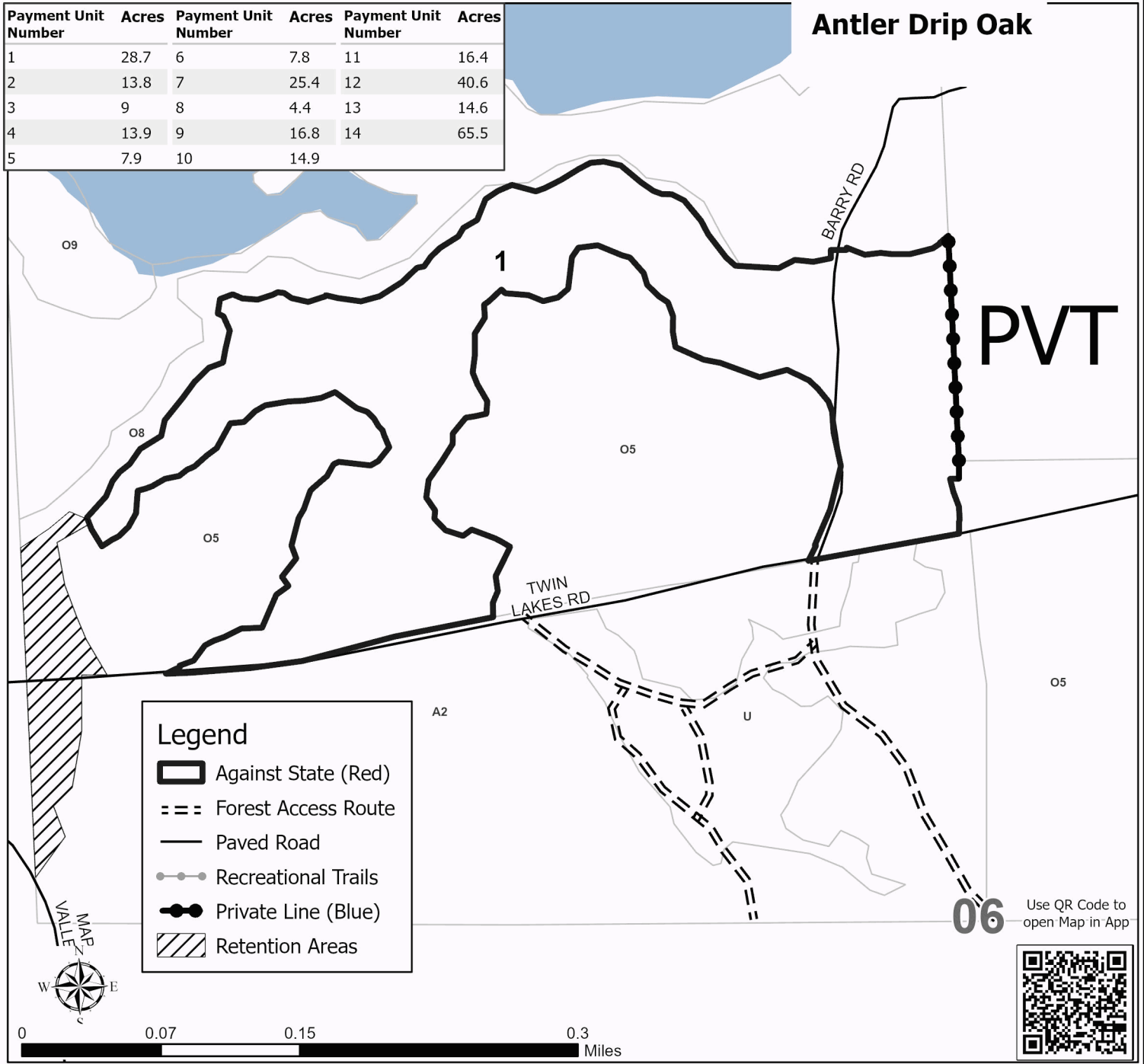

TIMBER SALE INFORMATION

61 Thin (71-011-25)

T24N, R01W, SEC. 30; T24N, R01W, SEC. 31; T24N, R02W, SEC. 24; T24N, R02W, SEC. 25.
Roscommon County (Advertised Price \$35,187.40)

SALE NOTE: A recreation site such as a trail, pathway, or campground is within the sale area or the vicinity. Certain restrictions/specifications may be applicable including time restrictions.

A timber sale contract for this lump sum, sealed bid timber sale will be awarded to the responsible bidder offering the highest sealed bid price. All units of volume listed below were estimated using the Inventory Manager computer program and the new Michigan taper model. Bids must be at or above the following advertised price for each product and species:

<u>PRODUCTS & SPECIES</u>	<u>ESTIMATED UNITS*</u>	<u>ADVERTISED PRICE</u>
Sawtimber		
B. T. Aspen	17.0 MBF	\$ 87.00 / MBF
Red Maple	2.5 MBF	\$ 73.00 / MBF
Red Oak	46.9 MBF	\$ 142.00 / MBF
Pulpwood		
B. T. Aspen	87 Cords	\$ 33.90 / Cord
Mixed Oak	262 Cords	\$ 20.45 / Cord
Red Maple	24 Cords	\$ 22.05 / Cord
Red Pine	402 Cords	\$ 44.85 / Cord

* The total volume is statistically estimated within plus (+) or minus (-) 16.65 percent. There are an estimated 930 cords on this timber sale, plus or minus 155 cords at the 95% confidence level. The estimated units are final and not subject to adjustment. Prospective bidders are urged to examine this timber and to make their own estimates of quantity and quality.

BOND AND PAYMENT SCHEDULE:

- A bond in the amount of \$1,759.00 to insure faithful performance of the conditions of the contract will be deposited by the successful bidder within 21 days of the sale award.
- Cutting in any sale or unit without the required advance payment would be considered a trespass.
- Total payment must be paid in advance or according to the following schedule :
 - Ten percent (10%) of the sale value must be paid within 21 days of the sale award.
 - The 10% down payment will be credited towards the first unit cut.
 - Payment for each of the following units must be made before cutting begins in that unit:

PAYMENT UNIT NUMBER	PERCENT OF TOTAL SALE VALUE
01	46.6%
02	2.2%
03	51.2%
- If no cutting takes place, the 10% down payment will not be refunded.
- Operations on the contract issued will terminate on 03/31/2028.

SALE STATISTICS

Volumes were calculated in cubic feet using the Michigan taper model. Cubic foot volume includes all wood inside bark for the product indicated. For display purposes, cubic feet were converted to cords and MBF using a simple conversion factor, e.g. 79 cubic feet per cord and 185 cubic feet per MBF. The cubic foot volumes are precise; the cords and MBF volumes are not. Cubic foot volume cannot be directly converted to cords or boards with precision.

SALE VOLUMES

The total estimated sale volume may not equal the sum of the species/products due to the nature of statistical calculations associated with double sampling methodology.

VOLUME			STATISTICAL RANGE IN CORDS	
TOTAL CUBIC FEET	TOTAL CORDS	PERCENT ERROR	MINIMUM	MAXIMUM
73,448	930	16.65%	775	1,085

VDU VOLUMES

A VDU is a Volume Determination Unit. Volumes and their associated statistics are calculated at the VDU level and summarized to the sale level. There is often a one to one relationship between a VDU and a Payment Unit, but not always, depending on the cruise design. Refer to the VDU TO PAYMENT UNIT table.

	VOLUME			RANGE IN CORDS	
VDU	TOTAL CUBIC FEET	TOTAL CORDS	PERCENT ERROR	MINIMUM	MAXIMUM
25	31,738	402	26.47%	295	508
41	41,710	528	21.78%	413	643
TOTAL:	73,448	930		708	1,151

VDU TO PAYMENT UNIT

When a VDU is associated with more than one Payment Unit (PU), the VDU volumes are assigned to the PU based on acres of the VDU within the PU.

VDU	VDU ACRES	PU	PU ACRES
TOTAL:			

DESCRIPTION OF TIMBER BY PAYMENT UNIT (PU)

PU	MARKET GROUP	PRODUCT	QUANTITY	UNIT	ACRES	ADVERTISE PRICE
1	B. T. Aspen	Sawtimber	16.2	MBF	51.9	\$16,400.00
	Red Maple		2.4	MBF		
	Red Oak		44.8	MBF		
	Red Oak		42.9	MBF		
	White Oak		1.9	MBF		
	B. T. Aspen	Pulpwood	83	Cords		
	Mixed Oak		251	Cords		
	Red (Hybrid) Oak		5	Cords		
	Red Oak		217	Cords		
	White Oak		29	Cords		
	Red Maple		23	Cords		
2	B. T. Aspen	Sawtimber	0.8	MBF	2.4	\$757.70
	Red Maple		0.1	MBF		
	Red Oak		2.1	MBF		
	Red Oak		2.0	MBF		
	White Oak		0.1	MBF		
	B. T. Aspen	Pulpwood	4	Cords		
	Mixed Oak		11	Cords		
	Red Oak		10	Cords		
	White Oak		1	Cords		
	Red Maple		1	Cords		
3	Red Pine	Pulpwood	402	Cords	16.0	\$18,029.70
TOTAL:			66.4	MBF		
TOTAL:			775	Cords		

Sale Specific Conditions & Requirements

Sale Name: 61 Thin

Sale Number: 71-011-25 Seq#: 1

1 - Sale Area

1.2 - Boundaries

1.2.1 - Painted Boundaries (9/19)

The sale boundary and Payment Unit boundaries are marked and identified by blue, red and yellow paint. Exterior sale boundary lines against private property are marked with blue paint. Exterior sale boundary lines against state are marked with red paint. Interior Payment Unit boundaries are marked with yellow paint. The exterior painted boundary line trees are not Included Timber and are to be protected unless marked with orange paint. Yellow painted trees designating an interior Payment Unit boundary are only to be cut when all surrounding Payment Units have been paid.

2 - Timber Specifications

2.1 - Included Timber

2.1.1 - Clearcut Unit(s) with Unmerchantable Trees (6/14)

Within Payment Unit(s) 2, cut all trees that are two (2) inches or more at DBH.

2.1.3 - Cut Tree Marked Unit(s) (12/08)

Within Payment Unit(s) 1 and 3, all trees are designated for cutting when marked with orange paint above and below stump height, regardless of merchantability.

2.2 - Utilization

2.2.6 - Roundwood Operation Required (3/21)

The skidding of whole trees or tree segments with limbs attached is prohibited. All products must be produced as roundwood and forwarded to existing roads or landing areas in final product length.

3 - Payments

3.3 - Pre-measured Sales

3.3.4 - Dividing Payment Units (7/14)

Payment Unit(s) may be divided at the request of the Purchaser and upon approval of the Unit Manager. Dividing Payment Units is a contract modification which requires a Timber Sale Contract Amendment. There will be only one division per Payment Unit.

3.4 - Damaged Timber

3.4.1 - Damaged Timber (12/24)

General Condition and Requirement 3.4 Damaged Timber, defines liquidated damages for undesignated live merchantable trees which are cut or injured.

No damage is acceptable to undesignated live merchantable trees. Within the Sale Area, if more than 5 % of trees (> 4.5" DBH) within a specified area of the sale are damaged, liquidated damages will be assessed for all trees damaged. Rates will be in accordance with General Condition and Requirement 3.4 Damaged Timber.

4 - Transportation

4.1 - Construction

4.1.6 - Road Construction (4/24)

Construction of new roads or improvements of existing roads shall be done in such a way as to minimize the environmental and visual impacts. Merchantable trees shall be cut and utilized unless otherwise directed. Non-merchantable trees shall be severed and laid flat on the ground. Slash shall be scattered, not left in windrows, and kept a minimum of 10 feet back from the road edge. Stumps shall be set upright, not left on edge, and be moved at least 10 feet away from the road edge. Disturbed soil shall be feathered into the woods and not left in berms or windrows.

4.1.7 - Road Closure (10/11)

All new roads built into the sale must be blocked to vehicle traffic upon completion of the sale. Overgrown roads that are reopened shall be considered new roads. In general, this will require constructing a four (4') foot high berm of stumps and logs covered with earth. These roads must be rendered impassable to cars and trucks. Contact the Sale Administrator for specific details of design and placement.

4.2 - Maintenance

4.2.3 - Road maintenance (8/13)

The following road maintenance may be needed: Within 60 days of completion of hauling, or if no hauling occurs for 60 days, the road must be maintained and graded. This includes cleaning of drainage areas, grading, crowning and filling with gravel, if necessary. Damages will be assessed if grading/repair does not occur.

4.2.5 - Two Wheel Drive Condition (2/04)

All existing trail roads on and adjacent to the Sale Area must be passable by two-wheel drive traffic for the duration of the sale.

5 - Operations

5.1 - Notification

5.1.1 - Pre-sale Conference (10/16)

A pre-sale conference between the Purchaser and Sale Administrator is required prior to beginning any operations to determine landing and road locations. The Unit Manager or his/her representative must be contacted at least two (2) days in advance to schedule the conference.

5.1.4 - Post-Sale Conference (10/16)

A post-sale conference on site between the Purchaser and sale administrator is required five (5) days prior to the completion of active logging operations to determine clean-up and repair of landings, road edges, and the fulfillment of other contract specifications.

5.2 - Conduct of Operations

5.2.1 - Slash

5.2.1.8 - Slash Height (12/08)

No slash or tree tops may exceed 24 inches in height.

5.2.3 - Operating Restrictions

5.2.3.3 - Bark Slippage Restriction (3/09)

Within Payment Unit(s) 3, unless changed by written agreement, cutting and skidding are not permitted during the period of April 15 to July 15. This restriction is because of bark slippage.

5.2.3.4 - Oak Wilt Restriction, No Exceptions (1/18)

Within Payment Units 1 and 2, cutting, skidding, hauling within the sale and brushing of access roads to the sale are not permitted during the period of April 15 to July 15. No exceptions will be granted. This is necessary to reduce the spread of oak wilt.

5.2.32 - Decking/Landing Restoration (9/13)

All decking and landing areas must have the surface area restored to a condition equal to or better than before. This is to ensure the proper regeneration of the stand. Wood debris, chips and "cookies" from trimmings must be removed or scattered away from landing and loading areas and may not be windrowed on the edge.

5.2.39 - ORV Trail/Route Protection (4/18)

There is an ORV trail going through Payment Unit 3 that is shown on the Timber Sale Map. If marked with orange paint, trees with yellow ORV markers shall be cut off above the markers and at least five (5) feet above ground. Do not run equipment down the ORV trail or route. Skidding across the trail or route may only occur in locations approved by the Sale Administrator.

5.7 - Protection of Historical Sites

5.7.2 - Potential Historical Site(s) (9/06)

The State Historic Preservation Office has identified the potential for a historic site within the boundary of this timber sale. Note that if the site is discovered during operations, General Condition and Requirement 5.7 - Protection of Historical Sites will apply.

5.8 - Protection of Endangered Species

5.8.8 - Protected Species, Other (2/12)

Within Payment Units 1 and 2, all harvesting operations including cutting, processing, and skidding will be limited to November 1 through March 31. No harvesting operations will be allowed outside of this time window for these payment units. This restriction is for the protection of smooth green snake.

6 - Safety and Fire Prevention

6.2 - Signing

6.2.1 - Road Posting (10/20)

The Purchaser is responsible for posting and maintaining caution signs on Pine Road, Moore Road, and Maybee Road prior to beginning operations. The road must be posted at appropriate distances from the Sale Area to warn of logging activity and truck traffic. Signs must be removed when harvest operations are suspended or completed. The Purchaser will provide these signs.

6.2.3 - Recreational Trail Posting (10/20)

The Purchaser is responsible for posting and maintaining caution signs on The ORV trail prior to beginning operations. The trail must be posted at appropriate distances from the Sale Area to warn of logging activity and truck traffic at both ends of the trail. Signs must be removed when harvest operations are suspended or completed. The Purchaser will provide these signs.

7 - Other Conditions

7.3 - Contract Modifications

7.3.2 - Modification for Oak Wilt (2/05)

Within the Sale Area, there may be patches of oak wilt. If oak wilt is identified within the Sale Area, this contract may be modified. The following modifications could occur: time of cutting, species to cut, volume to harvest, or various others dealing with the treatment of oak wilt. If a species is not specified in this contract, it shall be paid for at the average price received for that species and product.



TIMBER SALE MAP

This information provided by authority of Part 525, 1994 PA 451, as amended.

Sale Number

71-011-25

Date

09/29/2025

Forest Management Unit

County

Mapped By: Martell, Ewald & Lewicki

Roscommon Mgt Unit

Roscommon

Cruised By: Martell & Ewald

Scale

1:13,500

Page

1

Of

1

Township
24N

Range
01W /

Section(s) and

Subdivision(s) Sec. 24 SESE; Sec. 25 E1/2NE; Sec. 30 NWNW; Sec. 31 NENW,N1/2NE;

Cover Type

A = Aspen	J = Jack Pine	O = Oak	U = Upland Brush
B = Paper Birch	K = Rock	P = Lowland Poplar	UM = Upland Mix Forest
C = Cedar	L = Lowland Brush	Q = Mixed Swamp Conifer	V = Bog or Marsh
D = Treed Bog	LM = Lowland Mix Forest	R = Red Pine	W = White Pine
E = Swamp Hardwoods	M = Maple, Beech, Birch	S = Black Spruce	X = Non Stocked
F = Spruce/Fir	MC = Mixed Conifer	T = Tamarack	Y = Sand
G = Grass	MD = Mixed Deciduous		Z = Water
H = Hemlock	N = Marsh		

Density

0 = Non Stocked	5 = Pole Timber Medium
1 = Seedling Sapling Poor	6 = Pole Timber Well
2 = Seedling Sapling Medium	7 = Saw Timber Poor
3 = Seedling Sapling Well	8 = Saw Timber Medium
4 = Pole Timber Poor	9 = Saw Timber Well

Payment Unit Number	Acres	Payment Unit Number	Acres
1	52	3	16
2	2.4		

61 Thin

70.3 Acres

Use QR Code to open Map in App



Legend

- Against State (Red)
- Private Line (Blue)
- Payment Unit (Yellow)
- Stand
- Nearby Timber Sale
- Primary Forest Road
- Forest Access Route
- Administrative Access Only
- Paved Road
- Government Gravel/Dirt
- Private Gravel/Dirt
- Powerline
- Recreational Trails
- MIRIS Section Corner

Map Note:
Payment Unit 2 consists of the two small islands within Unit 1.

Unit 3 boundary along Pine rd is unpainted and designated by the road.

0 0.25 0.5 1 Miles

Antler Drip Oak (71-010-25)

T21N, R01W, SEC. 4; T21N, R01W, SEC. 6; T22N, R01W, SEC. 32; T22N, R01W,

In response to the notice of sale to be held 9:00 a.m. (local time) on January 20, 2026, I am hereby submitting my sealed bid (firm offer) for the following forest products to be cut. Bids for individual species must be at or above the advertised price. All non-responsive bid forms may be rejected.

<u>PRODUCTS & SPECIES</u>	<u>ESTIMATED VOLUME*</u>	<u>ADVERTISED PRICE</u>	<u>BID PRICE/UNIT</u>
Sawtimber			
Black/Red (Hybrid) Oak	221.5 MBF	\$ 122.00/MBF	\$ _____
Mixed Aspen	115.9 MBF	\$ 87.00/MBF	\$ _____
Red Maple	18.8 MBF	\$ 73.00/MBF	\$ _____
Red Oak	227.1 MBF	\$ 142.00/MBF	\$ _____
Red Pine	6.0 MBF	\$ 71.00/MBF	\$ _____
White Oak	144.8 MBF	\$ 83.00/MBF	\$ _____
White Pine	12.2 MBF	\$ 67.00/MBF	\$ _____
Pulpwood			
Jack Pine	4 Cords	\$ 21.15/Cord	\$ _____
Misc. Species 1	837 Cords	\$ 7.50/Cord	\$ _____
Mixed Aspen	125 Cords	\$ 33.90/Cord	\$ _____
Mixed Hardwood	136 Cords	\$ 22.05/Cord	\$ _____
Mixed Oak	1,165 Cords	\$ 20.45/Cord	\$ _____
Red Pine	9 Cords	\$ 44.85/Cord	\$ _____
White Pine	18 Cords	\$ 34.25/Cord	\$ _____

*The volumes are statistically estimated within plus (+) or minus (-) 8.34 percent at 95% confidence level. These estimated volumes are final and not subject to adjustment. Prospective bidders are urged to examine this timber and to make their own estimates of quantity and quality.

I understand that any or all bids may be rejected. All bids must be signed and all bid items must be bid or the bid form may be rejected. I also understand that consideration and awarding a contract will be based upon my past performance and ability to complete the contract based upon equipment and staffing subject to my control.

FEDERAL ID: ____ - ____ - ____ or SOCIAL SECURITY NUMBER: ____ - ____ - ____

Company or individual bidding: _____

Company representative's name: _____

Address: _____

City: _____ State: _____ Zip: _____

IF AVAILABLE, PLEASE PLACE THE PERSONALIZED LABEL FROM YOUR PROSPECTUS IN THE ABOVE BOX.

Individual or company representative's signature: _____ Date: _____

Phone number : _____ Email (optional): _____

THE WINNING BIDDER MUST COMPLETE THE VERIFICATION OF WORKER'S DISABILITY COMPENSATION ACT COMPLIANCE (ON REVERSE SIDE IF DOUBLE SIDED) WITHIN 21 DAYS OF SALE AWARD DATE



TIMBER SALE
VERIFICATION OF WORKER'S DISABILITY
COMPENSATION ACT COMPLIANCE

*As required by Act 317, P.A. 1969 (Worker's Compensation) and
Part 5 of Act 451 of 1994, as amended.*

FOR DEPARTMENT USE ONLY

Sale Number (XX – XXX – XX – XX)

Forest Management Unit:

VERIFICATION OF WORKER'S DISABILITY COMPENSATION ACT COMPLIANCE

- This verification must be completed and submitted within 21 days of contract award and prior to the issuance of the timber sale contract.
- In addition, if boxes 2B or 2C are checked, then Notice of Exclusion or Certificate of Insurance must be submitted within twenty-one (21) days of the contract award and prior to the issuance of the timber sale contract.
- All information must be typed or printed except for written signatures.

Please Check Appropriate Categories:

1. My business is organized as (you **must** check one of the boxes below):
 - A. ☐ Sole Proprietorship (individual)
 - B. ☐ Partnership
 - C. ☐ Corporation
2. You **must** check one of the boxes below:
 - A. ☐ I certify my business is a sole proprietorship and it has no employees but the sole proprietor. I am not subject to the Worker's Compensation Laws.
 - B. ☐ I certify my business has satisfied its obligation to the Worker's Compensation Act through the use of an approved Notice of Exclusion (BWC-337, Rev. 5/96). I will provide a copy of the Notice of Exclusion within 21 days of the contract award. (For questions or a copy of the BWC-337, please call the Worker's Compensation Bureau at 517-322-1195).
 - C. ☐ I certify my business has a Worker's Compensation Policy. I will provide an original Certificate of Insurance within twenty-one (21) days of the contract award.
3. If you have checked item 2(A) or 2(B), you **must** indicate the number of **both** full-time and part-time employees, other than yourself, including family members and active partners (if none, you must enter "0").

_____ Full-time Employees

_____ Part-time Employees

Name of Business		Federal ID (or) Social Security No.
Address		Telephone ()
City	State	ZIP

I hereby certify that the above information is true and correct. I agree to notify the Michigan DNR of any changes that occur in factors affecting my coverage during any of my present and future operations.

Signature of Owner or Authorized Representative

Title

Date

Please complete the "SEALED BID" information on the next page

61 Thin (71-011-25)

T24N, R01W, SEC. 30; T24N, R01W, SEC. 31; T24N, R02W, SEC. 24; T24N,

In response to the notice of sale to be held 9:00 a.m. (local time) on January 20, 2026, I am hereby submitting my sealed bid (firm offer) for the following forest products to be cut. Bids for individual species must be at or above the advertised price. All non-responsive bid forms may be rejected.

<u>PRODUCTS & SPECIES</u>	<u>ESTIMATED VOLUME*</u>	<u>ADVERTISED PRICE</u>	<u>BID PRICE/UNIT</u>
Sawtimber			
B. T. Aspen	17.0 MBF	\$ 87.00/MBF	\$ _____
Red Maple	2.5 MBF	\$ 73.00/MBF	\$ _____
Red Oak	46.9 MBF	\$ 142.00/MBF	\$ _____
Pulpwood			
B. T. Aspen	87 Cords	\$ 33.90/Cord	\$ _____
Mixed Oak	262 Cords	\$ 20.45/Cord	\$ _____
Red Maple	24 Cords	\$ 22.05/Cord	\$ _____
Red Pine	402 Cords	\$ 44.85/Cord	\$ _____

*The volumes are statistically estimated within plus (+) or minus (-) 16.65 percent at 95% confidence level. These estimated volumes are final and not subject to adjustment. Prospective bidders are urged to examine this timber and to make their own estimates of quantity and quality.

I understand that any or all bids may be rejected. All bids must be signed and all bid items must be bid or the bid form may be rejected. I also understand that consideration and awarding a contract will be based upon my past performance and ability to complete the contract based upon equipment and staffing subject to my control.

FEDERAL ID: ____-____-____ or SOCIAL SECURITY NUMBER: ____-____-____
Company or individual bidding: _____
Company representative's name: _____
Address: _____
City: _____ State: _____ Zip: _____

IF AVAILABLE, PLEASE PLACE THE PERSONALIZED LABEL FROM YOUR PROSPECTUS IN THE ABOVE BOX.

Individual or company representative's signature: _____ Date: _____

Phone number : _____ Email (optional): _____

**THE WINNING BIDDER MUST COMPLETE THE VERIFICATION OF WORKER'S DISABILITY COMPENSATION ACT
COMPLIANCE (ON REVERSE SIDE IF DOUBLE SIDED) WITHIN 21 DAYS OF SALE AWARD DATE**



TIMBER SALE VERIFICATION OF WORKER'S DISABILITY COMPENSATION ACT COMPLIANCE

As required by Act 317, P.A. 1969 (Worker's Compensation) and
Part 5 of Act 451 of 1994, as amended.

FOR DEPARTMENT USE ONLY

Sale Number (XX - XXX - XX - XX)

Forest Management Unit:

VERIFICATION OF WORKER'S DISABILITY COMPENSATION ACT COMPLIANCE

- This verification must be completed and submitted within 21 days of contract award and prior to the issuance of the timber sale contract.
- In addition, if boxes 2B or 2C are checked, then Notice of Exclusion or Certificate of Insurance must be submitted within twenty-one (21) days of the contract award and prior to the issuance of the timber sale contract.
- All Information must be typed or printed except for written signatures.

Please Check Appropriate Categories:

1. My business is organized as (you **must** check one of the boxes below):
 - A. ☐ Sole Proprietorship (individual)
 - B. ☐ Partnership
 - C. ☐ Corporation
2. You **must** check one of the boxes below:
 - A. ☐ I certify my business is a sole proprietorship and it has no employees but the sole proprietor. I am not subject to the Worker's Compensation Laws.
 - B. ☐ I certify my business has satisfied its obligation to the Worker's Compensation Act through the use of an approved Notice of Exclusion (BWC-337, Rev. 5/96). I will provide a copy of the Notice of Exclusion within 21 days of the contract award. (For questions or a copy of the BWC-337, please call the Worker's Compensation Bureau at 517-322-1195).
 - C. ☐ I certify my business has a Worker's Compensation Policy. I will provide an original Certificate of Insurance within twenty-one (21) days of the contract award.
3. If you have checked item 2(A) or 2(B), you **must** indicate the number of **both** full-time and part-time employees, other than yourself, including family members and active partners (if none, you must enter "0").

_____ Full-time Employees

_____ Part-time Employees

Name of Business		Federal ID (or) Social Security No.
Address		Telephone ()
City	State	ZIP

I hereby certify that the above information is true and correct. I agree to notify the Michigan DNR of any changes that occur in factors affecting my coverage during any of my present and future operations.

Signature of Owner or Authorized Representative

Title

Date

Please complete the "SEALED BID" information on the next page