



**DEPARTMENT OF NATURAL RESOURCES
STATE OF MICHIGAN
TIMBER SALE PROSPECTUS #7844**

SCHEDULED SALE DATE AND TIME: 9:00 a.m. (local time) on July 28, 2026.

LOCATION: ROSCOMMON MGMT UNIT, 8717B N ROSCOMMON RD., ROSCOMMON, MI 48653.

PROSPECTUS NOTE: The bidder is advised to inspect the sale area and review the location, estimated volumes, operating costs and contract terms of proposed sales. Please be aware that some landowners may request 60 days or more notice for access across their land.

Notice is hereby given that bids will be received by the Unit Manager, ROSCOMMON MANAGEMENT UNIT, for certain timber on the following described lands:

Tick Alley Mix (71-003-26) / T22N, R04W, SEC. 4 , SWSW.

T22N, R04W, SEC. 5 , NESW,SE.

T22N, R04W, SEC. 6 , NWNW.

T22N, R04W, SEC. 8 , NENE.

Roscommon County, Advertised Price \$38,000.40, 49.8 Acres, Red Pine, Hardwood.

SALE NOTE: Located just to the West of US-127 along the South side of M-55. Sale consists of a red pine seed tree unit and an oak seed tree unit that are a combined 49.8 acres. Timing restrictions apply for oak wilt, bark slip and Blanding's Turtle (see specs 5.2.3.3, 5.3.3.4, & 5.8.8)

Ogemaw Outwash Pine (71-005-26) / T24N, R01E, SEC. 10, S1/2SW.

T24N, R01E, SEC. 15, N1/2NW,E1/2NE,S1/2SW,S1/2SE.

T24N, R01E, SEC. 16, NENE.

T24N, R01E, SEC. 21, E1/2NE,E1/2SE.

T24N, R01E, SEC. 22, E1/2NE,E1/2SE.

T24N, R01E, SEC. 23, SE.

T24N, R01E, SEC. 26, NWNE.

T24N, R01E, SEC. 27, SESE.

T24N, R01E, SEC. 34, SWNE,NESW,N1/2SE,SESE.

Ogemaw County, Advertised Price \$107,678.50, 355.9 Acres, Red Pine, Jack Pine.

SALE NOTE: The sale consists of a red pine leave tree treatment and numerous smaller clearcuts.

A recreation site such as a trail, pathway, or campground is within the sale area or the vicinity. Certain restrictions/specifications may be applicable including time restrictions.

BID INSTRUCTIONS (VER. 10/10/2022):

1. Scheduled Bid Location, Date, and Time (2/11)

Bids must be received by the Unit Manager, ROSCOMMON OFFICE, 8717B N Roscommon Rd., Roscommon, MI 48653, no later than 9:00 a.m. (local time) on July 28, 2026. For further information concerning this sale, contact Jason Lewicki at 989-745-5870 extension .

2. Bidder's Qualifications (10/22)

If all or part of a timber sale was prepared by a private contractor, the contractor and that contractor's company are not permitted to bid on the timber sale. A person must be 18 years of age or older to purchase timber. Permanent employees of the Department of Natural Resources or members of their immediate household may not bid. Former employees, in the permanent or seasonal class, may not bid until 3 months after the last day of active duty. Bids will not be accepted from individuals or companies appearing on the DNR/FRD No-Bid List. This list contains the names of purchasers who previously failed to execute a contract within 21-days or who have a history of poor performance.

3. Preparation of Sealed Bids (5/16)

Bid Forms may be completed online thru Michigan DNR Timber Sale Online Bidding (OLB) at www.michigan.gov/timberbidding or by completing the hardcopy Bid Form found in the Timber Sale Prospectus . Hardcopy Bid Forms shall be manually signed in ink. Registration in OLB is considered your 'signature' for all bids submitted thru that system. Bid prices must be entered for each species and product in the Bid Price column for all material subject to bidding and all fill-in blanks must be completed. If erasures or other changes appear on the hardcopy Bid Form, each erasure or change must be initialed by the person signing the bid.

4. Submission of Sealed Bids (5/16)

Bid forms may be obtained from the Unit Manager or thru OLB. Bids may be submitted hardcopy or thru OLB. All hardcopy bids must be submitted on the bid form and in an envelope clearly identified as described in this section. NOTE: Only one bid form per bid envelope. Sealed bids must be submitted to the Unit office designated in the prospectus and must be submitted at or prior to the time established in the prospectus. The envelope should show on the outside (a) the sale name or number and (b) the date and time of bid opening, as shown in the prospectus. Bids received after the time specified in the sale prospectus are late bids and will be rejected.

It is possible for a bidder to submit multiple bids on a single sale. For example, a bid may be submitted hardcopy and a bid may be submitted thru OLB. Or, two bidders from the same company could both submit bids on the same sale. If this were to happen, the State would accept all bids received and award the contract accordingly. All bidding and contractual requirements would apply to all bids received.

5. Public Opening of Sealed Bids (7/16)

If conditions permit, the sealed bids will be publicly opened and posted at the time and place set in the prospectus.

If a bidder, present at a bid opening, has submitted bids on more than one sale, that bidder may withdraw their unopened bid envelopes or announce the withdrawal of their online bid after being declared the successful bidder on one sale.

6. Award of Contract (1/11)

Award of the contract will be made to the Bidder whose bid, conforming to the prospectus, is most advantageous to the State of Michigan on the basis of total value at rates bid for the estimated quantities. The State reserves the right to reject any bid or waive any minor irregularity in bids received. A written award mailed (or otherwise furnished) to the successful Bidder shall be deemed to result in a binding contract without further action by either party.

7. Down Payment (1/11)

The Bidder to whom award is made must make a down payment within 21 days of the sale award. The amount of the down payment will be calculated as shown in the Bond and Payment Schedule of this prospectus. Only cash may be used to meet this requirement.

8. Performance Security (1/11)

As guarantee of faithful performance, a cash bond, certificate of deposit, surety bond or irrevocable letter of credit (LOC) is required within 21 days of the sale award. The amount of the performance security is shown in the Bond and

Payment Schedule of this prospectus. If an LOC or surety is used, the coverage must extend for at least 6 months beyond the contract expiration.

9. Worker's Compensation (10/22)

Purchaser shall obtain worker's compensation insurance to cover claims under Michigan's Worker's Disability Compensation Act of 1969 or similar employee benefit act of any other state applicable to an employee. Verification of Worker's Disability Compensation Act Compliance must be completed and submitted within 21 days of contract award and prior to the issuance of the timber sale contract. In addition, if applicable, Notice of Exclusion or Certificate of Insurance must also be submitted.

10. Timber Sale Contract (10/22)

Additional conditions and requirements common to all timber sales are listed on the timber sale contract (R4031) and are available on line at www.michigan.gov/timber. Contact the Unit Manager for additional information or a sample contract. Within 21 days of the date of the award letter, the bidder must sign the contract and provide the required down payment, performance security, and verification of worker's disability compensation. The down payment and performance security shall be in accordance with the provisions of the timber sale contract, in the sums stated in this prospectus. If these actions are not taken, then the Bidder, the Bidder's corporation, and the corporation's principals may not be permitted to bid on State timber sales for a period of 3 months after the first offense, 6 months after the second offense, and 1 year after the third offense. An offense will only be counted against the Bidder for 5 years. In addition, the Bidder certifies that if awarded this contract, the Bidder will complete the timber sale contract in accordance with its terms and any modifications thereof including requirements to purchase, cut, and remove the included timber by the expiration date.

Payment Unit values in the State Forest Timber Sale Contract are calculated based on the advertised value of the Payment Unit as a percentage of the total advertised value of the contract. The advertised value of each Payment Unit is given in the Description of Timber by Payment Unit table on the Timber Sale Information page. For example, if the value of Payment Unit 1 is advertised as \$1,500 and the total Timber Sale value is advertised as \$10,000, the contract price for Payment Unit 1 will be 15% of the total bid price ($\$1,500/\$10,000 * 100$).

11. Disclaimer of Estimates and Bidder's Warranty of Inspection (10/22)

Before submitting this bid, the Bidder is advised and cautioned to inspect the sale area, review the requirements of the sale contract, and take other steps as may be reasonably necessary to ascertain the location, estimated volumes, construction estimates, and operating costs of the proposed sale. Failure to do so will not relieve the Bidder from responsibility for completing the contract.

The Bidder warrants that this bid is submitted solely on the basis of the Bidder's examination and inspection of the quality and quantity of the timber offered for sale and the Bidder's opinion of the value thereof and the costs of recovery. No reliance should be placed on the State of Michigan's estimates of timber quality, quantity or costs of recovery. Bidder further acknowledges that the State of Michigan: (i) expressly disclaims any warranty of fitness of timber for any purpose; (ii) offers this timber as is without any warranty of quality (merchantability) or quantity and (iii) expressly disclaims any warranty as to the quantity or quality of timber sold.

12. Certification and Chain-of-Custody (10/22)

Unless otherwise indicated in the contract under section 7 – Other Conditions of the Sale Specific Conditions & Requirements, the area encompassed by this timber sale is certified to the standards of the Forest Stewardship Council (FSC) - Certificate #SCS-FM/COC-00090N and the Sustainable Forestry Initiative (SFI) - Certificate #NSF-SFIS-5Y031-SF5. Forest products from this sale may be delivered to the mill as "FSC 100% and / or SFI certified" as long as the contractor hauling the forest products is chain-of-custody (COC) certified or covered under a COC certificate from the destination mill. The purchaser is responsible for maintaining COC after leaving the sale area.

13. Good Neighbor Authority (GNA) Requirements (10/22)

If the name of this timber sales contains the acronym GNA, it is authorized by the Good Neighbor Authority (GNA) and covered by various agreements between the U.S. Forest Service and the State. The timber sale occurs on federal land and the following conditions apply:

GNA contracts on US Forest Service land will not be awarded to purchasers on the Federal list of excluded parties. The System for Award Management (SAM) will be checked for active excluded parties prior to award of contract. In

addition, the Bidder to whom award is made must complete an Assurance Regarding Felony Conviction or Tax Delinquent Status for Corporate Applicants (AD-3031).

14. Good Neighbor Authority (GNA) Requirements, con't (10/22)

Bidder certifies, by signing this bid form, that to the best of Bidder's knowledge that the following representations are accurate and complete.

- a. That the Bidder and its principals are not presently debarred, suspended, proposed for debarment, declared ineligible, or voluntary excluded from timber sales (covered transactions) by any Federal department or agency.
- b. That the Bidder and its principals have not within a 3-year period preceding this bid been convicted of or had a civil judgment rendered against them for commission of fraud or a criminal offense in connection with obtaining , attempting to obtain, or performing a public (Federal, State, or local) transaction or contract under a public transaction; violation of Federal or State antitrust statutes or commission of embezzlement, theft, forgery, bribery, falsification or destruction of records, making false statements, or receiving stolen property.
- c. That the Bidder and its principals are not presently indicted for or otherwise criminally or civilly charged by a governmental entity (Federal, State, or local) with commission of any of the offenses enumerated in paragraph b of this certification.
- d. That the Bidder and its principals have not within a 3-year period preceding this bid had one or more public transactions (Federal, State, or local) terminated for breach or default of a timber or forest product contract.

Bidders that cannot certify this requirement, in whole or in part, shall submit an explanation with their bid.

Scott Bowen
Director

TIMBER SALE INFORMATION

Tick Alley Mix (71-003-26)

T22N, R04W, SEC. 4; T22N, R04W, SEC. 5; T22N, R04W, SEC. 6; T22N, R04W, SEC. 8.
Roscommon County (Advertised Price \$38,000.40)

SALE NOTE: Located just to the West of US-127 along the South side of M-55. Sale consists of a red pine seed tree unit and an oak seed tree unit that are a combined 49.8 acres. Timing restrictions apply for oak wilt, bark slip and Blanding's Turtle (see specs 5.2.3.3, 5.3.3.4, & 5.8.8)

A timber sale contract for this lump sum, sealed bid timber sale will be awarded to the responsible bidder offering the highest sealed bid price. All units of volume listed below were estimated using the Inventory Manager computer program and the new Michigan taper model. Bids must be at or above the following advertised price for each product and species:

<u>PRODUCTS & SPECIES</u>	<u>ESTIMATED UNITS*</u>	<u>ADVERTISED PRICE</u>
Sawtimber		
Black/Red (Hybrid) Oak	85.2 MBF	\$ 139.00 / MBF
Red Maple	8.2 MBF	\$ 64.00 / MBF
White Oak	4.0 MBF	\$ 66.00 / MBF
White Pine	2.1 MBF	\$ 76.00 / MBF
Pulpwood		
Jack Pine	1 Cords	\$ 10.25 / Cord
Mixed Aspen	20 Cords	\$ 32.85 / Cord
Mixed Hardwood	105 Cords	\$ 20.85 / Cord
Mixed Oak	137 Cords	\$ 18.15 / Cord
Red Pine	479 Cords	\$ 41.00 / Cord
White Pine	7 Cords	\$ 32.45 / Cord

* The total volume is statistically estimated within plus (+) or minus (-) 16.85 percent. There are an estimated 982 cords on this timber sale, plus or minus 165 cords at the 95% confidence level. The estimated units are final and not subject to adjustment. Prospective bidders are urged to examine this timber and to make their own estimates of quantity and quality.

BOND AND PAYMENT SCHEDULE:

1. A bond in the amount of \$1,900.00 to insure faithful performance of the conditions of the contract will be deposited by the successful bidder within 21 days of the sale award.
2. Cutting in any sale or unit without the required advance payment would be considered a trespass.
3. Total payment must be paid in advance or according to the following schedule :
 - (a) Ten percent (10%) of the sale value must be paid within 21 days of the sale award.
 - (b) The 10% down payment will be credited towards the first unit cut.
 - (c) Payment for each of the following units must be made before cutting begins in that unit:

PAYMENT UNIT NUMBER	PERCENT OF TOTAL SALE VALUE
01	52.7%
02	47.3%
4. If no cutting takes place, the 10% down payment will not be refunded.
5. Operations on the contract issued will terminate on 09/30/2029.

SALE STATISTICS

Volumes were calculated in cubic feet using the Michigan taper model. Cubic foot volume includes all wood inside bark for the product indicated. For display purposes, cubic feet were converted to cords and MBF using a simple conversion factor, e.g. 79 cubic feet per cord and 185 cubic feet per MBF. The cubic foot volumes are precise; the cords and MBF volumes are not. Cubic foot volume cannot be directly converted to cords or boards with precision.

SALE VOLUMES

The total estimated sale volume may not equal the sum of the species/products due to the nature of statistical calculations associated with double sampling methodology.

VOLUME		STATISTICAL RANGE IN CORDS		
TOTAL CUBIC FEET	TOTAL CORDS	PERCENT ERROR	MINIMUM	MAXIMUM
77,563	982	16.85%	816	1,147

VDU VOLUMES

A VDU is a Volume Determination Unit. Volumes and their associated statistics are calculated at the VDU level and summarized to the sale level. There is often a one to one relationship between a VDU and a Payment Unit, but not always, depending on the cruise design. Refer to the VDU TO PAYMENT UNIT table.

VDU	VOLUME		PERCENT ERROR	RANGE IN CORDS	
	TOTAL CUBIC FEET	TOTAL CORDS		MINIMUM	MAXIMUM
64	39,609	501	25.44%	374	629
101	37,953	480	22.47%	372	588
TOTAL:	77,563	982		746	1,217

VDU TO PAYMENT UNIT

When a VDU is associated with more than one Payment Unit (PU), the VDU volumes are assigned to the PU based on acres of the VDU within the PU.

VDU	VDU ACRES	PU	PU ACRES
TOTAL:			

DESCRIPTION OF TIMBER BY PAYMENT UNIT (PU)

PU	MARKET GROUP	PRODUCT	QUANTITY	UNIT	ACRES	ADVERTISE PRICE
1	Mixed Aspen	Pulpwood	11	Cords	12.0	\$20,007.35
	<i>Quaking Aspen</i>	<i>Sawtimber</i>	1.7	<i>MBF</i>		
	<i>Quaking Aspen</i>	<i>Pulpwood</i>	8	<i>Cords</i>		
	Mixed Hardwood		20	Cords		
	<i>Red Maple</i>		20	<i>Cords</i>		
	Red Pine		469	Cords		
2	Black/Red (Hybrid)	Sawtimber	85.2	MBF	37.8	\$17,993.05
	Red Maple		8.2	MBF		
	White Oak		4.0	MBF		
	White Pine		2.1	MBF		
	Jack Pine	Pulpwood	1	Cords		
	Mixed Aspen		9	Cords		
	<i>B. T. Aspen</i>		4	<i>Cords</i>		
	<i>Quaking Aspen</i>		5	<i>Cords</i>		
	Mixed Hardwood		85	Cords		
	<i>Paper Birch</i>	<i>Sawtimber</i>	0.6	<i>MBF</i>		
	<i>Pin Cherry</i>		0.9	<i>MBF</i>		
	<i>Paper Birch</i>	<i>Pulpwood</i>	8	<i>Cords</i>		
	<i>Pin Cherry</i>		5	<i>Cords</i>		
	<i>Red Maple</i>		69	<i>Cords</i>		
	Mixed Oak		137	Cords		
	<i>/Red (Hybrid) Oak</i>		124	<i>Cords</i>		
	<i>White Oak</i>		13	<i>Cords</i>		
	Red Pine		10	Cords		
	White Pine		7	Cords		
	TOTAL:			99.5		
TOTAL:			749	Cords		

Sale Specific Conditions & Requirements

Sale Name: Tick Alley Mix

Sale Number: 71-003-26 Seq#: 1

1 - Sale Area

1.2 - Boundaries

1.2.1 - Painted Boundaries (9/19)

The sale boundary is marked and identified by red paint, with the following exceptions. The Western boundary of Unit 1 is unpainted and is designated by the forest road. The interior boundaries of Unit 2 along the wildlife openings are unpainted and are designated by the openings. The painted boundary line trees are not Included Timber and are to be protected.

2 - Timber Specifications

2.1 - Included Timber

2.1.7 - Leave Tree Marked Unit(s) (6/14)

Within Payment Unit(s) 1 & 2, cut all trees that are two (2) inches or more at DBH except trees marked with green paint above and below stump height.

2.2 - Utilization

2.2.3 - Stump Heights (12/24)

Stump heights within the Sale Area shall not exceed 12 inches for trees greater than 10 inches at DBH and four (4) inches for trees smaller than 10 inches at DBH.

2.2.6 - Roundwood Operation Required (3/21)

The skidding of whole trees or tree segments with limbs attached is prohibited. All products must be produced as roundwood and forwarded to existing roads or landing areas in final product length. Trees must be harvested with in-woods processor in order to retain existing oak understory and to protect residual trees.

3 - Payments

3.3 - Pre-measured Sales

3.3.4 - Dividing Payment Units (7/14)

Payment Unit(s) may be divided at the request of the Purchaser and upon approval of the Unit Manager. Dividing Payment Units is a contract modification which requires a Timber Sale Contract Amendment. There will be only one division per Payment Unit.

3.4 - Damaged Timber

3.4.1 - Damaged Timber (12/24)

General Condition and Requirement 3.4 Damaged Timber, defines liquidated damages for undesignated live merchantable trees which are cut or injured. In addition, extreme care should be taken to avoid damage to tree seedlings and saplings.

Within the Sale Area, if more than 33% of the tree seedlings or saplings (1/4" to 4.5" DBH) within a specified portion of the Sale Area are damaged, liquidated damages will be assessed at \$500 per acre for all acreage within that specified portion of the Sale Area that was damaged.

No damage is acceptable to undesignated live merchantable trees. Within the Sale Area, if more than 10% of trees (> 4.5" DBH) within a specified area of the sale are damaged, liquidated damages will be assessed for all trees damaged. Rates will be in accordance with General Condition and Requirement 3.4 Damaged Timber.

4 - Transportation

4.1 - Construction

4.1.6 - Road Construction (4/24)

Construction of new roads or improvements of existing roads shall be done in such a way as to minimize the environmental

and visual impacts. Merchantable trees shall be cut and utilized unless otherwise directed. Non-merchantable trees shall be severed and laid flat on the ground. Slash shall be scattered, not left in windrows, and kept a minimum of 10 feet back from the road edge. Stumps shall be set upright, not left on edge, and be moved at least 10 feet away from the road edge. Disturbed soil shall be feathered into the woods and not left in berms or windrows.

4.1.7 - Road Closure (10/11)

All new roads built into the sale must be blocked to vehicle traffic upon completion of the sale. Overgrown roads that are reopened shall be considered new roads. In general, this will require constructing a four (4') foot high berm of stumps and logs covered with earth. Stumps and brush must be placed along the remainder of the trail. These roads must be rendered impassable to cars and trucks. All stumps from road building and landing construction must be reserved to block any newly constructed roads upon completion of the sale. These stumps must be scattered along the road system to prohibit vehicular movement. Contact the Sale Administrator for specific details of design and placement.

4.1.11 - Permits (2/12)

The Purchaser will secure any necessary permits that may be required.

4.2 - Maintenance

4.2.5 - Two Wheel Drive Condition (2/04)

All existing trail roads on and adjacent to the Sale Area must be passable by two-wheel drive traffic for the duration of the sale.

5 - Operations

5.1 - Notification

5.1.1 - Pre-sale Conference (10/25)

A pre-sale conference on site between the Purchaser and Sale Administrator is required prior to beginning any operations to determine landing and road locations. The Unit Manager or his/her representative must be contacted at least 5 days in advance to schedule the conference.

5.1.4 - Post-Sale Conference (10/16)

A post-sale conference on site between the Purchaser and sale administrator is required 5 days prior to the completion of active logging operations to determine clean-up and repair of landings, road edges, and the fulfillment of other contract specifications.

5.2 - Conduct of Operations

5.2.1 - Slash

5.2.1.8 - Slash Height (12/08)

No slash or tree tops may exceed 24 inches in height.

5.2.3 - Operating Restrictions

5.2.3.3 - Bark Slippage Restriction (3/09)

Within Payment Unit(s) 1, cutting and skidding are not permitted during the period of April 15 to July 15. This restriction is because of bark slippage.

5.2.3.4 - Oak Wilt Restriction, No Exceptions (1/18)

Within Payment Unit 2, cutting, skidding, hauling within the sale and brushing of access roads to the sale are not permitted during the period of April 15 to July 15. No exceptions will be granted. This is necessary to reduce the spread of oak wilt.

5.2.32 - Decking/Landing Restoration (9/13)

All decking and landing areas must have the surface area restored to a condition equal to or better than before. This is to ensure the proper regeneration of the stand. Wood debris, chips and "cookies" from trimmings must be removed or scattered away from landing and loading areas and may not be windrowed on the edge.

5.2.38 - No Decking Against Live Trees (2/04)

Cut products may not be decked against unmarked or designated leave trees.

5.2.43 - Opening Protection (2/21)

No harvesting, skidding or decking is permitted in openings marked on the Timber Sale Map with the letter "G". Hauling will be allowed, but only along the pre-existing road network. Any damage to the openings shall be repaired according to specifications of the Unit Manager or his/her representative.

5.4 - Soil Protection

5.4.1 - Rutting Restriction, General (7/16)

Operations are to cease immediately if equipment and weather conditions result in rutting of roads and/or skid trails which are 12 inches or greater in depth and 50 feet in length. The Unit Manager or his/her representative may restrict hauling and/or skidding if ruts exceed the specified depth. With the Unit Manager or his/her representative's approval, the Purchaser may return to the area when the risk of rutting has decreased.

5.8 - Protection of Endangered Species

5.8.8 - Protected Species, Other (2/12)

Within Payment Unit 2, all operations are restricted to the time period of September 15 to May 18. This restriction is in order to protect Blanding's Turtle.

6 - Safety and Fire Prevention

6.2 - Signing

6.2.1 - Road Posting (10/20)

The Purchaser is responsible for posting and maintaining caution signs on all roads adjacent to the sale area prior to beginning operations. The road must be posted at appropriate distances from the Sale Area to warn of logging activity and truck traffic. Signs must be removed when harvest operations are suspended or completed. The Purchaser will provide these signs.



TIMBER SALE MAP

This information provided by authority of Part 525, 1994 PA 451, as amended.

Sale Number 71-003-26	Date 11/05/2025
Scale 1:7,920	Page 1
	Of 2

Forest Management Unit Roscommon Mgt Unit	County Roscommon	Mapped By: Ewald
		Cruised By: Ewald

Township 22N	Range 04W	Section(s) and Subdivision(s) Sec. 4 SWSW; Sec. 5 NESW,SE; Sec. 6 NWNW; Sec. 8 NENE;
-----------------	--------------	--

Cover Type			
A = Aspen	J = Jack Pine	O = Oak	U = Upland Brush
B = Paper Birch	K = Rock	P = Lowland Poplar	UM = Upland Mix Forest
C = Cedar	L = Lowland Brush	Q = Mixed Swamp Conifer	V = Bog or Marsh
D = Treed Bog	LM = Lowland Mix Forest	R = Red Pine	W = White Pine
E = Swamp Hardwoods	M = Maple, Beech, Birch	S = Black Spruce	X = Non Stocked
F = Spruce/Fir	MC = Mixed Conifer	T = Tamarack	Y = Sand
G = Grass	MD = Mixed Deciduous	Z = Water	
H = Hemlock	N = Marsh		

Density	
0 = Non Stocked	5 = Pole Timber Medium
1 = Seedling Sapling Poor	6 = Pole Timber Well
2 = Seedling Sapling Medium	7 = Saw Timber Poor
3 = Seedling Sapling Well	8 = Saw Timber Medium
4 = Pole Timber Poor	9 = Saw Timber Well

Payment Unit Number	Acres
1	12
2	37.8

Tick Alley Mix

49.8 Acres

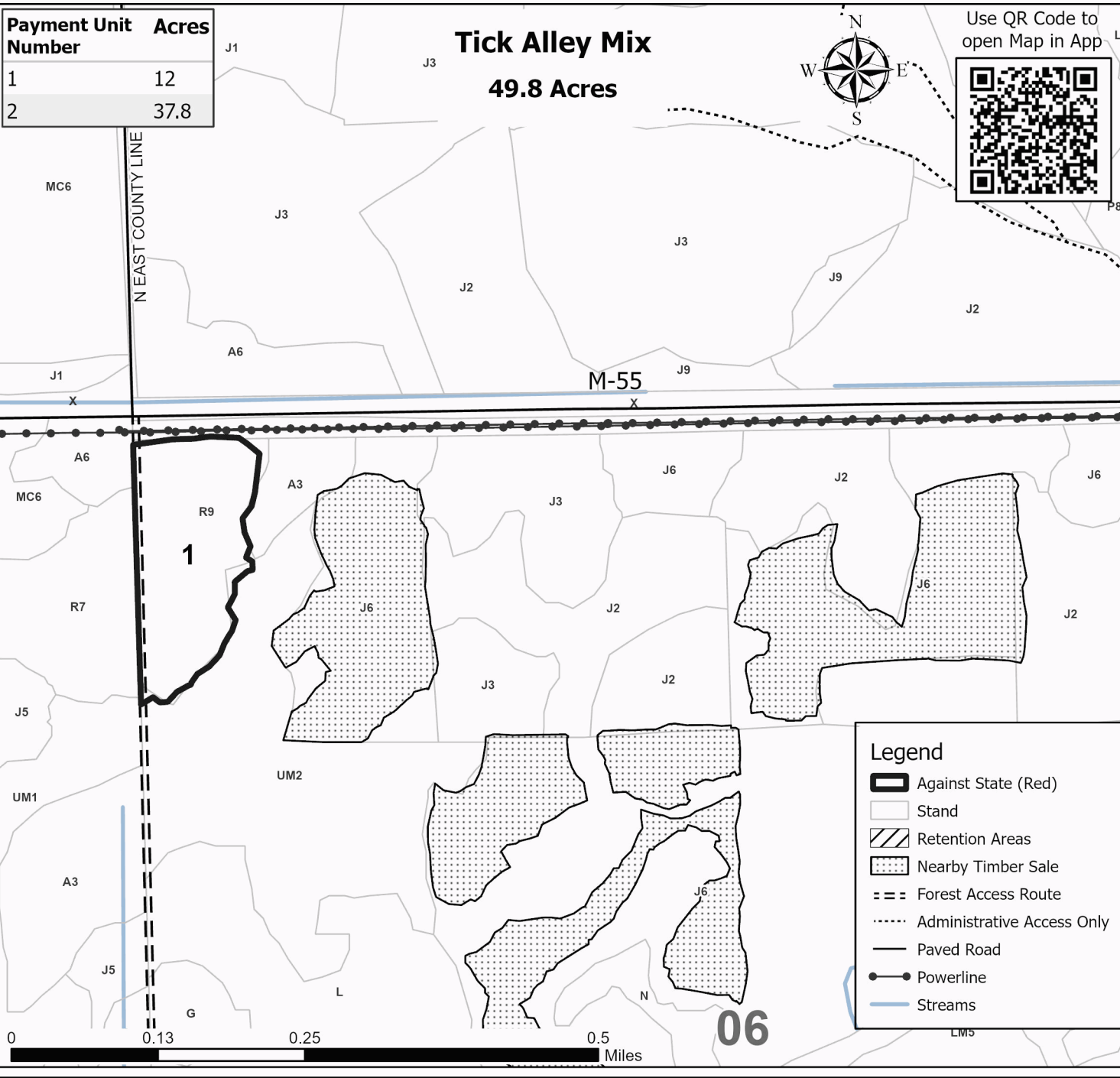



TIMBER SALE MAP

This information provided by authority of Part 525, 1994 PA 451, as amended.

Sale Number

71-003-26

Date

11/05/2025

Forest Management Unit

County

Mapped By: Ewald

Scale

Page

Of

Roscommon Mgt Unit

Roscommon

Cruised By: Ewald

1:7,920

2

2

Township
22N

Range
04W

Section(s) and
Subdivision(s) Sec. 4 SWSW; Sec. 5 NESW,SE; Sec. 6 NWNW; Sec. 8 NENE;

Cover Type

A = Aspen	J = Jack Pine	O = Oak	U = Upland Brush
B = Paper Birch	K = Rock	P = Lowland Poplar	UM = Upland Mix Forest
C = Cedar	L = Lowland Brush	Q = Mixed Swamp Conifer	V = Bog or Marsh
D = Treed Bog	LM = Lowland Mix Forest	R = Red Pine	W = White Pine
E = Swamp Hardwoods	M = Maple, Beech, Birch	S = Black Spruce	X = Non Stocked
F = Spruce/Fir	MC = Mixed Conifer	T = Tamarack	Y = Sand
G = Grass	MD = Mixed Deciduous	Z = Water	
H = Hemlock	N = Marsh		

Density

0 = Non Stocked	5 = Pole Timber Medium
1 = Seedling Sapling Poor	6 = Pole Timber Well
2 = Seedling Sapling Medium	7 = Saw Timber Poor
3 = Seedling Sapling Well	8 = Saw Timber Medium
4 = Pole Timber Poor	9 = Saw Timber Well

Payment Unit Number	Acres
1	12
2	37.8

Tick Alley Mix
49.8 Acres

05



Use QR Code to open Map in App



Legend

- Against State (Red)
- Stand
- Retention Areas
- Nearby Timber Sale
- Forest Access Route
- Paved Road
- Government Gravel/Dirt
- Powerline
- Streams

TIMBER SALE INFORMATION

Ogemaw Outwash Pine (71-005-26)

T24N, R01E, SEC. 10; T24N, R01E, SEC. 15; T24N, R01E, SEC. 16; T24N, R01E, SEC. 21; T24N, R01E, SEC. 22; T24N, R01E, SEC. 23; T24N, R01E, SEC. 26; T24N, R01E, SEC. 27; T24N, R01E, SEC. 34.

SALE NOTE: The sale consists of a red pine leave tree treatment and numerous smaller clearcuts.

A recreation site such as a trail, pathway, or campground is within the sale area or the vicinity. Certain restrictions/specifications may be applicable including time restrictions.

A timber sale contract for this lump sum, sealed bid timber sale will be awarded to the responsible bidder offering the highest sealed bid price. All units of volume listed below were estimated using the Inventory Manager computer program and the new Michigan taper model. Bids must be at or above the following advertised price for each product and species:

<u>PRODUCTS & SPECIES</u>	<u>ESTIMATED UNITS*</u>		<u>ADVERTISED PRICE</u>
Sawtimber			
Black/Red (Hybrid) Oak	36.1	MBF	\$ 139.00 / MBF
Jack Pine	42.1	MBF	\$ 31.00 / MBF
White Oak	4.3	MBF	\$ 66.00 / MBF
Pulpwood			
Jack Pine	1,340	Cords	\$ 10.25 / Cord
Mixed Hardwood	64	Cords	\$ 20.85 / Cord
Mixed Oak	158	Cords	\$ 18.15 / Cord
Quaking Aspen	71	Cords	\$ 32.85 / Cord
Red Pine	1,951	Cords	\$ 41.00 / Cord
White Pine	25	Cords	\$ 32.45 / Cord

* The total volume is statistically estimated within plus (+) or minus (-) 14.03 percent. There are an estimated 3,803 cords on this timber sale, plus or minus 534 cords at the 95% confidence level. The estimated units are final and not subject to adjustment. Prospective bidders are urged to examine this timber and to make their own estimates of quantity and quality.

BOND AND PAYMENT SCHEDULE:

1. A bond in the amount of \$5,384.00 to insure faithful performance of the conditions of the contract will be deposited by the successful bidder within 21 days of the sale award.
2. Cutting in any sale or unit without the required advance payment would be considered a trespass.
3. Total payment must be paid in advance or according to the following schedule :
 - (a) Ten percent (10%) of the sale value must be paid within 21 days of the sale award.
 - (b) The 10% down payment will be credited towards the first unit cut.
 - (c) Payment for each of the following units must be made before cutting begins in that unit:

PAYMENT UNIT NUMBER	PERCENT OF TOTAL SALE VALUE
01	4.3%
02	2.6%
03	5.3%
04	2.1%
05	2.6%
06	0.6%
07	0.1%
08	0.8%
09	0.0%
10	3.3%
11	1.1%
12	43.8%
13	27.8%
14	3.3%
15	2.3%

4. If no cutting takes place, the 10% down payment will not be refunded.
5. Operations on the contract issued will terminate on 09/30/2028.

SALE STATISTICS

Volumes were calculated in cubic feet using the Michigan taper model. Cubic foot volume includes all wood inside bark for the product indicated. For display purposes, cubic feet were converted to cords and MBF using a simple conversion factor, e.g. 79 cubic feet per cord and 185 cubic feet per MBF. The cubic foot volumes are precise; the cords and MBF volumes are not. Cubic foot volume cannot be directly converted to cords or boards with precision.

SALE VOLUMES

The total estimated sale volume may not equal the sum of the species/products due to the nature of statistical calculations associated with double sampling methodology.

VOLUME			STATISTICAL RANGE IN CORDS	
TOTAL CUBIC FEET	TOTAL CORDS	PERCENT ERROR	MINIMUM	MAXIMUM
300,437	3,803	14.03%	3,269	4,337

VDU VOLUMES

A VDU is a Volume Determination Unit. Volumes and their associated statistics are calculated at the VDU level and summarized to the sale level. There is often a one to one relationship between a VDU and a Payment Unit, but not always, depending on the cruise design. Refer to the VDU TO PAYMENT UNIT table.

VDU	VOLUME		PERCENT ERROR	RANGE IN CORDS	
	TOTAL CUBIC FEET	TOTAL CORDS		MINIMUM	MAXIMUM
8	11,689	148	43.60%	83	212
9	10,986	139	32.20%	94	184
11	168,261	2,130	23.71%	1,625	2,635
12	8,737	111	53.32%	52	170
14	5,610	71	79.32%	15	127
19	26,840	340	26.11%	251	428
20	6,593	83	70.74%	24	142
21	11,319	143	39.83%	86	200
35	3,549	45	83.73%	7	83
39	14,648	185	31.46%	127	244
70	4,307	55	41.07%	32	77
71	1,194	15	131.27%	0	35
73	5,963	75	37.38%	47	104
112	20,740	263	23.44%	201	324
TOTAL:	300,437	3,803		2,645	4,965

VDU TO PAYMENT UNIT

When a VDU is associated with more than one Payment Unit (PU), the VDU volumes are assigned to the PU based on acres of the VDU within the PU.

VDU	VDU ACRES	PU	PU ACRES
TOTAL:			

DESCRIPTION OF TIMBER BY PAYMENT UNIT (PU)

PU	MARKET GROUP	PRODUCT	QUANTITY	UNIT	ACRES	ADVERTISE PRICE
1	Black/Red (Hybrid)	Sawtimber	15.7	MBF	11.5	\$4,667.20
	Jack Pine		6.4	MBF		
	White Oak		0.5	MBF		
	Jack Pine	Pulpwood	10	Cords		
	Mixed Hardwood		4	Cords		
	<i>Pin Cherry</i>		4	<i>Cords</i>		
	Mixed Oak		39	Cords		
	<i>/Red (Hybrid) Oak</i>		37	<i>Cords</i>		
	<i>White Oak</i>		2	<i>Cords</i>		
	Quaking Aspen		13	Cords		
	<i>Quaking Aspen</i>		13	<i>Cords</i>		
	Red Pine		18	Cords		
	<i>Red Pine</i>		18	<i>Cords</i>		
	White Pine		6	Cords		
2	Black/Red (Hybrid)	Sawtimber	4.2	MBF	4.3	\$2,790.30
	Mixed Hardwood	Pulpwood	4	Cords		
	<i>Red Maple</i>		4	<i>Cords</i>		
	Mixed Oak		12	Cords		
	<i>/Red (Hybrid) Oak</i>		7	<i>Cords</i>		
	<i>White Oak</i>		5	<i>Cords</i>		
	Quaking Aspen		58	Cords		
	<i>Quaking Aspen</i>	<i>Sawtimber</i>	1.4	<i>MBF</i>		
	<i>Quaking Aspen</i>	<i>Pulpwood</i>	55	<i>Cords</i>		
3	Black/Red (Hybrid)	Sawtimber	7.7	MBF	39.6	\$5,657.55
	Jack Pine		15.5	MBF		
	White Oak		3.8	MBF		
	Jack Pine	Pulpwood	163	Cords		
	Mixed Hardwood		43	Cords		
	<i>Pin Cherry</i>	<i>Sawtimber</i>	0.7	<i>MBF</i>		
	<i>Pin Cherry</i>	<i>Pulpwood</i>	42	<i>Cords</i>		
	Mixed Oak		71	Cords		
	<i>/Red (Hybrid) Oak</i>		62	<i>Cords</i>		
<i>White Oak</i>		9	<i>Cords</i>			
4	Black/Red (Hybrid)	Sawtimber	1.9	MBF	9.3	\$2,220.20
	Jack Pine		8.0	MBF		
	Jack Pine	Pulpwood	157	Cords		
	Mixed Hardwood		3	Cords		
	<i>Pin Cherry</i>		3	<i>Cords</i>		
	Mixed Oak		2	Cords		
	<i>/Red (Hybrid) Oak</i>		2	<i>Cords</i>		
5	Jack Pine	Pulpwood	259	Cords	39.7	\$2,777.75
	Red Pine		3	Cords		
	<i>Red Pine</i>		3	<i>Cords</i>		
6	Jack Pine	Pulpwood	51	Cords	21.4	\$645.75
	Red Pine		3	Cords		
	<i>Red Pine</i>		3	<i>Cords</i>		
7	Jack Pine	Pulpwood	13	Cords	32.8	\$133.25
8	Jack Pine	Pulpwood	73	Cords	10.7	\$871.25
	Red Pine		3	Cords		
	<i>Red Pine</i>	<i>Sawtimber</i>	0.9	<i>MBF</i>		
	<i>Red Pine</i>	<i>Pulpwood</i>	1	<i>Cords</i>		
9	Jack Pine	Pulpwood	2	Cords	6.0	\$20.50
10	Black/Red (Hybrid)	Sawtimber	1.1	MBF	41.5	\$3,513.90
	Jack Pine		11.1	MBF		
	Jack Pine	Pulpwood	234	Cords		

DESCRIPTION OF TIMBER BY PAYMENT UNIT (PU), CON'T

PU	MARKET GROUP	PRODUCT	QUANTITY	UNIT	ACRES	ADVERTISE PRICE
10 con't	Mixed Oak	Pulpwood	16	Cords		
	/Red (Hybrid) Oak		16	Cords		
	Red Pine		8	Cords		
	Red Pine		8	Cords		
11	Black/Red (Hybrid)	Sawtimber	4.5	MBF	4.7	\$1,135.15
	Jack Pine	Pulpwood	1.1	MBF		
	Jack Pine		22	Cords		
	Mixed Oak		7	Cords		
	/Red (Hybrid) Oak		7	Cords		
	Red Pine		3	Cords		
	Red Pine		3	Cords		
12	Jack Pine	Pulpwood	196	Cords	69.4	\$47,274.65
	Mixed Hardwood		5	Cords		
	Pin Cherry		5	Cords		
	Red Pine		1,092	Cords		
	Red Pine		1,092	Cords		
	White Pine		12	Cords		
13	Jack Pine	Pulpwood	124	Cords	43.9	\$29,891.70
	Mixed Hardwood		3	Cords		
	Pin Cherry		3	Cords		
	Red Pine		691	Cords		
	Red Pine		691	Cords		
	White Pine		7	Cords		
14	Black/Red (Hybrid)	Sawtimber	1.0	MBF	12.6	\$3,566.40
	Jack Pine	Pulpwood	29	Cords		
	Mixed Hardwood		2	Cords		
	Pin Cherry		2	Cords		
	Mixed Oak		3	Cords		
	/Red (Hybrid) Oak		3	Cords		
	Red Pine		74	Cords		
	Red Pine		74	Cords		
15	Jack Pine	Pulpwood	7	Cords	8.5	\$2,512.95
	Mixed Oak		8	Cords		
	/Red (Hybrid) Oak		8	Cords		
	Red Pine		56	Cords		
	Red Pine		56	Cords		
TOTAL:			82.5	MBF		
TOTAL:			3,609	Cords		

Sale Specific Conditions & Requirements

Sale Name: Ogemaw Outwash Pine

Sale Number: 71-005-26 Seq#: 1

1 - Sale Area

1.2 - Boundaries

1.2.1 - Painted Boundaries (9/19)

The sale boundary and Payment Unit boundaries are marked and identified by red and yellow paint. Exterior sale boundary lines against private property are indicated by county roads. Exterior sale boundary lines against state are marked with red paint. Interior Payment Unit boundaries are marked with yellow paint. Retention patches are marked with red paint; no harvesting activities may occur within these areas. The painted boundary line trees are not Included Timber and are to be protected unless marked with orange paint. Yellow painted trees designating an interior Payment Unit boundary are only to be cut when all surrounding Payment Units have been paid.

2 - Timber Specifications

2.1 - Included Timber

2.1.1 - Clearcut Unit(s) with Unmerchantable Trees (6/14)

Within Payment Unit(s) 1, 4-11, 14, and 15, cut all trees that are two (2) inches or more at DBH.

2.1.4 - Designated Timber Unit(s) (6/17)

Within Payment Unit(s) 2 and 3, all trees except red and white pine are designated for cutting regardless of merchantability.

2.1.7 - Leave Tree Marked Unit(s) (6/14)

Within Payment Unit(s) 12 and 13, cut all trees that are two (2) inches or more at DBH except oak and trees marked with green paint above and below stump height.

2.2 - Utilization

2.2.2 - Chipping Required (12/24)

Payment Units 1, 5, 6, 8, 10, 14, and 15, must be chip harvested. The Purchaser has the option to produce sawlogs or pulpwood bolts, but the remaining portion of the trees must be chipped and hauled. If market conditions limit the practicality of chipping, tops and slash must be arranged in a way that will not inhibit future planting operations, as directed by the Sale Administrator. The requirement to retain approximately 1/6 to 1/3 of treetops and limbs less than four (4) inches in diameter is still applicable (G. C. & R. 2.2).

2.2.3 - Stump Heights (12/24)

Stump heights within the Sale Area shall not exceed six (6) inches for all trees.

2.2.10 - No Chipping Tops and Limbs (8/16)

Within Payment Unit(s) 7 and 9, chipping of limbs or tops is not permitted. Limbs and the remaining top must be left on site and scattered.

3 - Payments

3.4 - Damaged Timber

3.4.1 - Damaged Timber (12/24)

General Condition and Requirement 3.4 Damaged Timber, defines liquidated damages for undesignated live merchantable trees which are cut or injured. In addition, extreme care should be taken to avoid damage to tree seedlings and saplings.

Within Payment Unit 3, if more than 30% of the tree seedlings or saplings (1/4" to 4.5" DBH) within a specified portion of the Sale Area are damaged, liquidated damages will be assessed at \$500 per acre for all acreage within that specified portion of the Sale Area that was damaged.

No damage is acceptable to undesignated live merchantable trees. Within the Sale Area, if more than 5% of trees (> 4.5" DBH) within a specified area of the sale are damaged, liquidated damages will be assessed for all trees damaged. Rates will be in accordance with General Condition and Requirement 3.4 Damaged Timber.

4 - Transportation

4.1 - Construction

4.1.6 - Road Construction (4/24)

Construction of new roads or improvements of existing roads shall be done in such a way as to minimize the environmental and visual impacts. Merchantable trees shall be cut and utilized unless otherwise directed. Non-merchantable trees shall be severed and laid flat on the ground. Slash shall be scattered, not left in windrows, and kept a minimum of 10 feet back from the road edge. Stumps shall be set upright, not left on edge, and be moved at least 10 feet away from the road edge. Disturbed soil shall be feathered into the woods and not left in berms or windrows.

4.1.11 - Permits (2/12)

The Purchaser will secure any necessary permits that may be required.

5 - Operations

5.1 - Notification

5.1.1 - Pre-sale Conference (10/25)

A pre-sale conference on site between the Purchaser and Sale Administrator is required prior to beginning any operations to determine landing and road locations. The Unit Manager or his/her representative must be contacted at least 5 days in advance to schedule the conference.

5.1.4 - Post-Sale Conference (10/16)

A post-sale conference on site between the Purchaser and sale administrator is required 5 days prior to the completion of active logging operations to determine clean-up and repair of landings, road edges, and the fulfillment of other contract specifications.

5.2 - Conduct of Operations

5.2.1 - Slash

5.2.1.8 - Slash Height (12/08)

No slash or tree tops may exceed 24 inches in height.

5.2.1.11 - Slash for Reforestation (3/21)

To facilitate reforestation, Payment Unit(s) 7 and 9 shall be left with slash evenly distributed. Bunched tops within the cutting area shall be broken up and scattered. Stumps shall be cut low to the ground. Processing sites shall not be left with a compacted layer of slash; tops from these sites shall be hauled back into the cut area and scattered.

5.2.3 - Operating Restrictions

5.2.3.4 - Oak Wilt Restriction, No Exceptions (1/18)

Within Payment Unit(s) 12 and 13, cutting, skidding, hauling within the sale and brushing of access roads to the sale are not permitted during the period of April 15 to July 15. No exceptions will be granted. This is necessary to reduce the spread of oak wilt.

5.2.3.11 - Coppice Regeneration Protection (4/10)

Timber harvesting in Payment Unit 2 must be completed before significant aspen sprouting occurs in that Payment Unit, so as to minimize damage to the new regeneration. Any post-harvest operations, such as chipping, must be completed before sprouting of regeneration occurs. If it is anticipated that chipping will be delayed, then tops shall be carried to one central location or left unchipped. The Unit Manager or his/her representative may cease such operations if sprouting occurs before the operation is complete.

5.2.32 - Decking/Landing Restoration (9/13)

All decking and landing areas must have the surface area restored to a condition equal to or better than before. This is to ensure the proper regeneration of the stand. Wood debris, chips and "cookies" from trimmings must be removed or scattered away from landing and loading areas and may not be windrowed on the edge.

5.2.38 - No Decking Against Live Trees (2/04)

Cut products may not be decked against unmarked or designated leave trees.

5.2.41 - Snowmobile Trail Protection (9/11)

A snowmobile trail is shown on the Timber Sale Map. Do not cut or damage posts with orange trail markers or traffic control signs. If the trail is used, it must be maintained and restored to a condition equal to or better than before the sale. If the trail is used for hauling, it must be graded to the satisfaction of the Unit Manager or his/her representative prior to December 1. If the trail road is to be used for hauling during the snowmobile season, then a snow-covered base must be left on the trail. The snowmobile trail may only be crossed at right angles. Maintain a 20-foot-wide slash, debris, and rut free zone daily using the snowmobile trail as the centerline.

5.4 - Soil Protection

5.4.1 - Rutting Restriction, General (7/16)

Operations are to cease immediately if equipment and weather conditions result in rutting of roads and/or skid trails which are 12 inches or greater in depth and 50 feet in length. The Unit Manager or his/her representative may restrict hauling and/or skidding if ruts exceed the specified depth. With the Unit Manager or his/her representative's approval, the Purchaser may return to the area when the risk of rutting has decreased.

6 - Safety and Fire Prevention

6.2 - Signing

6.2.1 - Road Posting (10/20)

The Purchaser is responsible for posting and maintaining caution signs on roads in the sale area prior to beginning operations. The road must be posted at appropriate distances from the Sale Area to warn of logging activity and truck traffic. Signs must be removed when harvest operations are suspended or completed. The Purchaser will provide these signs.

6.2.2 - Snowmobile Trail Posting (10/20)

The Purchaser is responsible for posting and maintaining caution signs on the snowmobile trail shown on the map prior to beginning operations during the snowmobile season (approximately December 1 to March 31). The trail must be posted at appropriate distances from the Sale Area to warn of logging activity and truck traffic. Signs must be removed when harvest operations are suspended or completed. The Purchaser will provide these signs.



TIMBER SALE MAP

This information provided by authority of Part 525, 1994 PA 451, as amended.

Sale Number
71-005-26

Date
01/12/2026

Forest Management Unit	County	Mapped By: Sanborn
Roscommon Mgt Unit	Ogemaw	Cruised By: Sanborn

Scale	Page	Of
1:8,280	1	3

Township 24N	Range 01E	Section(s) and Subdivision(s)
		E1/2NE,E1/2SE; Sec. 23 SE; Sec. 26 NWNE; Sec. 27 SESE; Sec. 34 SWNE,NESW,N1/2SE,SESE; Sec. 10 S1/2SW; Sec. 15 N1/2NW,E1/2NE,S1/2SW,S1/2SE; Sec. 16 NENE; Sec. 21 E1/2NE,E1/2SE; Sec. 22

Cover Type

A = Aspen	J = Jack Pine	O = Oak	U = Upland Brush
B = Paper Birch	K = Rock	P = Lowland Poplar	UM = Upland Mix Forest
C = Cedar	L = Lowland Brush	Q = Mixed Swamp Conifer	V = Bog or Marsh
D = Treed Bog	LM = Lowland Mix Forest	R = Red Pine	W = White Pine
E = Swamp Hardwoods	M = Maple, Beech, Birch	S = Black Spruce	X = Non Stocked
F = Spruce/Fir	MC = Mixed Conifer	T = Tamarack	Y = Sand
G = Grass	MD = Mixed Deciduous	Z = Water	
H = Hemlock	N = Marsh		

Density

0 = Non Stocked	5 = Pole Timber Medium
1 = Seedling Sapling Poor	6 = Pole Timber Well
2 = Seedling Sapling Medium	7 = Saw Timber Poor
3 = Seedling Sapling Well	8 = Saw Timber Medium
4 = Pole Timber Poor	9 = Saw Timber Well

Payment Unit Number	Acres	Payment Unit Number	Acres	Payment Unit Number	Acres
1	11.5	6	21.4	11	4.7
2	4.3	7	32.8	12	69.4
3	39.6	8	10.7	13	43.9
4	9.3	9	6	14	12.5
5	39.7	10	41.5	15	8.5

**Ogemaw
Outwash Pine
355.9 Acres**

Map Note:
Private (Blue), Payment Unit (Yellow),
and Against State (Red), against county
roads are not painted.

Legend

- Against State (Red)
- Retention Areas
- Private Line (Blue)
- Payment Unit (Yellow)
- Forest Access Route
- Government Gravel/Dirt
- Private Gravel/Dirt
- Recreational Trails
- MIRIS Corners

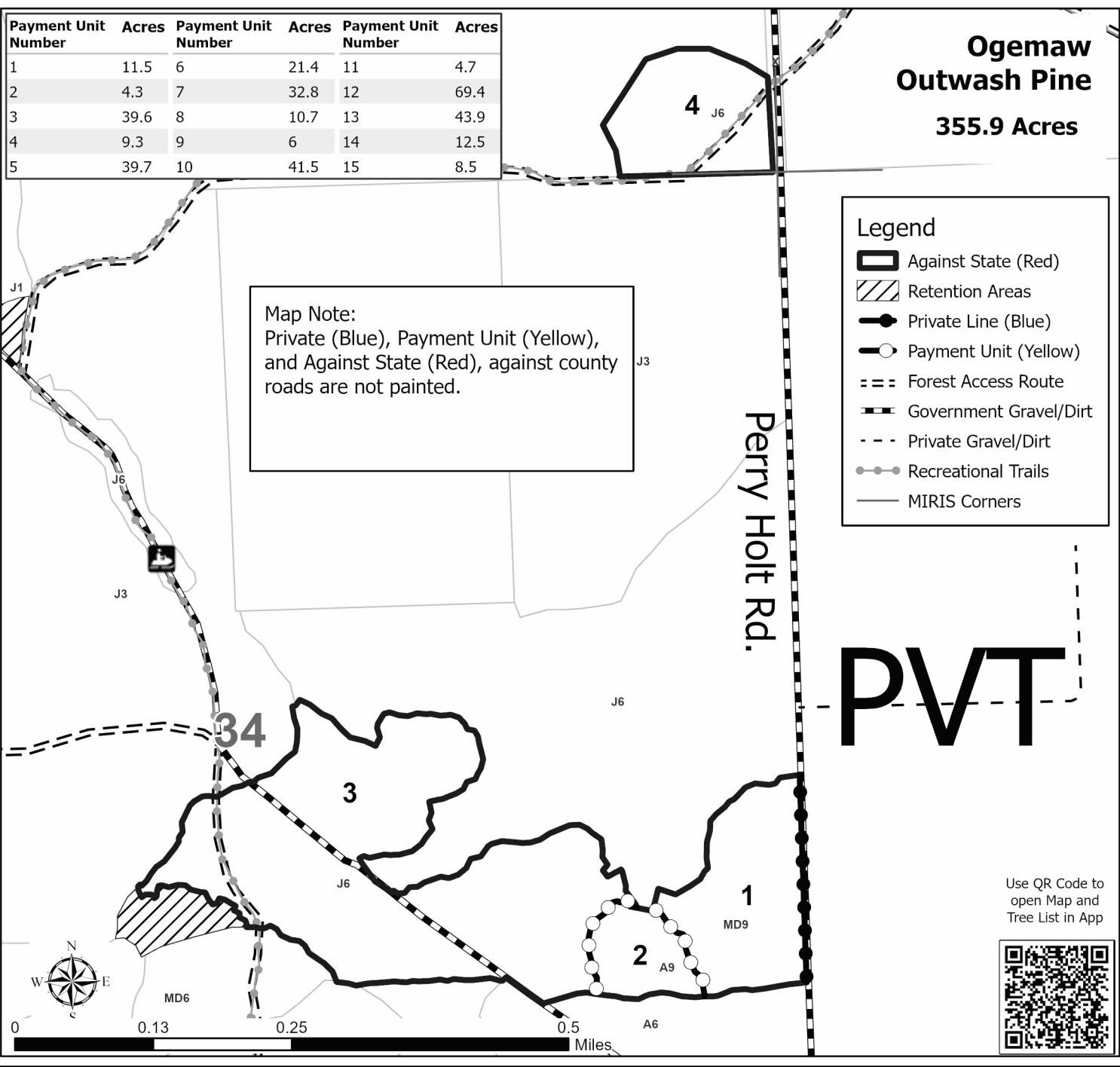

Use QR Code to
open Map and
Tree List in App





TIMBER SALE MAP

This information provided by authority of Part 525, 1994 PA 451, as amended.

Sale Number

71-005-26

Date

01/12/2026

Forest Management Unit

County

Mapped By: Sanborn

Scale

Page

Of

Roscommon Mgt Unit

Ogemaw

Cruised By: Sanborn

1:19,400

2

3

Township
24N

Range
01E

Section(s) and Subdivision(s) E1/2NE,E1/2SE; Sec. 23 SE; Sec. 26 NWNE; Sec. 27 SESE; Sec. 34 SWNE,NESW,N1/2SE,SESE;
Sec. 10 S1/2SW; Sec. 15 N1/2NW,E1/2NE,S1/2SW,S1/2SE; Sec. 16 NENE; Sec. 21 E1/2NE,E1/2SE; Sec. 22

Cover Type

A = Aspen	J = Jack Pine	O = Oak	U = Upland Brush
B = Paper Birch	K = Rock	P = Lowland Poplar	UM = Upland Mix Forest
C = Cedar	L = Lowland Brush	Q = Mixed Swamp Conifer	V = Bog or Marsh
D = Treed Bog	LM = Lowland Mix Forest	R = Red Pine	W = White Pine
E = Swamp Hardwoods	M = Maple, Beech, Birch	S = Black Spruce	X = Non Stocked
F = Spruce/Fir	MC = Mixed Conifer	T = Tamarack	Y = Sand
G = Grass	MD = Mixed Deciduous	Z = Water	
H = Hemlock	N = Marsh		

Density

0 = Non Stocked	5 = Pole Timber Medium
1 = Seedling Sapling Poor	6 = Pole Timber Well
2 = Seedling Sapling Medium	7 = Saw Timber Poor
3 = Seedling Sapling Well	8 = Saw Timber Medium
4 = Pole Timber Poor	9 = Saw Timber Well

Ogemaw Outwash Pine 355.9 Acres

Payment Unit Number	Acres	Payment Unit Number	Acres	Payment Unit Number	Acres
1	11.5	6	21.4	11	4.7
2	4.3	7	32.8	12	69.4
3	39.6	8	10.7	13	43.9
4	9.3	9	6	14	12.5
5	39.7	10	41.5	15	8.5

Legend

- Against State (Red)
- Retention Areas
- Private Line (Blue)
- Payment Unit (Yellow)
- Forest Access Route
- Government Gravel/Dirt
- Private Gravel/Dirt
- MIRIS Corners
- Nearby Timber Sale

Map Note:
Private (Blue), Payment Unit (Yellow),
and Against State (Red), against county
roads are not painted.

Use QR Code to
open Map and
Tree List in App
MC3

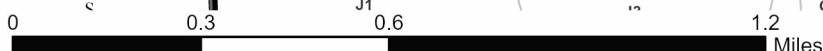



TIMBER SALE MAP

This information provided by authority of Part 525, 1994 PA 451, as amended.

Sale Number 71-005-26	Date 01/12/2026
Scale 1:7,050	Page 3
	Of 3

Forest Management Unit Roscommon Mgt Unit	County Ogemaw	Mapped By: Sanborn Cruised By: Sanborn
--	------------------	---

Township 24N	Range 01E	Section(s) and Subdivision(s) E1/2NE,E1/2SE; Sec. 23 SE; Sec. 26 NWNE; Sec. 27 SESE; Sec. 34 SWNE,NESW,N1/2SE,SESE; Sec. 10 S1/2SW; Sec. 15 N1/2NW,E1/2NE,S1/2SW,S1/2SE; Sec. 16 NENE; Sec. 21 E1/2NE,E1/2SE; Sec. 22
-----------------	--------------	---

Cover Type			
A = Aspen	J = Jack Pine	O = Oak	U = Upland Brush
B = Paper Birch	K = Rock	P = Lowland Poplar	UM = Upland Mix Forest
C = Cedar	L = Lowland Brush	Q = Mixed Swamp Conifer	V = Bog or Marsh
D = Treed Bog	LM = Lowland Mix Forest	R = Red Pine	W = White Pine
E = Swamp Hardwoods	M = Maple, Beech, Birch	S = Black Spruce	X = Non Stocked
F = Spruce/Fir	MC = Mixed Conifer	T = Tamarack	Y = Sand
G = Grass	MD = Mixed Deciduous	Z = Water	
H = Hemlock	N = Marsh		

Density	
0 = Non Stocked	5 = Pole Timber Medium
1 = Seedling Sapling Poor	6 = Pole Timber Well
2 = Seedling Sapling Medium	7 = Saw Timber Poor
3 = Seedling Sapling Well	8 = Saw Timber Medium
4 = Pole Timber Poor	9 = Saw Timber Well

Payment Unit Number	Acres	Payment Unit Number	Acres	Payment Unit Number	Acres
1	11.5	6	21.4	11	4.7
2	4.3	7	32.8	12	69.4
3	39.6	8	10.7	13	43.9
4	9.3	9	6	14	12.5
5	39.7	10	41.5	15	8.5

**Ogemaw
Outwash Pine
355.9 Acres**

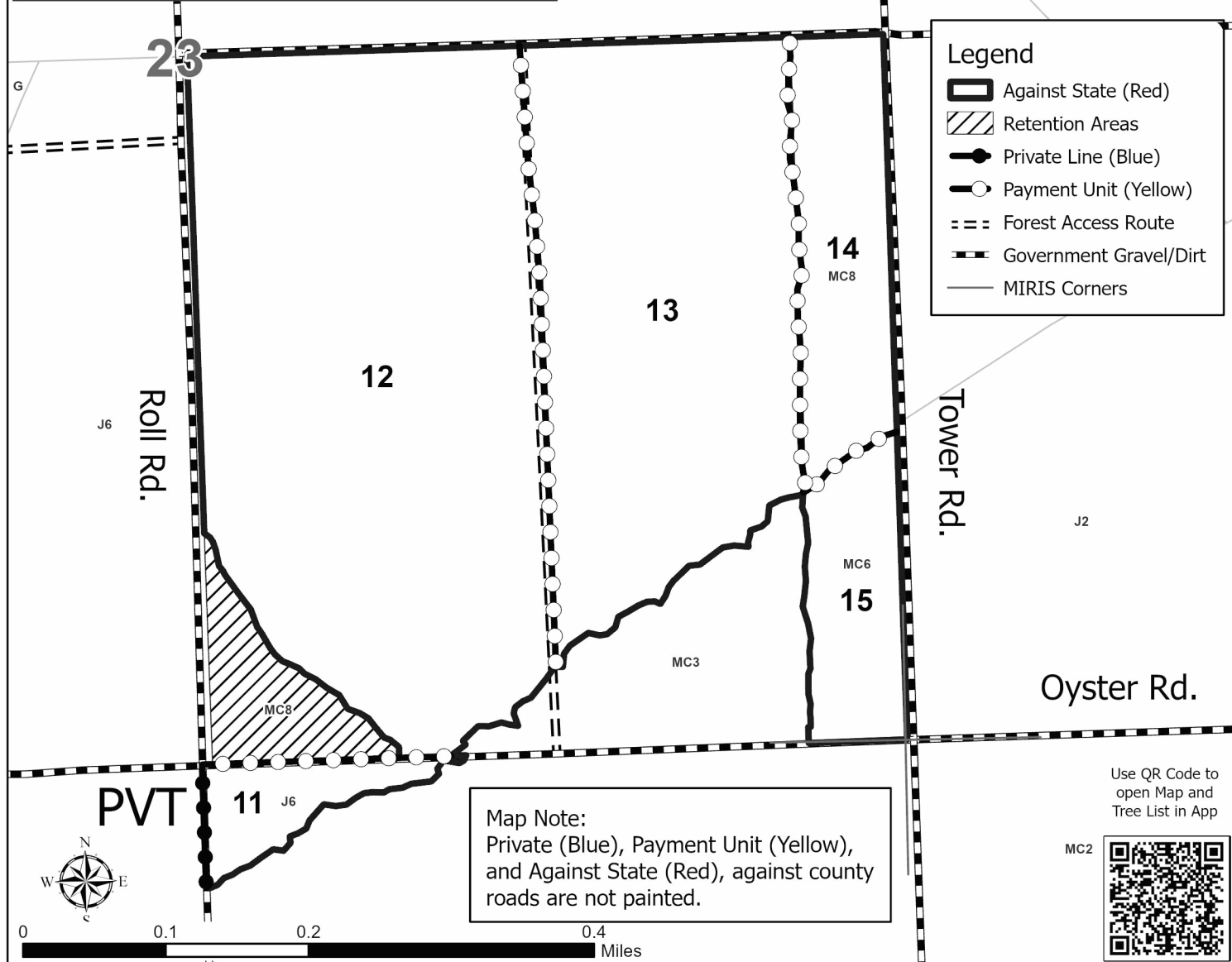

Use QR Code to open Map and Tree List in App



Tick Alley Mix (71-003-26)

T22N, R04W, SEC. 4; T22N, R04W, SEC. 5; T22N, R04W, SEC. 6; T22N, R04W,

In response to the notice of sale to be held 9:00 a.m. (local time) on July 28, 2026, I am hereby submitting my sealed bid (firm offer) for the following forest products to be cut. Bids for individual species must be at or above the advertised price. All non-responsive bid forms may be rejected.

<u>PRODUCTS & SPECIES</u>	<u>ESTIMATED VOLUME*</u>	<u>ADVERTISED PRICE</u>	<u>BID PRICE/UNIT</u>
Sawtimber			
Black/Red (Hybrid) Oak	85.2 MBF	\$ 139.00/MBF	\$ _____
Red Maple	8.2 MBF	\$ 64.00/MBF	\$ _____
White Oak	4.0 MBF	\$ 66.00/MBF	\$ _____
White Pine	2.1 MBF	\$ 76.00/MBF	\$ _____
Pulpwood			
Jack Pine	1 Cords	\$ 10.25/Cord	\$ _____
Mixed Aspen	20 Cords	\$ 32.85/Cord	\$ _____
Mixed Hardwood	105 Cords	\$ 20.85/Cord	\$ _____
Mixed Oak	137 Cords	\$ 18.15/Cord	\$ _____
Red Pine	479 Cords	\$ 41.00/Cord	\$ _____
White Pine	7 Cords	\$ 32.45/Cord	\$ _____

*The volumes are statistically estimated within plus (+) or minus (-) 16.85 percent at 95% confidence level. These estimated volumes are final and not subject to adjustment. Prospective bidders are urged to examine this timber and to make their own estimates of quantity and quality.

I understand that any or all bids may be rejected. All bids must be signed and all bid items must be bid or the bid form may be rejected. I also understand that consideration and awarding a contract will be based upon my past performance and ability to complete the contract based upon equipment and staffing subject to my control.

FEDERAL ID: _____ or SOCIAL SECURITY NUMBER: _____

Company or individual bidding: _____

Company representative's name: _____

Address: _____

City: _____ State: _____ Zip: _____

IF AVAILABLE, PLEASE PLACE THE PERSONALIZED LABEL FROM YOUR PROSPECTUS IN THE ABOVE BOX.

Individual or company representative's signature: _____ Date: _____

Phone number : _____ Email (optional): _____

THE WINNING BIDDER MUST COMPLETE THE VERIFICATION OF WORKER'S DISABILITY COMPENSATION ACT COMPLIANCE (ON REVERSE SIDE IF DOUBLE SIDED) WITHIN 21 DAYS OF SALE AWARD DATE



FOR DEPARTMENT USE ONLY
Sale Number (XX - XXX - XX - XX)
Forest Management Unit:

TIMBER SALE VERIFICATION OF WORKER'S DISABILITY COMPENSATION ACT COMPLIANCE

*As required by Act 317, P.A. 1969 (Worker's Compensation) and
Part 5 of Act 451 of 1994, as amended.*

VERIFICATION OF WORKER'S DISABILITY COMPENSATION ACT COMPLIANCE

- This verification must be completed and submitted within 21 days of contract award and prior to the issuance of the timber sale contract.
- In addition, if boxes 2B or 2C are checked, then Notice of Exclusion or Certificate of Insurance must be submitted within twenty-one (21) days of the contract award and prior to the issuance of the timber sale contract.
- All information must be typed or printed except for written signatures.

Please Check Appropriate Categories:

1. My business is organized as (you **must** check one of the boxes below):
 - A. Sole Proprietorship (individual)
 - B. Partnership
 - C. Corporation
2. You **must** check one of the boxes below:
 - A. I certify my business is a sole proprietorship and it has no employees but the sole proprietor. I am not subject to the Worker's Compensation Laws.
 - B. I certify my business has satisfied its obligation to the Worker's Compensation Act through the use of an approved Notice of Exclusion (BWC-337, Rev. 5/96). I will provide a copy of the Notice of Exclusion within 21 days of the contract award. (For questions or a copy of the BWC-337, please call the Worker's Compensation Bureau at 517 -322-1195).
 - C. I certify my business has a Worker's Compensation Policy. I will provide an original Certificate of Insurance within twenty-one (21) days of the contract award.
3. If you have checked item 2(A) or 2(B), you **must** indicate the number of **both** full-time and part-time employees, other than yourself, including family members and active partners (if none, you must enter "0").

_____ Full-time Employees

_____ Part-time Employees

Name of Business		Federal ID (or) Social Security No.	
Address		Telephone ()	
City	State	ZIP	

I hereby certify that the above information is true and correct. I agree to notify the Michigan DNR of any changes that occur in factors affecting my coverage during any of my present and future operations.

Signature of Owner or Authorized Representative

Title

Date

Please complete the "SEALED BID" information on the next page

Ogemaw Outwash Pine (71-005-26)
T24N, R01E, SEC. 10; T24N, R01E, SEC. 15; T24N, R01E, SEC. 16; T24N, R01E,

In response to the notice of sale to be held 9:00 a.m. (local time) on July 28, 2026, I am hereby submitting my sealed bid (firm offer) for the following forest products to be cut. Bids for individual species must be at or above the advertised price. All non-responsive bid forms may be rejected.

<u>PRODUCTS & SPECIES</u>	<u>ESTIMATED VOLUME*</u>	<u>ADVERTISED PRICE</u>	<u>BID PRICE/UNIT</u>
Sawtimber			
Black/Red (Hybrid) Oak	36.1 MBF	\$ 139.00/MBF	\$ _____
Jack Pine	42.1 MBF	\$ 31.00/MBF	\$ _____
White Oak	4.3 MBF	\$ 66.00/MBF	\$ _____
Pulpwood			
Jack Pine	1,340 Cords	\$ 10.25/Cord	\$ _____
Mixed Hardwood	64 Cords	\$ 20.85/Cord	\$ _____
Mixed Oak	158 Cords	\$ 18.15/Cord	\$ _____
Quaking Aspen	71 Cords	\$ 32.85/Cord	\$ _____
Red Pine	1,951 Cords	\$ 41.00/Cord	\$ _____
White Pine	25 Cords	\$ 32.45/Cord	\$ _____

*The volumes are statistically estimated within plus (+) or minus (-) 14.03 percent at 95% confidence level. These estimated volumes are final and not subject to adjustment. Prospective bidders are urged to examine this timber and to make their own estimates of quantity and quality.

I understand that any or all bids may be rejected. All bids must be signed and all bid items must be bid or the bid form may be rejected. I also understand that consideration and awarding a contract will be based upon my past performance and ability to complete the contract based upon equipment and staffing subject to my control.

FEDERAL ID: ____ - ____ - ____ or SOCIAL SECURITY NUMBER: ____ - ____ - ____

Company or individual bidding: _____

Company representative's name: _____

Address: _____

City: _____ State: _____ Zip: _____

IF AVAILABLE, PLEASE PLACE THE PERSONALIZED LABEL FROM YOUR PROSPECTUS IN THE ABOVE BOX.

Individual or company representative's signature: _____ Date: _____

Phone number : _____ Email (optional): _____

THE WINNING BIDDER MUST COMPLETE THE VERIFICATION OF WORKER'S DISABILITY COMPENSATION ACT COMPLIANCE (ON REVERSE SIDE IF DOUBLE SIDED) WITHIN 21 DAYS OF SALE AWARD DATE



FOR DEPARTMENT USE ONLY	
Sale Number (XX - XXX - XX - XX)	
Forest Management Unit:	

TIMBER SALE VERIFICATION OF WORKER'S DISABILITY COMPENSATION ACT COMPLIANCE

As required by Act 317, P.A. 1969 (Worker's Compensation) and
Part 5 of Act 451 of 1994, as amended.

VERIFICATION OF WORKER'S DISABILITY COMPENSATION ACT COMPLIANCE

- This verification must be completed and submitted within 21 days of contract award and prior to the issuance of the timber sale contract.
- In addition, if boxes 2B or 2C are checked, then Notice of Exclusion or Certificate of Insurance must be submitted within twenty-one (21) days of the contract award and prior to the issuance of the timber sale contract.
- All information must be typed or printed except for written signatures.

Please Check Appropriate Categories:

1. My business is organized as (you **must** check one of the boxes below):
 - A. Sole Proprietorship (individual)
 - B. Partnership
 - C. Corporation
2. You **must** check one of the boxes below:
 - A. I certify my business is a sole proprietorship and it has no employees but the sole proprietor. I am not subject to the Worker's Compensation Laws.
 - B. I certify my business has satisfied its obligation to the Worker's Compensation Act through the use of an approved Notice of Exclusion (BWC-337, Rev. 5/96). I will provide a copy of the Notice of Exclusion within 21 days of the contract award. (For questions or a copy of the BWC-337, please call the Worker's Compensation Bureau at 517 -322-1195).
 - C. I certify my business has a Worker's Compensation Policy. I will provide an original Certificate of Insurance within twenty-one (21) days of the contract award.
3. If you have checked item 2(A) or 2(B), you **must** indicate the number of **both** full-time and part-time employees, other than yourself, including family members and active partners (if none, you must enter "0").

_____ Full-time Employees

_____ Part-time Employees

Name of Business		Federal ID (or) Social Security No.	
Address		Telephone ()	
City	State	ZIP	

I hereby certify that the above information is true and correct. I agree to notify the Michigan DNR of any changes that occur in factors affecting my coverage during any of my present and future operations.

Signature of Owner or Authorized Representative

Title

Date

Please complete the "SEALED BID" information on the next page