



**DEPARTMENT OF NATURAL RESOURCES
STATE OF MICHIGAN
TIMBER SALE PROSPECTUS #7787**

SCHEDULED SALE DATE AND TIME: 4:00 p.m. (local time) on May 14, 2026.

LOCATION: TRAVERSE CITY MGMT UNIT, 2122 M 37 SOUTH, TRAVERSE CITY, MI 49685.

PROSPECTUS NOTE: The bidder is advised to inspect the sale area and review the location, estimated volumes, operating costs and contract terms of proposed sales. Please be aware that some landowners may request 60 days or more notice for access across their land.

Notice is hereby given that bids will be received by the Unit Manager, TRAVERSE CITY MANAGEMENT UNIT, for certain timber on the following described lands:

Kinney Creek Overlook (61-047-25) / T26N, R13W, SEC. 20, N1/2NE, SENE, SESW, SE.

T26N, R13W, SEC. 21, SWNW.

T26N, R13W, SEC. 29, NESE.

Benzie County, Advertised Price \$108,398.15, 129.8 Acres, Aspen, White Pine.

Carmean Corridor Cut (61-048-25) / T26N, R13W, SEC. 19, NENE, NWSE.

T26N, R13W, SEC. 20, S1/2NW, N1/2SW.

T26N, R13W, SEC. 30, N1/2NE.

Benzie County, Advertised Price \$45,106.75, 106.1 Acres, Aspen, White Pine.

SALE NOTE: Prospective purchasers who need the link for the tree list cruise data must contact the forester.

A recreation site such as a trail, pathway, or campground is within the sale area or the vicinity. Certain restrictions/specifications may be applicable including time restrictions.

BID INSTRUCTIONS (VER. 10/10/2022):

1. Scheduled Bid Location, Date, and Time (2/11)

Bids must be received by the Unit Manager, TRAVERSE CITY OFFICE, 2122 M 37 South, Traverse City, MI 49685, no later than 4:00 p.m. (local time) on May 14, 2026. For further information concerning this sale, contact Matthew Edison at 906-291-0095.

2. Bidder's Qualifications (10/22)

If all or part of a timber sale was prepared by a private contractor, the contractor and that contractor's company are not permitted to bid on the timber sale. A person must be 18 years of age or older to purchase timber. Permanent employees of the Department of Natural Resources or members of their immediate household may not bid. Former employees, in the permanent or seasonal class, may not bid until 3 months after the last day of active duty. Bids will not be accepted from individuals or companies appearing on the DNR/FRD No-Bid List. This list contains the names of purchasers who previously failed to execute a contract within 21-days or who have a history of poor performance.

3. Preparation of Sealed Bids (5/16)

Bid Forms may be completed online thru Michigan DNR Timber Sale Online Bidding (OLB) at www.michigan.gov/timberbidding or by completing the hardcopy Bid Form found in the Timber Sale Prospectus. Hardcopy Bid Forms shall be manually signed in ink. Registration in OLB is considered your 'signature' for all bids submitted thru that system. Bid prices must be entered for each species and product in the Bid Price column for all material subject to bidding and all fill-in blanks must be completed. If erasures or other changes appear on the hardcopy Bid Form, each erasure or change must be initialed by the person signing the bid.

4. Submission of Sealed Bids (5/16)

Bid forms may be obtained from the Unit Manager or thru OLB. Bids may be submitted hardcopy or thru OLB. All hardcopy bids must be submitted on the bid form and in an envelope clearly identified as described in this section. NOTE: Only one bid form per bid envelope. Sealed bids must be submitted to the Unit office designated in the prospectus and must be submitted at or prior to the time established in the prospectus. The envelope should show on the outside (a) the sale name or number and (b) the date and time of bid opening, as shown in the prospectus. Bids received after the time specified in the sale prospectus are late bids and will be rejected.

It is possible for a bidder to submit multiple bids on a single sale. For example, a bid may be submitted hardcopy and a bid may be submitted thru OLB. Or, two bidders from the same company could both submit bids on the same sale. If this were to happen, the State would accept all bids received and award the contract accordingly. All bidding and contractual requirements would apply to all bids received.

5. Public Opening of Sealed Bids (7/16)

If conditions permit, the sealed bids will be publicly opened and posted at the time and place set in the prospectus.

If a bidder, present at a bid opening, has submitted bids on more than one sale, that bidder may withdraw their unopened bid envelopes or announce the withdrawal of their online bid after being declared the successful bidder on one sale.

6. Award of Contract (1/11)

Award of the contract will be made to the Bidder whose bid, conforming to the prospectus, is most advantageous to the State of Michigan on the basis of total value at rates bid for the estimated quantities. The State reserves the right to reject any bid or waive any minor irregularity in bids received. A written award mailed (or otherwise furnished) to the successful Bidder shall be deemed to result in a binding contract without further action by either party.

7. Down Payment (1/11)

The Bidder to whom award is made must make a down payment within 21 days of the sale award. The amount of the down payment will be calculated as shown in the Bond and Payment Schedule of this prospectus. Only cash may be used to meet this requirement.

8. Performance Security (1/11)

As guarantee of faithful performance, a cash bond, certificate of deposit, surety bond or irrevocable letter of credit (LOC) is required within 21 days of the sale award. The amount of the performance security is shown in the Bond and

Payment Schedule of this prospectus. If an LOC or surety is used, the coverage must extend for at least 6 months beyond the contract expiration.

9. Worker's Compensation (10/22)

Purchaser shall obtain worker's compensation insurance to cover claims under Michigan's Worker's Disability Compensation Act of 1969 or similar employee benefit act of any other state applicable to an employee. Verification of Worker's Disability Compensation Act Compliance must be completed and submitted within 21 days of contract award and prior to the issuance of the timber sale contract. In addition, if applicable, Notice of Exclusion or Certificate of Insurance must also be submitted.

10. Timber Sale Contract (10/22)

Additional conditions and requirements common to all timber sales are listed on the timber sale contract (R4031) and are available on line at www.michigan.gov/timber. Contact the Unit Manager for additional information or a sample contract. Within 21 days of the date of the award letter, the bidder must sign the contract and provide the required down payment, performance security, and verification of worker's disability compensation. The down payment and performance security shall be in accordance with the provisions of the timber sale contract, in the sums stated in this prospectus. If these actions are not taken, then the Bidder, the Bidder's corporation, and the corporation's principals may not be permitted to bid on State timber sales for a period of 3 months after the first offense, 6 months after the second offense, and 1 year after the third offense. An offense will only be counted against the Bidder for 5 years. In addition, the Bidder certifies that if awarded this contract, the Bidder will complete the timber sale contract in accordance with its terms and any modifications thereof including requirements to purchase, cut, and remove the included timber by the expiration date.

Payment Unit values in the State Forest Timber Sale Contract are calculated based on the advertised value of the Payment Unit as a percentage of the total advertised value of the contract. The advertised value of each Payment Unit is given in the Description of Timber by Payment Unit table on the Timber Sale Information page. For example, if the value of Payment Unit 1 is advertised as \$1,500 and the total Timber Sale value is advertised as \$10,000, the contract price for Payment Unit 1 will be 15% of the total bid price ($\$1,500/\$10,000 * 100$).

11. Disclaimer of Estimates and Bidder's Warranty of Inspection (10/22)

Before submitting this bid, the Bidder is advised and cautioned to inspect the sale area, review the requirements of the sale contract, and take other steps as may be reasonably necessary to ascertain the location, estimated volumes, construction estimates, and operating costs of the proposed sale. Failure to do so will not relieve the Bidder from responsibility for completing the contract.

The Bidder warrants that this bid is submitted solely on the basis of the Bidder's examination and inspection of the quality and quantity of the timber offered for sale and the Bidder's opinion of the value thereof and the costs of recovery. No reliance should be placed on the State of Michigan's estimates of timber quality, quantity or costs of recovery. Bidder further acknowledges that the State of Michigan: (i) expressly disclaims any warranty of fitness of timber for any purpose; (ii) offers this timber as is without any warranty of quality (merchantability) or quantity and (iii) expressly disclaims any warranty as to the quantity or quality of timber sold.

12. Certification and Chain-of-Custody (10/22)

Unless otherwise indicated in the contract under section 7 – Other Conditions of the Sale Specific Conditions & Requirements, the area encompassed by this timber sale is certified to the standards of the Forest Stewardship Council (FSC) - Certificate #SCS-FM/COC-00090N and the Sustainable Forestry Initiative (SFI) - Certificate #NSF-SFIS-5Y031-SF5. Forest products from this sale may be delivered to the mill as "FSC 100% and / or SFI certified" as long as the contractor hauling the forest products is chain-of-custody (COC) certified or covered under a COC certificate from the destination mill. The purchaser is responsible for maintaining COC after leaving the sale area.

13. Good Neighbor Authority (GNA) Requirements (10/22)

If the name of this timber sales contains the acronym GNA, it is authorized by the Good Neighbor Authority (GNA) and covered by various agreements between the U.S. Forest Service and the State. The timber sale occurs on federal land and the following conditions apply:

GNA contracts on US Forest Service land will not be awarded to purchasers on the Federal list of excluded parties. The System for Award Management (SAM) will be checked for active excluded parties prior to award of contract. In

addition, the Bidder to whom award is made must complete an Assurance Regarding Felony Conviction or Tax Delinquent Status for Corporate Applicants (AD-3031).

14. Good Neighbor Authority (GNA) Requirements, con't (10/22)

Bidder certifies, by signing this bid form, that to the best of Bidder's knowledge that the following representations are accurate and complete.

- a. That the Bidder and its principals are not presently debarred, suspended, proposed for debarment, declared ineligible, or voluntary excluded from timber sales (covered transactions) by any Federal department or agency.
- b. That the Bidder and its principals have not within a 3-year period preceding this bid been convicted of or had a civil judgment rendered against them for commission of fraud or a criminal offense in connection with obtaining , attempting to obtain, or performing a public (Federal, State, or local) transaction or contract under a public transaction; violation of Federal or State antitrust statutes or commission of embezzlement, theft, forgery, bribery, falsification or destruction of records, making false statements, or receiving stolen property.
- c. That the Bidder and its principals are not presently indicted for or otherwise criminally or civilly charged by a governmental entity (Federal, State, or local) with commission of any of the offenses enumerated in paragraph b of this certification.
- d. That the Bidder and its principals have not within a 3-year period preceding this bid had one or more public transactions (Federal, State, or local) terminated for breach or default of a timber or forest product contract.

Bidders that cannot certify this requirement, in whole or in part, shall submit an explanation with their bid.

Scott Bowen
Director

TIMBER SALE INFORMATION

Kinney Creek Overlook (61-047-25)
T26N, R13W, SEC. 20; T26N, R13W, SEC. 21; T26N, R13W, SEC. 29.
Benzie County (Advertised Price \$108,398.15)

A timber sale contract for this lump sum, sealed bid timber sale will be awarded to the responsible bidder offering the highest sealed bid price. All units of volume listed below were estimated using the Inventory Manager computer program and the new Michigan taper model. Bids must be at or above the following advertised price for each product and species:

<u>PRODUCTS & SPECIES</u>	<u>ESTIMATED UNITS*</u>	<u>ADVERTISED PRICE</u>
Sawtimber		
Mixed Aspen	198.0 MBF	\$ 119.00 / MBF
Red Maple	28.1 MBF	\$ 100.00 / MBF
Red Oak	24.5 MBF	\$ 144.00 / MBF
Sugar Maple	5.4 MBF	\$ 167.00 / MBF
White Pine	89.1 MBF	\$ 84.00 / MBF
Pulpwood		
Black Cherry	60 Cords	\$ 16.65 / Cord
Mixed Aspen	2,053 Cords	\$ 24.75 / Cord
Red Maple	258 Cords	\$ 16.65 / Cord
Red Oak	30 Cords	\$ 30.55 / Cord
Sugar Maple	86 Cords	\$ 16.65 / Cord
White Pine	427 Cords	\$ 27.30 / Cord

* The total volume is statistically estimated within plus (+) or minus (-) 13.68 percent. There are an estimated 3,722 cords on this timber sale, plus or minus 509 cords at the 95% confidence level. The estimated units are final and not subject to adjustment. Prospective bidders are urged to examine this timber and to make their own estimates of quantity and quality.

BOND AND PAYMENT SCHEDULE:

1. A bond in the amount of \$5,420.00 to insure faithful performance of the conditions of the contract will be deposited by the successful bidder within 21 days of the sale award.
2. Cutting in any sale or unit without the required advance payment would be considered a trespass.
3. Total payment must be paid in advance or according to the following schedule :
 - (a) Ten percent (10%) of the sale value must be paid within 21 days of the sale award.
 - (b) The 10% down payment will be credited towards the first unit cut.
 - (c) Payment for each of the following units must be made before cutting begins in that unit:

PAYMENT UNIT NUMBER	PERCENT OF TOTAL SALE VALUE
01	15.9%
02	23.7%
03	30.6%
04	29.8%
4. If no cutting takes place, the 10% down payment will not be refunded.
5. Operations on the contract issued will terminate on 06/30/2029.

SALE STATISTICS

Volumes were calculated in cubic feet using the Michigan taper model. Cubic foot volume includes all wood inside bark for the product indicated. For display purposes, cubic feet were converted to cords and MBF using a simple conversion factor, e.g. 79 cubic feet per cord and 185 cubic feet per MBF. The cubic foot volumes are precise; the cords and MBF volumes are not. Cubic foot volume cannot be directly converted to cords or boards with precision.

SALE VOLUMES

The total estimated sale volume may not equal the sum of the species/products due to the nature of statistical calculations associated with double sampling methodology.

VOLUME		STATISTICAL RANGE IN CORDS		
TOTAL CUBIC FEET	TOTAL CORDS	PERCENT ERROR	MINIMUM	MAXIMUM
294,014	3,722	13.68%	3,212	4,231

VDU VOLUMES

A VDU is a Volume Determination Unit. Volumes and their associated statistics are calculated at the VDU level and summarized to the sale level. There is often a one to one relationship between a VDU and a Payment Unit, but not always, depending on the cruise design. Refer to the VDU TO PAYMENT UNIT table.

VDU	VOLUME		PERCENT ERROR	RANGE IN CORDS	
	TOTAL CUBIC FEET	TOTAL CORDS		MINIMUM	MAXIMUM
45	53,756	680	31.81%	464	897
55	71,243	902	30.71%	625	1,179
56	91,495	1,158	25.70%	860	1,456
75	77,520	981	24.33%	742	1,220
TOTAL:	294,014	3,722		2,692	4,752

VDU TO PAYMENT UNIT

When a VDU is associated with more than one Payment Unit (PU), the VDU volumes are assigned to the PU based on acres of the VDU within the PU.

VDU	VDU ACRES	PU	PU ACRES
TOTAL:			

DESCRIPTION OF TIMBER BY PAYMENT UNIT (PU)

PU	MARKET GROUP	PRODUCT	QUANTITY	UNIT	ACRES	ADVERTISE PRICE	
1	Mixed Aspen	Sawtimber	12.3	MBF	19.4	\$17,234.05	
	<i>B. T. Aspen</i>		12.3	<i>MBF</i>			
	Red Maple		13.9	MBF			
	Sugar Maple		5.4	MBF			
	White Pine		13.6	MBF			
	Black Cherry		Pulpwood	50			Cords
	Mixed Aspen			249			Cords
	<i>B. T. Aspen</i>			102			<i>Cords</i>
	<i>Quaking Aspen</i>			147			<i>Cords</i>
	Red Maple			120			Cords
	Sugar Maple			86			Cords
	White Pine			70			Cords
	2			Mixed Aspen			Sawtimber
<i>B. T. Aspen</i>		10.3	<i>MBF</i>				
<i>Quaking Aspen</i>		16.6	<i>MBF</i>				
White Pine		50.7	MBF				
Mixed Aspen		Pulpwood	525	Cords			
<i>B. T. Aspen</i>			284	<i>Cords</i>			
<i>Quaking Aspen</i>			241	<i>Cords</i>			
Red Maple			13	Cords			
White Pine			183	Cords			
3	Mixed Aspen	Sawtimber	63.3	MBF	47.6	\$33,207.10	
	<i>B. T. Aspen</i>		63.3	<i>MBF</i>			
	Red Maple		3.1	MBF			
	White Pine		22.0	MBF			
	Black Cherry		Pulpwood	10			Cords
	Mixed Aspen			748			Cords
	<i>B. T. Aspen</i>			714			<i>Cords</i>
	<i>Quaking Aspen</i>			34			<i>Cords</i>
	Red Maple			38			Cords
White Pine	154	Cords					
4	Mixed Aspen	Sawtimber	95.5	MBF	24.9	\$32,291.00	
	<i>B. T. Aspen</i>		95.5	<i>MBF</i>			
	Red Maple		11.1	MBF			
	Red Oak		24.5	MBF			
	White Pine		2.8	MBF			
	Mixed Aspen		Pulpwood	531			Cords
	<i>B. T. Aspen</i>			531			<i>Cords</i>
	Red Maple			87			Cords
	Red Oak			30			Cords
	White Pine			20			Cords
TOTAL:			345.1	MBF			
TOTAL:			2,914	Cords			

Sale Specific Conditions & Requirements

Sale Name: Kinney Creek Overlook

Sale Number: 61-047-25 Seq#: 1

1 - Sale Area

1.2 - Boundaries

1.2.1 - Painted Boundaries (9/19)

The sale boundary and Payment Unit boundaries are marked and identified by blue and red paint. Also, Hulbert road serves as east boundary for units 1, 2, and 3 in some portions. Turtle lake road and Cinder road also serve as a sale boundary in some portions for unit 4 (see map). Exterior sale boundary lines against private property are marked with blue paint. Exterior sale boundary lines against state are marked with red paint. Retention patches are marked with red paint; no harvesting activities may occur within these areas. The painted boundary line trees are not Included Timber and are to be protected.

2 - Timber Specifications

2.1 - Included Timber

2.1.7 - Leave Tree Marked Unit(s) (6/14)

Within Payment Unit(s) 1, 2, and 3, all aspen, maple, white pine and cherry trees that are two (2) inches or more at DBH are designated for cutting, EXCEPT trees marked with green paint above and below stump height. Also, protect sub-merchantable white pine from damage as much as possible. Within Payment Unit 4, all aspen, maple, cherry and red oak trees regardless of merchantability are designated for cutting, EXCEPT trees marked with green paint above and below stump height.

2.2 - Utilization

2.2.3 - Stump Heights (12/24)

Stump heights within the Sale Area shall not exceed 12 inches for trees greater than 10 inches at DBH and four (4) inches for trees smaller than 10 inches at DBH.

2.2.9 - No Chipping Permitted (12/08)

Within Payment Unit(s) 1, 3, 4, all wood must be removed by, tree segment, or roundwood. No chipping is permitted. tops may not be chipped.

2.2.10 - No Chipping Tops and Limbs (8/16)

Within Payment Unit(s) 2, chipping of the bole, two (2) inches in diameter or greater, is allowed. Chipping of limbs or portions of the tree less than two (2) inches in diameter is not permitted. Limbs and the remaining top must be left on site and scattered.

4 - Transportation

4.1 - Construction

4.1.3 - Slash and Earthen Piles (8/04)

Piles or windrows of earth along roads and landings that have been widened or constructed shall be leveled. Slash from road maintenance or construction, including stumps, shall be dispersed throughout the sale area as determined by the DNR sale administrator.

4.1.12 - No New Roads (1/12)

No new roads will be permitted in any Payment Unit. All operations are limited to existing roads. Only Skid trails will be allowed.

5 - Operations

5.2 - Conduct of Operations

5.2.1 - Slash

5.2.1.8 - Slash Height (12/08)

No slash or tree tops may exceed 24 inches in height.

5.2.3 - Operating Restrictions

5.2.3.4 - Oak Wilt Restriction, No Exceptions (1/18)

Within Payment Units 1-4, cutting, skidding, hauling within the sale and brushing of access roads to the sale are not permitted during the period of April 15 to July 15. No exceptions will be granted. This is necessary to reduce the spread of oak wilt.

5.2.4 - Dead and Down Creation

5.2.4.4 - Dead and Down Creation, Grouse (6/18)

To encourage grouse and other wildlife, in Payment Unit(s) 1-4, leave one 12" or larger diameter (or largest diameter trees within stand) whole tree on the ground for every two (2) acres, preferably of maple or white pine. These trees should be evenly scattered throughout the Payment Unit, preferably at least two chains from any roads, two-tracks, or trails open to vehicles. This can be an unmerchantable piece or a full tree.

5.2.38 - No Decking Against Live Trees (2/04)

Cut products may not be decked against unmarked or designated leave trees.



TIMBER SALE MAP

This information provided by authority of Part 525, 1994 PA 451, as amended.

Sale Number 61-047-25	Date 02/09/2026
Scale 1:15,840	Page 1
	Of 1

Forest Management Unit Traverse City Mgt Unit	County Benzie	Mapped By: Craig Allen
		Cruised By: Allen, Ventmiglia, Cotant

Township 26N	Range 13W	Section(s) and Subdivision(s) Sec. 20 N1/2NE,SENE,SESW,SE; Sec. 21 SWNW; Sec. 29 NESE;
-----------------	--------------	--

Cover Type			
A = Aspen	J = Jack Pine	O = Oak	U = Upland Brush
B = Paper Birch	K = Rock	P = Lowland Poplar	UM = Upland Mix Forest
C = Cedar	L = Lowland Brush	Q = Mixed Swamp Conifer	V = Bog or Marsh
D = Treed Bog	LM = Lowland Mix Forest	R = Red Pine	W = White Pine
E = Swamp Hardwoods	M = Maple, Beech, Birch	S = Black Spruce	X = Non Stocked
F = Spruce/Fir	MC = Mixed Conifer	T = Tamarack	Y = Sand
G = Grass	MD = Mixed Deciduous	Z = Water	
H = Hemlock	N = Marsh		

Density	
0 = Non Stocked	5 = Pole Timber Medium
1 = Seedling Sapling Poor	6 = Pole Timber Well
2 = Seedling Sapling Medium	7 = Saw Timber Poor
3 = Seedling Sapling Well	8 = Saw Timber Medium
4 = Pole Timber Poor	9 = Saw Timber Well

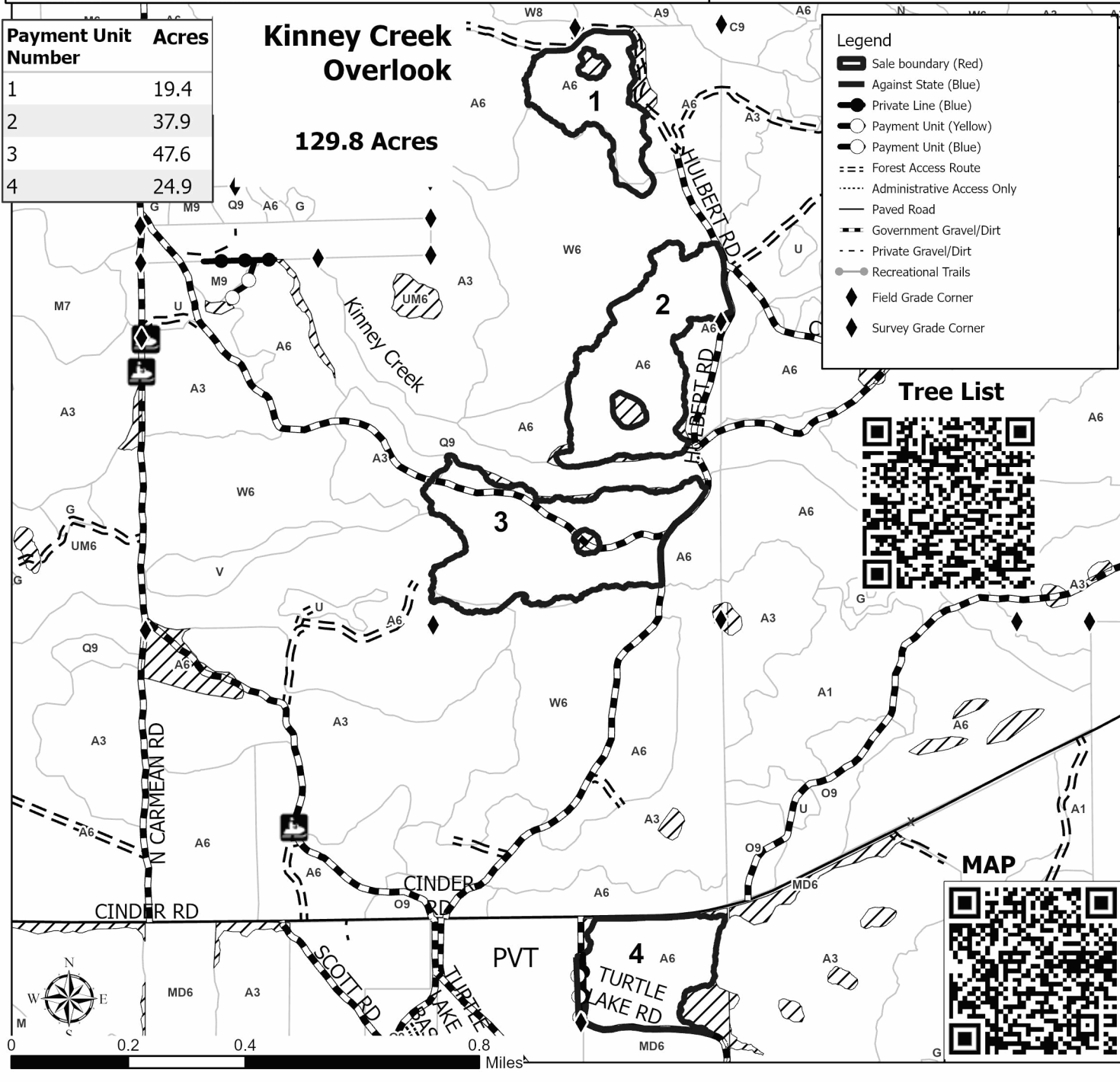

TIMBER SALE INFORMATION

Carmean Corridor Cut (61-048-25)

T26N, R13W, SEC. 19; T26N, R13W, SEC. 20; T26N, R13W, SEC. 30.
Benzie County (Advertised Price \$45,106.75)

SALE NOTE: Prospective purchasers who need the link for the tree list cruise data must contact the forester.

A recreation site such as a trail, pathway, or campground is within the sale area or the vicinity. Certain restrictions/specifications may be applicable including time restrictions.

A timber sale contract for this lump sum, sealed bid timber sale will be awarded to the responsible bidder offering the highest sealed bid price. All units of volume listed below were estimated using the Inventory Manager computer program and the new Michigan taper model. Bids must be at or above the following advertised price for each product and species:

<u>PRODUCTS & SPECIES</u>	<u>ESTIMATED UNITS*</u>	<u>ADVERTISED PRICE</u>
Sawtimber		
Basswood	10.9 MBF	\$ 88.00 / MBF
Beech	0.8 MBF	\$ 142.00 / MBF
Black Cherry	1.0 MBF	\$ 127.00 / MBF
Mixed Aspen	96.6 MBF	\$ 119.00 / MBF
Red Maple	24.0 MBF	\$ 100.00 / MBF
White Pine	47.1 MBF	\$ 84.00 / MBF
Pulpwood		
Mixed Aspen	631 Cords	\$ 24.75 / Cord
Mixed Hardwood	79 Cords	\$ 16.65 / Cord
Red Maple	97 Cords	\$ 16.65 / Cord
White Pine	275 Cords	\$ 27.30 / Cord

* The total volume is statistically estimated within plus (+) or minus (-) 21.28 percent. There are an estimated 1,504 cords on this timber sale, plus or minus 320 cords at the 95% confidence level. The estimated units are final and not subject to adjustment. Prospective bidders are urged to examine this timber and to make their own estimates of quantity and quality.

BOND AND PAYMENT SCHEDULE:

1. A bond in the amount of \$2,255.00 to insure faithful performance of the conditions of the contract will be deposited by the successful bidder within 21 days of the sale award.
2. Cutting in any sale or unit without the required advance payment would be considered a trespass.
3. Total payment must be paid in advance or according to the following schedule :
 - (a) Ten percent (10%) of the sale value must be paid within 21 days of the sale award.
 - (b) The 10% down payment will be credited towards the first unit cut.
 - (c) Payment for each of the following units must be made before cutting begins in that unit:

PAYMENT UNIT NUMBER	PERCENT OF TOTAL SALE VALUE
01	0.6%
02	3.0%
03	31.2%
04	34.0%
05	31.2%

4. If no cutting takes place, the 10% down payment will not be refunded.
5. Operations on the contract issued will terminate on 06/30/2029.

SALE STATISTICS

Volumes were calculated in cubic feet using the Michigan taper model. Cubic foot volume includes all wood inside bark for the product indicated. For display purposes, cubic feet were converted to cords and MBF using a simple conversion factor, e.g. 79 cubic feet per cord and 185 cubic feet per MBF. The cubic foot volumes are precise; the cords and MBF volumes are not. Cubic foot volume cannot be directly converted to cords or boards with precision.

SALE VOLUMES

The total estimated sale volume may not equal the sum of the species/products due to the nature of statistical calculations associated with double sampling methodology.

VOLUME			STATISTICAL RANGE IN CORDS	
TOTAL CUBIC FEET	TOTAL CORDS	PERCENT ERROR	MINIMUM	MAXIMUM
118,845	1,504	21.28%	1,184	1,825

VDU VOLUMES

A VDU is a Volume Determination Unit. Volumes and their associated statistics are calculated at the VDU level and summarized to the sale level. There is often a one to one relationship between a VDU and a Payment Unit, but not always, depending on the cruise design. Refer to the VDU TO PAYMENT UNIT table.

	VOLUME			RANGE IN CORDS	
VDU	TOTAL CUBIC FEET	TOTAL CORDS	PERCENT ERROR	MINIMUM	MAXIMUM
12	1,309	17	69.64%	5	28
19	3,952	50	79.12%	10	90
22	77,305	979	24.31%	741	1,216
24	36,279	459	47.50%	241	677
TOTAL:	118,845	1,504		997	2,011

VDU TO PAYMENT UNIT

When a VDU is associated with more than one Payment Unit (PU), the VDU volumes are assigned to the PU based on acres of the VDU within the PU.

VDU	VDU ACRES	PU	PU ACRES
TOTAL:			

DESCRIPTION OF TIMBER BY PAYMENT UNIT (PU)

PU	MARKET GROUP	PRODUCT	QUANTITY	UNIT	ACRES	ADVERTISE PRICE
1	Mixed Hardwood <i>Black Cherry</i>	Pulpwood	17	Cords	24.0	\$283.05
			17	<i>Cords</i>		
2	Beech Red Maple Mixed Hardwood <i>Beech</i> <i>Black Cherry</i> Red Maple	Sawtimber	0.8	MBF	3.3	\$1,359.75
			7.3	MBF		
			7	Cords		
		4	<i>Cords</i>			
		3	<i>Cords</i>			
		24	Cords			
3	Mixed Aspen <i>B. T. Aspen</i> Red Maple White Pine Mixed Aspen <i>B. T. Aspen</i> <i>Quaking Aspen</i> Mixed Hardwood <i>Black Cherry</i> Red Maple White Pine	Sawtimber	34.1	MBF	20.3	\$14,068.25
			34.1	<i>MBF</i>		
			2.2	MBF		
			14.8	MBF		
			219	Cords		
		104	<i>Cords</i>			
		115	<i>Cords</i>			
		10	Cords			
		10	<i>Cords</i>			
		4	Cords			
		106	Cords			
4	Basswood Black Cherry Mixed Aspen <i>Quaking Aspen</i> Red Maple White Pine Mixed Aspen <i>Quaking Aspen</i> Mixed Hardwood <i>Basswood</i> <i>Black Cherry</i> Red Maple White Pine	Sawtimber	5.7	MBF	30.5	\$15,338.35
			0.5	MBF		
			32.6	MBF		
			32.6	<i>MBF</i>		
			7.6	MBF		
			16.8	MBF		
		215	Cords			
		215	<i>Cords</i>			
		24	Cords			
		8	<i>Cords</i>			
		16	<i>Cords</i>			
		36	Cords			
88	Cords					
5	Basswood Black Cherry Mixed Aspen <i>Quaking Aspen</i> Red Maple White Pine Mixed Aspen <i>Quaking Aspen</i> Mixed Hardwood <i>Basswood</i> <i>Black Cherry</i> Red Maple White Pine	Sawtimber	5.2	MBF	28.0	\$14,057.35
			0.5	MBF		
			29.9	MBF		
			29.9	<i>MBF</i>		
			6.9	MBF		
			15.5	MBF		
		197	Cords			
		197	<i>Cords</i>			
		21	Cords			
		7	<i>Cords</i>			
		14	<i>Cords</i>			
		33	Cords			
81	Cords					
TOTAL:			180.4	MBF		
TOTAL:			1,082	Cords		

Sale Specific Conditions & Requirements

Sale Name: Carmean Corridor Cut

Sale Number: 61-048-25 Seq#: 1

1 - Sale Area

1.2 - Boundaries

1.2.1 - Painted Boundaries (9/19)

The sale boundary and Payment Unit boundaries are marked and identified by blue, red paint. Exterior sale boundary lines against private property are marked with blue paint. Exterior sale boundary lines against state are marked with red paint. Also, the forest road that divides unit 4 and 5 is the Payment Unit boundary. Retention patches are marked with red paint; no harvesting activities may occur within these areas. The painted boundary line trees are not Included Timber and are to be protected. Also, Carmean road is the east boundary for unit 1, 4 and 5. Brownell road is the north boundary of unit 1. See map.

2 - Timber Specifications

2.1 - Included Timber

2.1.3 - Cut Tree Marked Unit(s) (12/08)

Within Payment Unit(s) 2, all trees are designated for cutting when marked with orange paint above and below stump height, regardless of merchantability.

2.1.7 - Leave Tree Marked Unit(s) (6/14)

Within Payment Unit(s) 1, all trees are designated for cutting regardless of merchantability EXCEPT trees marked with green paint above and below stump height. Within Payment Units 3 cut all aspen, maple, white pine and cherry trees that are two (2) inches or more at DBH are designated for cutting, EXCEPT trees marked with green paint above and below stump height. Also, protect sub-merchantable white pine from damage as much as possible. Within Payment Unit 4 and 5 cut all aspen, maple, basswood and cherry. Also, cut all white pine 4.6 inch DBH to 20 inch DBH. Protect sub-merchantable (less than 4.6 inch DBH) white pine from damage as much as possible. Within Payment unit 4 and 5 do not cut any trees marked with green paint above and below stump height.

2.2 - Utilization

2.2.2 - Chipping Required (12/24)

Payment Unit 1 must be chip harvested to facilitate subsequent planting operations. Products may be produced as roundwood and forwarded to decking areas in final product length, but the tops must be left intact and skidded to the landing for chipping in order to minimize the amount of residual slash. The requirement to retain approximately 1/6 to 1/3 of treetops and limbs less than four (4) inches in diameter does not apply (G. C. & R. 2.2). This is because the area will be trenched and planted.

2.2.3 - Stump Heights (12/24)

Stump heights within the Sale Area shall not exceed 12 inches for trees greater than 10 inches at DBH and four (4) inches for trees smaller than 10 inches at DBH.

2.2.11 - Chipping Restriction (9/14)

If chipping occurs on this sale, then no woody debris present on the ground at the start of the sale may be chipped. In addition, brush or chips may not be stored or stockpiled on site for more than 30 days.

4 - Transportation

4.1 - Construction

4.1.3 - Slash and Earthen Piles (8/04)

Piles or windrows of earth along roads and landings that have been widened or constructed shall be leveled. Slash from road maintenance or construction, including stumps, shall be dispersed throughout the sale area as determined by the DNR sale administrator.

4.1.12 - No New Roads (1/12)

No new roads will be permitted in any Payment Unit. . All operations are limited to existing roads. Only Skid trails will be

allowed.

5 - Operations

5.2 - Conduct of Operations

5.2.1 - Slash

5.2.1.8 - Slash Height (12/08)

No slash or tree tops may exceed 24 inches in height.

5.2.3 - Operating Restrictions

5.2.3.4 - Oak Wilt Restriction, No Exceptions (1/18)

Within Payment Units 2, 3, 4, and 5 cutting, skidding, hauling within the sale and brushing of access roads to the sale are not permitted during the period of April 15 to July 15. No exceptions will be granted. This is necessary to reduce the spread of oak wilt.

5.2.4 - Dead and Down Creation

5.2.4.4 - Dead and Down Creation, Grouse (6/18)

To encourage grouse and other wildlife, in Payment Unit(s) 3, 4 and 5 leave one 12" or larger diameter (or largest diameter trees within stand) whole tree on the ground for every two (2) acres, preferably of maple or white pine. These trees will be evenly scattered throughout the Payment Unit, preferably at least two chains from any roads, two-tracks, or trails open to vehicles. This can be an unmerchantable piece or a full tree.

5.2.31 - Landing Locations (9/13)

Landing areas are marked on the Timber Sale Map with the letter "L". Landings must be confined to these designated sites unless otherwise authorized by the Unit Manager or his/her representative.

5.2.38 - No Decking Against Live Trees (2/04)

Cut products may not be decked against unmarked or designated leave trees.

5.2.41 - Snowmobile Trail Protection (9/11)

The Platte River snowmobile trail is shown on the Timber Sale Map. Do not cut or damage posts with orange trail markers or traffic control signs. If the trail is used, it must be maintained and restored to a condition equal to or better than before the sale. The road maintenance/restoration must be done prior to December 1. If the trail is used for hauling, it must be graded to the satisfaction of the Unit Manager or his/her representative prior to December 1. If the trail road is to be used for hauling during the snowmobile season, then a snow-covered base must be left on the trail. All stumps within 20 feet of the snowmobile trail must be cut at ground level.

6 - Safety and Fire Prevention

6.2 - Signing

6.2.2 - Snowmobile Trail Posting (10/20)

The Purchaser is responsible for posting and maintaining caution signs on the Platte River snowmobile trail prior to beginning operations during the snowmobile season (approximately December 1 to March 31). The trail must be posted at appropriate distances from the Sale Area to warn of logging activity and truck traffic. Signs must be removed when harvest operations are suspended or completed. The Purchaser will provide these signs.



TIMBER SALE MAP

This information provided by authority of Part 525, 1994 PA 451, as amended.

Sale Number
61-048-25

Date
09/30/2025

Forest Management Unit	County	Mapped By: Allen
Traverse City Mgt Unit	Benzie	Cruised By: Allen, Ventimiglia, Cotant

Scale	Page	Of
1:15,840	1	1

Township	Range	Section(s) and Subdivision(s)
26N	13W	Sec. 19 NENE,NWSE; Sec. 20 S1/2NW,N1/2SW; Sec. 30 N1/2NE;

Cover Type			
A = Aspen	J = Jack Pine	O = Oak	U = Upland Brush
B = Paper Birch	K = Rock	P = Lowland Poplar	UM = Upland Mix Forest
C = Cedar	L = Lowland Brush	Q = Mixed Swamp Conifer	V = Bog or Marsh
D = Treed Bog	LM = Lowland Mix Forest	R = Red Pine	W = White Pine
E = Swamp Hardwoods	M = Maple, Beech, Birch	S = Black Spruce	X = Non Stocked
F = Spruce/Fir	MC = Mixed Conifer	T = Tamarack	Y = Sand
G = Grass	MD = Mixed Deciduous	Z = Water	
H = Hemlock	N = Marsh		

Density	
0 = Non Stocked	5 = Pole Timber Medium
1 = Seedling Sapling Poor	6 = Pole Timber Well
2 = Seedling Sapling Medium	7 = Saw Timber Poor
3 = Seedling Sapling Well	8 = Saw Timber Medium
4 = Pole Timber Poor	9 = Saw Timber Well

Payment Unit Number	Acres
1	24
2	3.3
3	20.3
4	30.6
5	28

Carmean Corridor Cut

106.1 Acres

Legend	
	Payment Unit
	Private Line (Blue)
	Payment Unit (Yellow)
	Primary Forest Road
	Forest Access Route
	Administrative Access Only
	Paved Road
	Government Gravel/Dirt
	Private Gravel/Dirt
	Recreational Trails
	Field Grade Corner
	Survey Grade Corner

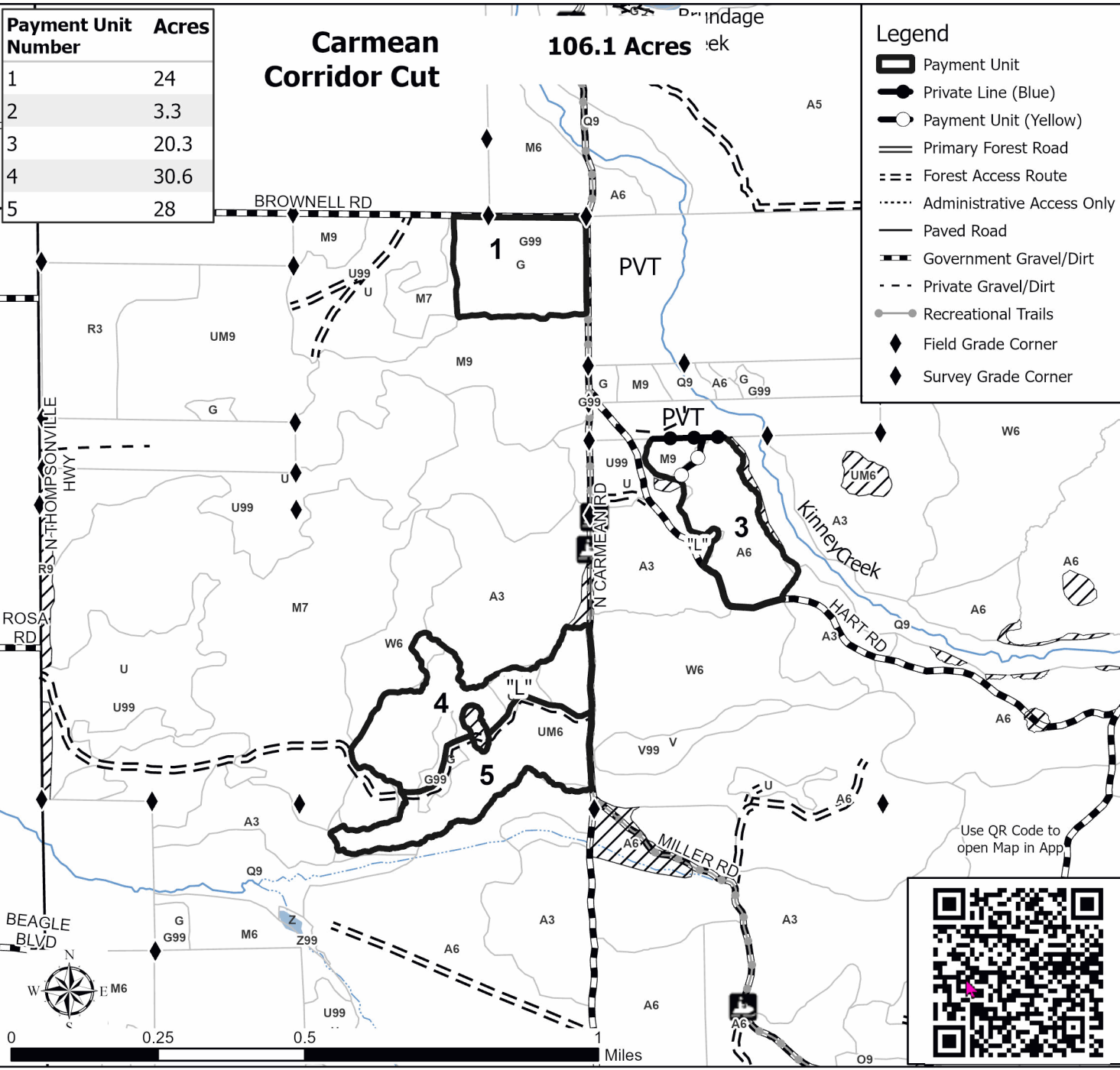

Kinney Creek Overlook (61-047-25)
T26N, R13W, SEC. 20; T26N, R13W, SEC. 21; T26N, R13W, SEC. 29; Benzie

In response to the notice of sale to be held 4:00 p.m. (local time) on May 14, 2026, I am hereby submitting my sealed bid (firm offer) for the following forest products to be cut. Bids for individual species must be at or above the advertised price. All non-responsive bid forms may be rejected.

<u>PRODUCTS & SPECIES</u>	<u>ESTIMATED VOLUME*</u>	<u>ADVERTISED PRICE</u>	<u>BID PRICE/UNIT</u>
Sawtimber			
Mixed Aspen	198.0 MBF	\$ 119.00/MBF	\$ _____
Red Maple	28.1 MBF	\$ 100.00/MBF	\$ _____
Red Oak	24.5 MBF	\$ 144.00/MBF	\$ _____
Sugar Maple	5.4 MBF	\$ 167.00/MBF	\$ _____
White Pine	89.1 MBF	\$ 84.00/MBF	\$ _____
Pulpwood			
Black Cherry	60 Cords	\$ 16.65/Cord	\$ _____
Mixed Aspen	2,053 Cords	\$ 24.75/Cord	\$ _____
Red Maple	258 Cords	\$ 16.65/Cord	\$ _____
Red Oak	30 Cords	\$ 30.55/Cord	\$ _____
Sugar Maple	86 Cords	\$ 16.65/Cord	\$ _____
White Pine	427 Cords	\$ 27.30/Cord	\$ _____

*The volumes are statistically estimated within plus (+) or minus (-) 13.68 percent at 95% confidence level. These estimated volumes are final and not subject to adjustment. Prospective bidders are urged to examine this timber and to make their own estimates of quantity and quality.

I understand that any or all bids may be rejected. All bids must be signed and all bid items must be bid or the bid form may be rejected. I also understand that consideration and awarding a contract will be based upon my past performance and ability to complete the contract based upon equipment and staffing subject to my control.

FEDERAL ID: _____ or SOCIAL SECURITY NUMBER: _____

Company or individual bidding: _____

Company representative's name: _____

Address: _____

City: _____ State: _____ Zip: _____

IF AVAILABLE, PLEASE PLACE THE PERSONALIZED LABEL FROM YOUR PROSPECTUS IN THE ABOVE BOX.

Individual or company representative's signature: _____ Date: _____

Phone number : _____ Email (optional): _____

THE WINNING BIDDER MUST COMPLETE THE VERIFICATION OF WORKER'S DISABILITY COMPENSATION ACT COMPLIANCE (ON REVERSE SIDE IF DOUBLE SIDED) WITHIN 21 DAYS OF SALE AWARD DATE



FOR DEPARTMENT USE ONLY
Sale Number (XX - XXX - XX - XX)
Forest Management Unit:

TIMBER SALE VERIFICATION OF WORKER'S DISABILITY COMPENSATION ACT COMPLIANCE

*As required by Act 317, P.A. 1969 (Worker's Compensation) and
Part 5 of Act 451 of 1994, as amended.*

VERIFICATION OF WORKER'S DISABILITY COMPENSATION ACT COMPLIANCE

- This verification must be completed and submitted within 21 days of contract award and prior to the issuance of the timber sale contract.
- In addition, if boxes 2B or 2C are checked, then Notice of Exclusion or Certificate of Insurance must be submitted within twenty-one (21) days of the contract award and prior to the issuance of the timber sale contract.
- All information must be typed or printed except for written signatures.

Please Check Appropriate Categories:

1. My business is organized as (you **must** check one of the boxes below):
 - A. Sole Proprietorship (individual)
 - B. Partnership
 - C. Corporation

2. You **must** check one of the boxes below:
 - A. I certify my business is a sole proprietorship and it has no employees but the sole proprietor. I am not subject to the Worker's Compensation Laws.
 - B. I certify my business has satisfied its obligation to the Worker's Compensation Act through the use of an approved Notice of Exclusion (BWC-337, Rev. 5/96). I will provide a copy of the Notice of Exclusion within 21 days of the contract award. (For questions or a copy of the BWC-337, please call the Worker's Compensation Bureau at 517-322-1195).
 - C. I certify my business has a Worker's Compensation Policy. I will provide an original Certificate of Insurance within twenty-one (21) days of the contract award.

3. If you have checked item 2(A) or 2(B), you **must** indicate the number of **both** full-time and part-time employees, other than yourself, including family members and active partners (if none, you must enter "0").

_____ Full-time Employees

_____ Part-time Employees

Name of Business		Federal ID (or) Social Security No.	
Address		Telephone ()	
City	State	ZIP	

I hereby certify that the above information is true and correct. I agree to notify the Michigan DNR of any changes that occur in factors affecting my coverage during any of my present and future operations.

Signature of Owner or Authorized Representative

Title

Date

Please complete the "SEALED BID" information on the next page

Carmean Corridor Cut (61-048-25)

T26N, R13W, SEC. 19; T26N, R13W, SEC. 20; T26N, R13W, SEC. 30; Benzie

In response to the notice of sale to be held 4:00 p.m. (local time) on May 14, 2026, I am hereby submitting my sealed bid (firm offer) for the following forest products to be cut. Bids for individual species must be at or above the advertised price. All non-responsive bid forms may be rejected.

<u>PRODUCTS & SPECIES</u>	<u>ESTIMATED VOLUME*</u>	<u>ADVERTISED PRICE</u>	<u>BID PRICE/UNIT</u>
Sawtimber			
Basswood	10.9 MBF	\$ 88.00/MBF	\$ _____
Beech	0.8 MBF	\$ 142.00/MBF	\$ _____
Black Cherry	1.0 MBF	\$ 127.00/MBF	\$ _____
Mixed Aspen	96.6 MBF	\$ 119.00/MBF	\$ _____
Red Maple	24.0 MBF	\$ 100.00/MBF	\$ _____
White Pine	47.1 MBF	\$ 84.00/MBF	\$ _____
Pulpwood			
Mixed Aspen	631 Cords	\$ 24.75/Cord	\$ _____
Mixed Hardwood	79 Cords	\$ 16.65/Cord	\$ _____
Red Maple	97 Cords	\$ 16.65/Cord	\$ _____
White Pine	275 Cords	\$ 27.30/Cord	\$ _____

*The volumes are statistically estimated within plus (+) or minus (-) 21.28 percent at 95% confidence level. These estimated volumes are final and not subject to adjustment. Prospective bidders are urged to examine this timber and to make their own estimates of quantity and quality.

I understand that any or all bids may be rejected. All bids must be signed and all bid items must be bid or the bid form may be rejected. I also understand that consideration and awarding a contract will be based upon my past performance and ability to complete the contract based upon equipment and staffing subject to my control.

FEDERAL ID: _____ or SOCIAL SECURITY NUMBER: _____

Company or individual bidding: _____

Company representative's name: _____

Address: _____

City: _____ State: _____ Zip: _____

IF AVAILABLE, PLEASE PLACE THE PERSONALIZED LABEL FROM YOUR PROSPECTUS IN THE ABOVE BOX.

Individual or company representative's signature: _____ Date: _____

Phone number : _____ Email (optional): _____

THE WINNING BIDDER MUST COMPLETE THE VERIFICATION OF WORKER'S DISABILITY COMPENSATION ACT COMPLIANCE (ON REVERSE SIDE IF DOUBLE SIDED) WITHIN 21 DAYS OF SALE AWARD DATE



FOR DEPARTMENT USE ONLY
Sale Number (XX - XXX - XX - XX)
Forest Management Unit:

TIMBER SALE VERIFICATION OF WORKER'S DISABILITY COMPENSATION ACT COMPLIANCE

*As required by Act 317, P.A. 1969 (Worker's Compensation) and
Part 5 of Act 451 of 1994, as amended.*

VERIFICATION OF WORKER'S DISABILITY COMPENSATION ACT COMPLIANCE

- This verification must be completed and submitted within 21 days of contract award and prior to the issuance of the timber sale contract.
- In addition, if boxes 2B or 2C are checked, then Notice of Exclusion or Certificate of Insurance must be submitted within twenty-one (21) days of the contract award and prior to the issuance of the timber sale contract.
- All information must be typed or printed except for written signatures.

Please Check Appropriate Categories:

1. My business is organized as (you **must** check one of the boxes below):
 - A. Sole Proprietorship (individual)
 - B. Partnership
 - C. Corporation

2. You **must** check one of the boxes below:
 - A. I certify my business is a sole proprietorship and it has no employees but the sole proprietor. I am not subject to the Worker's Compensation Laws.
 - B. I certify my business has satisfied its obligation to the Worker's Compensation Act through the use of an approved Notice of Exclusion (BWC-337, Rev. 5/96). I will provide a copy of the Notice of Exclusion within 21 days of the contract award. (For questions or a copy of the BWC-337, please call the Worker's Compensation Bureau at 517-322-1195).
 - C. I certify my business has a Worker's Compensation Policy. I will provide an original Certificate of Insurance within twenty-one (21) days of the contract award.

3. If you have checked item 2(A) or 2(B), you **must** indicate the number of **both** full-time and part-time employees, other than yourself, including family members and active partners (if none, you must enter "0").

_____ Full-time Employees

_____ Part-time Employees

Name of Business		Federal ID (or) Social Security No.	
Address		Telephone ()	
City	State	ZIP	

I hereby certify that the above information is true and correct. I agree to notify the Michigan DNR of any changes that occur in factors affecting my coverage during any of my present and future operations.

Signature of Owner or Authorized Representative

Title

Date

Please complete the "SEALED BID" information on the next page