

INSTITUTE FOR FISHERIES RESEARCH  
 DIVISION OF FISHERIES MICHIGAN CONSERVATION DEPT.  
 LAKE INVENTORY MAP  
**WHITMARSH LAKE**  
 AREA 10.6 ACRES  
 MARGINAL SURVEY AND SOUNDINGS BY  
 LAKE & STREAM IMPROVEMENT SECTION 12/59  
 CHIPPEWA COUNTY T.45 N., R. 5 W., SEC. 6

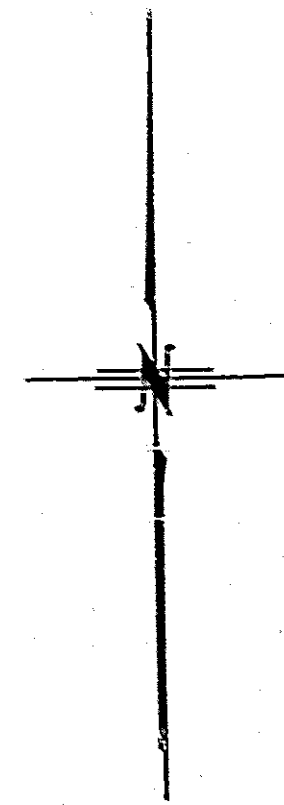

6. M. 1000 G. SPIRE ON BASE OF  
 20" RED PINE  
 WATER SURF. ELEV. = 95.2  
 12/17/53

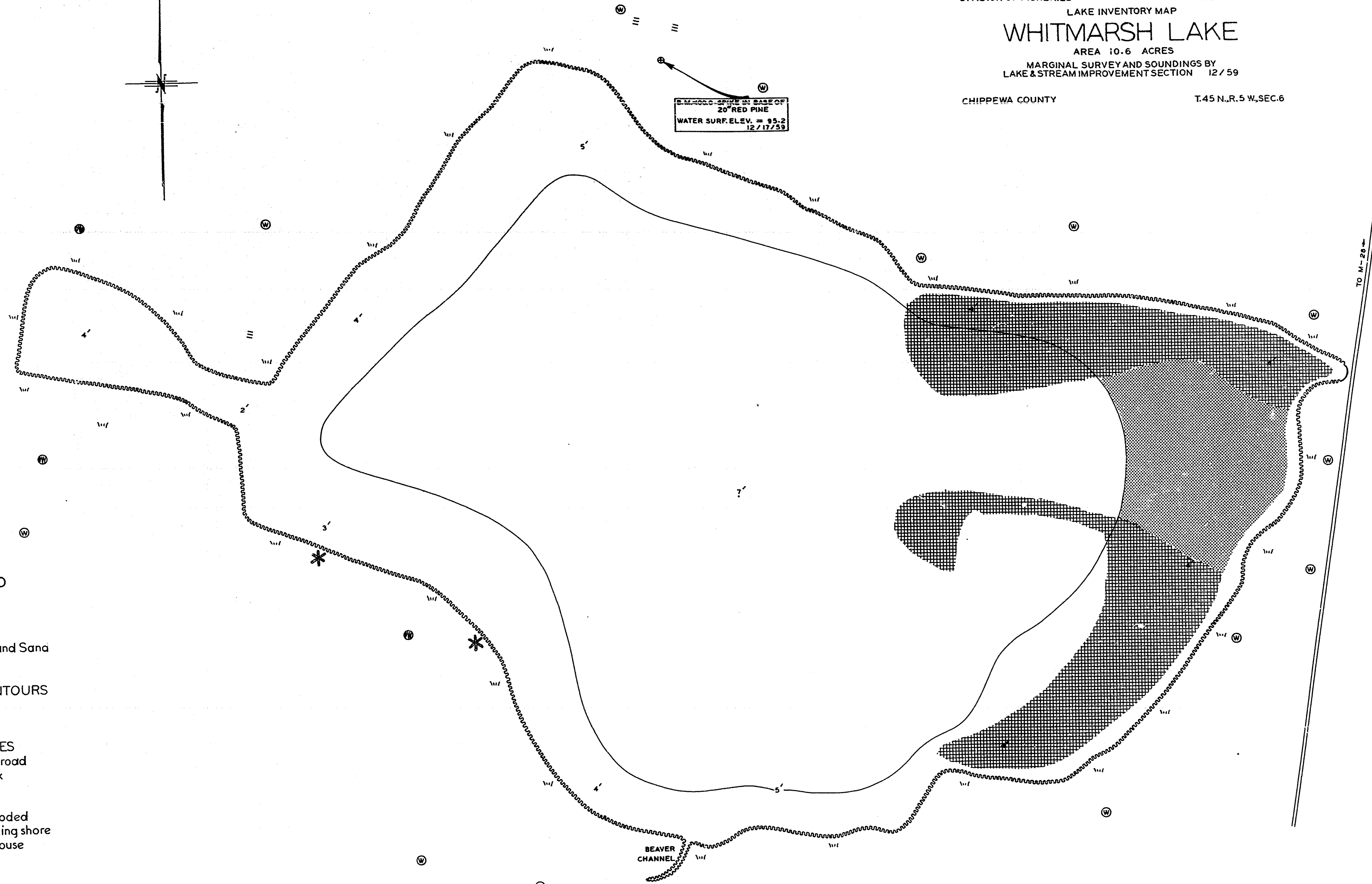

- LEGEND**
- BOTTOM**
- Organic
  - ▨ Organic and Sand
  - ▩ Sand
- OUTLINE & CONTOURS**
- Shoreline
  - 5- Contours
- SHORE FEATURES**
- Improved road
  - ||| High bank
  - wif Marsh
  - ⊙ Wooded
  - ⊙ Partly wooded
  - ~ Encroaching shore
  - \* Beaver house

