

INSTITUTE FOR FISHERIES RESEARCH
 DIVISION OF FISHERIES MICHIGAN CONSERVATION DEPT.
 LAKE INVENTORY MAP
HAYWIRE LAKE
 AREA 3.7 ACRES
 MARGINAL SURVEY AND SOUNDINGS 1/4/46
 MARQUETTE COUNTY T. 45 N., R. 30 W., SEC. 11

LEGEND

- BOTTOM**
 □ Sand
 □ Pulpy peat
 — Deadhead
- OUTLINE & CONTOURS**
 — Shoreline
 — Contours
- SHORE FEATURES**
 = Improved road
 - - - Unimproved road
 - - - Trail
 || Slope
 † Brush
 ⊙ Wooded
 ⊕ Partly wooded
 ⊖ Pasture

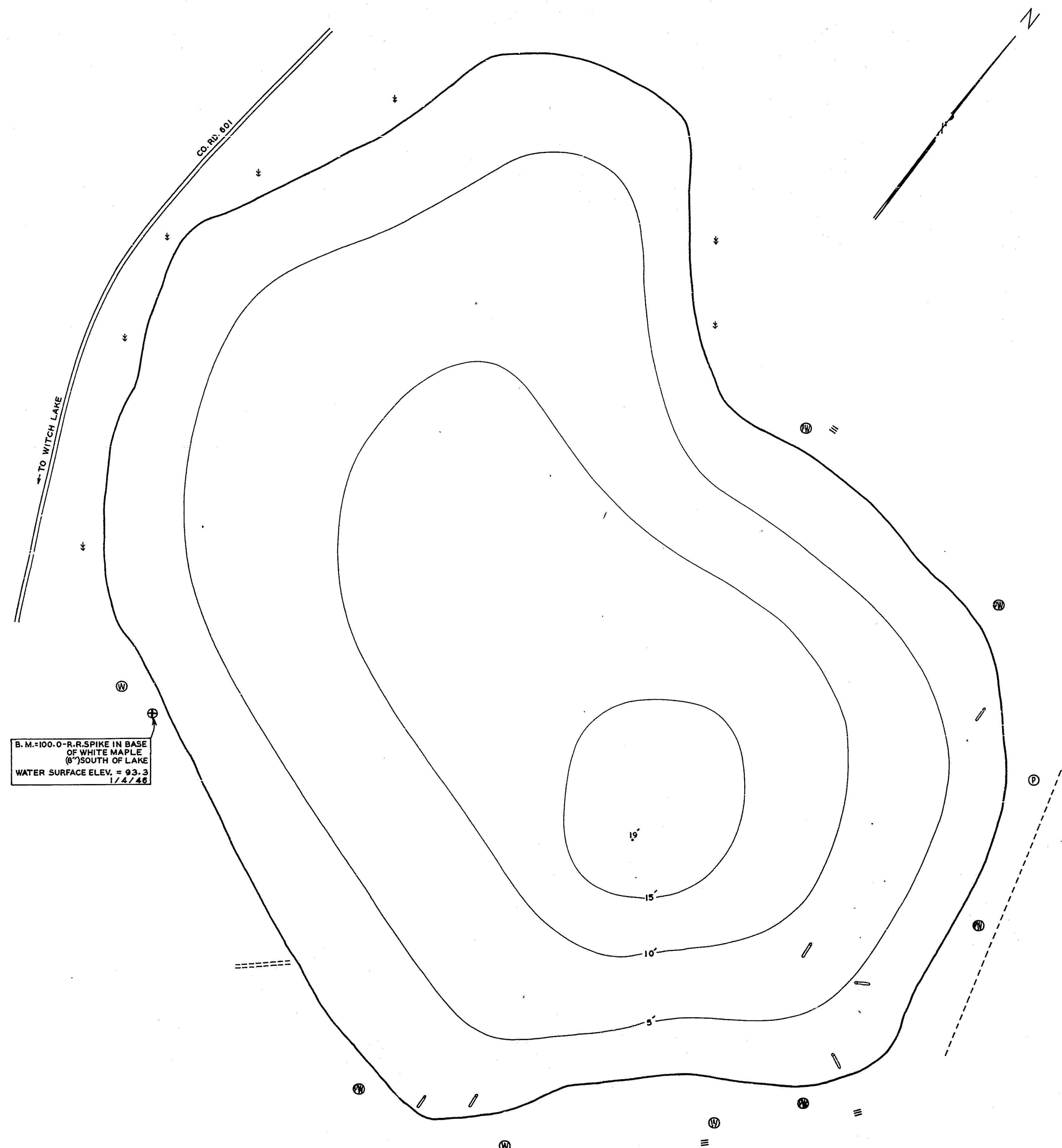

W.C.