



TIMBER SALE MAP

This information provided under authority of Part 525, Act 451 of 1994, as amended.

Sale No.	Year	Sale Type
32-020	07	01

State Forest and Forest Management Unit: GWINN MANAGEMENT UNIT		Mapped By: Kevin LaBumbard		Date: 2/13/2006
Township 44N	Range 26W	Section(s) 35 & 36	Subdivision 35 - NE1/4 36 - NWNW	Scale: 1 inch = 1/4 Mile

Cover Type

- | | | | |
|-------------------|--------------------|----------------------|------------------|
| A = Aspen | H = Hemlock | P = Lowland Poplar | V = Bog or Marsh |
| B = Paper Birch | J = Jack Pine | Q = Mixed Swamp Cnfr | W = White Pine |
| C = Cedar | L = Lowland Brush | R = Red Pine | X = Non Stocked |
| E = Swamp Hdwoods | M = Mpl, Bch, Brch | S = Black Spruce | Z = Water |
| F = Spruce Fir | N = Marsh | T = Tamarack | |
| G = Grass | O = Oak | U = Upland Brush | |

Density

- | | |
|---------------------------|-----------------------|
| 1 = Non Stocked | 7 = Saw Timber Poor |
| 2 = Seedling Sapling Poor | 8 = Saw Timber Medium |
| 3 = Seedling Sapling Well | 9 = Saw Timber Well |
| 4 = Pole Timber Poor | |
| 5 = Pole Timber Medium | |
| 6 = Pole Timber Well | |

GILLIS AGAIN



5.4 ACRES

3:5

3:6

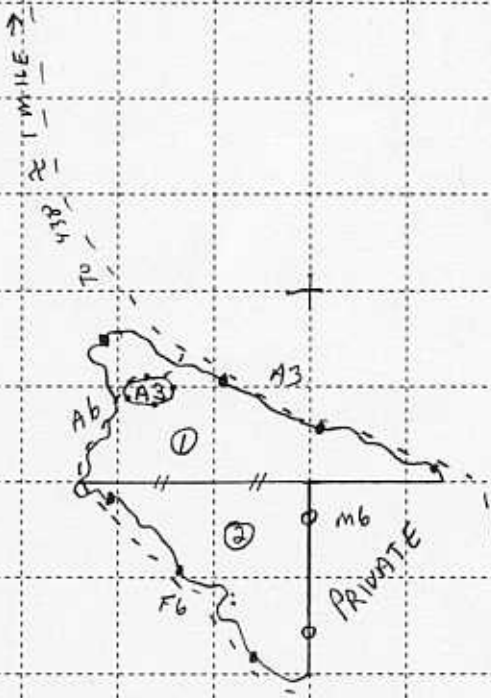

LEGEND

- BLUE PAINT LINE
- RED PAINT LINE
- RED "||" LINE
- PAYMENT UNIT #