

Field Map

Compartment 8
 T29N, R02E, Sec. 7, 8, 9
 County: Montmorency
 Unit: Atlanta
 YOY: 2008
 Acres: 1,466 GIS Calculated
 Stand Examiner: Richard Barber
 Map Revised: 1/02/2007
 Map Phase: Post Review

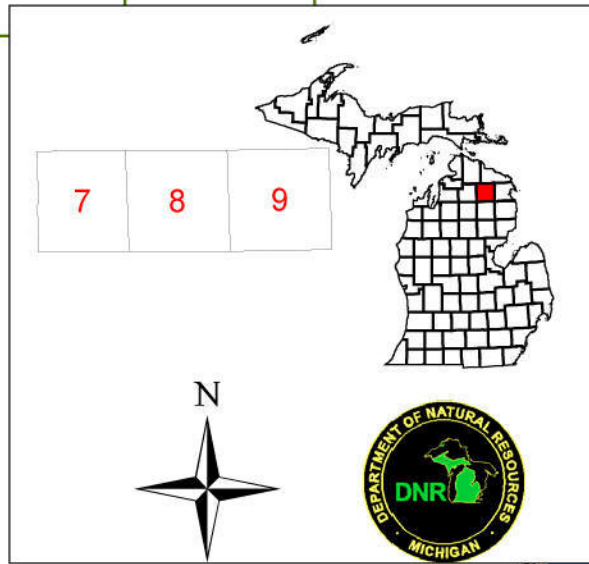
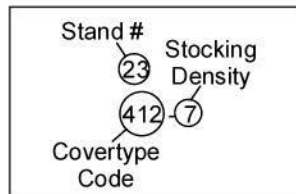

Legend

- Miris Corners
- Paved Roads
- Gravel Roads
- Poor Dirt Roads
- Trails
- Intermittent Stream/Drain
- Stream
- Lakes and Rivers
- MCCCT Trails
- Stands
- Single Tree Selection
- Clearcut
- Other Treatment - See Comments

Forest Stands

- 411 - Northern Hardwood
- 412 - Oak Types
- 413 - Aspen Types
- 612 - Lowland Coniferous Forest

Non-Forest Stands

- 122 - Road/Parking Lot
- 310 - Herbaceous Openland
- 330 - Low-Density Trees
- 500 - Water
- 622 - Lowland Shrub
- 710 - Sand, Soil

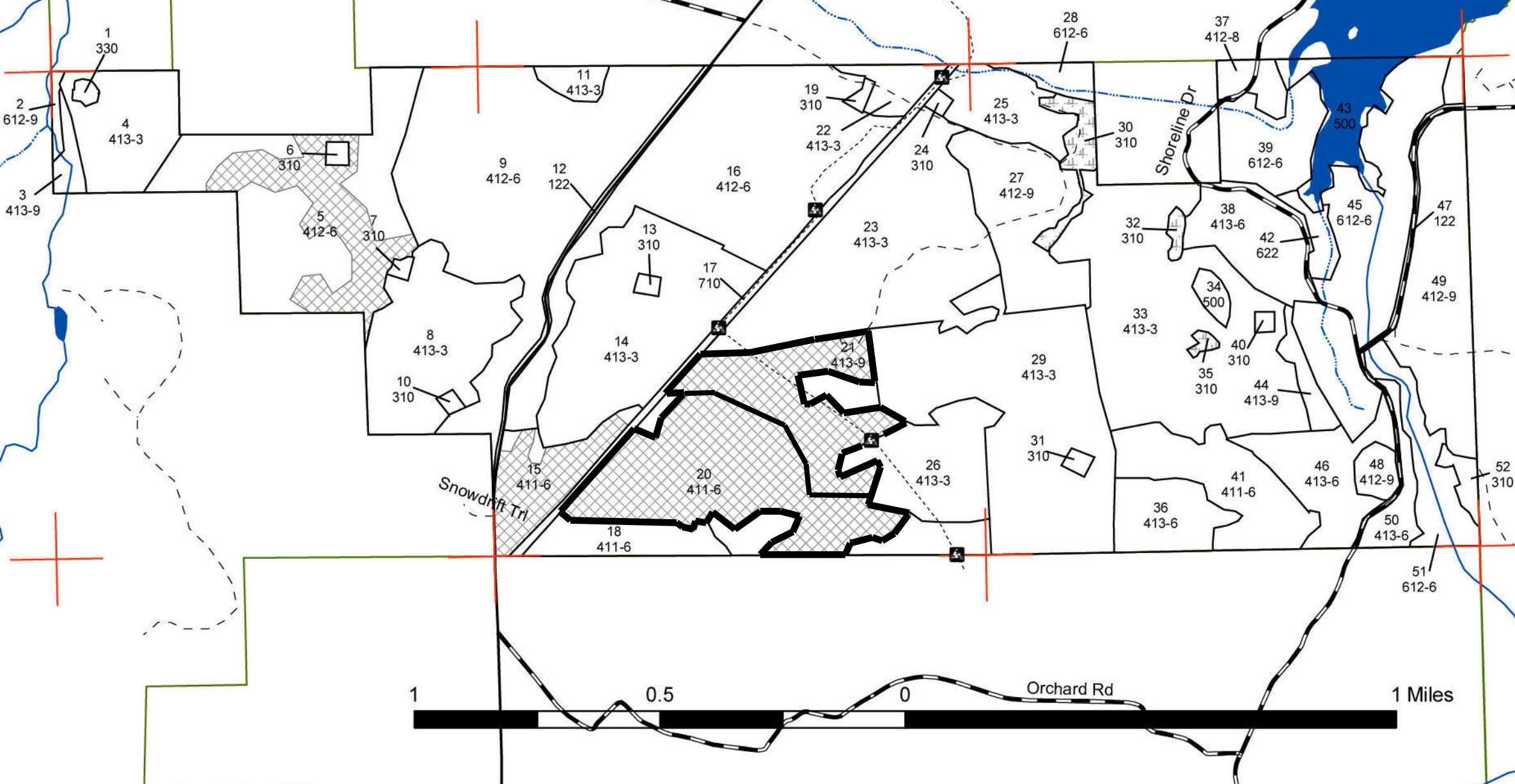

Stocking Density	Definition
1	Sapling low
2	Sapling medium
3	Sapling well
4	Pole timber low
5	Pole timber medium
6	Pole timber well
7	Saw timber low
8	Saw timber medium
9	Saw timber well

Multi-part Stands:
- Stand 49, 2 parts, N of stand 47.

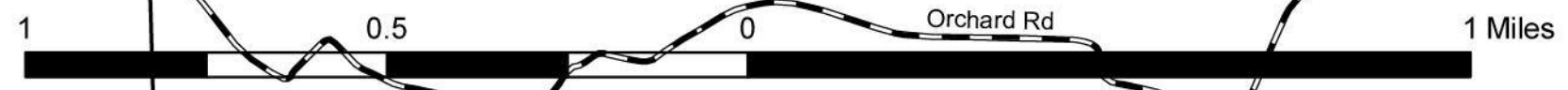

County Road 489