



TIMBER SALE MAP

This information provided by authority of Part 525 of Act 451, PA 1994, as amended.

Sale Number	Year
NA	2008
Date	Page of
04/19/2008	1 1
Scale: 4 inch = 1 mile	

Forest Management Unit	County	Mapped By
Atlanta	Presque Isle	C. Stevens
Township	Range	Section(s) and Subdivision(s)
34N	03E	12: SENE, N1/2SE, SWSE, SESW
Cruised By		NA

Cover Type				Density	
A = Aspen	G = Grass	O = Oak	U = Upland Brush	0 = Non Stocked	5 = Pole Timber Medium
B = Paper Birch	H = Hemlock	P = Lowland Poplar	V = Bog or Marsh	1 = Seedling Sapling Poor	6 = Pole Timber Well
C = Cedar	J = Jack Pine	Q = Mixed Swamp Cnfr	W = White Pine	2 = Seedling Sapling Medium	7 = Saw Timber Poor
D = Treed Bog	L = Lowland Brush	R = Red Pine	X = Non Stocked	3 = Seedling Sapling Well	8 = Saw Timber Medium
E = Swamp Hdwoods	M = Mpl, Bch, Brch	S = Black Spruce	Z = Water	4 = Pole Timber Poor	9 = Saw Timber Well
F = Spruce Fir	N = Marsh	T = Tamarack			

Compartment 135 RPP
Approx. 63 acres
Paint Color & Approx Location

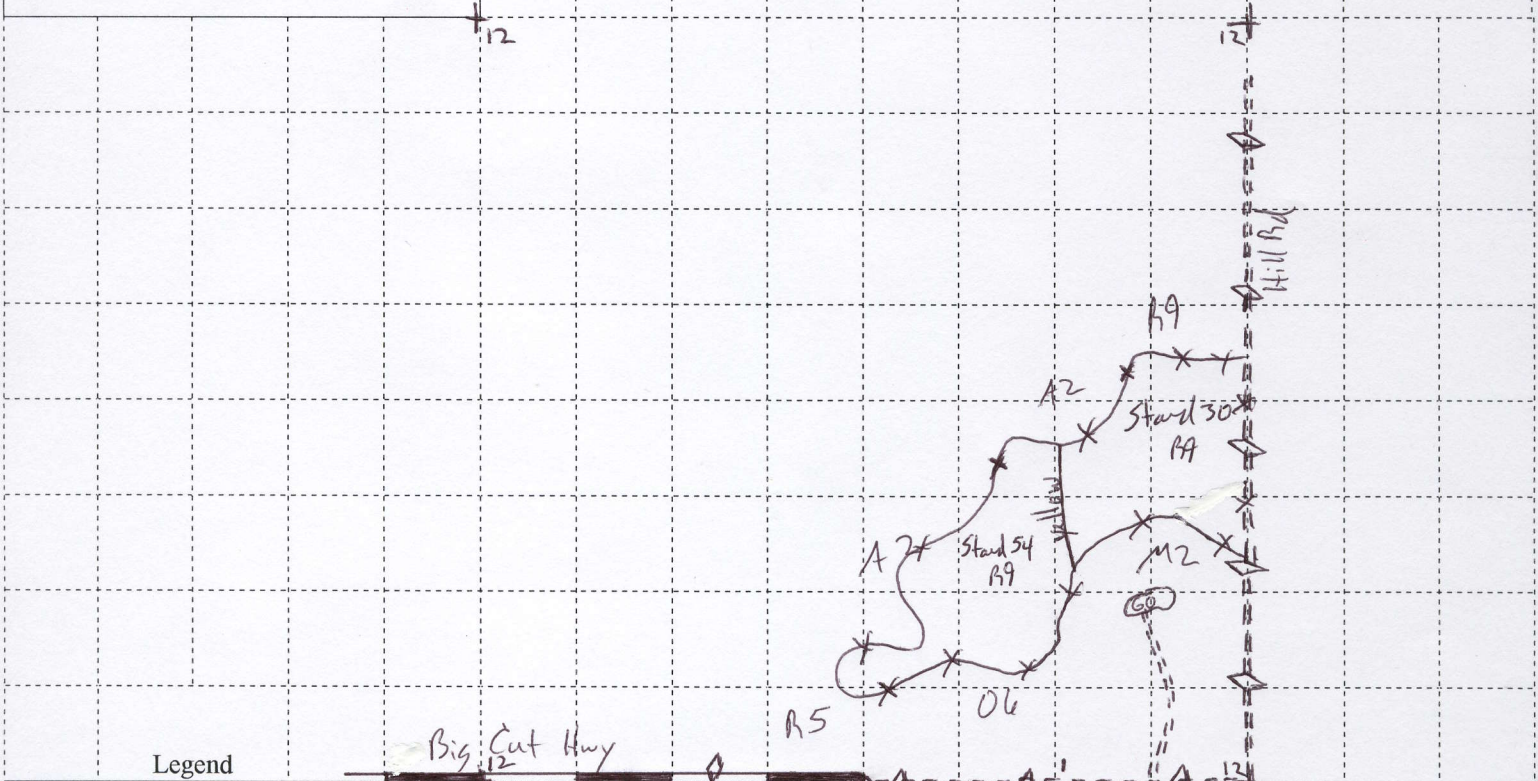

Legend

- Sale Boundary: (Red Paint)
- Private Boundary: (Blue Paint)
- Unit Boundary: (Yellow Paint)
- County Road:
- Two-Track:
- Snowmobile Trail:

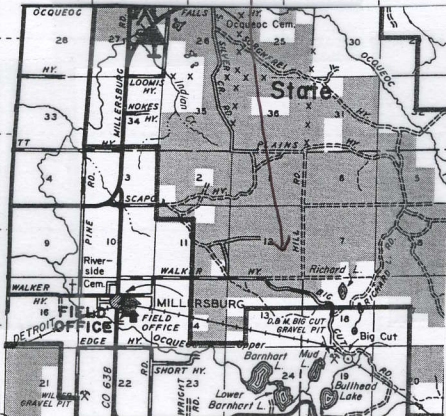

Comp: 135
 Stands: 30 & 54