

STATE OF MICHIGAN
DEPARTMENT OF NATURAL RESOURCES
TIMBER SALE MAP

SALE NO. 0120801
YEAR 08
SALE TYPE 01

STATE FOREST AND FOREST AREA: Copper Country S.F. Crystal Falls M.U.
MAPPED BY: Otto Jacob
DATE: 2/5/08
T 42N R 29W Section(s) 10 S 1/2 SE, S 1/2 SW, sec 9, SESE, sec 17 NENE
15 N 1/2 NE, NW 1/4, NWSW sec 16 E 1/2 NE, NESE, N 1/2 NW, NWNE
COVER TYPE DENSITY Scale: 1 inch = 1/4 mile

- | | | | | | |
|-----------------|--------------------|--------------------|------------------|---------------------------|-----------------------|
| A - Aspen | H - Hemlock | P - Lowland Poplar | V - Bog or Marsh | 1 - Non Stocked | 7 - Saw Timber Poor |
| B - Paper Birch | J - Jack Pine | Q - Mx Swamp Cnpr | W - White Pine | 2 - Seedling Sapling Poor | 8 - Saw Timber Medium |
| C - Cedar | L - Lowland Brush | R - Red Pine | X - Non Stocked | 3 - Seedling Sapling Well | 9 - Saw Timber Well |
| E - Swamp Hdws | M - Mpl, Bch, Brch | S - Black Spruce | Z - Water | 4 - Pole Timber Poor | |
| F - Spruce Fir | N - Marsh | T - Tamarack | | 5 - Pole Timber Medium | |
| G - Grass | O - Oak | U - Upland Brush | | 6 - Pole Timber Well | |

UNIT	Acres
1	13
2	39
3	20
4	23
5	43
6	24
7	26
8	34
9	30
10	29
11	30
	311

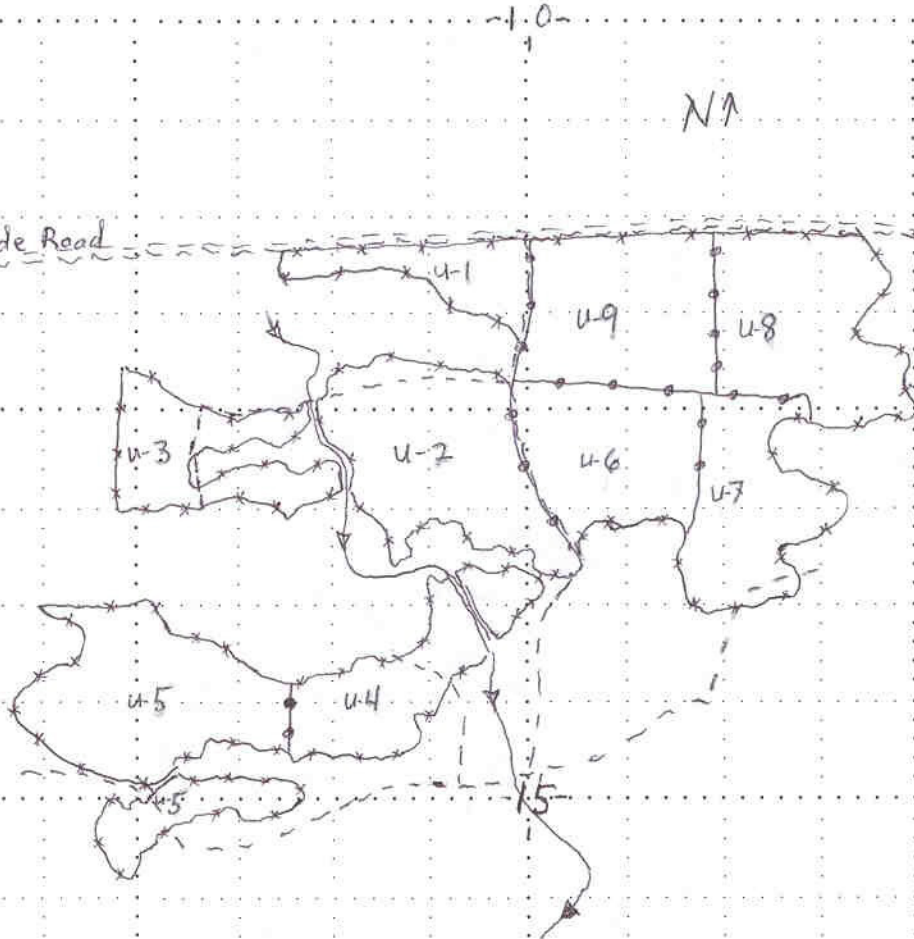

Weasel Huffer
311 Acres

- Key
- Woods Road
 - Poor Woods Road
 - creek
 - Red Boundary line
 - Red Limit Line

Map 1 of 2

STATE OF MICHIGAN
DEPARTMENT OF NATURAL RESOURCES
TIMBER SALE MAP

SALE NO. 10120801 YEAR 08 SALE TYPE 01

STATE FOREST AND FOREST AREA: Copper Country S.E. Crystal Falls M.U.
 MAPPED BY: Otto JACOB
 DATE: 2/5/08
 T 42N R 29W Section(s) Sub. Scale: 1 inch = 1/4 mile

COVER TYPE

DENSITY

- | | | | | | |
|-----------------|--------------------|--------------------|------------------|---------------------------|-----------------------|
| A - Aspen | H - Hemlock | P - Lowland Poplar | V - Bog or Marsh | 1 - Non Stocked | 7 - Saw Timber Poor |
| B - Paper Birch | J - Jack Pine | Q - Mx Swamp Cnpr | W - White Pine | 2 - Seedling Sapling Poor | 8 - Saw Timber Medium |
| C - Cedar | L - Lowland Brush | R - Red Pine | X - Non Stocked | 3 - Seedling Sapling Well | 9 - Saw Timber Well |
| E - Swamp Hdws | M - Mpl, Bch, Brch | S - Black Spruce | Z - Water | 4 - Pole Timber Poor | |
| F - Spruce Fir | N - Marsh | T - Tamarack | | 5 - Pole Timber Medium | |
| G - Grass | O - Oak | U - Upland Brush | | 6 - Pole Timber Well | |

