



TIMBER SALE MAP

This information provided by authority of Part 525 of Act 451, PA 1994, as amended.

Sale Number	Year
32-021-08-01	2008

Forest Management Unit Gwinn	County Alger	Mapped By Jerry Mohlman	Date 2/6/08	Page 1	of 1
Township 44N	Range 22W	Section(s) and Subdivision(s) 34 NWSW, NESW, NWSE, SWNE, SENW	33-SESE, NESE		

Cover Type				Density	
A = Aspen	G = Grass	O = Oak	U = Upland Brush	0 = Non Stocked	5 = Pole Timber Medium
B = Paper Birch	H = Hemlock	P = Lowland Poplar	V = Bog or Marsh	1 = Seedling Sapling Poor	6 = Pole Timber Well
C = Cedar	J = Jack Pine	Q = Mixed Swamp Cnfr	W = White Pine	2 = Seedling Sapling Medium	7 = Saw Timber Poor
D = Treed Bog	L = Lowland Brush	R = Red Pine	X = Non Stocked	3 = Seedling Sapling Well	8 = Saw Timber Medium
E = Swamp Hdwoods	M = Mpl, Bch, Brch	S = Black Spruce	Z = Water	4 = Pole Timber Poor	9 = Saw Timber Well
F = Spruce Fir	N = Marsh	T = Tamarack			



WERNER BRIDGE SALE

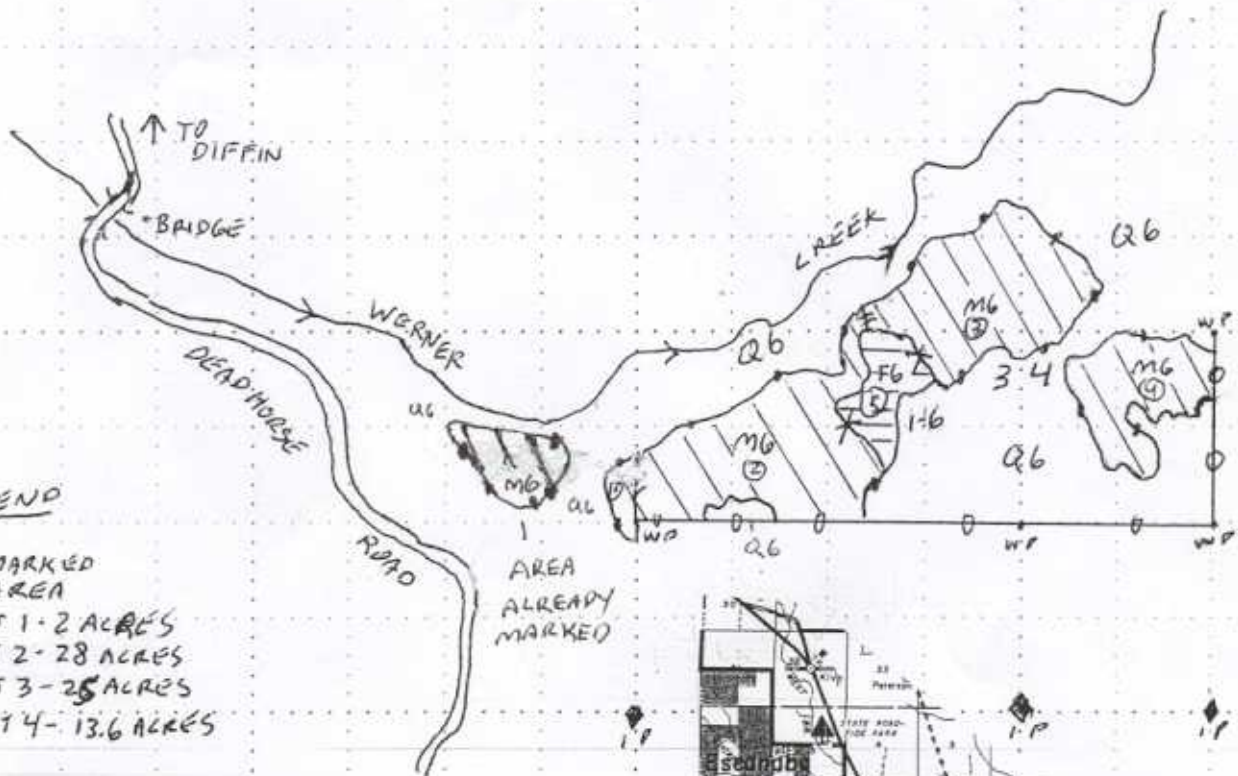

LEGEND

- MARKED AREA
- UNIT 1 - 2 ACRES
- UNIT 2 - 28 ACRES
- UNIT 3 - 25 ACRES
- UNIT 4 - 13.6 ACRES
- CLEARCUT 7.5 ACRES
- BLUE PAINT
- RED PAINT
- RED X
- RED DOUBLE SLASH
- UNIT BOUNDARIES
- IRON PIPE CORNER
- WOOD POST CORNER
- PAYMENT UNIT #S.

