



Michigan Department of Natural Resources-Forest Management Division  
**TIMBER SALE MAP**

*This information provided under authority of Part 525, Act 451 of 1994, as amended.*

Sale No.	Year	Sale Type
033	08	01

State Forest and Forest Management Unit: <b>Pere Marquette - Traverse City</b>		Mapped By: <b>Patrick Ruppen</b>	Date: <b>4/10/2008</b>
Township <b>25N</b>	Range <b>9W</b>	Section(s) <b>27</b>	Subdivision <b>part of NWNW</b>
			Scale: <b>1:15,840</b>

**Cover Type**

**Density**

A=Aspen	H=Hemlock	P=Lowland Poplar	V=Bog or Marsh	1=Non Stocked	7=Saw Timber Poor
B=Paper Birch	J=Jack Pine	Q=Mixed Swamp Cnfr	W=White Pine	2=Seedling Sapling Poor	8=Saw Timber Medium
C=Cedar	L=Lowland Brush	R=Red Pine	X=Non Stocked	3=Seedling Sapling Well	9=Saw Timber Well
E=Swamp Hdwoods	M=Mp l, Bch, Bch	S=Black Spruce	Z=Water	4=Pde Timber Poor	
F=Spruce Fir	N=Marsh	T=Tamarack		5=Pde Timber Medium	
G=Grass	O=Oak	U=Upland Brush		6=Pde Timber Well	



# Walton Road Pine

Sale Area 13.9 acres

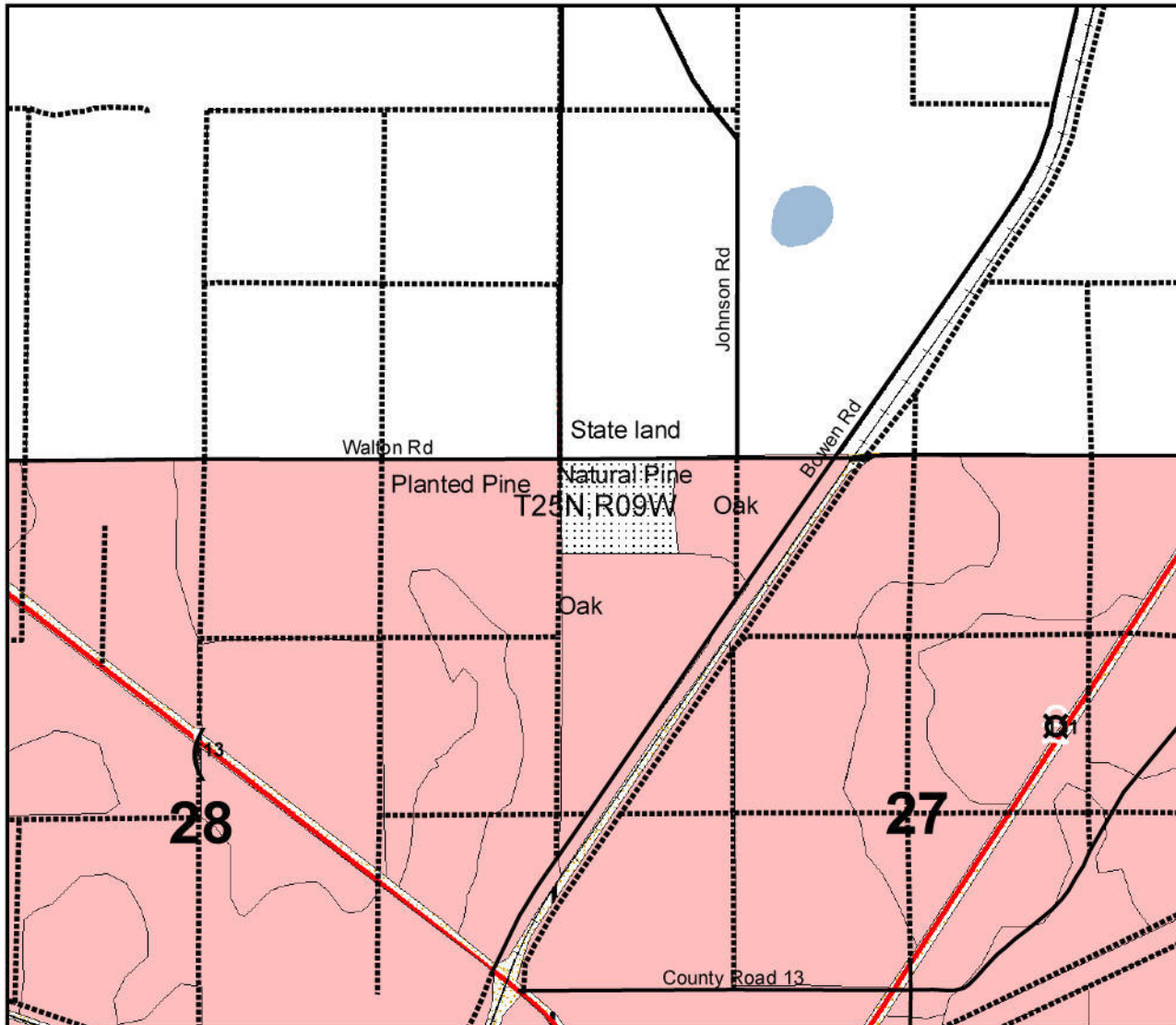

## Legend

-  Non-Forest Stands - state land
-  Forest Stands
-  Walton Road Pine