



Michigan Department of Natural Resources – Forest, Mineral & Fire Management
TIMBER SALE MAP

This information is provided by authority of Part 525 of Act 451, PA 1994, as amended.

SAI F NUMBER	YEAR
63-013-09-01	2009
DATE	PAGE OF
01/12/2009	1 2

FOREST MANAGEMENT UNIT Cadillac FMU		COUNTY Missaukee	MAPPED BY Steve Eisele CRUISED BY
TOWNSHIP 21N	RANGE 05W	SECTION(S) AND SUBDIVISION(S) 13, 15, 16	

1:15,840

Cover Type				Density	
A = Aspen	H = Hemlock	P = Lowland Poplar	V = Bog or Marsh	0 = Non Stocked	5 = Pole Timber Medium
B = Paper Birch	J = Jack Pine	Q = Mixed Swamp Cnfr	W = White Pine	1 = Seedling Sapling Poor	6 = Pole Timber Well
C = Cedar	L = Lowland Brush	R = Red Pine	X = Non Stocked	2 = Seedling Sapling Medium	7 = Saw Timber Poor
E = Swamp Hdwoods	M = Mpl. Bch, Brch	S = Black Spruce	Z = Water	3 = Seedling Sapling Well	8 = Saw Timber Medium
F = Spruce Fir	N = Marsh	T = Tamarack		4 = Pole Timber Poor	9 = Saw Timber Well
G = Grass	O = Oak	U = Upland Brush			

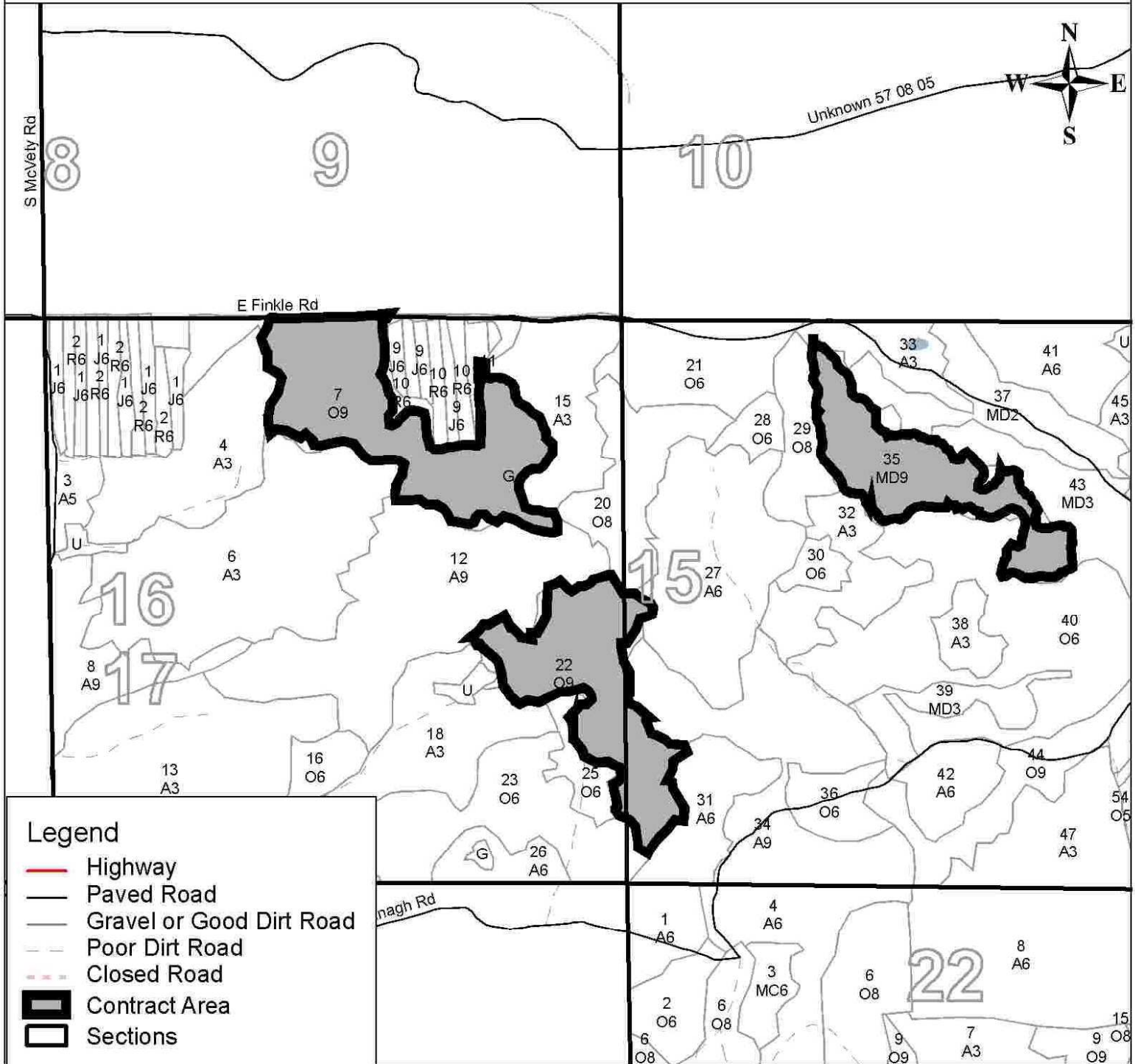

Legend

- Highway
- Paved Road
- Gravel or Good Dirt Road
- Poor Dirt Road
- Closed Road
- Contract Area
- Sections

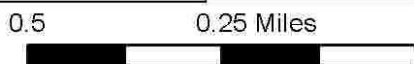



Michigan Department of Natural Resources – Forest, Mineral & Fire Management
TIMBER SALE MAP

This information is provided by authority of Part 525 of Act 451, PA 1994, as amended.

SAI F NUMBER	YEAR
63-013-09-01	2009
DATE	PAGE OF
01/12/2009	2 2

FOREST MANAGEMENT UNIT Cadillac FMU		COUNTY Missaukee	MAPPED BY Steve Eisele
TOWNSHIP 21N		RANGE 05W	CRUISED BY
SECTION(S) AND SUBDIVISION(S) 13, 15, 16			1:15,840

Cover Type				Density	
A = Aspen	H = Hemlock	P = Lowland Poplar	V = Bog or Marsh	0 = Non Stocked	5 = Pole Timber Medium
B = Paper Birch	J = Jack Pine	Q = Mixed Swamp Cnfr	W = White Pine	1 = Seedling Sapling Poor	6 = Pole Timber Well
C = Cedar	L = Lowland Brush	R = Red Pine	X = Non Stocked	2 = Seedling Sapling Medium	7 = Saw Timber Poor
E = Swamp Hdwoods	M = Mpl. Bch, Brch	S = Black Spruce	Z = Water	3 = Seedling Sapling Well	8 = Saw Timber Medium
F = Spruce Fir	N = Marsh	T = Tamarack		4 = Pole Timber Poor	9 = Saw Timber Well
G = Grass	O = Oak	U = Upland Brush			

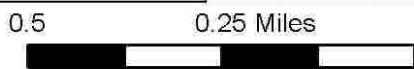
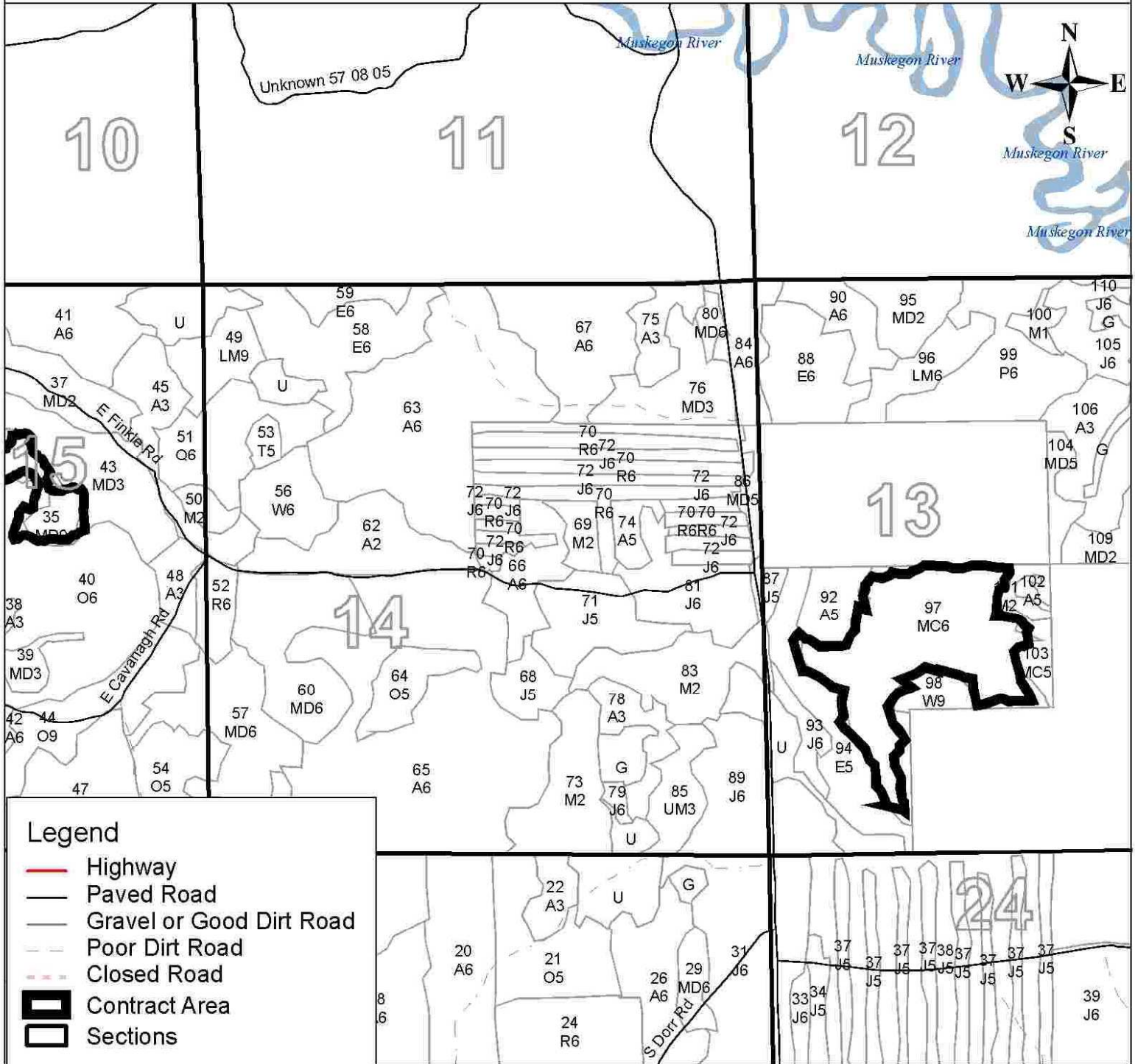



Michigan Department of Natural Resources – Forest, Mineral & Fire Management
TIMBER SALE MAP

This information is provided by authority of Part 525 of Act 451, PA 1994, as amended.

SAI F NUMBER	YEAR
63-013-09-01	2009
DATE	PAGE OF
01/12/2009	2 2

FOREST MANAGEMENT UNIT Cadillac FMU	COUNTY Missaukee	MAPPED BY Steve Eisele CRUISED BY
TOWNSHIP 21N	RANGE 05W	SECTION(S) AND SUBDIVISION(S) 13, 15, 16

1:15,840

Cover Type				Density	
A = Aspen	H = Hemlock	P = Lowland Poplar	V = Bog or Marsh	0 = Non Stocked	5 = Pole Timber Medium
B = Paper Birch	J = Jack Pine	Q = Mixed Swamp Cnfr	W = White Pine	1 = Seedling Sapling Poor	6 = Pole Timber Well
C = Cedar	L = Lowland Brush	R = Red Pine	X = Non Stocked	2 = Seedling Sapling Medium	7 = Saw Timber Poor
E = Swamp Hdwoods	M = Mpl. Bch, Brch	S = Black Spruce	Z = Water	3 = Seedling Sapling Well	8 = Saw Timber Medium
F = Spruce Fir	N = Marsh	T = Tamarack		4 = Pole Timber Poor	9 = Saw Timber Well
G = Grass	O = Oak	U = Upland Brush			

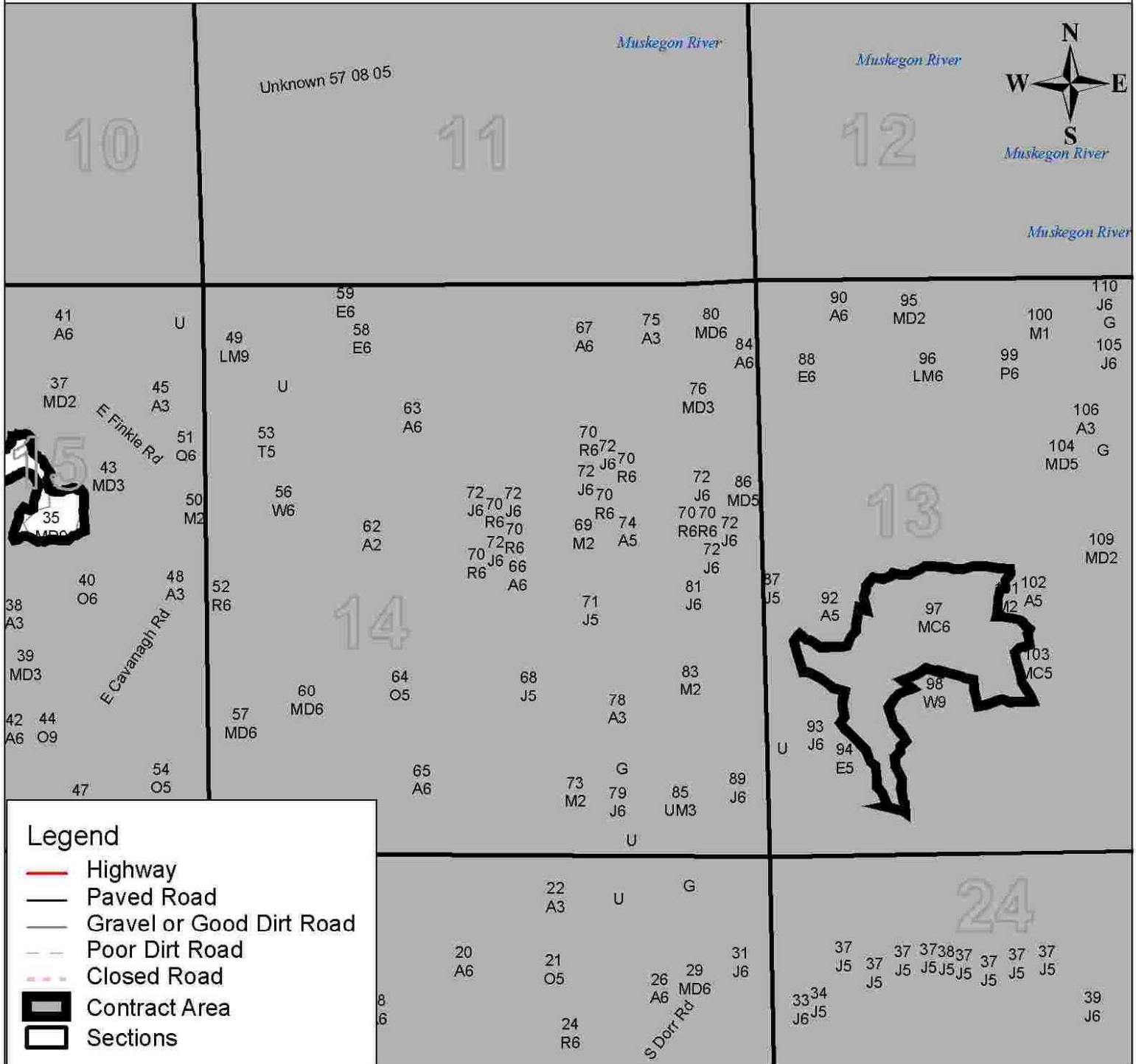

Legend

- Highway
- Paved Road
- Gravel or Good Dirt Road
- Poor Dirt Road
- Closed Road
- Contract Area
- Sections

