

Compartment 3  
 T20N, R4W, Sec. 34  
 County: Clare  
 Unit: Gladwin  
 YOE: 2010  
 Acres: 2,876  
 Stand Examiner: Steven Nyhoff

# Half Moon Harvest

73-004-10-01



Blue Sale Boundary Line

Yellow Sale Cutting Unit

Red Sale Boundary Line

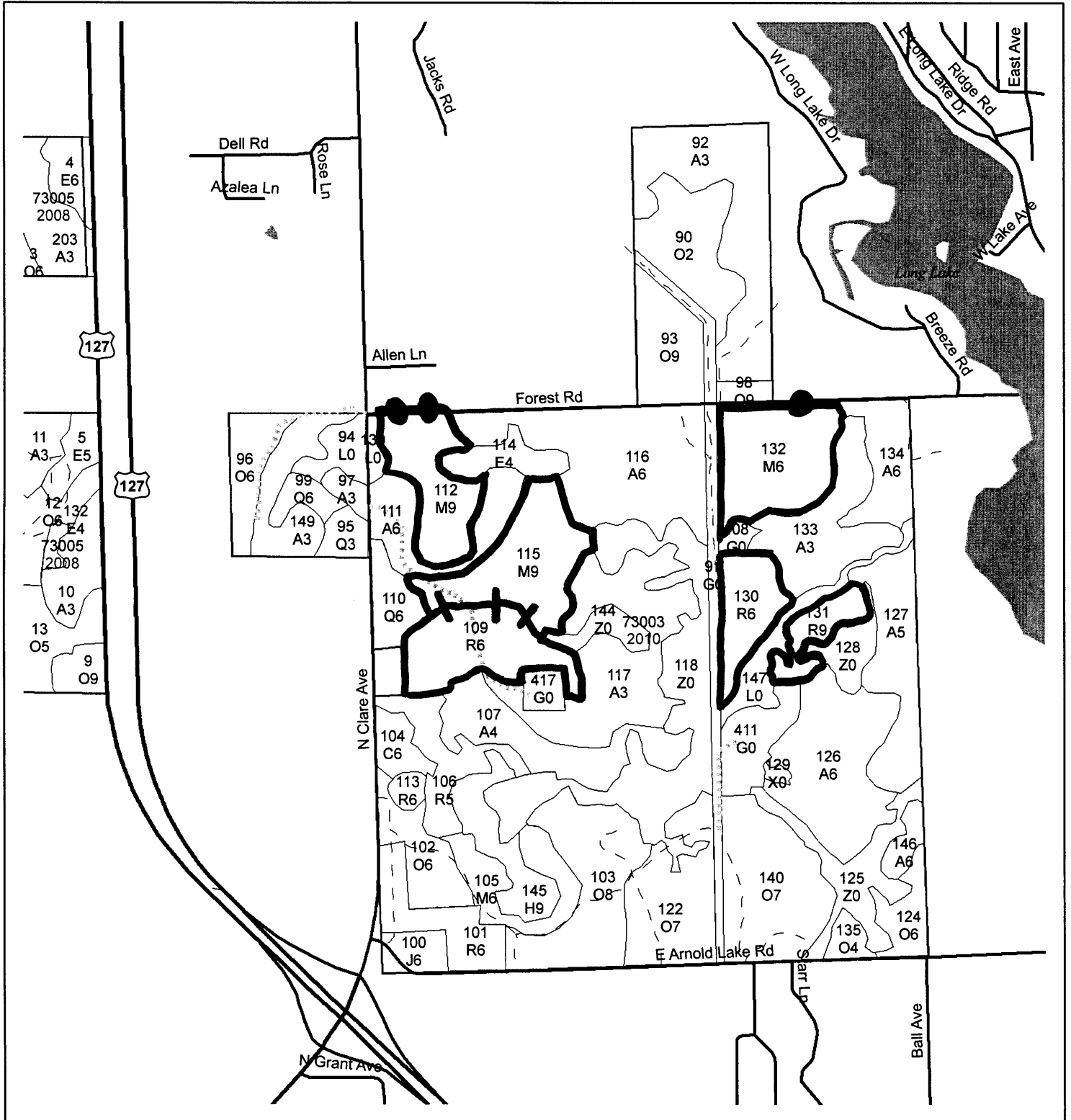

0.3 0.15 0 0.3 Miles

