



Michigan Department of Natural Resources & Environment - Forest Management Division

Sale Number

Year

TIMBER SALE MAP

70-005-11-01

2011

This information provided by authority of Part 525, 1994 PA 451, as amended.

Forest Management Unit GLADWIN	County IOSCO	Mapped By Richard Myrick	Date 03/29/2011	Page 1	of 1
Township T21N	Range R06E	Cruised By N/A	Section(s) and Subdivision(s) Sec 26, SE of the SW		

Township T21N		Range R06E	Section(s) and Subdivision(s) Sec 26, SE of the SW	1:15,840
-------------------------	--	----------------------	--	----------

Cover Type				Density		
A = Aspen	G = Grass	O = Oak	U = Upland Brush	0 = Non Stocked	5 = Pole Timber Medium	
B = Paper Birch	H = Hemlock	P = Lowland Poplar	V = Bog or Marsh	1 = Seedling Sapling Poor	6 = Pole Timber Well	
C = Cedar	J = Jack Pine	Q = Mixed Swamp Cnfr	W = White Pine	2 = Seedling Sapling Medium	7 = Saw Timber Poor	
D = Treed Bog	L = Lowland Brush	R = Red Pine	X = Non Stocked	3 = Seedling Sapling Well	8 = Saw Timber Medium	
E = Swamp Hdwoods	M = Mpl, Bch, Brch	S = Black Spruce	Z = Water	4 = Pole Timber Poor	9 = Saw Timber Well	
F = Spruce Fir	N = Marsh	T = Tamarack				

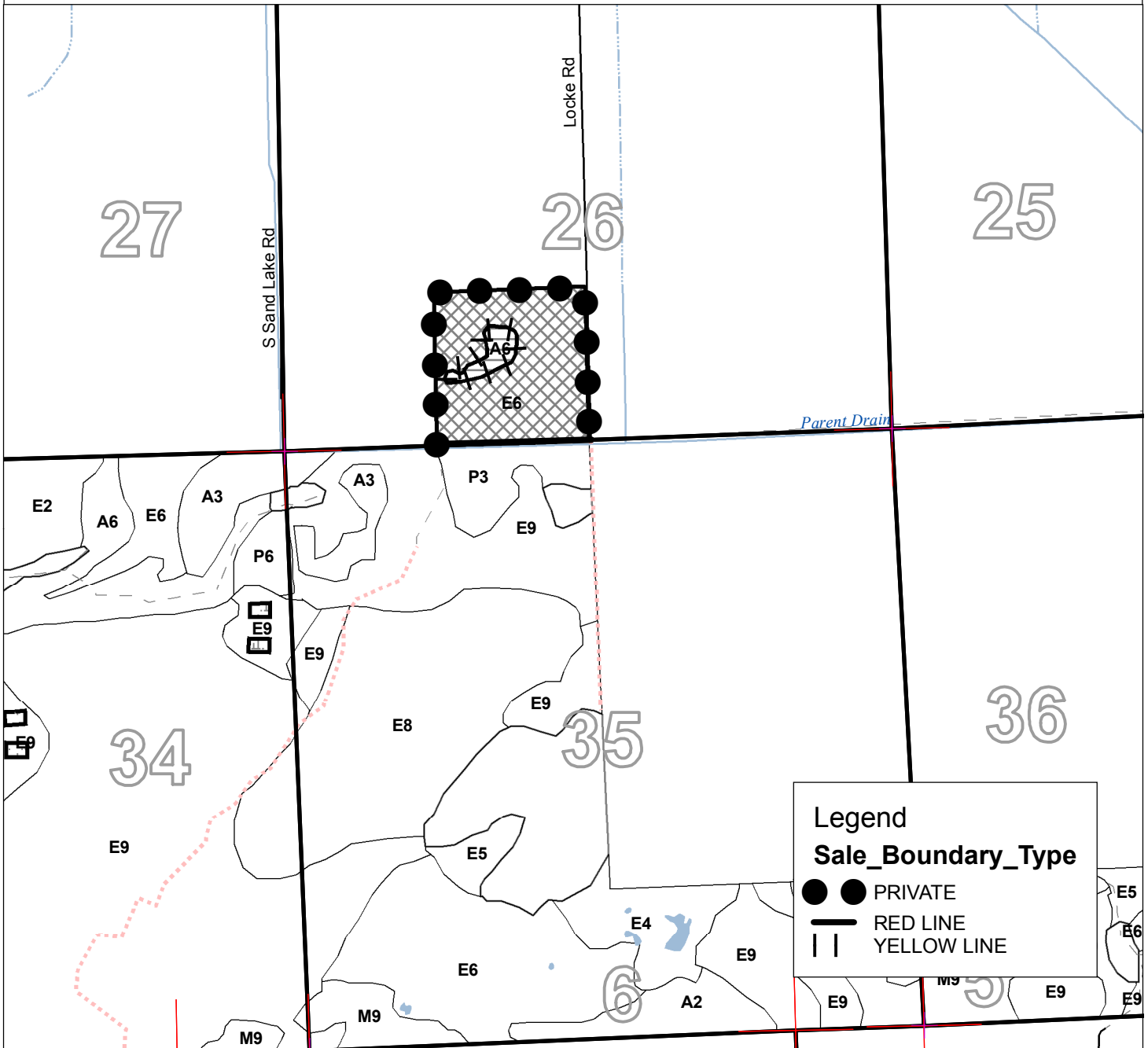

Legend

Sale_Boundary_Type

- ● PRIVATE
- RED LINE
- - - YELLOW LINE

