



TIMBER SALE MAP

This information provided by authority of Part 525 of Act 451, PA 1994, as amended.

| | |
|-------------|------|
| SALE NUMBER | YEAR |
| 120531301 | 2013 |

| | | | | | | |
|---|--------------|--|---------------------------|--------------------------------------|-----------|---------|
| FOREST MANAGEMENT UNIT: CRYSTAL FALLS | | COUNTY Iron | MAPPED BY SCOTT SEBERO | DATE 10/16/2012 | PAGE 1 | OF 1 |
| TOWNSHIP 43N | RANGE 33W | SECTION(S) AND SUBDIVISION(S) 6 E1/2, SENW 7 N1/2NE, SWNE | | Scale: 4 inches..... = 1 mile | | |

| Cover Type | | | | Density | |
|-------------------|--------------------|----------------------|------------------|-----------------------------|------------------------|
| A = Aspen | H = Hemlock | P = Lowland Poplar | V = Bog or Marsh | 0 = Non Stocked | 5 = Pole Timber Medium |
| B = Paper Birch | J = Jack Pine | Q = Mixed Swamp Cnfr | W = White Pine | 1 = Seedling Sapling Poor | 6 = Pole Timber Well |
| C = Cedar | L = Lowland Brush | R = Red Pine | X = Non Stocked | 2 = Seedling Sapling Medium | 7 = Saw Timber Poor |
| E = Swamp Hdwoods | M = Mpl, Bch, Brch | S = Black Spruce | Z = Water | 3 = Seedling Sapling Well | 8 = Saw Timber Medium |
| F = Spruce Fir | N = Marsh | T = Tamarack | | 4 = Pole Timber Poor | 9 = Saw Timber Well |
| G = Grass | O = Oak | U = Upland Brush | | | |

Spray Can
189 Acres
Unit 1 - 30 acres
Unit 2 - 17 acres
Unit 3 - 23 acres
Unit 4 - 16 acres
Unit 5 - 46 acres
Unit 6 - 57 acres

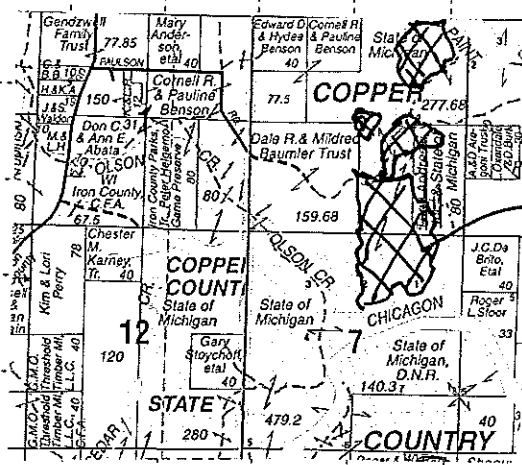
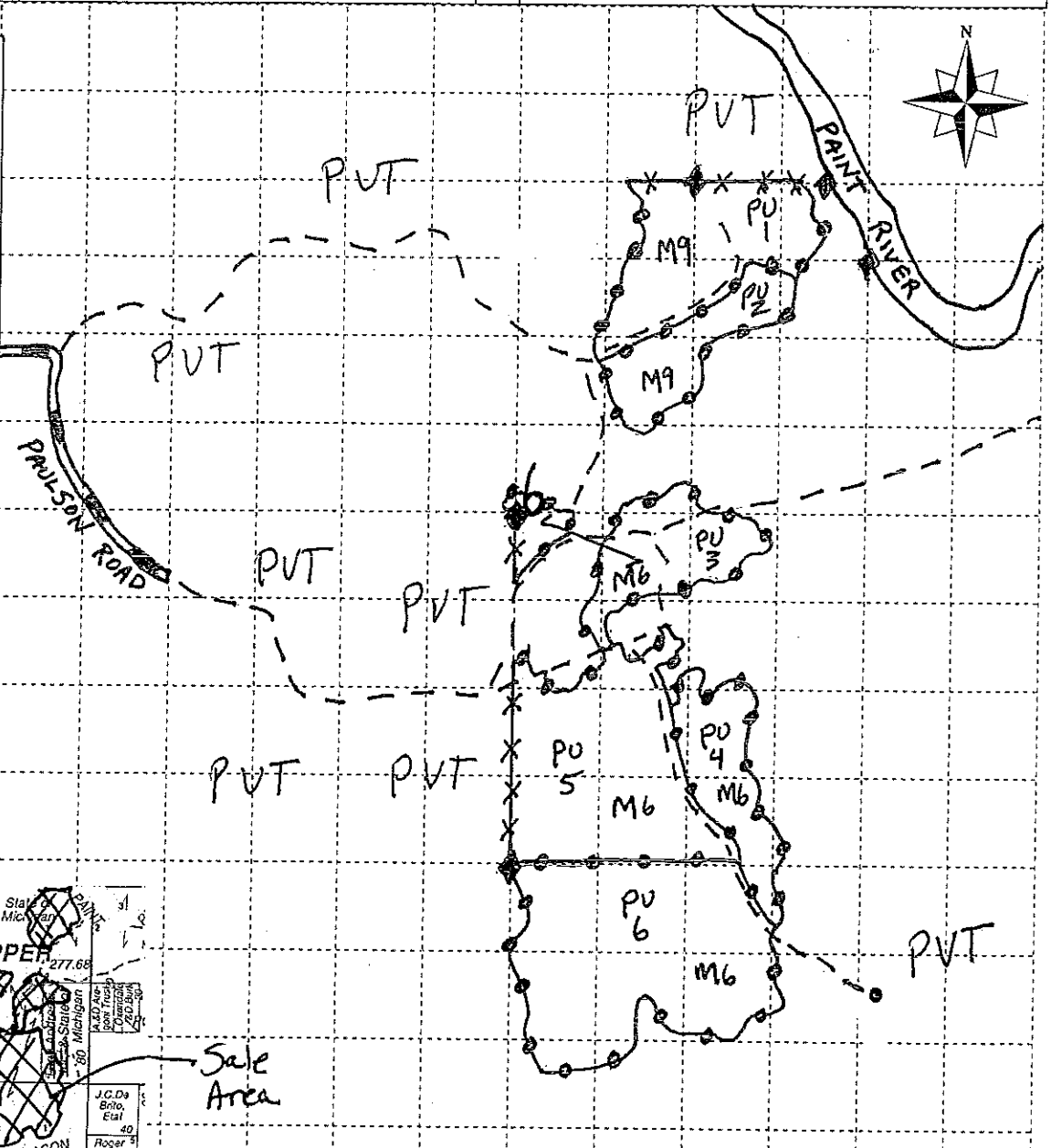

Sale Area

LEGEND

| | |
|--------------------|------|
| BLUE PROPERTY LINE | |
| RED BOUNDARY LINE | |
| TRAIL ROAD | |
| SURVEY CORNER | |
| CENTER SECTION | 6 |
| PAYMENT UNIT | PU 4 |